

INDEX OF SHEETS

Sheet No.	Description
1	COVER SHEET
2	TYPICAL CROSS SECTIONS AND DETAILS
3	DETAILS & SCHEDULES

STANDARDS

701301-01	TRAFFIC CONTROL
701306-01	TRAFFIC CONTROL
702001-05	TRAFFIC CONTROL

STATE OF ILLINOIS
DEPARTMENT OF TRANSPORTATION
COUNTY OF KANKAKEE
DEPARTMENT OF HIGHWAYS
PLANS FOR PROPOSED
FEDERAL AID SECONDARY PROJECT
SECTION 04-00068-02-RS
F.A.S. 1320 (CH 3)

PROJECT RS - 1320(106) JOB NO. C-93-047-05

F.A.S. ROUTE NO.	SEC.	COUNTY	NO. SHEETS	SHEET NO.
1320	*	Kankakee	3	1
ILLINOIS PROJECT		Contract No. 87308		
* 04-00068-02-RS		KANKAKEE COUNTY		

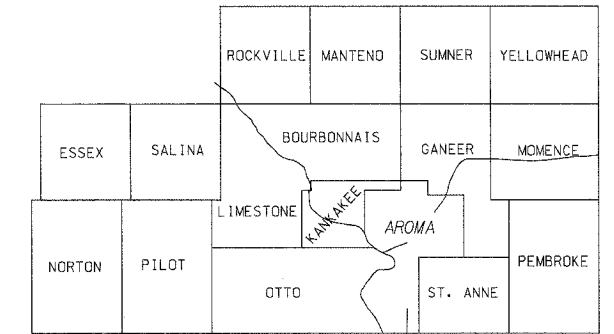

PROJECT LOCATION



SUMMARY OF QUANTITIES

CODE NO.	Description	Quantity	Unit
* X4066414	BITUMINOUS CONCRETE SURFACE COURSE, SUPERPAVE MIXTURE C, N 50	860	TON
* X4066765	LEVELING BINDER (MACHINE METHOD) SUPERPAVE MIXTURE C, N 50	667	TON
* 40600100	BITUMINOUS MATERIALS (PRIME COAT)	1226	GALLON
40600300	AGGREGATE (PRIME COAT)	29	TON
40600980	BITUMINOUS SURFACE REMOVAL - BUTT JOINT	177	SQ YD
40600990	TEMPORARY RAMP	14	SQ YD
40800040	INCIDENTAL BITUMINOUS SURFACING	65	TON
44000005	BITUMINOUS SURFACE REMOVAL 1 1/4"	289	SQ YD
* 48101200	AGGREGATE SHOULDERS, TYPE B	650	TON
* 70100460	TRAFFIC CONTROL AND PROTECTION, STANDARD 701306	1	L SUM
* 70300100	SHORT-TERM PAVEMENT MARKING	1072	FOOT
67100100	MOBILIZATION	1	L SUM

* Special Provisions

Construction Code I000

CONSTRUCTION STARTS
STA. 221+86
(S. ER FAS 1322 CH 37)
Stationing per 92-00068-01-RS

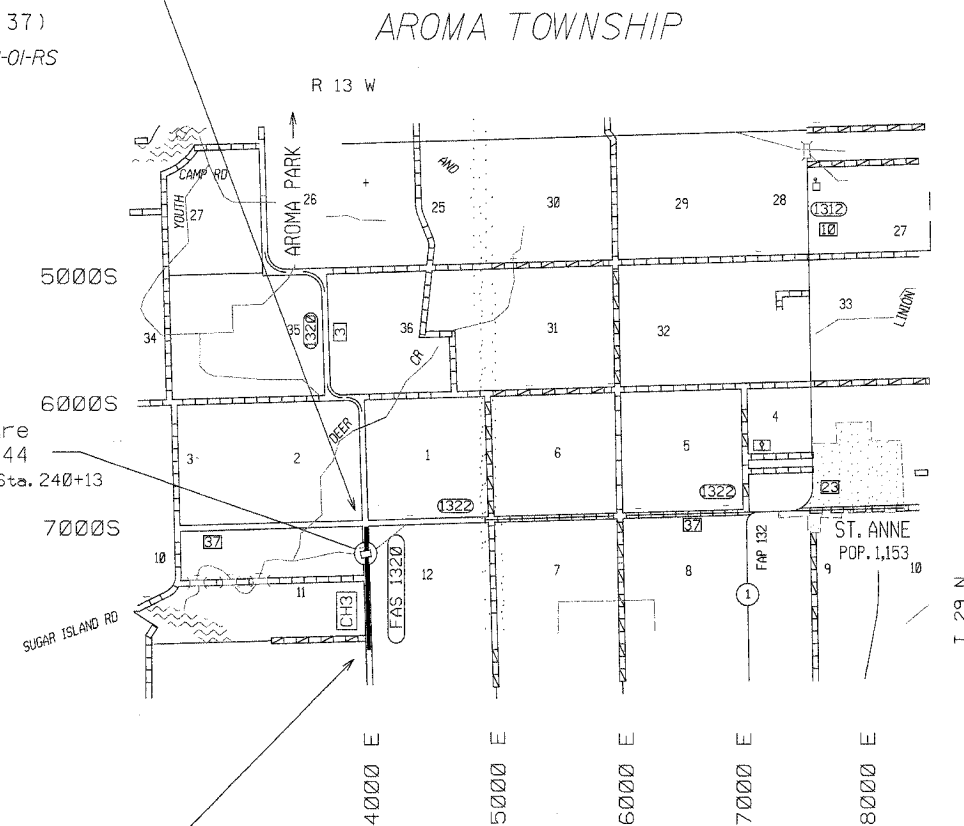

CONSTRUCTION ENDS
STA. 275+45
(South Kankakee County Line)

LOCATION MAP

No Scale

NET LENGTH = 5359 LIN FT = 1.015 MILES

THE ACCEPTANCE OF THIS PROJECT IS BASED ON THE MINIMUM DESIGN CRITERIA FOR LOCAL AGENCY PAVEMENT PRESERVATION POLICY (LAPP) PROJECTS

CLASS III ROAD
CURRENT A.D.T. = 670 2005
DESIGN A.D.T. = 704 2010
DESIGN SPEED = 50 M.P.H.
Functional Class = Collector

STATE OF ILLINOIS
DEPARTMENT OF TRANSPORTATION
DIVISION OF HIGHWAYS

Submitted 6-3 2005

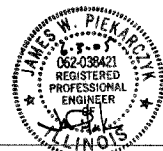

James W. Piekarczyk, P.E.
County Engineer

Passed 6-13 2005

James R. Thredgill III
Bureau Chief, Local Roads & Streets

Approved 6-13 2005

Greg Mounts
Region 2 Engineer

CONTRACT NO. 87308

J.U.L.I.E. 1-800-892-0123

DESIGNED BY AKD