

INDEX OF SHEETS

Sheet No.	Description
1	COVER SHEET
2	TYPICAL CROSS SECTIONS AND DETAILS
3	DETAILS & SCHEDULES

STANDARDS

701301-01	TRAFFIC CONTROL
701306-01	TRAFFIC CONTROL
702001-05	TRAFFIC CONTROL

STATE OF ILLINOIS
DEPARTMENT OF TRANSPORTATION
COUNTY OF KANKAKEE
DEPARTMENT OF HIGHWAYS
PLANS FOR PROPOSED
FEDERAL AID SECONDARY PROJECT
SECTION 04-00068-02-RS
F.A.S. 1320 (CH 3)

PROJECT RS - 1320(106) JOB NO. C-93-047-05

F.A.S. ROUTE NO.	SEC.	COUNTY	NO. SHEETS	SHEET NO.
1320	*	Kankakee	3	1
ILLINOIS PROJECT		Contract No. 87308		
* 04-00068-02-RS		KANKAKEE COUNTY		

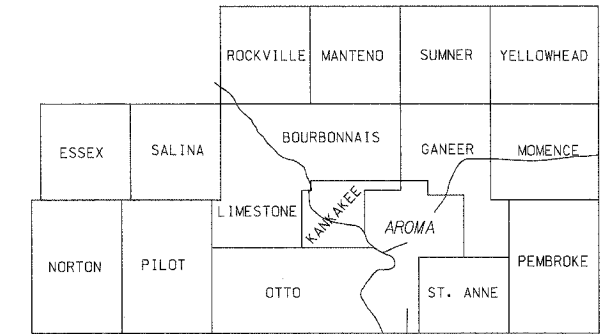

PROJECT LOCATION



SUMMARY OF QUANTITIES

CODE NO.	Description	Quantity	Unit
* X4066414	BITUMINOUS CONCRETE SURFACE COURSE, SUPERPAVE MIXTURE C, N 50	860	TON
* X4066765	LEVELING BINDER (MACHINE METHOD) SUPERPAVE MIXTURE C, N 50	667	TON
* 40600100	BITUMINOUS MATERIALS (PRIME COAT)	1226	GALLON
40600300	AGGREGATE (PRIME COAT)	29	TON
40600980	BITUMINOUS SURFACE REMOVAL - BUTT JOINT	177	SQ YD
40600990	TEMPORARY RAMP	14	SQ YD
40800040	INCIDENTAL BITUMINOUS SURFACING	65	TON
44000005	BITUMINOUS SURFACE REMOVAL 1 1/4"	289	SQ YD
* 48101200	AGGREGATE SHOULDERS, TYPE B	650	TON
* 70100460	TRAFFIC CONTROL AND PROTECTION, STANDARD 701306	1	L SUM
* 70300100	SHORT-TERM PAVEMENT MARKING	1072	FOOT
67100100	MOBILIZATION	1	L SUM

* Special Provisions

Construction Code I000

CONTRACT NO. 87308

J.U.L.I.E. 1-800-892-0123

DESIGNED BY AKD

CONSTRUCTION STARTS
STA. 221+86
(S. ER FAS 1322 CH 37)
Stationing per 92-00068-01-RS

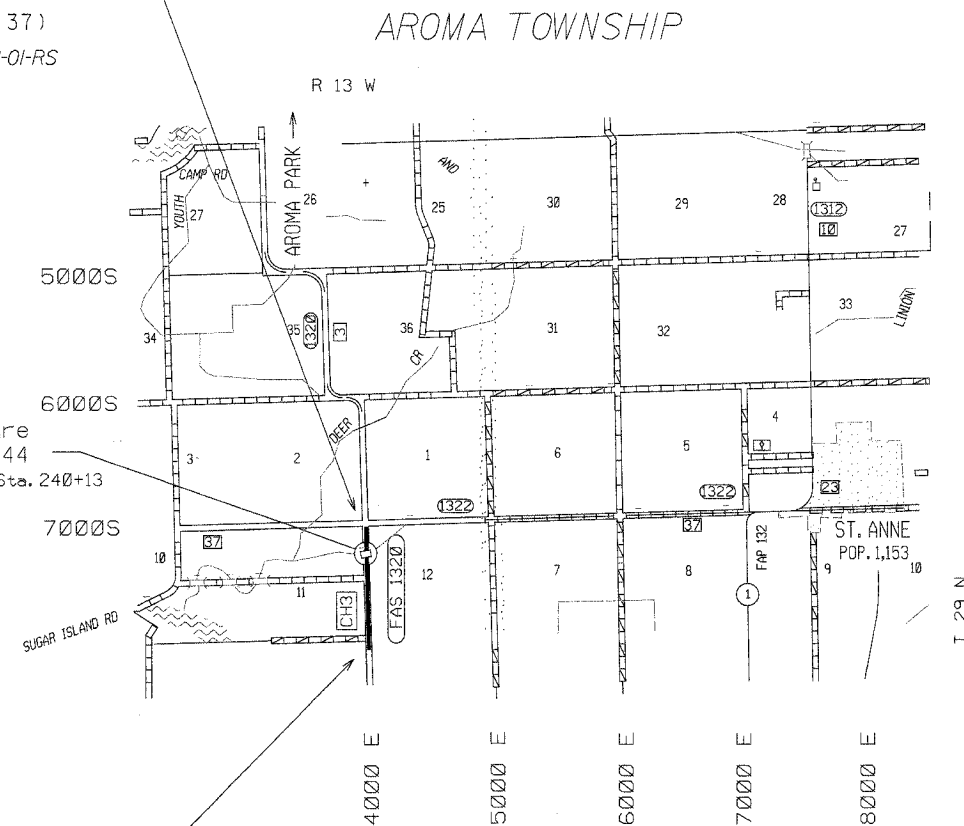

CONSTRUCTION ENDS
STA. 275+45
(South Kankakee County Line)

LOCATION MAP

No Scale

NET LENGTH = 5359 LIN FT = 1.015 MILES

THE ACCEPTANCE OF THIS PROJECT IS BASED ON THE MINIMUM DESIGN CRITERIA FOR LOCAL AGENCY PAVEMENT PRESERVATION POLICY (LAPP) PROJECTS

CLASS III ROAD
CURRENT A.D.T. = 670 2005
DESIGN A.D.T. = 704 2010
DESIGN SPEED = 50 M.P.H.
Functional Class = Collector

STATE OF ILLINOIS
DEPARTMENT OF TRANSPORTATION
DIVISION OF HIGHWAYS

Submitted 6-3 2005

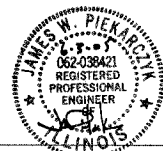

James W. Piekarczyk, P.E.
County Engineer

Passed 6-13 2005

James R. Thredgill III
Bureau Chief, Local Roads & Streets

Approved 6-13 2005

Greg Mounts
Region 2 Engineer

TYPICAL ENTRANCE DETAIL

W : WIDTH OF APPROACH PADS IS ESTIMATED AT 20' PER ENTRANCE .
THE ACTUAL CONSTRUCTED WIDTH MAY VARY AS DIRECTED BY THE
ENGINEER TO FIT THE EXISTING ENTRANCES .

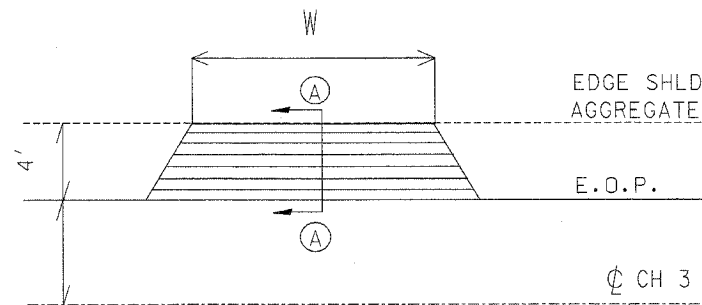

ESTIMATED QUANTITIES-4 ENTRANCES		
ITEM	UNIT	QUANTITY
BITUMINOUS MATERIALS (PRIME COAT)	GAL	3
BIT. CONC. SURFACE CSE. MIX C CL I TY. 2	TON	6

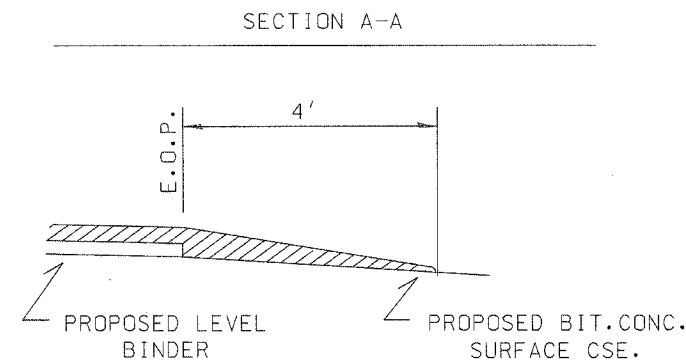

TYPICAL MAILBOX TURNOUT RESURFACING DETAIL

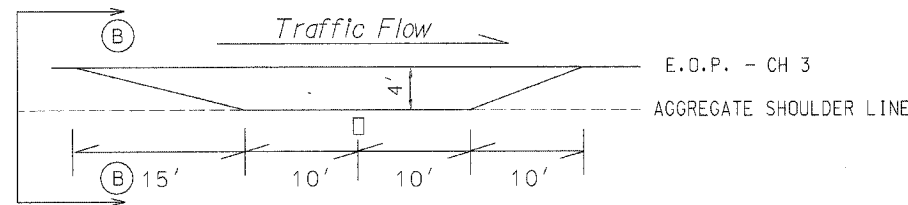

MAILBOX TURNOUT SCHEDULE			
STATION	SIDE	STATION	SIDE
243+84	RT	263+80	RT

ESTIMATED QUANTITIES - 2 MAILBOX TURNOUTS		
ITEM	UNIT	QUANTITY
BIT. MATERIALS (PRIME COAT)	GAL	2
BIT. CONC. SURFACE CSE. MIX C, N50	TON	4

	Incidental Bit. Surfacing	Superpave Leveling Binder	Superpave Surface
PG Grade	PG 58-22	PG 58-22	PG 58-22
Max % Rap	15%	15%	15%
Design Air Voids	4.0%	4.0%	4.0%
Mixture Composition	IL 9.5 MM	IL 9.5 MM	IL 9.5 MM
Friction Aggregate	Mix C	Mix C	Mix C
Density Control Limits	% of Growth Curve	Satisfaction of Engineer	% of Growth Curve

SECTION	COUNTY	TOTAL SHEETS	SHEET NO.
04-00068-02-RS	KANKAKEE	3	2

Contract No. 87308

TYPICAL CROSS SECTION

STA. 221+86 To 275+45

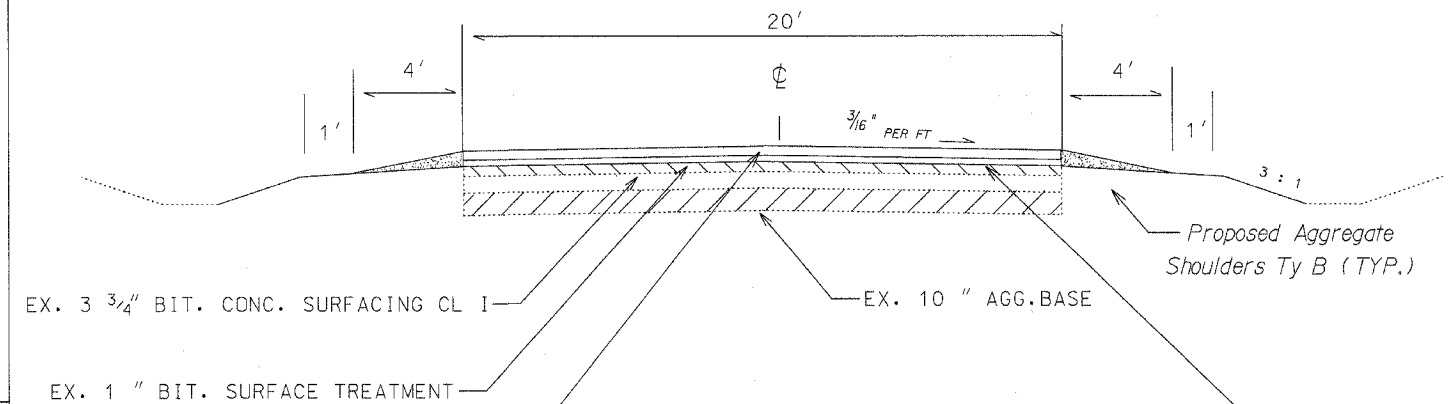

Sta 222+16 to 275+15 (Bridge Omission 238+89 to 240+13)
CONSTRUCT Leveling Binder (Machine Method),
SuperPave N50 3/4" Thick (112 Lbs/SqYd)
To Correct Crown and Fill Depressions.

Sta 221+86 to 275+45
CONSTRUCT 1 1/4" Bituminous Concrete Surface
Course. Superpave Mix C, N50

ESTIMATED QUANTITIES ON TANGENT

ITEM	UNIT	Quantity
Bituminous Materials (Prime Coat)	GALLON	1191
Aggregate (Prime Coat)	TON	24
Leveling Binder (MM) Superpave, N50	TON	667
Bit. Con. Surf. Cse. Superpave Mix C, N50	TON	850
Aggregate Shoulders Ty. B	TON	650
Short Term Pavement Marking	FOOT	1072

SECTION	COUNTY	TOTAL SHEETS	SHEET NO.
04-00068-02-RS	KANKAKEE	3	3

Contract No. 87308

INTERSECTION DETAIL

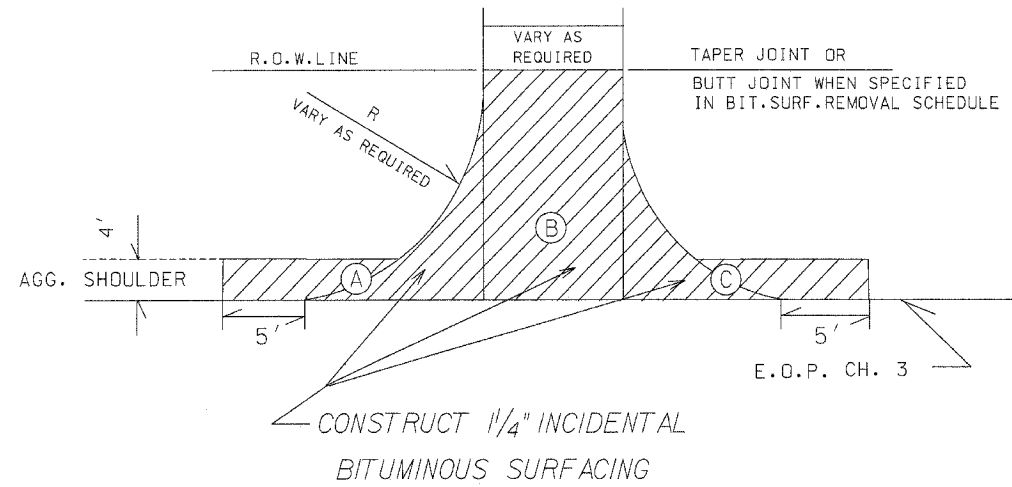

STATION	AREA	SIDE	WIDTH	RADIUS	INCIDENTAL BIT. SURFACING (TON)	BIT. MATRLS. (PRIME COAT) (GAL)	AGGREGATE (PRIME COAT) (TON)	LOCATION
248+28	A+B+C	RT	18 (B)	30(A) 30(C)	20	10	1.0	7500S
275+15	A+B+C	RT	18 (B)	30(A) 30(C)	20	10	1.0	8000S
Total					65	30	3	

PAVEMENT REMOVAL-BUTT JOINT

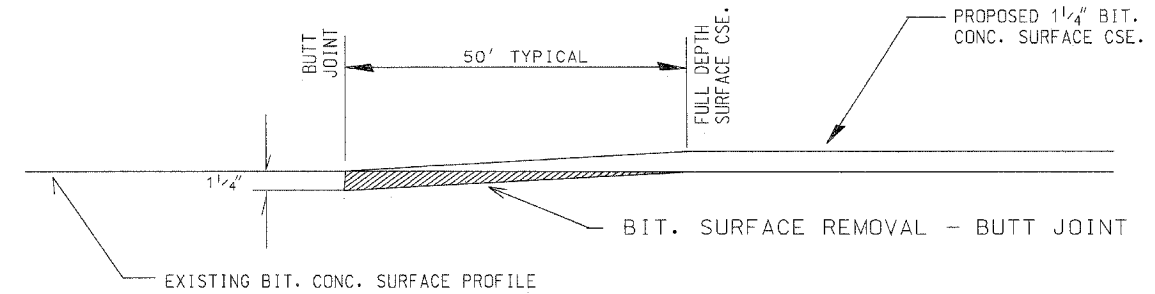

STA TO STA	OPERATION	TEMPORARY RAMP (3' Wide)
221+86 to 222+16 (Includes Radl)	110 Sq Yd Butt Jt 1 1/4"	7 Sq Yd
238+89 to 239+39 (North Abut)	111 Sq Yd Pvt Removal 1 1/4"	
239+39 to 239+63 (Br. Deck)	67 Sq Yd Pvt Removal 1 1/4"	
(South Abut) 239+63 to 240+13	111 Sq Yd Pvt Removal 1 1/4"	
275+15 to 275+45	67 Sq Yd Butt Jt 1 1/4"	7 Sq Yd
TOTALS	177 Sq Yd/Butt JT & 289 Sq Yd/Bit Surface Rem	14 Sq Yd

PAVEMENT REMOVAL - BRIDGE DECK AND APPROACHES

Pavement Design Data

Design Period = 10 Years
 A.D.T. = 670 (2005) 704 (2010)
 P.V. = 88 % = 620 S.U. = 7 % = 50 M.U. = 5 % = 34

T.F. = 0.08

DT = 2.79

PAVEMENT STRUCTURE NUMBER

Ex. 10" Agg. Base (Crushed). 10 X 0.10 = 1.00
 Ex. 3 3/4" Bit. Class I Surfacing 3.75 X 0.21 = 0.79
 Ex. 1" Bituminous Surf. Treatment 1 X 0.20 = 0.20
 Prop. 2" Bit Conc. Surface N50 2 X 0.40 = 0.80

2.79

Marshall Stability \geq 1700

