

STATE OF ILLINOIS  
 DEPARTMENT OF TRANSPORTATION  
 DIVISION OF HIGHWAYS  
**PLANS FOR PROPOSED  
 SURFACE TRANSPORTATION-RURAL  
 STARK COUNTY**

F.A.S. 373 (STARK-SPEER ROAD)  
 SECTION 01-00149-00-RS  
 PROJECT RS-373 (108)  
 JOB NO. C-94-103-03  
 CONTRACT NO. 89316

INDEX OF SHEETS

- | SHEET NO. | SHEET TITLE   |
|-----------|---|
| 1.        | COVER SHEET   |
| 2.        | TYPICAL SECTIONS, DETAILS OF ENTRANCES, SIDE ROADS, AND MAILBOX TURNOUT |
| 3.        | SUMMARY OF QUANTITIES, QUANTITIES NOT OTHERWISE SHOWN                   |
| 4.        | PROJECT SCHEMATIC, CURVE DATA, AND S.E. RATES                           |

COMMITMENTS

NONE.

LIST OF STANDARDS

- 701301-02 LANE CLOSURE 2L, 2W SHORT TIME OPERATIONS
- 701306-01 LANE CLOSURE 2L, 2W SLOW MOVING OPERATIONS-DAY ONLY FOR SPEEDS ≥ 45 MPH
- 701311-02 LANE CLOSURE 2L, 2W MOVING OPERATIONS-DAY ONLY
- 702001-05 TRAFFIC CONTROL DEVICES
- 780001-01 TYPICAL PAVEMENT MARKINGS
- BLR18-4 TYPICAL APPLICATION OF TRAFFIC CONTROL DEVICES FOR CONSTRUCTION ON RURAL LOCAL HIGHWAYS

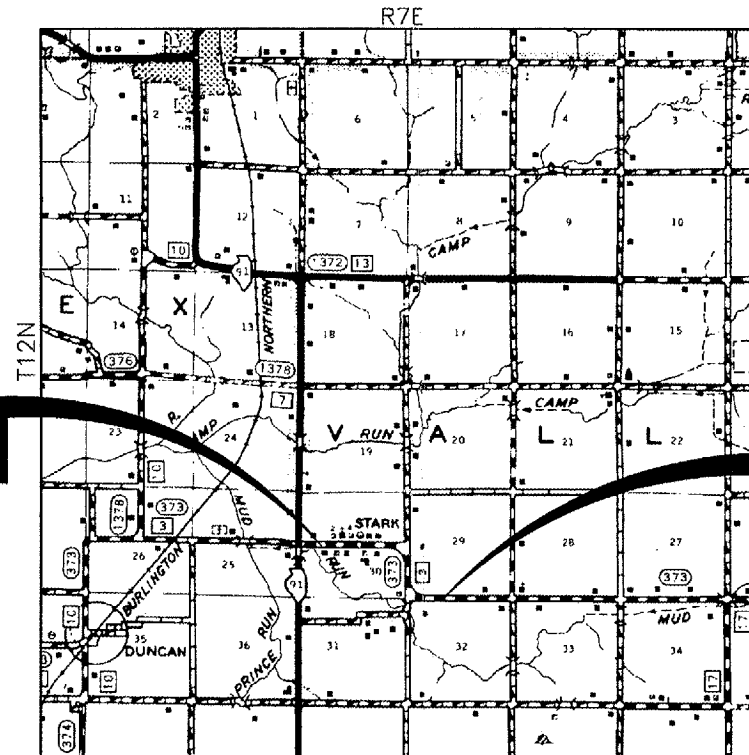

LOCATION MAP  
NO SCALE

TOTAL LENGTH OF IMPROVEMENT = 8370 FEET = 1.585 MILES  
 3R GUIDE LINES, MAJOR COLLECTOR  
 DESIGN SPEED = 55 M.P.H.  
 VARIANCES GRANTED: NONE  
 PREPARED BY



DAILY AND ASSOCIATES ENGINEERS, INC.  
 CHAMPAIGN - PEORIA, ILLINOIS

RTE.	SECTION	COUNTY	TOTAL SHEETS	SHEET NO.
FAS 373 (CH #3)	*	STARK CO.	4	1
STA. 101+30		TO STA. 185+00		
F.H.W.A. REG.		ILLINOIS	PROJECT **	

\*01-00149-00-RS  
 \*\*RS-373 (108)

**QC/QA BITUMINOUS  
 SUPERPAVE PROJECT**

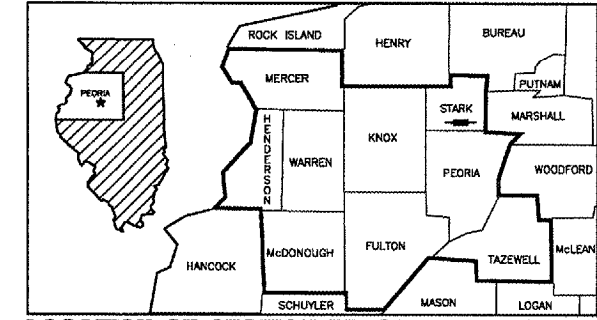

LOCATION OF SECTION INDICATED THUS:-

STATE OF ILLINOIS  
 DEPARTMENT OF TRANSPORTATION

*John Laballe* 6-6-05  
 PASSED: DISTRICT FOUR ENGINEER OF LOCAL ROADS & STREETS DATE  
*John* 06/06/05  
 RELEASING FOR BID BASED DEPUTY DIRECTOR OF HIGHWAYS, DATE  
 ON LIMITED REVIEW: REGION THREE ENGINEER

BITUMINOUS MIXTURE REQUIREMENTS

THE FOLLOWING MIXTURE REQUIREMENTS ARE APPLICABLE TO THIS PROJECT.

MIXTURE USE(S):	SURFACE COURSE	BINDER COURSE
AC/PG:	PG 64-22	PG 64-22
RAP%:(MAX)**	15%	25%
DESIGN AIR VOIDS:	4.2% @ Ndes=50	4.2% @ Ndes=50
MIXTURE COMPOSITION: (GRADATION MIXTURE)	IL 9.5 or 12.5	IL 19.0
FRICITION AGGREGATE:	MIXTURE D	

\*\*IF > 15% RAP IS USED, THE CONTRACTOR MAY BE REQUIRED TO USE A SOFTER GRADE OF ASPHALT AS DETERMINED BY THE MATERIALS ENGINEER.



CALL JULIE 1-800-892-0123  
 WITH THE FOLLOWING:  
 COUNTY: STARK  
 CITY-TOWNSHIP: VALLEY TOWNSHIP  
 SEC. & 1/4 SEC. NO. SW 1/4 SEC. 5, T12N, R6W, 3rd PM  
 48 HOURS BEFORE YOU DIG.  
 EXCLUDING SAT., SUN., & HOLIDAYS

*Gerald Fitzpatrick* 5/31/05  
 GERALD FITZPATRICK DATE  
 STARK COUNTY ENGINEER

*Michael J. Bryant* 5/31/05  
 MICHAEL J. BRYANT DATE  
 REGISTERED PROFESSIONAL ENGINEER  
 ILLINOIS NO. 44543 EXPIRES 11-30-05

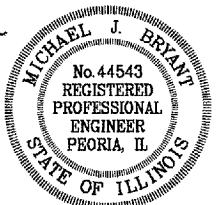

CAD DRAWING NO. 5607-10c.dwg

G:\data\5607-11\DWG\560711\_01rev.DWG  
 May 24, 2005 - 3:53pm