

ROUTE NO.	SECTION	COUNTY	TOTAL SHEETS	SHEET NO.
CH 31	*	MACON	162	16
FEDERAL DIST.	ILLINOIS	PROJECT		

* 02-00175-00-PV

CONSTRUCTION STAGING AND MAINTENANCE OF TRAFFIC

STAGE 1
 MAINTAIN LOCAL TRAFFIC ON TURPIN ROAD. CONSTRUCT THE PROPOSED TURPIN ROAD.

1. CONSTRUCT TURPIN ROAD COMPLETE FROM STA 509+69.52 TO STA 535+36.
2. DURING CONSTRUCTION, TRAFFIC SHALL BE MAINTAINED IN ACCORDANCE WITH THE APPLICABLE PORTIONS OF TRAFFIC CONTROL AND PROTECTION STANDARD BLR 22.
3. CONSTRUCT TEMPORARY CONNECTION FROM NEWLY CONSTRUCTED TURPIN ROAD TO EXISTING TURPIN ROAD AT STA 535+36.

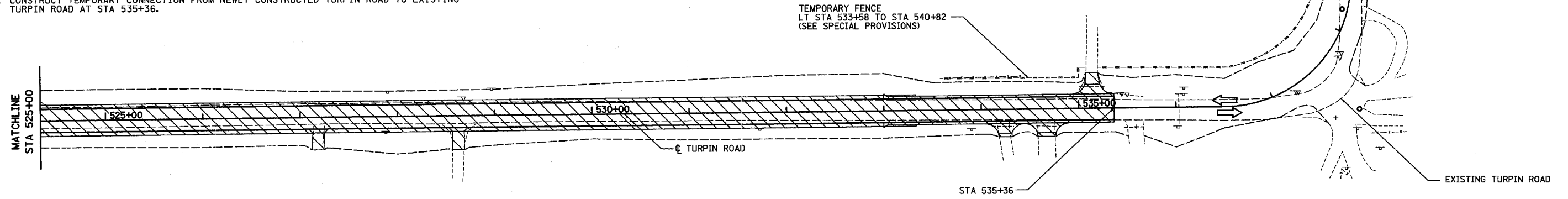

STAGE 1

STAGE 2

LEGEND

- WORK ZONE
- DIRECTION OF TRAFFIC
- OBLITERATE ROADWAY

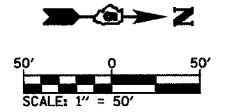

CONSTRUCTION STAGING AND MAINTENANCE OF TRAFFIC

STAGE 2A
 MAINTAIN LOCAL TRAFFIC ON TURPIN ROAD. CONSTRUCT THE PROPOSED TURPIN ROAD.

1. CONSTRUCT TURPIN ROAD COMPLETE FROM STA 535+36 TO STA 540+67 (INCLUDING THE RETAINING WALL) AND TEMPE DRIVE IMPROVEMENTS.
2. DURING CONSTRUCTION, TURPIN ROAD AND TEMPE DRIVE SHALL BE CLOSED TO THROUGH TRAFFIC AND LOCAL TRAFFIC SHALL USE LOCAL SIDE ROADS TO DETOUR AROUND THE CONSTRUCTION AREA. TURPIN ROAD AND TEMPE DRIVE SHALL BE CONSTRUCTED IN PHASES TO MAXIMIZE ACCESS TO THE RESIDENCES LOCATED AT STA 537+50. DURING CONSTRUCTION OF TURPIN ROAD AND TEMPE DRIVE, TRAFFIC SHALL BE MAINTAINED IN ACCORDANCE WITH THE APPLICABLE PORTIONS OF TRAFFIC CONTROL AND PROTECTION STANDARD BLR 22 AND 701501.

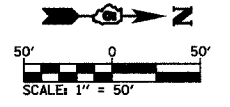
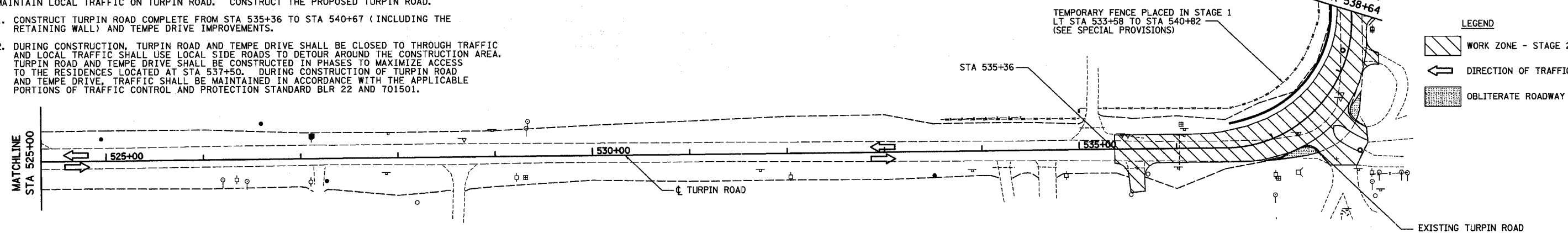

LEGEND

- WORK ZONE - STAGE 2A
- DIRECTION OF TRAFFIC
- OBLITERATE ROADWAY

REVISIONS		TRAFFIC CONTROL AND STAGING		TURPIN ROAD CONNECTOR (CH 31) MACON COUNTY, ILLINOIS		DESIGN BY DATE EMR 05/03
No.	DATE	INITIALS				CHECKED BY DATE GLF 03/05
1						BOOK NUMBER 471
2						PROJECT No. 4805
3						SHEET No.
4						
5						
6						
7						
8						
9						
10						

HOMER L. CHASTAIN & ASSOCIATES, LLP
 CONSULTING ENGINEERS
184-00197

DECATUR
(317) 422-8544

CHICAGO
(773) 714-0060