

INDEX OF SHEETS:

- 1 COVER SHEET
- 2 SUMMARY OF QUANTITIES
- 3 TYPICAL CROSS SECTIONS, LEGEND, AND GENERAL NOTES
- 4-5 SCHEDULE OF QUANTITIES
- 6-7 CONTROL AND SURVEY TIES
- 8-18 PLAN AND PROFILE
- 19-22 TEMPORARY EROSION CONTROL PLANS
- 23-25 MISCELLANEOUS DETAILS
- 26-56 CROSS SECTIONS

STATE STANDARD DETAILS:

- 000001-04 STANDARD SYMBOLS, ABBREVIATIONS, & PATTERNS
- 001001 AREAS OF REINFORCEMENT BARS
- 001006 DECIMAL OF AN INCH AND OF A FOOT
- 280001-02 TEMPORARY EROSION CONTROL SYSTEMS
- 701001-01 OFF-RD OPERATIONS, 2L, 2W, MORE THAN 4.5m (15') AWAY
- 701006-02 OFF-RD OPERATIONS, 2L, 2W, 4.5 M (15') TO 600mm (24") FROM PAVEMENT EDGE
- 701011-01 OFF-RD MOVING OPERATIONS 2L, 2W, DAY ONLY
- 701201-02 LANE CLOSURE, 2L, 2W, DAY ONLY, FOR SPEEDS > 45 MPH
- 701301-02 LANE CLOSURE 2L, 2W SHORT TIME OPERATIONS
- 701306-01 LANE CLOSURE 2L, 2W SLOW MOVING OPERATIONS - DAY ONLY FOR SPEEDS > 45 MPH
- 701311-02 LANE CLOSURE 2L, 2W MOVING OPERATIONS - DAY ONLY
- 701326-02 LANE CLOSURE 2L, 2W PAVEMENT WIDENING FOR SPEEDS > 45 MPH
- 702001-05 TRAFFIC CONTROL DEVICES
- 780001-01 TYPICAL PAVEMENT MARKINGS
- BLR 21-6 TYPICAL APPLICATIONS OF TRAFFIC CONTROL DEVICES FOR CONSTRUCTION ON RURAL LOCAL HIGHWAYS
- BLR 22-4 TYPICAL APPLICATIONS OF TRAFFIC CONTROL DEVICES FOR CONSTRUCTION ON RURAL LOCAL HIGHWAYS
- BLR 24-1 MAILBOX TURNOUTS

STATE OF ILLINOIS
DEPARTMENT OF TRANSPORTATION
DIVISION OF HIGHWAYS
PLANS FOR PROPOSED
FEDERAL AID SECONDARY HIGHWAY

PLAN 1:50
PROFILE HORIZ. 1:50
PROFILE VERT. 1:5
CROSS SECTIONS VERT. 1:5, HORIZ. 1:10

FAS ROUTE 694
COUNTY HIGHWAY 1
CRAWFORD COUNTY
SECTION 03-00088-00-WR
PROJECT NO. SR-694(113)
JOB NO. C-97-011-05

F.A.S. RTE.	SECTION	COUNTY	TOTAL SHEETS	SHEET NO.
694	03-00088-00-WR	CRAWFORD	1	56
STA. 10+18.41		TO STA. 158+00		
FED. ROAD DIST. NO.		ILLINOIS FED. AID PROJECT		
CONTRACT NO. 95433				

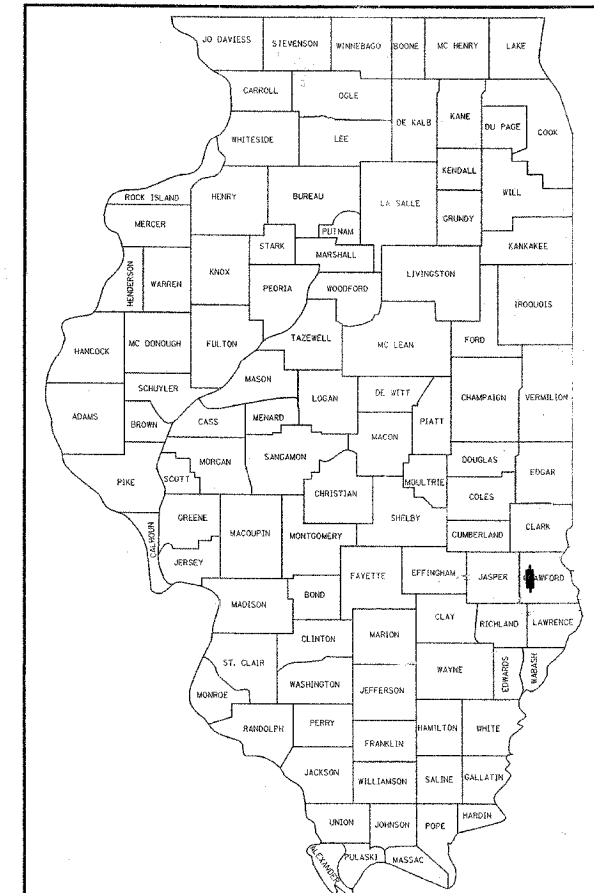

LOCATION OF SECTION INDICATED THUS: - ■ -

THE IMPROVEMENTS UNDER THIS CONTRACT ARE IN ACCORDANCE WITH THE ILLINOIS DEPARTMENT OF TRANSPORTATION "FEDERAL-AID PROCEDURES FOR LOCAL HIGHWAY IMPROVEMENTS (3R POLICY)".

STRUCTURAL DESIGN DATA:

CH 1 - RURAL MAJOR COLLECTOR
 POSTED SPEED = 55 MPH
 DESIGN SPEED = 55 MPH
 ADT (2005) 1,300, (2025) 1,600 DHV = 12.0%
 STRUCTURAL DESIGN TRAFFIC YEAR: 2015
 PC: 1,340 SU: 100 MU: 10
 CLASS OF STREET: III
 % SDT IN DESIGN LANE: PC: 50% SU: 50% MU: 50%
 TRAFFIC FACTOR: 0.122
 MINIMUM SOIL SUPPORT IFR: 3.9, D_t=3.4
 PAVEMENT STRUCTURAL MATERIALS: SEE PROPOSED TYPICAL SECTION

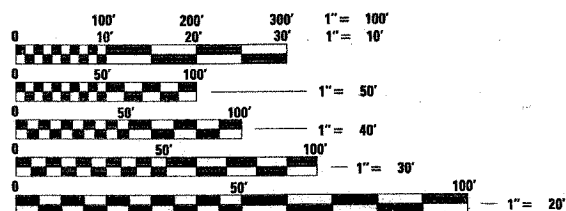

FULL SIZE PLANS HAVE BEEN PREPARED USING STANDARD ENGINEERING SCALES, REDUCED SIZED PLANS WILL NOT CONFORM TO STANDARD SCALES, IN MAKING MEASUREMENTS ON REDUCED PLANS, THE ABOVE SCALES MAY BE USED.

J.U.L.I.E.
 JOINT UTILITY LOCATION INFORMATION FOR EXCAVATION
 1-800-892-0123

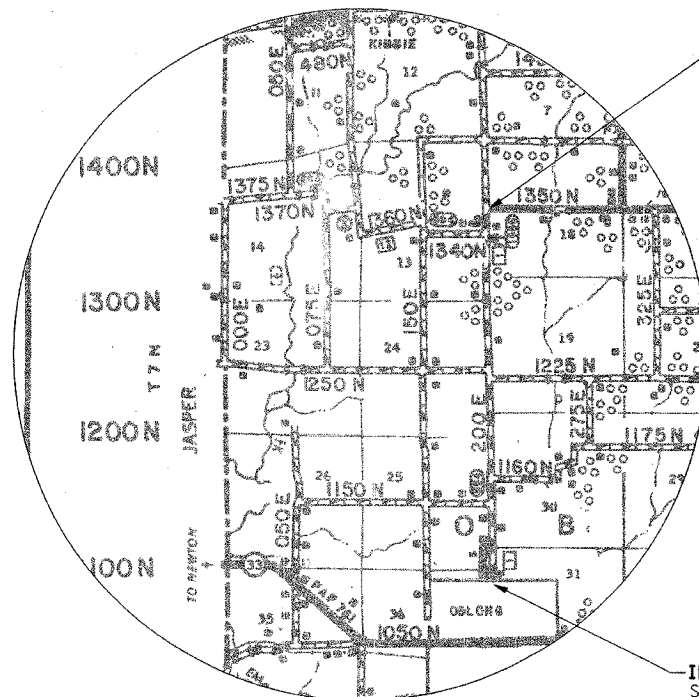

IMPROVEMENT ENDS
 STA 158+00
 COUNTY HIGHWAY #1
 SECT: 03-00088-00-WR



N.T.S.

IMPROVEMENT BEGINS
 STA 10+18.41
 COUNTY HIGHWAY #1
 SECT: 03-00088-00-WR

LOCATION MAP - CRAWFORD COUNTY (COUNTY HIGHWAY #1)

TOTAL LENGTH OF PROJECT = 14,781.59 FEET = 2.80 MILES
 NET LENGTH OF PROJECT = 14,781.59 FEET = 2.80 MILES



Eric R. Bachman
 SIGNATURE

EXPIRATION DATE NOV. 30, 2005



200 N. 3RD. ST., Suite 200
 Effingham, IL 62401
 217/342-5668, 217/342-5663 fax

CONTRACT NO. 95433