

SEC 25, T7N, R14W

F.A.S. RTE.	SECTION	COUNTY	TOTAL SHEETS	SHEET NO.
694	03-00088-00-WR	CRAWFORD	56	11
STA. 52+50		TO STA. 67+50		
FED. ROAD DIST. NO.		ILLINOIS	FED. AID PROJECT	
CONTRACT NO. 95433				

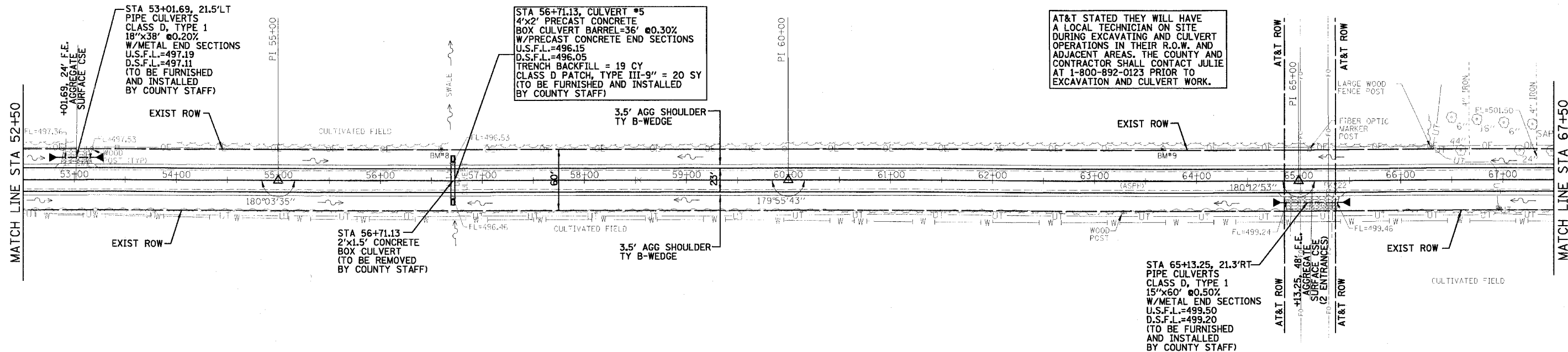

AT&T STATED THEY WILL HAVE A LOCAL TECHNICIAN ON SITE DURING EXCAVATING AND CULVERT OPERATIONS IN THEIR R.O.W. AND ADJACENT AREAS. THE COUNTY AND CONTRACTOR SHALL CONTACT JULIE AT 1-800-892-0123 PRIOR TO EXCAVATION AND CULVERT WORK.

SEC 30, T7N, R13W

COUNTY HIGHWAY #1 (200E)

- NOTES:
- ELLIP=ELLIPTICAL
ERS=EQUIVALENT ROUND SIZE
PRC=PRECAST REINFORCED CONCRETE
FES=FLARED END SECTIONS
 - SEE CROSS SECTIONS FOR LOCATIONS WHERE THE CONTRACTOR SHALL GRADE DITCHES.

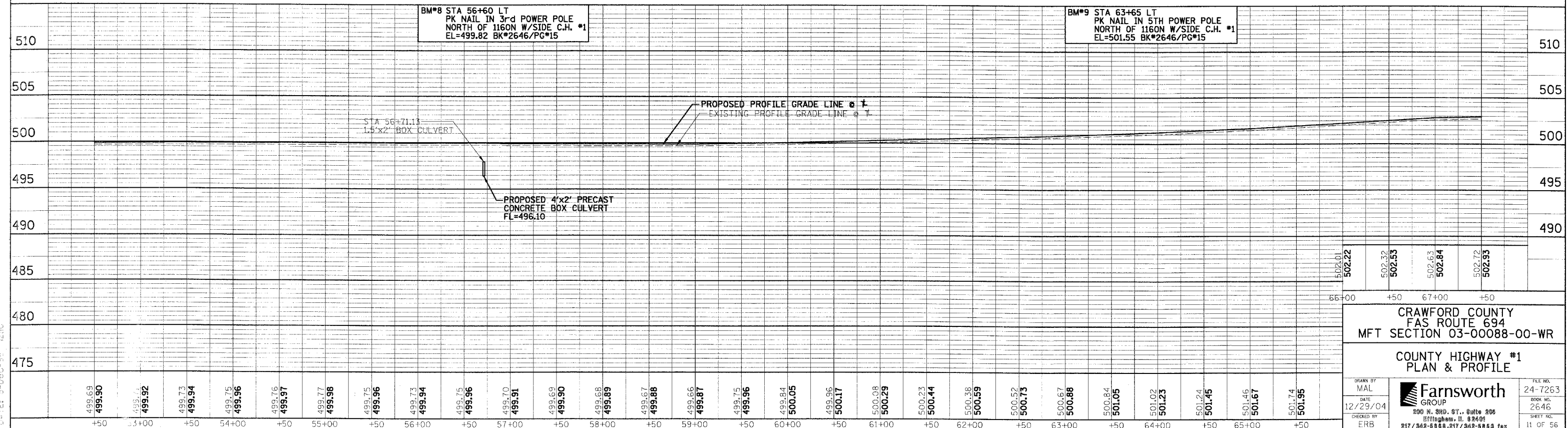
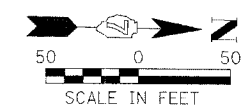

502.01	502.22	502.32	502.53	502.63	502.84	502.72	502.93
66+00		+50	67+00			+50	
CRAWFORD COUNTY FAS ROUTE 694 MFT SECTION 03-00088-00-WR							
COUNTY HIGHWAY #1 PLAN & PROFILE							
DRAWN BY MAL	DATE 12/29/04	CHECKED BY ERB				FILE NO. 24-7263	BOOK NO. 2646
				200 N. 2ND ST., Suite 206 Effingham, IL 62401 217/342-5858, 217/342-5854 fax		SHEET NO. 11 OF 56	

File: c:\Users\jason\Documents\proj\2406\2406.dwg
 Date: 9-Dec-04 12:41