

| | | | | |
|---------------------|-------------|----------|------------------|-----------|
| CONTRACT NO. 98631 | | | | |
| F.A. RTE. | SECTION | COUNTY | TOTAL SHEETS | SHEET NO. |
| 332 | 31-1-2, 31B | SALINE | 199 | 95 |
| STA. | | TO STA. | | |
| FED. ROAD DIST. NO. | | ILLINOIS | FED. AID PROJECT | |

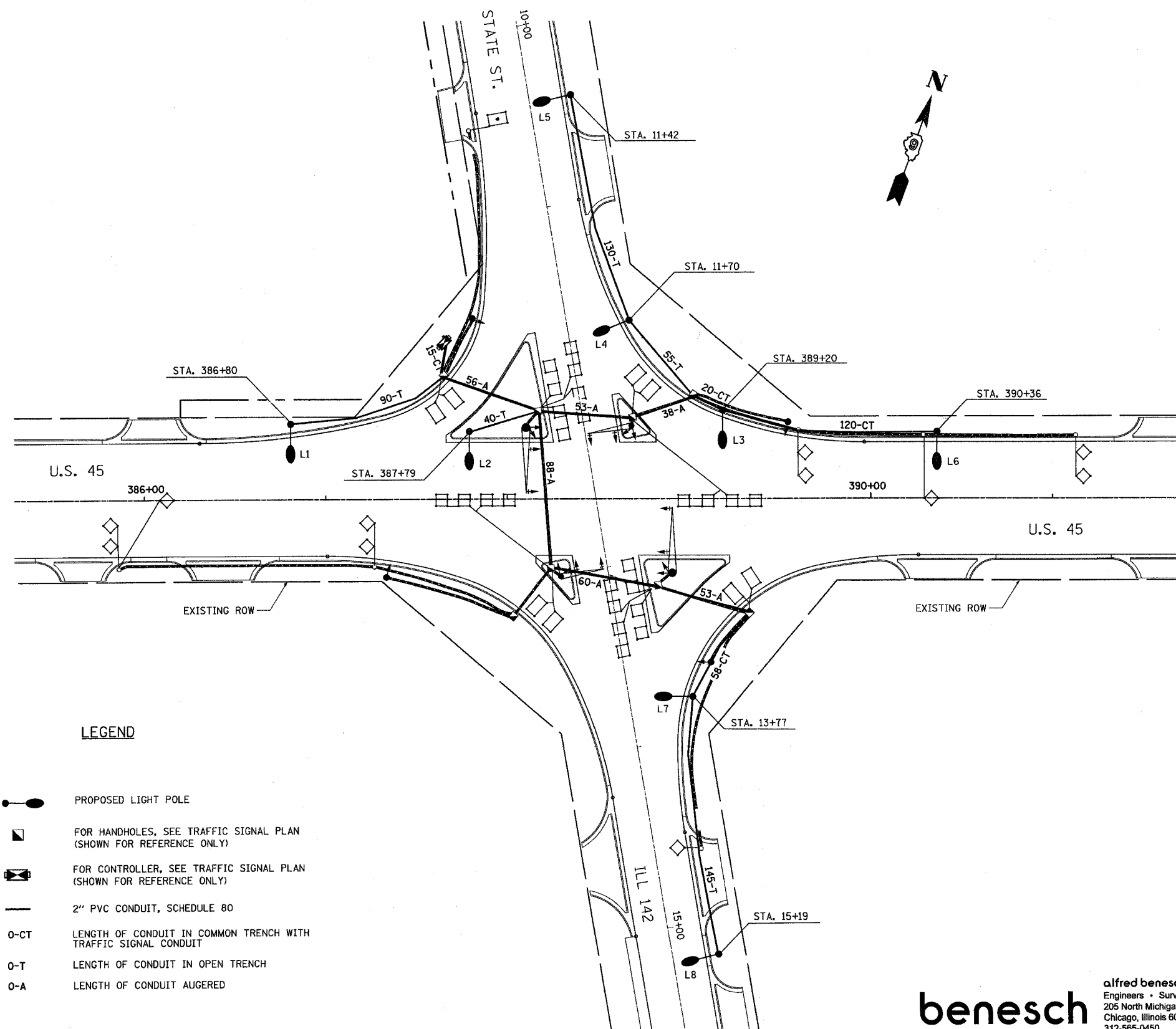

GENERAL NOTES-LIGHTING PLAN

1. THE CONTRACTOR SHALL MATCH THE BOLT CIRCLE OF THE POLE BASE WITH THE BOLT CIRCLE OF THE PROPOSED METAL FOUNDATION.
2. ANCHOR BOLTS SHALL NOT BE PAID SEPARATELY, BUT SHALL BE INCIDENTAL TO THE FOUNDATION.
3. LIGHT POLES SHALL BE LOCATED 6 FT FROM THE FACE OF THE CURB TO THE CENTER OF THE POLE.
4. LIGHT POLES SHALL BE AFFIXED WITH POLE NUMBERS TO MATCH THE EXISTING POLE NUMBERS. IF THE EXISTING POLES DO NOT SHOW ANY POLE NUMBERS, THEN THE NEW POLE NUMBERS SHALL BE AFFIXED PER PLANS. POLE NUMBER SPECIFICATIONS SHALL BE PER STANDARD SPECIFICATIONS SEC. 1069.02.
5. LIGHT POLE LOCATIONS SHALL BE PER PLAN LOCATIONS +5' OR AS DIRECTED BY THE ENGINEER TO AVOID CONFLICTS.
6. LIGHTING SHALL BE MAINTAINED OPERATIONAL EVERY NIGHT AND THE COST OF MAINTENANCE SHALL BE INCLUDED IN THE LIGHT POLE, 40 FT., MH, 15 FT. DAVIT ARM ITEM.
7. BREAKAWAY COUPLINGS TO FIT 1" DIA. STUDS SHALL BE INSTALLED AT ALL LIGHT POLE LOCATIONS.
8. FOR CONTROLLER LOCATION, SEE PROPOSED TRAFFIC SIGNAL PLAN.
9. SEE TRAFFIC SIGNAL PLANS FOR HANDHOLES, CONTROLLERS, SIGNALS, MAST AND POSTS, MAST ARM ASSEMBLIES, LOOPS AND COMMON CONDUITS. (SHOWN FOR REFERENCE ONLY)

LEGEND

- PROPOSED LIGHT POLE
- FOR HANDHOLES, SEE TRAFFIC SIGNAL PLAN (SHOWN FOR REFERENCE ONLY)
- FOR CONTROLLER, SEE TRAFFIC SIGNAL PLAN (SHOWN FOR REFERENCE ONLY)
- 2" PVC CONDUIT, SCHEDULE 80
- LENGTH OF CONDUIT IN COMMON TRENCH WITH TRAFFIC SIGNAL CONDUIT
- LENGTH OF CONDUIT IN OPEN TRENCH
- LENGTH OF CONDUIT AUGERED

benesch

alfred benesch & company
 Engineers • Surveyors • Planners
 205 North Michigan Avenue, Suite 2400
 Chicago, Illinois 60601
 312-565-0450

Rev. 7-18-05

| REVISIONS | |
|-----------|------|
| NAME | DATE |
| | |
| | |
| | |
| | |
| | |
| | |
| | |
| | |
| | |
| | |

ILLINOIS DEPARTMENT OF TRANSPORTATION
 IL RTE 142 AT U.S. 45
 PROPOSED LIGHTING PLAN

SCALE: 1"=30'
 DATE 7/14/05

DRAWN BY DJK
 CHECKED BY RCG

L-1

m:\pco\13526\Roadway\Final Plans Contract 4\142PRLighting.dgn