

F.A. RTE.	SECTION	COUNTY	TOTAL SHEETS	SHEET NO.
332	31-1-2, 31B	SALINE	199	96
STA.		TO STA.		
FED. ROAD DIST. NO.		ILLINOIS FED. AID PROJECT		

GENERAL NOTES-LIGHTING PLAN

1. A 30 AMP CIRCUIT BREAKER SHALL BE ADDED TO THE PROPOSED TRAFFIC CONTROLLER. THIS CIRCUIT BREAKER WILL BE DEDICATED TO THE FEED FOR THE STREET LIGHTING IN THE AREA.
2. SPLICING OF LIGHTING CONDUCTORS SHALL NOT BE PERMITTED IN THE BELOW GRADE HANDHOLES. SPLICING SHALL BE DONE AT THE POLE HANDHOLES ONLY
3. LIGHT POLES SHALL HAVE FUSES AND FUSE HOLDERS AND SURGE PROTECTION PER SS SEC. 1065.01. THIS WORK SHALL NOT BE PAID SEPARATELY, BUT SHALL BE INCLUDED IN THE CABLE IN CONDUIT PAY ITEM.
4. CONTRACTOR SHALL VERIFY IF THE LUMINAIRE INPUT VOLTAGE IS COMPATIBLE WITH THE NEW SERVICE VOLTAGE AT THE POLE HANDHOLE. IF THE LUMINAIRE INPUT VOLTAGE IS DIFFERENT FROM THE SERVICE VOLTAGE, THE CONTRACTOR WILL BE PERMITTED TO REPLACE THE BALLAST, LUMINAIRE OR TRANSFORMER AT NO ADDITIONAL COST TO THE CONTRACT TO MAKE THE LIGHTING SYSTEM OPERATIONAL.
5. LIGHTING WILL BE MAINTAINED OPERATIONAL EVERY NIGHT AND THE COST OF MAINTENANCE IS INCLUDED IN THE RELOCATION OF LIGHT POLE, 40 FT., MH, 15 FT. DAVIT ARM ITEM.
6. SPLICE CIRCUIT CONDUCTORS AT LIGHT POLE HANDHOLE.

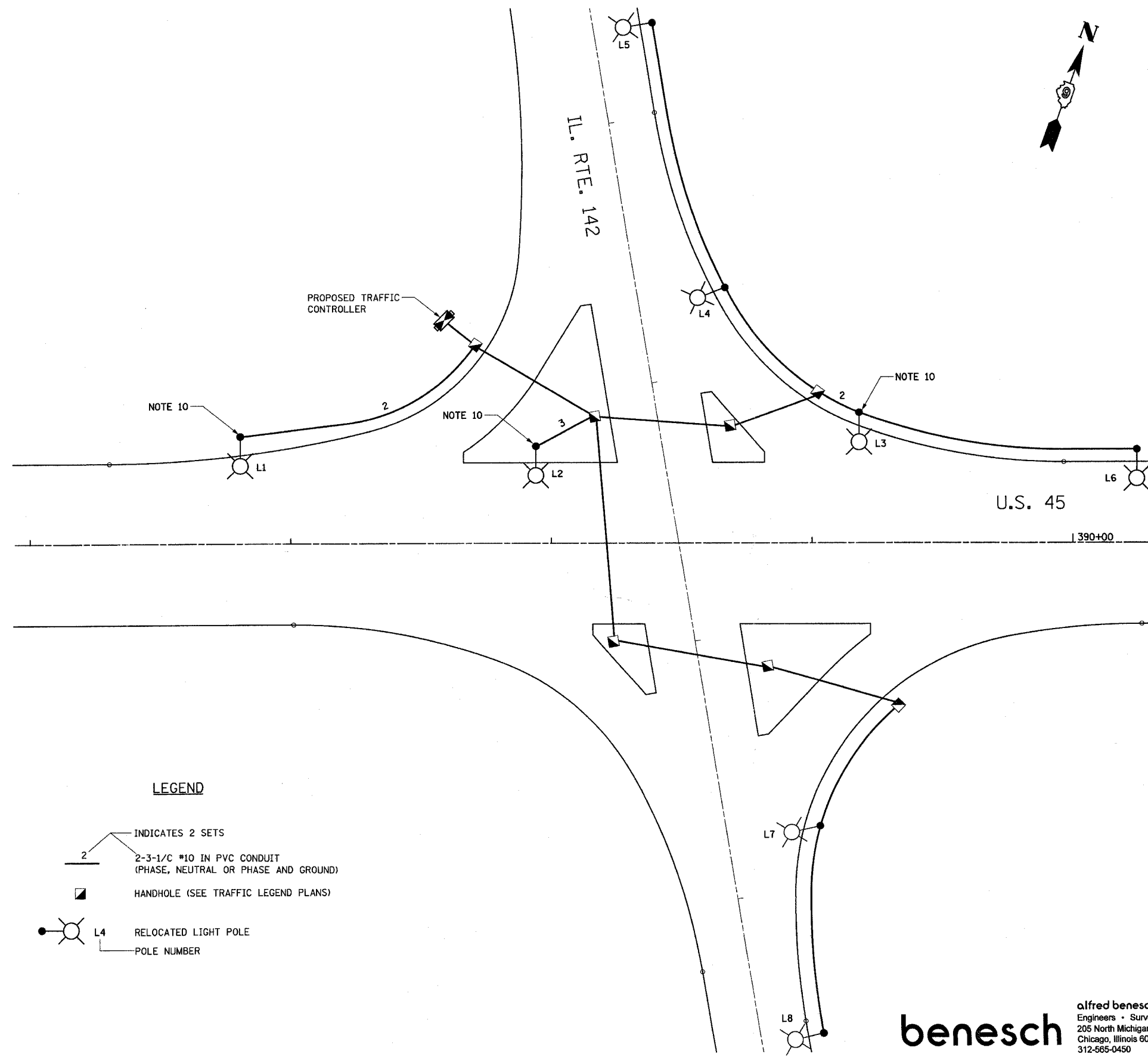

LEGEND

- INDICATES 2 SETS
- 2-3-1/C #10 IN PVC CONDUIT (PHASE, NEUTRAL OR PHASE AND GROUND)
- HANDHOLE (SEE TRAFFIC LEGEND PLANS)
- RELOCATED LIGHT POLE
- POLE NUMBER

benesch
 Engineers • Surveyors • Planners
 205 North Michigan Avenue, Suite 2400
 Chicago, Illinois 60601
 312-565-0450

Rev. 7-18-05

REVISIONS	
NAME	DATE

ILLINOIS DEPARTMENT OF TRANSPORTATION
 IL RTE 142 AT U.S. 45
 LIGHTING WIRING PLAN
 SCALE: NONE
 DATE 7/14/05
 DRAWN BY DJK
 CHECKED BY RCG

m:\p\013526\Roadway\Final Plans_Contract_4\421twire.dgn