

F.A. RTE.	SECTION	COUNTY	TOTAL SHEETS	SHEET NO.
332	31-1-2, 31B	SALINE	199	30
STA.	TO STA.			
FED. ROAD DIST. NO.	ILLINOIS	FED. AID PROJECT		

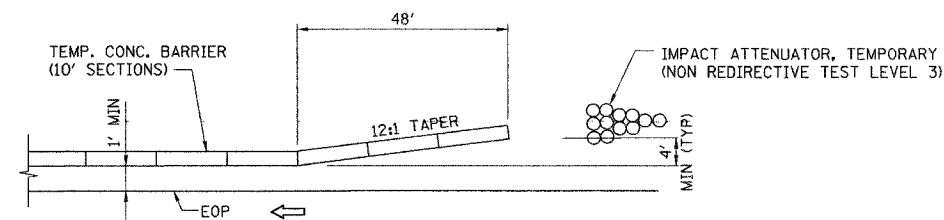

END TREATMENT (TYPICAL)

N.T.S.

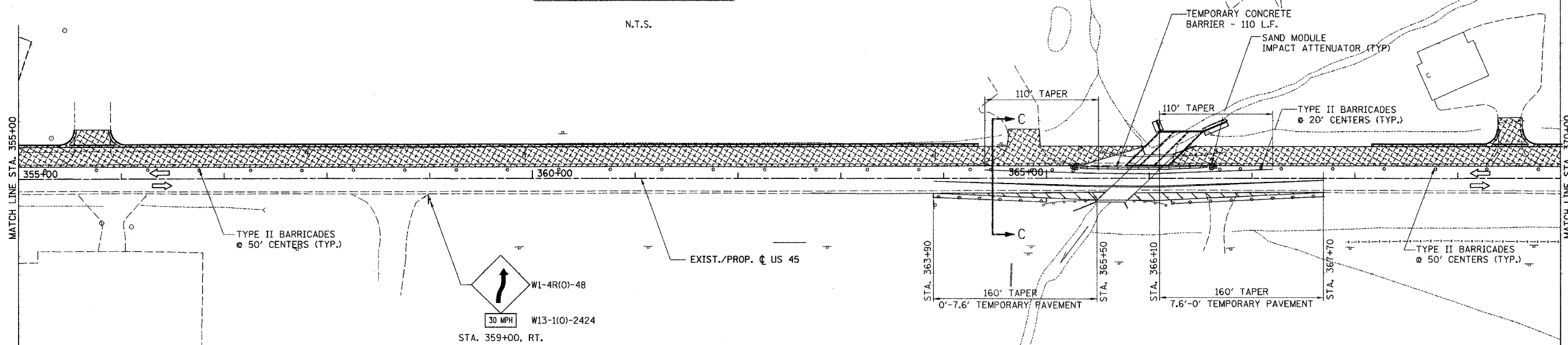

- NOTES:
- FOR TYPICAL SECTION AT PROPOSED STRUCTURE SEE STRUCTURAL DRAWINGS
 - TEMPORARY CONCRETE BARRIER WILL BE PLACED ACCORDING TO STANDARD 704001
 - BI-DIRECTIONAL LIGHTS WILL BE USED AT NIGHT ALONG THE CENTERLINE WHERE THE WORK AREA IS SEPARATED FROM THE TRAVEL LANE USING BARRICADES OR DRUMS. MONODIRECTIONAL LIGHTS WILL BE USED AT NIGHT ON ALL OTHER BARRICADES OR DRUMS
 - THE IMPACT ATTENUATORS MAY BE PLACED DIRECTLY ON THE PAVEMENT OR ON PALLETS OR SKIDS. (MAX PALLET/SKID HEIGHT 2 1/4")
 - THE IMPACT ATTENUATORS WILL BE STRIPED IN ACCORDANCE WITH THE REQUIREMENTS FOR DRUMS IN STANDARD 702001

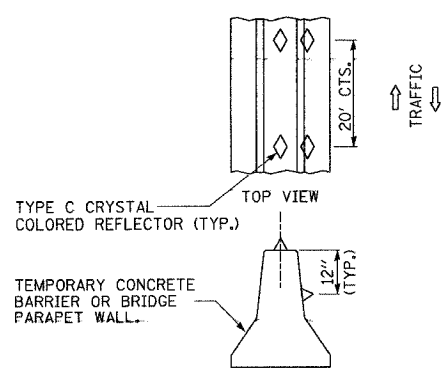

BARRIER WALL REFLECTORS

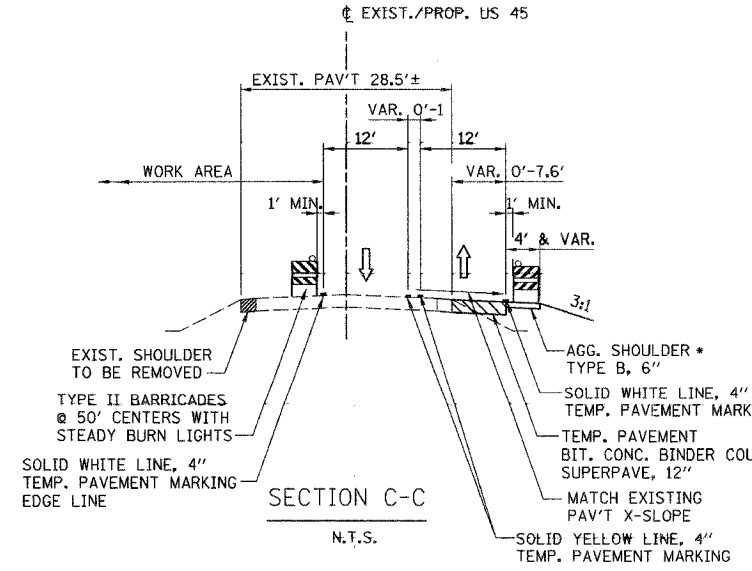

* AGG. SHOULDER LIMITS: STA. 363+90 TO STA. 365+00
STA. 366+20 TO STA. 367+70

LEGEND:

	PERMANENT CONSTRUCTION
	TEMPORARY PAVEMENT
	BARRICADE, TYPE III
	BARRICADE, TYPE II

REVISIONS	
NAME	DATE

ILLINOIS DEPARTMENT OF TRANSPORTATION
U.S. ROUTE 45
MAINTENANCE OF TRAFFIC
STAGE 1A
STA. 355+00 TO STA. 370+00

SCALE: 1" = 50'
 DATE: _____ DRAWN BY: SK
 CHECKED BY: AW

M:\PROJECTS\PROJ98631\ROADWAY\COMMON\Reference Files
 motorist-3.dgn, motorist-4.dgn, motorist-5.dgn, motorist-6.dgn, motorist-7.dgn, motorist-8.dgn, motorist-9.dgn, motorist-10.dgn, motorist-11.dgn, motorist-12.dgn, motorist-13.dgn, motorist-14.dgn, motorist-15.dgn, motorist-16.dgn, motorist-17.dgn, motorist-18.dgn, motorist-19.dgn, motorist-20.dgn, motorist-21.dgn, motorist-22.dgn, motorist-23.dgn, motorist-24.dgn, motorist-25.dgn, motorist-26.dgn, motorist-27.dgn, motorist-28.dgn, motorist-29.dgn, motorist-30.dgn, motorist-31.dgn, motorist-32.dgn, motorist-33.dgn, motorist-34.dgn, motorist-35.dgn, motorist-36.dgn, motorist-37.dgn, motorist-38.dgn, motorist-39.dgn, motorist-40.dgn, motorist-41.dgn, motorist-42.dgn, motorist-43.dgn, motorist-44.dgn, motorist-45.dgn, motorist-46.dgn, motorist-47.dgn, motorist-48.dgn, motorist-49.dgn, motorist-50.dgn, motorist-51.dgn, motorist-52.dgn, motorist-53.dgn, motorist-54.dgn, motorist-55.dgn, motorist-56.dgn, motorist-57.dgn, motorist-58.dgn, motorist-59.dgn, motorist-60.dgn, motorist-61.dgn, motorist-62.dgn, motorist-63.dgn, motorist-64.dgn, motorist-65.dgn, motorist-66.dgn, motorist-67.dgn, motorist-68.dgn, motorist-69.dgn, motorist-70.dgn, motorist-71.dgn, motorist-72.dgn, motorist-73.dgn, motorist-74.dgn, motorist-75.dgn, motorist-76.dgn, motorist-77.dgn, motorist-78.dgn, motorist-79.dgn, motorist-80.dgn, motorist-81.dgn, motorist-82.dgn, motorist-83.dgn, motorist-84.dgn, motorist-85.dgn, motorist-86.dgn, motorist-87.dgn, motorist-88.dgn, motorist-89.dgn, motorist-90.dgn, motorist-91.dgn, motorist-92.dgn, motorist-93.dgn, motorist-94.dgn, motorist-95.dgn, motorist-96.dgn, motorist-97.dgn, motorist-98.dgn, motorist-99.dgn, motorist-100.dgn