

F.A. RTE.	SECTION	COUNTY	TOTAL SHEETS	SHEET NO.
332	31-1-2, 31B	SALINE	199	37
STA. TO STA.		FED. ROAD DIST. NO. ILLINOIS FED. AID PROJECT		

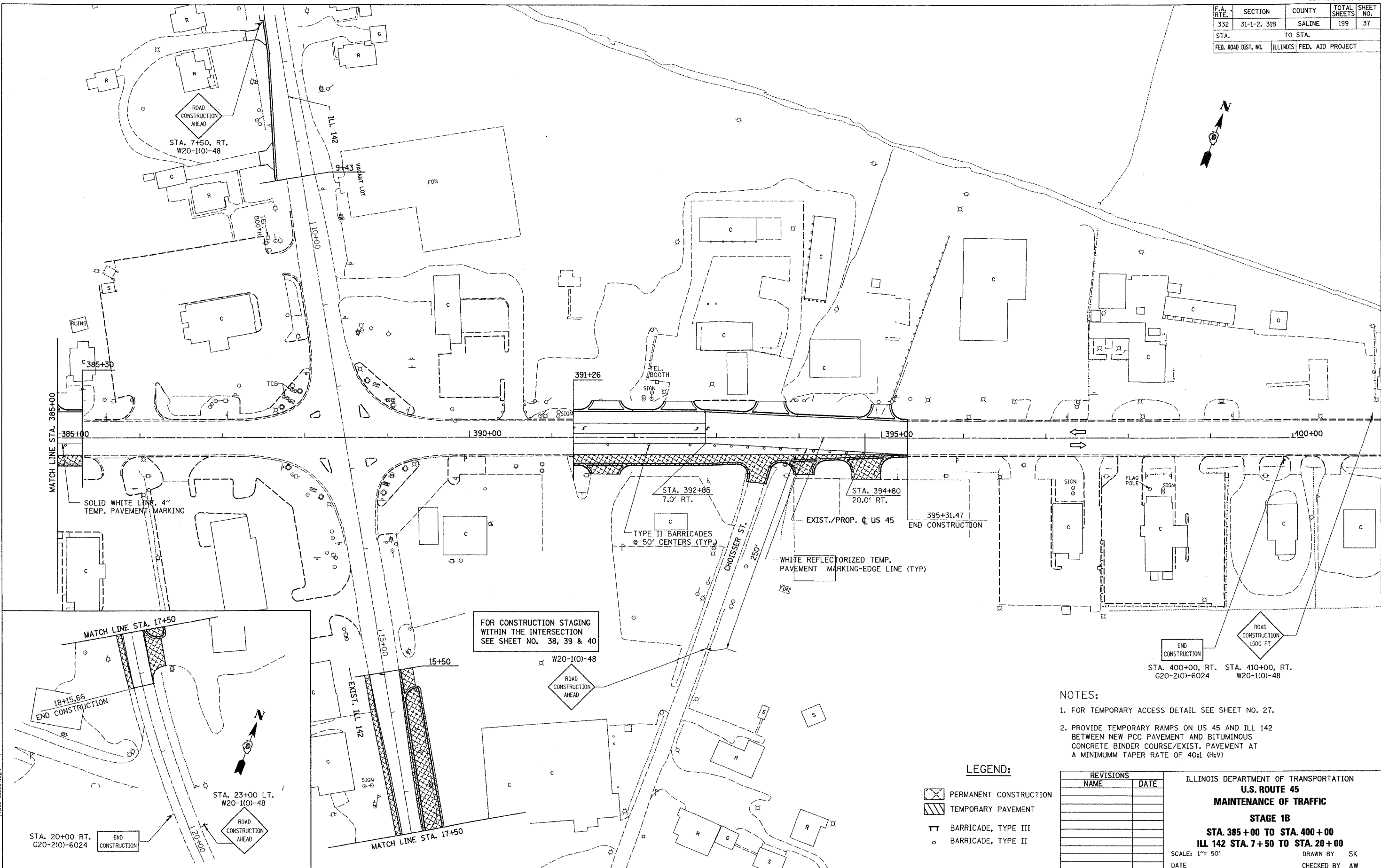

FOR CONSTRUCTION STAGING WITHIN THE INTERSECTION SEE SHEET NO. 38, 39 & 40

- NOTES:**
- FOR TEMPORARY ACCESS DETAIL SEE SHEET NO. 27.
 - PROVIDE TEMPORARY RAMPS ON US 45 AND ILL 142 BETWEEN NEW PCC PAVEMENT AND BITUMINOUS CONCRETE BINDER COURSE/EXIST. PAVEMENT AT A MINIMUM TAPER RATE OF 40:1 (H:V)

LEGEND:

- PERMANENT CONSTRUCTION
- TEMPORARY PAVEMENT
- BARRICADE, TYPE III
- BARRICADE, TYPE II

REVISIONS	
NAME	DATE

ILLINOIS DEPARTMENT OF TRANSPORTATION
U.S. ROUTE 45
MAINTENANCE OF TRAFFIC
STAGE 1B
STA. 385+00 TO STA. 400+00
ILL 142 STA. 7+50 TO STA. 20+00
 SCALE: 1" = 50'
 DATE _____ DRAWN BY SK
 CHECKED BY AW

NO. PROJECTS/PROJISSE/ROADWAY/COMMON/...
 ACTIVE FILE
 PROJECT NO. 332-31-1-2-31B
 DRAWING NO. 332-31-1-2-31B-37
 DATE 08/14/01
 DESIGNED BY SK
 CHECKED BY AW
 DRAWN BY SK