

F.A. RTE.	SECTION	COUNTY	TOTAL SHEETS	SHEET NO.
332	31-1-2, 31B	SALINE	199	45
STA.	TO STA.			
FED. ROAD DIST. NO.	ILLINOIS FED. AID PROJECT			

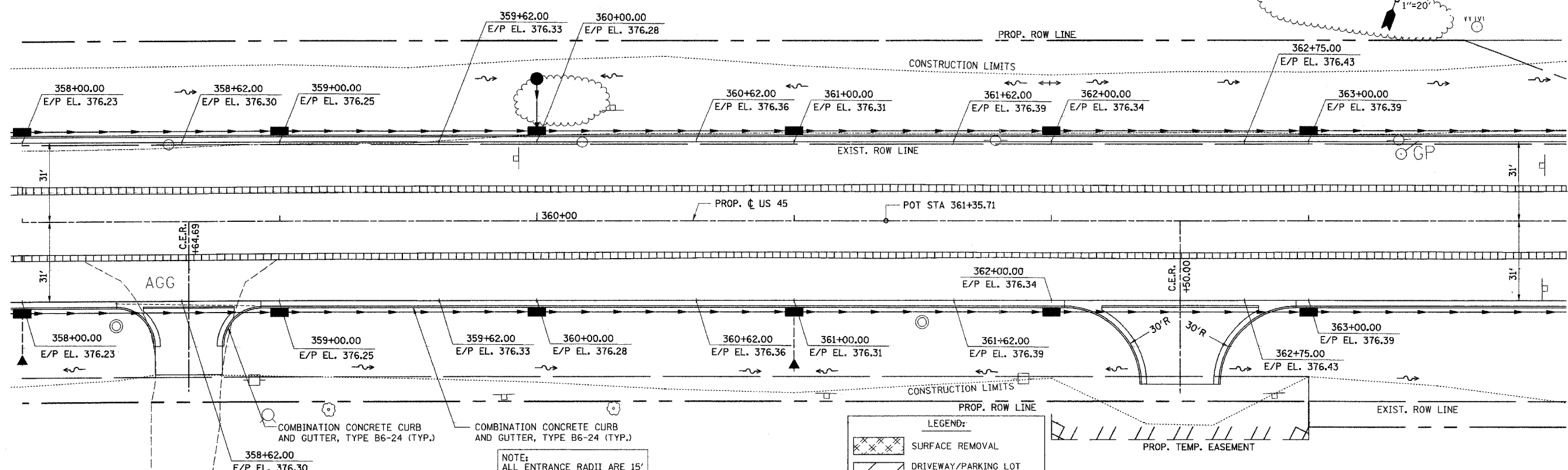
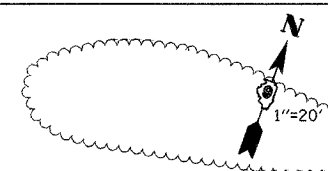

LEGEND:

- SURFACE REMOVAL
- DRIVEWAY/PARKING LOT PAVEMENT REMOVAL
- PAVEMENT REMOVAL
- PAVED SHOULDER REMOVAL

NOTE:
ALL ENTRANCE RADII ARE 15'
UNLESS OTHERWISE NOTED.

DATE: 7/01
BY: [Signature]
CHECKED BY: [Signature]
REVISIONS:
NO. 1: [Description]
NO. 2: [Description]
NO. 3: [Description]
NO. 4: [Description]
NO. 5: [Description]
NO. 6: [Description]
NO. 7: [Description]
NO. 8: [Description]
NO. 9: [Description]
NO. 10: [Description]
NO. 11: [Description]
NO. 12: [Description]
NO. 13: [Description]
NO. 14: [Description]
NO. 15: [Description]
NO. 16: [Description]
NO. 17: [Description]
NO. 18: [Description]
NO. 19: [Description]
NO. 20: [Description]
NO. 21: [Description]
NO. 22: [Description]
NO. 23: [Description]
NO. 24: [Description]
NO. 25: [Description]
NO. 26: [Description]
NO. 27: [Description]
NO. 28: [Description]
NO. 29: [Description]
NO. 30: [Description]
NO. 31: [Description]
NO. 32: [Description]
NO. 33: [Description]
NO. 34: [Description]
NO. 35: [Description]
NO. 36: [Description]
NO. 37: [Description]
NO. 38: [Description]
NO. 39: [Description]
NO. 40: [Description]
NO. 41: [Description]
NO. 42: [Description]
NO. 43: [Description]
NO. 44: [Description]
NO. 45: [Description]
NO. 46: [Description]
NO. 47: [Description]
NO. 48: [Description]
NO. 49: [Description]
NO. 50: [Description]
NO. 51: [Description]
NO. 52: [Description]
NO. 53: [Description]
NO. 54: [Description]
NO. 55: [Description]
NO. 56: [Description]
NO. 57: [Description]
NO. 58: [Description]
NO. 59: [Description]
NO. 60: [Description]
NO. 61: [Description]
NO. 62: [Description]
NO. 63: [Description]
NO. 64: [Description]
NO. 65: [Description]
NO. 66: [Description]
NO. 67: [Description]
NO. 68: [Description]
NO. 69: [Description]
NO. 70: [Description]
NO. 71: [Description]
NO. 72: [Description]
NO. 73: [Description]
NO. 74: [Description]
NO. 75: [Description]
NO. 76: [Description]
NO. 77: [Description]
NO. 78: [Description]
NO. 79: [Description]
NO. 80: [Description]
NO. 81: [Description]
NO. 82: [Description]
NO. 83: [Description]
NO. 84: [Description]
NO. 85: [Description]
NO. 86: [Description]
NO. 87: [Description]
NO. 88: [Description]
NO. 89: [Description]
NO. 90: [Description]
NO. 91: [Description]
NO. 92: [Description]
NO. 93: [Description]
NO. 94: [Description]
NO. 95: [Description]
NO. 96: [Description]
NO. 97: [Description]
NO. 98: [Description]
NO. 99: [Description]
NO. 100: [Description]

PLAN & PROFILE CHECKED BY: [Signature]
DRAINAGE CHECKED BY: [Signature]
DRAWN BY: [Signature]

DATE: 7/01
BY: [Signature]
CHECKED BY: [Signature]
REVISIONS:
NO. 1: [Description]
NO. 2: [Description]
NO. 3: [Description]
NO. 4: [Description]
NO. 5: [Description]
NO. 6: [Description]
NO. 7: [Description]
NO. 8: [Description]
NO. 9: [Description]
NO. 10: [Description]
NO. 11: [Description]
NO. 12: [Description]
NO. 13: [Description]
NO. 14: [Description]
NO. 15: [Description]
NO. 16: [Description]
NO. 17: [Description]
NO. 18: [Description]
NO. 19: [Description]
NO. 20: [Description]
NO. 21: [Description]
NO. 22: [Description]
NO. 23: [Description]
NO. 24: [Description]
NO. 25: [Description]
NO. 26: [Description]
NO. 27: [Description]
NO. 28: [Description]
NO. 29: [Description]
NO. 30: [Description]
NO. 31: [Description]
NO. 32: [Description]
NO. 33: [Description]
NO. 34: [Description]
NO. 35: [Description]
NO. 36: [Description]
NO. 37: [Description]
NO. 38: [Description]
NO. 39: [Description]
NO. 40: [Description]
NO. 41: [Description]
NO. 42: [Description]
NO. 43: [Description]
NO. 44: [Description]
NO. 45: [Description]
NO. 46: [Description]
NO. 47: [Description]
NO. 48: [Description]
NO. 49: [Description]
NO. 50: [Description]
NO. 51: [Description]
NO. 52: [Description]
NO. 53: [Description]
NO. 54: [Description]
NO. 55: [Description]
NO. 56: [Description]
NO. 57: [Description]
NO. 58: [Description]
NO. 59: [Description]
NO. 60: [Description]
NO. 61: [Description]
NO. 62: [Description]
NO. 63: [Description]
NO. 64: [Description]
NO. 65: [Description]
NO. 66: [Description]
NO. 67: [Description]
NO. 68: [Description]
NO. 69: [Description]
NO. 70: [Description]
NO. 71: [Description]
NO. 72: [Description]
NO. 73: [Description]
NO. 74: [Description]
NO. 75: [Description]
NO. 76: [Description]
NO. 77: [Description]
NO. 78: [Description]
NO. 79: [Description]
NO. 80: [Description]
NO. 81: [Description]
NO. 82: [Description]
NO. 83: [Description]
NO. 84: [Description]
NO. 85: [Description]
NO. 86: [Description]
NO. 87: [Description]
NO. 88: [Description]
NO. 89: [Description]
NO. 90: [Description]
NO. 91: [Description]
NO. 92: [Description]
NO. 93: [Description]
NO. 94: [Description]
NO. 95: [Description]
NO. 96: [Description]
NO. 97: [Description]
NO. 98: [Description]
NO. 99: [Description]
NO. 100: [Description]

M:\PROJECTS\PROJ0536\ROADWAY\COMMON\
Reference Files
Active Files
2/2/2014 5:00pm

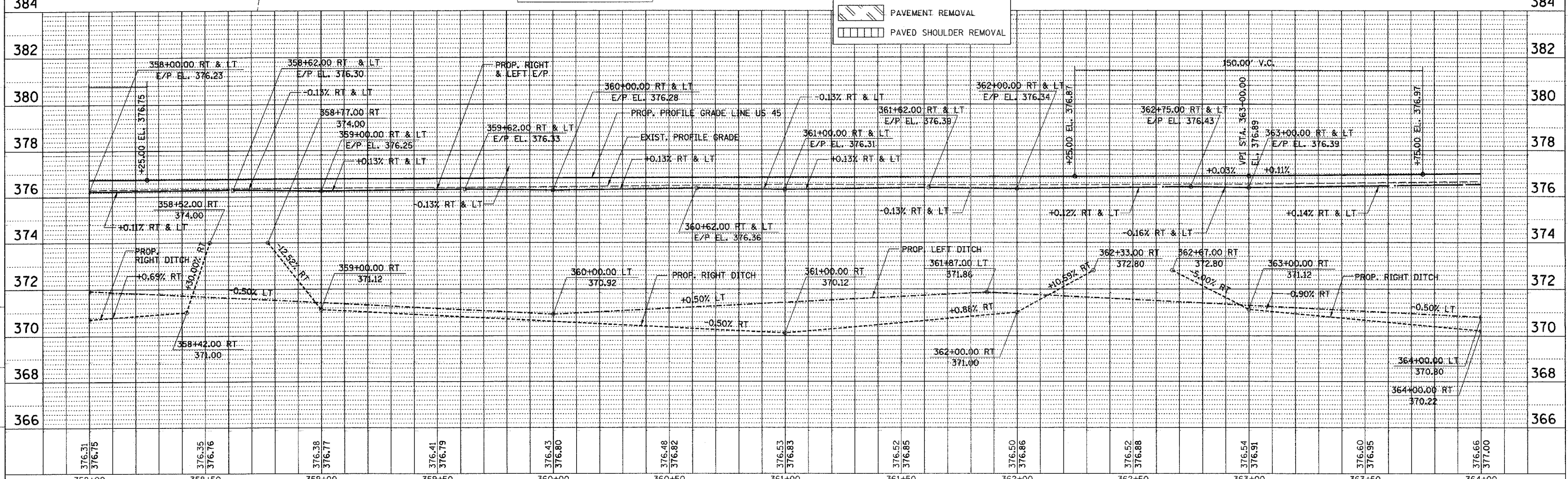

PLAN PROFILE - US 45 STA. 358+00 TO STA. 364+00