

CONTRACT NO. 98631				
F.A. RTE.	SECTION	COUNTY	TOTAL SHEETS	SHEET NO.
332	31-1-2, 31B	SALINE	199	95
STA.		TO STA.		
FED. ROAD DIST. NO.		ILLINOIS FED. AID PROJECT		

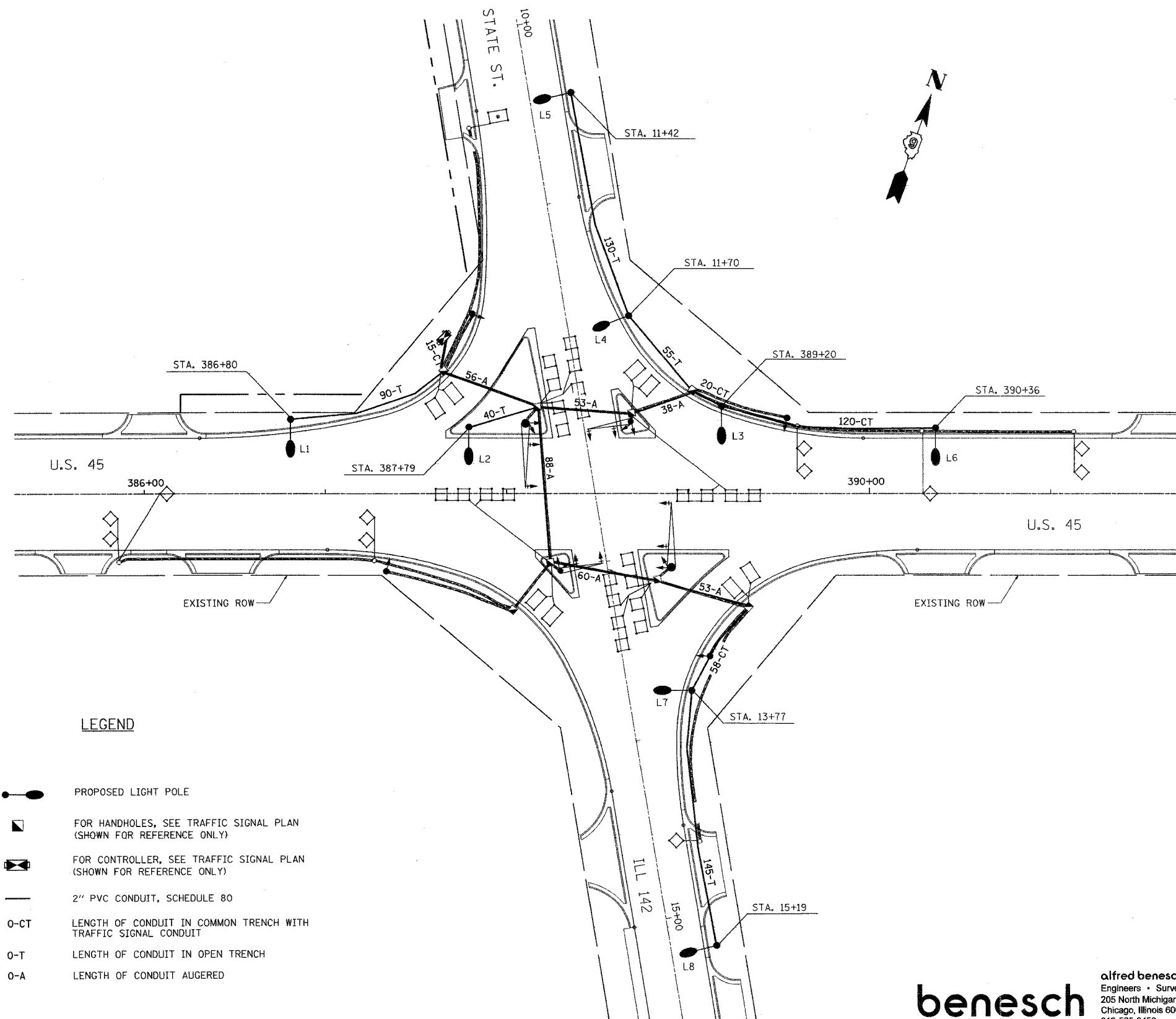

GENERAL NOTES-LIGHTING PLAN

1. THE CONTRACTOR WILL MATCH THE BOLT CIRCLE OF THE POLE BASE WITH THE BOLT CIRCLE OF THE PROPOSED METAL FOUNDATION.
2. ANCHOR BOLTS WILL NOT BE PAID SEPARATELY, BUT WILL BE INCIDENTAL TO THE FOUNDATION.
3. THE LIGHTING INSTALLATION WILL COMPLY WITH APPLICABLE NEC CODE AND STANDARDS.
4. LIGHT POLES WILL LOCATED 6 FT FROM THE FACE OF THE CURB TO THE CENTER OF THE POLE.
5. LIGHT POLES WILL BE AFFIXED WITH POLE NUMBERS TO MATCH THE EXISTING POLE NUMBERS. IF THE EXISTING POLES DO NOT SHOW ANY POLE NUMBERS, THAN THE NEW POLE NUMBERS WILL BE AFFIXED PER PLANS. POLE NUMBER SPECIFICATIONS WILL BE PER STANDARD SPECIFICATIONS SEC. 1069.02.
6. STANDARD SPECIFICATIONS SEC. 1069.02.
7. LIGHT POLE LOCATIONS WILL BE PER PLAN LOCATIONS +5' OR AS DIRECTED BY THE ENGINEER TO AVOID CONFLICTS.
8. CONTRACTOR WILL COMPLY WITH GENERAL ELECTRICAL/LIGHTING REQUIREMENTS PER SS SECTION 801. LIGHTING WILL BE MAINTAINED OPERATIONAL EVERY NIGHT AND THE COST OF MAINTENANCE IS INCLUDED IN THE RELOCATION OF EXISTING LIGHTING UNIT ITEM.
9. LIGHTING SYSTEM WILL COMPLY WITH NEC 250 AND SEC. 806 FOR GROUNDING REQUIREMENTS, THIS WORK WILL NOT BE PAID SEPARATELY BUT WILL BE INCLUDED IN THE ELECTRIC CABLE IN CONDUIT PAY ITEM.
10. BREAKAWAY COUPLINGS TO BE INSTALLED AT ALL LIGHT POLE LOCATIONS. COUPLING WILL BE INCIDENTAL TO THE LIGHT POLE UNIT.
11. FOR CONTROLLER LOCATION, SEE PROPOSED TRAFFIC SIGNAL PLAN.

LEGEND

- PROPOSED LIGHT POLE
- FOR HANDHOLES, SEE TRAFFIC SIGNAL PLAN (SHOWN FOR REFERENCE ONLY)
- FOR CONTROLLER, SEE TRAFFIC SIGNAL PLAN (SHOWN FOR REFERENCE ONLY)
- 2" PVC CONDUIT, SCHEDULE 80
- O-CT LENGTH OF CONDUIT IN COMMON TRENCH WITH TRAFFIC SIGNAL CONDUIT
- O-T LENGTH OF CONDUIT IN OPEN TRENCH
- O-A LENGTH OF CONDUIT AUGERED

L-1

REVISIONS		ILLINOIS DEPARTMENT OF TRANSPORTATION
NAME	DATE	
		IL RTE 142 AT U.S. 45 PROPOSED LIGHTING PLAN
SCALE: 1"=30'		DRAWN BY DJK CHECKED BY RCC
DATE		

benesch

alfred benesch & company
Engineers • Surveyors • Planners
205 North Michigan Avenue, Suite 2400
Chicago, Illinois 60601
312-565-0450

FILE 49