

Bench Mark : BM 370 "□" Cut in SE wing wall of Bridge 083-0003 at Sta. 365+70, 20' Rt. of new Rt. 45 @ Elev. 376.732

Existing Structure : S.N. 083-0003, single span 30'-2 1/4" bk to bk abutments, 16" R.C. slab bridge 68'-7" out to out closed abutments. Originally Built in 1922. Built as S.B.I. Route 1, Section 31B-Y at Sta. 365+85.7. Structure widened in 1948. The contractor shall remove existing structure SN 083-0003 and construct new triple box culvert SN 083-2014. Traffic shall be maintained during the construction of the structure by stage construction.

No Salvage.

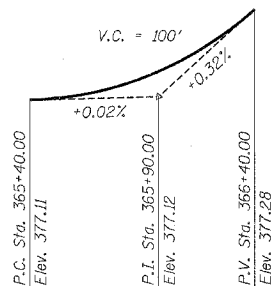

PROFILE GRADE
Along @ U.S. Route 45

STATE OF ILLINOIS
DEPARTMENT OF TRANSPORTATION

GENERAL NOTES

Reinforcement bars shall conform to the requirements of AASHTO M 31, or M 322 Grade 60.

Layout of slope protection system may be varied in the field to suit ground conditions as directed by the Engineer.

For Backfilling and Embankment, See Standard Specifications.

Exposed edges shall have a 3/4" chamfer unless otherwise noted.

A distance of half the length of the wingwall but not less than 6'-0" of barrel shall be cast monolithically with the wingwalls.

Precast alternate is not allowed

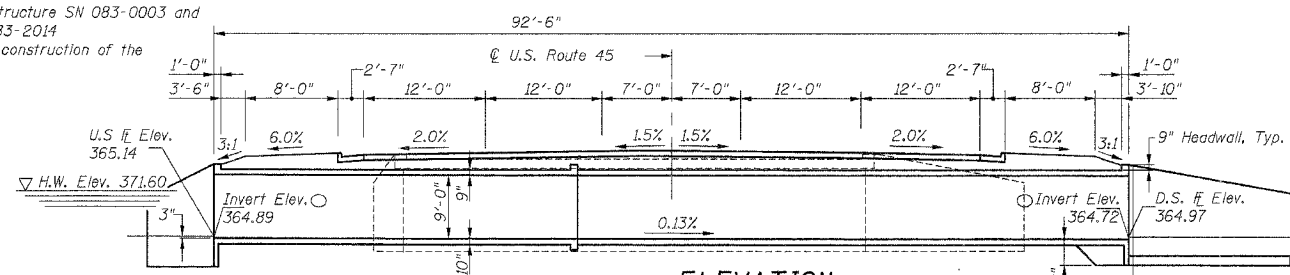

ELEVATION
Dimensions at Right Angle to @ U.S. Route 45

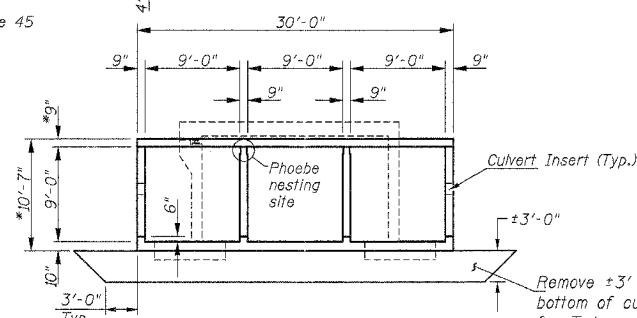

SECTION THRU BARREL

F.A.P. DIST.	SECTION	COUNTY	TOTAL SHEETS	SHEET NO.
332	31-1, 42-1	SALINE	199	78

Sheet 1 of 7 Sheets
CONTRACT NO. 98631

LOADING HS20-44

Allow 50 lb/ft² for future wearing surface.

DESIGN SPECIFICATIONS

1996 AASHTO with 1997, 1998, 1999 and 2000 interims.

DESIGN STRESSES

FIELD UNITS
f_c = 3,500 psi
f_y = 60,000 psi (Reinf.)
q_{all} = 2,300 psf

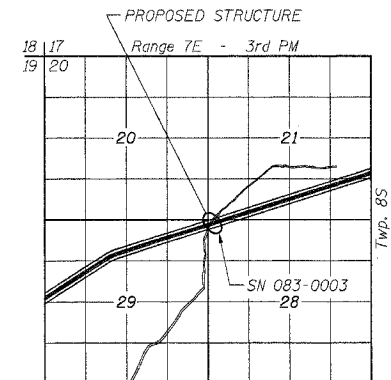

LOCATION SKETCH

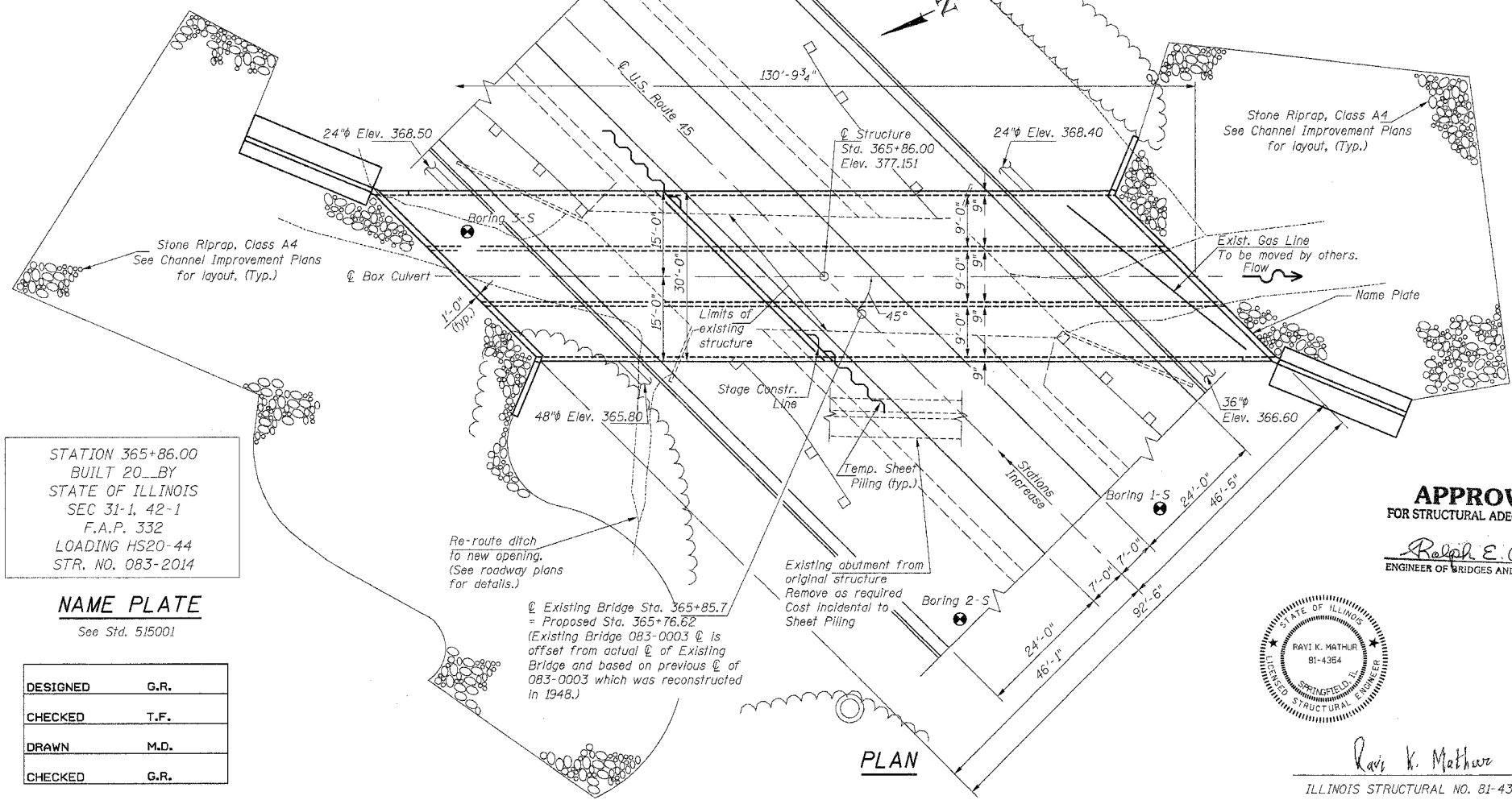

PLAN

STATION 365+86.00
BUILT 20__ BY
STATE OF ILLINOIS
SEC 31-1, 42-1
F.A.P. 332
LOADING HS20-44
STR. NO. 083-2014

NAME PLATE
See Std. 515001

DESIGNED	G.R.
CHECKED	T.F.
DRAWN	M.D.
CHECKED	G.R.

TOTAL BILL OF MATERIAL

ITEMS	UNIT	TOTAL
Removal of Existing Structures	Each	1
Concrete Box Culvert	Cu. Yd.	421.4
Reinforcement Bars	Pound	142,020
Reinforcement Bars, Epoxy Coated	Pound	720
Name Plates	Each	1
Stone Riprap, Class A4	Sq. Yd.	966
Filter Fabric for use with Riprap	Sq. Yd.	966
Temporary Sheet Piling	Sq. Ft.	1,261
Bar Splacers	Each	142
Structure Excavation	Cu. Yd.	685.7
Porous Granular Embankment	Ton	291
Breaker Run Crushed Stone	Ton	1,157

WATERWAY INFORMATION

Drainage Area = 1.9 Sq. Mi. Low Grade Elev. = 377.1 ft. @ Sta. 365+86

Flood	Freq. Yr.	Q cfs	Opening Sq. ft.		Nat. H.W.E. ft.	Head - ft.		Headwater Elev. - ft.	
			Exist.	Prop.		Exist.	Prop.	Exist.	Prop.
Design	50	755	77	165	371.6	2.4	0.3	374.0	371.9
Base	100	855	83	173	371.9	2.7	0.4	374.6	372.3
Overlapping	—	—	—	—	—	—	—	—	—
Max. Calc.	500	1090	95	191	372.6	3.3	0.7	375.9	373.3

APPROVED
FOR STRUCTURAL ADEQUACY ONLY
Ralph E. Anderson
ENGINEER OF BRIDGES AND STRUCTURES



Ravi K. Mathur 6.24.2005
ILLINOIS STRUCTURAL NO. 81-4354 EXPIRES 11-30-2006

GENERAL PLAN
U.S. ROUTE 45 OVER
TRIBUTARY TO MIDDLE FORK OF SALINE RIVER
F.A.P. ROUTE 332 SECTION 31-1, 42-1
SALINE COUNTY
STATION 365+86.00
STRUCTURE NUMBER 083-2014

