

CONTRACT NO. 98631				
F.A.P. RTE.	SECTION	COUNTY	TOTAL SHEETS	SHEET NO.
332	31-1-2, 31B	SALINE	199	109
STA.		TO STA.		
FED. ROAD DIST. NO.		ILLINOIS FED. AID PROJECT		

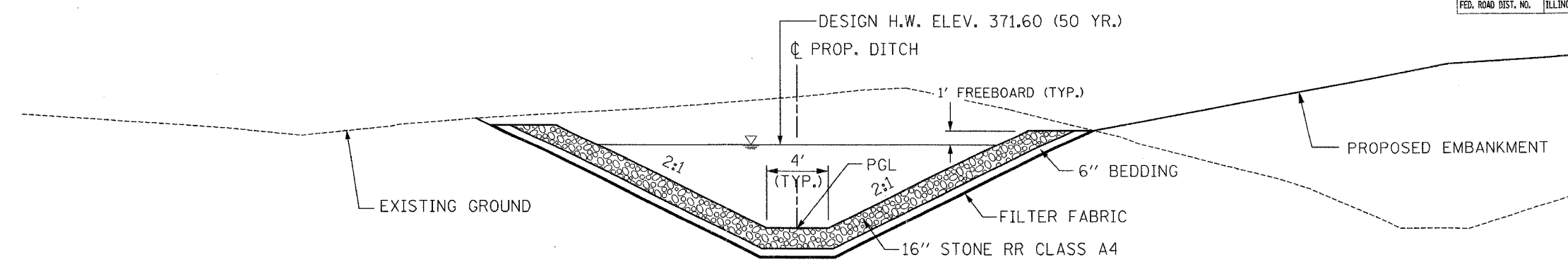

**PROP. CURVE CHO1C4**  
 PI STA. = 4+50.00  
 $\Delta = 90^\circ 00' 00''$  (LT)  
 $D = 190^\circ 59' 09''$   
 $R = 30.00'$   
 $T = 30.00'$   
 $L = 47.12'$   
 $E = 12.43'$   
 P.C. STA. = 4+20.00  
 P.T. STA. = 4+67.12

**PROP. CURVE CHO2C4**  
 PI STA. = 4+98.59  
 $\Delta = 73^\circ 19' 46''$  (RT)  
 $D = 143^\circ 14' 22''$   
 $R = 40.00'$   
 $T = 29.78'$   
 $L = 51.19'$   
 $E = 9.87'$   
 P.C. STA. = 4+68.81  
 P.T. STA. = 5+20.00

**TYPICAL DRAINAGE DITCH SECTION**  
(NO SCALE)

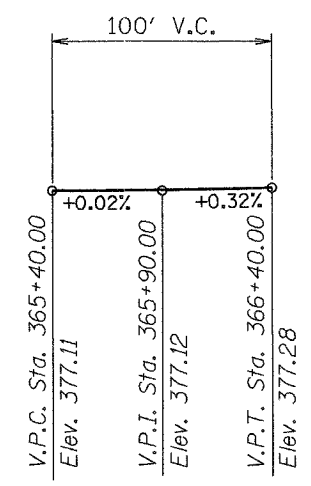
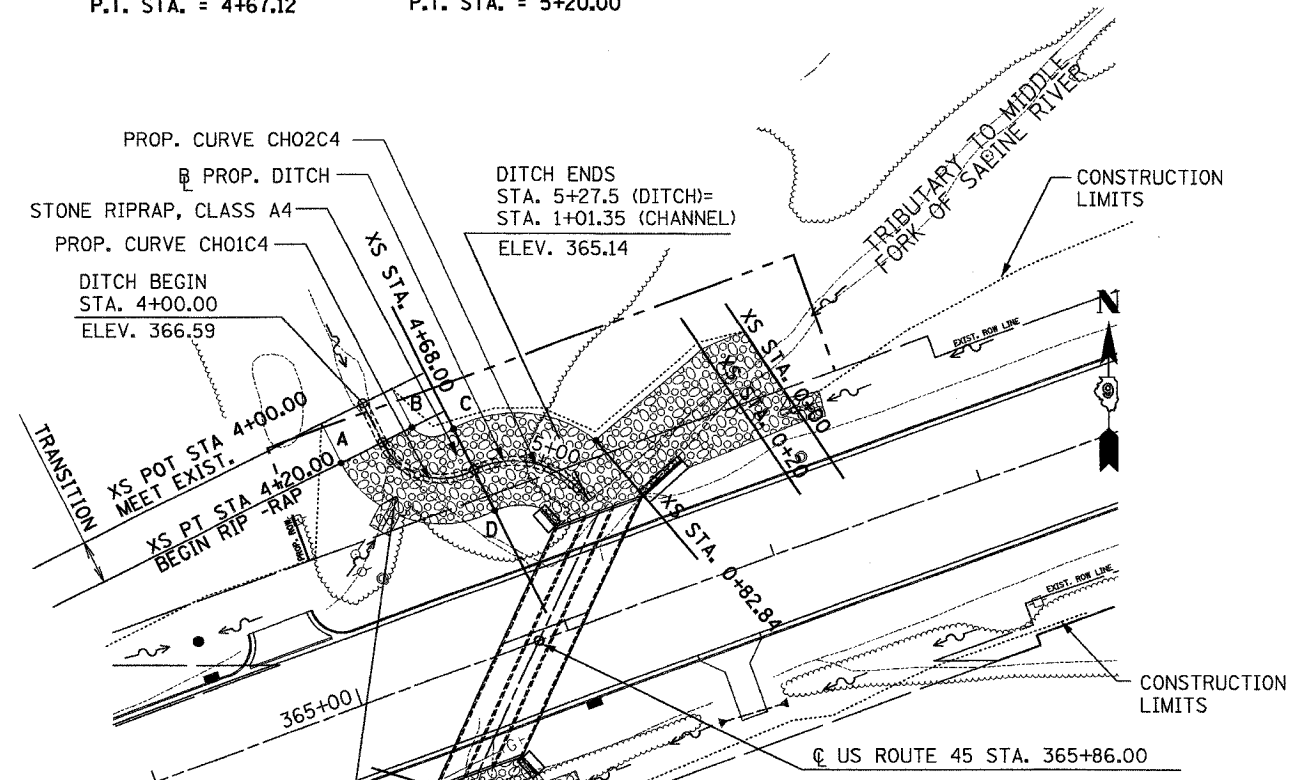

**PROFILE GRADE**  
Along  $\bar{C}$  of U.S. Route 45

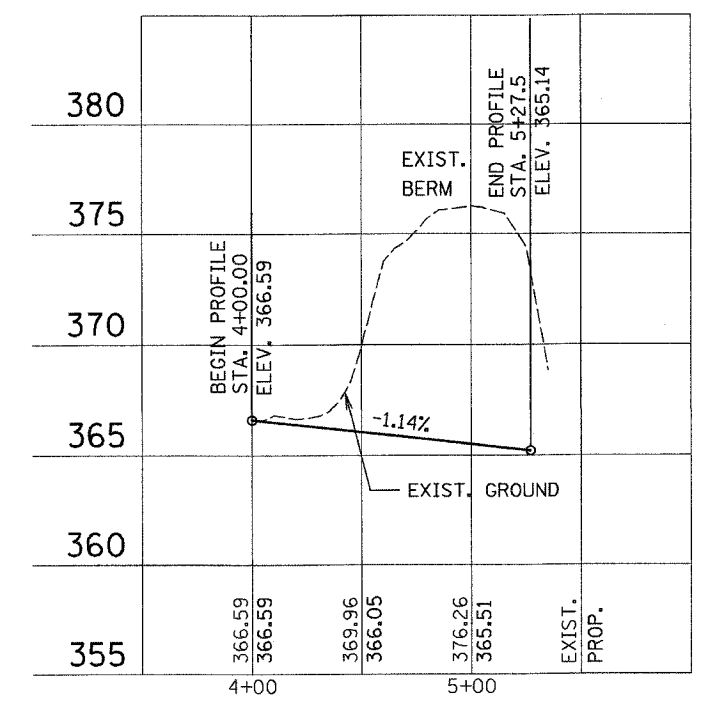

**DRAINAGE DITCH PROFILE**  
1" = 40'

- A = STA. 4+20, 20' RT.
- B = STA. 4+20, 15' LT.
- C = STA. 4+68, 20' LT.
- D = STA. 4+68, 20' RT.

- NOTES:
- SEE SHEET 105 FOR CHANNEL IMPROVEMENTS FOR THE TRIBUTARY
  - SEE SHEET 98-104 FOR BOX CULVERT PLANS

STA. 4+39.00 O/S 14' RT (DITCH)  
 STA. 365+50.00 O/S 83' LT (US 45 LEFT DITCH)  
 ELEV. = 370.27

**PLAN**  
1" = 40'

**CHANNEL IMPROVEMENT  
 DRAINAGE DITCH  
 SALINE COUNTY  
 STATION 365+86.00  
 STR. NO. 083-2014**

DRAWN BY: J.S.  
 CHECKED BY: M.J.