

JUN 10, 2005 9:39 AM CCC  
 I:\AIRPORTS\DECATUR\802-04TXD\AIRPORT\ SHEETS\CONTRACT-1\R-151MRK.DWG - STA. 378+00 TO 391+00

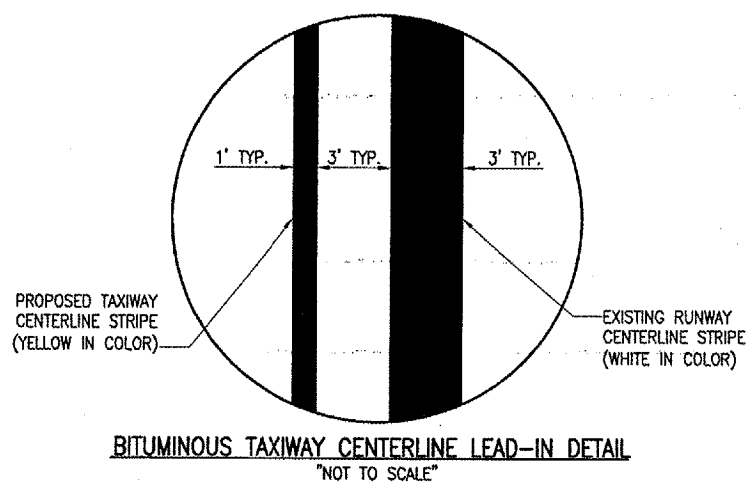

BITUMINOUS TAXIWAY CENTERLINE LEAD-IN DETAIL  
 "NOT TO SCALE"

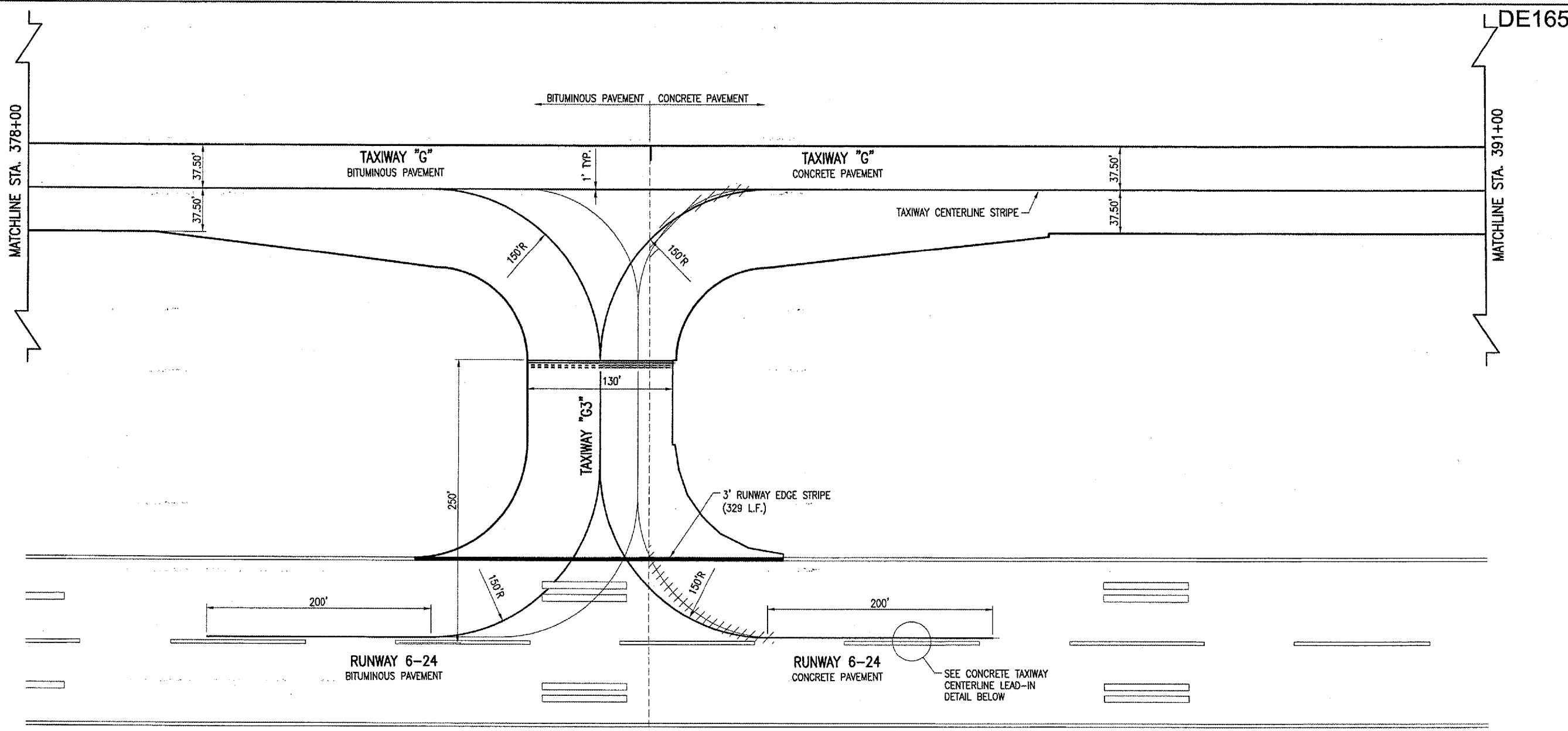
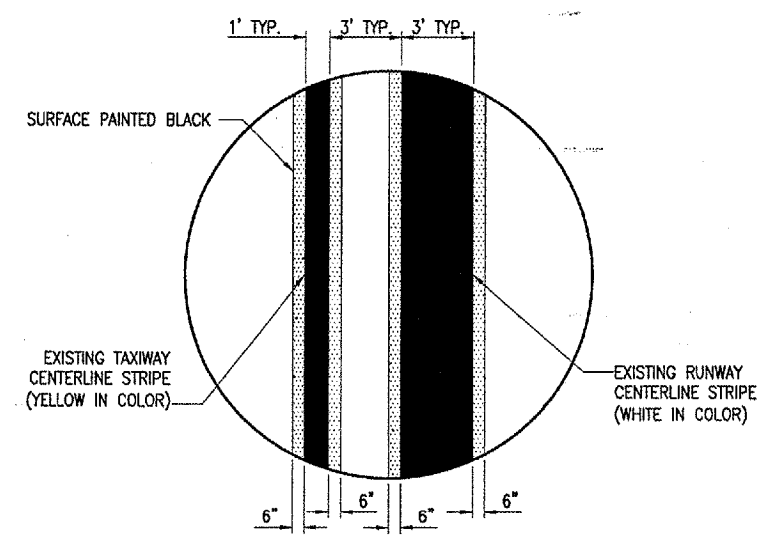

CONCRETE TAXIWAY CENTERLINE LEAD-IN DETAIL  
 "NOT TO SCALE"

- LEGEND**
- EXISTING PAVEMENT
  - PROPOSED PAVEMENT
  - EXISTING MARKING
  - PROPOSED MARKING
  - MARKING TO BE REMOVED

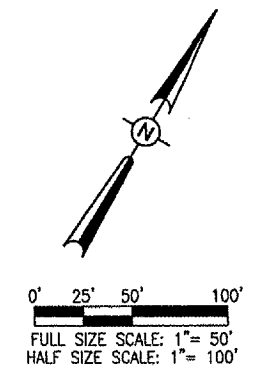

DATE	REVISION	BY

**DECATUR, ILLINOIS**
  
 I.L. PROJ.: DEC-3414

I&E Project No. 802-04TXD Element R-151MRK.DWG Scale 1"=50' Date 03/18/05	LAYOUT CCC 03/18/05 DRAWN CCC 03/18/05 REVIEWED WJM 06/07/05
--	--

**HANSON**
  
 Engineers, Architects, Scientists  
 1625 West Lake Street  
 Springfield, Illinois 62703-2886  
 Offices Nationwide

**TAXIWAY G WIDENING  
 PHASE II**  
 PROPOSED  
 MARKING PLAN  
 STA. 378+00 TO STA. 391+00