

JUN 10, 2005 12:44 PM CCC  
 I:\AIRPORTS\DECATUR\802-04TXD\AIRPORT\SHEETS\CONTRACT-1\R-311-XS.DWG - STA. 383+50 TO 384+50

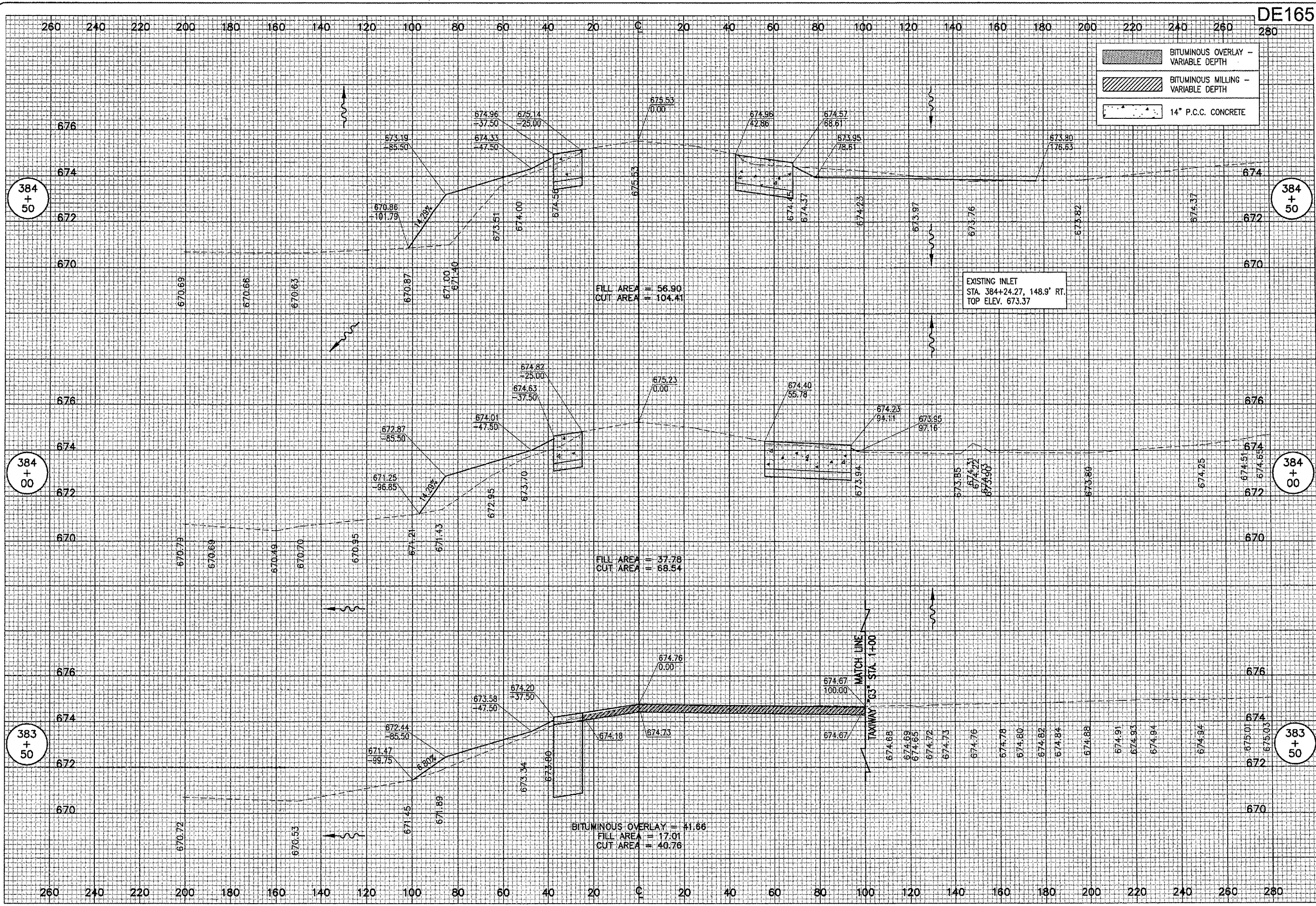

DE165

	BITUMINOUS OVERLAY - VARIABLE DEPTH
	BITUMINOUS MILLING - VARIABLE DEPTH
	14\" P.C.C. CONCRETE

EXISTING INLET  
 STA. 384+24.27, 148.9' RT.  
 TOP ELEV. 673.37

FILL AREA = 56.90  
 CUT AREA = 104.41

FILL AREA = 37.78  
 CUT AREA = 68.54

BITUMINOUS OVERLAY = 41.66  
 FILL AREA = 17.01  
 CUT AREA = 40.76

BY	
REVISION	
DATE	

DECATUR, ILLINOIS  
 I.L. PROJ.: DEC-3414  
 A.I.P. PROJ.: 3-17-0033-28

HEL. PROJ. NO. 802-04TXD	
PLAN NO. 311-XS.DWG	
SCALE 1" = 50'	
DATE 11/11/04	
LAYOUT	CCC 11/11/04
DRAWN	CCC 11/11/04
REVIEWED	CAH 06/07/05

HANSON  
 Engineers, Architects, Scientists  
 1525 South Sixth Street  
 Springfield, Illinois 62703-2886  
 Offices Nationwide

TAXIWAY G WIDENING  
 PHASE II  
 PROPOSED CROSS-SECTIONS  
 TAXIWAY "G"  
 STA. 383+50 TO STA. 384+50