

LEGEND

- ⊕ BM #1 BENCHMARK AND NO.
- EXISTING 16" DIA. PIPELINE
- - - - - EXISTING AIRPORT PROPERTY LINE

WHERE SPECIFIC MANUFACTURERS OF EQUIPMENT ARE GIVEN, THE CONTRACTOR MAY SUBMIT ALTERNATE EQUIPMENT EQUAL TO THAT PROPOSED FOR CONSIDERATION BY THE ENGINEER.

HORIZONTAL CONTROL

PT	DESCRIPTION	NORTHING	EASTING
1	RUNWAY 36 END	1770558.078	720619.730
2	RUNWAY 18/36 AND TAXIWAY L	1771559.057	720612.866
3	RUNWAY 18/36 AND TAXIWAY K	1772554.033	720606.009
4	RUNWAY 18/36 AND TAXIWAY J	1773559.010	720599.152
5	RUNWAY 18/36 AND TAXIWAY G1	1774542.487	720592.409
6	RUNWAY 18 END	1774580.322	720592.285
7	RUNWAY 18/36 CENTERLINE AT LOCALIZER	1775560.299	720585.429

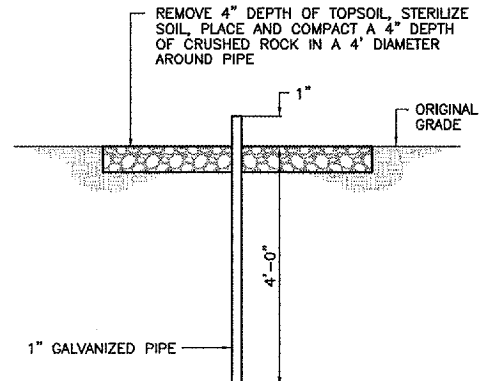
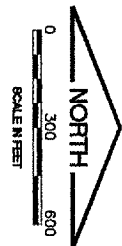

LOCALIZER GROUND CHECK POINT IN SOIL

N.T.S.

NOTE: LOCALIZER GROUND CHECK POINTS SHALL BE CONSIDERED INCIDENTAL TO THE LOCALIZER.

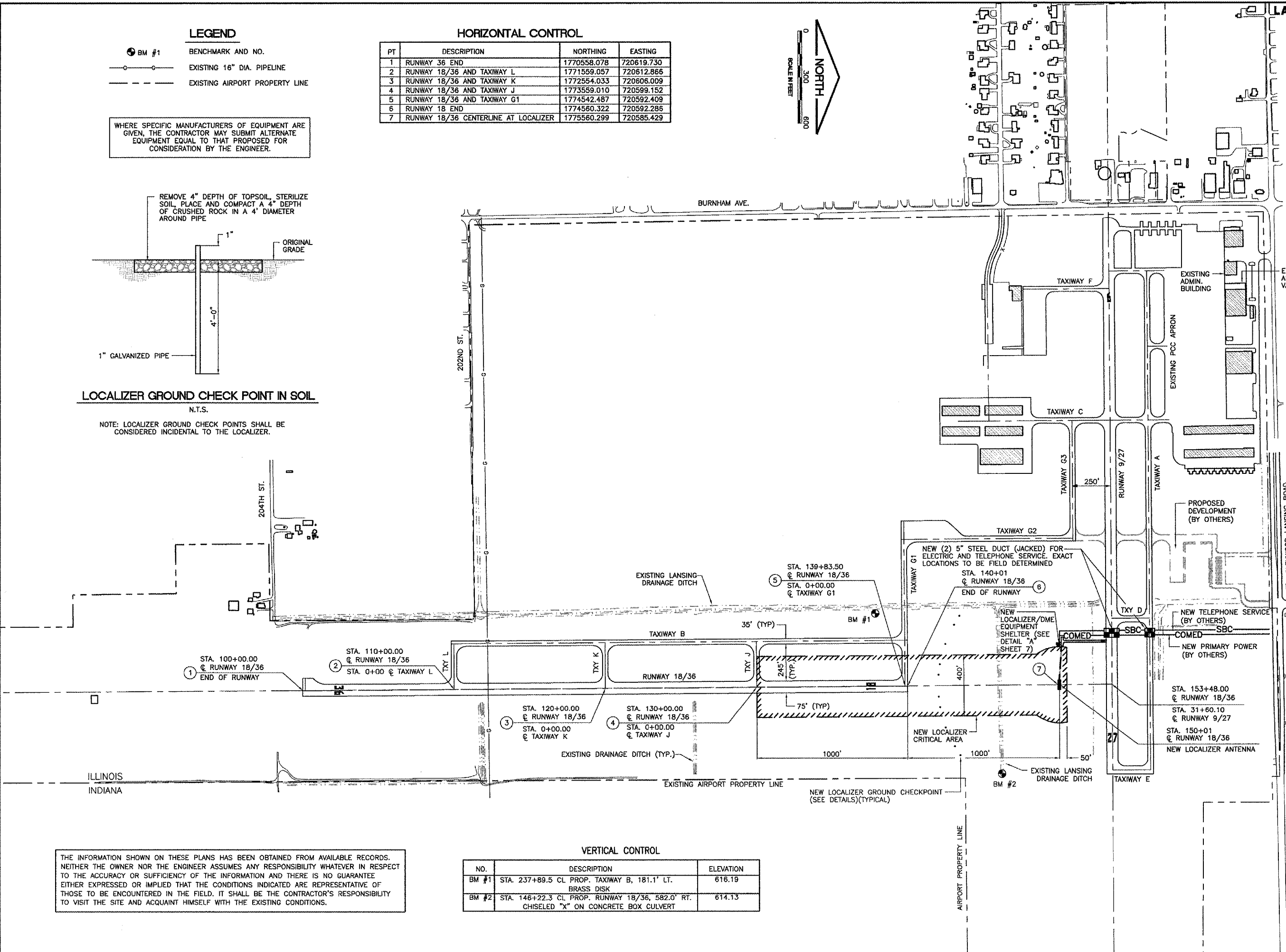

REVISIONS

NUMBER	BY	DATE

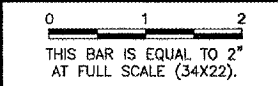

**LANSING MUNICIPAL AIRPORT
 LANSING, ILLINOIS**
**INSTALL RUNWAY 36 LOCALIZER
 SITE PLAN AND
 PROJECT CONTROL PLAN**

© Copyright CMT, Inc.
CMT
 CRAWFORD, MURPHY & TILLY, INC.
 CONSULTING ENGINEERS
 License No. 184-000513

DESIGN BY:	MJS
DRAWN BY:	JRO
CHECKED BY:	CAL
APPROVED BY:	
DATE:	06/22/05
JOB No:	04297-03

IL. PROJECT: IGQ-3482
 A.I.P. PROJECT: 3-17-0121-B23

THE INFORMATION SHOWN ON THESE PLANS HAS BEEN OBTAINED FROM AVAILABLE RECORDS. NEITHER THE OWNER NOR THE ENGINEER ASSUMES ANY RESPONSIBILITY WHATEVER IN RESPECT TO THE ACCURACY OR SUFFICIENCY OF THE INFORMATION AND THERE IS NO GUARANTEE EITHER EXPRESSED OR IMPLIED THAT THE CONDITIONS INDICATED ARE REPRESENTATIVE OF THOSE TO BE ENCOUNTERED IN THE FIELD. IT SHALL BE THE CONTRACTOR'S RESPONSIBILITY TO VISIT THE SITE AND ACQUAINT HIMSELF WITH THE EXISTING CONDITIONS.

VERTICAL CONTROL

NO.	DESCRIPTION	ELEVATION
BM #1	STA. 237+89.5 CL PROP. TAXIWAY B, 181.1' LT. BRASS DISK	616.19
BM #2	STA. 146+22.3 CL PROP. RUNWAY 18/36, 582.0' RT. CHISELED "X" ON CONCRETE BOX CULVERT	614.13