

CONSTRUCTION NOTES FOR SILT FENCE

1. WHEN TWO SECTIONS OF FILTER CLOTH ADJOIN EACH OTHER THEY SHALL BE OVERLAPPED BY 6" MIN. AND FOLDED.
2. MAINTENANCE SHALL BE PERFORMED AS NEEDED AND MATERIAL REMOVED WHEN "BULGES" DEVELOP IN THE SILT FENCE. MAINTENANCE, WHICH INCLUDES THE REPLACEMENT OF DAMAGED FENCE, SHALL BE CONSIDERED INCIDENTAL TO THE COST OF THE EROSION CONTROL FENCE.
3. SILT FENCE SHALL BE INSTALLED PER STORM WATER POLLUTION PREVENTION PLAN OR AS DIRECTED BY THE ENGINEER.



SEE NRCS STANDARD DRAWING NO. IL-530 EROSION BLANKET PLAN (INCLUDED IN SPECIAL PROVISIONS) FOR INSTALLATION DETAIL AND NOTES

SEE NRCS STANDARD DRAWING NO. IL-620 SILT FENCE PLAN (INCLUDED IN SPECIAL PROVISIONS) FOR INSTALLATION DETAIL AND ADDITIONAL NOTES

GENERAL NOTES

1. ALL PROJECT AREAS, INCLUDING STOCKPILES, ABANDONED HAUL ROADS AND STAGING AREAS, AS SHOWN ON THE PLANS, SHALL HAVE 4 INCHES OF TOPSOIL PLACED AND BE SEEDED AND BLANKETED IN ACCORDANCE WITH THE SPECIFICATIONS. AREAS DISTURBED OUTSIDE THE PROJECT LIMITS WILL BE SEEDED AND BLANKETED BY THE CONTRACTOR AT HIS COST AND RESTORED TO ORIGINAL CONDITIONS.
2. FOR MORE INFORMATION, SEE STORMWATER POLLUTION PREVENTION NOTES ON SHEET 6 AND DETAILS INCLUDED IN SPECIAL PROVISIONS.
3. SEDIMENT AND EROSION CONTROL MEASURES SHALL BE INSPECTED ON A WEEKLY BASIS AND AFTER EACH 1/2" RAIN EVENT.
4. THE CONTRACTOR SHALL HAVE A COPY OF THE APPROVED EROSION AND SEDIMENT CONTROL PLAN ON THE SITE AT ALL TIMES.

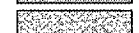
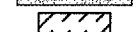
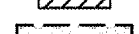
LEGEND

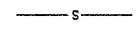
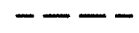
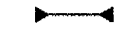
-  NEW BITUMINOUS PAVEMENT
-  NEW AGGREGATE PAD/WALKWAY
-  NEW LOCALIZER SHELTER BUILDING
-  NEW SEED (901) AND EROSION CONTROL BLANKET (156)
-  NEW SILT FENCE
-  NEW GRADING LIMITS
-  NEW CULVERT AND END SECTION
-  EXISTING AIR OPERATION LINE (A.O.A.)

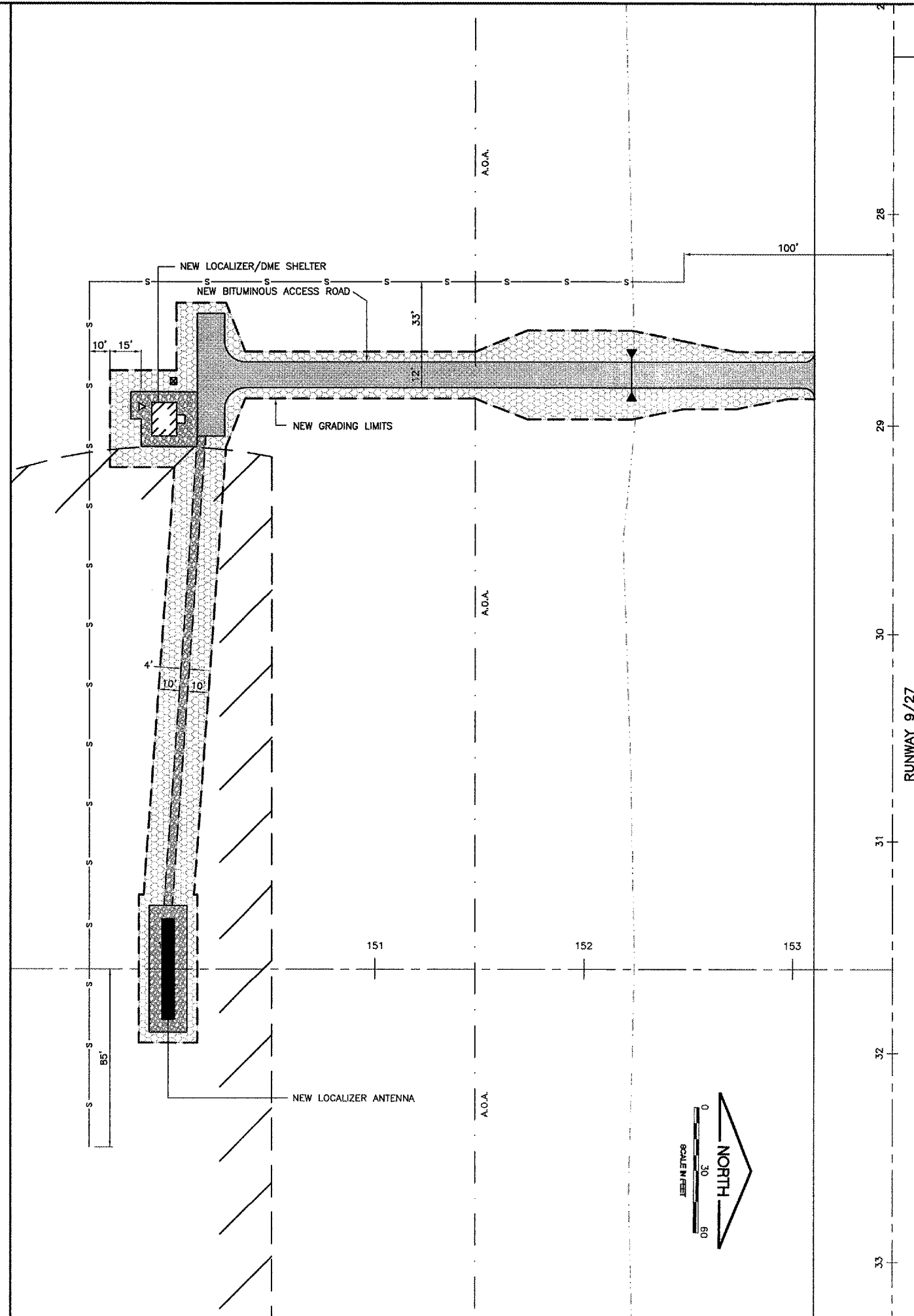

LA035
 PATH: K:\LansingAp\0429703\Draw\See
 FILE: localizer-spp.dwg
 UPDATE BY: johse
 SURVEY BOOK #
 XREF DWG:
 XREF DWG:
 DATE: Mon 6/13/05 9:10pm

REVISIONS		
NUMBER	BY	DATE

0 1 2
 THIS BAR IS EQUAL TO 2"
 AT FULL SCALE (34X22).

**LANSING MUNICIPAL AIRPORT
 LANSING, ILLINOIS**

**INSTALL RUNWAY 36 LOCALIZER
 STORMWATER POLLUTION PREVENTION
 PLAN AND DETAILS**

CMT
 CRAWFORD, MURPHY & TILLY, INC.
 CONSULTING ENGINEERS
 License No. 184-000613

Lansing Municipal
airport

DESIGN BY: CAL
 DRAWN BY: JRO
 CHECKED BY: CAL
 APPROVED BY:
 DATE: 06/22/05
 JOB No: 04297-03
 I.L. PROJECT: IGQ-3482
 A.I.P. PROJECT: 3-17-0121-B23
 SHEET 5 OF 18 SHEETS