

**NOTES**

1. CONTRACTOR SHALL VERIFY EXISTING RUNWAY AND TAXIWAY LIGHTING ARE OPERATIONAL AT THE END OF EACH WORKING DAY.
2. ANY TEMPORARY CABLING REQUIRED FOR THIS PROJECT SHALL BE CONSIDERED INCIDENTAL TO THE CONTRACT.
3. IN AREAS WHERE UNDERDRAIN OR STORM SEWER IS BEING REMOVED BELOW LIMITS OF NEW OR EXISTING PAVEMENTS, TRENCH SHALL BE BACKFILLED WITH COMPACTED CRUSHED AGGREGATE BACKFILL (208). COST OF BACKFILLING SHALL BE PAID FOR UNDER TRENCH BACKFILL (701).
4. ALL CONCRETE AND ASPHALT DEBRIS ENCOUNTERED DURING EXCAVATION MAY BE USED AS EMBANKMENT FILL, IF APPROVED BY THE ENGINEER. MATERIAL SHALL BE BROKEN IN 1'x1' PIECES OR SMALLER. LOCATION OF FILL SHALL BE AS APPROVED BY THE ENGINEER. COST IS INCIDENTAL TO ITEM 152.

**REVISIONS**

NUMBER	BY	DATE

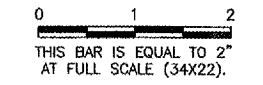

**LEGEND**

- X— EXISTING STORM SEWER
- ⊙ EXISTING MANHOLE
- EXISTING SLOPE BOX
- V— EXISTING HEADWALL/FLARED END SECTION
- UD— EXISTING UNDERDRAIN
- W— EXISTING WATER MAIN
- ⊗ EXISTING VALVE
- ⊕ EXISTING FIRE HYDRANT
- X— EXISTING FENCE
- ⊠ EXISTING BASE MOUNTED MITL
- E— EXISTING TAXIWAY KILO CIRCUIT IN 2" PVC
- ⊠ EXISTING TAXI GUIDANCE SIGN
- C— EXISTING CONDUIT/DUCT BANK
- EXISTING UNDERDRAIN CLEANOUT
- X EXISTING ITEM TO BE REMOVED
- ▨ NEW PAVEMENT (BY OTHERS)
- ⊕ EXISTING GATE
- A EXISTING ITEM TO BE ADJUSTED
- R EXISTING ITEM TO BE RECONSTRUCTED
- ▨ EXISTING 6" AVG. GRAVEL TO BE REMOVED
- ▨ EXISTING P.C.C. PAVEMENT TO BE REMOVED
- W— EXISTING CONTOUR

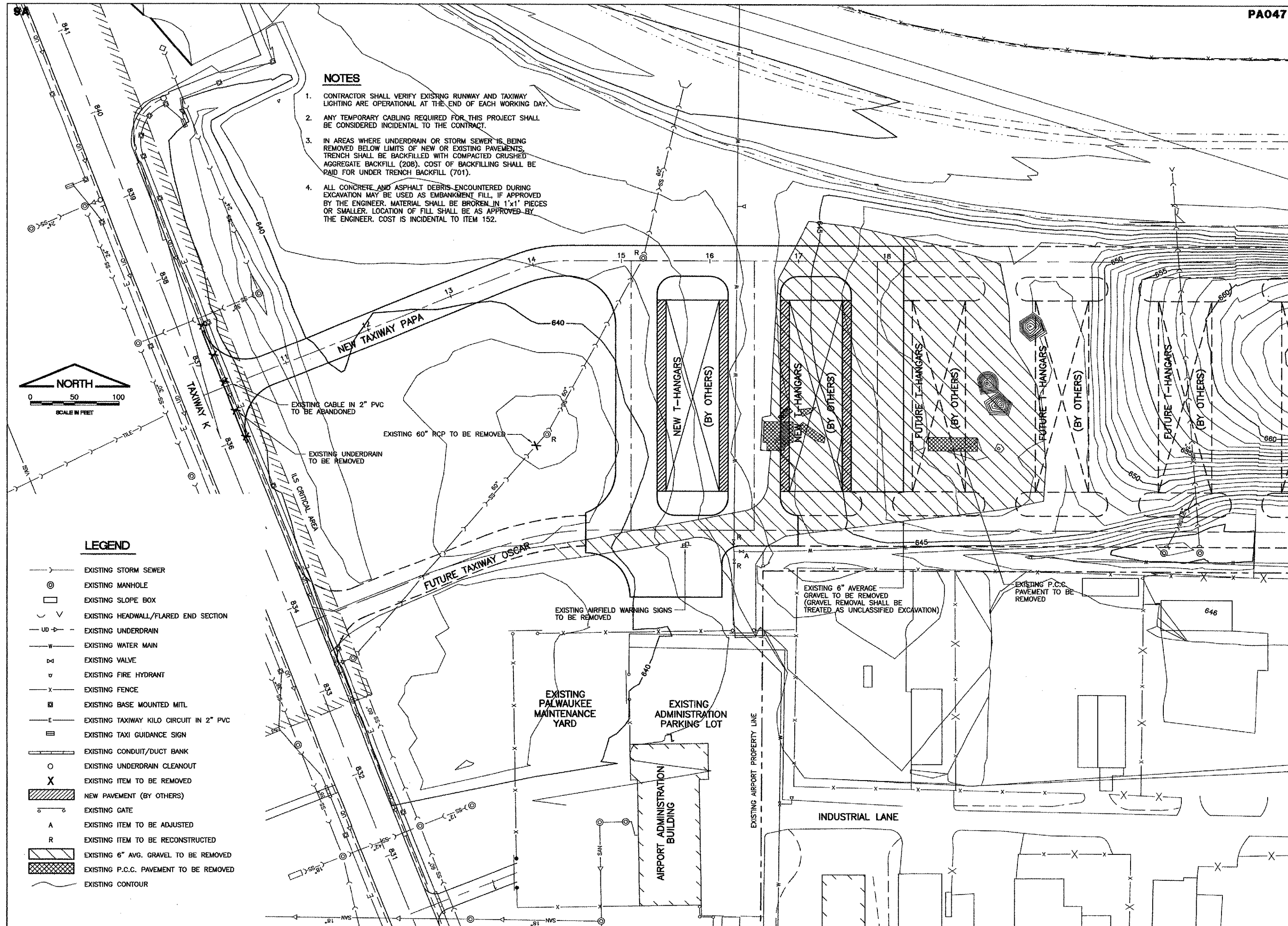

**PALWAUKEE MUNICIPAL AIRPORT  
WHEELING / PROSPECT HEIGHTS ILLINOIS**

**NORTHEAST QUADRANT SITEWORK**

**EXISTING CONDITIONS/PROPOSED REMOVALS  
NORTHEAST QUADRANT**

© Copyright CMT, Inc.

**CMT**  
CRAWFORD, MURPHY & TILLY, INC.  
CONSULTING ENGINEERS  
License No. 184-000613

DESIGN BY:	MJS
DRAWN BY:	JP
CHECKED BY:	MJS
APPROVED BY:	
DATE:	06/28/05
JOB No:	03290-02
ILLINOIS PROJECT:	PWK-3471