

UN043

K:\Campaign\030503\draw\sheet\FILE: 05\_Controls.dwg  
 LAYOUT: Layout1  
 UPDATE BY: odraghan  
 SURVEY BOOK #  
 DATE: Thu 6/16/05 2:00pm  
 XREF DWG: CMI\Base\EQPOL.dwg  
 C:\info.dwg  
 Exist\_Cond.dwg  
 baselines.dwg  
 tb.dwg  
 key.dwg

REVISIONS		
NUMBER	BY	DATE

0 1 2  
 THIS BAR IS EQUAL TO 2"  
 AT FULL SCALE (3/4X22).

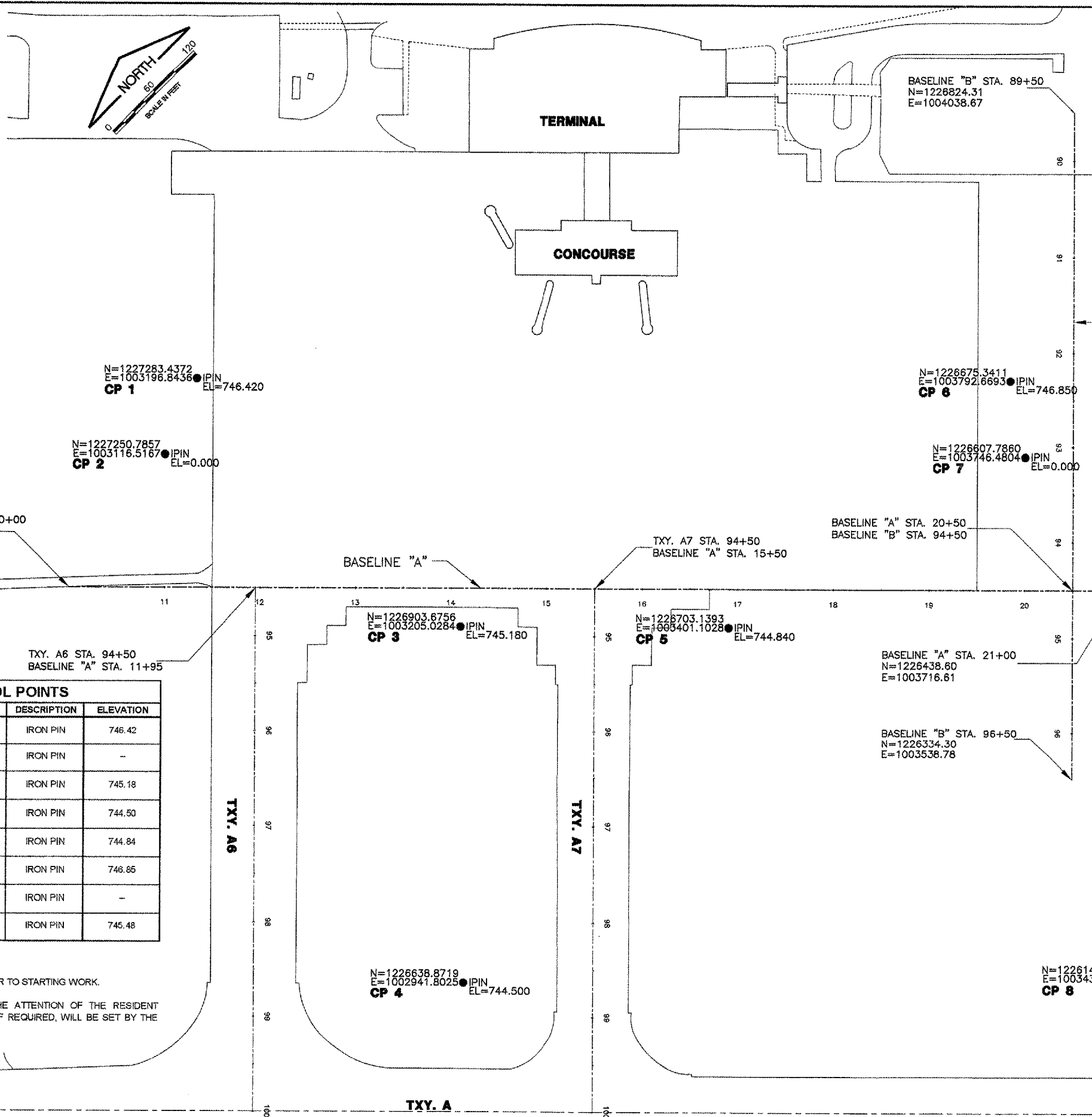
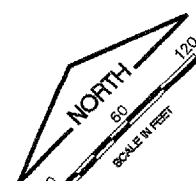
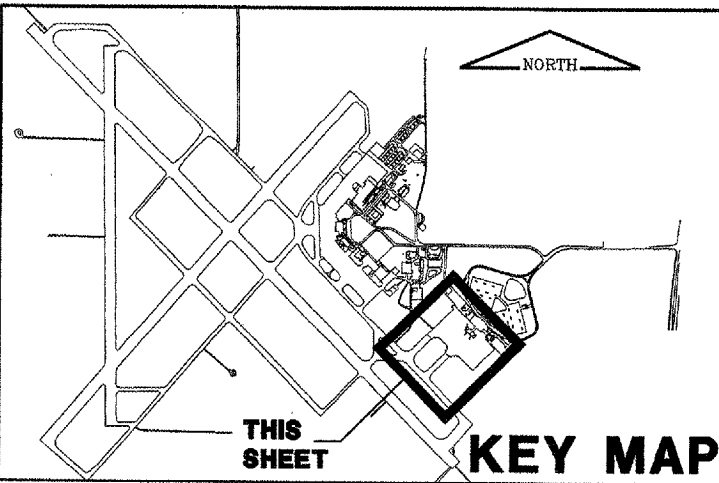

UNIVERSITY OF ILLINOIS  
 WILLARD AIRPORT  
 REHABILITATE AIR CARRIER RAMP  
 HORIZONTAL AND VERTICAL CONTROLS

SURVEY HORIZONTAL AND VERTICAL CONTROL POINTS					
DESIGNATION	LOCATION	NORTHING	EASTING	DESCRIPTION	ELEVATION
CP 1	BASELINE "A" STA. 11+32.84, 220.22' LT	1227283.44	1003196.84	IRON PIN	746.42
	BASELINE "B" STA. 92+29.78, 917.16' RT				
CP 2	BASELINE "A" STA. 10+99.92, 140.00' LT	1227250.79	1003116.52	IRON PIN	-
	BASELINE "B" STA. 93+10.00, 960.08' RT				
CP 3	BASELINE "A" STA. 14+09.76, 39.77' RT	1226903.68	1003205.03	IRON PIN	745.18
	BASELINE "B" STA. 94+89.77, 640.24' RT				
CP 4	BASELINE "A" STA. 14+14.61, 413.11' RT	1226638.87	1002941.80	IRON PIN	744.50
	BASELINE "B" STA. 98+63.11, 635.39' RT				
CP 5	BASELINE "A" STA. 16+90.23, 40.13' RT	1226703.14	1003401.10	IRON PIN	744.84
	BASELINE "B" STA. 94+90.13, 359.77' RT				
CP 6	BASELINE "A" STA. 19+84.18, 220.04' LT	1226675.34	1003792.67	IRON PIN	746.85
	BASELINE "B" STA. 92+29.96, 65.82' RT				
CP 7	BASELINE "A" STA. 20+00.09, 139.77' LT	1226607.79	1003746.48	IRON PIN	-
	BASELINE "B" STA. 93+10.23, 49.91' RT				
CP 8	BASELINE "A" STA. 21+17.02, 406.88' RT	1226141.64	1003437.97	IRON PIN	745.48
	BASELINE "B" STA. 98+56.86, 67.02' LT				

- NOTES:**
- CONTRACTOR TO VERIFY HORIZONTAL AND VERTICAL CONTROL POINTS PRIOR TO STARTING WORK.
  - DISCREPANCIES IN THE CONTROL POINTS ARE TO BE BROUGHT TO THE ATTENTION OF THE RESIDENT ENGINEER AS SOON AS THEY ARE DISCOVERED. NEW CONTROL POINTS, IF REQUIRED, WILL BE SET BY THE ENGINEER.

© Copyright CMT, Inc.

**CMT**  
 CRAWFORD, MURPHY & TILLY, INC.  
 CONSULTING ENGINEERS  
 License No. 184-00063

DESIGN BY:	CMT
DRAWN BY:	CMT
CHECKED BY:	SMS
APPROVED BY:	[Signature]
DATE:	06/10/2005
JOB No:	03059-03-00
IL PROJECT:	CMI-3449
A.J.P. PROJECT:	3-17-0016-22
SHEET	5 OF 58 SHEETS