

REVISIONS		
NUMBER	BY	DATE

0 1 2
 THIS BAR IS EQUAL TO 2"
 AT FULL SCALE (34X22).

**UNIVERSITY OF ILLINOIS
 WILLARD AIRPORT
 REHABILITATE AIR CARRIER RAMP
 CONSTRUCTION ACTIVITY PLAN
 PHASE 5 MARKING**

© Copyright CMT, Inc.
CMT
 CRAWFORD, MURPHY & TILLY, INC.
 CONSULTING ENGINEERS
 License No. 184-000613

DESIGN BY:	CMT
DRAWN BY:	CMT
CHECKED BY:	SMS
APPROVED BY:	<i>[Signature]</i>
DATE:	06/10/2005
JOB No:	03059-03-00
IL PROJECT:	CMI-3449
A.I.P. PROJECT:	3-17-0016-22
SHEET	17 OF 58 SHEETS

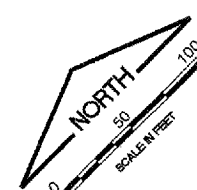
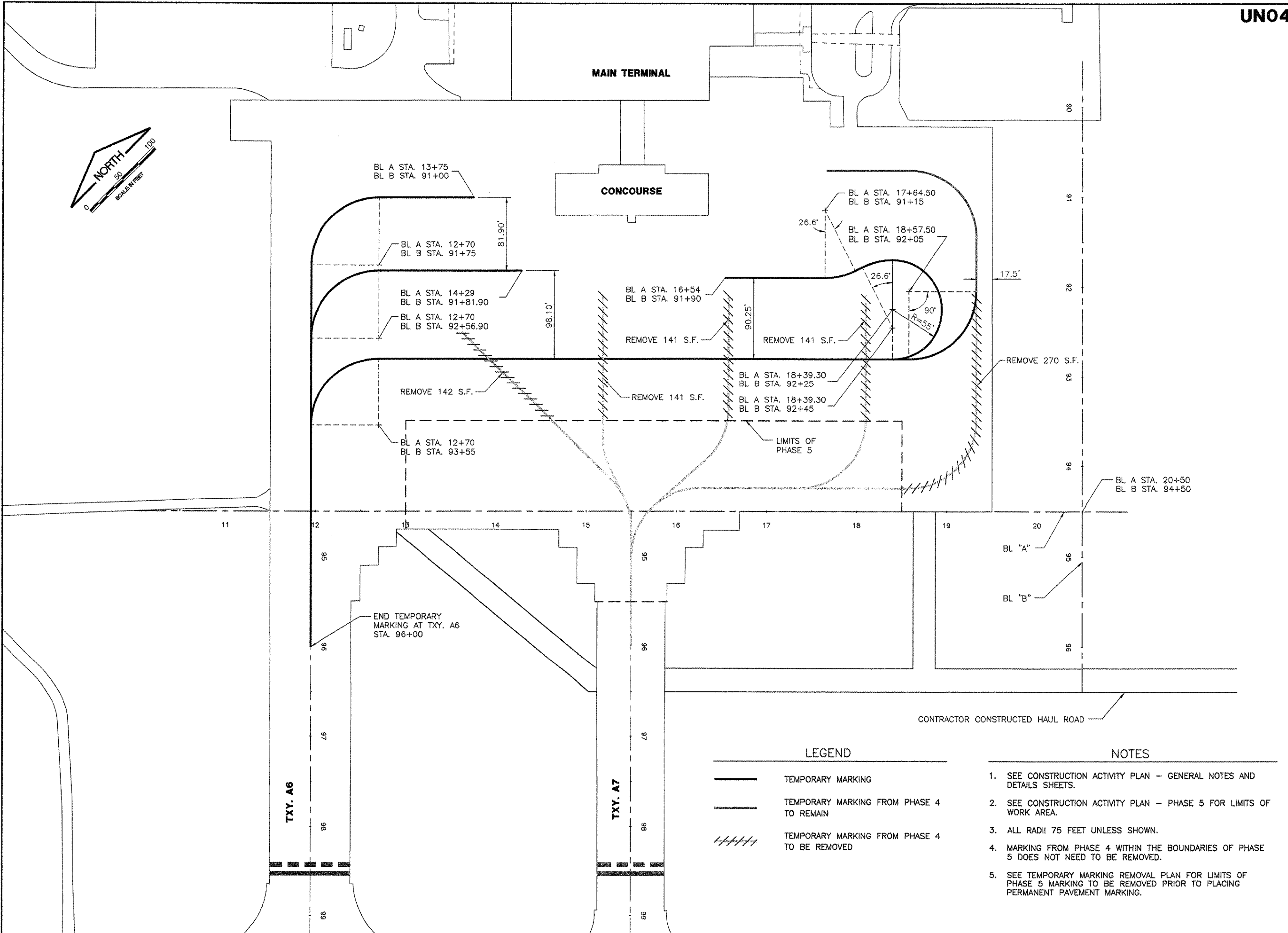

LEGEND

	TEMPORARY MARKING
	TEMPORARY MARKING FROM PHASE 4 TO REMAIN
	TEMPORARY MARKING FROM PHASE 4 TO BE REMOVED

- NOTES**
- SEE CONSTRUCTION ACTIVITY PLAN - GENERAL NOTES AND DETAILS SHEETS.
 - SEE CONSTRUCTION ACTIVITY PLAN - PHASE 5 FOR LIMITS OF WORK AREA.
 - ALL RADII 75 FEET UNLESS SHOWN.
 - MARKING FROM PHASE 4 WITHIN THE BOUNDARIES OF PHASE 5 DOES NOT NEED TO BE REMOVED.
 - SEE TEMPORARY MARKING REMOVAL PLAN FOR LIMITS OF PHASE 5 MARKING TO BE REMOVED PRIOR TO PLACING PERMANENT PAVEMENT MARKING.