

IMAGE FILES:

UN043

K:\Champaign\0305603\draw\sheet\
FILE: 20\_EXCOND2.dwg
LAYOUT: Layout1
UPDATE BY: adraughan
SURVEY BOOK #
DATE: Mon 6/20/05 1:12pm
XREF DWG: CMBaseEPOEL.dwg
Cintinfo.dwg
Exist\_Cond.dwg
tb.dwg

LEGEND - PAVEMENT

- REMOVE 8" P.C.C. AND 4" ATPS, AR501908 AND AR302900
6" P.C.C. MILLING, AR800331
REMOVE 15" P.C.C. AND 4" ATPS, AR501915 AND AR502900
EXISTING SIDEWALK & CURB TO BE REMOVED, AR501690 AND AR800235
8" P.C.C. MILLING, AR800332
EXISTING SIDEWALK TO REMAIN

LEGEND

- STAKE MOUNTED TAXIWAY LIGHT
BASE MOUNTED TAXIWAY LIGHT
TAXI GUIDANCE SIGN
GROUND ROD
MANHOLE
APRON LIGHT
WATER VALVE
FIRE HYDRANT
EXISTING UNDERDRAIN
EXISTING FENCE
TEMPORARY FENCE
EXISTING ELEC. CABLE
ITEM TO BE REMOVED
ITEM TO BE ADJUSTED
ITEM TO BE REPLACED

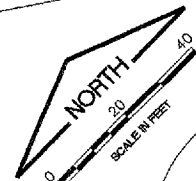

Table with 3 columns: NUMBER, BY, DATE. It is currently empty.

0 1 2
THIS BAR IS EQUAL TO 2" AT FULL SCALE (34X22).

AR162908 REMOVE ELECTRIC GATE
PAVEMENT REMOVAL FOR ELECTRIC GATE. SEE ELECTRIC GATE DETAILS SHEET 2.

MAIN TERMINAL

WATER

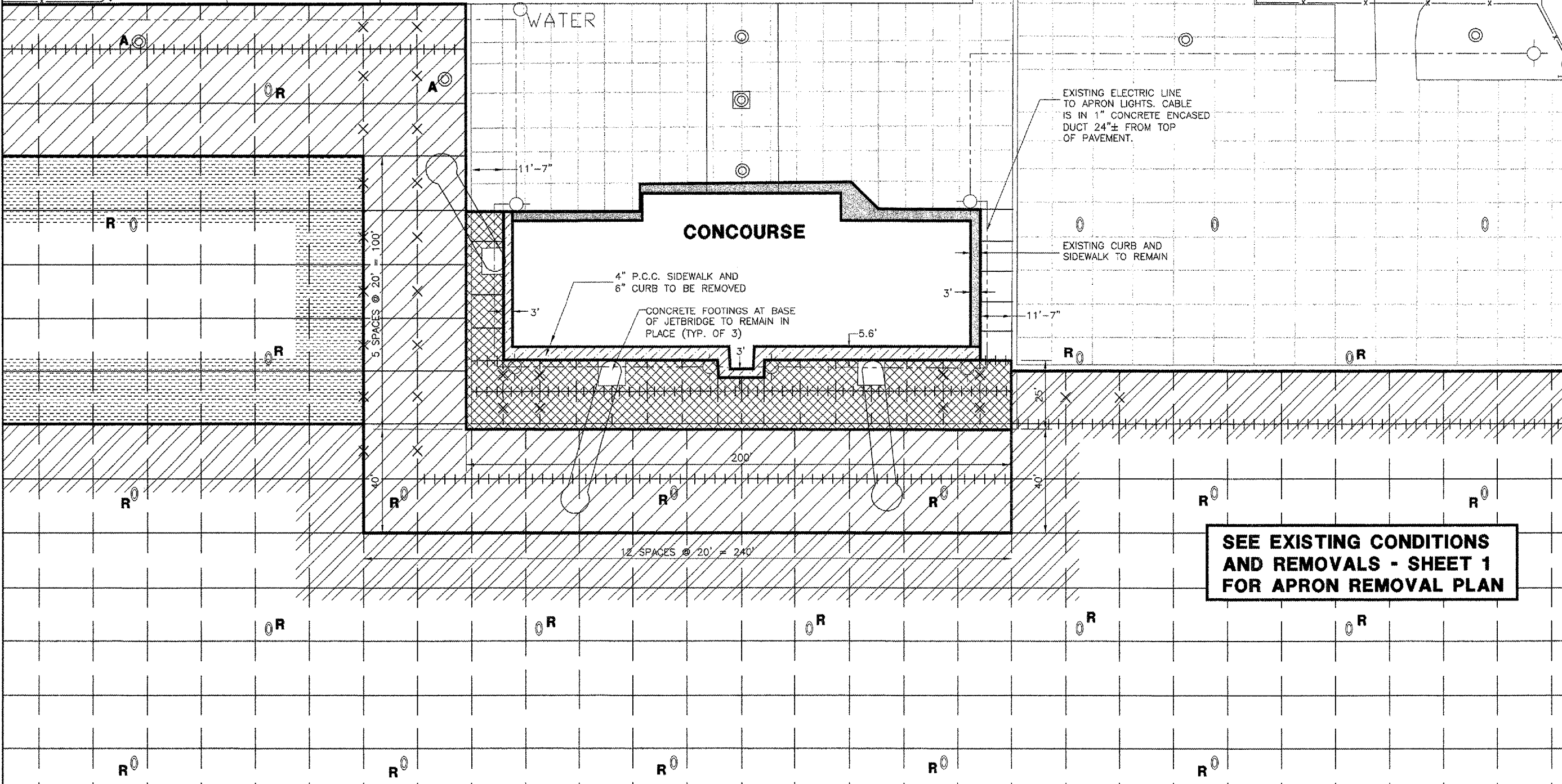

SEE EXISTING CONDITIONS AND REMOVALS - SHEET 1 FOR APRON REMOVAL PLAN

UNIVERSITY OF ILLINOIS WILLARD AIRPORT

REHABILITATE AIR CARRIER RAMP
EXISTING CONDITIONS AND REMOVALS 2
AREA AROUND TERMINAL

GMT
CRAWFORD, MERRY & TILLY, INC.
CONSULTING ENGINEERS
License No. 04-006810

DESIGN BY: SMS
DRAWN BY: CMT
CHECKED BY: SMS
APPROVED BY: [Signature]
DATE: 06/10/2005
JOB No: 03059-03-00
IL PROJECT: CMI-3449
A.I.P. PROJECT: 3-17-0016-22
SHEET 20 OF 58 SHEETS