

UN043

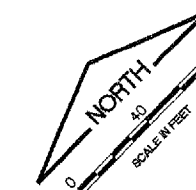

K:\Champaign\0305903\draw\sheet\ UN043.dwg  
FILE: 24\_ProjImp-Apron.dwg  
LAYOUT: Layout1  
UPDATE BY: adroughan  
SURVEY BOOK #  
DATE: Thu 6/16/05 2:28pm  
XREF DWG: CMIbaseEPOEL.dwg  
Cintinfo.dwg  
tb.dwg  
baselines.dwg

### MAIN TERMINAL

#### NOTES:

1. SEE STAKING PLANS FOR LIMITS OF BUTT JOINT CONSTRUCTION.
2. EXISTING CURB AND SIDEWALK NOT SCHEDULED FOR REMOVAL TO BE PROTECTED FROM DAMAGE.

#### REVISIONS

NUMBER	BY	DATE

0 1 2  
THIS BAR IS EQUAL TO 2' AT FULL SCALE (34X22).

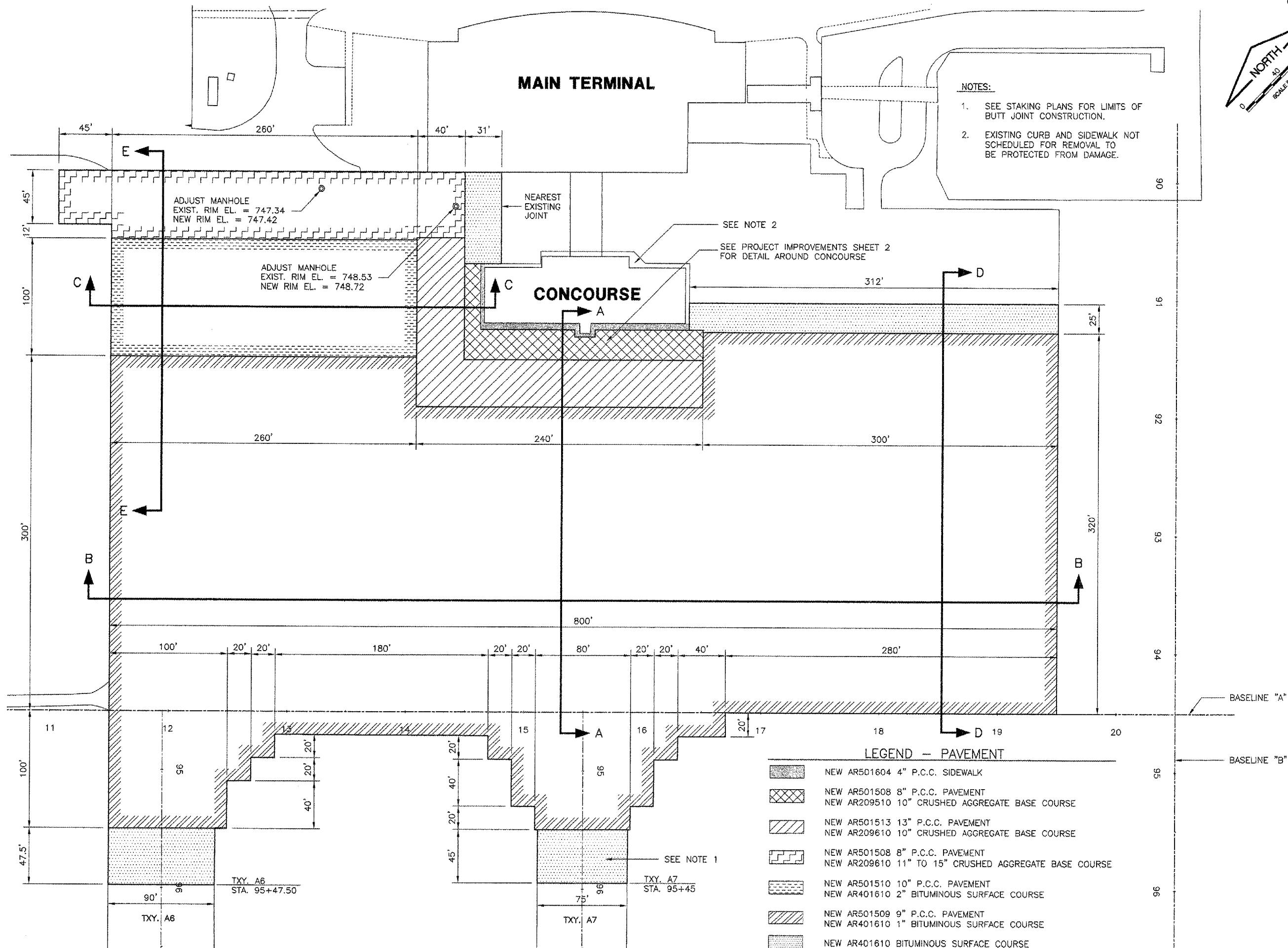

#### LEGEND - PAVEMENT

	NEW AR501604 4" P.C.C. SIDEWALK
	NEW AR501508 8" P.C.C. PAVEMENT
	NEW AR209510 10" CRUSHED AGGREGATE BASE COURSE
	NEW AR501513 13" P.C.C. PAVEMENT
	NEW AR209610 10" CRUSHED AGGREGATE BASE COURSE
	NEW AR501508 8" P.C.C. PAVEMENT
	NEW AR209610 11" TO 15" CRUSHED AGGREGATE BASE COURSE
	NEW AR501510 10" P.C.C. PAVEMENT
	NEW AR401610 2" BITUMINOUS SURFACE COURSE
	NEW AR501509 9" P.C.C. PAVEMENT
	NEW AR401610 1" BITUMINOUS SURFACE COURSE
	NEW AR401610 BITUMINOUS SURFACE COURSE

**UNIVERSITY OF ILLINOIS  
WILLARD AIRPORT**

**REHABILITATE AIR CARRIER RAMP**

**PROJECT IMPROVEMENTS 1**

**AIR CARRIER APRON**

© Copyright CMT, Inc.  
**CMT**  
CRAWFORD, MURPHY & TELY, INC.  
CONSULTING ENGINEERS  
License No. 84-00618

DESIGN BY:	SMS
DRAWN BY:	CMT
CHECKED BY:	SMS
APPROVED BY:	<i>[Signature]</i>
DATE:	06/10/2005
JOB No:	03059-03-00
IL PROJECT:	CM-3449
A.I.P. PROJECT:	3-17-0016-22
SHEET	24 OF 58 SHEETS