

STATE OF ILLINOIS  
DEPARTMENT OF TRANSPORTATION

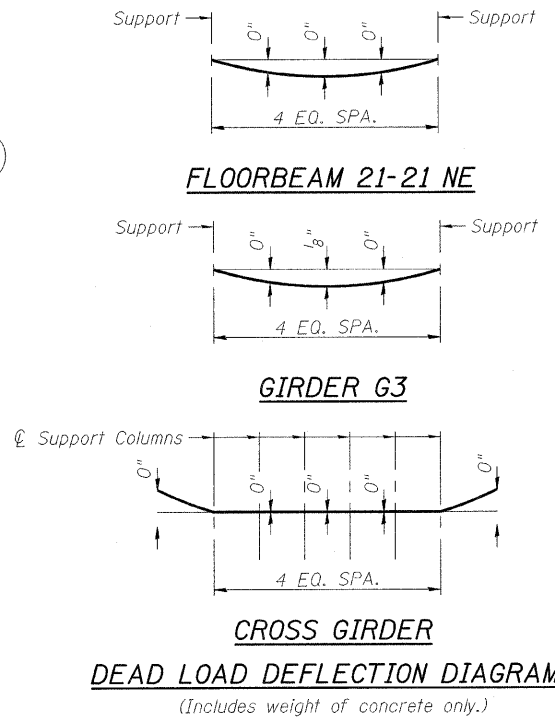

PLAN

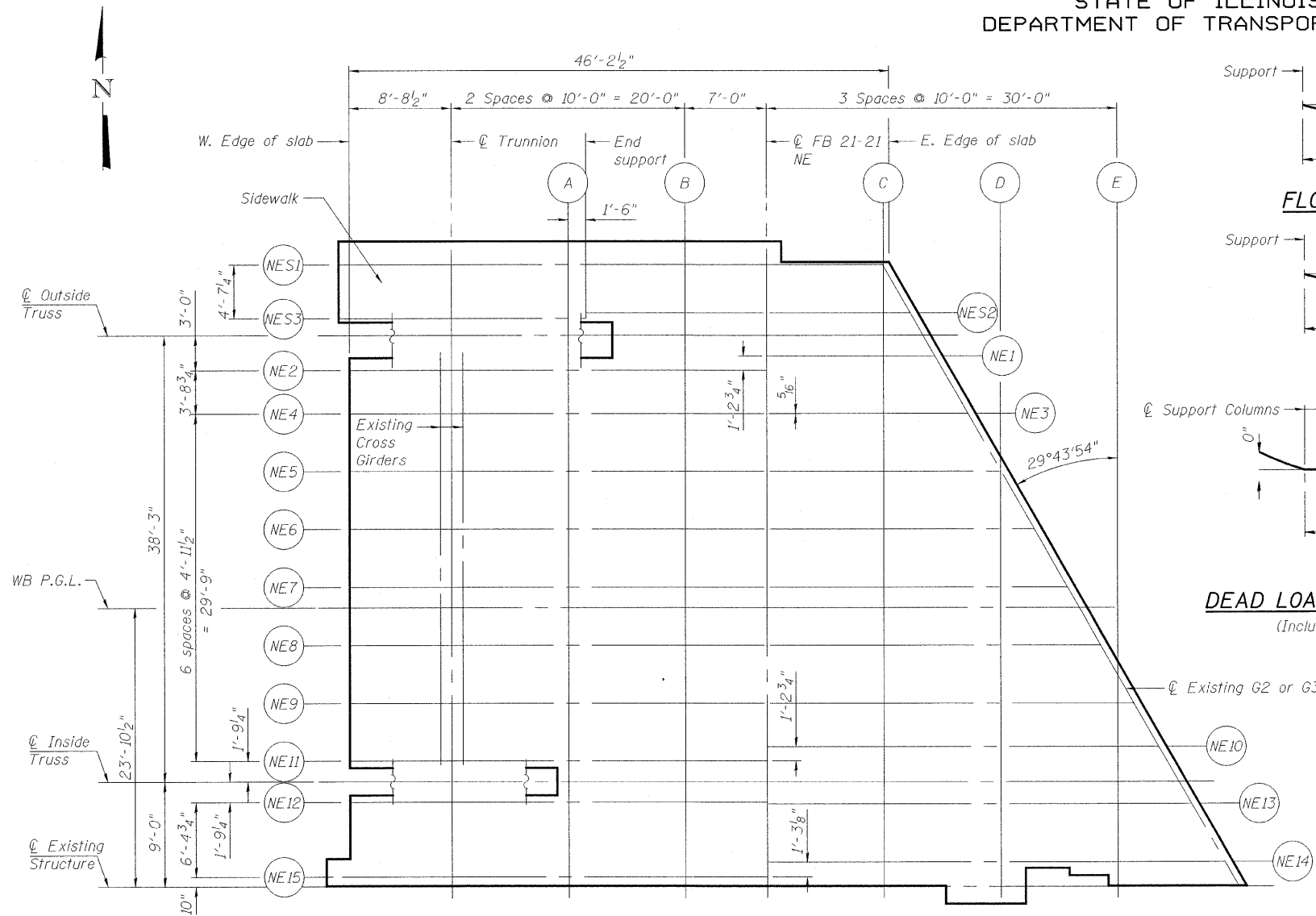
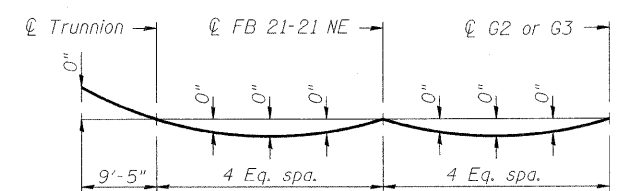

TYP. STRINGERS  
DEAD LOAD DEFLECTION DIAGRAM  
(Includes weight of concrete only.)

Note:  
The above deflections are not to be used in the field if the engineer is working from the theoretical grade elevations adjusted for dead load deflections as shown on the right and on sheets 15 and 16 of 163.

STRINGER NES1

Location	Station	Offset	Theoretical Grade Elevations	Theoretical Grade Elevations Adjusted For Dead Load Deflection
W. Edge of slab	381+65.93	-53.01	33.06	33.06
@ Trunnion	381+75.59	-53.02	32.98	32.98
A	381+85.59	-53.03	32.88	32.88
B	381+95.59	-53.05	32.77	32.77
@ FB 21-21	382+02.59	-53.06	32.69	32.69
@ Existing G3	382+12.51	-53.07	32.55	32.55
E. Edge of slab	382+13.18	-53.07	32.54	32.54

STRINGER NES2

Location	Station	Offset	Theoretical Grade Elevations	Theoretical Grade Elevations Adjusted For Dead Load Deflection
End support B	381+87.09	-48.91	32.91	32.91
@ FB 21-21	382+02.59	-48.93	32.70	32.70
@ Existing G6	382+14.87	-48.95	32.52	32.52
E. Edge of slab	382+15.54	-48.95	32.51	32.51

STRINGER NES3

Location	Station	Offset	Theoretical Grade Elevations	Theoretical Grade Elevations Adjusted For Dead Load Deflection
W. Edge of slab	381+65.94	-48.40	33.17	33.17
@ Trunnion	381+75.59	-48.42	33.04	33.04
A	381+85.59	-48.43	32.93	32.93
B	381+95.59	-48.43	32.92	32.92

STRINGER NE1

Location	Station	Offset	Theoretical Grade Elevations	Theoretical Grade Elevations Adjusted For Dead Load Deflection
@ FB 21-21	382+02.60	-45.25	32.01	32.01
C	382+12.60	-45.26	31.95	31.95
@ Existing G3	382+16.98	-45.27	31.93	31.93
E. Edge of slab	382+17.66	-45.27	31.92	31.92

TOP OF SLAB ELEVATIONS  
NORTHEAST FIXED SPANS  
STRUCTURE NO. 016-2445

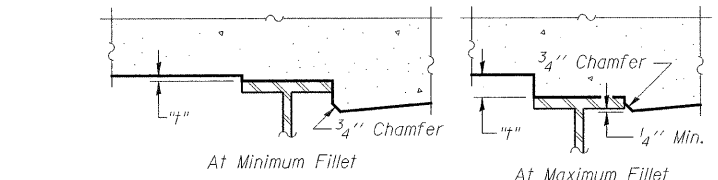

FILLET HEIGHTS

To determine "t": After all structural steel has been erected, elevations of the top flanges of the beams shall be taken at intervals shown above. These elevations subtracted from the "Theoretical Grade Elevations Adjusted for Dead Load Deflection" shown in the tables, minus slab thickness, equals the fillet heights "t" above top flange of beams.

DESIGNED	A. HAMMAD
CHECKED	J. GRAINAWI
DRAWN	D. C. PATEL
CHECKED	A. HAMMAD

**PB Americas, Inc.**  
230 WEST MONROE STREET,  
SUITE 900  
CHICAGO, IL. 60606

SHEET NO. 14	F.A.P RTE. 389	SECTION 2424.2B-R	COUNTY COOK	TOTAL SHEETS 398	SHEET NO. 95
163 SHEETS	FED. ROAD DIST. NO. 7 ILLINOIS		FED. AID PROJECT CONTRACT NO. 60D61		

T:\16849A\Structural\Cadd\Pre-final\EB\_Plans\0162445-60D61-TSE-014.dgn  
07-MAY-2009