

STATE OF ILLINOIS
DEPARTMENT OF TRANSPORTATION

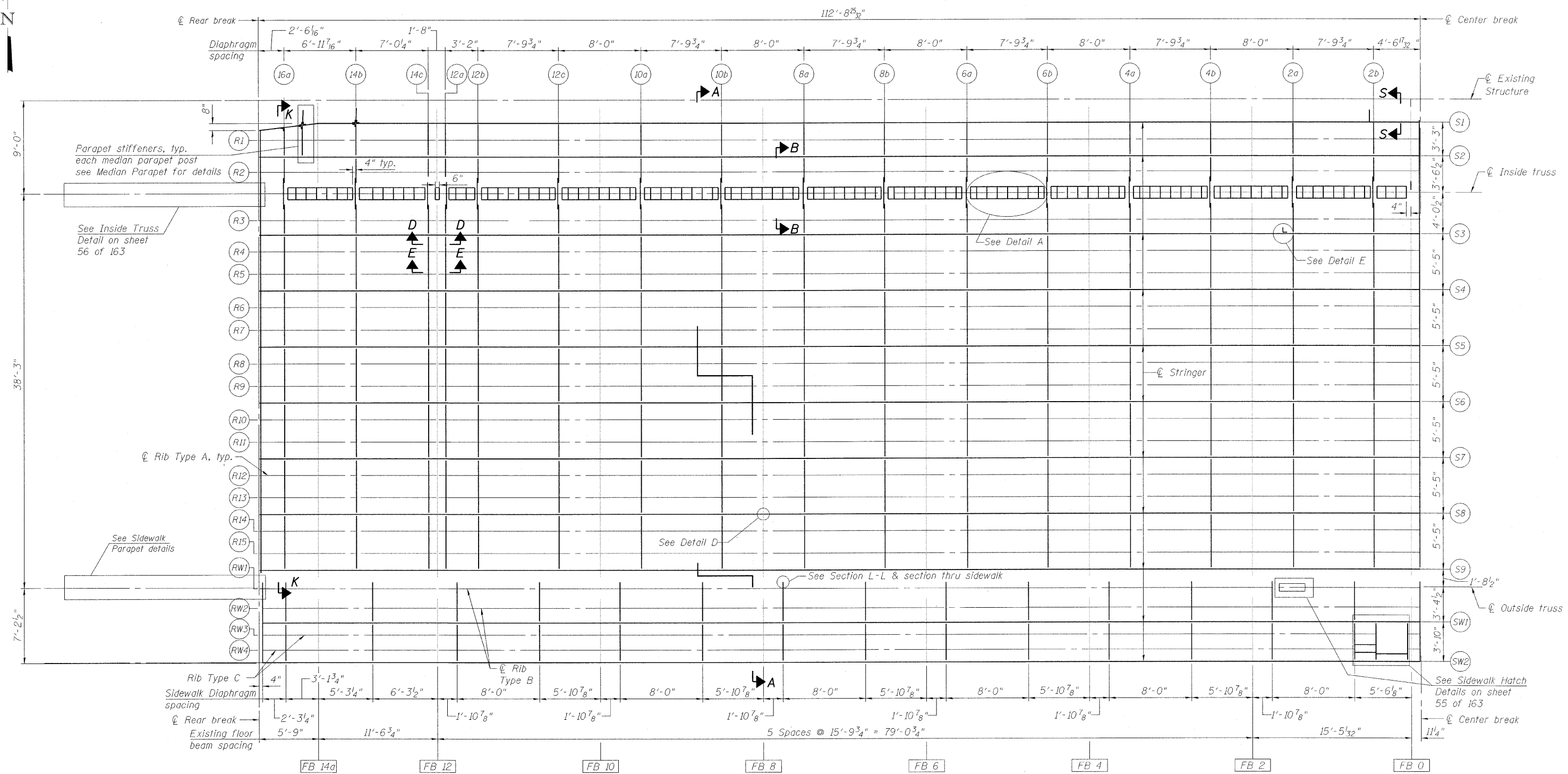

ORTHOTROPIC FRAMING PLAN SOUTHWEST LEAF
(Stiffeners and Parapet bracing not shown for clarity)

DESIGNED	P. PILARSKI
CHECKED	J. GRAINAWI
DRAWN	D. C. PATEL
CHECKED	A. HAMMAD

LEGEND

- Existing member
- New member

Notes:
Dimension to diaphragms are to back of channel or back face of plate diaphragm.
For Sections A-A & B-B see sheet 48 of 163.
For Sections D-D & E-E and Detail D see sheet 53 of 163.
For Detail E and Section S-S see sheet 54 of 163.
For Section K-K see sheet 59 of 163.

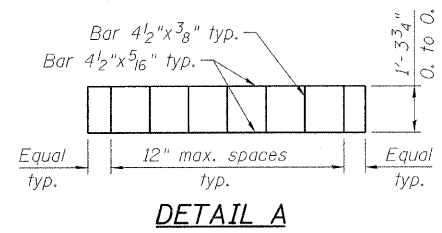

**DECK FRAMING PLAN
SOUTHWEST MOVABLE SPAN
STRUCTURE NO. 016-2445**

SHEET NO. 49 163 SHEETS	F.A.P RTE.	SECTION	COUNTY	TOTAL SHEETS	SHEET NO.
	389	2424.2B-R	COOK	398	130
FED. ROAD DIST. NO. 7 ILLINOIS			FED. AID PROJECT		
CONTRACT NO. 60D61					

PB Americas, Inc.
230 WEST MONROE STREET,
SUITE 900
CHICAGO, IL. 60606

T:\16843A\Structural\Cadd\Pre-Final\EB_Plans\0162445-60D61-SUP-049.dgn 07-MAY-2009