

- LEGEND**
- EXISTING INLET
 - EXISTING CATCH BASIN
 - ⊙ EXISTING MANHOLE
 - E ELECTRIC
 - W WATER
 - CE COM ED (ADJUSTMENTS PERFORMED BY OTHERS)
 - Ⓐ VALVE VAULTS TO BE ADJUSTED
 - T TELEPHONE (ADJUSTMENTS PERFORMED BY OTHERS)
 - G GAS
 - Ⓢ FRAMES AND LIDS TO BE ADJUSTED, SPECIAL
 - Ⓐ FRAMES AND LIDS TO BE ADJUSTED
 - Ⓡ DRAINAGE STRUCTURES TO BE RECONSTRUCTED

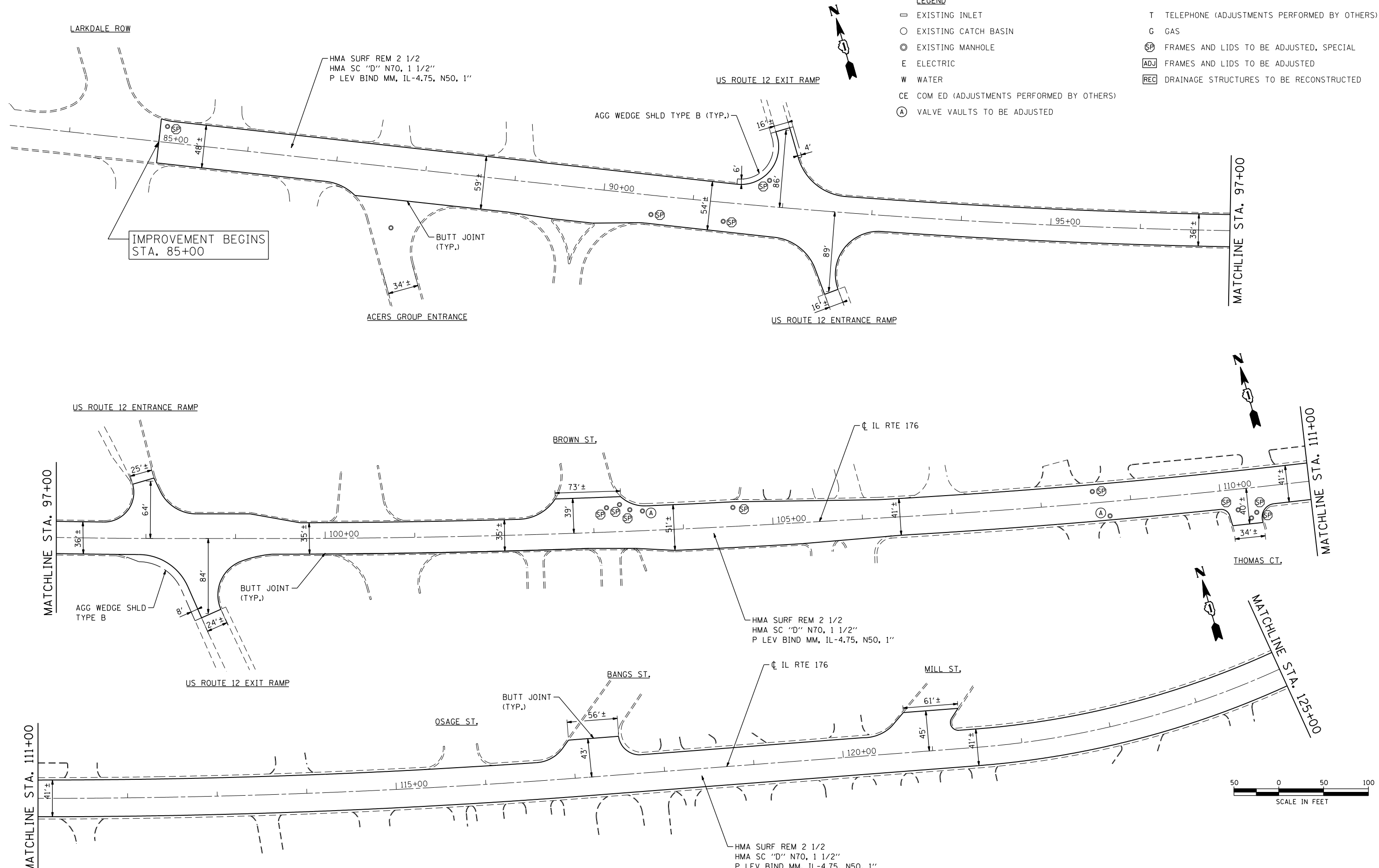

COMPANY NAME: #COMPANY_NAME
 PROJECT CONTACT: #PROJECT_CONTACT
 DATE PLOTTED: 6/9/2014 8:50:23 AM
 FILE NAME: 86100196.08-plan-01.dgn
 PLOT DRIVER: pdfcut
 PEN TABLE: standard-trans.tbl



USER NAME = bhartma	DESIGNED - B. HARTMAN	REVISED -
PLOT SCALE = 1" = 50'	DRAWN -	REVISED -
PLOT DATE = 6/9/2014	CHECKED - T. HAMILTON	REVISED -
	DATE - 6/9/14	REVISED -

**STATE OF ILLINOIS
 DEPARTMENT OF TRANSPORTATION**

**ROADWAY PLAN
 ILLINOIS ROUTE 176 (US ROUTE 12 TO HILLTOP TER.)**

SCALE: 1" = 50' SHEET NO. 1 OF 9 SHEETS STA. BEGIN TO STA. 125+00

F.A. RTE. 335	SECTION 145X-RS-2	COUNTY LAKE	TOTAL SHEETS 44	SHEET NO. 8
FED. ROAD DIST. NO. ILLINOIS FED. AID PROJECT			CONTRACT NO. 60N62	