

MATCHLINE STA. 335+00

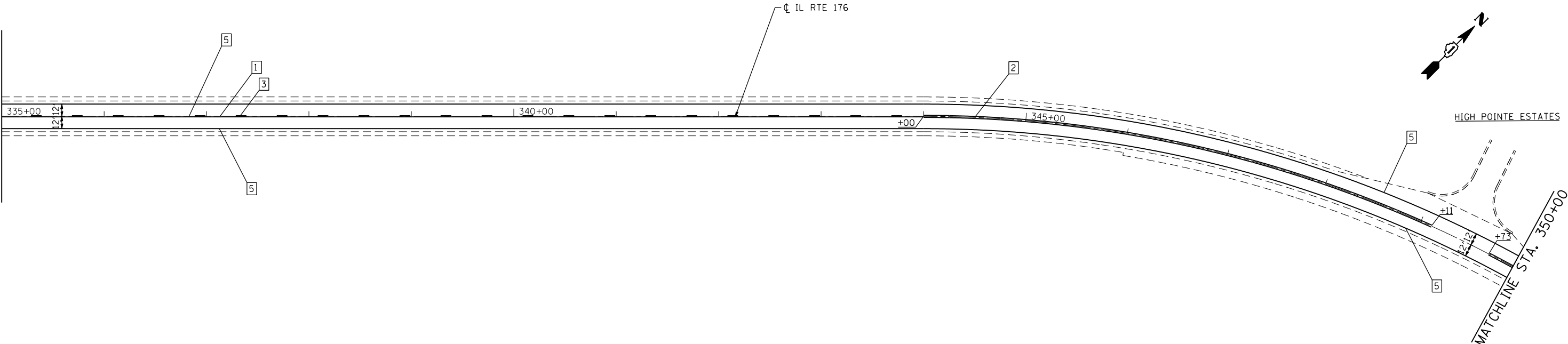

MATCHLINE STA. 350+00

MATCHLINE STA. 350+00

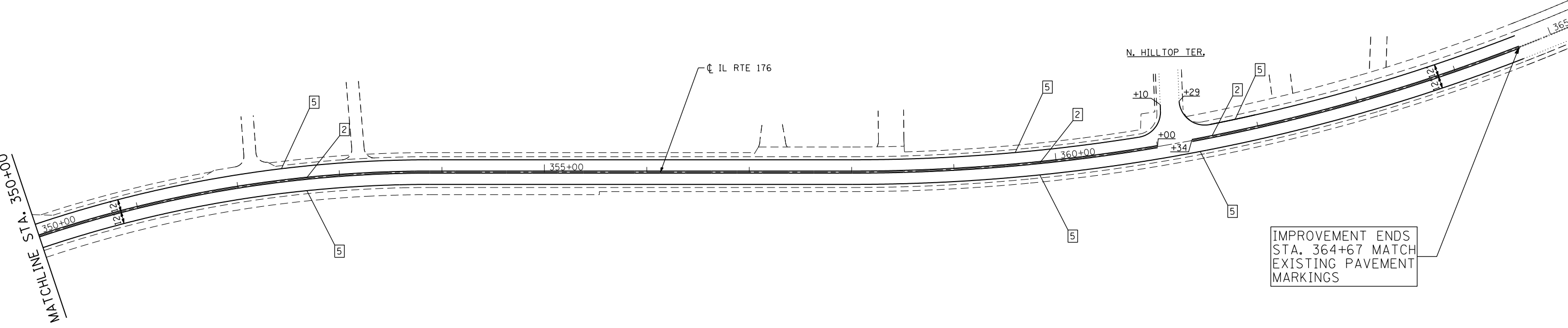

LEGEND	
1	LINE 4" (YELLOW SOLID LINE)
2	LINE 4" (DOUBLE YELLOW SOLID LINES)
3	LINE 4" (YELLOW - 10' DASH, 30' SKIP)
4	LINE 4" (WHITE LANE LINE - 10' DASH, 30' SKIP)
5	LINE 4" (WHITE SOLID LINE)
6	LINE 6" (WHITE SOLID LINE)
7	LINE 6" (WHITE LANE LINE - 2' DASH, DASH, 6' SKIP)
8	LINE 8" (WHITE SOLID LINE)
9	LINE 12" (WHITE SOLID LINE)
10	LINE 12" (WHITE DIAGONAL LINE)
11	LINE 12" (YELLOW DIAGONAL LINE)
12	LINE 24" (WHITE STOP BAR)
13	LETTERS AND SYMBOLS (TYP.)

NOTES:

- ALL PAVEMENT MARKINGS SHALL BE THERMOPLASTIC UNLESS OTHERWISE SPECIFIED.
- RAISED REFLECTIVE PAVEMENT MARKERS SHALL BE USED THROUGHOUT THE PROJECT LIMITS. SEE DISTRICT DETAIL TC-11.

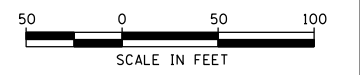

COMPANY NAME: #COMPANY_NAME
 PROJECT CONTACT: #PROJECT_CONTACT
 DATE PLOTTED: 6/9/2014 8:51:58 AM
 FILE NAME: 86100196.08-pm-09.dgn
 PLOT DRIVER: pdfcut
 PEN TABLE: standard-trans.tbl



USER NAME = bhartma	DESIGNED - B. HARTMAN	REVISED -
PLOT SCALE = 1" = 50'	DRAWN -	REVISED -
PLOT DATE = 6/9/2014	CHECKED - T. HAMILTON	REVISED -
	DATE - 6/9/14	REVISED -

**STATE OF ILLINOIS
 DEPARTMENT OF TRANSPORTATION**

**PAVEMENT MARKING PLAN
 ILLINOIS ROUTE 176 (US ROUTE 12 TO HILLTOP TER.)**

SCALE: 1" = 50' SHEET NO. 9 OF 9 SHEETS STA. 335+00 TO STA. END

F.A. RTE.	SECTION	COUNTY	TOTAL SHEETS	SHEET NO.
335	145X-RS-2	LAKE	44	25
FED. ROAD DIST. NO.			ILLINOIS FED. AID PROJECT	
			CONTRACT NO.	60N62