

PRE-STAGE 2D

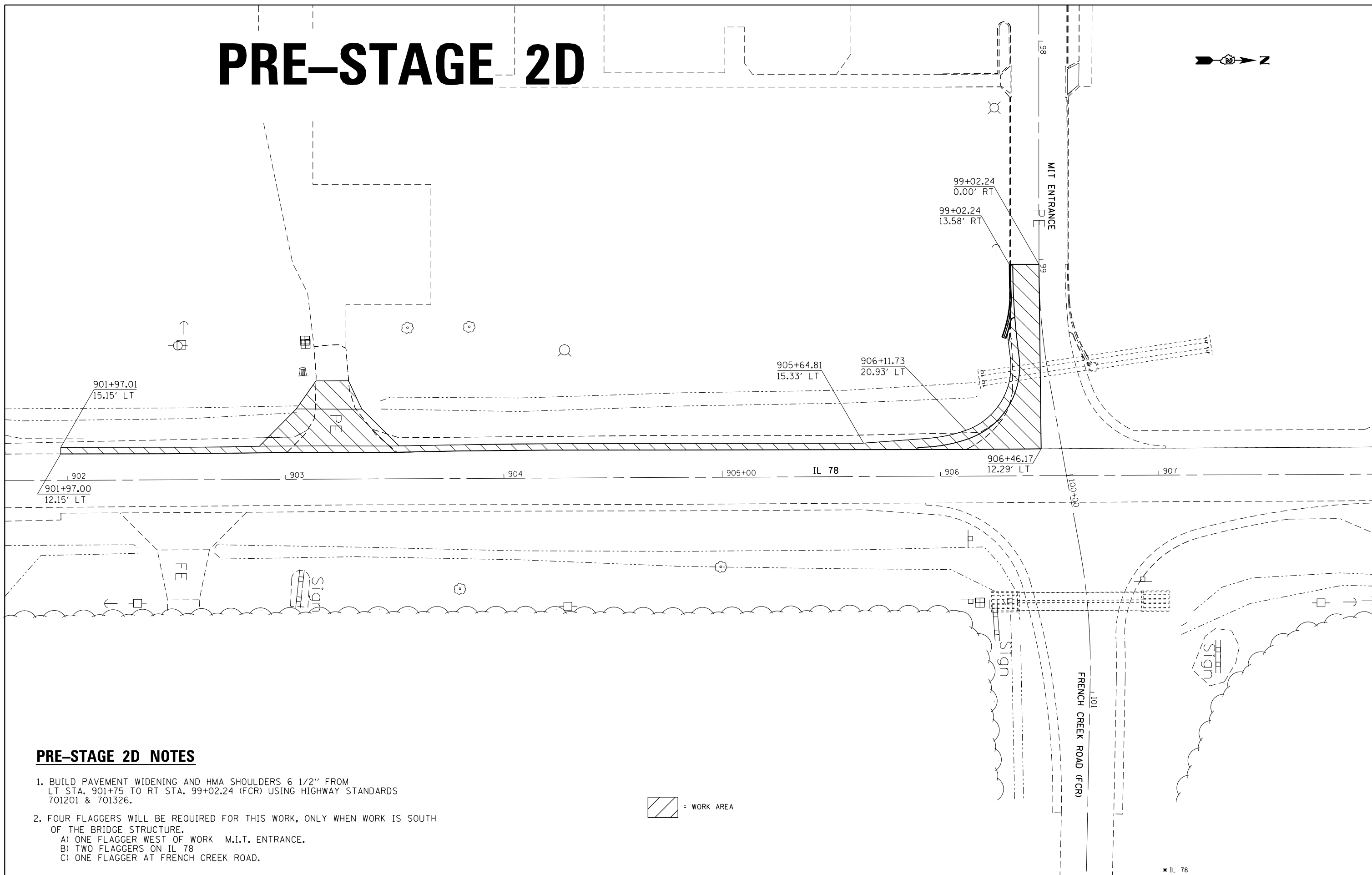

PRE-STAGE 2D NOTES

1. BUILD PAVEMENT WIDENING AND HMA SHOULDERS 6 1/2" FROM LT STA. 901+75 TO RT STA. 99+02.24 (FCR) USING HIGHWAY STANDARDS 701201 & 701326.
2. FOUR FLAGGERS WILL BE REQUIRED FOR THIS WORK, ONLY WHEN WORK IS SOUTH OF THE BRIDGE STRUCTURE.
 - A) ONE FLAGGER WEST OF WORK M.I.T. ENTRANCE.
 - B) TWO FLAGGERS ON IL 78
 - C) ONE FLAGGER AT FRENCH CREEK ROAD.

= WORK AREA

FILE NAME =	USER NAME = Fasslermj	DESIGNED -	REVISD -
ca:\pw_work\pwidot\fasslermj\d0149594\0208209-shit-staging.dgn		DRAWN -	REVISD -
PLOT SCALE = 40.0000' / in.		CHECKED -	REVISD -
PLOT DATE = Fri Jun 13 11:36:49 2014		DATE -	REVISD -

**STATE OF ILLINOIS
DEPARTMENT OF TRANSPORTATION**

IL 78 STAGING DETAILS		
PRE-STAGE 2D		
SCALE: 20' / IN.	SHEET NO. 8 OF 14 SHEETS	STA. 903+00 TO STA. 909+00

* IL 78	F.A.P. RTE. #22	SECTION 15BR-1	COUNTY WHITESIDE	TOTAL SHEETS 146	SHEET NO. 47
	CONTRACT NO. 64E19			ILLINOIS FED. AID PROJECT	