

Notes:
 See sheets S-10 and S-11 for superstructure details and Bill of Material.
 See sheet S-11 for parapet reinforcement, Section A-A, Section B-B, and Cross Section.

* Order $a_1(E)$ and $a_3(E)$ bars full length. Cut to fit skew and use remainder of bars in opposite end.

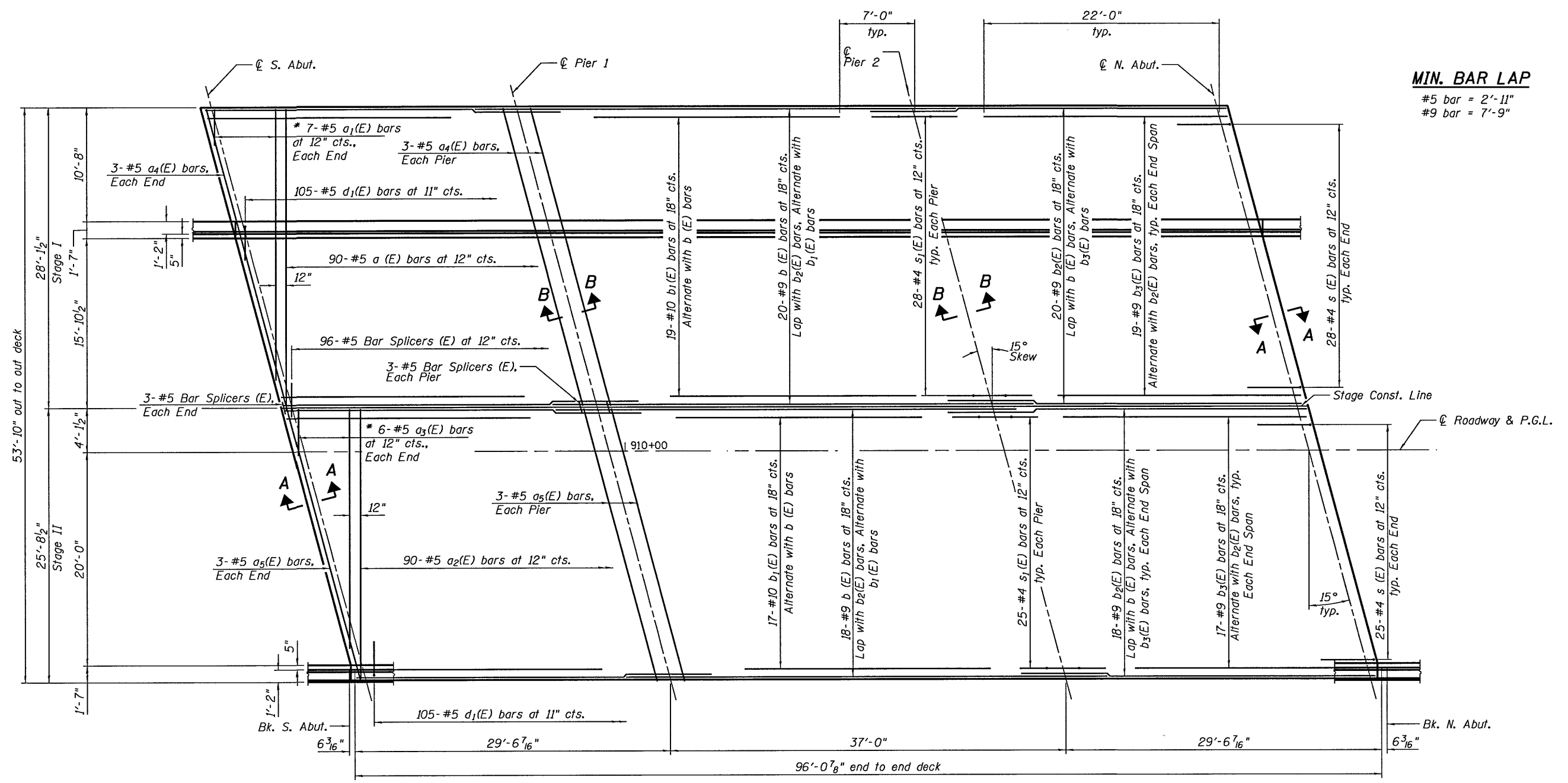

MIN. BAR LAP
 #5 bar = 2'-11"
 #9 bar = 7'-9"

BOTTOM OF SLAB PLAN

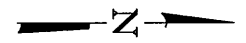

COMPANY NAME: HR GREEN, INC.
 PROJECT CONTACT: KEVIN J BRENNAN
 DATE PLOTTED: 9/17/2012 3:24:28 PM
 FILE NAME: 080018-64F19-008-508-SBR.dgn
 PLOT DRIVER: pdf_bw_no_level.ctb
 PEN TABLE: Illinois.hart.tbl

HRGreen
 HRGreen.com
 Illinois Professional Design Firm
 # 184-001322

USER NAME =	DESIGNED - MGH	REVISED
	CHECKED - KJB	REVISED
PLOT SCALE =	DRAWN - WJH	REVISED
PLOT DATE =	CHECKED - KJB	REVISED

STATE OF ILLINOIS
DEPARTMENT OF TRANSPORTATION

SUPERSTRUCTURE PLAN - BOTTOM REINFORCEMENT
STRUCTURE NO. 098-0118
 SHEET NO. 5-8 OF 5-23 SHEETS

F.A.P. RTE. 22	SECTION 15BR-1	COUNTY WHITESIDE	TOTAL SHEETS 146	SHEET NO. 66
CONTRACT NO. 64F19				
ILLINOIS FED. AID PROJECT				