

STATE OF ILLINOIS
DEPARTMENT OF TRANSPORTATION
DIVISION OF HIGHWAYS
**PROPOSED
HIGHWAY PLANS**
F.A.I. ROUTE 57 (I-57)
SECTION (38-3)RS-2

F.A.I. RTE.	SECTION	COUNTY	TOTAL SHEETS	SHEET NO.
57	(38-3)RS-2	IROQUOIS	186	1
FED. ROAD DIST. NO.	ILLINOIS	CONTRACT NO. 66C53		

INDEX OF SHEETS

- 1 COVER SHEET
- 2 HIGHWAY STANDARDS & GENERAL NOTES
- 3 - 9 SUMMARY OF QUANTITIES
- 10 - 11 TYPICAL SECTIONS
- 12 - 16 SCHEDULE OF QUANTITIES
- 17 - 22 ALIGNMENT, TIES & BENCHMARKS
- 23 - 37 PLAN & PROFILE SHEETS
- 38 - 43 STAGING & TRAFFIC CONTROL DETAILS
- 44 - 48 DETAILS
- 49 - 127 CROSS SECTIONS - MAINLINE
- 128 - 143 CROSS SECTIONS - RAMP A
- 144 - 157 CROSS SECTIONS - RAMP B
- 158 - 171 CROSS SECTIONS - RAMP C
- 172 - 186 CROSS SECTIONS - RAMP D

P-93-050-05
D-93-012-13



FOR HIGHWAY STANDARDS SEE SHEET NO. 2

IROQUOIS COUNTY
C - 93 - 010 - 13
HMA SURFACE REMOVAL WITH 5 1/2" RESURFACING



MICROFILMED _____
REEL NUMBER _____
AWARDED _____
RESIDENT ENGINEER _____
AS BUILT CHANGES WERE MADE
ON THE FOLLOWING SHEETS _____

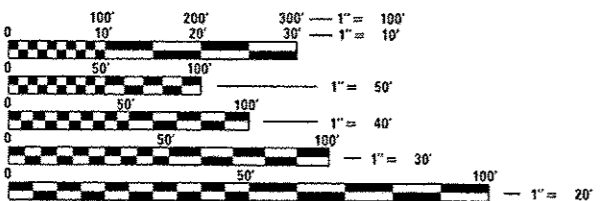

FULL SIZE PLANS HAVE BEEN PREPARED USING STANDARD ENGINEERING SCALES. REDUCED SIZED PLANS WILL NOT CONFORM TO STANDARD SCALES. IN MAKING MEASUREMENTS ON REDUCED PLANS, THE ABOVE SCALES MAY BE USED.

J.U.L.I.E.
JOINT UTILITY LOCATION INFORMATION FOR EXCAVATION
1-800-892-0123
OR 811

DISTRICT 3 NO. (815) 434-6131

PROJECT ENGINEER: CRAIG REED, P.E.
UNIT CHIEF: BRAD DUNCAN, P.E.

CONTRACT NO. 66C53

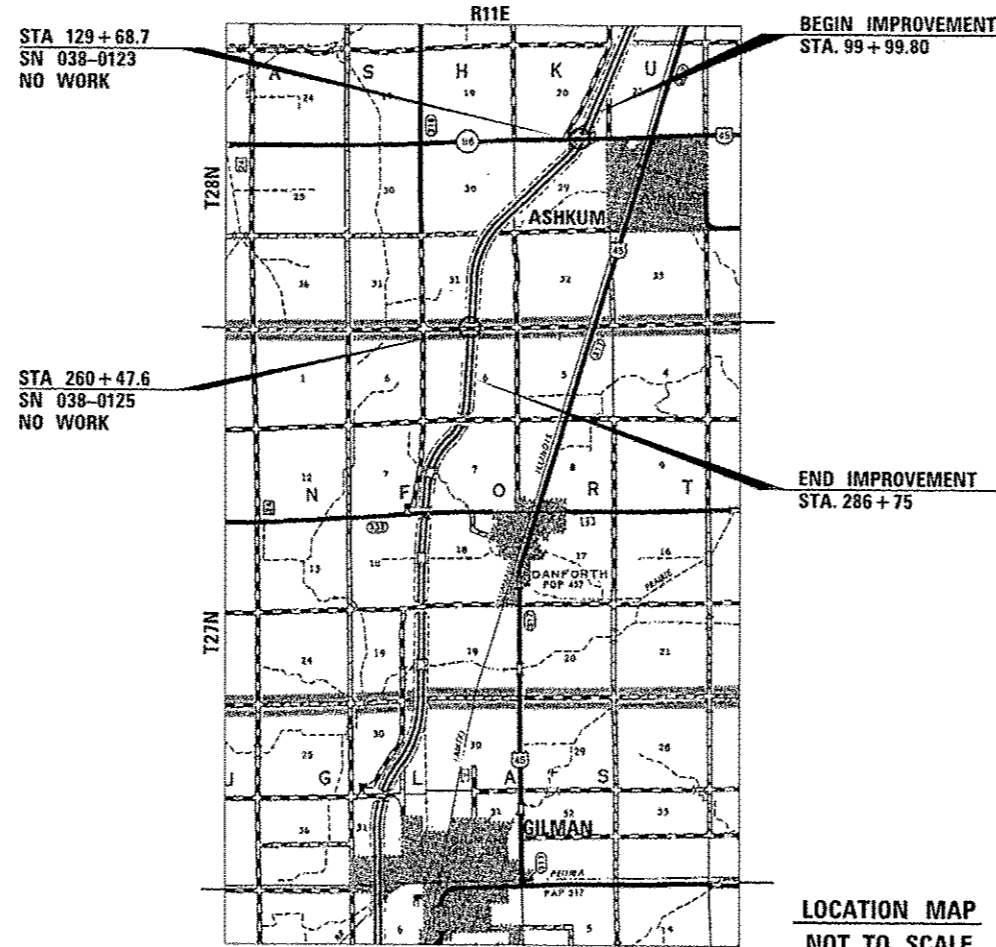

GROSS & NET LENGTH = 18675.2 FT. = 3.54 MI.

INTERSTATE (RURAL)
2013 ADT = 15400
P.V. = 74.1% S.U. = 54.7% M.U. = 21.2%

STATE OF ILLINOIS
DEPARTMENT OF TRANSPORTATION
DIVISION OF HIGHWAYS

SUBMITTED June 13, 2014
Paul Wotzke
DEPUTY DIRECTOR OF HIGHWAYS, REGION ENGINEER

July 18, 2014
John D. Baranzelli
ENGINEER OF DESIGN AND ENVIRONMENT

July 18, 2014
Omair Osman
DIRECTOR OF HIGHWAYS, CHIEF ENGINEER

**PRINTED BY THE AUTHORITY
OF THE STATE OF ILLINOIS**

5:23:32 PM C:\pwwork\pwwork\dwg\0366C53-sty-cover.dgn