

PNT 78 POT STA. 0+00 RAMP D
PNT 82 POT STA. 653+42.34 IL 116

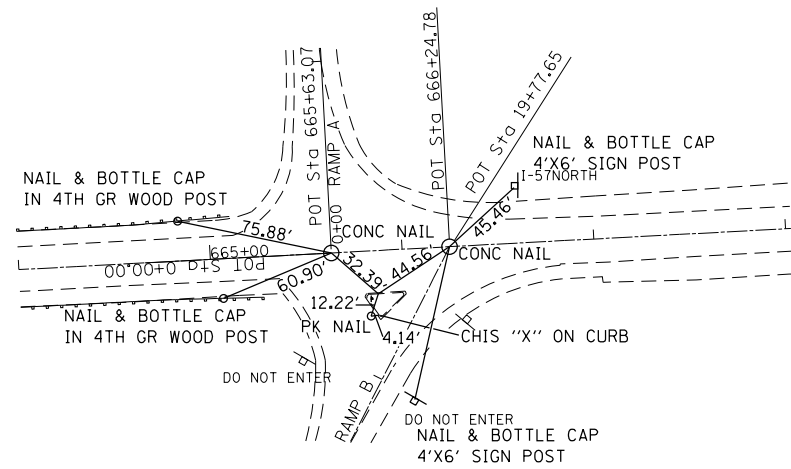

PNT 84 POT STA. 665+63.07 IL 116 = PNT 70 STA. 0+00 RAMP A
PNT 85 POT STA. 666+24.78 IL 116 = PNT 73 STA. 19+77.65 RAMP B
POINT 5013

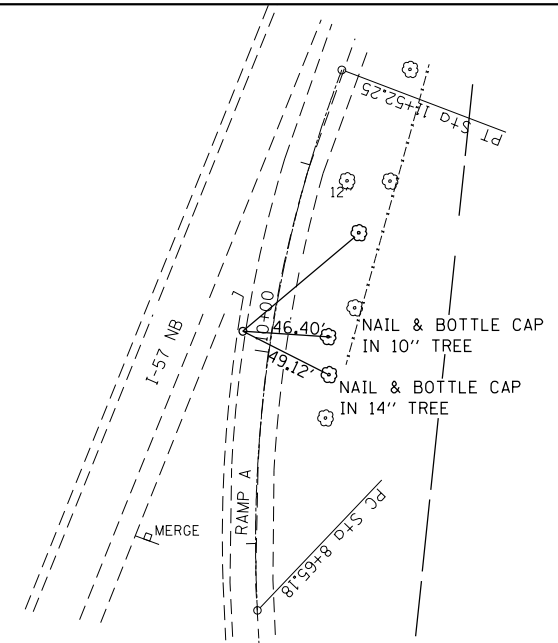

PNT 103 PI STA. 10+10.82 RAMP A

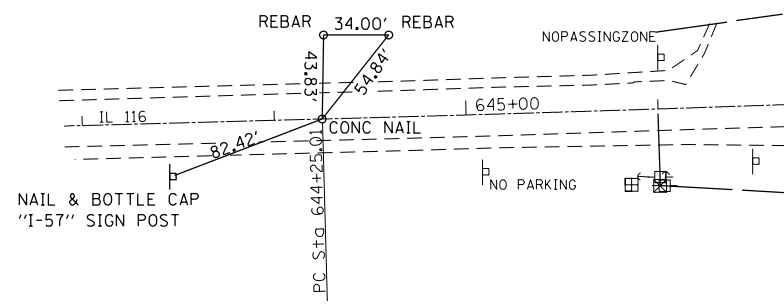

PNT PC116CL-1 PC STA. 644+25.01 IL 116

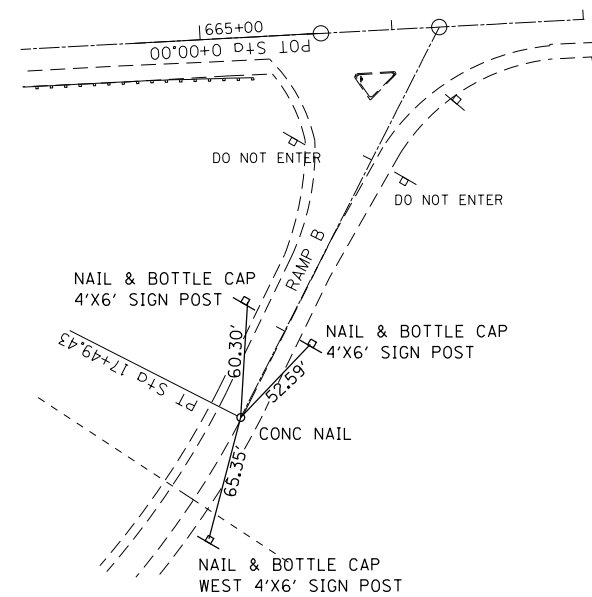

PNT PT116RMB-3 PT STA. 17+49.43 RAMP B

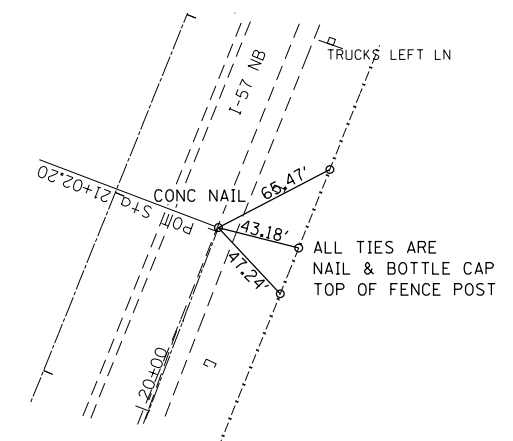

PNT 71 POT STA. 21+02.20 RAMP A

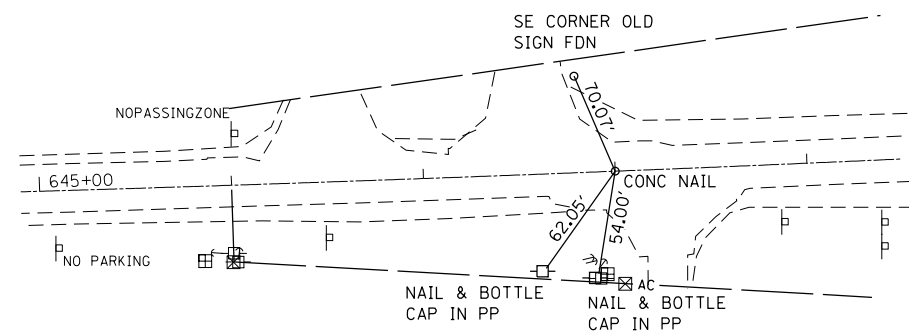

PNT 101 PI STA. 648+00.04 IL 116

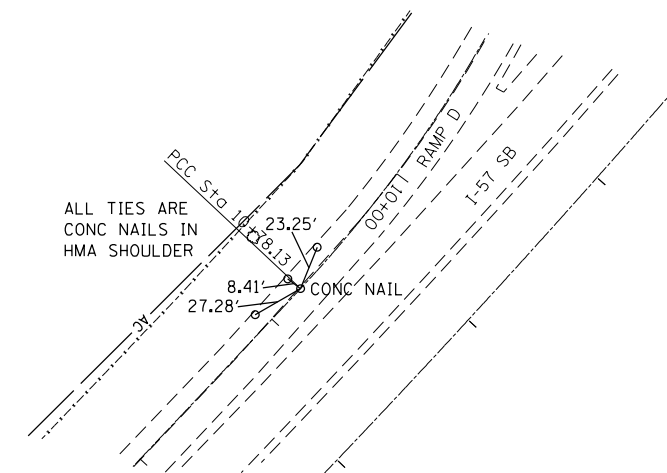

PNT PT116RMD-1 PT = PC116RMD-2 PC STA. 10+78.13 RAMP D

FILE NAME =	USER NAME = duncanbd	DESIGNED -	REVISED -
et:\pw\work\p1\dot\duncanbd\0315542\036653-sht-alignment-ties.DGN		DRAWN -	REVISED -
	PLOT SCALE = 100.0000' / in.	CHECKED -	REVISED -
	PLOT DATE = 6/10/2014	DATE -	REVISED -

STATE OF ILLINOIS
DEPARTMENT OF TRANSPORTATION

ALIGNMENT & SURVEY TIES

SCALE: SHEET NO. 5 OF 6 SHEETS STA. TO STA.

F.A.I. RTE.	SECTION	COUNTY	TOTAL SHEETS	SHEET NO.
57	(38-IRS-2	IROQUOIS	186	21
CONTRACT NO. 66C53				
ILLINOIS FED. AID PROJECT				