

P.C. STA. 239+70.25

MAG NAIL

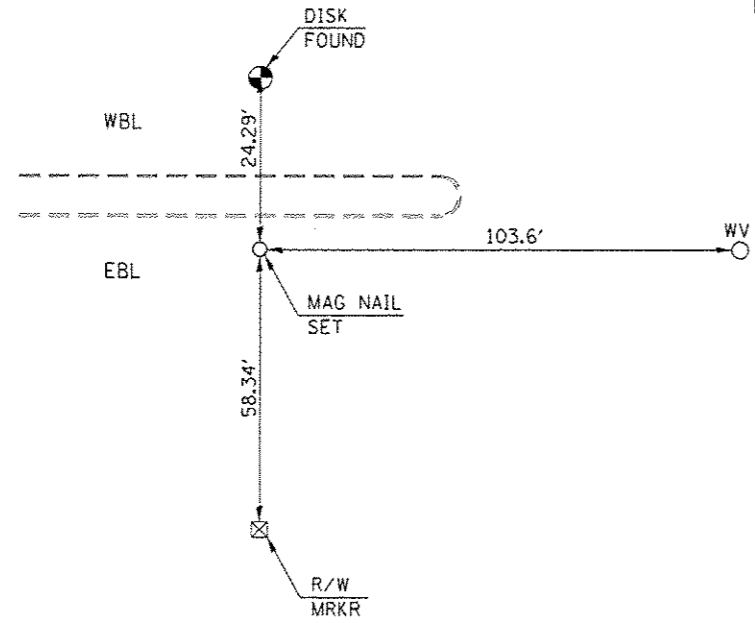

P.I. #30 STA. 243+69.94

MAG NAIL

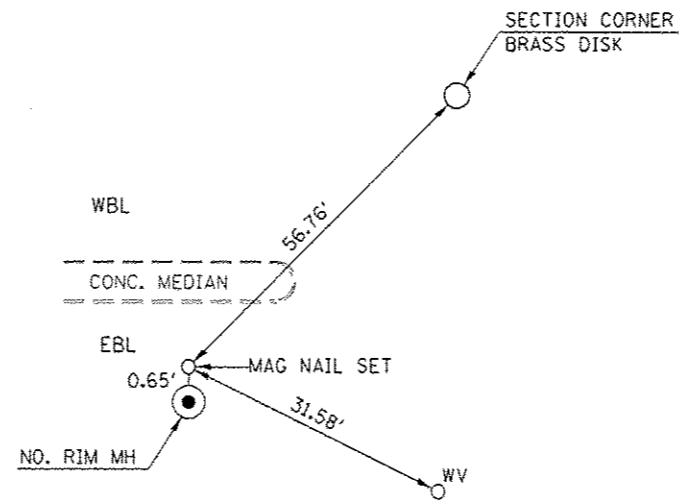

P.T. #24 STA. 247+69.59

DISK

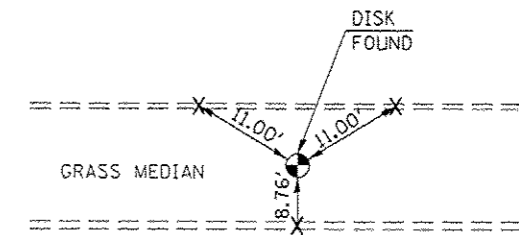

P.O.T. #29 STA. 250+50.00
& P.O.T. #28 STA. 150+56.32

DISK

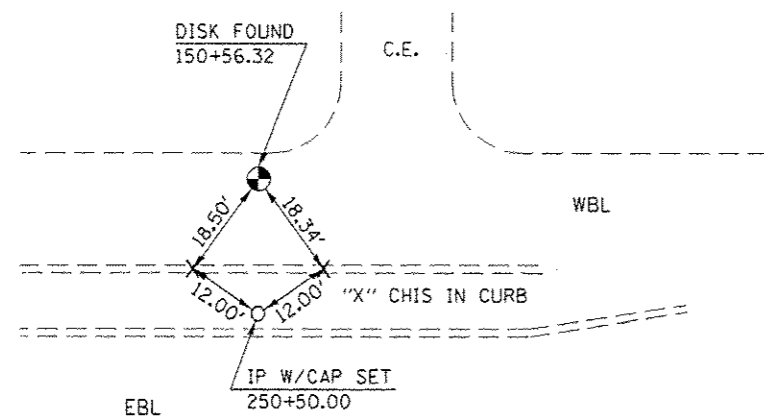

P.I. #26 STA. 174+49.70

DISK

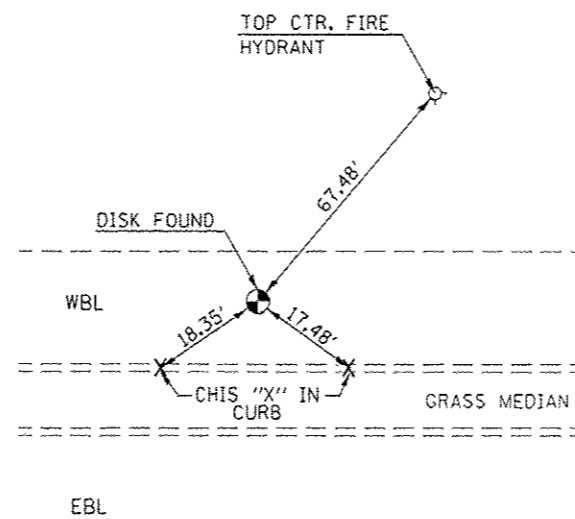

P.I. #27 STA. 183+99.97

MAG NAIL

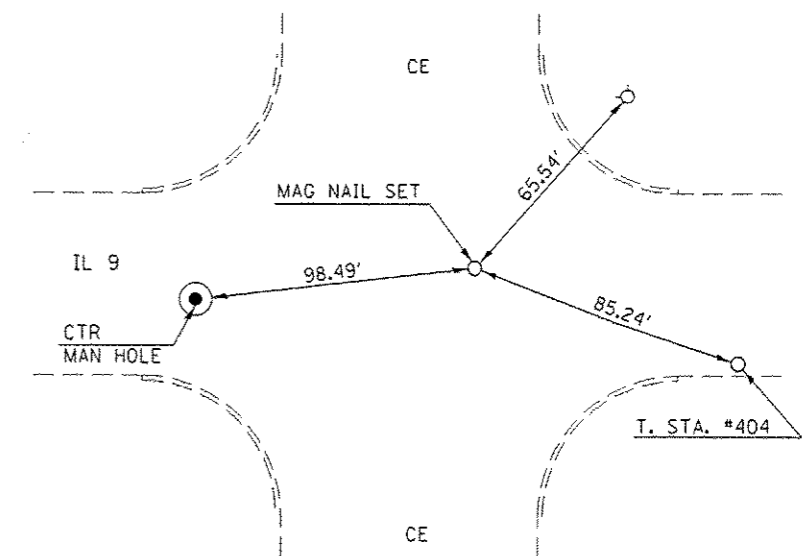

FILE NAME =	USER NAME = p10p10n0r	DESIGNED -	REVISED -	STATE OF ILLINOIS DEPARTMENT OF TRANSPORTATION	TIE POINT LAYOUTS		F.A.P. RTE.	SECTION	COUNTY	TOTAL SHEETS	SHEET NO.
01\p10p10n0r\p10p10n0r\102101149\057	7707-shl-A70.dgn	DRAWN -	REVISED -				693	(FRRS-1)	MCLEAN	48	4
PLOT SCALE = 48,0000 1/1 in.	CHECKED -	REVISED -					CONTRACT NO. 70787				
PLOT DATE = 6/13/2014	DATE -	REVISED -					ILLINOIS FED. AID PROJECT				
				SCALE: N/A		SHEET 1 OF 2 SHEETS		STA. TO STA.			