

PROPOSED HIGHWAY PLANS

F.A.I. ROUTE 70 (I-70)
SECTION (26-3,4)RS-3

RESURFACING
FAYETTE COUNTY

C-97-085-07

F.A.I. RTE.	SECTION	COUNTY	TOTAL SHEETS	SHEET NO.
70	(26-3,4)RS-3	FAYETTE	31	1
		ILLINOIS	CONTRACT NO. 74255	

FOR INDEX OF SHEETS, SEE SHEET NO. 2

ADT = 19,700 (2013)

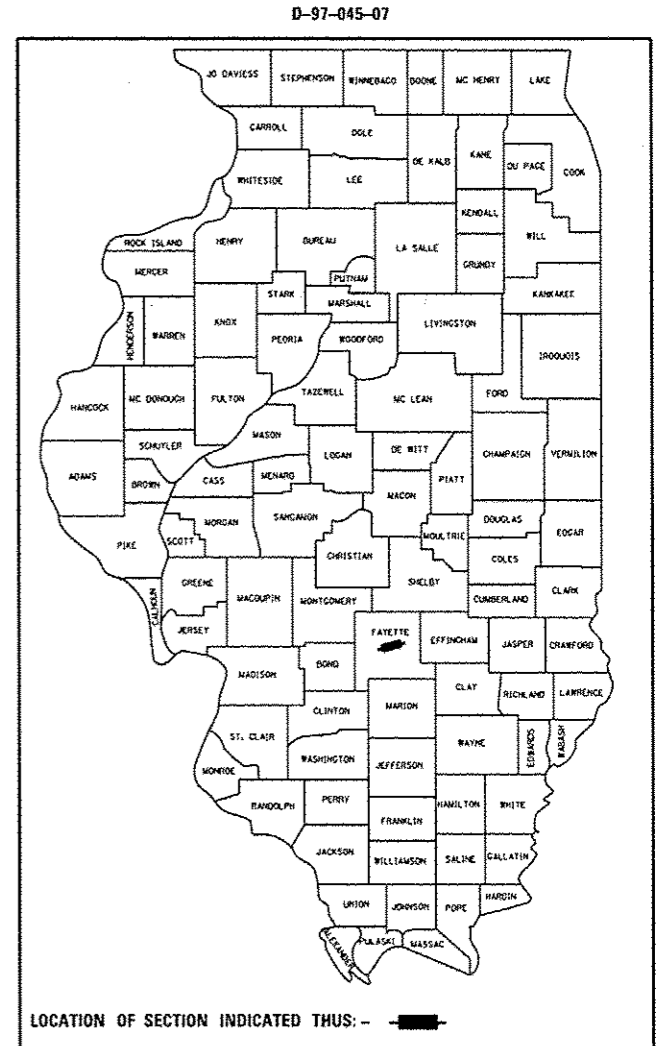

PROJECT BEGINS:
STA. 656 + 13

PROJECT ENDS:
STA. 1043 + 60

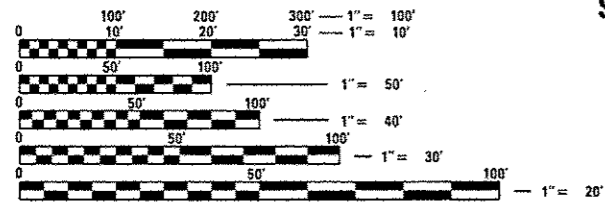
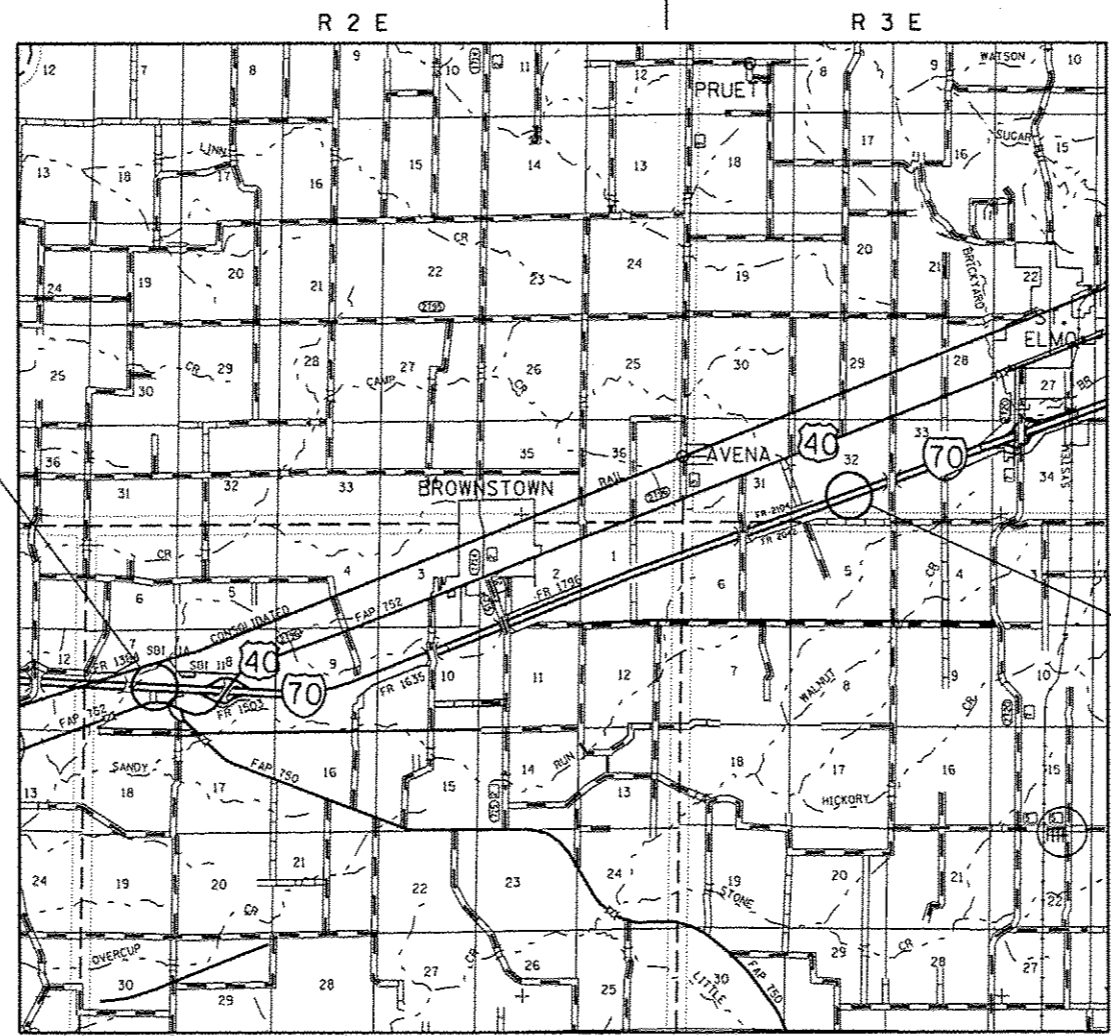

FULL SIZE PLANS HAVE BEEN PREPARED USING STANDARD ENGINEERING SCALES. REDUCED SIZED PLANS WILL NOT CONFORM TO STANDARD SCALES. IN MAKING MEASUREMENTS ON REDUCED PLANS, THE ABOVE SCALES MAY BE USED.

J.U.L.I.E.
JOINT UTILITY LOCATION INFORMATION FOR EXCAVATION
1-800-892-0123
OR 811

PROJECT ENGINEER: TOM RONAN
PROJECT MANAGER: KALEB HIRTZEL
PHONE: (217)-342-8320
CONTRACT NO. 74255

GROSS LENGTH = 38,731 FT. = 7.34 MILES
NET LENGTH = 38,731 FT. = 7.34 MILES

STATE OF ILLINOIS
DEPARTMENT OF TRANSPORTATION
DIVISION OF HIGHWAYS

SUBMITTED JUNE 12 20 14
Roger L. Drishell 1602
DEPUTY DIRECTOR OF HIGHWAYS, REGION ENGINEER

July 18 20 14
John D. Baranzelli P.E. /a
ENGINEER OF DESIGN AND ENVIRONMENT

July 18 20 14
Omer Osman P.E. /a
DIRECTOR OF HIGHWAYS, CHIEF ENGINEER

PRINTED BY THE AUTHORITY
OF THE STATE OF ILLINOIS

INDEX OF SHEETS

SHEET NO.	ITEM
1	COVER SHEET
2	INDEX OF SHEETS
3	GENERAL NOTES
4-6	SUMMARY OF QUANTITIES
7-12	TYPICAL SECTIONS
13-14	STAGING TYPICAL CROSS SECTIONS
15	TRANSITION DETAILS
16-20	SCHEDULE OF QUANTITIES
21-27	PLAN SHEETS
28	INTERSECTION DETAIL
29	TRAFFIC BARRIER TERMINAL TYPE 6B (SPECIAL) DETAIL
30-31	TYPICAL APPLICATIONS OF INTERSTATE PAVEMENT MARKING

THE FOLLOWING STANDARDS ARE A PART OF THESE PLANS AND ARE INCLUDED FOLLOWING THE LAST NUMBERED SHEET OF THE PLANS.

STD. NO.	DESCRIPTION
000001-06	STANDARD SYMBOLS, ABBREVIATIONS, AND PATTERNS
001001-02	AREAS OF REINFORCEMENT BARS
001006	DECIMAL OF AN INCH AND OF A FOOT
442001-04	CLASS A PATCHES
442101-07	CLASS B PATCHES
482001-02	HMA SHOULDER ADJACENT TO FLEXIBLE PAVEMENT
630001-10	STEEL PLATE BEAM GUARDRAIL
630301-06	SHOULDER WIDENING FOR TYPE I (SPECIAL) GUARDRAIL TERMINALS
631011-09	TRAFFIC BARRIER TERMINAL, TYPE 2
631031-12	TRAFFIC BARRIER TERMINAL, TYPE 6
631033-05	TRAFFIC BARRIER TERMINAL, TYPE 6B
635001-01	DELINEATORS
635006-03	REFLECTOR AND TERMINAL MARKER PLACEMENT
635011-02	REFLECTOR MARKER AND MOUNTING DETAILS
642001-02	SHOULDER RUMBLE STRIPS 16"
665001-02	WOVEN WIRE FENCE
701006-05	OFF-RD OPERATIONS, 2L, 2W, 15' TO 24" FROM PAVEMENT EDGE
701011-04	OFF-RD MOVING OPERATIONS, 2L, 2W, DAY ONLY
701101-04	OFF-RD OPERATIONS, MULTILANE, 15' TO 24" FROM PAVEMENT EDGE
701106-02	OFF-RD OPERATIONS, MULTILANE, MORE THAN 15' AWAY
701400-07	APPROACH TO LANE CLOSURE, FREEWAY/EXPRESSWAY
701401-08	LANE CLOSURE, FREEWAY/EXPRESSWAY
701406-08	LANE CLOSURE, FREEWAY/EXPRESSWAY, DAY OPERATIONS ONLY
701411-08	LANE CLOSURE, MULTILANE, AT ENTRANCE OR EXIT RAMP, FOR SPEEDS \geq 45 MPH
701426-06	LANE CLOSURE, MULTILANE, INTERMITTENT OR MOVING OPERATION, FOR SPEEDS \geq 45 MPH
701451-02	RAMP CLOSURE FREEWAY/EXPRESSWAY
701456-03	PARTIAL EXIT RAMP CLOSURE, FREEWAY/EXPRESSWAY
701901-03	TRAFFIC CONTROL DEVICES
780001-04	TYPICAL PAVEMENT MARKINGS
781001-03	TYPICAL APPLICATIONS RAISED REFLECTIVE PAVEMENT MARKERS

GENERAL NOTES

THIS SECTION SHALL BE CONSTRUCTED IN ACCORDANCE WITH THE PLANS; THE "STANDARD SPECIFICATIONS FOR ROAD AND BRIDGE CONSTRUCTION" ADOPTED JANUARY 1, 2012; AND THE SPECIAL PROVISIONS INCLUDED IN THE PROPOSAL.

THIS PROJECT IS LOCATED ON FAI ROUTE 70 (I-70) IN FAYETTE COUNTY, FROM 1 MILE WEST OF US 40 AT BROWNSTOWN TO 2 MILES WEST OF ST. ELMO. THE WORK INCLUDED IN SECTION (26-3.4)RS-3 CONSISTS OF PATCHING, HOT-MIX ASPHALT SURFACE REMOVAL, HOT-MIX ASPHALT RESURFACING, PAVEMENT MARKING, GUARDRAIL REMOVAL AND REPLACEMENT, AND ANY OTHER WORK NECESSARY TO COMPLETE THE SECTION.

PAVEMENT MARKING SHALL BE APPLIED IN ACCORDANCE WITH SECTION 780 OF THE STANDARD SPECIFICATIONS. SHORT TERM PAVEMENT MARKING SHALL BE APPLIED TO THE MILLED SURFACE, BITUMINOUS MATERIALS (PRIME COAT), AND HOT-MIX ASPHALT SURFACE COURSE AS SPECIFIED IN SECTION 703 OF THE STANDARD SPECIFICATIONS. TEMPORARY TAPE SHALL BE USED ON THE SURFACE COURSE AND HOT-MIX ASPHALT SHOULDERS. PAINT SHALL BE USED ON MILLED SURFACES.

THE TOTAL QUANTITY OF THERMOPLASTIC PAVEMENT MARKING - LINE 4" CONSISTS OF 82,624 FEET OF YELLOW AND 83,607 FEET OF WHITE.

THE TOTAL QUANTITY OF THERMOPLASTIC PAVEMENT MARKING - LINE 8" CONSISTS OF 5,190 FEET OF WHITE.

THE TOTAL QUANTITY OF PREFORMED PLASTIC PAVEMENT MARKING, TYPE B - INLAID - LINE 6" CONSISTS OF 19,374 FEET OF WHITE.

THE RAISED REFLECTIVE PAVEMENT MARKERS SHALL BE PLACED AS DOUBLE MARKERS ON I-70 AS SHOWN ON STANDARD 781001. THE TOTAL QUANTITY OF RAISED REFLECTIVE PAVEMENT MARKERS IS 1,938 ONE-WAY CRYSTAL.

ALL OF THE EXISTING HMA SHALL BE REMOVED DOWN TO THE ORIGINAL CONCRETE PAVEMENT. THE CONTRACTOR WILL BE REQUIRED TO MILL THROUGH SOME PORTLAND CEMENT CONCRETE PATCHES. MILLING THE AREA OF THE PORTLAND CEMENT CONCRETE PATCHES WILL BE PAID FOR AS HOT-MIX ASPHALT SURFACE REMOVAL OF THE THICKNESS SPECIFIED AND NO ADDITIONAL COMPENSATION WILL BE PERMITTED FOR MILLING THROUGH CONCRETE PATCHES. THE SHOULDERS SHALL BE MILLED AT INTERMITTENT LOCATIONS TO ALLOW FOR ADEQUATE DRAINAGE. THE LOCATIONS SHALL BE DETERMINED BY THE ENGINEER IN THE FIELD. THE COST OF ALLOWING ADEQUATE DRAINAGE SHALL BE INCLUDED IN THE COST OF THE PAY ITEMS INVOLVED.

AN ESTIMATED QUANTITY OF HOT-MIX ASPHALT SHOULDERS AND PAVED SHOULDER REMOVAL HAS BEEN INCLUDED FOR ANY NECESSARY SHOULDER REPAIR. THE QUANTITIES SHOWN IN THE PLANS ARE ESTIMATES ONLY. THE FINAL LOCATIONS AND QUANTITIES SHALL BE DETERMINED BY THE ENGINEER IN THE FIELD. THE THICKNESS OF THE PAVED SHOULDER TO BE REMOVED IS 14".

THE EXISTING PAVEMENT SHALL BE PATCHED IN ACCORDANCE WITH SECTION 442 OF THE STANDARD SPECIFICATIONS AND THE SPECIAL PROVISIONS. CLASS A AND CLASS B PAVEMENT PATCHING IS INCLUDED FOR PATCHING THE PAVEMENT ON I-70. AN ESTIMATED QUANTITY OF HOT-MIX ASPHALT FOR PATCHING POTHOLES (COLD MIX) HAS BEEN INCLUDED FOR ANY NECESSARY POTHOLE PATCHING. THE QUANTITIES OF PATCHING AND POTHOLE PATCHING SHOWN IN THE PLANS ARE ESTIMATES ONLY. THE FINAL LOCATIONS AND QUANTITIES SHALL BE DETERMINED BY THE ENGINEER IN THE FIELD.

THE RESIDENT ENGINEER SHALL BE THE SOLE JUDGE CONCERNING THE CURING TIME FOR THE VARIOUS HOT-MIX ASPHALT LIFTS.

THE CONTRACTOR WILL BE REQUIRED TO USE A MATERIAL TRANSFER DEVICE AT ALL TIMES WHEN CONSTRUCTING THE POLYMERIZED HMA SURFACE COURSE, STONE MATRIX ASPHALT, N80. THE HMA CROSS SECTION TO BE CONSTRUCTED IS NOT CONSIDERED FULL-DEPTH HMA PAVEMENT. THE SPECIAL PROVISION "HOT MIX ASPHALT - PAY FOR PERFORMANCE USING PERCENT WITHIN LIMITS - JOBSITE SAMPLING" APPLIES TO BOTH LIFTS OF POLYMERIZED BINDER COURSE AND ALL STONE MATRIX ASPHALT SURFACE COURSE.

THE CONTRACTOR SHALL PROVIDE INTERNET ACCESSIBILITY TO THE HOT-MIX ASPHALT PLANT QUALITY CONTROL LAB SO THAT HOT-MIX ASPHALT PLANT REPORTS CAN BE E-MAILED TO THE DISTRICT HEADQUARTERS. THIS WORK SHALL BE INCLUDED IN THE COST OF ALL HOT-MIX ASPHALT ITEMS.

GENERAL NOTES (Cont'd)

IN ADDITION TO THE REQUIREMENTS IN ARTICLE 701.15(j), A LAPTOP COMPUTER SHALL BE SUPPLIED BY THE CONTRACTOR.

A UNIFORMLY STRAIGHT SAW CUT SHALL BE MADE AT LOCATIONS WHERE PROPOSED NEW CONSTRUCTION WILL ABUT EXISTING HOT-MIX ASPHALT SURFACES. THE SAW CUT SHALL BE MADE FULL DEPTH THROUGH THE EXISTING SURFACE. THIS WORK WILL BE CONSIDERED INCLUDED IN THE COST OF THE CONTRACT ITEMS INVOLVED AND NO EXTRA COMPENSATION WILL BE ALLOWED.

THE FOLLOWING MIXTURE REQUIREMENTS ARE APPLICABLE FOR THIS PROJECT:

APPLICATION	AC/PG	DESIGN AIR VOIDS	MIXTURE COMPOSITION	FRICTION AGGREGATE
HMA SURFACE COURSE - POLYMERIZED HMA SURFACE COURSE, SMA, N80	SBS PG 76-22	4.0% @ N=80	IL - 12.5	N/A
TOP BINDER COURSE LIFT - POLYMERIZED HMA BINDER COURSE, IL-19.0 FG, N90	SBS PG 70-22	4.0% @ N=90	IL - 19.0 FG	N/A
BINDER COURSE LIFT #1 - HMA BINDER COURSE, IL-19.0 FG, N90	PG 64-22	4.0% @ N=90	IL - 19.0 FG	N/A
HMA SHOULDERS - 1 1/2" OVERLAY AND REPAIR TOP LIFT (1 1/2") HMA SURFACE COURSE, MIX "C", N90	PG 64-22	4.0% @ N=90	IL - 9.5	MIX C
HMA SHOULDER REPAIR (FULL DEPTH) BOTTOM LIFTS - HMA BINDER COURSE, IL-19.0, N90	PG 64-22	4.0% @ N=90	IL - 19.0	N/A
SURFACE COURSE - 1 1/2" (US 40 INTERCHANGE RAMPS) HMA SURFACE COURSE, MIX "C", N90	SBS PG 70-22	4.0% @ N=90	IL - 9.5	MIX C
SURFACE COURSE - 1 1/2" (WEIGH STATION RAMPS) HMA SURFACE COURSE, MIX "D", N90	SBS PG 76-22	4.0% @ N=90	IL - 9.5	MIX D
RAMP SHOULDERS (1 1/2") HMA SURFACE COURSE, IL-9.5L, N30	PG 64-22	4.0% @ N=30	IL - 9.5L	N/A

THE FOLLOWING RATES OF APPLICATION HAVE BEEN USED IN THE CALCULATING PLAN QUANTITIES:

BITUMINOUS MATERIALS (PRIME COAT)	0.05 LBS/SQ FT
BITUMINOUS MATERIALS (PRIME COAT)-FOG COAT	0.025 LBS/SQ FT
STONE MATRIX HOT-MIX ASPHALT	130 LBS/SQ YD/INCH
HOT-MIX ASPHALT SURFACE COURSE	112 LBS/SQ YD/INCH
HOT-MIX ASPHALT BINDER	112 LBS/SQ YD/INCH
HOT-MIX ASPHALT SHOULDERS	112 LBS/SQ YD/INCH

FILE NAME :	USER NAME : staffennk	DESIGNED -	REVISED -	STATE OF ILLINOIS DEPARTMENT OF TRANSPORTATION	GENERAL NOTES				F.A.I. R/E:	SECTION	COUNTY	TOTAL SHEETS	SHEET NO.
o:\p\work\p\uidot\staffennk\02030930\074255-ahs-index.dgn	DRAWN -	REVISED -	70		(26-3.4)RS-3	FAYETTE	31	3					
PLOT SCALE = 100.0000' / 1"	CHECKED -	REVISED -	CONTRACT NO. 74255										
Default	DATE -	REVISED -	SCALE: N/A		SHEET 1	OF 1 SHEETS	STA. TO STA.	ILLINOIS FED. AID PROJECT					

SUMMARY OF QUANTITIES			TOTAL QUANTITIES	CONSTRUCTION TYPE CODE		
CODE NO	ITEM	UNIT		100% STATE		
40600990	TEMPORARY RAMP	SO YD	1798	1798		
40603092	HOT-MIX ASPHALT BINDER COURSE, IL-19.0 FG, N90	TON	25847	25847		
40603153	POLYMERIZED HOT-MIX ASPHALT SURFACE COURSE, STONE MATRIX ASPHALT, N80	TON	27742	27742		
40603243	POLYMERIZED HOT-MIX ASPHALT BINDER COURSE, IL-19.0, FG, N90	TON	25860	25860		
40603320	HOT-MIX ASPHALT SURFACE COURSE, MIX "C", N90	TON	529	529		
40603345	HOT-MIX ASPHALT SURFACE COURSE, MIX "D", N90	TON	384	384		
44000153	HOT-MIX ASPHALT SURFACE REMOVAL, 1"	SO YD	126270	126270		
44000155	HOT-MIX ASPHALT SURFACE REMOVAL, 1 1/2"	SO YD	24786	24786		
44000173	HOT-MIX ASPHALT SURFACE REMOVAL, 6"	SO YD	205077	205077		
44004250	PAVED SHOULDER REMOVAL	SO YD	7233	7233		
44200529	CLASS A PATCHES, TYPE II, 8 INCH	SO YD	56	56		
44200533	CLASS A PATCHES, TYPE III, 8 INCH	SO YD	25	25		

SUMMARY OF QUANTITIES			TOTAL QUANTITIES	CONSTRUCTION TYPE CODE		
CODE NO	ITEM	UNIT		100% STATE		
44200577	CLASS A PATCHES, TYPE II, 12 INCH	SO YD	56	56		
44200581	CLASS A PATCHES, TYPE III, 12 INCH	SO YD	25	25		
44200620	CLASS A PATCHES, TYPE II, 14 INCH	SO YD	120	120		
44200982	CLASS B PATCHES, TYPE II, 11 INCH	SO YD	39	39		
44200986	CLASS B PATCHES, TYPE III, 11 INCH	SO YD	17	17		
44200988	CLASS B PATCHES, TYPE IV, 11 INCH	SO YD	81	81		
44201007	CLASS B PATCHES, TYPE II, 13 INCH	SO YD	143	143		
44201011	CLASS B PATCHES, TYPE III, 13 INCH	SO YD	16	16		
44201043	CLASS B PATCHES, TYPE II, 16 INCH	SO YD	955	955		
44201047	CLASS B PATCHES, TYPE III, 16 INCH	SO YD	76	76		
44201299	DOWEL BARS 1 1/2"	EACH	2696	2696		
44213000	PATCHING REINFORCEMENT	SO YD	506	506		
44213100	PAVEMENT FABRIC	SO YD	189	189		
44213200	SAW CUTS	FOOT	9334	9334		

SUMMARY OF QUANTITIES			TOTAL QUANTITIES	CONSTRUCTION TYPE CODE		
CODE NO	ITEM	UNIT		100% STATE		
44213208	TIE BARS 1 1/4"	EACH	78	78		
48102100	AGGREGATE WEDGE SHOULDER, TYPE B	TON	1226	1226		
48203100	HOT-MIX ASPHALT SHOULDERS	TON	16796	16796		
63000001	STEEL PLATE BEAM GUARDRAIL, TYPE A, 6 FOOT POSTS	FOOT	2637.5	2637.5		
63100045	TRAFFIC BARRIER TERMINAL, TYPE 2	EACH	3	3		
63100085	TRAFFIC BARRIER TERMINAL, TYPE 6	EACH	4	4		
63100089	TRAFFIC BARRIER TERMINAL, TYPE 6B	EACH	5	5		
63100167	TRAFFIC BARRIER TERMINAL, TYPE 1 (SPECIAL) TANGENT	EACH	12	12		
63200310	GUARDRAIL REMOVAL	FOOT	5051	5051		
63400105	GUARD POSTS	EACH	96	96		
63500105	DELINEATORS	EACH	292	292		
64200116	SHOULDER RUMBLE STRIPS, 16 INCH	FOOT	149573	149573		
66500105	WOVEN WIRE FENCE, 4'	FOOT	1175	1175		

SUMMARY OF QUANTITIES			TOTAL QUANTITIES	CONSTRUCTION TYPE CODE		
CODE NO	ITEM	UNIT		100% STATE		
67000400	ENGINEER'S FIELD OFFICE, TYPE A	CAL MO	12	12		
67100100	MOBILIZATION	L SUM	1	1		
70100420	TRAFFIC CONTROL AND PROTECTION, STANDARD 701411	EACH	4	4		
70100700	TRAFFIC CONTROL AND PROTECTION, STANDARD 701406	L SUM	1	1		
70100800	TRAFFIC CONTROL AND PROTECTION, STANDARD 701401	L SUM	1	1		
70100820	TRAFFIC CONTROL AND PROTECTION, STANDARD 701451	L SUM	1	1		
70100825	TRAFFIC CONTROL AND PROTECTION, STANDARD 701456	L SUM	1	1		
70300100	SHORT TERM PAVEMENT MARKING	FOOT	11259	11259		
70300220	TEMPORARY PAVEMENT MARKING - LINE 4"	FOOT	171421	171421		
70300240	TEMPORARY PAVEMENT MARKING - LINE 6"	FOOT	19374	19374		
70301000	WORK ZONE PAVEMENT MARKING REMOVAL	SQ FT	3753	3753		

* SPECIALTY ITEMS

FILE NAME =	USER NAME = steffanmk	DESIGNED -	REVISED -
c:\p\work\p\p\dot\steffanmk\0308908\074255-ehf-soq.dgn		DRAWN -	REVISED -
		CHECKED -	REVISED -
		DATE -	REVISED -
Default	PLOT DATE = 6/12/2014		

STATE OF ILLINOIS
DEPARTMENT OF TRANSPORTATION

SUMMARY OF QUANTITIES

SCALE: N/A SHEET 2 OF 3 SHEETS STA. TO STA.

F.A.I. RTE.	SECTION	COUNTY	TOTAL SHEETS	SHEET NO.
70	126-3,41RS-3	FAYETTE	31	5
CONTRACT NO. 74255			ILLINOIS FED. AID PROJECT	

SUMMARY OF QUANTITIES			TOTAL QUANTITIES	CONSTRUCTION TYPE CODE	
CODE NO	ITEM	UNIT		100% STATE	0005
* 78000200	THERMOPLASTIC PAVEMENT MARKING - LINE 4"	FOOT	166231	166231	
* 78000500	THERMOPLASTIC PAVEMENT MARKING - LINE 8"	FOOT	5190	5190	
* 78004230	PREFORMED PLASTIC PAVEMENT MARKING, TYPE B - INLAID - LINE 6"	FOOT	19374	19374	
* 78100100	RAISED REFLECTIVE PAVEMENT MARKER	EACH	1938	1938	
* 78200410	GUARDRAIL MARKERS, TYPE A	EACH	52	52	
* 78201000	TERMINAL MARKER - DIRECT APPLIED	EACH	12	12	
78300100	PAVEMENT MARKING REMOVAL	SO FT	66494	66494	
X4060110	BITUMINOUS MATERIALS (PRIME COAT)	POUND	256079	256079	
X4401198	HOT-MIX ASPHALT SURFACE REMOVAL, VARIABLE DEPTH	SO YD	311	311	
* X6311217	TRAFFIC BARRIER TERMINAL, TYPE 6B (SPECIAL)	EACH	1	1	
X6350120	DELINEATOR REMOVAL	EACH	292	292	
X6650202	WOVEN WIRE FENCE REMOVAL	FOOT	1175	1175	
X7010410	SPEED DISPLAY TRAILER	CAL MO	5	5	

SUMMARY OF QUANTITIES			TOTAL QUANTITIES	CONSTRUCTION TYPE CODE	
CODE NO	ITEM	UNIT		100% STATE	0005
X7015005	CHANGEABLE MESSAGE SIGN	CAL DA	28	28	
* X7830070	GROOVING FOR RECESSED PAVEMENT MARKING 5"	FOOT	166231	166231	
* X7830076	GROOVING FOR RECESSED PAVEMENT MARKING 9"	FOOT	5190	5190	
Z0005010	HOT-MIX ASPHALT FOR PATCHING POTHOLES (COLD MIX)	TON	15	15	
Z0034105	MATERIAL TRANSFER DEVICE	TON	79449	79449	
Z0076600	TRAINEES	HOOR	500	500	
Z0076604	TRAINEES TRAINING PROGRAM GRADUATE	HOOR	500	500	

* SPECIALTY ITEMS

9 0042

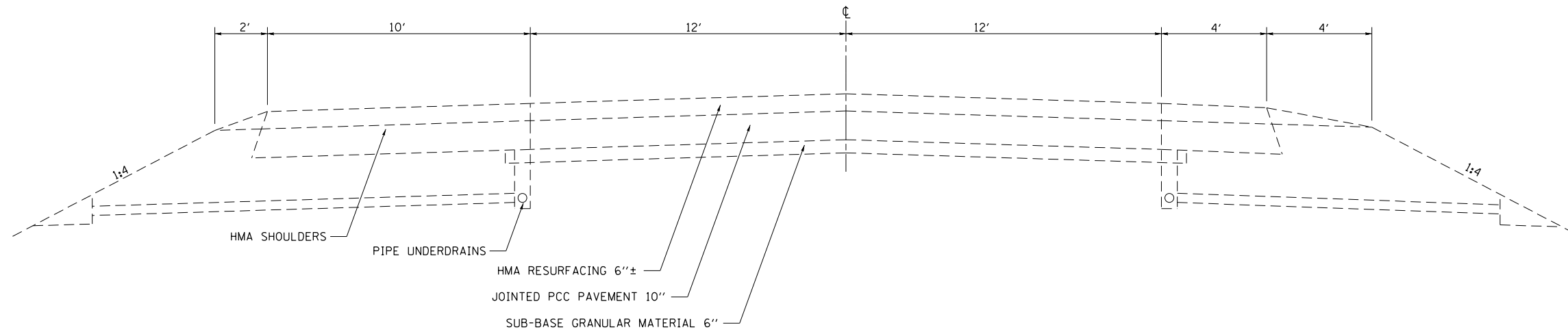

EXISTING TYPICAL SECTION

WESTBOUND
 STA. 656+13.00 TO STA. 734+69.44
 STA. 783+60.55 TO STA. 1043+60.00

EASTBOUND
 STA. 656+13.00 TO STA. 726+40.78

NOTE: NOTE TO SCALE

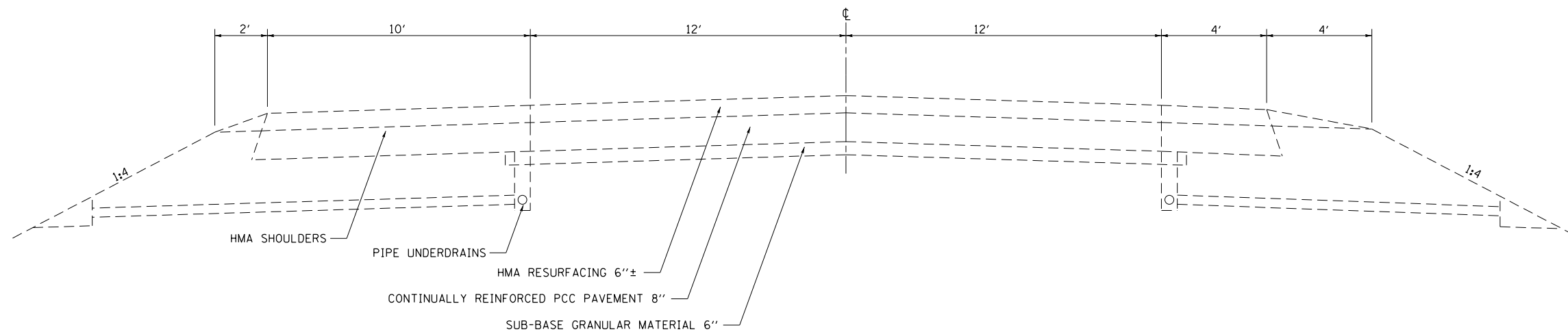

EXISTING TYPICAL SECTION

EASTBOUND
 STA. 726+40.78 TO STA. 734+69.44
 STA. 783+60.55 TO STA. 1043+60.00

NOTE: NOTE TO SCALE

FILE NAME =	USER NAME = steffenmk	DESIGNED -	REVISED -
c:\pwork\pwork\stevfenmk\d0338930\074255-sht-typicals.dgn		DRAWN -	REVISED -
Default	PLOT SCALE = 100.0000' / 1in.	CHECKED -	REVISED -
	PLOT DATE = 6/12/2014	DATE -	REVISED -

**STATE OF ILLINOIS
 DEPARTMENT OF TRANSPORTATION**

EXISTING TYPICAL CROSS SECTIONS

SCALE: N.A. SHEET 1 OF 6 SHEETS STA. TO STA.

F.A.I. RTE.	SECTION	COUNTY	TOTAL SHEETS	SHEET NO.
70	126-3,4)RS-3	FAYETTE	31	7
CONTRACT NO. 74255			ILLINOIS FED. AID PROJECT	

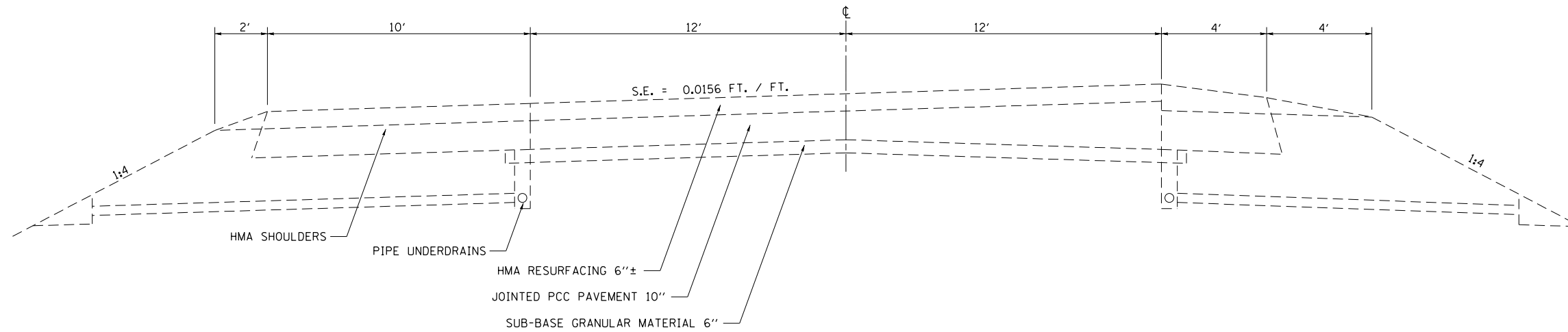

EXISTING TYPICAL SECTION

WESTBOUND
 STA. 734+69.44 TO STA. 783+60.55

NOTE: NOTE TO SCALE

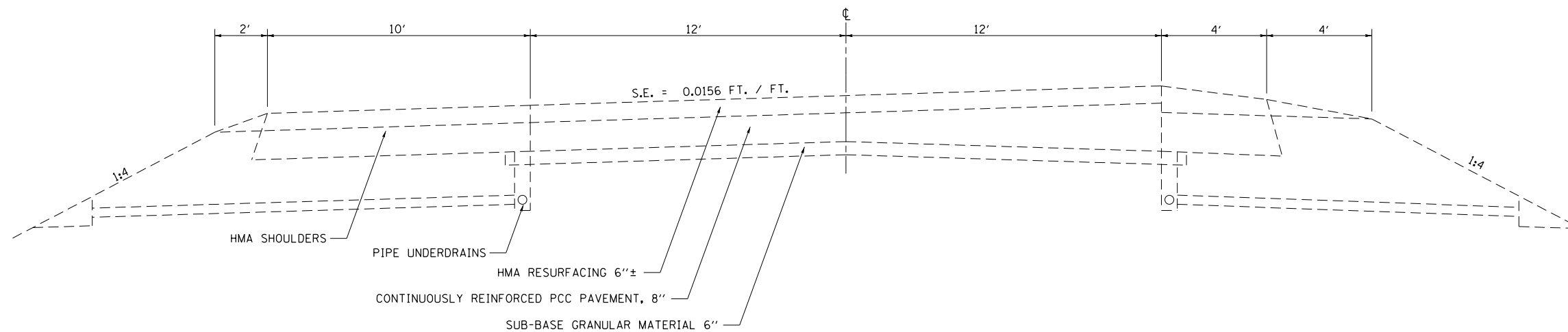

EXISTING TYPICAL SECTION

EASTBOUND
 STA. 734+69.44 TO STA. 783+60.55

NOTE: NOTE TO SCALE

FILE NAME = c:\pwork\pwork\stefhenk\d0338930\074255-sht-typicals.dgn	USER NAME = stefhenk	DESIGNED -	REVISED -	STATE OF ILLINOIS DEPARTMENT OF TRANSPORTATION	EXISTING TYPICAL CROSS SECTIONS			F.A.I. RTE.	SECTION	COUNTY	TOTAL SHEETS	SHEET NO.
	PLOT SCALE = 100.0000' / in.	CHECKED -	REVISED -					70	126-3,41RS-3	FAYETTE	31	8
Default	PLOT DATE = 6/12/2014	DATE -	REVISED -	SCALE: N.A. SHEET 2 OF 6 SHEETS STA. TO STA.			ILLINOIS FED. AID PROJECT CONTRACT NO. 74255					

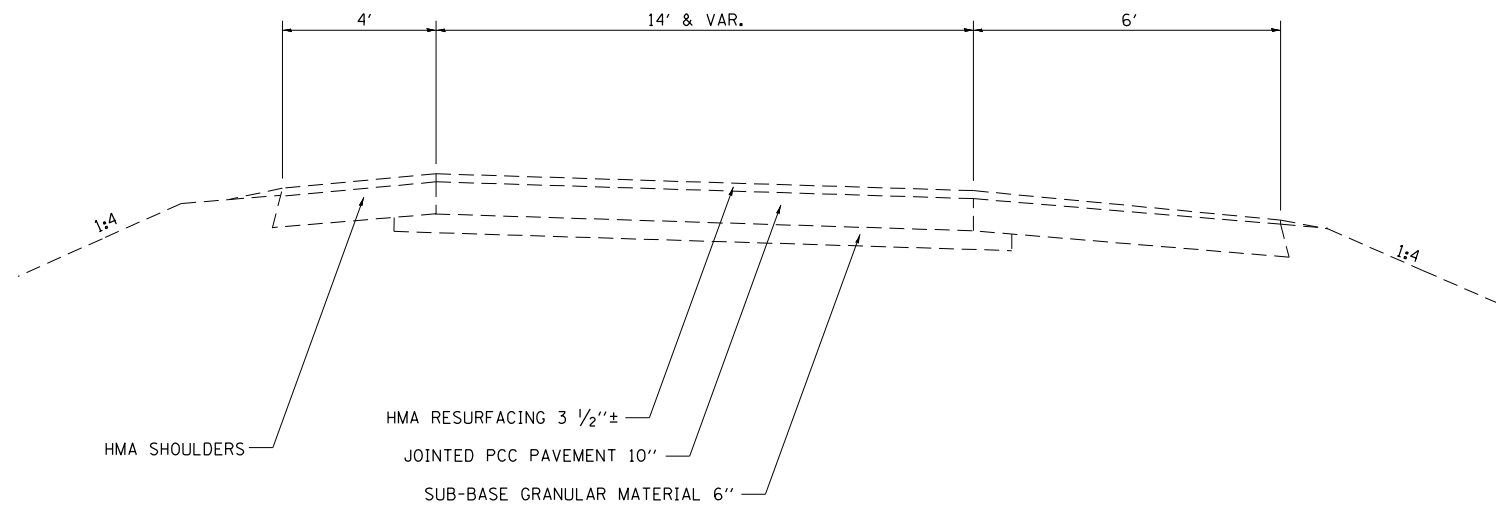

EXISTING TYPICAL SECTION

RAMPS A, B, C, & D

NOTE: NOTE TO SCALE

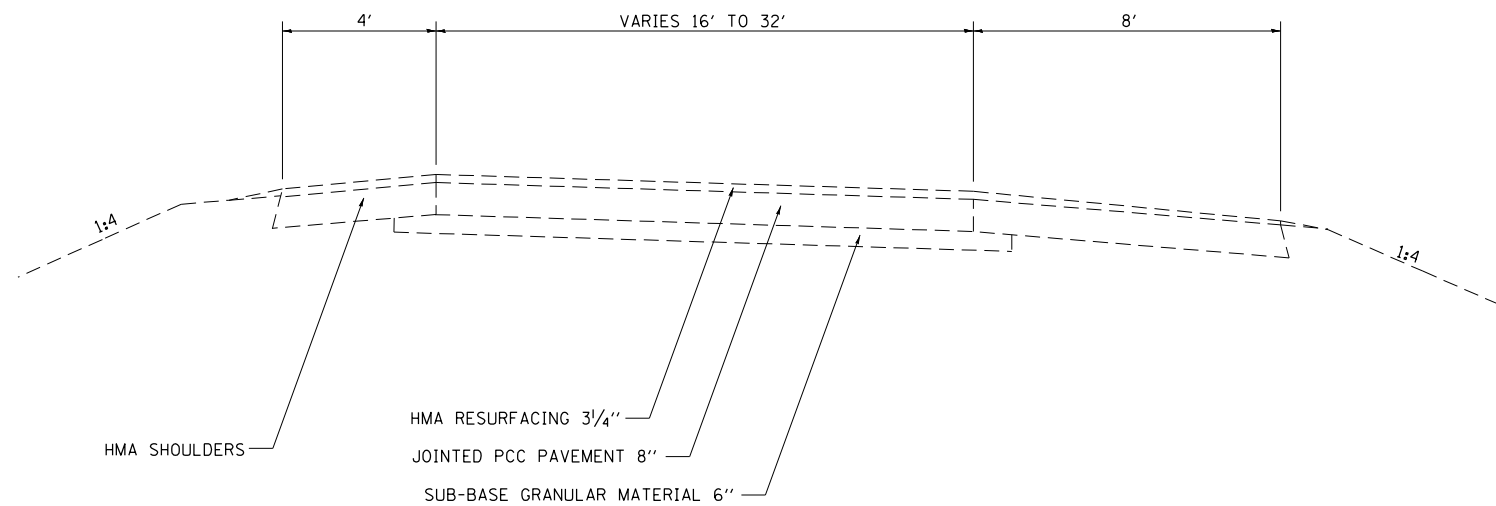

EXISTING TYPICAL SECTION

WEIGH STATION RAMPS

NOTE: NOTE TO SCALE

FILE NAME =	USER NAME = steffenmk	DESIGNED -	REVISED -	STATE OF ILLINOIS DEPARTMENT OF TRANSPORTATION	EXISTING TYPICAL CROSS SECTIONS			F.A.I. RTE.	SECTION	COUNTY	TOTAL SHEETS	SHEET NO.
c:\pwork\pwork\stevfenmk\d0338930\074255-sht-typicals.dgn	74255-sht-typicals.dgn	DRAWN -	REVISED -		70	126-3,4)RS-3	FAYETTE	31	9			
Default	PLOT SCALE = 100.0000' / in.	CHECKED -	REVISED -		SCALE: N.A. SHEET 3 OF 6 SHEETS STA. TO STA.			CONTRACT NO. 74255				
	PLOT DATE = 6/12/2014	DATE -	REVISED -		ILLINOIS FED. AID PROJECT							

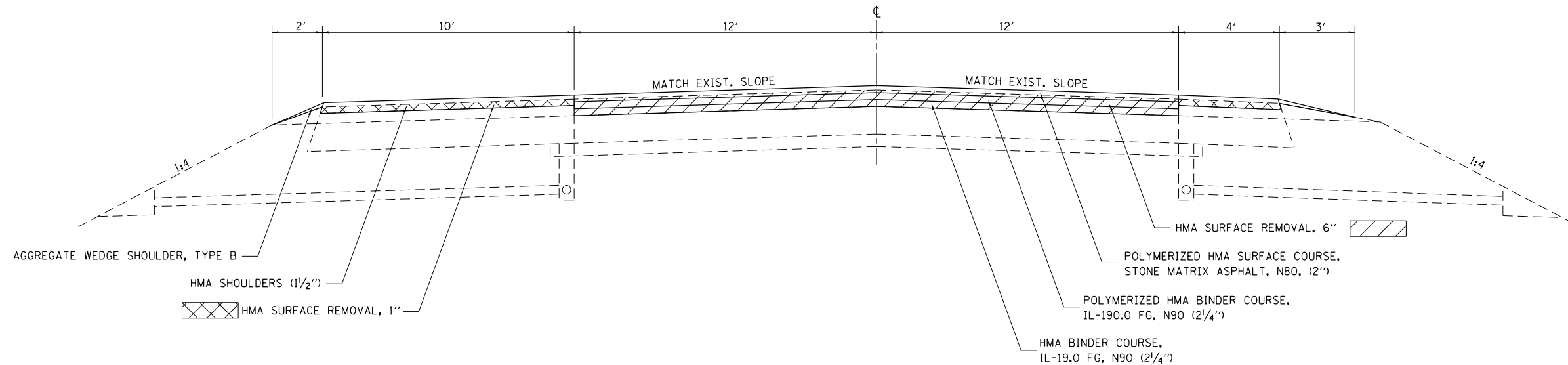

PROPOSED TYPICAL SECTION

WESTBOUND
 STA. 656+13.00 TO STA. 734+69.44
 STA. 783+60.55 TO STA. 1043+60.00

EASTBOUND
 STA. 656+13.00 TO STA. 726+40.78

NOTE: NOTE TO SCALE

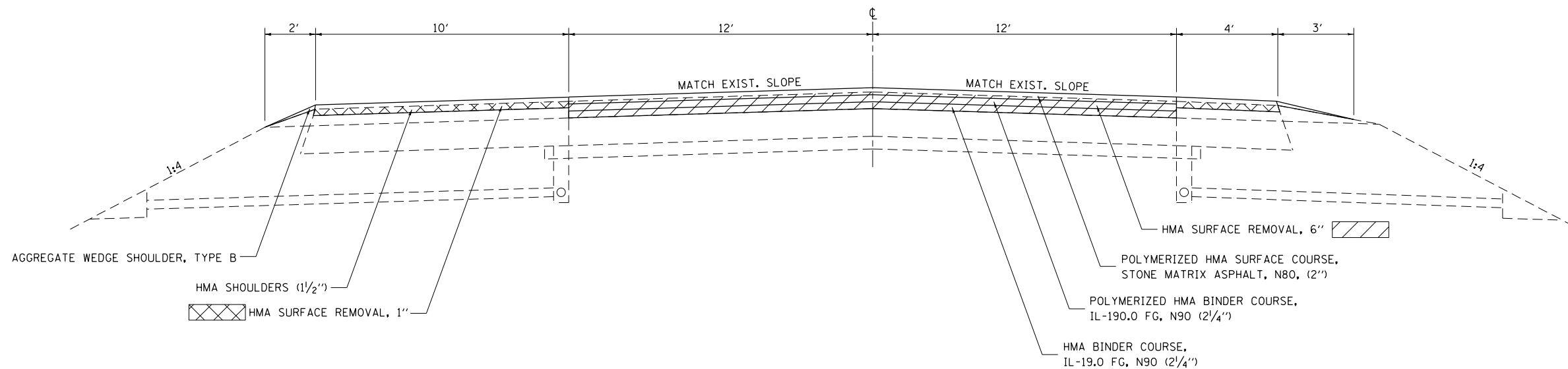

PROPOSED TYPICAL SECTION

EASTBOUND
 STA. 726+40.78 TO STA. 734+69.44
 STA. 783+60.55 TO STA. 1043+60.00

NOTE: NOTE TO SCALE

FILE NAME =	USER NAME = steffenmk	DESIGNED -	REVISED -
c:\pwwork\pwwork\stefhenk\d0338930\074255-sht-typicals.dgn		DRAWN -	REVISED -
Default	PLOT SCALE = 100.0000' / in.	CHECKED -	REVISED -
	PLOT DATE = 6/12/2014	DATE -	REVISED -

**STATE OF ILLINOIS
 DEPARTMENT OF TRANSPORTATION**

PROPOSED TYPICAL CROSS SECTIONS

SCALE: N.A. SHEET 4 OF 6 SHEETS STA. TO STA.

F.A.I. RTE.	SECTION	COUNTY	TOTAL SHEETS	SHEET NO.
70	(26-3,4)RS-3	FAYETTE	31	10
CONTRACT NO. 74255			ILLINOIS FED. AID PROJECT	

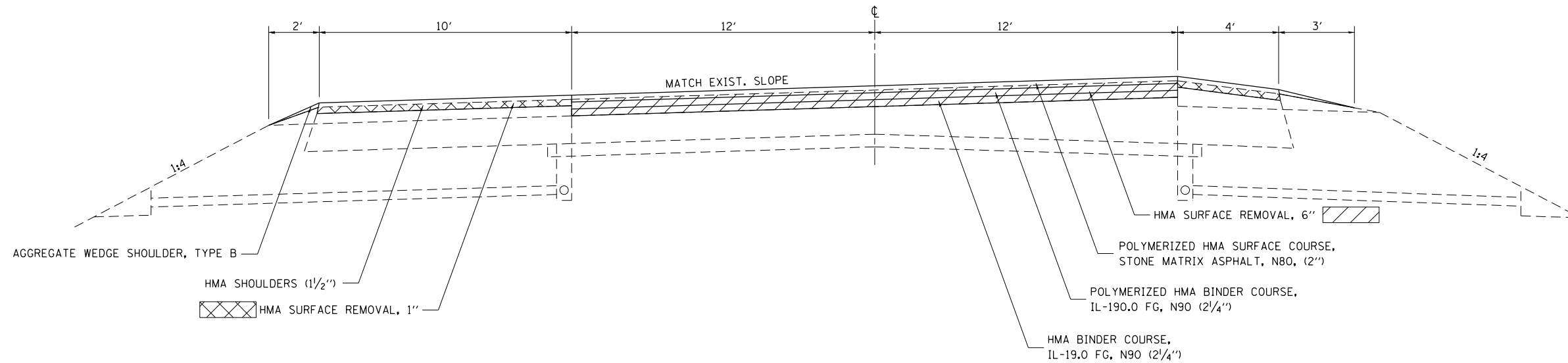

PROPOSED TYPICAL SECTION

WESTBOUND
 STA. 734+69.44 TO STA. 783+60.55

NOTE: NOTE TO SCALE

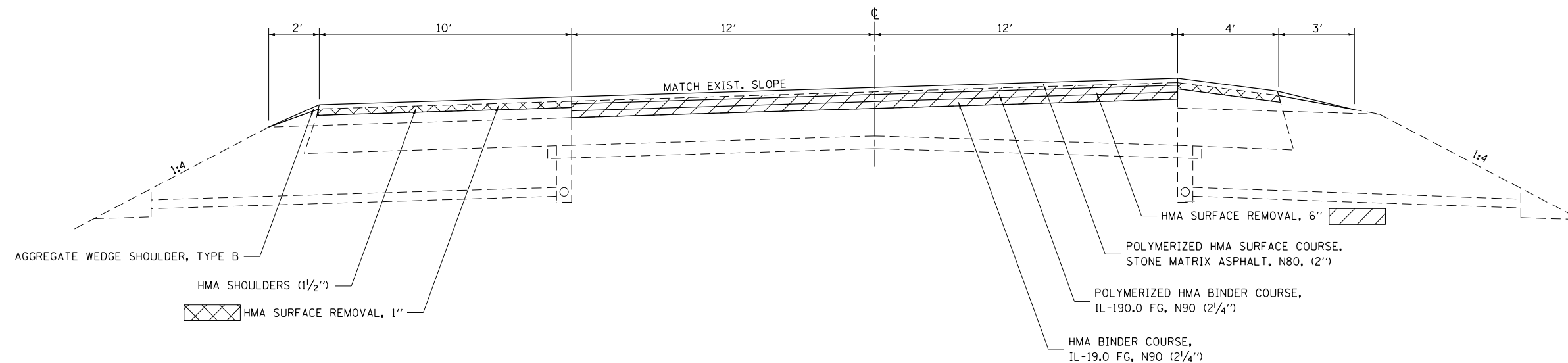

PROPOSED TYPICAL SECTION

EASTBOUND
 STA. 734+69.44 TO STA. 783+60.55

NOTE: NOTE TO SCALE

FILE NAME =	USER NAME = steffenmk	DESIGNED -	REVISED -
c:\pwork\pwork\stevfennk\d0338930\074255-sht-typicals.dgn		DRAWN -	REVISED -
Default	PLOT SCALE = 100.0000' / 1in.	CHECKED -	REVISED -
	PLOT DATE = 6/12/2014	DATE -	REVISED -

**STATE OF ILLINOIS
 DEPARTMENT OF TRANSPORTATION**

PROPOSED TYPICAL CROSS SECTIONS

SCALE: N.A. SHEET 5 OF 6 SHEETS STA. TO STA.

F.A.I. RTE.	SECTION	COUNTY	TOTAL SHEETS	SHEET NO.
70	(26-3,4)RS-3	FAYETTE	31	11
CONTRACT NO. 74255			ILLINOIS FED. AID PROJECT	

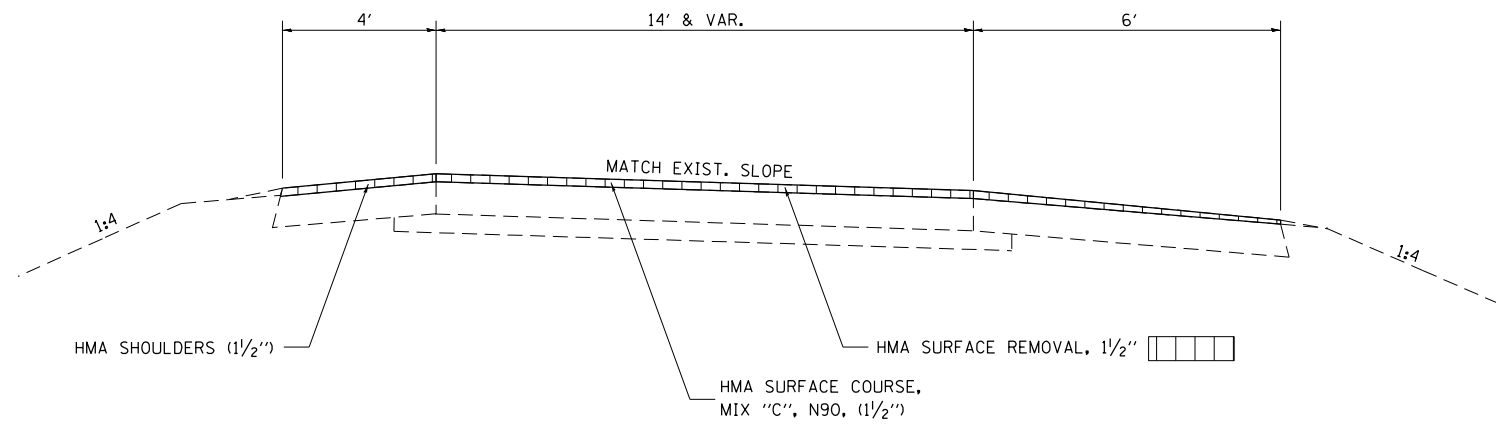

PROPOSED TYPICAL SECTION

RAMPS A, B, C, & D

NOTE: NOTE TO SCALE

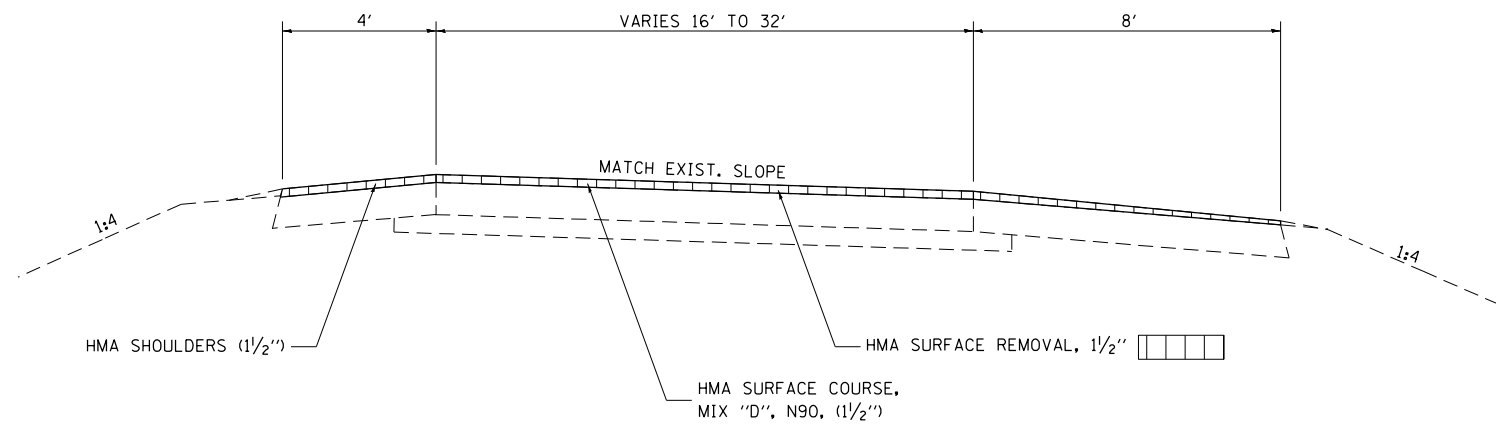

PROPOSED TYPICAL SECTION

WEIGH STATION RAMPS

NOTE: NOTE TO SCALE

FILE NAME =	USER NAME = steffenmk	DESIGNED -	REVISED -
ci:\pw\work\p\dot\steffenmk\d0338930\074255-sht-typicals.dgn		DRAWN -	REVISED -
	PLOT SCALE = 100.0000' / in.	CHECKED -	REVISED -
Default	PLOT DATE = 6/12/2014	DATE -	REVISED -

**STATE OF ILLINOIS
DEPARTMENT OF TRANSPORTATION**

PROPOSED TYPICAL CROSS SECTIONS

SCALE: N.A. SHEET 6 OF 6 SHEETS STA. TO STA.

F.A.I. RTE.	SECTION	COUNTY	TOTAL SHEETS	SHEET NO.
70	(26-3,4)RS-3	FAYETTE	31	12
CONTRACT NO. 74255			ILLINOIS FED. AID PROJECT	

PRE-STAGE TYPICAL CROSS SECTION

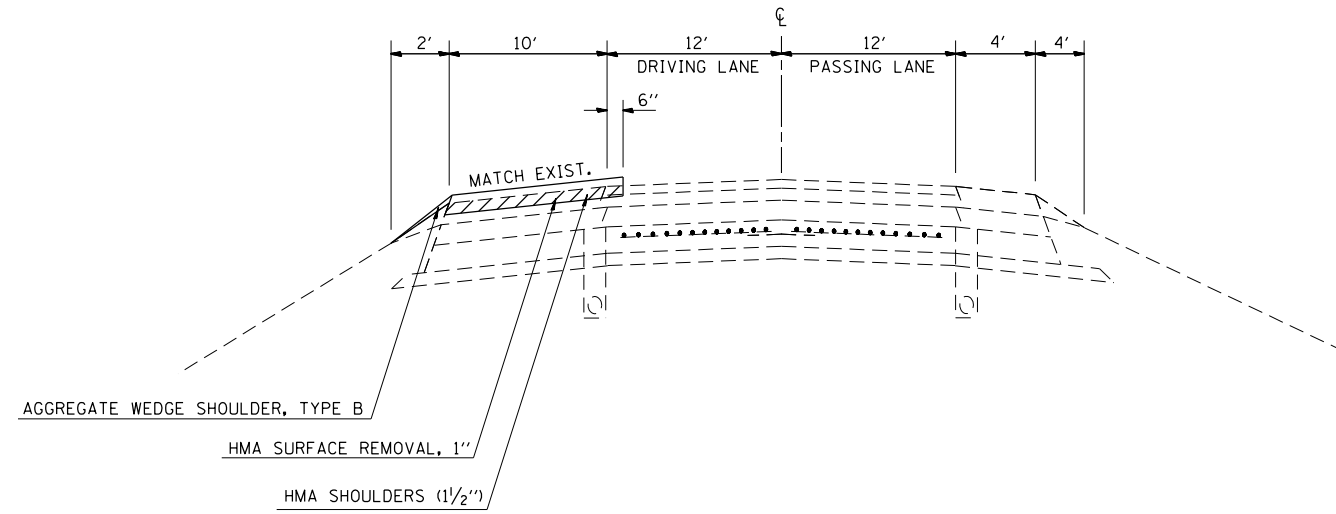

NOTE: NOT TO DRAWN TO SCALE

STAGE 1A TYPICAL CROSS SECTION

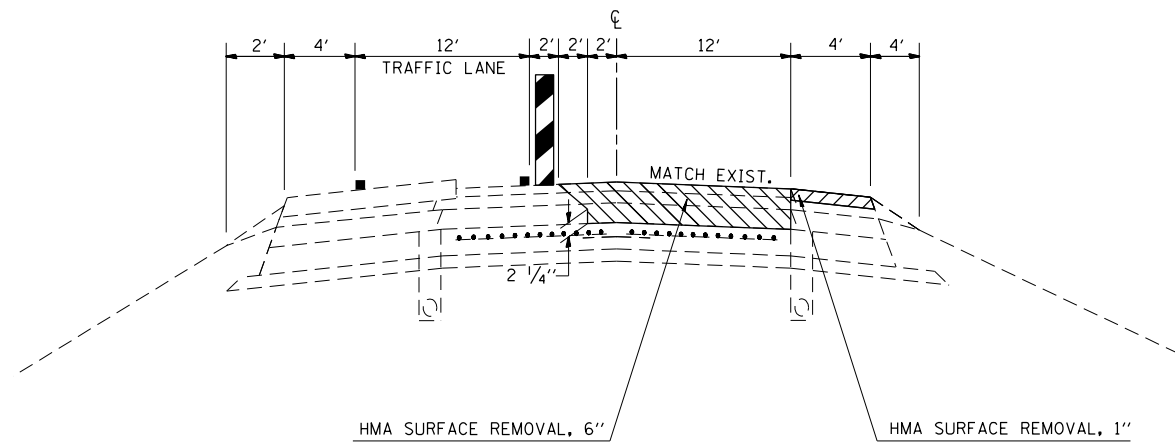

STAGE 1B TYPICAL CROSS SECTION
WESTBOUND LANE ONLY

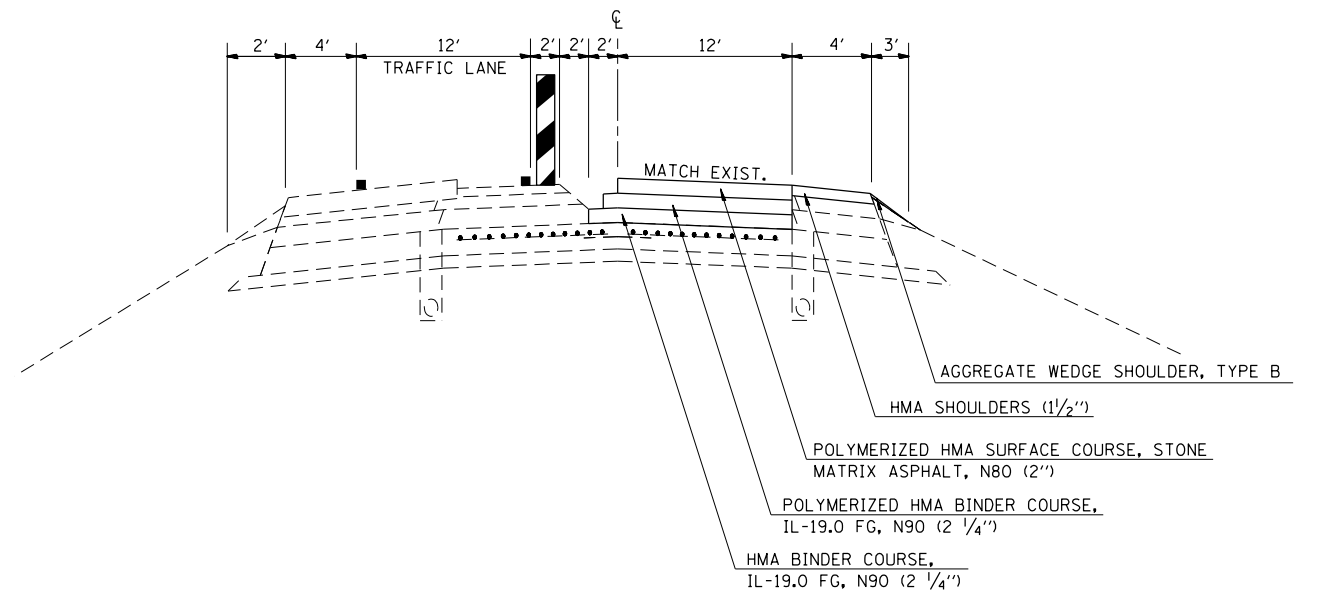

NOTE: NOT TO DRAWN TO SCALE

FILE NAME =	USER NAME = steffenmk	DESIGNED -	REVISED -
ci:\pw\work\p\dot\stefjenmk\d0338930\074255-sht-stgtypicals.dgn		DRAWN -	REVISED -
Default	PLOT SCALE = 100.0000' / in.	CHECKED -	REVISED -
	PLOT DATE = 6/12/2014	DATE -	REVISED -

**STATE OF ILLINOIS
DEPARTMENT OF TRANSPORTATION**

STAGING TYPICAL CROSS SECTIONS

SCALE: N/A SHEET 1 OF 2 SHEETS STA. TO STA.

F.A.I. RTE.	SECTION	COUNTY	TOTAL SHEETS	SHEET NO.
70	(26-3,4)RS-3	FAYETTE	31	13
CONTRACT NO. 74255			ILLINOIS FED. AID PROJECT	

STAGE 2A TYPICAL CROSS SECTION

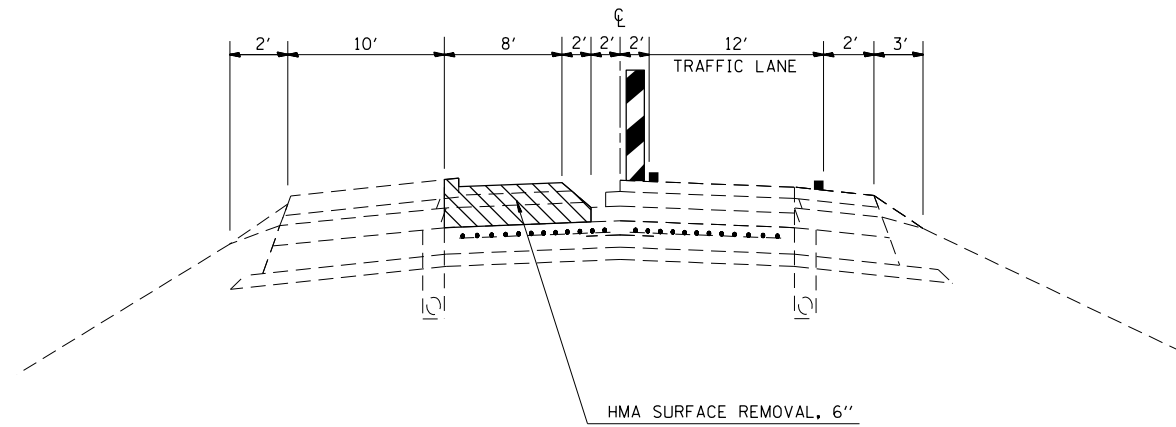

STAGE 2B TYPICAL CROSS SECTION

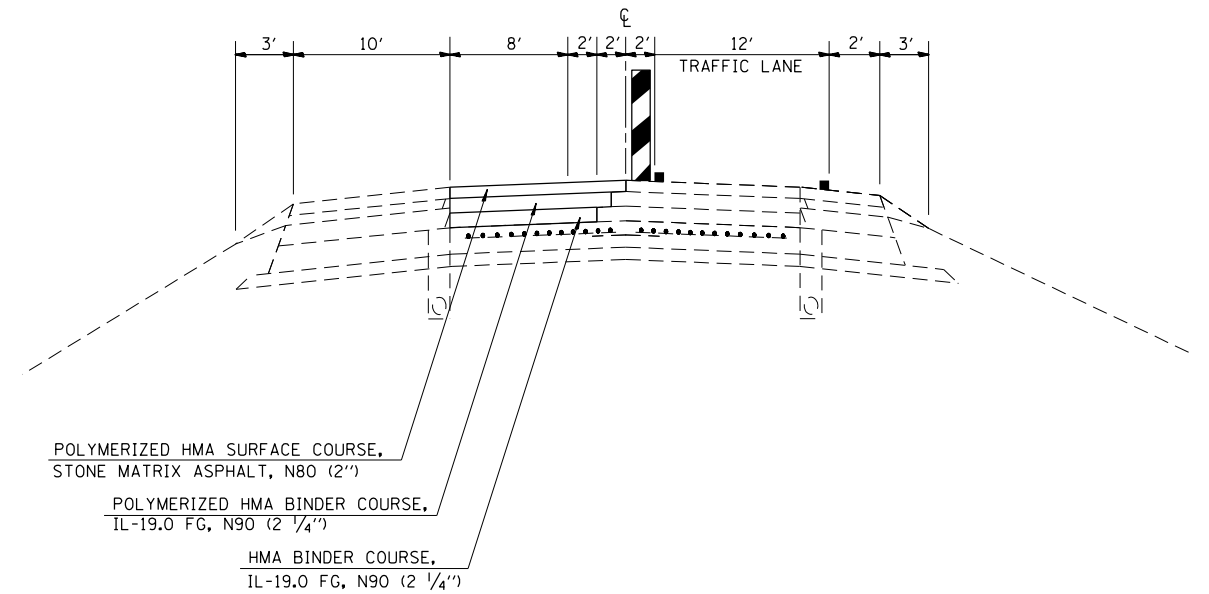

NOTE:
 THE 6" WIDE BY 1/2" THICK BLOCK OF PAVEMENT CONSTRUCTED DURING PRE-STAGE SHALL BE MILLED WITH THE EXISTING DRIVING LANE PAVEMENT. THIS WORK SHALL NOT BE PAID FOR SEPARATELY BUT SHALL BE INCLUDED IN THE COST FOR HMA SURFACE REMOVAL, 6"

NOTE: NOT TO DRAWN TO SCALE

FILE NAME =	USER NAME = steffenmk	DESIGNED -	REVISED -
c:\pw\work\p\dot\steffenmk\d0338930\074255-sht-stgtypicals.dgn		DRAWN -	REVISED -
Default	PLOT SCALE = 100.0000' / in.	CHECKED -	REVISED -
	PLOT DATE = 6/12/2014	DATE -	REVISED -

STATE OF ILLINOIS
 DEPARTMENT OF TRANSPORTATION

STAGING TYPICAL CROSS SECTIONS

SCALE: N/A SHEET 2 OF 2 SHEETS STA. TO STA.

F.A.I. RTE.	SECTION	COUNTY	TOTAL SHEETS	SHEET NO.
70	(26-3,4)RS-3	FAYETTE	31	14
			CONTRACT NO. 74255	
ILLINOIS FED. AID PROJECT				

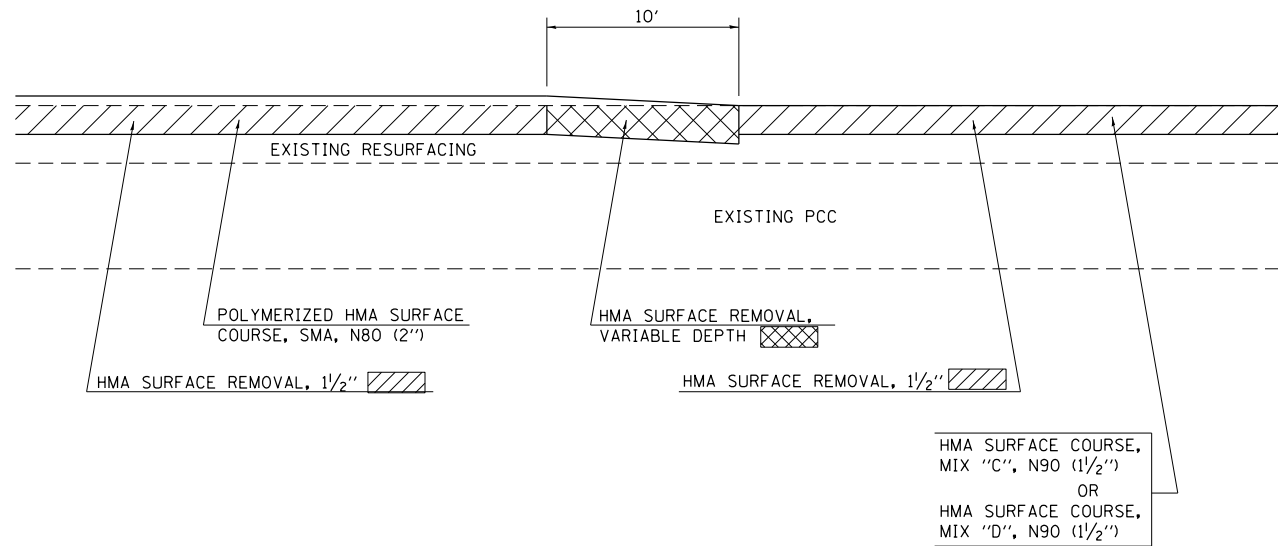

RAMP SURFACE COURSE TRANSITION DETAIL

- RAMP A:** STA. 0+97 TO STA. 1+07
- RAMP B:** STA. 11+81 TO STA. 11+91
- RAMP C:** STA. 12+16 TO STA. 12+26
- RAMP D:** STA. -0+70 TO STA. -0+60
- WEIGH STATION EXIT:** STA. -0+46 TO STA. -0+36
- WEIGH STATION ENTRANCE:** STA. 919+59 TO STA. 919+69

NOTE: NOT TO SCALE

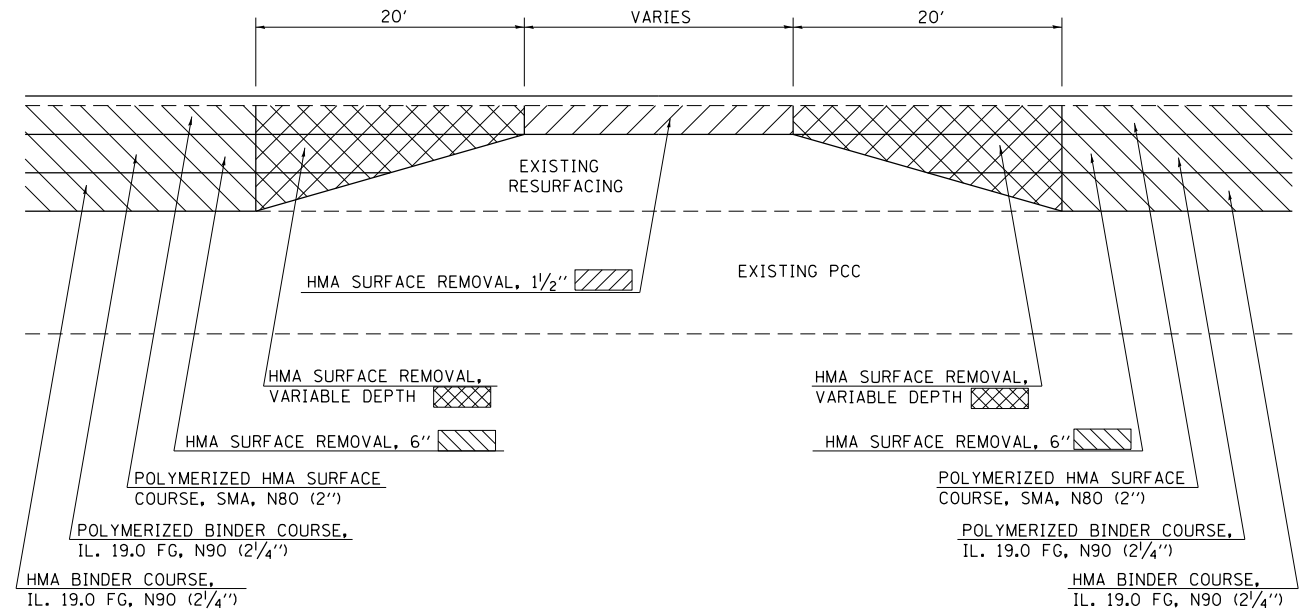

EASTBOUND - DRIVING LANE ONLY

- STA. 688+75 TO STA. 690+75
- STA. 713+33 TO STA. 716+53

WESTBOUND - DRIVING LANE ONLY

- STA. 690+20 TO STA. 694+60
- STA. 719+25 TO STA. 721+25

I-70 PAVING TRANSITION DETAIL

NOTE: THE PAVING TRANSITION IS TO BE USED IN CONJUNCTION WITH TEMPORARY RAMPS TO MAINTAIN ACCESS TO THE RAMPS AT THE U. S. RTE. 40 INTERCHANGE

NOTE: NOT TO SCALE

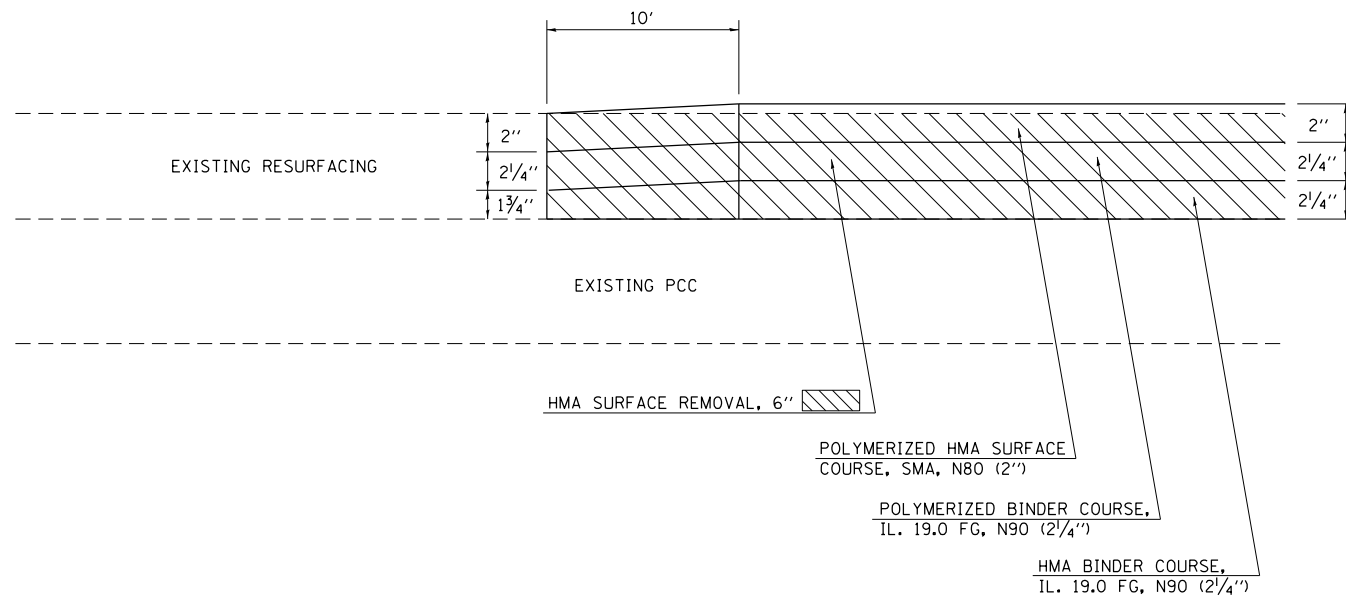

EASTBOUND
STA. 656+13 TO STA. 656+23

WESTBOUND
STA. 656+13 TO STA. 656+23

START OF PROJECT PAVING TRANSITION DETAIL

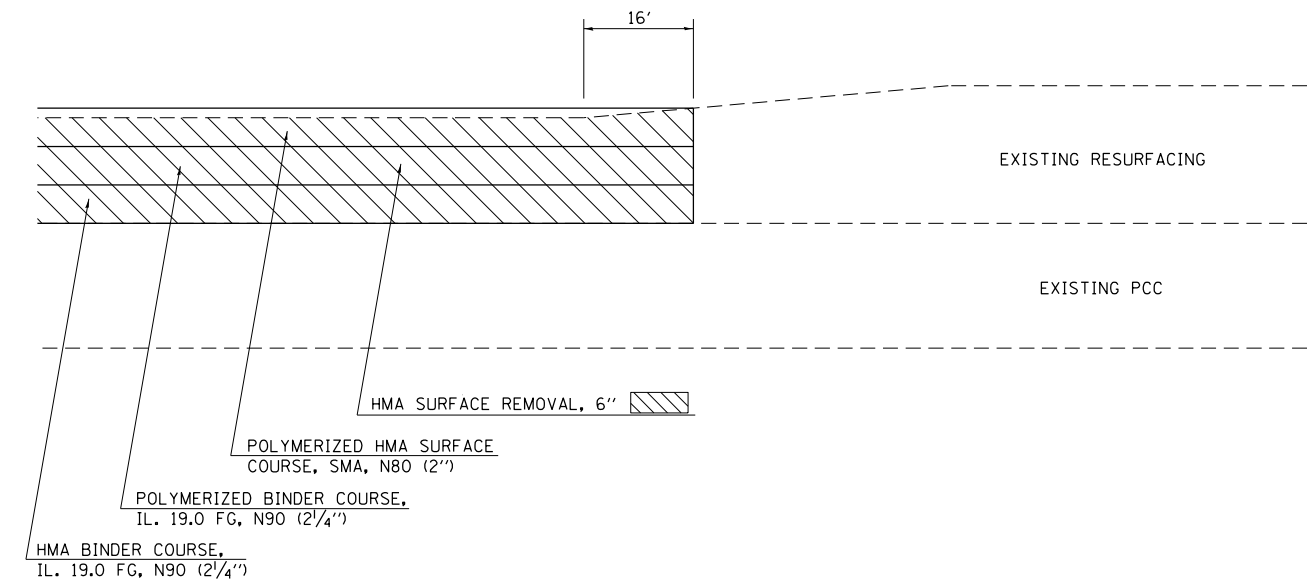

EASTBOUND
STA. 1043+44 TO STA. 1043+60

WESTBOUND
STA. 1043+44 TO STA. 1043+60

END OF PROJECT PAVING TRANSITION DETAIL

NOTE: THE ADDITIONAL THICKNES OF HMA SURFACE REMOVAL SHALL NOT BE PAID FOR SEPARATELY BUT SHALL BE INCLUDED IN THE COST OF HMA SURFACE REMOVAL, 6"

FILE NAME =	USER NAME = steffenmk	DESIGNED -	REVISED -
c:\pwork\pwork\steffenmk\d0338930\074255-sht-details.dgn		DRAWN -	REVISED -
Default	PLOT SCALE = 100.0000' / 1in.	CHECKED -	REVISED -
	PLOT DATE = 6/12/2014	DATE -	REVISED -

**STATE OF ILLINOIS
DEPARTMENT OF TRANSPORTATION**

TRANSITION DETAILS

SCALE: N/A SHEET 1 OF 1 SHEETS STA. TO STA.

F.A.I. RTE.	SECTION	COUNTY	TOTAL SHEETS	SHEET NO.
70	(26-3,4)RS-3	FAYETTE	31	15
CONTRACT NO. 74255			ILLINOIS FED. AID PROJECT	

PAVING SCHEDULE				LENGTH	TEMPORARY RAMPS	HOT-MIX ASPHALT SURFACE REMOVAL, 1"	HOT-MIX ASPHALT SURFACE REMOVAL, 1 1/2"	HOT-MIX ASPHALT SURFACE REMOVAL, 6"	HOT-MIX ASPHALT SURFACE REMOVAL, VARIABLE DEPTH	BITUMINOUS MATERIALS (PRIME COAT)	HOT-MIX ASPHALT BINDER COURSE, 1L-19.0 FG, N90	POLYMERIZED HOT-MIX ASPHALT BINDER COURSE, 1L-19.0 FG, N90	POLYMERIZED HOT-MIX ASPHALT SURFACE COURSE, SMA, N80	MATERIAL TRANSFER DEVICE	HOT-MIX ASPHALT SURFACE COURSE, MIX "C", N90	HOT-MIX ASPHALT SURFACE COURSE, MIX "D", N90	HOT-MIX ASPHALT SHOULDERS	SHOULDER RUMBLE STRIPS, 16 INCH	AGGREGATE WEDGE SHOULDER, TYPE B
STATION	TO	STATION	FEET	SO YD	SO YD	SO YD	SO YD	SO YD	SO YD	POUND	TON	TON	TON	TON	TON	TON	TON	FOOT	TON
EASTBOUND																			
656+13	TO	685+25	2912	-	4691.6	-	7765.3	-	-	9100.0	978.4	978.4	1009.5	2966.3	-	-	394.1	5824	46.1
685+25	TO	688+75	350	-	563.9	373.3	933.3	-	-	1426.3	117.6	117.6	169.4	404.6	-	-	47.4	350	5.5
688+75	TO	688+95	20	-	32.2	41.5	26.7	26.7	99.5	4.2	5.9	12.3	22.4	-	-	2.7	20	0.3	
688+95	TO	690+55	160	236.4	257.8	622.7	213.3	-	-	492.0	26.9	26.9	108.6	162.4	-	-	21.7	160	2.5
690+55	TO	690+75	20	-	43.2	50.1	26.7	26.7	106.9	4.2	5.9	12.7	22.8	-	-	3.6	20	0.3	
690+75	TO	691+52	77	-	204.9	172.0	205.3	-	-	452.2	25.9	25.9	52.3	104.1	-	-	17.2	77	1.2
691+52	TO	712+48	2096	-	3376.9	-	5589.3	-	-	6550.0	704.3	704.3	726.6	2135.2	-	-	283.7	4192	33.2
712+48	TO	713+33	85	-	238.8	132.8	226.7	-	-	428.3	28.6	28.6	46.7	103.9	-	-	20.1	85	1.3
713+33	TO	713+53	20	-	46.5	31.1	26.7	26.7	96.4	4.2	5.9	11.0	21.1	-	-	3.9	20	0.3	
713+53	TO	716+53	300	443.3	483.3	971.4	400.0	-	-	832.5	50.4	50.4	177.7	278.5	-	-	40.6	300	4.7
716+53	TO	716+73	20	-	32.2	31.0	26.7	26.7	90.5	4.2	5.9	11.0	21.1	-	-	2.7	20	0.3	
716+73	TO	723+10	637	-	1026.3	521.7	1698.7	-	-	2468.4	214.0	214.0	289.8	717.8	-	-	86.2	637	10.1
723+10	TO	870+87	14777	-	23807.4	-	39405.3	-	-	46178.1	4965.1	4965.1	5122.7	15052.9	-	-	1999.8	29554	233.7
870+87	TO	877+10	623	-	1330.9	962.0	1661.3	-	-	2670.4	209.3	209.3	301.5	720.1	-	-	111.9	623	9.8
877+10	TO	919+56	4246	-	6840.8	-	11322.7	-	-	13268.8	1426.7	1426.7	1471.9	4325.3	-	-	574.6	8492	67.2
919+56	TO	934+20	1464	-	2986.8	1908.1	3904.0	-	-	6211.9	491.9	491.9	708.4	1692.2	-	-	251.0	1464	23.1
934+20	TO	1043+60	10940	-	17625.6	-	29173.3	-	-	34187.5	3675.8	3675.8	3792.5	11144.1	-	-	1480.5	21880	173.0
EB TOTALS:			38747	680	63589	5818	102605	107	-	124660	12932	12939	14025	39895	0	0	5342	73718	613
WESTBOUND																			
656+13	TO	686+90	3077	-	4957.4	-	8205.3	-	-	9615.6	1033.9	1033.9	1066.7	3134.5	-	-	416.4	6154	48.7
686+90	TO	690+20	330	-	531.7	253.4	880.0	-	-	1212.8	110.9	110.9	140.6	362.4	-	-	44.7	330	5.2
690+20	TO	690+40	20	-	32.2	21.8	26.7	26.7	82.5	4.2	5.9	9.8	19.9	-	-	2.7	20	0.3	
690+40	TO	694+40	400	591.1	644.4	725.0	533.3	-	-	1030.0	67.2	67.2	213.8	348.2	-	-	54.1	400	6.3
694+40	TO	694+60	20	-	37.1	31.1	26.7	26.7	92.2	4.2	5.9	11.0	21.1	-	-	3.1	20	0.3	
694+60	TO	697+49	289	-	666.4	449.9	770.7	-	-	1390.8	97.1	97.1	158.6	352.8	-	-	56.0	289	4.6
697+49	TO	718+85	2136	-	3441.3	-	5696.0	-	-	6675.0	717.7	717.7	740.5	2175.9	-	-	289.1	4272	33.8
718+85	TO	719+25	40	-	102.5	89.6	106.7	-	-	201.1	13.4	13.4	22.5	49.3	-	-	8.6	40	0.6
719+25	TO	719+45	20	-	43.7	49.7	26.7	26.7	100.2	4.2	5.9	11.7	21.8	-	-	3.7	20	0.3	
719+45	TO	721+05	160	236.4	257.8	623.0	213.3	-	-	492.0	26.9	26.9	108.6	162.4	-	-	21.7	160	2.5
721+05	TO	721+25	20	-	32.2	41.2	26.7	26.7	99.5	4.2	5.9	12.3	22.4	-	-	2.7	20	0.3	
721+25	TO	724+65	340	-	547.8	360.9	906.7	-	-	1385.5	114.2	114.2	164.5	392.9	-	-	46.0	340	5.4
724+65	TO	1043+60	31895	-	51386.4	-	85053.3	-	-	99671.9	10716.7	10716.7	11056.9	32490.3	-	-	4316.5	63790	504.5
WB TOTALS:			38747	828	62681	2646	102472	107	-	122049	12915	12922	13718	39554	0	0	5265	75855	613

FILE NAME =	USER NAME = steffenmk	DESIGNED -	REVISED -	STATE OF ILLINOIS DEPARTMENT OF TRANSPORTATION	SCHEDULE OF QUANTITIES				F.A.I. RTE.	SECTION	COUNTY	TOTAL SHEETS	SHEET NO.
c:\pw_work\p\dot\steffenmk\d0338930\074255-sht-sch.dgn	DRAWN -	REVISED -	70						(26-3,4)RS-3	FAYETTE	31	16	
Default	PLOT SCALE = 100.0000' / in.	CHECKED -	REVISED -		SCALE: N/A	SHEET 1 OF 5 SHEETS	STA.	TO STA.	CONTRACT NO. 74255				
	PLOT DATE = 6/12/2014	DATE -	REVISED -		ILLINOIS FED. AID PROJECT								

PAVING
SCHEDULE
(Cont'd)

STATION	TO	STATION	LENGTH FEET	TEMPORARY RAMPS SQ YD	HOT-MIX ASPHALT SURFACE REMOVAL, 1" SQ YD	HOT-MIX ASPHALT SURFACE REMOVAL, 1 1/2" SQ YD	HOT-MIX ASPHALT SURFACE REMOVAL, 6" SQ YD	HOT-MIX ASPHALT SURFACE REMOVAL, VARIABLE DEPTH SQ YD	BITUMINOUS MATERIALS (PRIME COAT) POUND	HOT-MIX ASPHALT BINDER COURSE, IL-19.0 FG, N90 TON	POLYMERIZED HOT-MIX ASPHALT BINDER COURSE, IL-19.0 FG, N90 TON	POLYMERIZED HOT-MIX ASPHALT SURFACE COURSE, SMA, N80 TON	MATERIAL TRANSFER DEVICE TON	HOT-MIX ASPHALT SURFACE COURSE, MIX "C", N90 TON	HOT-MIX ASPHALT SURFACE COURSE, MIX "D", N90 TON	HOT-MIX ASPHALT SHOULDERS TON	SHOULDER RUMBLE STRIPS, 16 INCH FOOT	AGGREGATE WEDGE SHOULDER, TYPE B TON
RAMP A																		
0+97	TO	1+07	10	-	-	-	-	15.6	-	-	-	-	-	-	-	-	-	-
1+07	TO	11+64	1057	42.2	-	2818.7	-	-	1268.4	-	-	-	-	138.1	-	98.7	-	-
RAMP A TOTALS:			1067	42	0	2819	0	16	1268	0	0	0	0	138	0	99	0	0
RAMP B																		
1+15	TO	11+81	1066	42.2	-	2842.7	-	-	1279.2	-	-	-	-	139.3	-	99.5	-	-
11+81	TO	11+91	10	-	-	-	-	15.6	-	-	-	-	-	-	-	-	-	-
RAMP B TOTALS:			1076	42	0	2843	0	16	1279	0	0	0	0	139	0	100	0	0
RAMP C																		
1+69	TO	12+16	1047	42.2	-	2792.0	-	-	1256.4	-	-	-	-	136.8	-	97.7	-	-
12+16	TO	12+26	10	-	-	-	-	15.6	-	-	-	-	-	-	-	-	-	-
RAMP C TOTALS:			1057	42	0	2792	0	16	1256	0	0	0	0	137	0	98	0	0
RAMP D																		
-0+70	TO	-0+60	10	-	-	-	-	15.6	-	-	-	-	-	-	-	-	-	-
-0+60	TO	8+20	880	44.4	-	2346.7	-	-	1056.0	-	-	-	-	115.0	-	82.1	-	-
RAMP D TOTALS:			890	44	0	2347	0	16	1056	0	0	0	0	115	0	82	0	0
WEIGH STATION EXIT																		
-0+46	TO	-0+36	10	-	-	-	-	17.8	-	-	-	-	-	-	-	-	-	-
-0+36	TO	0+94	130	53.3	-	404.4	-	-	182.0	-	-	-	-	-	19.4	14.6	-	-
WEIGH ST EXIT TOTALS:			140	53	0	404	0	18	182	0	0	0	0	0	19	15	0	0
WEIGH STATION ENTRANCE																		
908+32	TO	918+32	1000	35.6	-	4666.7	-	-	2100.0	-	-	-	-	-	336.0	112	-	-
918+32	TO	919+17	85	-	-	340.0	-	-	153.0	-	-	-	-	-	22.2	9.5	-	-
919+17	TO	919+59	42	31.1	-	112.0	-	-	2074.8	-	-	-	-	-	6.3	4.7	-	-
919+59	TO	919+69	10	-	-	-	-	17.8	-	-	-	-	-	-	-	-	-	-
WEIGH ST ENT. TOTALS:			1137	66.7	0	5118.7	0	17.8	4328	0	0	0	0	0	364.5	126.2	0	0
PROJECT TOTALS:			82861	1798	126270	24786	205077	311	256079	25847	25860	27742	79449	529	384	11126	149573	1226

PAVEMENT MARKING SCHEDULE			LENGTH	SHORT TERM PAVEMENT MARKING	WORK ZONE PAVEMENT MARKING REMOVAL	PAVEMENT MARKING REMOVAL	TEMPORARY PAVEMENT MARKING - LINE 4"	TEMPORARY PAVEMENT MARKING - LINE 6"	PREFORMED PLASTIC PAVEMENT MARKING, TY B - INLAID - LINE 6"	THERMOPLASTIC PAVEMENT MARKING - LINE 4"	GROOVING FOR RECESSED PAVEMENT MARKING, 5"	THERMOPLASTIC PAVEMENT MARKING - LINE 8"	GROOVING FOR RECESSED PAVEMENT MARKING, 9"	RAISED REFLECTIVE PAVEMENT MARKERS	DELINEATOR REMOVAL	DELINEATORS
STATION TO	STATION	FOOT	FOOT	SQ FT	SQ FT	FOOT	FOOT	FOOT	FOOT	FOOT	FOOT	FOOT	FOOT	EACH	EACH	EACH
EASTBOUND																
656+13	TO 687+86	3173	444	148.1	2512.0	6433	793	793	6433	6433	0	0	0	79	10	10
687+86	TO 692+03	417	42	13.9	330.1	834	104	104	417	417	417	417	417	10	1	1
692+03	TO 712+23	2020	283	94.3	1599.2	4257	505	505	4257	4257	0	0	0	51	10	10
712+23	TO 716+56	433	43	14.4	342.8	866	108	108	433	433	433	433	433	11	1	1
716+56	TO 874+10	15754	2206	735.2	12471.9	31616	3939	3939	31616	31616	0	0	0	394	42	42
874+10	TO 878+10	400	40	13.3	316.7	800	100	100	400	400	400	400	400	10	1	1
878+10	TO 920+50	4240	593	197.9	3356.7	8480	1060	1060	8480	8480	0	0	0	106	11	11
920+50	TO 925+70	520	52	17.3	411.7	1040	130	130	520	520	520	520	520	13	1	1
925+70	TO 1043+60	11790	1651	550.2	9333.8	23863	2948	2948	23863	23863	0	0	0	295	36	36
EB TOTALS:		-	5354	1785	30675	78189	9687	9687	76419	76419	1770	1770	1770	969	113	113
WESTBOUND																
656+13	TO 693+47	3734	523	174.3	2956.1	7686	934	934	7686	7686	0	0	0	93	14	14
693+47	TO 697+72	425	42	14.2	336.5	850	106	106	425	425	425	425	425	11	1	1
697+72	TO 718+10	2038	285	95.1	1613.4	4076	510	510	4076	4076	0	0	0	51	5	5
718+10	TO 722+10	400	40	13.3	316.7	800	100	100	400	400	400	400	400	10	1	1
722+10	TO 1043+60	32150	4501	1500.3	25452.1	64386	8038	8038	64386	64386	0	0	0	804	83	83
WB TOTALS:		-	5391	1797	30675	77798	9687	9687	76973	76973	825	825	825	969	104	104
RAMPS																
RAMP A		1453	99	33.1	825.0	2905	0	0	2480	2480	425	425	425	0	12	12
RAMP B		1387	95	31.7	972.0	2775	0	0	2375	2375	400	400	400	0	14	14
RAMP C		1458	99	33.1	925.0	2916	0	0	2483	2483	433	433	433	0	14	14
RAMP D		1243	83	27.4	968.3	2475	0	0	2058	2058	417	417	417	0	14	14
WEIGH STATION EXIT		430	20	6.5	295.7	887	0	0	487	487	400	400	400	0	5	5
WEIGH STATION ENTRANCE		1738	118	39.4	1158.7	3476	0	0	2956	2956	520	520	520	0	16	16
RAMP TOTALS:		-	514	171	5145	15434	0	0	12839	12839	2595	2595	2595	0	75	75
PROJECT TOTALS:		-	11259	3753	66494	171421	19374	19374	166231	166231	5190	5190	5190	1938	292	292

FILE NAME =	USER NAME = steffenmk	DESIGNED -	REVISED -	STATE OF ILLINOIS DEPARTMENT OF TRANSPORTATION	SCHEDULE OF QUANTITIES				F.A.I. RTE.	SECTION	COUNTY	TOTAL SHEETS	SHEET NO.
c:\pw\work\p\idot\steffenmk\d0338930\074255-sht-sch.dgn	DRAWN -	REVISED -	70						(26-3,4)RS-3	FAYETTE	31	18	
Default	PLOT SCALE = 100.0000' / in.	CHECKED -	REVISED -		SCALE: N/A	SHEET 3 OF 5 SHEETS	STA.	TO STA.	CONTRACT NO. 74255		ILLINOIS FED. AID PROJECT		
	PLOT DATE = 6/12/2014	DATE -	REVISED -										

PATCHING SCHEDULE	CLASS A PATCHES, THPE II, 8 INCH	CLASS A PATCHES, TYPE III, 8 INCH	CLASS A PATCHES, TYPE II, 12 INCH	CLASS A PATCHES, TYPE III, 12 INCH	CLASS A PATCHES, TYPE II, 14 INCH	CLASS B PATCHES, TYPE II, 11 INCH	CLASS B PATCHES, TYPE III, 11 INCH	CLASS B PATCHES, TYPE II, 11 INCH	CLASS B PATCHES, TYPE II, 13 INCH	CLASS B PATCHES, TYPE III, 13 INCH	CLASS B PATCHES, TYPE II, 16 INCH	CLASS B PATCHES, TYPE III, 16 INCH	SAW CUTS	DOWEL BARS, 1 1/2"	TIE BARS, 1 1/4"	PAVEMENT FABRIC	PATCHING REINFORCEMENT	PAVED SHOULDER REMOVAL	HOT-MIX ASPHALT SHOULDERS
	SQ YD	SQ YD	SQ YD	SQ YD	SQ YD	SQ YD	SQ YD	SQ YD	SQ YD	SQ YD	SQ YD	SQ YD	FOOT	EACH	EACH	SQ YD	SQ YD	SQ YD	TON
EASTBOUND	-	-	-	-	120.1	-	-	-	-	-	126.5	56.0	1678	300	14	56.0	120.1	3616.4	2835.2
WESTBOUND	-	-	-	-	-	-	-	-	-	-	828.2	20.0	4296	1680	7	20.0	-	3616.4	2835.2
RAMP A	-	-	-	-	-	-	-	-	49.2	15.6	-	-	880	370	-	15.6	-	-	-
RAMP B	-	-	-	-	-	-	-	-	29.7	-	-	-	160	68	-	-	-	-	-
RAMP C	-	-	-	-	-	-	-	-	55.0	-	-	-	310	130	-	-	-	-	-
RAMP D	-	-	-	-	-	-	-	-	9.3	-	-	-	54	24	-	-	-	-	-
WEIGH STATION OFF RAMP	-	-	-	-	-	39.3	16.7	80.8	-	-	-	-	492	124	57	97.5	-	-	-
WEIGH STATION	55.8	24.9	55.8	24.9	-	-	-	-	-	-	-	-	1464	-	-	-	385.4	-	-
TOTALS:	56	25	56	25	120	39	17	81	143	16	955	76	9334	2696	78	189	506	7233	5670

GUARDRAIL SCHEDULE	GUARDRAIL REMOVAL	TRAFFIC BARRIER TERMINAL, TYPE 6	TRAFFIC BARRIER TERMINAL, TYPE 6B	TRAFFIC BARRIER TERMINAL, TYPE 6B (SPECIAL)	TRAFFIC BARRIER TERMINAL, TYPE 2	STEEL PLATE BEAM GUARD RAIL, TYPE A, 6 FOOT POSTS	TRAFFIC BARRIER TERMINAL, TYPE 1 (SPECIAL) TANGENT	TERMINAL MARKERS - DIRECT APPLIED	GUARDRAIL MARKERS, TYPE A
	FOOT	EACH	EACH	EACH	EACH	FOOT	EACH	EACH	EACH
I 70 EB									
SN 026-0076 PIER PROTECTION	854.0	0.0	0.0	1.0	1.0	487.5	1.0	1.0	8.0
STA. 827+11 TO STA. 827+77	66.0	0.0	0.0	0.0	1.0	162.5	1.0	1.0	4.0
SN 026-0054 PIER PROTECTION	468.0	0.0	1.0	0.0	0.0	162.5	1.0	1.0	4.0
STA. 872+02 TO STA. 874+30	228.0	0.0	0.0	0.0	1.0	162.5	1.0	1.0	4.0
SN 026-0078 PIER PROTECTION	369.0	0.0	1.0	0.0	0.0	162.5	1.0	1.0	4.0
I 70 WB									
SN 026-0076 PIER PROTECTION	680.0	0.0	1.0	0.0	0.0	162.5	1.0	1.0	4.0
SN 026-0054 PIER PROTECTION	467.0	0.0	1.0	0.0	0.0	162.5	1.0	1.0	4.0
SN 026-0078 PIER PROTECTION	442.0	0.0	1.0	0.0	0.0	162.5	1.0	1.0	4.0
OVERHEAD STURCTURE									
SN 026-0049 SE CORNER	367.0	1.0	0.0	0.0	0.0	250.0	1.0	1.0	4.0
SN 026-0049 SW CORNER	363.0	1.0	0.0	0.0	0.0	250.0	1.0	1.0	4.0
SN 026-0049 NE CORNER	367.0	1.0	0.0	0.0	0.0	250.0	1.0	1.0	4.0
SN 026-0049 NW CORNER	380.0	1.0	0.0	0.0	0.0	262.5	1.0	1.0	4.0
TOTALS=	5051.0	4.0	5.0	1.0	3.0	2637.5	12.0	12.0	52.0

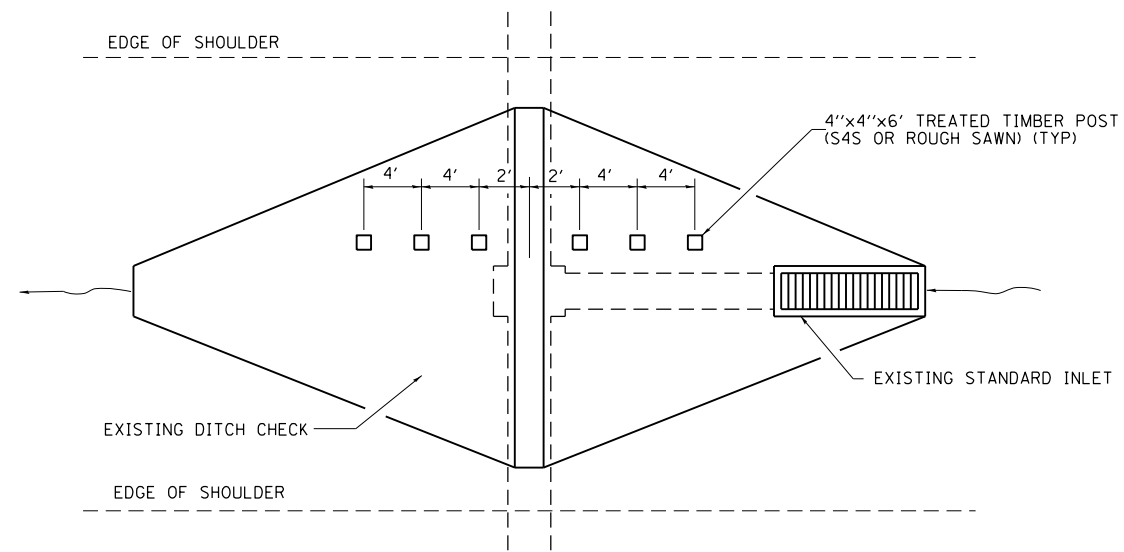

PLAN VIEW

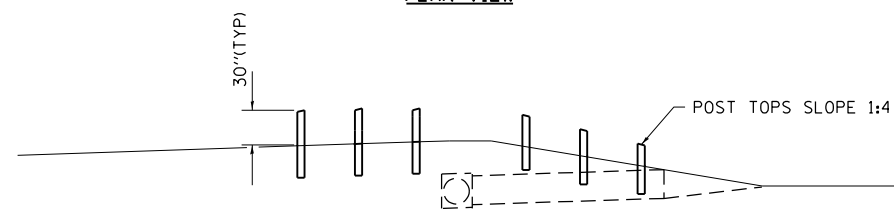

PROFILE VIEW

DETAIL OF GUARD POSTS

DETAIL OF GUARD POSTS

GUARD POST SCHEDULE	
LOCATION	GUARD POSTS
	EACH
704+30	6
705+75	6
764+80	6
816+50	5
817+85	5
820+50	6
830+35	6
857+40	5
858+75	5
884+00	12
913+80	6
989+75	5
991+10	5
1039+00	18
TOTALS	96

EB WOVEN WIRE FENCE SCHEDULE	WOVEN WIRE FENCE REMOVAL	WOVEN WIRE FENCE, 4'
	FOOT	FOOT
LOCATION		
656+13 TO 658+38	225	225
683+60	50	50
764+50	20	20
858+00	30	30
871+00	30	30
915+20	20	20
922+20	40	40
924+30	30	30
929+80	20	20
932+50	30	30
935+70	50	50
939+30	30	30
955+00	70	70
963+25	10	10
1009+50	20	20
1020+80	50	50
1038+50	10	10
1041+00	20	20
EASTBOUND TOTALS	755	755

WB WOVEN WIRE FENCE SCHEDULE	WOVEN WIRE FENCE REMOVAL	WOVEN WIRE FENCE, 4'
	FOOT	FOOT
LOCATION		
686+00	40	40
776+00	20	20
791+00	20	20
851+00	50	50
905+00	40	40
906+15	20	20
907+50	20	20
908+69 TO 909+79	110	110
911+50	20	20
923+00	20	20
982+80	20	20
992+20	10	10
1041+80	30	30
WESTBOUND TOTALS	420	420

FILE NAME =	USER NAME = steffenmk	DESIGNED -	REVISED -
ci:\pw\work\p\dot\steffenmk\d0338930\074255-sht-sch.dgn		DRAWN -	REVISED -
Default	PLOT SCALE = 100.0000' / in.	CHECKED -	REVISED -
	PLOT DATE = 6/12/2014	DATE -	REVISED -

STATE OF ILLINOIS
DEPARTMENT OF TRANSPORTATION

SCHEDULE OF QUANTITIES

SCALE: N/A SHEET 5 OF 5 SHEETS STA. TO STA.

F.A.I. RTE.	SECTION	COUNTY	TOTAL SHEETS	SHEET NO.
70	(26-3,4)RS-3	FAYETTE	31	20
CONTRACT NO. 74255			ILLINOIS FED. AID PROJECT	

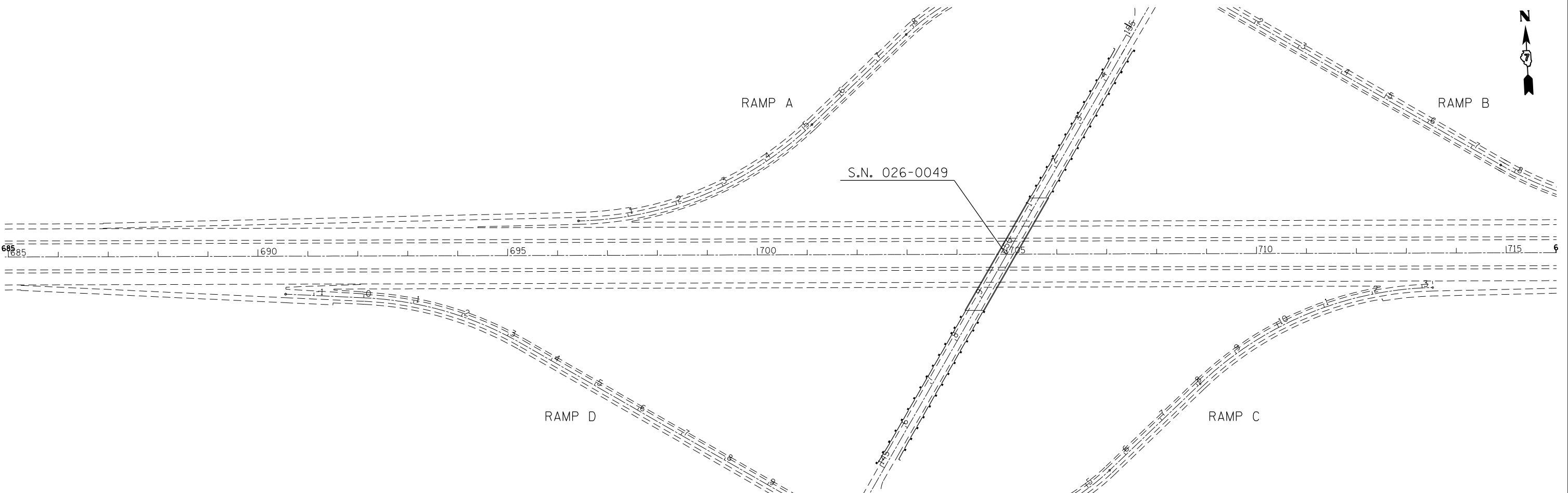
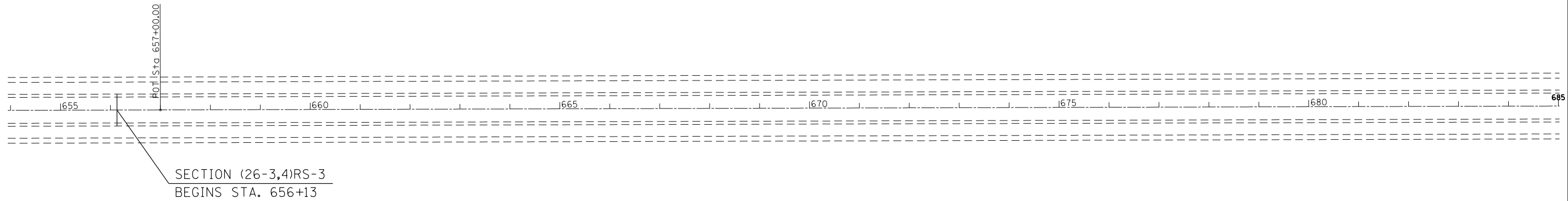

FILE NAME =	USER NAME = steffenmk	DESIGNED -	REVISED -
c:\pwork\pwork\dot\steffenmk\d0338930\074255-sht-plan.dgn		DRAWN -	REVISED -
Default	PLOT SCALE = 200.0000' / in.	CHECKED -	REVISED -
	PLOT DATE = 6/12/2014	DATE -	REVISED -

**STATE OF ILLINOIS
DEPARTMENT OF TRANSPORTATION**

PLAN

SCALE: 100 SHEET 1 OF 7 SHEETS STA. 656+13 TO STA. 716+00

F.A.I. RTE.	SECTION	COUNTY	TOTAL SHEETS	SHEET NO.
70	(26-3,4)RS-3	FAYETTE	31	21
ILLINOIS FED. AID PROJECT			CONTRACT NO. 74255	

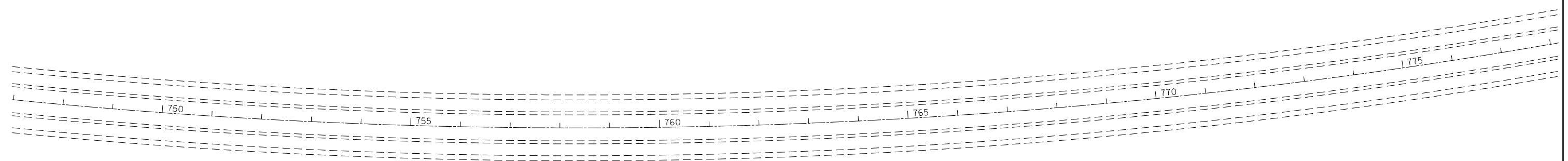
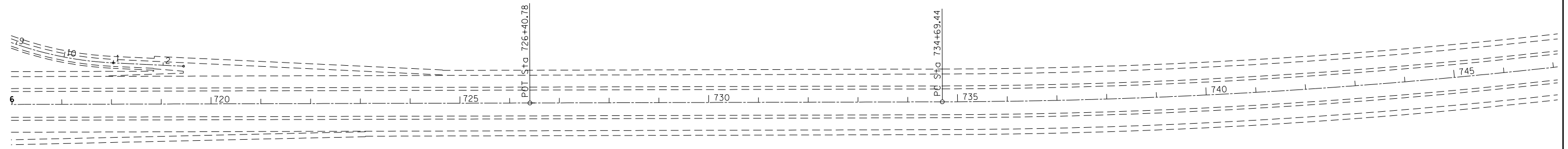

EXIST. CURVE 47
 PI STA. = 759+52.81
 Δ = 24° 27' 20" (LT)
 D = 0° 30' 00"
 R = 11,459.16'
 T = 2,483.37'
 L = 4,891.11'
 E = 266.01'
 e = -----
 T.R. = -----
 S.E. RUN = -----
 P.C. STA. = 734+69.44
 P.T. STA. = 783+60.55

PI Sta. 759+52.81

FILE NAME =	USER NAME = steffenmk	DESIGNED -	REVISED -
c:\pwork\pwork\stevfenmk\d0338930\074255-sht-plan.dgn		DRAWN -	REVISED -
Default	PLOT SCALE = 200.0000' / in.	CHECKED -	REVISED -
	PLOT DATE = 6/12/2014	DATE -	REVISED -

**STATE OF ILLINOIS
 DEPARTMENT OF TRANSPORTATION**

PLAN

SCALE: 100 SHEET 2 OF 7 SHEETS STA. 716+00 TO STA. 7778+00

F.A.I. RTE.	SECTION	COUNTY	TOTAL SHEETS	SHEET NO.
70	(26-3,4)RS-3	FAYETTE	31	22
ILLINOIS FED. AID PROJECT			CONTRACT NO. 74255	

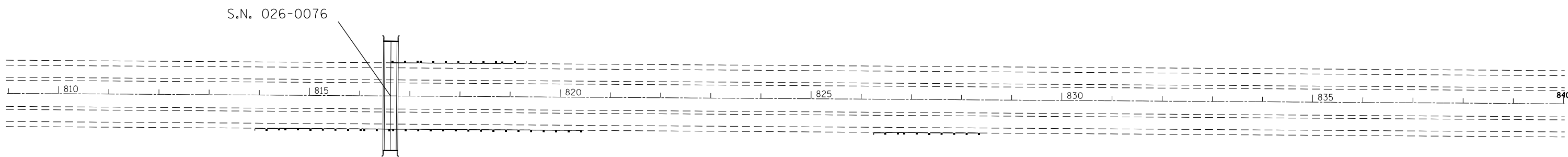
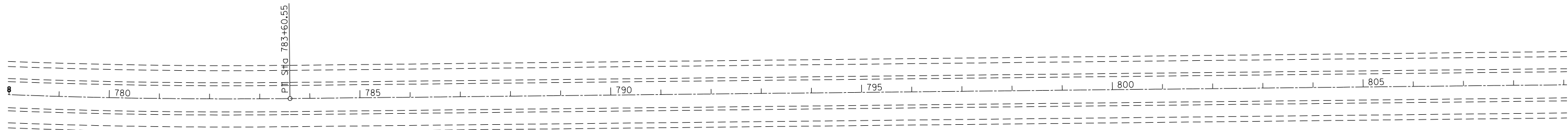

FILE NAME =	USER NAME = steffenmk	DESIGNED -	REVISED -
c:\pwork\pwork\dot\stefjenmk\d0338930\074255-sht-plan.dgn		DRAWN -	REVISED -
Default	PLOT SCALE = 200.0000' / in.	CHECKED -	REVISED -
	PLOT DATE = 6/12/2014	DATE -	REVISED -

**STATE OF ILLINOIS
DEPARTMENT OF TRANSPORTATION**

PLAN

SCALE: 100 SHEET 3 OF 7 SHEETS STA. 778+00 TO STA. 840+00

F.A.I. RTE.	SECTION	COUNTY	TOTAL SHEETS	SHEET NO.
70	(26-3,4)RS-3	FAYETTE	31	23
ILLINOIS FED. AID PROJECT			CONTRACT NO. 74255	



S.N. 026-0054

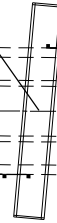

840 845 850 855 860 865 870



WEIGH STATION EXIT RAMP
WORK ENDS: STATION 0+94

POT Sta 0+00.00

PC Sta 10+24.47

PT Sta 14+29.45

EQUATION:
STG 22+62.87 BK =
STG 900+07.73 AH

FILE NAME =	USER NAME = steffenmk	DESIGNED -	REVISED -
ci:\pw\work\p\dot\steffenmk\d0338930\074255-sht-plan.dgn		DRAWN -	REVISED -
Default	PLOT SCALE = 200.0000' / in.	CHECKED -	REVISED -
	PLOT DATE = 6/12/2014	DATE -	REVISED -

STATE OF ILLINOIS
DEPARTMENT OF TRANSPORTATION

PLAN

SCALE: 100 SHEET 4 OF 7 SHEETS STA. 840+00 TO STA. 902+00

F.A.I. RTE.	SECTION	COUNTY	TOTAL SHEETS	SHEET NO.
70	(26-3,4)RS-3	FAYETTE	31	24
CONTRACT NO. 74255			ILLINOIS FED. AID PROJECT	

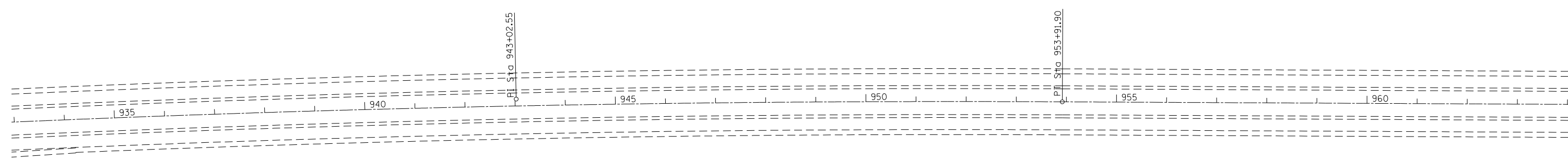
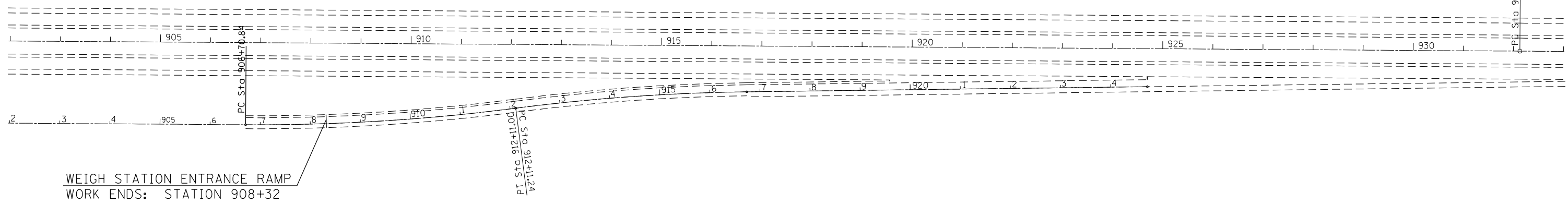

EXIST. CURVE 48
 PI STA. = 943+02.55
 Δ = 2° 54' 20" (RT)
 D = 0° 08' 00"
 R = 42,971.83'
 T = 1,089.82'
 L = 2,179.17'
 E = 13.82'
 e = -----
 T.R. = -----
 S.E. RUN = -----
 P.C. STA. = 932+12.73
 P.T. STA. = 953+91.90

FILE NAME =	USER NAME = steffenmk	DESIGNED -	REVISED -
ei:\pw\work\p\dot\steffenmk\d0338930\074255-sht-plan.dgn		DRAWN -	REVISED -
Default	PLOT SCALE = 200.0000' / in.	CHECKED -	REVISED -
	PLOT DATE = 6/12/2014	DATE -	REVISED -

**STATE OF ILLINOIS
 DEPARTMENT OF TRANSPORTATION**

PLAN			
SCALE: 100	SHEET 5	OF 7	SHEETS
STA. 902+00	TO STA. 964+00		

F.A.I. RTE.	SECTION	COUNTY	TOTAL SHEETS	SHEET NO.
70	(26-3,4)RS-3	FAYETTE	31	25
ILLINOIS FED. AID PROJECT			CONTRACT NO. 74255	

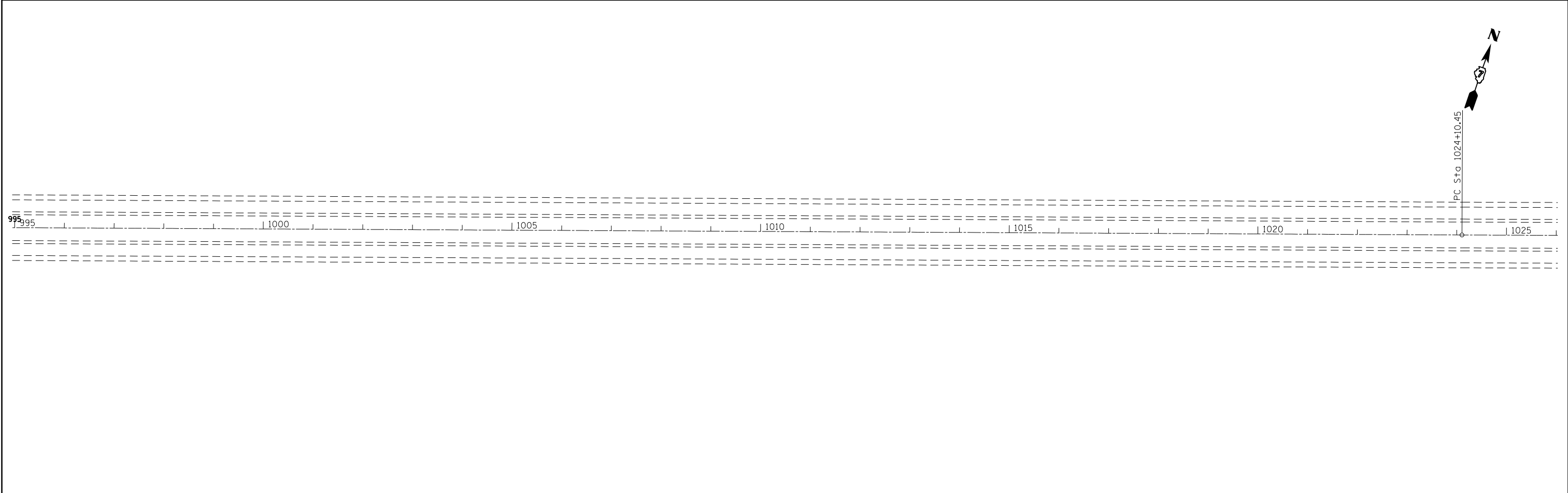
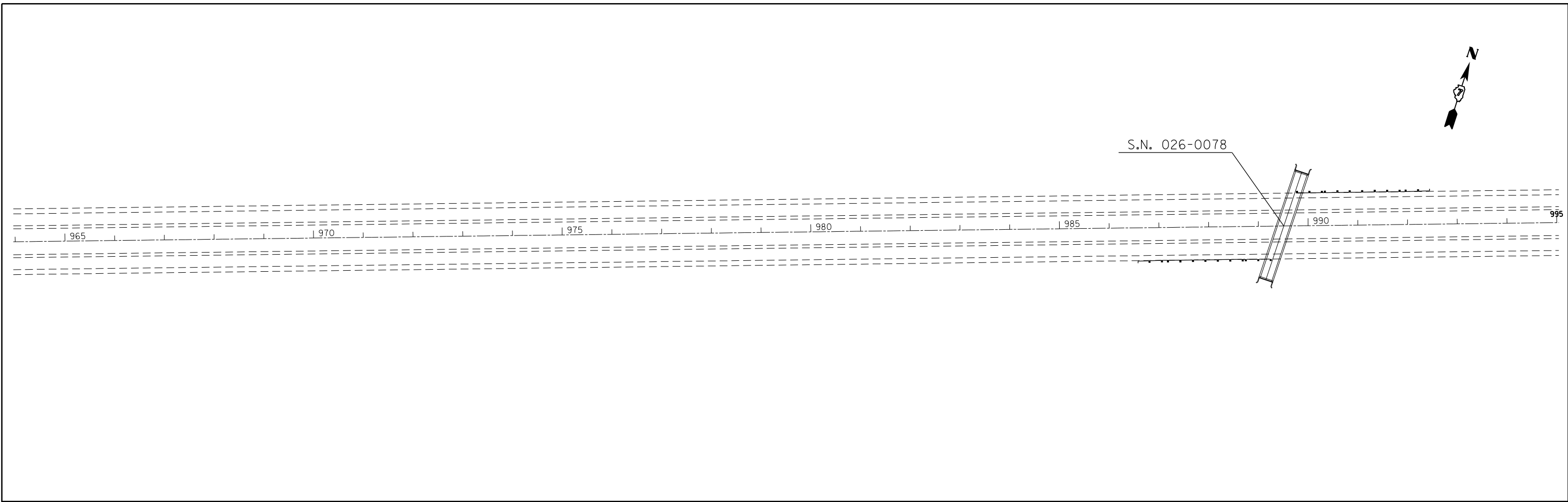

FILE NAME =	USER NAME = steffenmk	DESIGNED -	REVISED -	STATE OF ILLINOIS DEPARTMENT OF TRANSPORTATION	PLAN			F.A.I. RTE.	SECTION	COUNTY	TOTAL SHEETS	SHEET NO.
ci:\pw\work\p\idot\steffenmk\d0338930\074255-sht-plan.dgn		DRAWN -	REVISED -		70	(26-3,4)RS-3	FAYETTE	31	26			
Default	PLOT SCALE = 200.0000' / in.	CHECKED -	REVISED -		SCALE: 100 SHEET 6 OF 7 SHEETS STA. 964+00 TO STA. 1026+00			CONTRACT NO. 74255				
	PLOT DATE = 6/12/2014	DATE -	REVISED -		ILLINOIS FED. AID PROJECT							

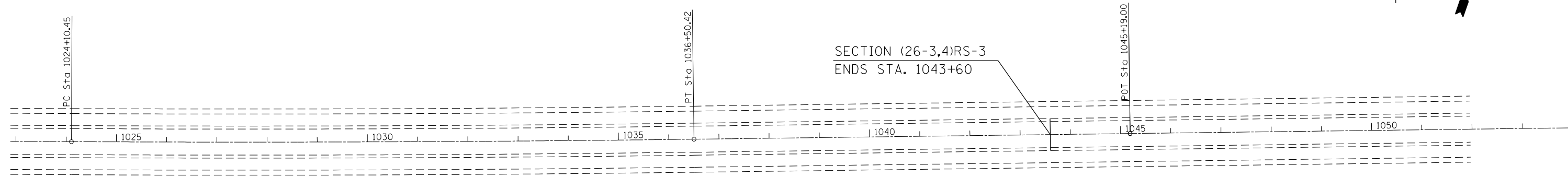

EXIST. CURVE 49
 PI STA. = 1030+30.45
 Δ = 1° 02' 00" (LT)
 D = 0° 05' 00"
 R = 68,754.94'
 T = 620.00'
 L = 1,239.98'
 E = 2.80'
 e = -----
 T.R. = -----
 S.E. RUN = -----
 P.C. STA. = 1024+10.45
 P.T. STA. = 1036+50.42

FILE NAME =	USER NAME = steffenmk	DESIGNED -	REVISED -
c:\pwork\pwork\dot\stefjenmk\d0338930\074255-sht-plan.dgn		DRAWN -	REVISED -
Default	PLOT SCALE = 200.0000' / in.	CHECKED -	REVISED -
	PLOT DATE = 6/12/2014	DATE -	REVISED -

STATE OF ILLINOIS
DEPARTMENT OF TRANSPORTATION

PLAN
 SCALE: 100 SHEET 7 OF 7 SHEETS STA. 1023+00 TO STA. 1043+44

F.A.I. RTE.	SECTION	COUNTY	TOTAL SHEETS	SHEET NO.
70	(26-3,4)RS-3	FAYETTE	31	27
CONTRACT NO.			74255	
ILLINOIS FED. AID PROJECT				

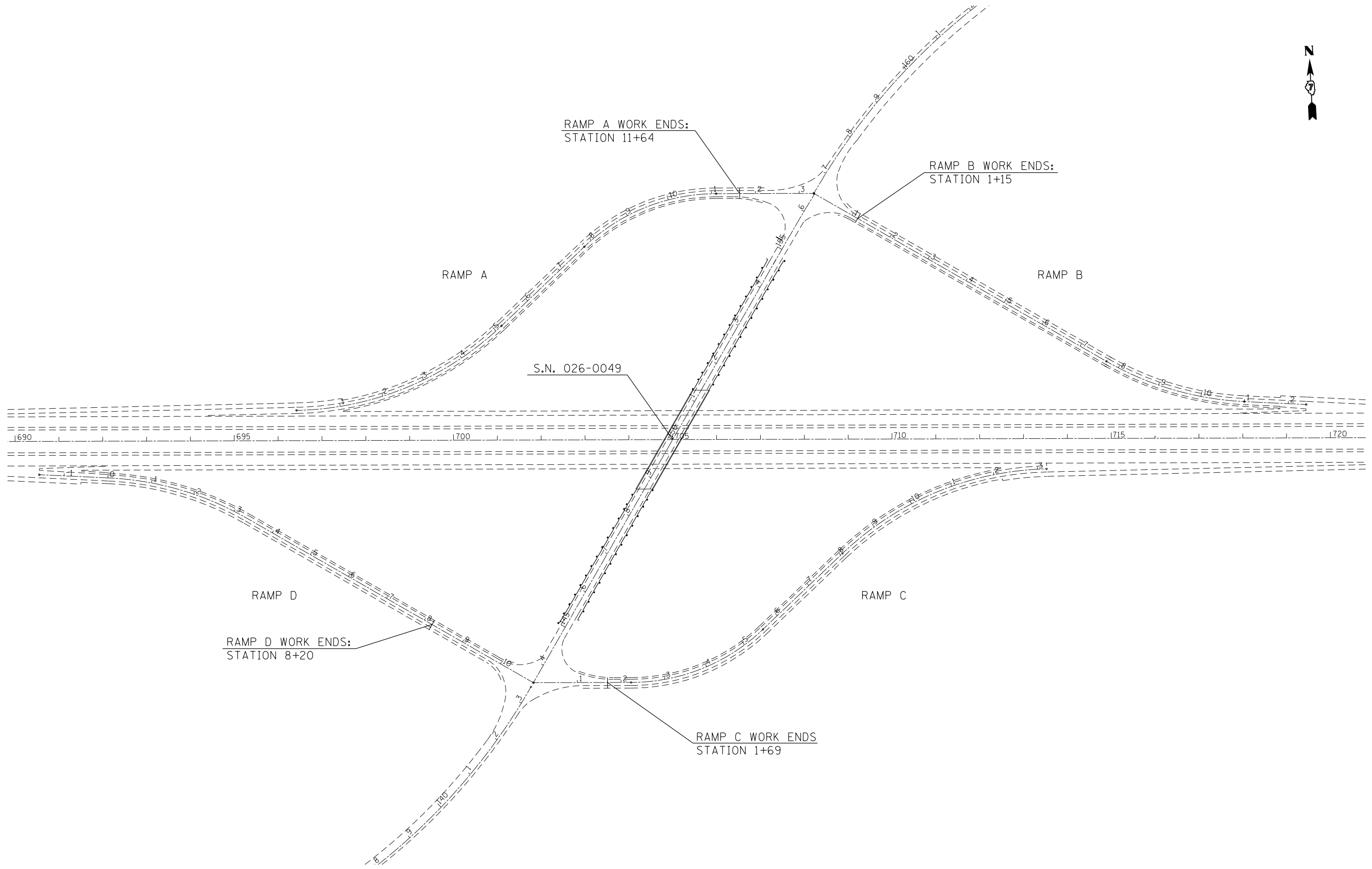

FILE NAME =	USER NAME = steffenmk	DESIGNED -	REVISED -
c:\pwork\pwork\stevfenmk\d0338930\074255-sht-pln.dgn		DRAWN -	REVISED -
Default	PLOT SCALE = 200.0000' / in.	CHECKED -	REVISED -
	PLOT DATE = 6/12/2014	DATE -	REVISED -

**STATE OF ILLINOIS
DEPARTMENT OF TRANSPORTATION**

**INTERSECTION DETAIL
I-70 & U.S. RTE. 40**

SCALE: 100 SHEET 1 OF 1 SHEETS STA. TO STA.

F.A.I. RTE.	SECTION	COUNTY	TOTAL SHEETS	SHEET NO.
70	(26-3,4)RS-3	FAYETTE	31	28
CONTRACT NO. 74255				
ILLINOIS FED. AID PROJECT				

TRAFFIC BARRIER TERMINAL, TYPE 6B (SPECIAL)

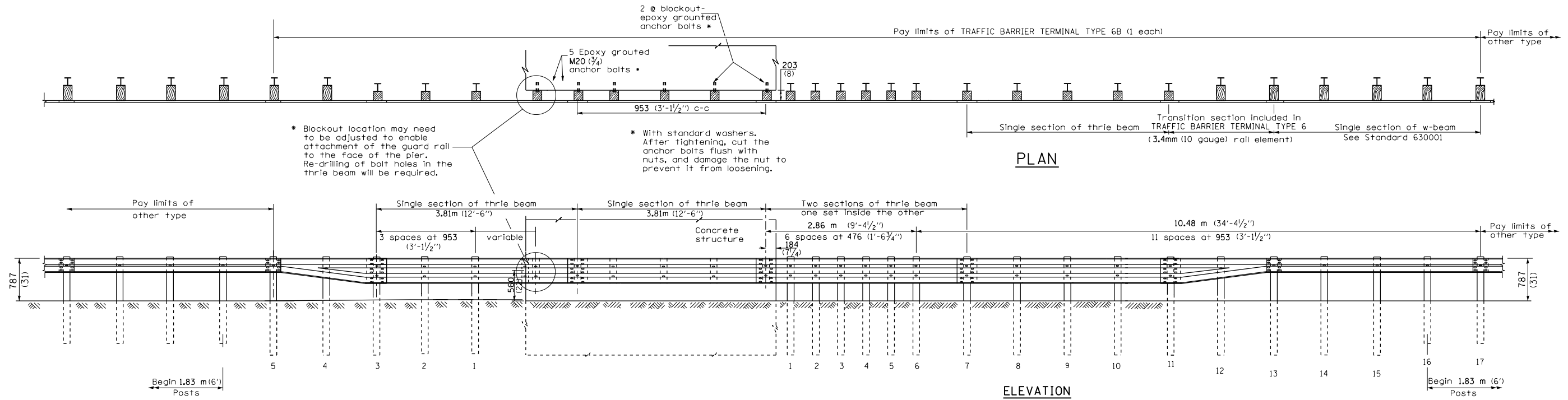

* Blockout location may need to be adjusted to enable attachment of the guard rail to the face of the pier. Re-drilling of bolt holes in the thrie beam will be required.

* With standard washers. After tightening, cut the anchor bolts flush with nuts, and damage the nut to prevent it from loosening.

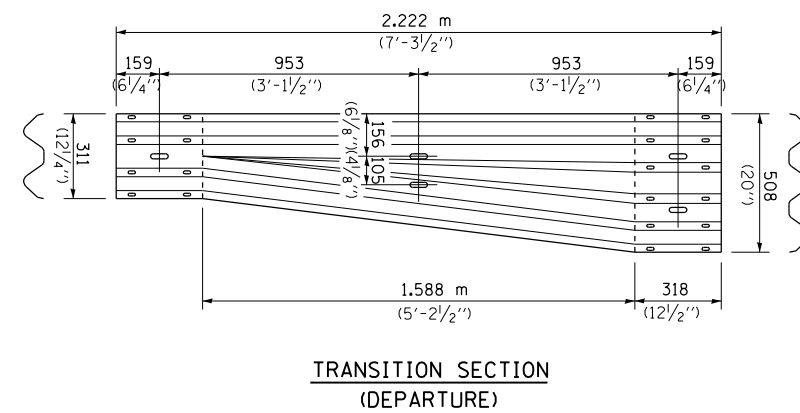
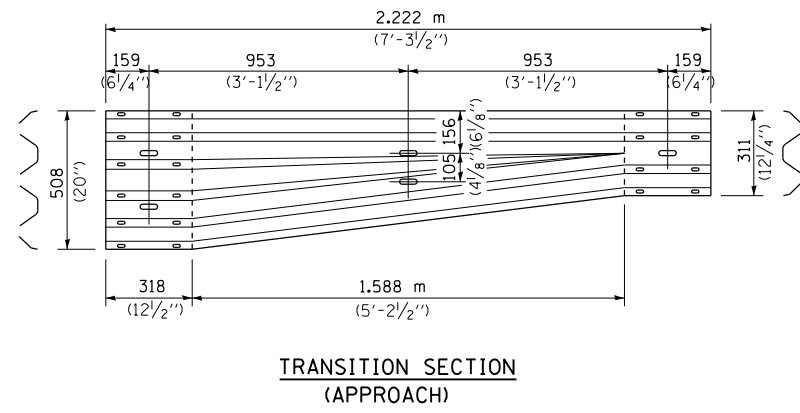
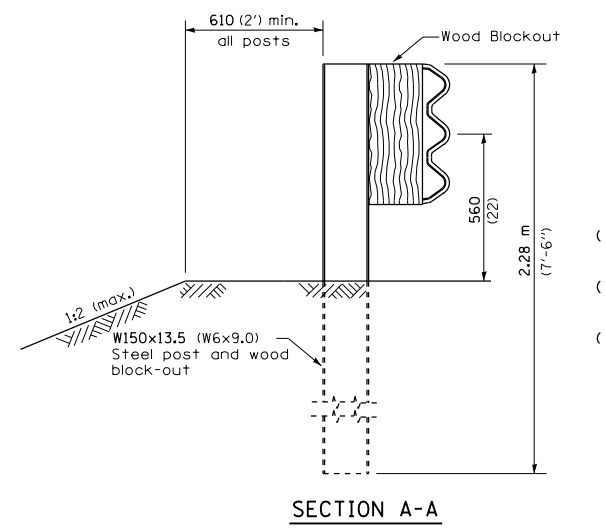

GENERAL NOTES

- See Standard 630001 for details of guardrail not shown.
- Thrie beam rail shall be bolted to block-out at all posts.
- All slope ratios are expressed as units of vertical displacement to units of horizontal displacement (V:H).
- All dimensions are in millimeters (inches) unless otherwise shown.

FILE NAME =	USER NAME = steffenmk	DESIGNED - JLD	REVISED -	STATE OF ILLINOIS DEPARTMENT OF TRANSPORTATION	TRAFFIC BARRIER TERMINAL TYPE 6B (SPECIAL)	F.A.I R.T.E.	SECTION	COUNTY	TOTAL SHEETS	SHEET NO.	
		DRAWN - JLD	REVISED -			70	(26-3,41R5-3	FAYETTE	31	29	
	PLOT SCALE = 100.0000' / 1in.	CHECKED -	REVISED -			CONTRACT NO. 74255					
	PLOT DATE = 6/12/2014	DATE -	REVISED -			ILLINOIS FED. AID PROJECT					

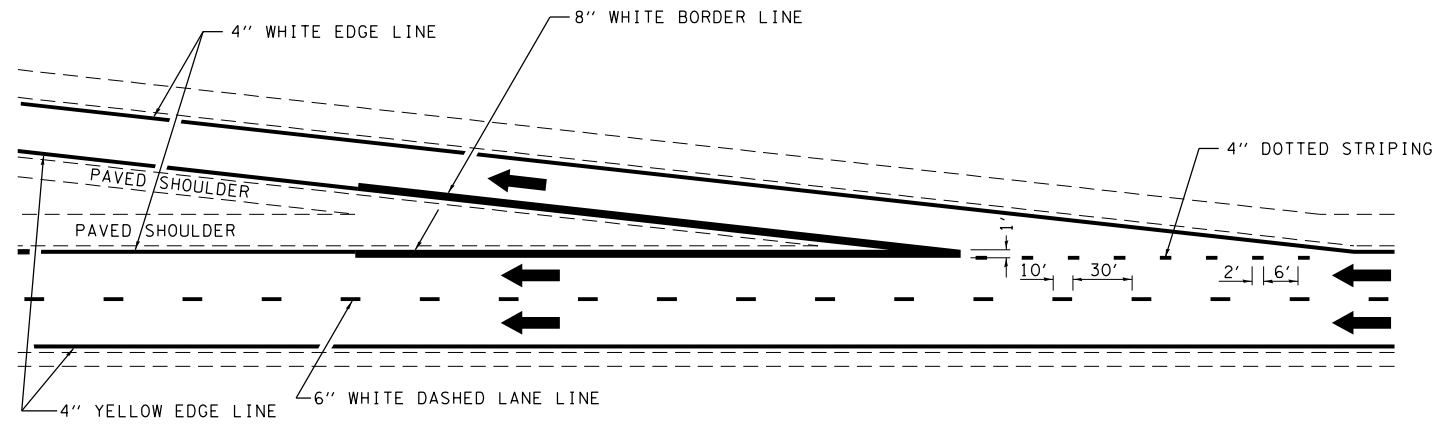

TYPICAL EXIT RAMP MARKING

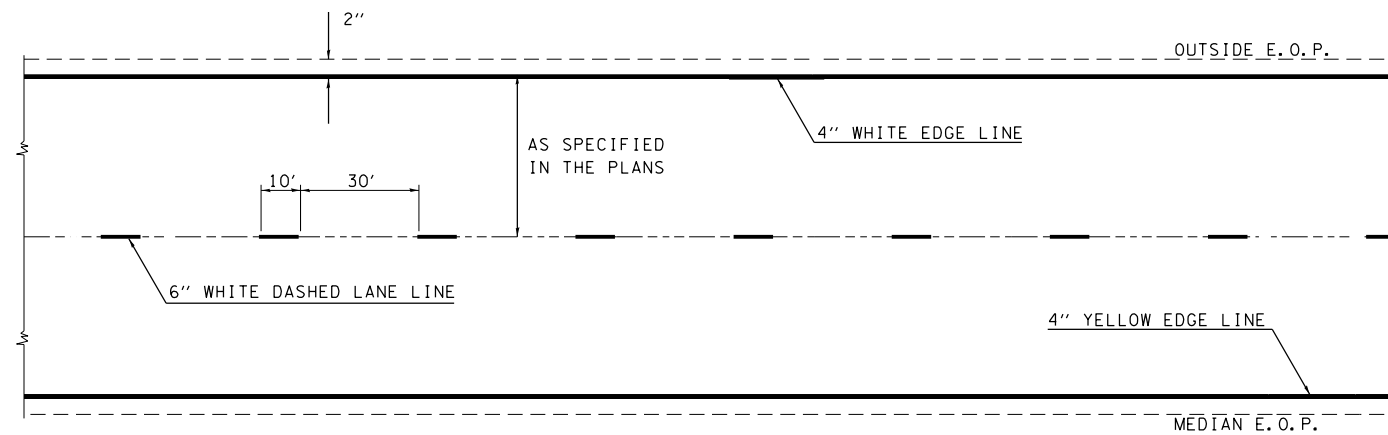

TYPICAL CENTERLINE & EDGELINE MARKINGS

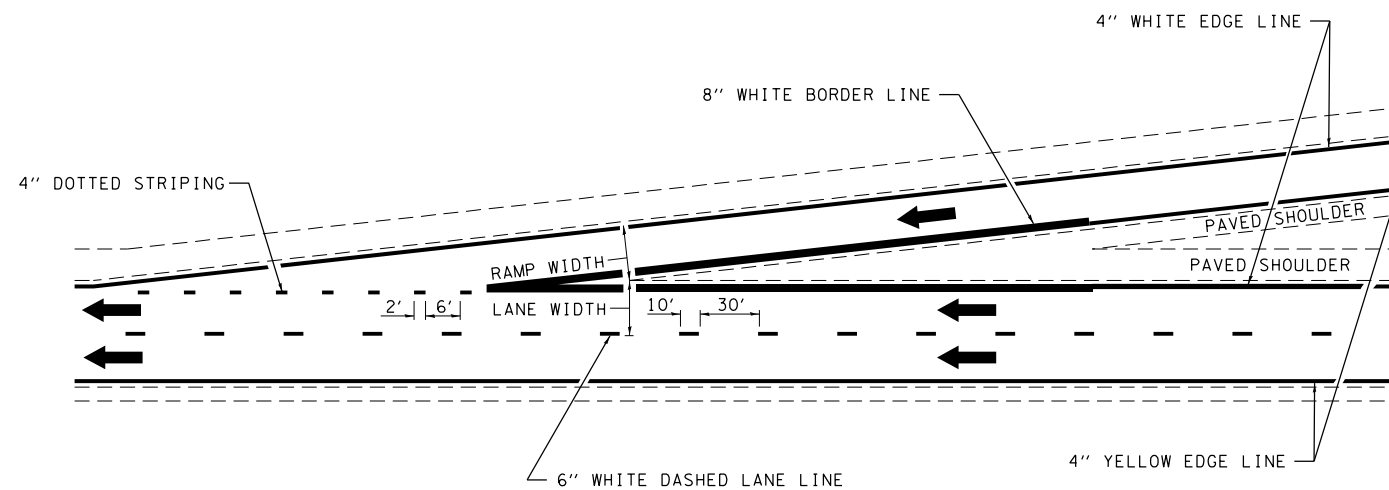

TYPICAL ENTRANCE RAMP MARKING

NOT TO SCALE

DISTRICT 7 DETAIL NO. 7800002

FILE NAME =	USER NAME = steffenmk	DESIGNED -	REVISED - DRM 08-04
ei:\pwork\pwork\stevfenmk\d0338930\074255-sht-details.dgn		DRAWN -	REVISED - MKS 04-08
	PLOT SCALE = 100.0000' / in.	CHECKED -	REVISED - DRM 01-09
	PLOT DATE = 6/12/2014	DATE -	REVISED - DRM 12-10

**STATE OF ILLINOIS
DEPARTMENT OF TRANSPORTATION**

TYPICAL APPLICATIONS OF INTERSTATE PAVEMENT MARKING

SCALE: N/A SHEET NO. 1 OF 2 SHEETS STA. TO STA.

F.A.I. RTE.	SECTION	COUNTY	TOTAL SHEETS	SHEET NO.
70	(26-3,4)RS-3	FAYETTE	31	30
CONTRACT NO. 74255				
FED. ROAD DIST. NO. ILLINOIS FED. AID PROJECT				

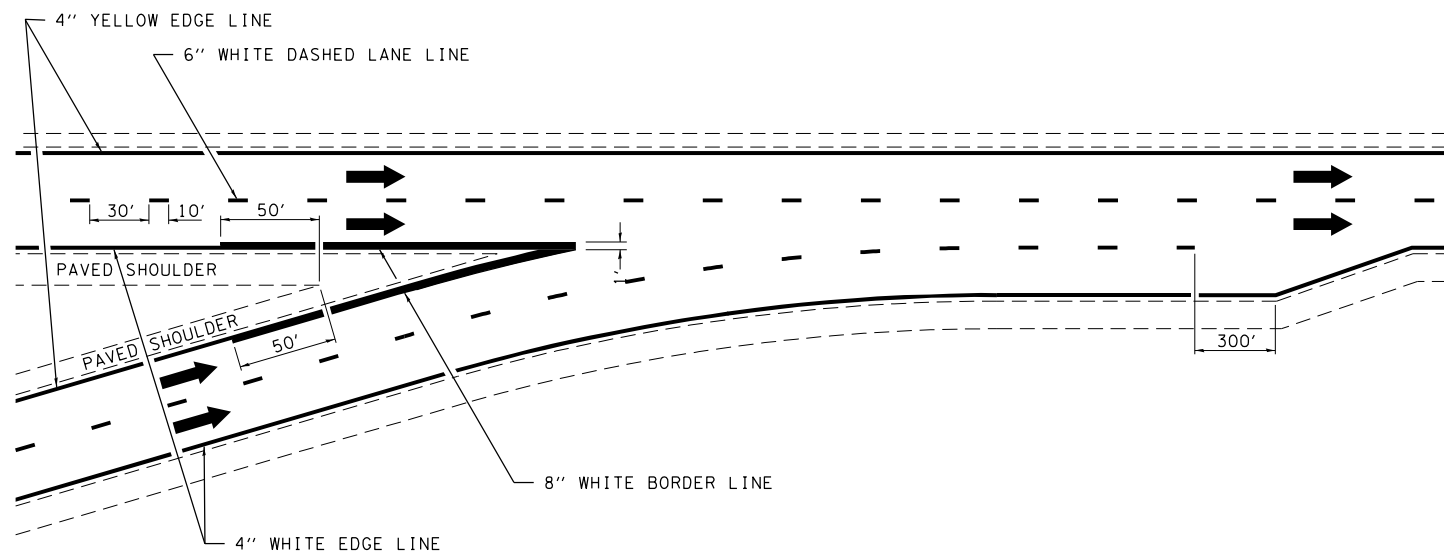

TYPICAL CONVERGENCE MARKING

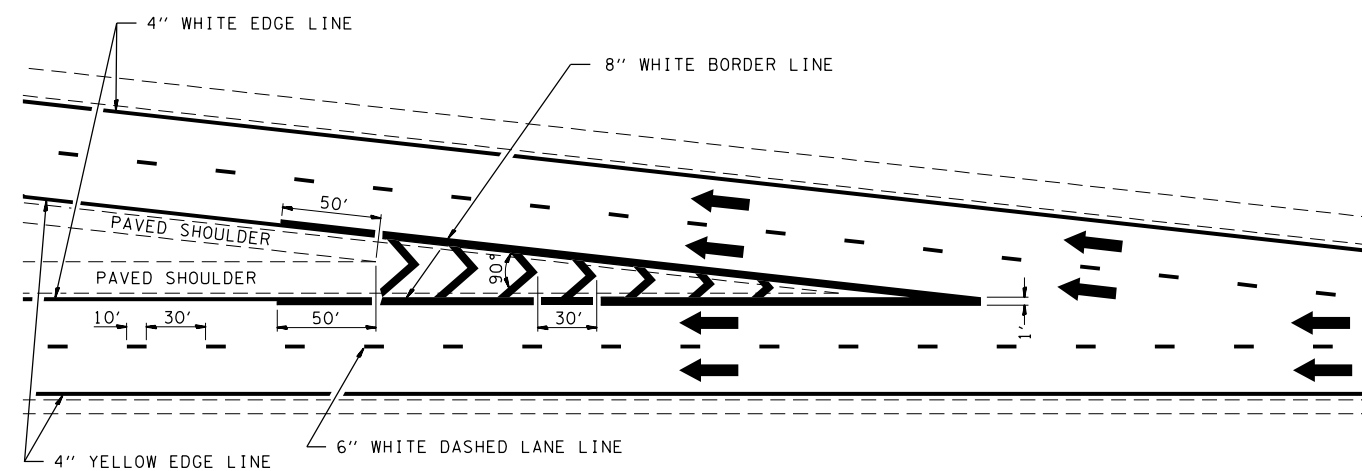

TYPICAL DIVERGENCE MARKING

AERIAL SPEED CHECK ZONES

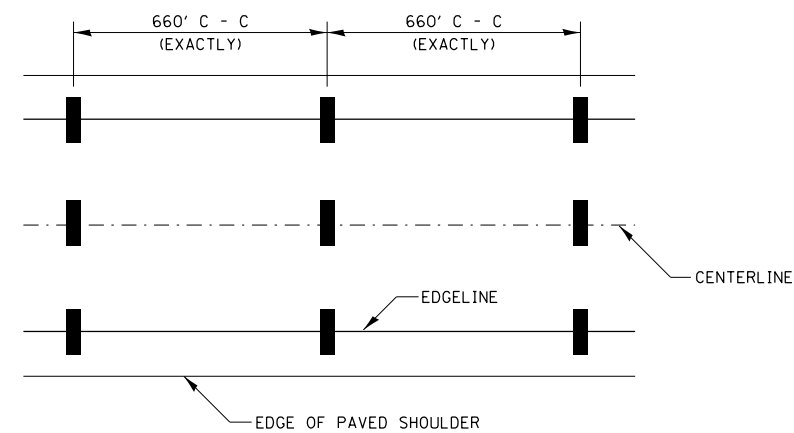

IT WILL BE NECESSARY TO HAVE A REPRESENTATIVE OF THE STATE POLICE PRESENT SO THAT THE ACCURACY OF MEASUREMENT CAN BE ATTESTED TO IN COURT.

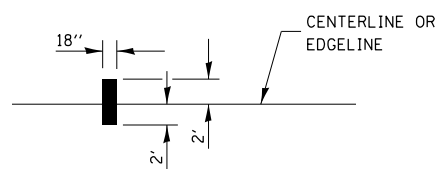

NOT TO SCALE

DISTRICT 7 DETAIL NO. 7800002

FILE NAME =	USER NAME = steffenmk	DESIGNED -	REVISED - MMO 12-99
ci:\pw\work\p\dot\steffenmk\d0338930\074255-sht-details.dgn		DRAWN -	REVISED - DRM 08-04
	PLOT SCALE = 100.0000' / in.	CHECKED -	REVISED - MKS 04-08
	PLOT DATE = 6/12/2014	DATE -	REVISED - DRM 01-09

STATE OF ILLINOIS
DEPARTMENT OF TRANSPORTATION

TYPICAL APPLICATIONS OF INTERSTATE PAVEMENT MARKING

SCALE: N/A SHEET NO. 2 OF 2 SHEETS STA. TO STA.

F.A.I. RTE.	SECTION	COUNTY	TOTAL SHEETS	SHEET NO.
70	(26-3,4)RS-3	FAYETTE	31	31
CONTRACT NO. 74255				
FED. ROAD DIST. NO. ILLINOIS FED. AID PROJECT				