

Existing Structure: S.N. 095-0041 (E.B.) and 095-0042 (W.B.) built in 1971 as F.A.I. Route 64 over the southeast overflow channel of the Kaskaskia River, Sec. 95-1B-2 at Sta. 1867+38.25 (095-0041) and Sta. 1869+03.10 (095-0042). Existing structures consist of five span, 36" continuous rolled steel beam bridges, (57'-73'-73'-73'-57'). The back to back of abutments measure 339'-2" and the out to out bridge widths are 42'-6" with a 23° 33' skew. Stub abutments bear on concrete piles and solid wall piers bear on creosoted piles.

Structure improvements include deck patching, sealing deck and parapets, modifying fixed bearings and placing polymer concrete and silicone joint seals at the expansion joints.

One lane of traffic in each direction is to be maintained during construction using stage construction.

No salvage.

FAI ROUTE 64 CURVE DATA

Eastbound Lanes		Westbound Lanes	
P.I. Sta. = 1872+86.94	$\Delta = 20^\circ 58' 08''$ (RT)	P.I. Sta. = 1861+99.67	$\Delta = 25^\circ 17' 17''$ (RT)
$D = 0^\circ 30' 00''$	$R = 11,459.16'$	$D = 0^\circ 30' 00''$	$R = 11,459.16'$
$T = 2120.60'$	$L = 4193.75'$	$T = 2570.67'$	$L = 5057.61'$
$E = 194.56'$	$S.E. = 0.016 \text{ \%/}$	$E = 284.80'$	$S.E. = 0.016 \text{ \%/}$
P.C. Sta. = 1851+66.34	P.T. Sta. = 1893+60.10	P.C. Sta. = 1836+29.00	P.T. Sta. = 1886+86.61

TOTAL BILL OF MATERIAL

ITEM	UNIT	TOTAL
Anchor Bolts, 1"	Each	48
Bridge Deck Concrete Sealer	Sq. Ft.	32751
Structural Steel Repair	Pound	410
Deck Slab Repair (Partial)	Sq. Yd.	225
Silicone Joint Sealer, 1.5"	Foot	185.0
Polymer Concrete	Cu. Ft.	3

INDEX OF SHEETS

1. General Plan & Elevation
2. Staging Plan
3. Deck Patching Survey (Sheet 1 of 2)
4. Deck Patching Survey (Sheet 2 of 2)
5. Details
6. Temporary Concrete Barrier for Stage Construction

SCOPE OF WORK

Seal deck and parapets, replace silicone joint sealer (full width), replace polymer concrete nosing (as directed), partial depth deck slab and existing $\pm 2\frac{3}{8}$ " microsilica overlay patching and install side retainers with anchor bolts at the fixed pier bearings.

GENERAL NOTES:

Plan dimensions and details relative to existing plans are subject to nominal construction variations. The Contractor shall field verify existing dimensions and details affecting new construction and make necessary approved adjustments prior to construction or ordering of materials. Such variations shall not be cause for additional compensation for a change in scope of the work, however, the Contractor will be paid for the quantity actually furnished at the unit price bid for the work.

The existing structural steel coating contains lead. The Contractor shall take appropriate precautions to deal with the presence of lead on this project.

All structural steel shall be conform to AASHTO Classification M 270 Grade 36 unless otherwise noted.

No field welding is permitted except as specified in the contract documents.

Existing structural steel shall only be cleaned and painted as required by the Special Provision "Cleaning and Painting Adjacent Areas of Existing Steel Structures".

All structural steel shall be shop painted with inorganic zinc rich primer per AASHTO M 300, Type 1. Cost included with "Structural Steel Repair."

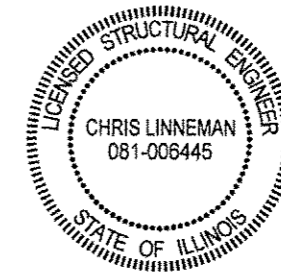

Signed: *[Signature]*
Date: 6/11/2014
License Expires: 11/30/2014

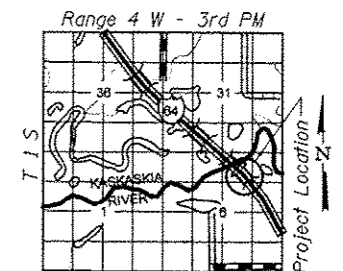

LOCATION SKETCH

GENERAL PLAN & ELEVATION
F.A.I. 64 OVER KASKASKIA RIVER (OVERFLOW CHANNEL)
F.A.I. 64 - SECTION 95-(1,2)RS-1
WASHINGTON COUNTY
STA. 1867+38.25 (095-0041)
STA. 1869+03.10 (095-0042)
STRUCTURE NO. 095-0041 & 095-0042

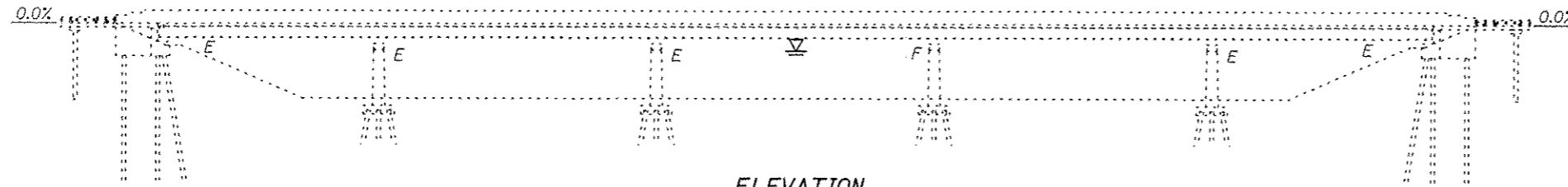

ELEVATION

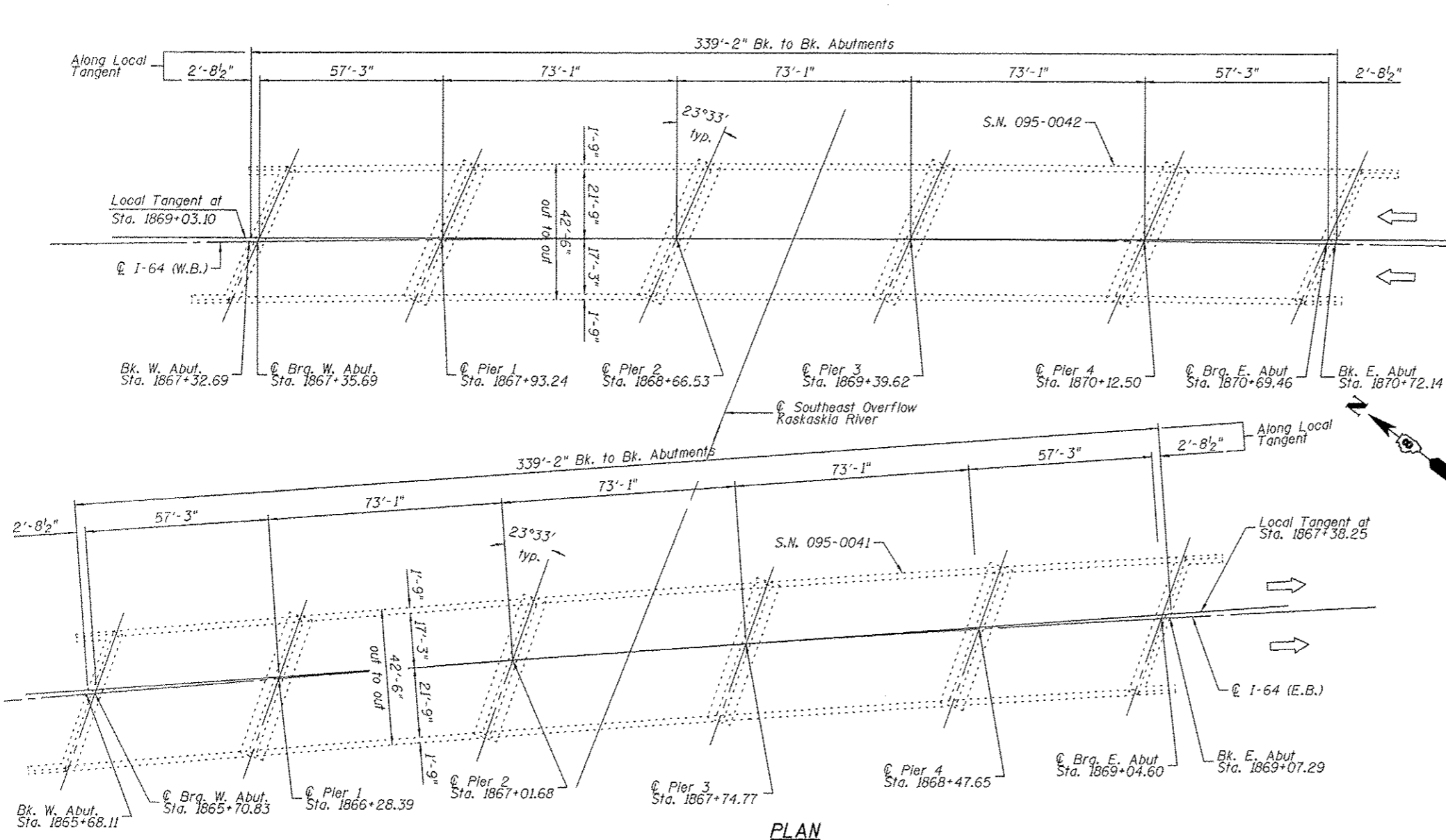

PLAN

EFK Moen, LLC
 Civil Engineering Design
 303 Fountains Parkway, Suite 240
 Fairview Heights, IL 62208
 Phone 618-206-4250

USER NAME	DESIGNED	REVISIONS
cdl	CDL	-
	CTW	-
	JA	-
		-

STATE OF ILLINOIS
 DEPARTMENT OF TRANSPORTATION

GENERAL PLAN & ELEVATION
 STRUCTURE NO. 095-0041 & 095-0042

F.A.I. RTE.	SECTION	COUNTY	TOTAL SHEETS	SHEET NO.
64	95-(1,2)RS-1	WASHINGTON	126	103

CONTRACT NO. T6D20
 ILLINOIS FED. AID PROJECT

SHEET NO. 1 OF 6 SHEETS

PRINT DATE: 6/11/2014 2:05:27 PM Y:\2014\1-64 Bridge Repairs\Bridges\Final\Plotsheets\095-0041\0042\0950041-00000-001-GPE.dgn