

Existing Structure: S.N. 095-0043 (W.B.) and 095-0044 (E.B.) built in 1969 as F.A.I. Route 64 over Plum Creek, Sec. 95-1B at Sta. 2000+40. Existing structures consist of three span, 42" precast prestressed I-beam bridges, (50'-51'-50'). The back to back of abutments measure 156'-2" and the out to out bridge widths are 43'-0" with a 30° skew. Stub abutments bear on concrete piles and solid wall piers bear on creosoted piles.

Structure improvements include sealing deck and parapets, replacing abutment bearings, placing polymer concrete and silicone joint seals at the expansion joints.

One lane of traffic in each direction is to be maintained during construction using stage construction.

No salvage.

FAI ROUTE 64

CURVE DATA

P.I. Sta. = 1988+14.91
 $\Delta = 28^\circ 48' 11''$ (L.T)
 $D = 1^\circ 00' 00''$
 $R = 5729.59'$
 $T = 1471.27'$
 $L = 2880.31'$
 $E = 185.88'$
 $S.E. = 0.028 \%$
P.C. Sta. = 1973+43.64
P.T. Sta. = 2002+23.95

EXIST. PROFILE GRADE

FAI ROUTE 64

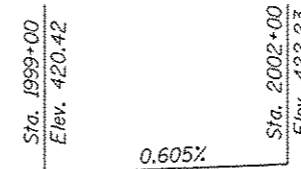

TOTAL BILL OF MATERIAL

ITEM	UNIT	TOTAL
Concrete Removal	Cu. Yd.	3.2
Concrete Superstructure	Cu. Yd.	4.9
Reinforcement Bars, Epoxy Coated	Pound	400
Anchor Bolts, 1"	Each	56
Elastomeric Bearing Assembly, Type II (Special)	Each	28
Bridge Deck Concrete Sealer	Sq. Ft.	15342
Jack and Remove Existing Bearings	Each	28
Silicone Joint Sealer, 1.5"	Foot	197.5
Polymer Concrete	Cu. Ft.	17
Relocating Name Plates	Each	2

1. General Plan & Elevation
2. Staging Plan
3. Joint Details
4. Wingwall Modification (EB)
5. Wingwall Modification (WB)
6. Bearing Replacement Details
7. Temporary Concrete Barrier for Stage Construction

SCOPE OF WORK

Jack and remove existing abutment bearings. Install new anchor bolts and bearings at abutments. Seal deck and parapets, replace silicone joint sealer (full width), replace polymer concrete nosing (as directed), partially remove and replace approach wingwalls to accept new guardrail end section.

GENERAL NOTES:

Plan dimensions and details relative to existing plans are subject to nominal construction variations. The Contractor shall field verify existing dimensions and details affecting new construction and make necessary approved adjustments prior to construction or ordering of materials. Such variations shall not be cause for additional compensation for a change in scope of the work, however, the Contractor will be paid for the quantity actually furnished at the unit price bid for the work.

The existing structural steel coating contains lead. The Contractor shall take appropriate precautions to deal with the presence of lead on this project.

All structural steel shall be conform to AASHTO Classification M 270 Grade 36 unless otherwise noted.

No field welding is permitted except as specified in the contract documents.

Existing structural steel that will be in contact with new structural steel shall be cleaned and painted prior to erection as required by the Special Provision "Cleaning and Painting Contact Surface Areas of Existing Steel Structures". Cost included with Jack and Remove Existing Bearings.

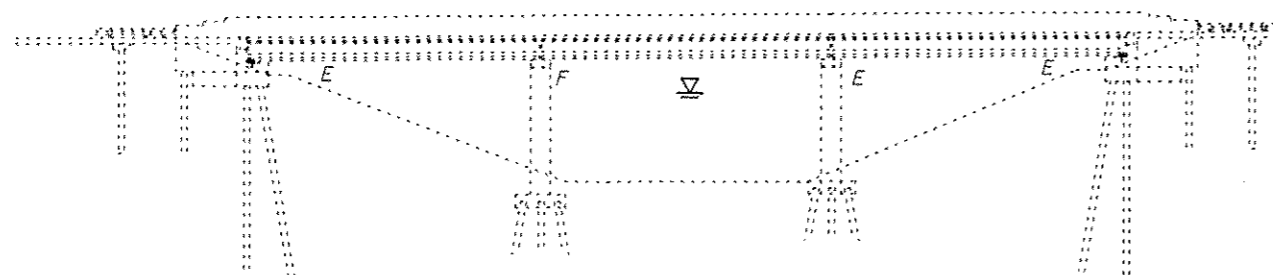

ELEVATION

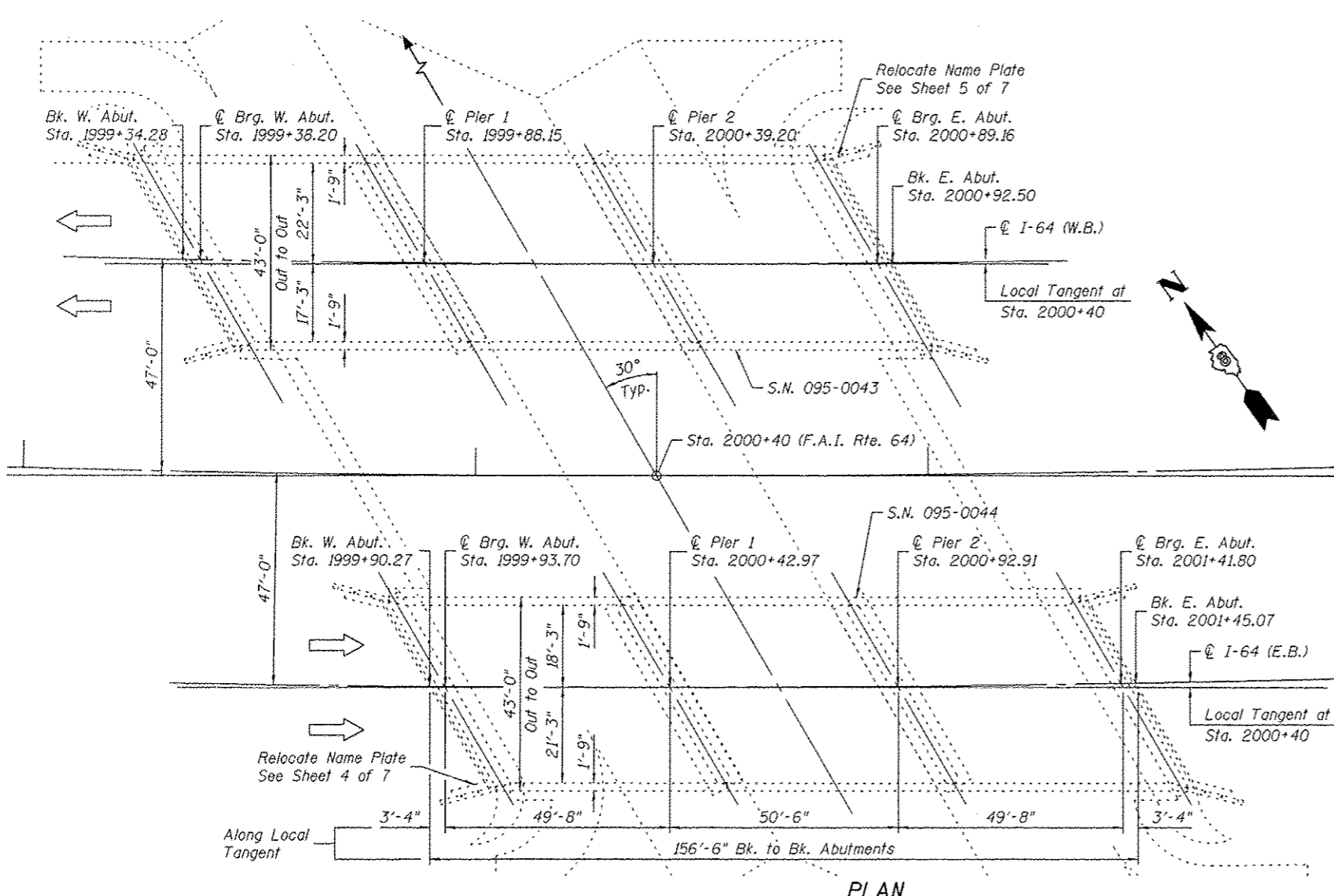

PLAN

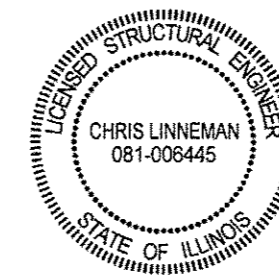

Signed: *[Signature]*
Date: 6/11/2014
License Expires: 11/30/2014

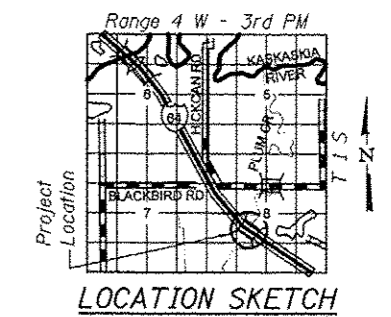

LOCATION SKETCH

GENERAL PLAN & ELEVATION
F.A.I. 64 OVER PLUM CREEK
F.A.I. 64 - SECTION 95-(1,2)RS-1
WASHINGTON COUNTY
STA. 2000+40.00
STRUCTURE NO. 095-0043 & 095-0044

PRINT DATE: 6/11/2014 2:06:04 PM Y:\2014\1-64 Bridge Repairs\ADGN\Bridg\Final\Plotsheets\095-0043_0044\0950043-00000-001-GPE.dgn

EFK Moen, LLC
Civil Engineering Design
303 Fountains Parkway, Suite 240
Fairview Heights, IL 62208
Phone 618-206-4250

USER NAME = cdl	DESIGNED - CDL	REVISD -
PLOT SCALE = 012 1/4" = 1"	CHECKED - CTW	REVISD -
PLOT DATE = 6/11/2014	DRAWN - JA	REVISD -
	DATE - 6/11/2014	REVISD -

STATE OF ILLINOIS
DEPARTMENT OF TRANSPORTATION

GENERAL PLAN & ELEVATION
STRUCTURE NO. 095-0043 & 095-0044
SHEET NO. 1 OF 7 SHEETS

F.A.I. RTE.	SECTION	COUNTY	TOTAL SHEETS	SHEET NO.
64	95-(1,2)RS-1	WASHINGTON	126	109

CONTRACT NO. 76D20
ILLINOIS FED. AID PROJECT