

Existing Structure: S.N. 095-0045 built in 1970 as Township Road 68 over F.A.I. Route 64, Sec. 95-1HB at Sta. 2057+00.82. Existing structure consist of two span 48" web, continuous steel plate girder bridge, (111'-111') with 36' approach spans on 36" P.P.C. I-beams. The back to back of approach span length is 299'-0" and the out to out bridge width is 30'-0" with a 36° skew. Closed abutments and the hammerhead pier bear on spread footings. The approach bents are supported by steel piles.

Structure Improvements include sealing the deck and parapets, cleaning abutment seats, installing silicone joint sealer at expansion joints, abutment angle bumpers and riprap.

One lane of traffic in each direction is to be maintained during construction using staged construction.

No salvage.

**TOTAL BILL OF MATERIAL**

ITEM	UNIT	TOTAL
Stone Riprap, Class A3	Sq. Yd.	33
Filter Fabric	Sq. Yd.	33
Bridge Deck Concrete Sealer	Sq. Ft.	9904
Structural Steel Repair	Pound	820
Cleaning Bridge Seats	Sq. Ft.	176
Silicone Joint Sealer, 1.5"	Foot	73

**INDEX OF SHEETS**

- General Plan & Elevation
- Cross Section
- Details

**SCOPE OF WORK**

Structure Improvements include sealing the deck and parapets, cleaning abutment seats, installing silicone joint sealer at expansion joints, abutment angle bumpers and riprap.

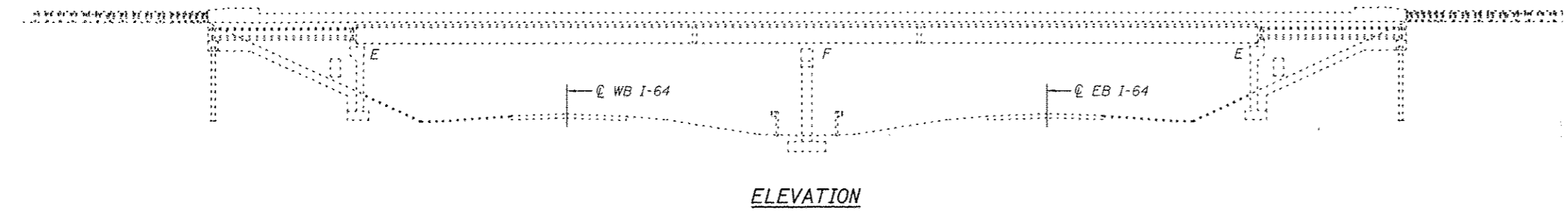

**ELEVATION**

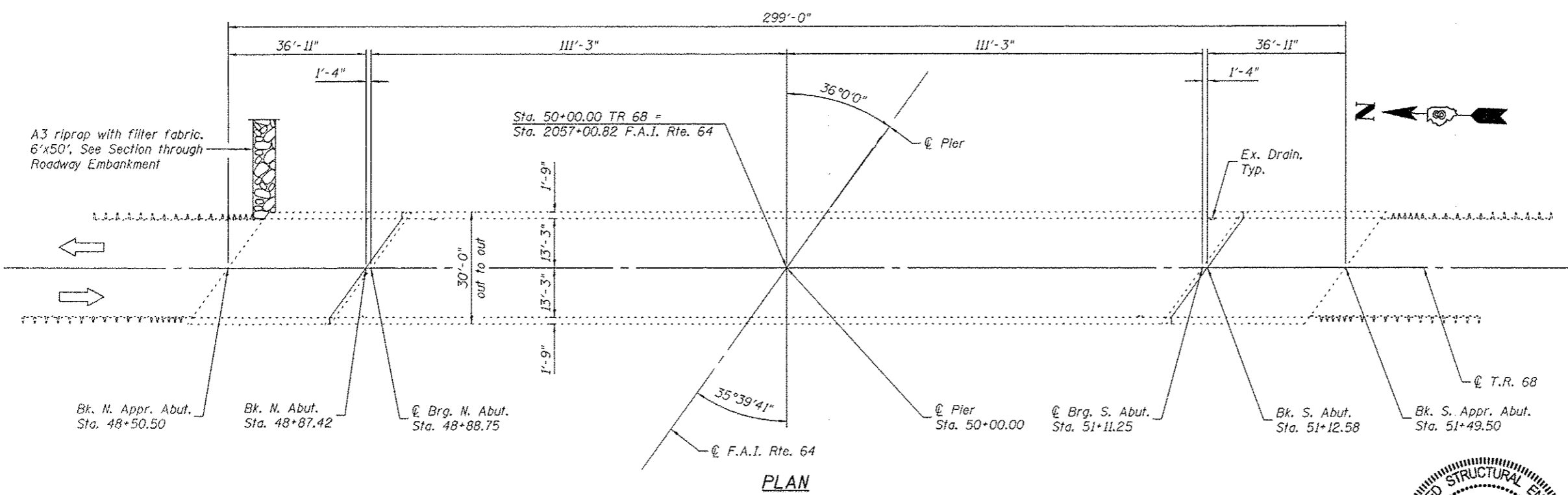

**PLAN**

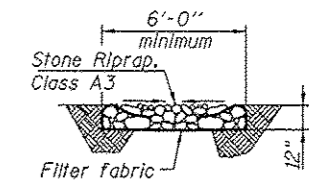

**SECTION THROUGH ROADWAY EMBANKMENT**

Provide drainage down embankment from bridge approach slab. Layout may be varied to suit ground conditions in the field as directed by the Engineer.

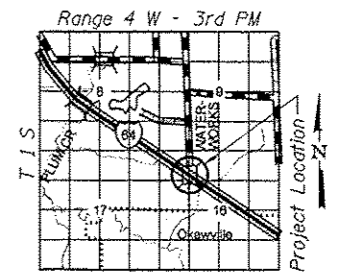

**LOCATION SKETCH**



Signed:   
 Date: 6/11/2014  
 License Expires: 11/30/2014

**GENERAL NOTES:**

Plan dimensions and details relative to existing plans are subject to nominal construction variations. The Contractor shall field verify existing dimensions and details affecting new construction and make necessary approved adjustments prior to construction or ordering of materials. Such variations shall not be cause for additional compensation for a change in scope of the work, however, the Contractor will be paid for the quantity actually furnished at the unit price bid for the work.

The existing structural steel coating contains lead. The Contractor shall take appropriate precautions to deal with the presence of lead on this project.

Fasteners shall be high strength bolts. Bolts 3/4" φ, open holes 13/16" φ, unless otherwise noted.

All structural steel shall conform to AASHTO Classification M-270 Gr. 36 unless otherwise noted.

Existing structural steel that will be in contact with new structural steel shall be cleaned and painted prior to erection as required by the Special Provision "Cleaning and Painting Contact Surface Areas of Existing Steel Structures". Cost included with Structural Steel Repair.

The Inorganic Zinc Rich Primer / Acrylic / Acrylic Paint System shall be used for shop and field painting of new structural steel except where otherwise noted. The color of the final finish coat for all interior steel surfaces shall be Gray, Munsell No. 5B 7/1. The color of the final finish coat for the exterior and bottom flange of the fascia beams shall be Gray, Munsell No. 5B 7/1. See Special Provision "Cleaning and Painting New Metal Structures". Cost included with Structural Steel Repair.

Existing structural steel shall only be cleaned and painted as required by the Special Provision "Cleaning and Painting Adjacent Areas of Existing Steel Structures".

**GENERAL PLAN & ELEVATION**  
**TR 68 OVER F.A.I. 64**  
**F.A.I. 64 - SECTION 95-(1,2)RS-1**  
**WASHINGTON COUNTY**  
**STA. 2057+00.82**  
**STRUCTURE NO. 095-0045**

PRINT DATE: 6/11/2014 2:06:39 PM Y:\2014\1-64 Bridge Repairs\DCM\Bridges\Final\Plotsheets\095-0045\0950045-00000-001-6FE.dgn

**EFK Moen, LLC**  
 Civil Engineering Design  
 303 Fountains Parkway, Suite 240  
 Fairview Heights, IL 62208  
 Phone 618-286-4350

USER NAME	DESIGNED	REVISIONS
cdl	CDL	-
	CTW	-
	JA	-
		-
		-
		-
		-
		-

**STATE OF ILLINOIS**  
**DEPARTMENT OF TRANSPORTATION**

**GENERAL PLAN & ELEVATION**  
**STRUCTURE NO. 095-0045**

SHEET NO. 1 OF 3 SHEETS

F.A.I. RTE.	SECTION	COUNTY	TOTAL SHEETS	SHEET NO.
64	95-(1,2)RS-1	WASHINGTON	126	116
			CONTRACT NO. 76D20	
ILLINOIS FED. AID PROJECT				