

F.A.P. RTE.	F.A.U. RTE.	SECTION	COUNTY	TOTAL SHEETS	SHEET NO.
592	9190	121-1RS-1	ST. CLAIR	32	1
			ILLINOIS	CONTRACT NO. 76G80	

D-98-006-14

INDEX OF SHEETS

- 1. COVER SHEET
- 2. GENERAL NOTES
- 3.-6. SUMMARY OF QUANTITIES
- 7.-8. TYPICAL SECTIONS
- 9.-10. SCHEDULE OF QUANTITIES
- 11. ROADWAY PLAN KEYMAP
- 12. AVERAGE DAILY TRAFFIC DATA
- 13.-20. ROADWAY PLANS
- 21. RESURFACING DETAILS
- 22.-27. PAVEMENT MARKING PLANS
- 28. PAVEMENT MARKING DETAILS
- 29.-32. TRAFFIC SIGNAL PLANS

**STATE OF ILLINOIS
DEPARTMENT OF TRANSPORTATION
DIVISION OF HIGHWAYS**

**PROPOSED
HIGHWAY PLANS**

F.A.P 592 & F.A.U. 9190 (IL 157 & IL 163)

SECTION 121-1RS-1

**PCC PATCHING AND BITUMINOUS RESURFACING
IN THE CITIES OF CAHOKIA AND ALORTON
ST. CLAIR COUNTY**

C-98-004-14

HIGHWAY STANDARDS

- 000001-06 STANDARD SYMBOLS, ABBREVIATIONS AND PATTERNS
- 001006 DECIMAL OF AN INCH AND OF A FOOT
- 442101-07 CLASS B PATCHES
- 442201-03 CLASS C AND D PATCHES
- 701011-04 OFF-ROAD MOVING OPERATIONS 2L, 2W, DAY ONLY
- 701301-04 LANE CLOSURE, 2L, 2W, SHORT TIME OPERATIONS
- 701306-03 LANE CLOSURE, 2L, 2W, SLOW MOVING OPERATIONS DAY ONLY, FOR SPEEDS ≥ 45 MPH
- 701311-03 LANE CLOSURE, 2L, 2W, MOVING OPERATIONS-DAY ONLY
- 701336-06 LANE CLOSURE, 2L, 2W, WORK AREAS IN SERIES, FOR SPEEDS ≥ 45 MPH
- 701501-06 URBAN LANE CLOSURE, 2L, 2W, UNDIVIDED
- 701502-06 URBAN LANE CLOSURE, 2L, 2W, WITH BIDIRECTIONAL LEFT TURN LANE
- 701601-09 URBAN LANE CLOSURE, MULTILANE, 1W OR 2W WITH NONTRAVERSABLE MEDIAN
- 701701-09 URBAN LANE CLOSURE, MULTILANE INTERSECTION
- 701901-03 TRAFFIC CONTROL DEVICES
- 780001-04 TYPICAL PAVEMENT MARKINGS
- 781001-03 TYPICAL APPLICATIONS RAISED REFLECTIVE PAVEMENT MARKERS
- 886001-01 DETECTOR LOOP INSTALLATIONS
- 886006-01 TYPICAL LAYOUTS FOR DETECTION LOOPS



GROSS LENGTH = 27,008 FT. = 5.11 MILES
NET LENGTH = 16,992 FT. = 3.22 MILES

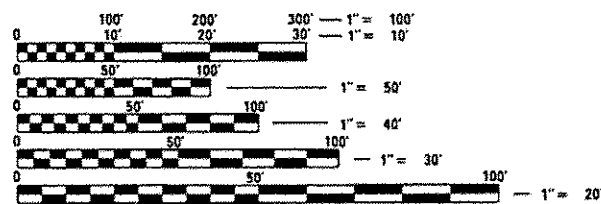

FULL SIZE PLANS HAVE BEEN PREPARED USING STANDARD ENGINEERING SCALES. REDUCED SIZED PLANS WILL NOT CONFORM TO STANDARD SCALES. IN MAKING MEASUREMENTS ON REDUCED PLANS, THE ABOVE SCALES MAY BE USED.

J.U.L.I.E.
JOINT UTILITY LOCATION INFORMATION FOR EXCAVATION
1-800-892-0123
OR 811

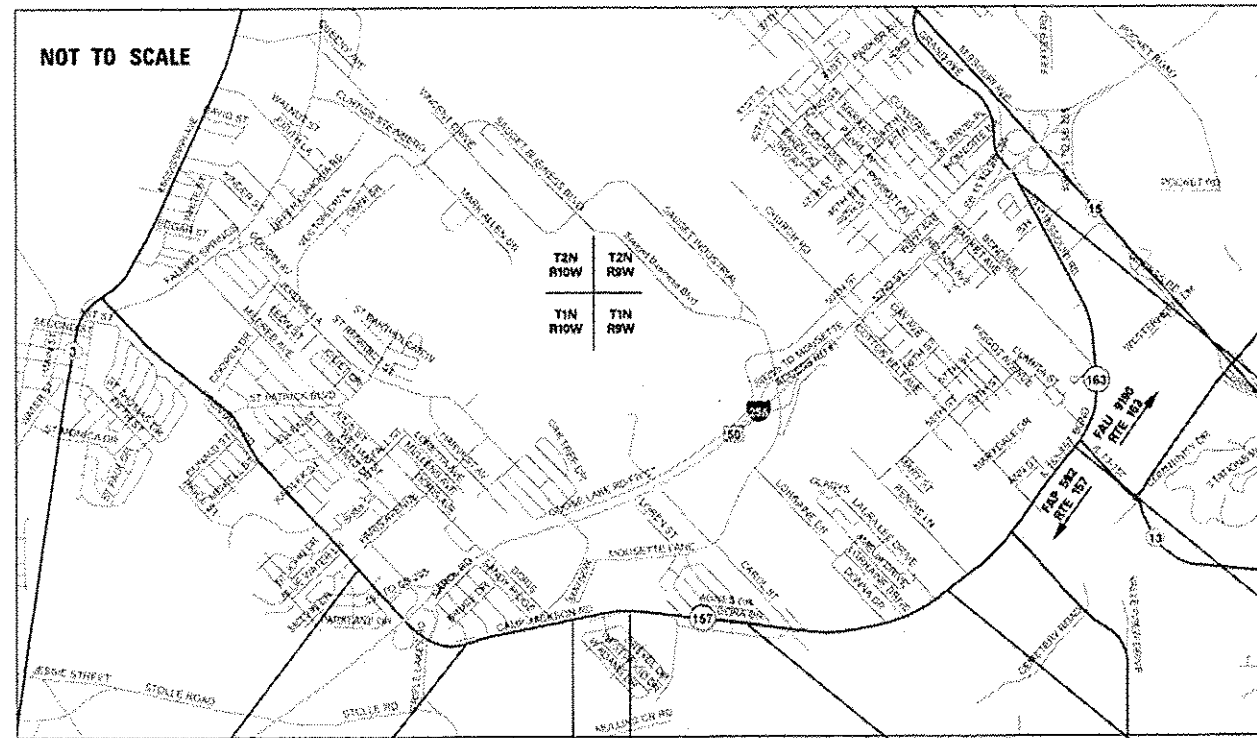

BEGIN PCC PATCHING
IL RTE 157 STA. 106+81

END PCC PATCHING
IL RTE 157 STA. 142+72

BEGIN OMISSION
IL RTE 157 STA. 182+49

BEGIN RESURFACING
IL RTE 157 STA. 168+74

END OMISSION
IL RTE 157 STA. 207+98

END RESURFACING
IL RTE 163
STA. 376+89

END OMISSION
IL RTE 157
STA. 307+41

END RESURFACING
IL RTE 163
STA. 376+89

END OMISSION
IL RTE 157
STA. 307+41

STATE OF ILLINOIS
DEPARTMENT OF TRANSPORTATION
DIVISION OF HIGHWAYS

SUBMITTED June 12, 2014

Jeffrey Z. Fair
DEPUTY DIRECTOR OF HIGHWAYS, REGION 5 ENGINEER

July 15, 2014

John D. Baranzelli, P.E.
acting ENGINEER OF DESIGN AND ENVIRONMENT

July 18, 2014

Omber Osman, P.E.
DIRECTOR, DIVISION OF HIGHWAYS

**PRINTED BY THE AUTHORITY
OF THE STATE OF ILLINOIS**

PROJECT ENGINEER PATTI LEBEAU (618) 346-3179
PROJECT MANAGER BILLIE OWEN (618) 346-3209

CONTRACT NO. 76G80



Lance D. Chrisman 6/11/2014
LANCE CHRISMAN, P.E. DATE
LICENSE NO. 062.056127 EXPIRES 11/30/2015

Kaskaskia
Engineering Group, LLC
PROFESSIONAL REGISTRATIONS
Illinois Professional Design Firm
Professional Engineering Group

208 East Main Street, Suite 100
Bellaire, Illinois 62230
618.333.9777 phone
618.333.9777 fax
www.kaskaskiaeng.com

