

DETECTOR LOOP REQUIREMENTS AND CALCULATIONS
FOR IL 157 & I-255 B-D RAMPS

LOOP#	PHASE#	LOOP SIZE (FT. X FT.)	REQUIRED# OF TURNS	CALCULATED INDUCTANCE MICROHENRIES	CALCULATED RESISTANCE OHMS
1. EB LT CD	6	6 X 50-Q	3-6-3	834.8	2.7
2. EB THRU CD	6	6 X 50-Q	3-6-3	838.6	2.8
3. EB RT CD	6	6 X 50-Q	3-6-3	826.9	2.5
4. NB LT-THRU CD	4	6 X 50-Q	3-6-3	828.0	2.5
5. NB RT CD	4	6 X 50-Q	3-6-3	828.5	2.6
6. WB CCO A	2	6 X 6	6	323.1	1.9
7. WB CCO B	2	6 X 6	6	320.9	1.9
8. WB LT CD	5	6 X 50-Q	3-6-3	814.2	2.2
9. WB THRU CD A	2	6 X 50-Q	3-6-3	817.7	2.3
10. WB THRU CD B	2	6 X 50-Q	3-6-3	821.2	2.4
11. WB RT CD	2	6 X 50-Q	3-6-3	796.8	1.8
12. SB LT CD	3	6 X 50-Q	3-6-3	834.2	2.7
13. SB THRU CD	3	6 X 50-Q	3-6-3	837.3	2.8
14. SB RT CD	3	6 X 50-Q	3-6-3	825.2	2.5

THE ABOVE VALUES ARE CALCULATED OF COMBINED LOOP AND LEAD-IN INDUCTANCE AND RESISTANCE. ACTUAL MEASURED VALUES SHOULD BE WITHIN +/- 20% OF THESE VALUES.

Q=QUADRAPOLE

⊙=SEE DETAIL A

NOTE: THIS LOCATION IS PATCHING ONLY. QUANTITIES HAVE BEEN INCLUDED FOR DETECTOR LOOP REPLACEMENT IN THE EVENT THAT THE LOCATIONS OF THE PATCHING DISTURB THE EXISTING LOOPS.

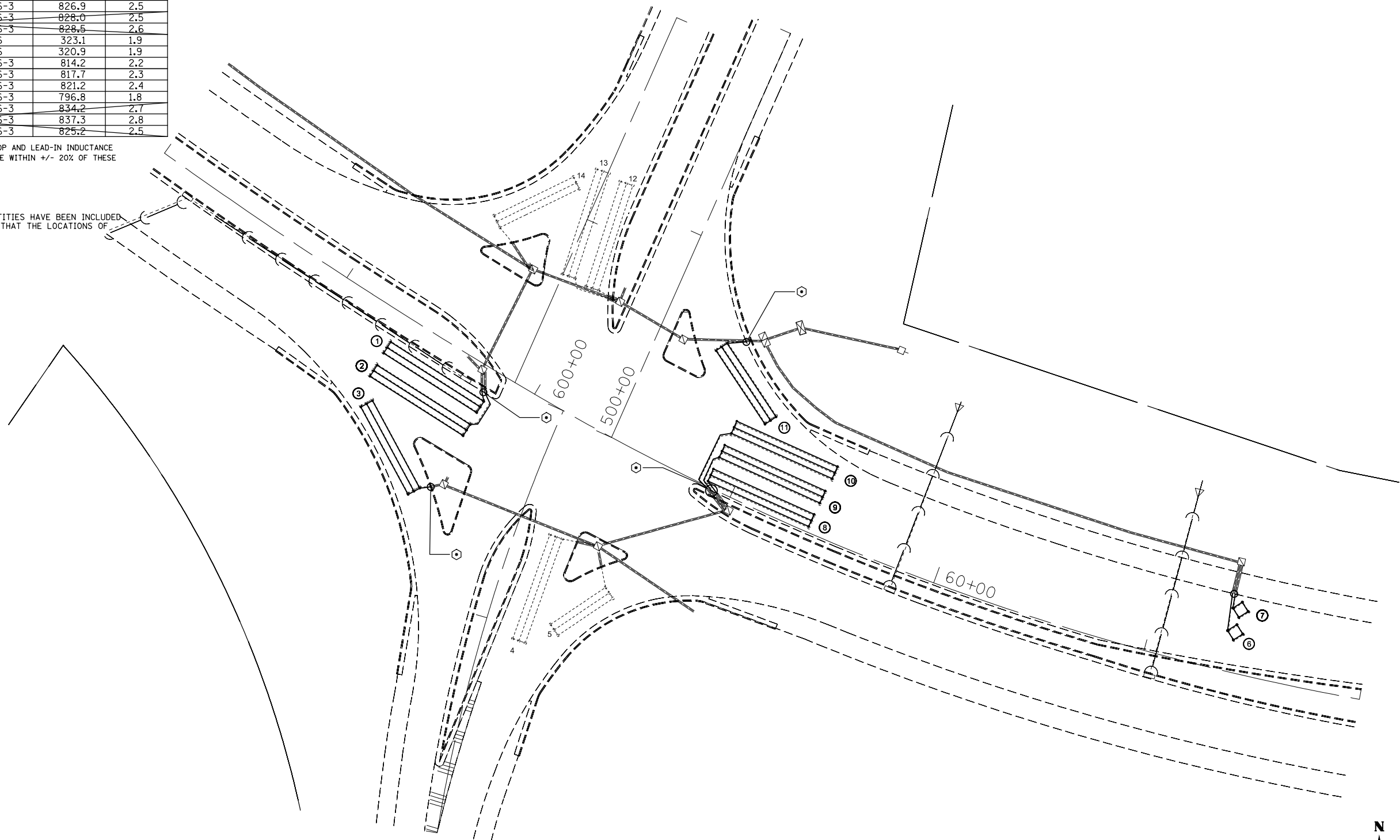

IL 157 & I-255 B-D RAMPS

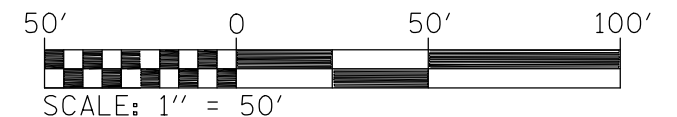

FILE NAME =	USER NAME = prestonm	DESIGNED -	REVISED -	STATE OF ILLINOIS DEPARTMENT OF TRANSPORTATION	DETECTOR LOOP REPLACEMENT PLAN		SECTION	COUNTY	TOTAL SHEETS	SHEET NO.
c:\pwork\pwork\prestonm\d0355955\d076g80-sht-TS.dgn		DRAWN -	REVISED -				121-IRS-1	ST. CLAIR	32	32
		CHECKED -	REVISED -		CONTRACT NO. 76G80					
		DATE -	REVISED -		ILLINOIS FED. AID PROJECT					