



# Illinois Department of Transportation

2300 South Dirksen Parkway / Springfield, Illinois / 62764

September 10, 2015

SUBJECT: FAP Route 17 (US 52/IL 64)  
Project ACNHPP-0017(132)  
Section 104B-2  
Carroll County, IL & Jackson County, IA  
Contract No. 64G59  
Item No. 1X, September 18, 2015 Letting  
Addendum A

## NOTICE TO PROSPECTIVE BIDDERS:

Attached is an addendum to the plans or proposal. This addendum involves revised and/or added material.

1. Replaced the Schedule of Prices
2. Revised the Table of Contents to the Special Provisions
3. Revised pages 44, 131, 135, 136, & 409 - 413 of the Special Provisions
4. Added pages 414 - 439 to the Special Provisions
5. Revised sheets 2, 6, 7, 24, 45, 63, 65, 81, 135 & 155 of the Plans

Prime contractors must utilize the enclosed material when preparing their bid and must include any Schedule of Prices changes in their bidding proposal.

Bidders using computer-generated bids are cautioned to reflect any and all Schedule of Prices changes, if involved, into their computer programs.

Very truly yours,

John D. Baranzelli, P.E.  
Acting Engineer of Design and Environment

A handwritten signature in black ink, appearing to read 'Ted B. Walschleger' with a small 'P.E.' to the right.

By: Ted B. Walschleger, P. E.  
Engineer of Project Management

cc: Paul Loete, Region 2, District 2; Tim Kell; D. Carl Puzey; Estimates

MS/ck

ILLINOIS DEPARTMENT OF TRANSPORTATION  
SCHEDULE OF PRICES  
CONTRACT  
NUMBER - 64G59

State Job # - C-92-128-13

County Name - CARROLL - -

Code - 15 - -

District - 2 - -

Section Number - 104B-2

Project Number

ACNHPP-0017/132/

\*REVISED: SEPTEMBER 3, 2015

Route

FAP 17

Item Number	Pay Item Description	Unit of Measure	Quantity	x	Unit Price	=	Total Price
A2C015G3	T-BETULA NIGRA CG 3G	EACH	166.000				
A2C040G3	T-PLAT OCCID CG 3G	EACH	166.000				
A2C050G3	T-QUERC BICOL CG 3G	EACH	166.000				
A2002314	T-BETULA NIGRA 1-3/4	EACH	27.000				
A2006514	T-QUERCUS BICOL 1-3/4	EACH	27.000				
A2006914	T-QUERCUS PALUS 1-3/4	EACH	27.000				
A2007814	T-TILIA AMER 1-3/4	EACH	26.000				
C2C01120	S-CEPHALAN OCCID 2' C	EACH	166.000				
C2C09624	S-SAMBUCUS CANAD 2'C	EACH	166.000				
X0300864	MAINT OF NAVIGATION	L SUM	1.000				
X0301847	WATER TRANSPORT- ENGR	CAL MO	30.000				
X0321809	PERMANENT GRND ANCHOR	EACH	268.000				
X0322024	TRENCH DRAIN	EACH	1.000				
X0322227	CCTV CAMERA SYSTEM	EACH	2.000				
*ADD X0323387	TIRTL TR DATA COL SYS	EACH	1.000				

ILLINOIS DEPARTMENT OF TRANSPORTATION  
SCHEDULE OF PRICES  
CONTRACT  
NUMBER - 64G59

State Job # - C-92-128-13

County Name - CARROLL - -  
Code - 15 - -  
District - 2 - -  
Section Number - 104B-2

Project Number  
ACNHPP-0017/132/  
\*REVISED: SEPTEMBER 3, 2015

Route  
FAP 17

Item Number	Pay Item Description	Unit of Measure	Quantity	x	Unit Price	=	Total Price
X0324455	DRILL/SET SOLD P SOIL	CU FT	34,256.000				
X0324456	DRILL/SET SOLD P ROCK	CU FT	24,003.000				
X0325366	STORM SEWER REPAIR	FOOT	3.000				
X0325634	HLMR BRNG FIXED 2500K	EACH	2.000				
X0325658	HLMR BRG GUID EX 2500	EACH	2.000				
X0326498	GFCI20A DX RECEPTACLE	EACH	26.000				
X0326805	FOUNDATION REMOVAL	SQ FT	4,644.000				
X0326935	CROSSHOLE SONIC LOG	EACH	32.000				
X0327357	CONSTRN VBRN MONITRNG	L SUM	1.000				
X0327778	HANGER ASSEMBLY ARCH	L SUM	1.000				
X0488100	REM EX SEPTIC TANK	EACH	2.000				
X0900015	COFFERCELL LOCATION 6	EACH	1.000				
X0900016	COFFERCELL LOCATION 7	EACH	1.000				
X0900017	COFFERCELL LOCATION 8	EACH	1.000				
X0900018	COFFERCELL LOCATION 9	EACH	1.000				

ILLINOIS DEPARTMENT OF TRANSPORTATION  
SCHEDULE OF PRICES  
CONTRACT  
NUMBER - 64G59

State Job # - C-92-128-13

County Name - CARROLL - -  
Code - 15 - -  
District - 2 - -  
Section Number - 104B-2

Project Number  
ACNHPP-0017/132/  
\*REVISED: SEPTEMBER 3, 2015

Route  
FAP 17

Item Number	Pay Item Description	Unit of Measure	Quantity	x	Unit Price	=	Total Price
X0900019	COFFERCELL LOC 10	EACH	1.000				
X0900020	THML INTGRTY PROF TST	EACH	4.000				
X1400094	LUM LED HM LOW WATT	EACH	14.000				
X1400113	LUM LED HM MED WATT	EACH	9.000				
X1400114	LED LIGHT DIM CON SYS	L SUM	1.000				
X1400115	TEMP WATWY OBS WL SYS	L SUM	1.000				
X2010505	CLEARING SPECIAL	L SUM	1.000				
X2300006	BICYCLE RAILING PR MT	FOOT	4,974.000				
X2501845	SEEDING CL 7 SPL	ACRE	2.500				
X4060310	HMA SC "C" N50 SPL	TON	101.000				
X4400110	TEMP PAVT REMOVAL	SQ YD	3,879.000				
X4823029	HMA SHOULDERS 8 SPL	SQ YD	2,226.000				
X5121800	PERM STEEL SHT PILING	SQ FT	7,114.000				
X5210110	HLMR BRG GUID EXP 200	EACH	6.000				
X5210120	HLMR BRG GUID EXP 250	EACH	6.000				

ILLINOIS DEPARTMENT OF TRANSPORTATION  
 SCHEDULE OF PRICES  
 CONTRACT  
 NUMBER - 64G59

State Job # - C-92-128-13

County Name - CARROLL - -  
 Code - 15 - -  
 District - 2 - -  
 Section Number - 104B-2

Project Number  
 ACNHPP-0017/132/  
 \*REVISED: SEPTEMBER 3, 2015

Route  
 FAP 17

Item Number	Pay Item Description	Unit of Measure	Quantity	x	Unit Price	=	Total Price
X5210160	HLMR BRG GUID EXP 450	EACH	24.000				
X5210345	HLMR BRNG FIXED 550K	EACH	6.000				
X5210355	HLMR BRNG FIXED 650K	EACH	12.000				
X550A576	TEMP SS CL A 2 24	FOOT	124.000				
X5860110	GRANULAR BACKFILL STR	CU YD	265.000				
X6024240	INLETS SPL	EACH	4.000				
X6024248	INLETS SPL N4	EACH	1.000				
X6024250	INLETS SPL N5	EACH	24.000				
X6026050	SANITARY MANHOLE ADJ	EACH	2.000				
X6028050	TEMPORARY MANHOLE	EACH	1.000				
X6028404	TEMP INLETS TA T1F OL	EACH	1.000				
X6062400	CONC GUTTER SPL	FOOT	1,386.000				
X6100120	TE INLT BX 610001 SPL	EACH	4.000				
X6330725	SPBGR (SHORT RADIUS)	FOOT	100.000				
X6640525	CH LK FENCE 4 ATT STR	FOOT	1,565.000				

ILLINOIS DEPARTMENT OF TRANSPORTATION  
SCHEDULE OF PRICES  
CONTRACT  
NUMBER - 64G59

State Job # - C-92-128-13

County Name - CARROLL - -  
Code - 15 - -  
District - 2 - -  
Section Number - 104B-2

Project Number  
ACNHPP-0017/132/  
\*REVISED: SEPTEMBER 3, 2015

Route  
FAP 17

Item Number	Pay Item Description	Unit of Measure	Quantity	x	Unit Price	=	Total Price
X7040125	PIN TEMP CONC BARRIER	EACH	486.000				
X7230203	INSTALL SIGN PANEL T3	SQ FT	32.000				
X7330064	SIGN SUPPORT SPL	EACH	5.000				
X7830060	GRV RCSD PM LTR & SYM	SQ FT	117.000				
X7830070	GRV RCSD PVT MRKG 5	FOOT	25,910.000				
X7830076	GRV RCSD PVT MRKG 9	FOOT	251.000				
X7830078	GRV RCSD PVT MRKG 13	FOOT	677.000				
X7830090	GRV RCSD PVT MRKG 25	FOOT	129.000				
X8110456	CON AT ST 1.5 SS	FOOT	80.000				
Z0005300	BOX CUL TO BE CLEANED	EACH	1.000				
Z0007118	UNTREATED TIMBER LAG	SQ FT	18,611.000				
Z0007601	BLDG REMOV NO 1	L SUM	1.000				
Z0013300	CONC REM SPEC	SQ YD	178.000				
Z0013797	STAB CONSTR ENTRANCE	SQ YD	500.000				
Z0013798	CONSTRUCTION LAYOUT	L SUM	1.000				

ILLINOIS DEPARTMENT OF TRANSPORTATION  
 SCHEDULE OF PRICES  
 CONTRACT  
 NUMBER - 64G59

State Job # - C-92-128-13

County Name - CARROLL - -  
 Code - 15 - -  
 District - 2 - -  
 Section Number - 104B-2

Project Number  
 ACNHPP-0017/132/  
 \*REVISED: SEPTEMBER 3, 2015

Route  
 FAP 17

Item Number	Pay Item Description	Unit of Measure	Quantity	x	Unit Price	=	Total Price
Z0015500	DEBRIS REMOVAL	L SUM	1.000				
Z0018002	DRAINAGE SCUPPR DS-11	EACH	32.000				
Z0023201	SED CONT SILT CURTAIN	EACH	6.000				
Z0025505	PROPERTY MARKERS	EACH	19.000				
Z0026403	FUR SOLDIER PILES BU	FOOT	4,427.000				
Z0026404	FUR SOLDIER PILES WS	FOOT	3,275.000				
Z0027800	GEOTECH FABRIC	SQ YD	4,471.000				
Z0028415	GEOTECHNICAL REINF	SQ YD	9,560.000				
Z0034398	MODULAR EXPAN JT 15	FOOT	40.000				
Z0034500	MODULAR EXPAN JT 18	FOOT	40.000				
Z0046304	P UNDR FOR STRUCT 4	FOOT	1,723.000				
Z0048665	RR PROT LIABILITY INS	L SUM	1.000				
Z0049901	R&D NON-FR ASB BLD 1	L SUM	1.000				
Z0054400	ROCK FILL	CU YD	7,284.000				
Z0056610	STORM SEW WM REQ 15	FOOT	117.000				

ILLINOIS DEPARTMENT OF TRANSPORTATION  
SCHEDULE OF PRICES  
CONTRACT  
NUMBER - 64G59

State Job # - C-92-128-13

County Name - CARROLL - -  
Code - 15 - -  
District - 2 - -  
Section Number - 104B-2

Project Number  
ACNHPP-0017/132/  
\*REVISED: SEPTEMBER 3, 2015

Route  
FAP 17

Item Number	Pay Item Description	Unit of Measure	Quantity	x	Unit Price	=	Total Price
Z0056628	STORM SEW WM REQ 54	FOOT	47.000				
Z0062456	TEMP PAVEMENT	SQ YD	3,879.000				
Z0062458	TEMP PAVEMT VAR DEPTH	TON	245.000				
Z0073002	TEMP SOIL RETEN SYSTM	SQ FT	14,512.000				
Z0075496	CONC RETAIN WALL REM	FOOT	799.000				
Z0076600	TRAINEES	HOURL	4,000.000		0.800		3,200.000
Z0076604	TRAINEES TPG	HOURL	4,000.000		15.000		60,000.000
20100110	TREE REMOV 6-15	UNIT	474.000				
*REV 20100210	TREE REMOV OVER 15	UNIT	248.000				
20100500	TREE REMOV ACRES	ACRE	3.250				
20101100	TREE TRUNK PROTECTION	EACH	10.000				
20101350	TREE PRUN OVER 10	EACH	10.000				
20200100	EARTH EXCAVATION	CU YD	33,040.000				
20200200	ROCK EXCAVATION	CU YD	541.000				
20201200	REM & DISP UNS MATL	CU YD	12,980.000				



ILLINOIS DEPARTMENT OF TRANSPORTATION  
 SCHEDULE OF PRICES  
 CONTRACT  
 NUMBER - 64G59

State Job # - C-92-128-13

County Name - CARROLL - -  
 Code - 15 - -  
 District - 2 - -  
 Section Number - 104B-2

Project Number  
 ACNHPP-0017/132/  
 \*REVISED: SEPTEMBER 3, 2015

Route  
 FAP 17

Item Number	Pay Item Description	Unit of Measure	Quantity	x	Unit Price	=	Total Price
20400800	FURNISHED EXCAVATION	CU YD	6,372.000				
20600110	GRAN EMBANK SPEC	TON	1,806.000				
20800150	TRENCH BACKFILL	CU YD	1,365.000				
21101615	TOPSOIL F & P 4	SQ YD	23,025.000				
21301052	EXPLOR TRENCH 52	FOOT	500.000				
21400100	GRADING & SHAP DITCH	FOOT	95.000				
25000100	SEEDING CL 1	ACRE	1.750				
25000312	SEEDING CL 4A	ACRE	2.500				
25000400	NITROGEN FERT NUTR	POUND	413.000				
25000500	PHOSPHORUS FERT NUTR	POUND	413.000				
25000600	POTASSIUM FERT NUTR	POUND	413.000				
25000750	MOWING	ACRE	7.500				
25100125	MULCH METHOD 3	ACRE	8.000				
25100630	EROSION CONTR BLANKET	SQ YD	5,961.000				
25100900	TURF REINF MAT	SQ YD	11,653.000				

ILLINOIS DEPARTMENT OF TRANSPORTATION  
 SCHEDULE OF PRICES  
 CONTRACT  
 NUMBER - 64G59

State Job # - C-92-128-13

County Name - CARROLL - -  
 Code - 15 - -  
 District - 2 - -  
 Section Number - 104B-2

Project Number  
 ACNHPP-0017/132/  
 \*REVISED: SEPTEMBER 3, 2015

Route  
 FAP 17

Item Number	Pay Item Description	Unit of Measure	Quantity	x	Unit Price	=	Total Price
25200110	SODDING SALT TOLERANT	SQ YD	2,457.000				
25200200	SUPPLE WATERING	UNIT	22.100				
28000250	TEMP EROS CONTR SEED	POUND	3,517.000				
28000305	TEMP DITCH CHECKS	FOOT	30.000				
28000400	PERIMETER EROS BAR	FOOT	4,843.000				
28000500	INLET & PIPE PROTECT	EACH	37.000				
28100107	STONE RIPRAP CL A4	SQ YD	681.000				
28100109	STONE RIPRAP CL A5	SQ YD	10,467.000				
28100201	STONE RIPRAP CL A1	TON	2,403.000				
28100209	STONE RIPRAP CL A5	TON	18,011.000				
28200200	FILTER FABRIC	SQ YD	14,668.000				
28500400	ARTICUL BLOCK REV MAT	SQ YD	444.000				
30300112	AGG SUBGRADE IMPR 12	SQ YD	23,371.000				
30300124	AGG SUBGRADE IMPR 24	SQ YD	1,244.000				
31101900	SUB GRAN MAT C	TON	367.000				

ILLINOIS DEPARTMENT OF TRANSPORTATION  
 SCHEDULE OF PRICES  
 CONTRACT  
 NUMBER - 64G59

State Job # - C-92-128-13

County Name - CARROLL - -

Code - 15 - -

District - 2 - -

Section Number - 104B-2

Project Number  
 ACNHPP-0017/132/  
 \*REVISED: SEPTEMBER 3, 2015

Route

FAP 17

Item Number	Pay Item Description	Unit of Measure	Quantity	x	Unit Price	=	Total Price
35102000	AGG BASE CSE B 8	SQ YD	166.000				
40200800	AGG SURF CSE B	TON	374.000				
40201000	AGGREGATE-TEMP ACCESS	TON	241.000				
40600275	BIT MATLS PR CT	POUND	106,523.000				
40603310	HMA SC "C" N50	TON	367.000				
40701871	HMA PAVT FD 9 1/2	SQ YD	4,275.000				
40701876	HMA PAVT FD 9 3/4	SQ YD	8,461.000				
40800050	INCIDENTAL HMA SURF	TON	19.000				
42001300	PROTECTIVE COAT	SQ YD	1,931.000				
42001430	BR APPR PVT CON (FLX)	SQ YD	777.000				
42300300	PCC DRIVEWAY PAVT 7	SQ YD	470.000				
42400200	PC CONC SIDEWALK 5	SQ FT	3,387.000				
42400800	DETECTABLE WARNINGS	SQ FT	57.000				
44000100	PAVEMENT REM	SQ YD	10,827.000				
44000200	DRIVE PAVEMENT REM	SQ YD	2,333.000				

ILLINOIS DEPARTMENT OF TRANSPORTATION  
SCHEDULE OF PRICES  
CONTRACT  
NUMBER - 64G59

State Job # - C-92-128-13

County Name - CARROLL - -  
Code - 15 - -  
District - 2 - -  
Section Number - 104B-2

Project Number  
ACNHPP-0017/132/  
\*REVISED: SEPTEMBER 3, 2015

Route  
FAP 17

Item Number	Pay Item Description	Unit of Measure	Quantity	x	Unit Price	=	Total Price
44000500	COMB CURB GUTTER REM	FOOT	2,696.000				
44000600	SIDEWALK REM	SQ FT	3,078.000				
44004250	PAVED SHLD REMOVAL	SQ YD	3,131.000				
44201717	CL D PATCH T2 6	SQ YD	150.000				
44201721	CL D PATCH T3 6	SQ YD	150.000				
44201723	CL D PATCH T4 6	SQ YD	175.000				
48101600	AGGREGATE SHLDS B 8	SQ YD	1,379.000				
48203021	HMA SHOULDERS 6	SQ YD	3,395.000				
50100100	REM EXIST STRUCT	EACH	1.000				
50157300	PROTECTIVE SHIELD	SQ YD	1,792.000				
50200100	STRUCTURE EXCAVATION	CU YD	4,127.000				
50200300	COFFERDAM EXCAVATION	CU YD	2,023.000				
50200400	ROCK EXC STRUCT	CU YD	46.000				
50201121	COFFERDAM TYP 2 LOC 1	EACH	1.000				
50201122	COFFERDAM TYP 2 LOC 2	EACH	1.000				

ILLINOIS DEPARTMENT OF TRANSPORTATION  
SCHEDULE OF PRICES  
CONTRACT  
NUMBER - 64G59

State Job # - C-92-128-13

County Name - CARROLL - -

Code - 15 - -

District - 2 - -

Section Number - 104B-2

Project Number

ACNHPP-0017/132/

\*REVISED: SEPTEMBER 3, 2015

Route

FAP 17

Item Number	Pay Item Description	Unit of Measure	Quantity	x	Unit Price	=	Total Price
50201123	COFFERDAM TYP 2 LOC 3	EACH	1.000				
50201124	COFFERDAM TYP 2 LOC 4	EACH	1.000				
50300225	CONC STRUCT	CU YD	8,759.900				
50300255	CONC SUP-STR	CU YD	3,717.000				
50300260	BR DECK GROOVING	SQ YD	10,807.000				
50300265	SEAL COAT CONC	CU YD	674.200				
50300280	CONCRETE ENCASEMENT	CU YD	8.000				
50300285	FORM LINER TEX SURF	SQ FT	25,352.000				
50300300	PROTECTIVE COAT	SQ YD	16,487.000				
50500105	F & E STRUCT STEEL	L SUM	1.000				
50500505	STUD SHEAR CONNECTORS	EACH	48,473.000				
50800105	REINFORCEMENT BARS	POUND	975,181.000				
50800205	REINF BARS, EPOXY CTD	POUND	2,105,460.000				
50800515	BAR SPLICERS	EACH	98.000				
50800530	MECHANICAL SPLICERS	EACH	1,696.000				

ILLINOIS DEPARTMENT OF TRANSPORTATION  
 SCHEDULE OF PRICES  
 CONTRACT  
 NUMBER - 64G59

State Job # - C-92-128-13

County Name - CARROLL - -  
 Code - 15 - -  
 District - 2 - -  
 Section Number - 104B-2

Project Number  
 ACNHPP-0017/132/  
 \*REVISED: SEPTEMBER 3, 2015

Route  
 FAP 17

Item Number	Pay Item Description	Unit of Measure	Quantity	x	Unit Price	=	Total Price
51200959	FUR M S PILE 14X0.312	FOOT	9,318.000				
51201600	FUR STL PILE HP12X53	FOOT	441.000				
51202305	DRIVING PILES	FOOT	9,759.000				
51203200	TEST PILE MET SHELLS	EACH	10.000				
51203600	TEST PILE ST HP12X53	EACH	2.000				
51204650	PILE SHOES	EACH	23.000				
51500100	NAME PLATES	EACH	2.000				
51602000	PERMANENT CASING	FOOT	2,191.000				
51603000	DRILLED SHAFT IN SOIL	CU YD	3,959.700				
51604000	DRILLED SHAFT IN ROCK	CU YD	690.300				
52000110	PREF JT STRIP SEAL	FOOT	99.500				
52100010	ELAST BEARING ASSY T1	EACH	96.000				
52100020	ELAST BEARING ASSY T2	EACH	14.000				
52100510	ANCHOR BOLTS 3/4	EACH	168.000				
52100530	ANCHOR BOLTS 1 1/4	EACH	52.000				

ILLINOIS DEPARTMENT OF TRANSPORTATION  
 SCHEDULE OF PRICES  
 CONTRACT  
 NUMBER - 64G59

State Job # - C-92-128-13

County Name - CARROLL - -  
 Code - 15 - -  
 District - 2 - -  
 Section Number - 104B-2

Project Number  
 ACNHPP-0017/132/  
 \*REVISED: SEPTEMBER 3, 2015

Route  
 FAP 17

Item Number	Pay Item Description	Unit of Measure	Quantity	x	Unit Price	=	Total Price
52100540	ANCHOR BOLTS 1 1/2	EACH	48.000				
52100560	ANCHOR BOLTS 2	EACH	20.000				
54002070	EXPAN BOLTS 3/4 X 15	EACH	4.000				
54213447	END SECTIONS 12	EACH	1.000				
54244405	FL INLT BX MED 542546	EACH	1.000				
54248510	CONCRETE COLLAR	CU YD	1.000				
54260311	TRAVERS PIPE GRATE	FOOT	62.000				
54261315	CONC ES 542001 15 1:3	EACH	1.000				
54261318	CONC ES 542001 18 1:3	EACH	1.000				
54261324	CONC ES 542001 24 1:3	EACH	1.000				
54261336	CONC ES 542001 36 1:3	EACH	2.000				
54261354	CONC ES 542001 54 1:3	EACH	1.000				
550A0050	STORM SEW CL A 1 12	FOOT	30.000				
550A0070	STORM SEW CL A 1 15	FOOT	95.000				
550A0120	STORM SEW CL A 1 24	FOOT	23.000				

ILLINOIS DEPARTMENT OF TRANSPORTATION  
 SCHEDULE OF PRICES  
 CONTRACT  
 NUMBER - 64G59

State Job # - C-92-128-13

County Name - CARROLL - -  
 Code - 15 - -  
 District - 2 - -  
 Section Number - 104B-2

Project Number  
 ACNHPP-0017/132/  
 \*REVISED: SEPTEMBER 3, 2015

Route  
 FAP 17

Item Number	Pay Item Description	Unit of Measure	Quantity	x	Unit Price	=	Total Price
550A0340	STORM SEW CL A 2 12	FOOT	165.000				
550A0360	STORM SEW CL A 2 15	FOOT	509.000				
550A0380	STORM SEW CL A 2 18	FOOT	883.000				
550A0410	STORM SEW CL A 2 24	FOOT	796.000				
550A0450	STORM SEW CL A 2 36	FOOT	58.000				
550A0490	STORM SEW CL A 2 54	FOOT	78.000				
55100500	STORM SEWER REM 12	FOOT	28.000				
55100900	STORM SEWER REM 18	FOOT	75.000				
55101900	STORM SEWER REM 48	FOOT	236.000				
56100600	WATER MAIN 6	FOOT	50.000				
56100700	WATER MAIN 8	FOOT	30.000				
56200200	WATER SERV LINE 3/4	FOOT	122.000				
56400500	FIRE HYDNTS TO BE REM	EACH	1.000				
56400600	FIRE HYDRANTS	EACH	1.000				
58700300	CONCRETE SEALER	SQ FT	20,218.000				



ILLINOIS DEPARTMENT OF TRANSPORTATION  
 SCHEDULE OF PRICES  
 CONTRACT  
 NUMBER - 64G59

State Job # - C-92-128-13

County Name - CARROLL - -  
 Code - 15 - -  
 District - 2 - -  
 Section Number - 104B-2

Project Number  
 ACNHPP-0017/132/  
 \*REVISED: SEPTEMBER 3, 2015

Route  
 FAP 17

Item Number	Pay Item Description	Unit of Measure	Quantity	x	Unit Price	=	Total Price
59100100	GEOCOMPOSITE WALL DR	SQ YD	1,564.000				
60100080	FRENCH DRAINS	CU YD	6.000				
60100945	PIPE DRAINS 12	FOOT	11.000				
60107600	PIPE UNDERDRAINS 4	FOOT	2,198.000				
60108100	PIPE UNDERDRAIN 4 SP	FOOT	174.000				
60218400	MAN TA 4 DIA T1F CL	EACH	13.000				
60221100	MAN TA 5 DIA T1F CL	EACH	1.000				
60224459	MAN TA 8 DIA T1F CL	EACH	1.000				
60224469	MAN TA 9 DIA T1F CL	EACH	2.000				
60266600	VALVE BOX ADJ	EACH	4.000				
60500060	REMOV INLETS	EACH	4.000				
60605000	COMB CC&G TB6.24	FOOT	1,206.500				
60608582	COMB CC&G TM4.24	FOOT	1,882.500				
60615400	PAVED DITCH TA-15	FOOT	47.000				
60622320	CONC MED TSM4.24	SQ FT	1,008.000				

ILLINOIS DEPARTMENT OF TRANSPORTATION  
 SCHEDULE OF PRICES  
 CONTRACT  
 NUMBER - 64G59

State Job # - C-92-128-13

County Name - CARROLL - -  
 Code - 15 - -  
 District - 2 - -  
 Section Number - 104B-2

Project Number  
 ACNHPP-0017/132/  
 \*REVISED: SEPTEMBER 3, 2015

Route  
 FAP 17

Item Number	Pay Item Description	Unit of Measure	Quantity	x	Unit Price	=	Total Price
60900515	CONC THRUST BLOCKS	EACH	12.000				
63000001	SPBGR TY A 6FT POSTS	FOOT	3,587.500				
63000009	SPBGR TY B 9FT POSTS	FOOT	250.000				
63000370	LSG OVER CUL 25' SPAN	FOOT	350.000				
63100045	TRAF BAR TERM T2	EACH	1.000				
63100085	TRAF BAR TERM T6	EACH	4.000				
63100167	TR BAR TRM T1 SPL TAN	EACH	2.000				
63200310	GUARDRAIL REMOV	FOOT	4,158.000				
66600105	FUR ERECT ROW MARKERS	EACH	2.000				
66700305	PERM SURV MKRS T2	EACH	2.000				
66900200	NON SPL WASTE DISPOSL	CU YD	7,400.000				
66900450	SPL WASTE PLNS/REPORT	L SUM	1.000				
66900530	SOIL DISPOSAL ANALY	EACH	6.000				
67000400	ENGR FIELD OFFICE A	CAL MO	30.000				
67000600	ENGR FIELD LAB	CAL MO	30.000				

ILLINOIS DEPARTMENT OF TRANSPORTATION  
 SCHEDULE OF PRICES  
 CONTRACT  
 NUMBER - 64G59

State Job # - C-92-128-13

County Name - CARROLL - -  
 Code - 15 - -  
 District - 2 - -  
 Section Number - 104B-2

Project Number  
 ACNHPP-0017/132/  
 \*REVISED: SEPTEMBER 3, 2015

Route  
 FAP 17

Item Number	Pay Item Description	Unit of Measure	Quantity	x	Unit Price	=	Total Price
67100100	MOBILIZATION	L SUM	1.000				
70100100	TRAF CONT-PROT 701316	EACH	5.000				
70100200	TRAF CONT-PROT 701331	EACH	5.000				
70100450	TRAF CONT-PROT 701201	L SUM	1.000				
70100500	TRAF CONT-PROT 701326	L SUM	1.000				
70102620	TR CONT & PROT 701501	L SUM	1.000				
70102635	TR CONT & PROT 701701	L SUM	1.000				
70102640	TR CONT & PROT 701801	L SUM	1.000				
70103815	TR CONT SURVEILLANCE	CAL DA	175.000				
70106500	TEMP BR TRAF SIGNALS	EACH	5.000				
70106700	TEMP RUMBLE STRIPS	EACH	12.000				
70106800	CHANGEABLE MESSAGE SN	CAL MO	9.000				
70300100	SHORT TERM PAVT MKING	FOOT	1,464.000				
70300220	TEMP PVT MK LINE 4	FOOT	52,208.000				
70300280	TEMP PVT MK LINE 24	FOOT	287.000				

ILLINOIS DEPARTMENT OF TRANSPORTATION  
 SCHEDULE OF PRICES  
 CONTRACT  
 NUMBER - 64G59

State Job # - C-92-128-13

County Name - CARROLL - -  
 Code - 15 - -  
 District - 2 - -  
 Section Number - 104B-2

Project Number  
 ACNHPP-0017/132/  
 \*REVISED: SEPTEMBER 3, 2015

Route  
 FAP 17

Item Number	Pay Item Description	Unit of Measure	Quantity	x	Unit Price	=	Total Price
70301000	WORK ZONE PAVT MK REM	SQ FT	17,781.000				
70400100	TEMP CONC BARRIER	FOOT	1,525.000				
70400200	REL TEMP CONC BARRIER	FOOT	612.500				
70500100	TEMP SPBGR TY A	FOOT	337.000				
70500615	TEMP TR BAR TERM T1	EACH	3.000				
70500690	TEMP TR BAR TERM T11	EACH	3.000				
70600240	IMP ATTN TEMP NRD TL2	EACH	1.000				
70600255	IMP ATTN TEMP FRN TL2	EACH	3.000				
70600260	IMP ATTN TEMP FRN TL3	EACH	1.000				
70600322	IMP ATTN REL FRN TL2	EACH	4.000				
70600332	IMP ATTN REL FRN TL3	EACH	3.000				
70600340	IMP ATTN REL NRD TL2	EACH	1.000				
72000100	SIGN PANEL T1	SQ FT	506.000				
72000200	SIGN PANEL T2	SQ FT	148.000				
72400100	REMOV SIN PAN ASSY TA	EACH	45.000				

ILLINOIS DEPARTMENT OF TRANSPORTATION  
SCHEDULE OF PRICES  
CONTRACT  
NUMBER - 64G59

State Job # - C-92-128-13

County Name - CARROLL - -  
Code - 15 - -  
District - 2 - -  
Section Number - 104B-2

Project Number  
ACNHPP-0017/132/  
\*REVISED: SEPTEMBER 3, 2015

Route  
FAP 17

Item Number	Pay Item Description	Unit of Measure	Quantity	x	Unit Price	=	Total Price
72400200	REMOV SIN PAN ASSY TB	EACH	17.000				
72800100	TELES STL SIN SUPPORT	FOOT	784.000				
73000100	WOOD SIN SUPPORT	FOOT	210.000				
73100100	BASE TEL STL SIN SUPP	EACH	2.000				
78008200	POLYUREA PM T1 LTR-SY	SQ FT	117.000				
78008210	POLYUREA PM T1 LN 4	FOOT	25,910.000				
78008240	POLYUREA PM T1 LN 8	FOOT	251.000				
78008250	POLYUREA PM T1 LN 12	FOOT	677.000				
78008270	POLYUREA PM T1 LN 24	FOOT	129.000				
78100100	RAISED REFL PAVT MKR	EACH	85.000				
78200300	PRISMATIC CURB REFL	EACH	16.000				
78200420	GUARDRAIL MKR TYPE B	EACH	65.000				
78200520	BAR WALL MKR TYPE B	EACH	62.000				
78201000	TERMINAL MARKER - DA	EACH	5.000				
78300100	PAVT MARKING REMOVAL	SQ FT	3,412.000				

ILLINOIS DEPARTMENT OF TRANSPORTATION  
 SCHEDULE OF PRICES  
 CONTRACT  
 NUMBER - 64G59

State Job # - C-92-128-13

County Name - CARROLL - -  
 Code - 15 - -  
 District - 2 - -  
 Section Number - 104B-2

Project Number  
 ACNHPP-0017/132/  
 \*REVISED: SEPTEMBER 3, 2015

Route  
 FAP 17

Item Number	Pay Item Description	Unit of Measure	Quantity	x	Unit Price	=	Total Price
80400100	ELECT SERV INSTALL	EACH	1.000				
81028770	UNDRGRD C CNC 3	FOOT	240.000				
81100500	CON AT ST 1 1/2 GALVS	FOOT	3,330.000				
81200230	CON EMB STR 2 PVC	FOOT	3,835.000				
81300520	JUN BX SS AS 12X8X6	EACH	26.000				
81300530	JUN BX SS AS 12X10X6	EACH	10.000				
81300555	JUN BX SS AS 12X12X8	EACH	9.000				
81300720	JUN BX SS AS 16X12X8	EACH	2.000				
81603000	UD 2#8 #8G XLP USE 3/4	FOOT	1,500.000				
81603040	UD 2#6 #8G XLP USE 1	FOOT	70.000				
81603080	UD 3#2#4G XLP USE 1 1/4	FOOT	250.000				
81702120	EC C XLP USE 1C 8	FOOT	7,580.000				
81702130	EC C XLP USE 1C 6	FOOT	7,720.000				
81702140	EC C XLP USE 1C 4	FOOT	5,820.000				
81702150	EC C XLP USE 1C 2	FOOT	3,060.000				

ILLINOIS DEPARTMENT OF TRANSPORTATION  
 SCHEDULE OF PRICES  
 CONTRACT  
 NUMBER - 64G59

State Job # - C-92-128-13

County Name - CARROLL - -

Code - 15 - -

District - 2 - -

Section Number - 104B-2

Project Number

ACNHPP-0017/132/

\*REVISED: SEPTEMBER 3, 2015

Route

FAP 17

Item Number	Pay Item Description	Unit of Measure	Quantity	x	Unit Price	=	Total Price
82200605	WATWY OBS WARN LM LED	EACH	6.000				
82500390	LT CONT BASM 240V100D	EACH	1.000				
83001200	LT P A 35MH 6DA	EACH	14.000				
83003600	LT P A 45MH 15DA	EACH	9.000				
83600355	LP F M 15BC 8" X 6'	EACH	9.000				
83800650	BKWY DEV COU SS SCRN	EACH	8.000				
84200600	REM LT U NO SALV	EACH	13.000				
84200804	REM POLE FDN	EACH	1.000				
84301100	REM NAV OBS WL UNIT	EACH	6.000				
84500110	REMOV LIGHTING CONTR	EACH	1.000				
84500120	REMOV ELECT SERV INST	EACH	2.000				

**CONTRACT NUMBER**

**64G59**

**THIS IS THE TOTAL BID**

**\$ \_\_\_\_\_**

**NOTES:**

- 1. Each PAY ITEM should have a UNIT PRICE and a TOTAL PRICE.**
- 2. The UNIT PRICE shall govern if no TOTAL PRICE is shown or if there is a discrepancy between the product of the UNIT PRICE multiplied by the QUANTITY.**
- 3. If a UNIT PRICE is omitted, the TOTAL PRICE will be divided by the QUANTITY in order to establish a UNIT PRICE.**
- 4. A bid may be declared UNACCEPTABLE if neither a unit price nor a total price is shown.**



## TABLE OF CONTENTS

LOCATION OF PROJECT .....	1
DESCRIPTION OF PROJECT .....	1
MAINTENANCE OF ROADWAYS .....	1
COMPLETION DATE PLUS WORKING DAYS .....	2
WORK RESTRICTIONS .....	2
POTENTIAL CONSTRUCTION DELAYS DUE TO HIGH WATER .....	3
COOPERATION WITH UTILITIES .....	3
TRAFFIC CONTROL PLAN .....	4
TRAFFIC CONTROL SURVEILLANCE .....	9
WORK ZONE PAVEMENT MARKING AND REMOVAL .....	10
IMPACT ATTENUATORS, TEMPORARY (NON-REDIRECTIVE) .....	10
PCC AUTOMATIC BATCHING EQUIPMENT .....	11
PCC QC/QA ELECTRONIC REPORTS SUBMITTAL .....	11
CRITICAL PATH SCHEDULE .....	11
RAILROAD COORDINATION WITH THE BURLINGTON NORTHERN SANTA FE R.R.....	12
MAINTENANCE OF NAVIGATION.....	14
WATER TRANSPORTATION FOR ENGINEER .....	19
ENGINEER’S FIELD OFFICE TYPE A.....	19
STABILIZED CONSTRUCTION ENTRANCE.....	20
SEDIMENT CONTROL, SILT CURTAIN .....	20
WETLAND MITIGATION .....	22
SEED BED PREPARATION .....	22
SEEDING, CLASS 7 (SPECIAL) .....	22
TREES .....	23
MOWING .....	24
ROCK EMBANKMENT .....	25
STONE RIPRAP .....	25
ROCK FILL .....	25
ARTICULATED BLOCK REVETMENT MAT .....	26
GEOTECHNICAL FABRIC .....	29
GEOTECHNICAL REINFORCEMENT .....	29

TEMPORARY PAVEMENT .....	32
TEMPORARY PAVEMENT (VARIABLE DEPTH) .....	33
HOT MIX ASPHALT QUALITY CONTROL FOR PERFORMANCE (BMPR) .....	33
HOT-MIX ASPHALT MIXTURE IL-9.5FG (BMPR) .....	37
HOT-MIX ASPHALT MIXTURE IL-19.0FG (BMPR) .....	42
HOT-MIX ASPHALT SURFACE COURSE, MIX C, N50, SPECIAL .....	43
HOT-MIX ASPHALT SURFACE COURSE, CUT OFF DATE.....	44
HOT-MIX ASPHALT SHOULDERS, 8", SPECIAL.....	44
CLEARING, SPECIAL .....	44
DEBRIS REMOVAL .....	45
GUARDRAIL REMOVAL .....	45
CONCRETE REMOVAL (SPECIAL).....	45
CONCRETE RETAINING WALL REMOVAL.....	46
FOUNDATION REMOVAL.....	47
REMOVAL OF EXISTING STRUCTURES .....	48
COFFERCELL .....	50
DRILLED SHAFTS.....	51
CROSSHOLE SONIC LOGGING .....	52
HANGER ASSEMBLIES FOR TIED ARCH SPAN .....	58
FABRICATION AND ERECTION OF STEEL TIED ARCH STRUCTURE.....	63
ERECTION OF STEEL GIRDER STRUCTURES.....	70
TEMPORARY FACILITIES INSTALLED BY CONTRACTOR .....	71
HOT DIP GALVANIZING FOR STRUCTURAL STEEL .....	72
CHAIN LINK FENCE, 4' ATTACHED TO STRUCTURE .....	77
BICYCLE RAILING (PARAPET MOUNTED).....	78
PERMANENT GROUND ANCHORS .....	78
FORM LINER TEXTURED SURFACE .....	90
USE OF EXPLOSIVES .....	93
POTENTIAL IMPACTS TO FISH FROM BLASTING .....	94
CONSTRUCTION VIBRATION MONITORING .....	95
WATER MAIN .....	96
STORM SEWER WATER MAIN REQUIREMENT .....	101
STORM SEWER REPAIR .....	102

STORM SEWER REMOVAL ..... 102

VALVE BOXES TO BE ADJUSTED ..... 103

FIRE HYDRANTS TO BE REMOVED ..... 103

FIRE HYDRANTS ..... 103

INLETS, SPECIAL ..... 104

INLETS, SPECIAL, NO. 4, 5 ..... 105

TYPE E INLET BOX, STANDARD 610001 (SPECIAL) ..... 105

TRENCH DRAIN ..... 106

SANITARY MANHOLES TO BE ADJUSTED OR RECONSTRUCTED ..... 106

PROTECTION OF EXISTING DRAINAGE FACILITIES DURING CONSTRUCTION..... 107

CULVERT TO BE CLEANED ..... 107

TEMPORARY STORM SEWERS , CLASS A, TYPE 2 24" ..... 107

TEMPORARY MANHOLE ..... 108

TEMPORARY INLETS, TYPE A, TYPE 1 FRAME, OPEN LID ..... 108

REMOVING EXISTING SEPTIC TANK ..... 109

CONCRETE GUTTER (SPECIAL) ..... 110

PROPERTY MARKERS ..... 110

STEEL PLATE BEAM GUARDRAIL (SHORT RADIUS)..... 111

STEEL PLATE BEAM GUARDRAIL, TYPE B, 9 FOOT POSTS ..... 111

SIGN SUPPORT SPECIAL..... 111

INSTALL SIGN PANEL - TYPE 3 ..... 112

CLOSED CIRCUIT TELEVISION CAMERA SYSTEM ..... 112

GFCI 20 AMP DUPLEX RECEPTACLE ..... 114

CONDUIT ATTACHED TO STRUCTURE ..... 114

TEMPORARY WATERWAY OBSTRUCTION WARNING LIGHTING SYSTEM..... 115

LUMINAIRE, LED, HORIZONTAL MOUNT, LW ..... 116

LUMINAIRE, LED, HORIZONTAL MOUNT, MW ..... 116

LED LIGHTING DIMMING CONTROL SYSTEM..... 124

BUILDING REMOVAL - CASE II (NON-FRIABLE ASBESTOS ABATEMENT) (BDE) ..... 129

REMOVAL AND DISPOSAL OF REGULATED SUBSTANCES..... 136

THERMAL INTEGRITY PROFILING FOR DRILLED SHAFTS ..... 138

HIGH LOAD MULTI-ROTATIONAL BEARINGS..... 141

MODULAR EXPANSION JOINT..... 146

DRILLED SOLDIER PILE RETAINING WALL ..... 150

TEMPORARY SOIL RETENTION SYSTEM ..... 156

PIPE UNDERDRAINS FOR STRUCTURES ..... 157

SLIPFORM PARAPET ..... 158

COFFERDAMS ..... 163

PERMANENT STEEL SHEET PILING (LRFD) ..... 165

GRANULAR BACKFILL FOR STRUCTURES ..... 166

BRIDGE DECK CONSTRUCTION ..... 167

AGGREGATE SUBGRADE IMPROVEMENT (BDE)..... 170

AUTOMATED FLAGGER ASSISTANCE DEVICES (BDE) ..... 172

COARSE AGGREGATE QUALITY (BDE) ..... 174

COATED GALVANIZED STEEL CONDUIT (BDE)..... 176

COILABLE NONMETALLIC CONDUIT (BDE)..... 176

CONCRETE END SECTIONS FOR PIPE CULVERTS (BDE) ..... 176

CONCRETE GUTTER, CURB, MEDIAN, AND PAVED DITCH (BDE) ..... 178

CONCRETE MIX DESIGN – DEPARTMENT PROVIDED (BDE) ..... 179

CONTRACT CLAIMS (BDE)..... 179

DISADVANTAGED BUSINESS ENTERPRISE PARTICIPATION (BDE)..... 180

EQUAL EMPLOYMENT OPPORTUNITY (BDE) ..... 191

FRICITION AGGREGATE (BDE) ..... 194

GROOVING FOR RECESSED PAVEMENT MARKINGS (BDE) ..... 197

HOT-MIX ASPHALT – MIXTURE DESIGN COMPOSITION AND VOLUMETRIC REQUIREMENTS (BDE) ..... 199

HOT-MIX ASPHALT – MIXTURE DESIGN VERIFICATION AND PRODUCTION (BDE).....209

HOT MIX ASPHALT – PRIME COAT (BDE) .....212

LRFD PIPE CULVERT BURIAL TABLES (BDE) .....217

LRFD STORM SEWER BURIAL TABLES (BDE) .....236

PAVED SHOULDER REMOVAL (BDE) .....245

PAVEMENT PATCHING (BDE) .....246

PAVEMENT STRIPING - SYMBOLS (BDE) .....247

PORTLAND CEMENT CONCRETE BRIDGE DECK CURING (BDE) .....248

PROGRESS PAYMENTS (BDE) .....250

RECLAIMED ASPHALT PAVEMENT AND RECLAIMED ASPHALT SHINGLES (BDE) .....251

RETROREFLECTIVE SHEETING FOR HIGHWAY SIGNS (BDE) .....	261
REINFORCEMENT BARS (BDE) .....	263
RIGID METAL CONDUIT (BDE) .....	264
SIDEWALK, CORNER, OR CROSSWALK CLOSURE (BDE) .....	264
TEMPORARY CONCRETE BARRIER (BDE) .....	265
TRACKING THE USE OF PESTICIDES (BDE).....	266
TRAFFIC BARRIER TERMINALS TYPE 6 OR 6B (BDE) .....	266
TRAINING SPECIAL PROVISIONS (BDE) .....	267
IDOT TRAINING PROGRAM GRADUATE ON-THE-JOB TRAINING SPECIAL PROVISION (TPG) .....	269
TRAVERSABLE PIPE GRATE (BDE) .....	272
WATERWAY OBSTRUCTION WARNING LUMINAIRE (BDE) .....	273
WARM MIX ASPHALT (BDE) .....	274
WEEKLY DBE TRUCKING REPORTS (BDE).....	275
BITUMINOUS MATERIALS COST ADJUSTMENTS (BDE) (RETURN FORM WITH BID).....	276
FUEL COST ADJUSTMENT (BDE) (RETURN FORM WITH BID).....	279
STEEL COST ADJUSTMENT (BDE) (RETURN FORM WITH BID).....	283
FAA PERMITS .....	287
SWPPP .....	335
IDNR PERMIT .....	343
404 PERMIT .....	347
IOWA 401 PERMIT .....	396
SOVEREIGN LANDS PERMIT .....	403
FLOOD PLAIN PERMIT .....	406
ASBESTOS REPORT .....	413
RAILROAD PROTECTIVE LIABILITY INSURANCE (5 AND 10) (BDE) .....	422
UNITED STATES COAST GUARD STRUCTURE PERMIT.....	423
FAA DETERMINATION EXTENSION .....	430
FABRIC REINFORCED ELASTOMERIC .....	439

Materials: Surface Mixture 9.5 or 9.5 FG, Mix C, N50 shall be placed on frontage roads, detours, Good Neighbor Policy roads, city streets, and county or township roads. All others shall match the Mixture and N number of the adjacent mainline.

Required Field Tests: Density Acceptance at 95% - 102% of growth curve at the frequency indicated in Article 1030.05(d)(3).

This work will be paid for at the contract unit price per Ton for HOT-MIX ASPHALT SURFACE COURSE, MIX C, N50, SPECIAL.

### **HOT-MIX ASPHALT SURFACE COURSE, CUT OFF DATE**

Effective: December 8, 1998 Revised: October 17, 2007

Placement of Hot-Mix Asphalt Surface Course will not be permitted after October 15 unless approved, in writing, by the Resident Engineer.

### **HOT-MIX ASPHALT SHOULDERS, 8", SPECIAL**

This work shall be done in accordance with Section 482 of the Standard Specifications. This item shall only be used along the US 52 Causeway within Iowa.

Basis of Payment: The work will be paid for at the contract unit price per square yard for HOT-MIX ASPHALT SHOULDERS, 8" (SPECIAL).

### **CLEARING, SPECIAL**

Description: This work shall consist of extensive removal and disposal of shrubs, brush, debris (including fences, rocks, bottles, etc.) and selected trees up to six (6) inches (150 mm) in diameter. All trees and shrubs to be saved shall be carefully protected as provided by Article 201.05 of the Standard Specifications. Locations for Selective Clearing and vegetation to be cleared or saved shall be designated by the Engineer. The undesirable trees and brush shall be cut flush with the ground and all stubs or stumps shall be treated with a re-sprout herbicide approved by the Engineer to prevent re-growth from the stumps. Branches on remaining trees shall be pruned off up to 6 feet (2 meters) from the ground.

All cleared areas shall be graded, trimmed, smoothed, and finished uniformly to the satisfaction of the Engineer with equipment approved by the Engineer. Disposal of material shall be done in accordance with Article 202.03.

Method of Measurement: The removal and clearing items for CLEARING, SPECIAL shall not be measured for payment individually. The removal and clearing items for CLEARING, SPECIAL shall be measured for payment as a LUMP SUM for clearing of the locations as shown in the contract plans.

Basis of Payment: This work will be paid for at the contract lump sum price for CLEARING, SPECIAL.

Revised 9/10/15

**ASBESTOS ABATEMENT (GENERAL CONDITIONS):** This work consists of the removal and disposal of non-friable asbestos from the building(s) to be demolished. All work shall be done according to the requirements of the U.S. Environmental Protection Agency (USEPA), the Illinois Environmental Protection Agency (IEPA), the Occupational Safety and Health Administration (OSHA), the Special Provision for "Removal and Disposal of Non-Friable Asbestos, Building No. 1," and as outlined herein.

Sketches indicating the location of Asbestos Containing Material (ACM) are included in the proposal on pages 418 thru 420. Also refer to the Materials Description Table on page 415 for a brief description and location of the various materials. Also included is a Materials Quantities Table on page 414. This table states the ACM is non-friable and gives the approximate quantity. The quantities are given only for information and it shall be the Contractor's responsibility to determine the exact quantities prior to submitting his/her bid.

The work involved in the removal and disposal of non-friable asbestos if done prior to demolition, shall be performed by a Contractor or Sub-Contractor prequalified with the Illinois Capital Development Board.

The Contractor shall provide a shipping manifest, similar to the one shown on page 421, to the Engineer for the disposal of all ACM wastes.

**Permits:** The Contractor shall apply for permit(s) in compliance with applicable regulations of the Illinois Environmental Protection Agency. Any and all other permits required by other federal, state, or local agencies for carrying on the work shall be the responsibility of the Contractor. Copies of the permit(s) shall be sent to the district office and the Engineer.

**Notifications:** The "Demolition/Renovation Notice" form, which can be obtained from the IEPA office, shall be completed and submitted to the address listed below at least ten days prior to commencement of any asbestos removal or demolition activity. Separate notices shall be sent for the asbestos removal work and the building demolition if they are done as separate operations.

Asbestos Demolition/Renovation Coordinator  
Illinois Environmental Protection Agency  
Division of Air Pollution Control  
P. O. Box 19276  
Springfield, Illinois 62794-9276  
(217) 785-1743

Notices shall be updated if there is a change in the starting date or the amount of asbestos changes by more than 20 percent.

Revised 9/10/15

D. Air Monitoring Professional

1. All air sampling shall be conducted by a qualified Air Sampling Professional supplied by the Contractor. The Air Sampling Professional shall submit documentation of successful completion of the National Institute for Occupational Safety and Health (NIOSH) course #582 - "Sampling and Evaluating Airborne Asbestos Dust".
2. Air sampling shall be conducted according to NIOSH Method 7400. The results of these tests shall be provided to the Engineer within 24 hours of the collection of air samples.

REMOVAL AND DISPOSAL OF NON-FRIABLE ASBESTOS, BUILDING NO. 1: The Contractor has the option of removing and disposing of the non-friable asbestos prior to demolition of the building(s) or demolishing the building(s) with the non-friable asbestos in place.

Option #1 - If the Contractor chooses to remove all non-friable asbestos prior to demolition, the work shall be done according to the Special Provision titled "Asbestos Abatement (General Conditions)".

Option #2 - If the Contractor chooses to demolish the building(s) with the non-friable asbestos in place, the following provisions shall apply:

1. Continuously wet all non-friable ACM and other building debris with water during demolition.
2. Dispose of all demolition debris as asbestos containing material by placing it in lined, covered transport haulers and placing it in an approved landfill.

This work will be paid for at the contract unit price per lump sum for REMOVAL AND DISPOSAL OF NON-FRIABLE ASBESTOS, BUILDING NO. 1, as shown.

The cost for this work shall be determined as follows:

Option #1 - Actual cost of removal and disposal of non-friable asbestos.

Option #2 - The difference in cost between removing and disposing of the building if all non-friable asbestos is left in place and removing and disposing of the building assuming all non-friable asbestos is removed prior to demolition.

The cost of removing and disposing of the building(s), assuming all non-friable asbestos is removed first, shall be represented by the pay item "BUILDING REMOVAL NO. 1".

Regardless of the option chosen by the Contractor, this pay item will not be deleted, nor will the pay item BUILDING REMOVAL NO. 1 be deleted.

Revised 9/10/15



## REMOVAL AND DISPOSAL OF REGULATED SUBSTANCES

The work shall be according to Article 669 of the Standard Specifications and the following:

Qualifications. The term environmental firm shall mean an environmental firm with at least five (5) documented leaking underground storage tank (LUST) cleanups or that is pre-qualified in hazardous waste by the Department. Documentation includes but not limited to verifying remediation and special waste operations for sites contaminated with gasoline, diesel, or waste oil in accordance with all Federal, State, or local regulatory requirements and shall be provided to the Engineer for approval. The environmental firm selected shall not be a former or current consultant or have any ties with any of the properties contained within and/or adjacent to this construction project.

General. This Special Provision will likely require the Contractor to subcontract for the execution of certain activities.

All contaminated materials shall be managed as either “uncontaminated soil” or non-special waste. This work shall include monitoring and potential sampling, analytical testing, and management of a material contaminated by regulated substances. The Environmental Firm shall continuously monitor all soil excavation for worker protection and soil contamination.

Phase I Preliminary Engineering information is available through the District’s Environmental Studies Unit. Soil samples or analysis without the approval of the Engineer will be at no additional cost to the Department. The lateral distance is measured from centerline and the farthest distance is the offset distance or construction limit whichever is less.

The Contractor shall manage any excavated soils and sediment within the following areas:

### Site 2387V1-03 (Municipal Building)

- Station 709+20 to Station 709+55 (US 52/IL 64/IL 84), 145 feet LT to 210 feet LT (Municipal Building, PESA site 387V1-03, 1123 N. Main Street) – This material meets the criteria of Article 669.09(a)(2) and shall be managed in accordance with Article 669.09. COC sampling parameters: manganese.
- Station 708+35 to Station 709+20 (US 52/IL 64/IL 84), 0 to 40 feet LT (Municipal Building, PESA site 387V1-03, 1123 N. Main Street) - This material meets the criteria of Article 669.09(a)(2) and shall be managed in accordance with Article 669.09. COC sampling parameters: manganese.

### Site 2387V1-04 (Commercial Building)

- Station 709+55 to Station 710+25 (US 52/IL 64/IL 84), 0 to 80 feet LT (Commercial Building, PESA site 2387V1-04, 1203 N. Main Street) - This material meets the criteria of Article 669.09(a)(5) and shall be managed in accordance with Article 669.09. COC sampling parameters: benzo(a)anthracene, benzo(a)pyrene, benzo(b)fluoranthene, dibenzo(a,h)anthracene, indeno(1,2,3-cd)pyrene, and lead.
- Station 709+55 to Station 710+15 (US 52/IL 64/IL 84), 160 to 220 feet LT (Commercial Building, PESA site 2387V1-04, 1203 N. Main Street) - This material meets the criteria of Article 669.09(a)(3) and shall be managed in accordance with Article 669.09. COC sampling parameters: benzo(a)pyrene.

Revised 9/10/15

I hereby certify that this engineering document was prepared by me or under my direct personal supervision and that I am a duly licensed Professional Engineer under the laws of the State of Illinois.

*William C. Olson* 3/12/15

William C. Olson, P.E. Date \_\_\_\_\_  
 License Number: 21735  
 My License Expires On or Before: 8/30/16

Page or sheet covered by this seal:  
**1-118, 137-172, 391-528**

I hereby certify that this engineering document was prepared by me or under my direct personal supervision and that I am a duly licensed Professional Engineer under the laws of the State of Illinois.

Mark A. Land, P.E. Date \_\_\_\_\_  
 License Number: 14045  
 My License Expires On or Before: 8/30/16

Page or sheet covered by this seal:  
**119-136**

I hereby certify that this engineering document was prepared by me or under my direct personal supervision and that I am a duly licensed Professional Engineer under the laws of the State of Illinois.

*Martin R. Furrer* 3/12/15

Martin R. Furrer, P.E. Date \_\_\_\_\_  
 License Number: 15916  
 My License Expires On or Before: 8/30/16

Page or sheet covered by this seal:  
**173-349**

STATE OF ILLINOIS  
 MARTIN R. FURRER  
 081-005886  
 CHICAGO  
 IL  
 LICENSED STRUCTURAL ENGINEER

NAME: \_\_\_\_\_  
 EXPIRES: \_\_\_\_\_  
 DATE: \_\_\_\_\_  
 SHEETS: 173-349

STATE OF ILLINOIS  
 ROGER L. DIGIULIO  
 081-005197  
 CHICAGO  
 IL  
 LICENSED STRUCTURAL ENGINEER

NAME: \_\_\_\_\_  
 EXPIRES: \_\_\_\_\_  
 DATE: \_\_\_\_\_  
 SHEETS: 350-390

LICENSED PROFESSIONAL ENGINEER  
 MARK A. LAND  
 062-063448  
 STATE OF ILLINOIS

NAME: \_\_\_\_\_  
 EXPIRES: \_\_\_\_\_  
 DATE: \_\_\_\_\_  
 SHEETS: 119-136

Department of Natural Resources  
**APPROVED PLANS**  
 Flood Plain Permit FP No. 205-135  
 1065

RECEIVED  
 MAY 18 2015

DESIGNED - JB	REVISION -	STATE OF ILLINOIS DEPARTMENT OF TRANSPORTATION	ENGINEERING SEALS AND SIGNATURES		FAP NO.	SECTION	COUNTY	TOTAL SHEET NO.
DRAWN - SO	REVISION -				11	104B-2	JACKSON	5
CHECKED - JC	REVISION -				CONTRACT NO. 64G59			
DATE - 03-12-2015	REVISION -							

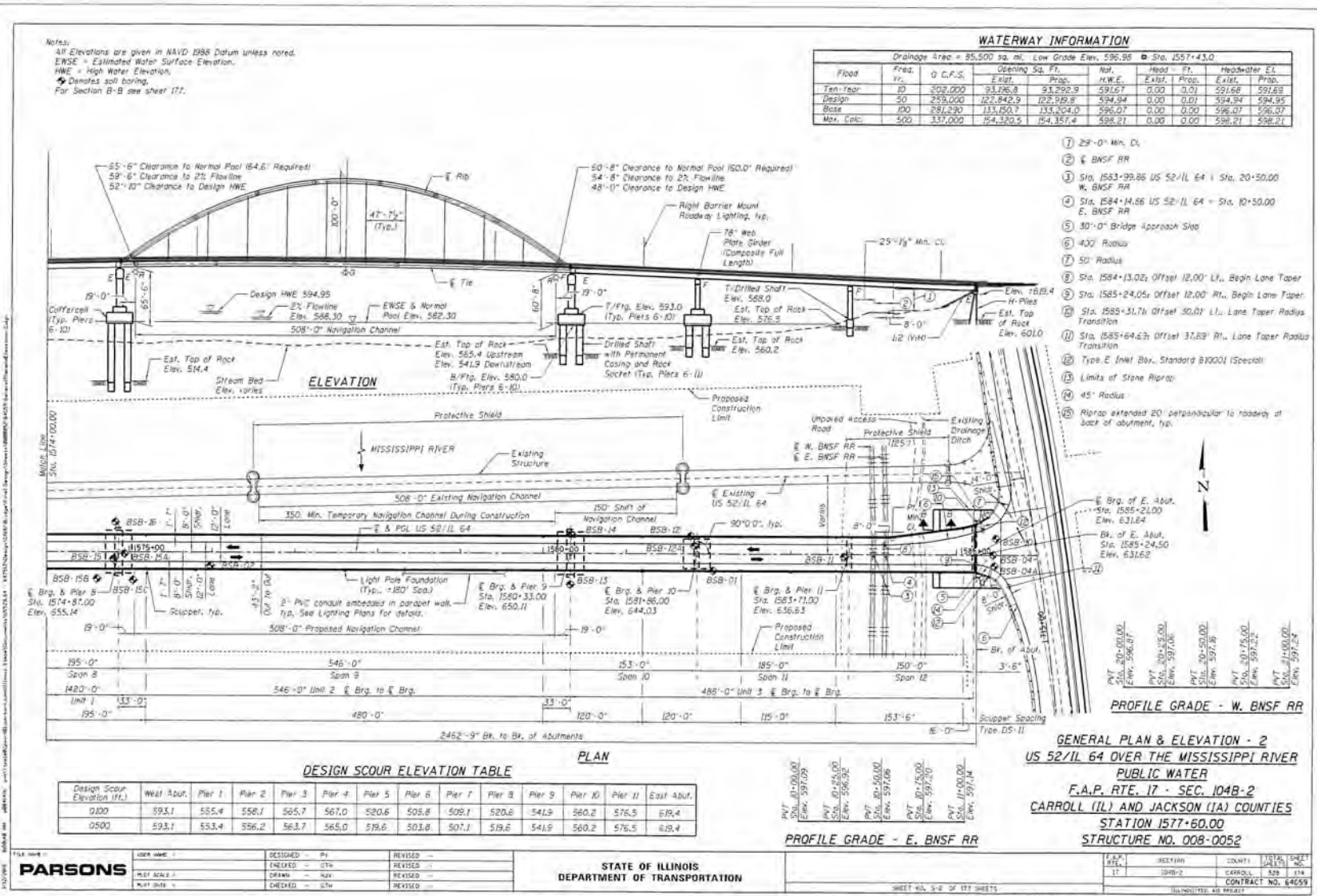

FAP Route 17 (US 52/IL 64)  
 Project ACNHPP-0017(132)  
 Section 104B-2  
 Carroll County, IL & Jackson County, IA  
 Contract No. 64G59

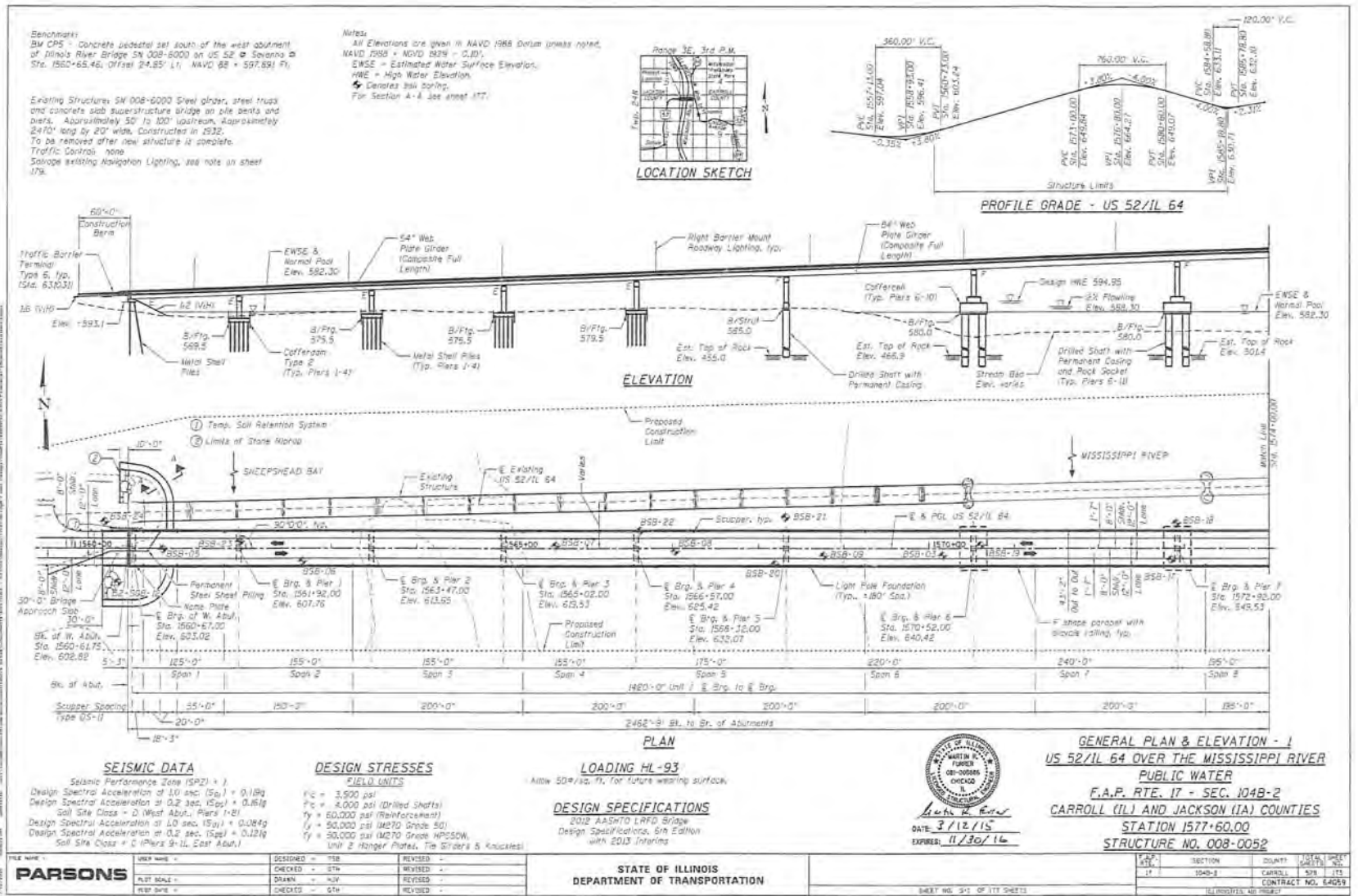

FAP Route 17 (US 52/IL 64)  
 Project ACNHPP-0017(132)  
 Section 104B-2  
 Carroll County, IL & Jackson County, IA  
 Contract No. 64G59

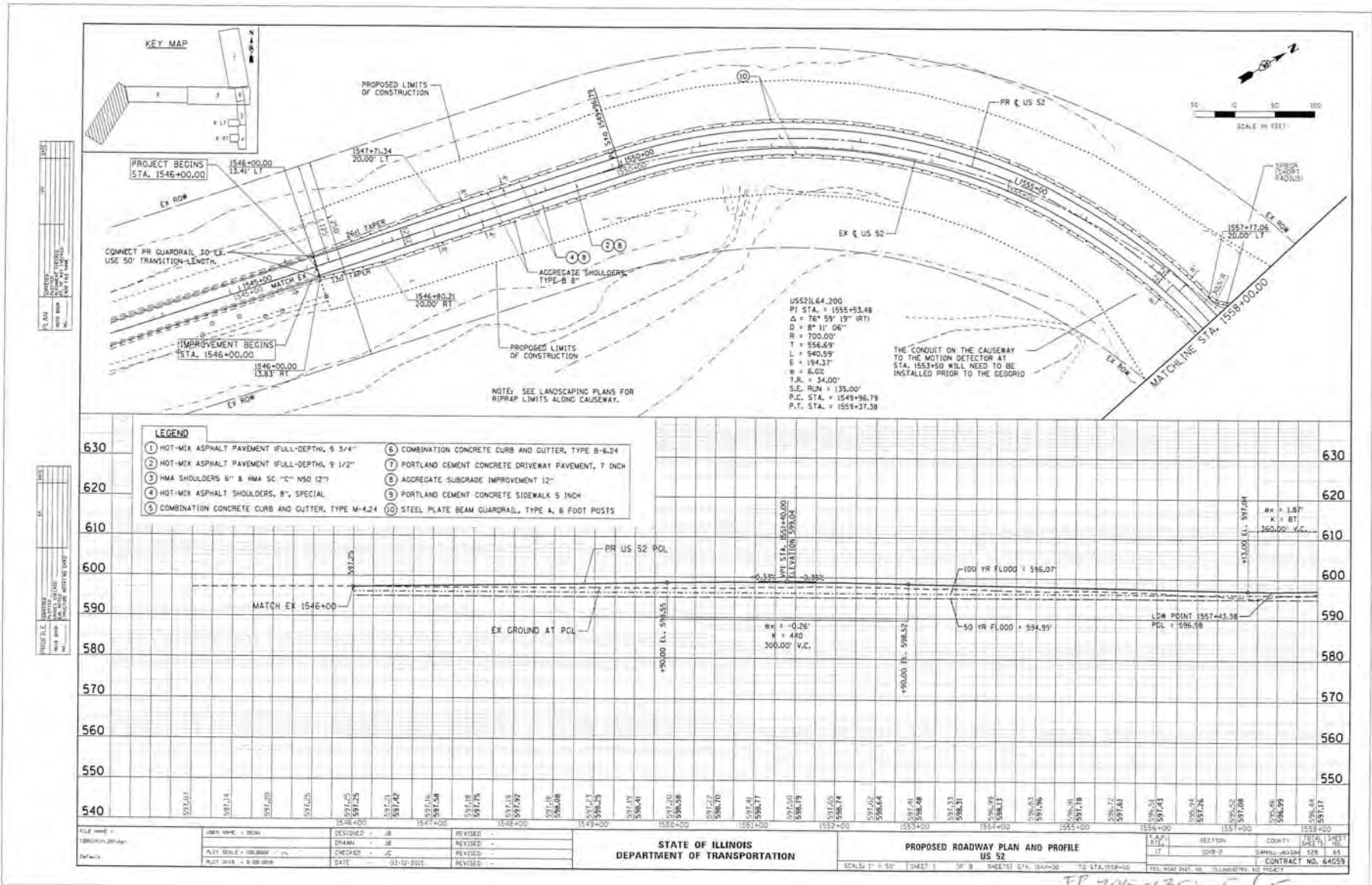

**ASBESTOS REPORT**

**SECTION 1**  
 1.1 Survey Summary Sheet

**SITE INFORMATION:**

FAP Route:	<u>FA 17</u>	Address:	<u>1203 Main Street</u>
County:	<u>Carroll</u>	Address:	
IDOT Job No:	<u>R-92-003-11</u>	City, State Zip	<u>Savanna, Illinois 61074</u>
Section:	<u>104B-2</u>	Property Type:	<u>Commercial Fish Market</u>
Parcel No:	<u>2031101</u>	Construction Date:	<u>Circa Late 1960s</u>
IDOT Work Order No:	<u>509</u>	Building Size (sqft):	<u>5,611</u>

<b>Asbestos Containing Materials</b>	
Survey Date	<u>May 6, 2014</u>
By Whom:	<u>PSI, Inc.</u> <u>Tom Novatka</u> <u>100-08002</u>
Firm	
Inspector	
IDPH License No.	
<b>Results</b>	
Number of Material Types Sampled:	<u>15</u>
Number of Samples Collected:	<u>45</u>
Number of Materials Testing Positive:	<u>3</u>
Was Friable ACM Found?	<u>No</u>
Were Roofing Materials Sampled?	<u>Yes</u>
Are There Unique State or Local Requirements?	<u>Yes</u>
<b>Laboratory Utilized:</b>	
Name:	<u>STAT Analysis Corp.</u>
Address:	<u>2242 W. Harrison Street Suite 200</u> <u>Chicago, Illinois 60612</u>
<b>Building Access Limitations:</b>	
<u>None</u>	

**SECTION 1**  
 1.2 Survey Summary & Results

**ACM SURVEY RESULTS - Parcel No: 2031101**  
**Commercial Fish Market**  
**1203 Main Street**  
**Savanna, Illinois 61074**

The following homogeneous building material types were sampled as part of this survey and their results are summarized in the table below:

MTL #	MATERIAL DESCRIPTION	LOCATION	F/NF <sup>1</sup>	COND. <sup>2</sup>	% ACM <sup>3</sup>	# SAMPLES	QUANTITY (ENG/MET)
01	Built-up roof field	Lower roof below EPDM	NF	Good	1-5%	3	2,210 sf 205.32 sm
02	Flashing	Lower roof at east wall below EPDM	NF	Good	1-5%	3	50 lf 15.2 lm
03	Gray sealant	Lower roof at east wall at terminator bar	NF	Good	ND	3	50 lf 15.2 lm
04	Window glazing	North and south side windows	NF	Good	ND	3	28 lf 8.53 lm
05	Built-up roof field	Upper roof below EPDM	NF	Good	ND	3	2,800 sf 260.13 sm
06	Flashing	Upper roof at parapet below EPDM	NF	Good	ND	3	175 lf 53.34 lm
07	Built-up roof patch	Upper roof, north east corner below EPDM	NF	Good	ND	3	50 sf 4.65 sm
08	Black sealant	Upper roof along parapet	NF	Good	1-5%	3	175 lf 53.34 lm
09	Drywall / joint compound	Upper level walls	F	Good	ND	3	3,500 sf 325.16 sm
10	2' x 4" white with medium fissures and dots lay-in ceiling tile	Upper level	F	Good	ND	3	2,800 sf 260.13 sm
11	Beige with 9" square pattern vinyl sheet flooring	Upper level rest room	NF	Good	ND/ND	3	55 sf 5.11 sm
12	4" white vinyl base cove / mastic	Upper level restroom	NF	Good	ND/ND	3	20 lf 6.1 lm
13	Insulation residue	Upper level water piping	F	Poor	ND	3	100 lf 30.48 lm
14	Ceiling coating	Lower level room A	NF	Good	ND	3	155 sf 14.4 sm
15	Ceiling coating	Lower level room B	NF	Good	ND	3	80 sf 7.43 sm
<b>TOTAL QUANTITY OF ACM</b>							<b>2,385 SF</b> <b>150 LF</b>

<sup>1</sup> F = Friable; NF = Nonfriable      Friability is further defined in section 4.  
<sup>2</sup> Cond. = Condition Of Materials      Either good, fair or poor.  
<sup>3</sup> ND = None Detected  
 \* Point Count Analysis



North Face



South Face

1203 Main Street  
Carroll, County  
Savanna, Illinois

Parcel No.	2031101
Work Order No.	509
PSI Project No.	00471712





East Face



West Face

1203 Main Street  
Carroll, County  
Savanna, Illinois

Parcel No.	2031101
Work Order No.	509
PSI Project No.	00471712



Roof

1203 Main Street  
Carroll, County  
Savanna, Illinois

Parcel No.	2031101
Work Order No.	509
PSI Project No.	00471712

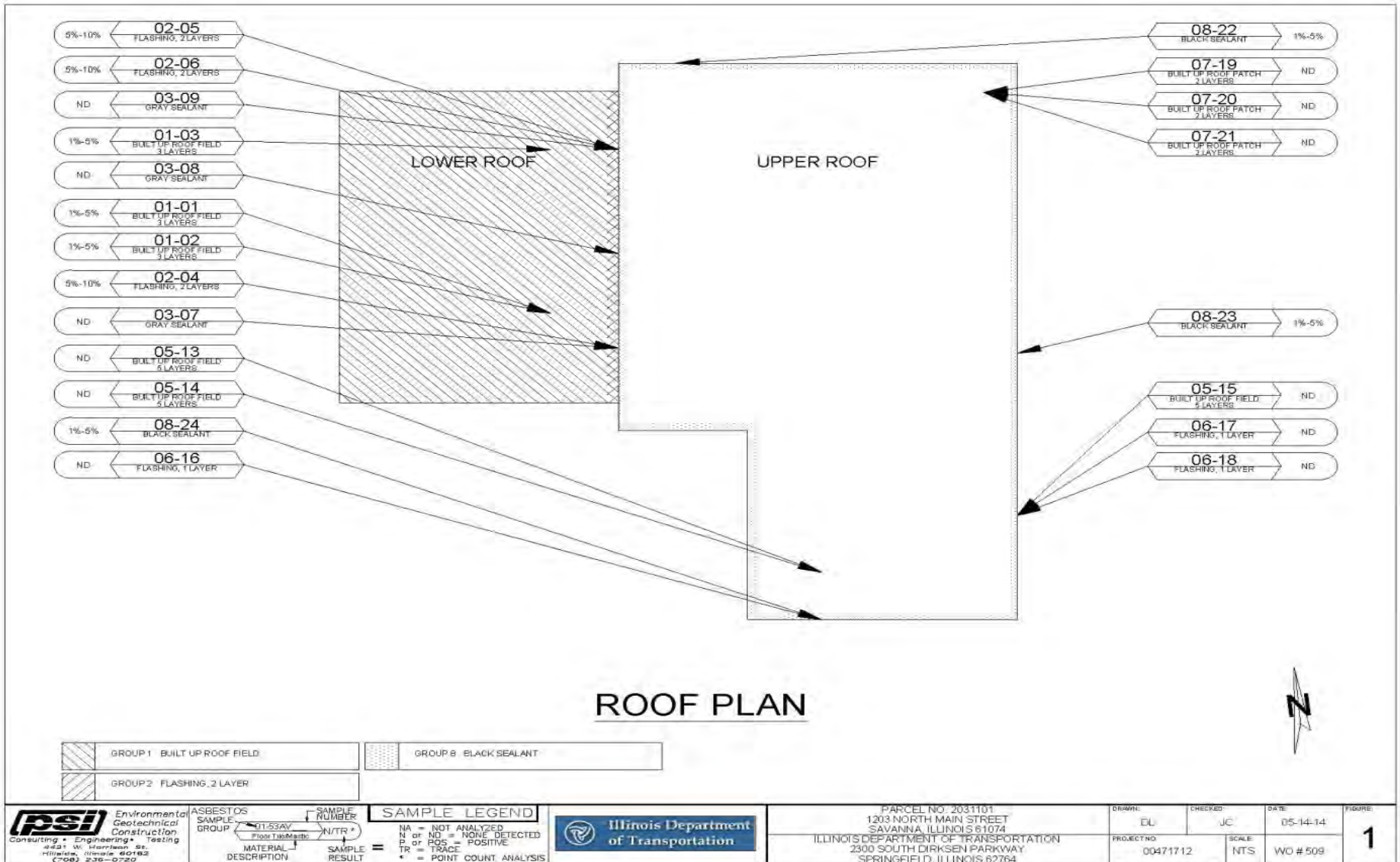

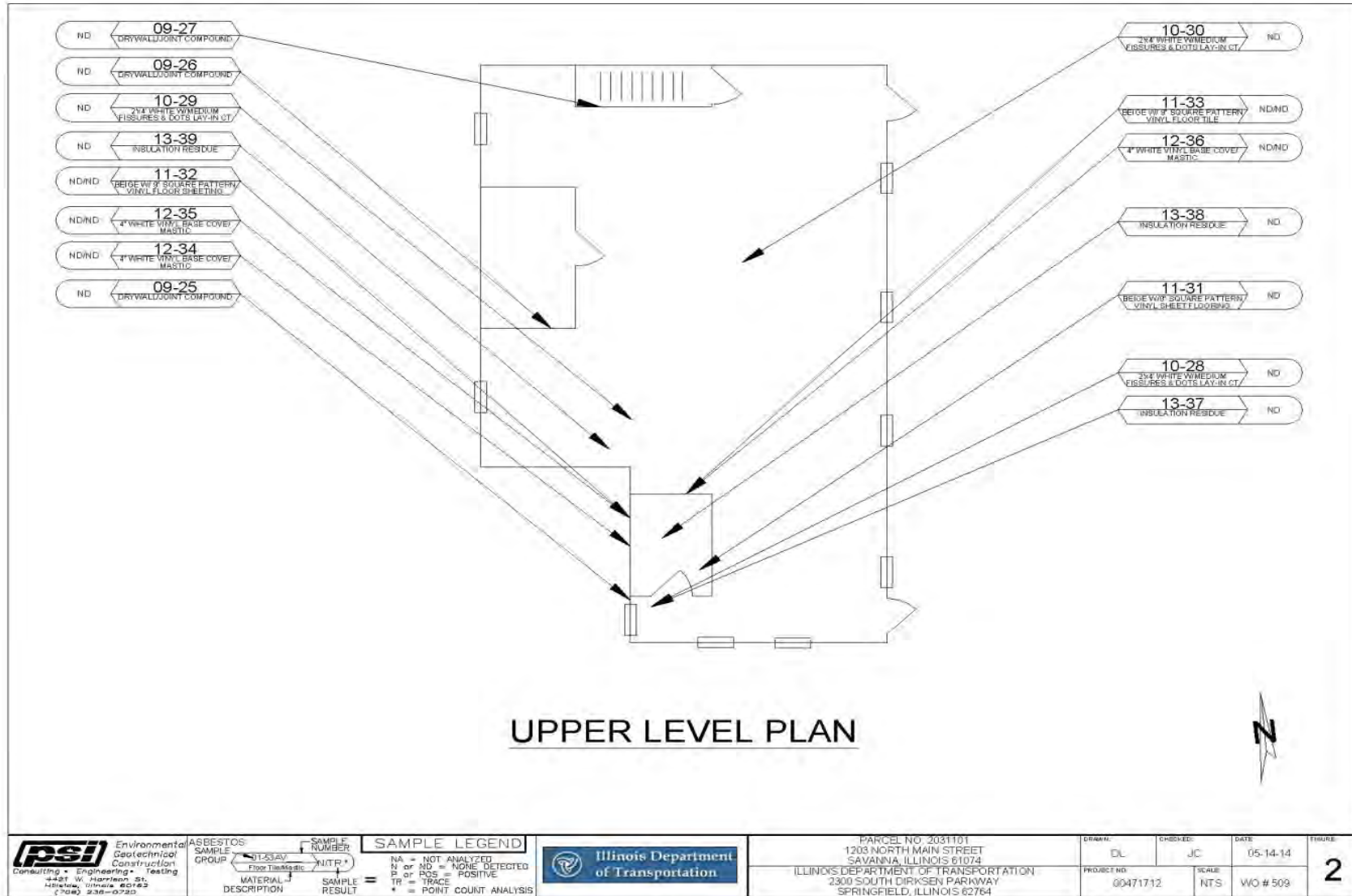

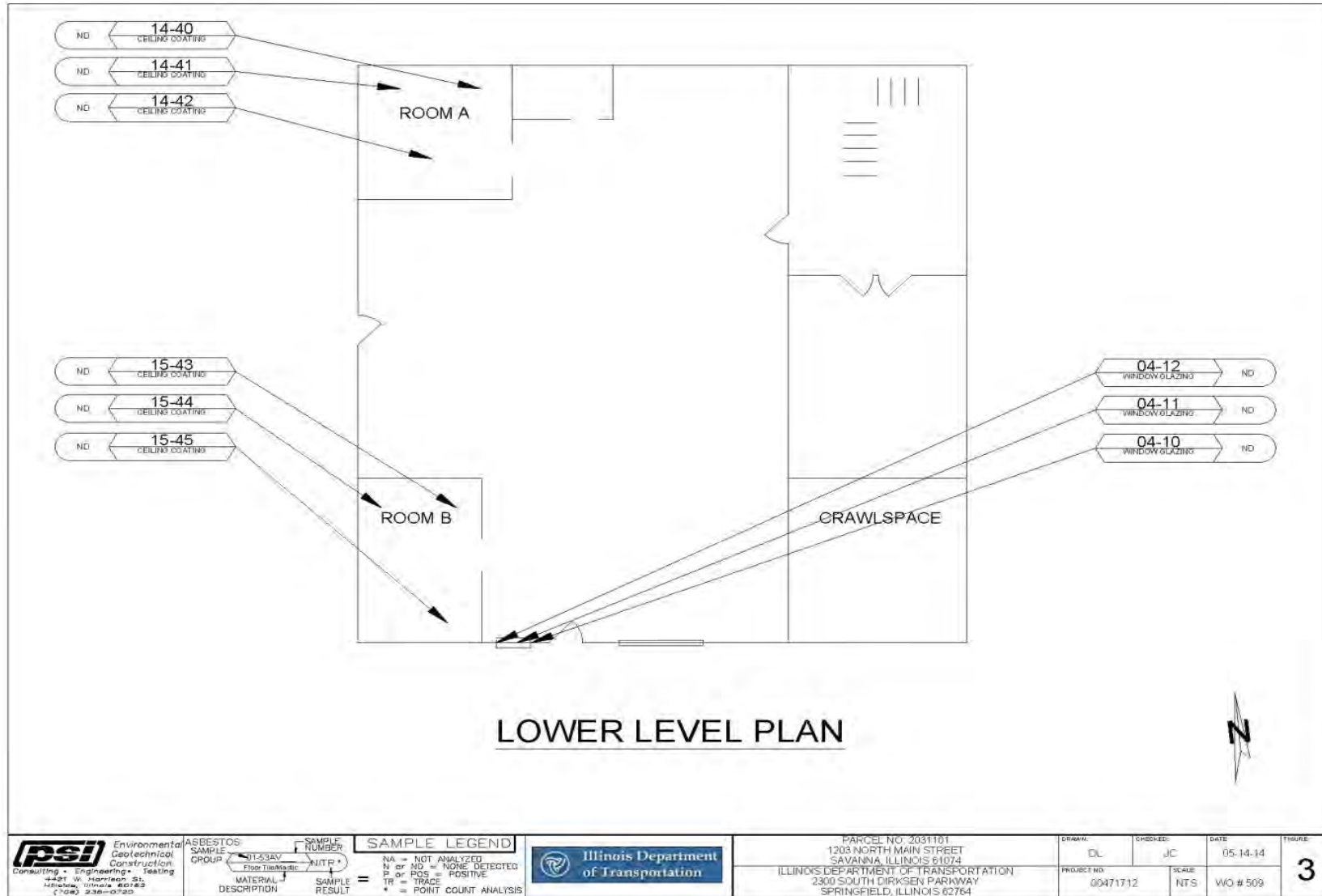

APPENDIX D  
 SHIPPING MANIFEST  
 Generator

1. Work Site Name and Mailing Address		Owner's Name		Owner's Telephone No.	
2. Operator's Name and Address				Operator's Telephone No.	
3. Waste Disposal Site (WDS) Name Mailing Address, and Physical Site Location				WDS Telephone No.	
4. Name and Address of Responsible Agency					
5. Description of Materials					
6. Containers		No.	Type		
7. Total Quantity		M <sup>3</sup>	(Yd <sup>3</sup> )		
8. Special Handling Instructions and Additional Information					
9. OPERATOR'S CERTIFICATION: I hereby declare that the contents of this consignment are fully and accurately described above by proper shipping name and are classified, packed, marked, and labeled, and are in all respects in proper condition for transport by highway according to applicable international and government regulations.					
Printed/Typed Name & Title		Signature		Month Day Year	
Transporter					
10. Transporter 1 (Acknowledgement of Receipt of Materials)					
Printed/Typed Name & Title		Signature		Month Day Year	
Address and Telephone No.					
11. Transporter 2 (Acknowledgement of Receipt of Materials)					
Printed/Typed Name & Title		Signature		Month Day Year	
Address and Telephone No.					
Disposal Site					
12. Discrepancy Indication Space					
13. Waste Disposal Site Owner or Operator: Certification of Receipt of Asbestos Materials Covered By This Manifest Except As Noted in Item 12					
Printed/Typed Name & Title		Signature		Month Day Year	

**RAILROAD PROTECTIVE LIABILITY INSURANCE (5 AND 10) (BDE)**

Effective: January 1, 2006

Description. Railroad Protective Liability and Property Damage Liability Insurance shall be carried according to Article 107.11 of the Standard Specifications, except the limits shall be a minimum of \$5,000,000 combined single limit per occurrence for bodily injury liability and property damage liability with an aggregate limit of \$10,000,000 over the life of the policy. A separate policy is required for each railroad unless otherwise noted.

---

NAMED INSURED & ADDRESS	NUMBER & SPEED OF PASSENGER TRAINS	NUMBER & SPEED OF FREIGHT TRAINS
-------------------------	------------------------------------	----------------------------------

---

The BNSF Railway Company 80 – 44 <sup>th</sup> Avenue N.E. Minneapolis, Minnesota 55421	0	25 per day at 50 MPH
---	---	----------------------

Calvin Nutt, Manager of Public Projects

DOT/AAR No.: 069 909W RR Division: Chicago	RR Mile Post: 146.07 RR Sub-Division: Aurora
---	---

For Freight/Passenger Information Contact: Manager of Track Maintenance (MTM)	Travis Boardman	Phone: 608-769-8454
--	-----------------	---------------------

For Insurance Information Contact:	Rosa Martinez (Marsh USA)	Phone: 214-303-8519
------------------------------------	---------------------------	---------------------

---

**Comments:**

Railroad flaggers are required if working within 25 feet of the tracks. Contact Travis Boardman.

Approval of Insurance. The original and one certified copy of each required policy shall be submitted to the following address for approval:

Illinois Department of Transportation  
 Bureau of Design and Environment  
 2300 South Dirksen Parkway, Room 326  
 Springfield, Illinois 62764

The Contractor will be advised when the Department has received approval of the insurance from the railroad(s). Before any work begins on railroad right-of-way, the Contractor shall submit to the Engineer evidence that the required insurance has been approved by the railroad(s). The Contractor shall also provide the Engineer with the expiration date of each required policy.

Basis of Payment. Providing Railroad Protective Liability and Property Damage Liability Insurance will be paid for at the contract unit price per Lump Sum for RAILROAD PROTECTIVE LIABILITY INSURANCE.

**UNITED STATES COAST GUARD STRUCTURE PERMIT**



COMMANDANT (CG-BRG)  
US COAST GUARD, STOP 7418  
2703 MARTIN LUTHER KING JR AVE, SE  
WASHINGTON DC 20593-7418

Phone: (202) 372-1511

16591  
P(2-15-8)  
**AUG 24 2015**

**MEMORANDUM**

From: Shelly H. Sugarman  
COMDT (CG-BRG-2)

A handwritten signature in blue ink, appearing to be "SSugarman", written over the "From:" field of the memorandum.

Reply to: CG-BRG-2  
Attn of: SSugarman  
202-372-1521

To: CGD EIGHT (dwb)

Subj: **PROPOSED REPLACEMENT OF THE US 52/IL 64 MISSISSIPPI RIVER  
BRIDGE ACROSS THE UPPER MISSISSIPPI RIVER, MILE 537.81,  
BETWEEN SABULA, CARROLL COUNTY, ILLINOIS AND SABULA,  
JACKSON COUNTY, IOWA**

1. Enclosed is the bridge permit approving the subject bridge replacement. The original should be sent to the permittee and a copy retained for your files.
2. Matt Robertson and Jake Hoogland completed the CG-BRG-2 staff review on this project. Please direct any questions regarding this review to Matt.

#

Enclosure: (1) Original permit and copy  
(2) Enclosure 5a





---

## BRIDGE PERMIT

(2-15-8)

AUG 24 2015

**WHEREAS** by Title V of an act of Congress approved August 2, 1946, entitled "General Bridge Act of 1946," as amended (33 U.S.C. 525-533), the consent of Congress was granted for the construction, maintenance and operation of bridges and approaches thereto over the navigable waters of the United States;

**AND WHEREAS** the Secretary of Homeland Security has delegated the authority of Section 502(b) of that act to the Commandant, U.S. Coast Guard by Department of Homeland Security Delegation Number: 0170.1;

**AND WHEREAS** before construction is commenced, the Commandant must approve the location and plans of any such bridge and may impose any specific conditions relating to the construction, maintenance and operation of the structure deemed necessary in the interest of public navigation, such conditions to have the force of law;

**AND WHEREAS** the - STATE OF ILLINOIS - has submitted for approval the location and plans of a bridge to be constructed across the Upper Mississippi River between Savanna, Illinois and Sabula, Iowa;

**NOW THEREFORE**, This is to certify that the location and plans dated 13 January 2015 are hereby approved by the Commandant, subject to the following conditions:

1. No deviation from the approved plans may be made either before or after completion of the structure unless the modification of said plans has previously been submitted to and received the approval of the Commandant.

2. The construction of falsework, pilings, cofferdams or other obstructions, if required, and the scheme for constructing the bridge shall be in accordance with plans submitted to and approved by the Commander, Eighth Coast Guard District, prior to construction of the bridge. All work shall be so conducted that the free navigation of the waterway is not unreasonably interfered with and the present navigable depths are not impaired. Timely notice of any and all events that may affect navigation shall be given to the District Commander during construction of the bridge. The channel or channels through the structure shall be promptly cleared of all obstructions placed therein or caused by the construction of the bridge to the satisfaction of the District Commander, when in the judgment of the District Commander the construction work has reached a point where such action should be taken, but in no case later than 90 days after the bridge has been opened to traffic.

Continuation Sheet

**Bridge across the Upper Mississippi River  
between Savanna, Illinois and Sabula, Iowa**

**AUG 24 2015**  
BRIDGE PERMIT  
(2-15-8)

3. Issuance of this permit does not relieve the permittee of the obligation or responsibility for compliance with the provisions of any other law or regulation as may be under the jurisdiction of any federal, state or local authority having cognizance of any aspect of the location, construction or maintenance of said bridge.

4. A bridge fendering system shall be installed and maintained in good condition by and at the expense of the owner of the bridge when so required by the District Commander. Said installation and maintenance shall be for the safety of navigation and be in accordance with plans submitted to and approved by the District Commander prior to its construction.

5. Clearance gauges shall be installed and maintained in a good and legible condition by and at the expense of the owner of the bridge when so required by the District Commander. The type of gauges and the locations in which they are to be installed will be submitted to the District Commander for approval.

6. All parts of the existing to-be-replaced U.S. Highway 52/IL-64 Bridge across the Upper Mississippi River, mile 537.8, not utilized in the new bridge, except parts on land, shall be removed down to or below elevation 568.0 feet Mean Sea Level or two feet below the natural bottom of the waterway, whichever is deeper, and the waterway cleared to the satisfaction of the District Commander. All parts on land shall be removed down to or below two feet below the natural ground line. A period of 90 days subsequent to the opening to traffic of the new bridge, mile 537.81, will be allowed for such removal and clearance. The proposed method and schedule for removal of the existing bridge shall be submitted to the District Commander for approval prior to commencing such removal.

7. When the proposed bridge is no longer used for transportation purposes, it shall be removed in its entirety or to an elevation deemed appropriate by the District Commander and the waterway cleared to the satisfaction of the District Commander. Such removal and clearance shall be completed by and at the expense of the owner of the bridge upon due notice from the District Commander.

8. The approval hereby granted shall cease and be null and void unless construction of the bridge is commenced within five years and completed within eight years after the date of this permit.

  
Brian L. Dunn  
Chief, Office of Bridge Programs  
U.S. Coast Guard  
By direction of the Commandant

Added 9/10/15



ROBERT A. MAGLIOLA  
 44403  
 REGISTERED  
 PROFESSIONAL  
 ENGINEER  
 OF  
 ILLINOIS  
*Robert A. Magliola*

STATE OF ILLINOIS  
 DEPARTMENT OF TRANSPORTATION  
 DIVISION OF HIGHWAYS

US 52/IL 64 OVER THE MISSISSIPPI RIVER  
 Proposed Structure No.: 008-0052

FAP ROUTE 17  
 SECTION 104B-2  
 CARROLL COUNTY, IL and JACKSON COUNTY, IA

CONTRACT No.: 64G59  
 PROJECT No.: D92-001-11

River Mile = 537.81

Date: 1/13/2015 Sheet 1 of 4

APPROVED  
 28-AUG-2015  
 P(2-15-8)  
 U.S.  
 COAST GUARD

This project has been designed in compliance with all applicable AASHTO Standards.

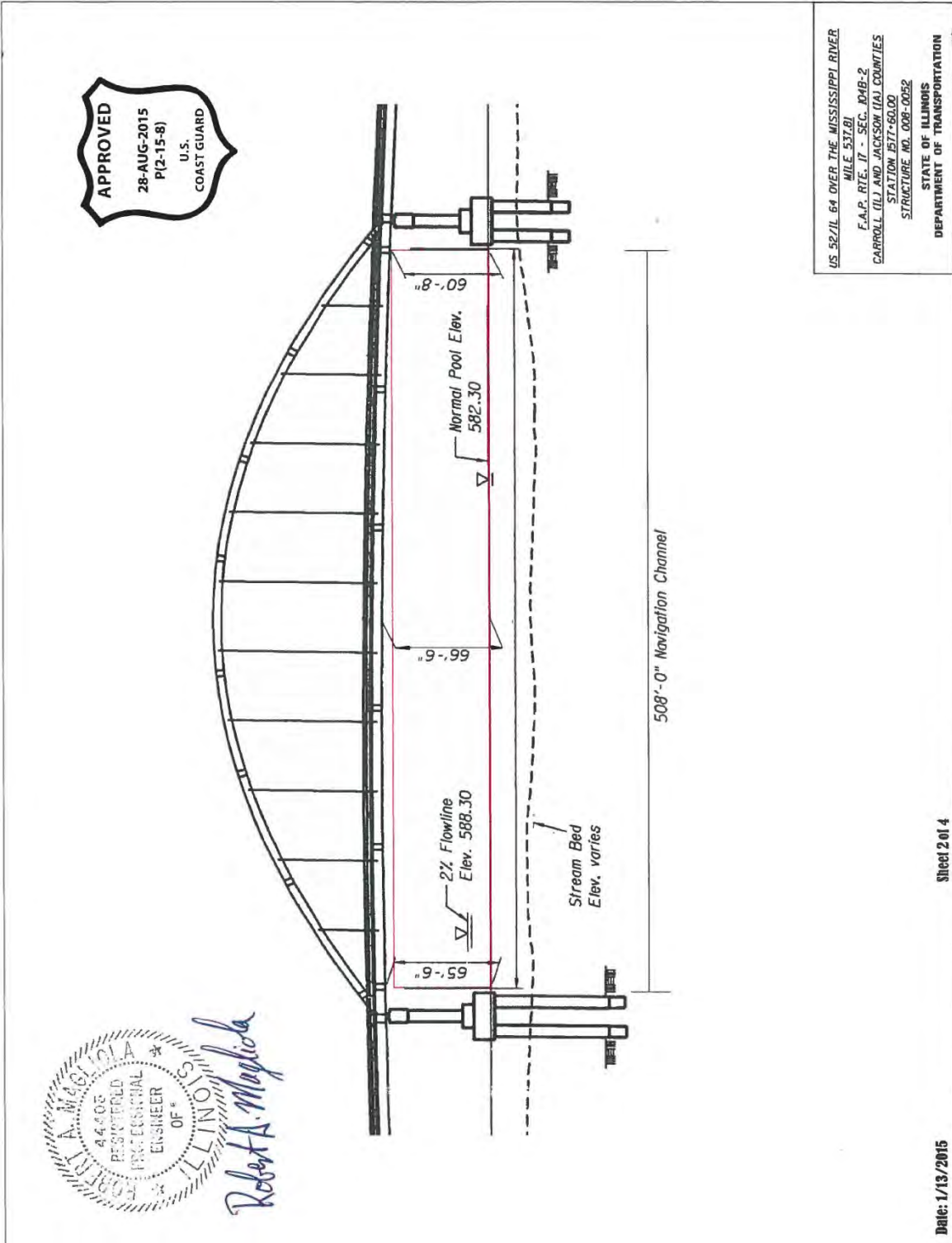



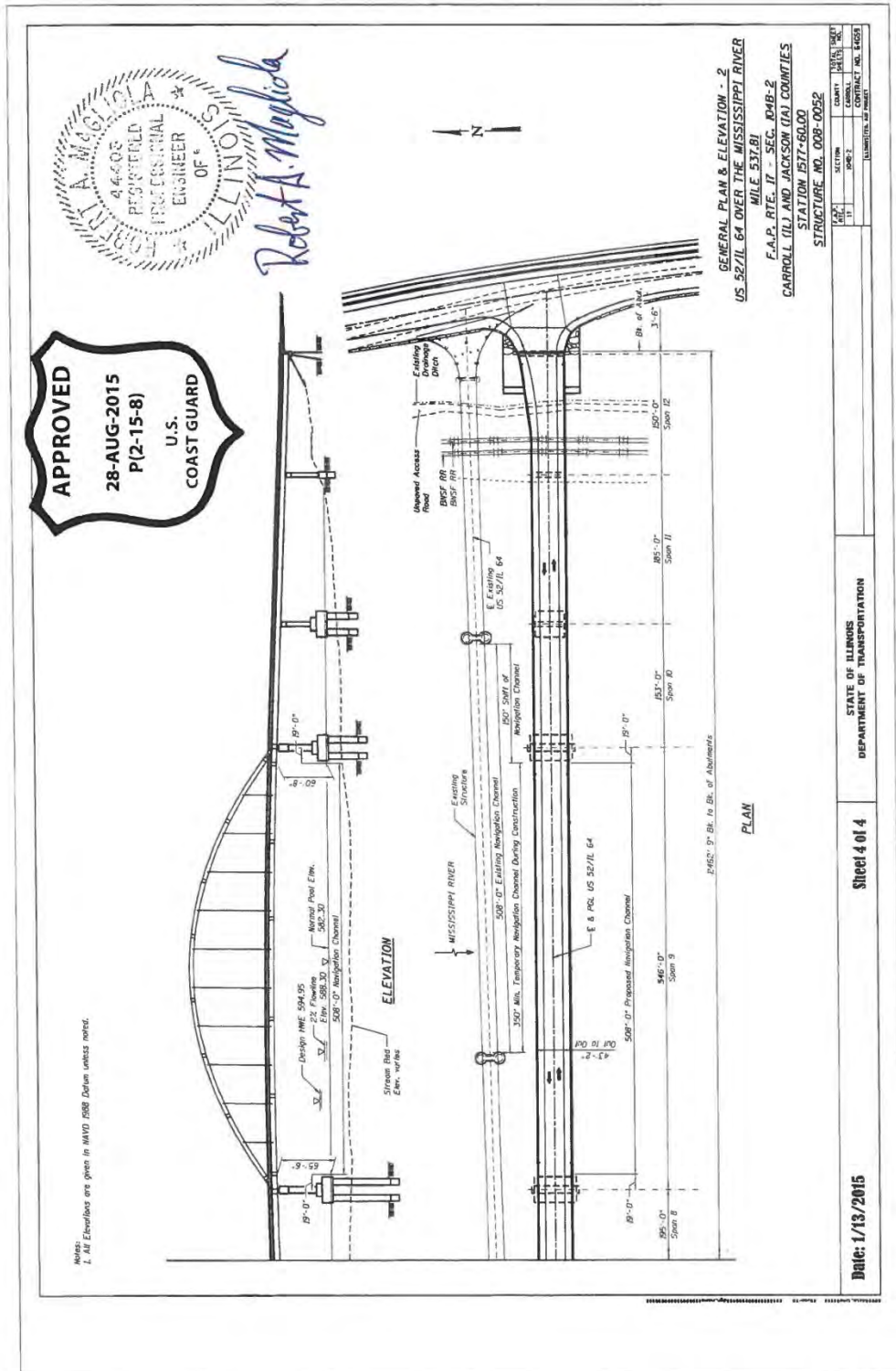

**APPROVED**  
 28-AUG-2015  
 P(2-15-8)  
 U.S. COAST GUARD

ROBERT A. MAGOLDA  
 44603  
 REGISTERED PROFESSIONAL ENGINEER  
 OF ILLINOIS

GENERAL PLAN & ELEVATION - 2  
 US 52/IL 64 OVER THE MISSISSIPPI RIVER  
 MILE 537.81  
 F.A.P. RTE. 17 - SEC. 104B-2  
 CARROLL (IL) AND JACKSON (IA) COUNTIES  
 STATION 1977-6000  
 STRUCTURE NO. 008-0092

SECTION	DATE	BY	CHKD
NO. 1	1/13/2015	MM	MM
NO. 2			
NO. 3			
NO. 4			
NO. 5			
NO. 6			
NO. 7			
NO. 8			
NO. 9			
NO. 10			
NO. 11			
NO. 12			
NO. 13			
NO. 14			
NO. 15			
NO. 16			
NO. 17			
NO. 18			
NO. 19			
NO. 20			
NO. 21			
NO. 22			
NO. 23			
NO. 24			
NO. 25			
NO. 26			
NO. 27			
NO. 28			
NO. 29			
NO. 30			
NO. 31			
NO. 32			
NO. 33			
NO. 34			
NO. 35			
NO. 36			
NO. 37			
NO. 38			
NO. 39			
NO. 40			
NO. 41			
NO. 42			
NO. 43			
NO. 44			
NO. 45			
NO. 46			
NO. 47			
NO. 48			
NO. 49			
NO. 50			
NO. 51			
NO. 52			
NO. 53			
NO. 54			
NO. 55			
NO. 56			
NO. 57			
NO. 58			
NO. 59			
NO. 60			
NO. 61			
NO. 62			
NO. 63			
NO. 64			
NO. 65			
NO. 66			
NO. 67			
NO. 68			
NO. 69			
NO. 70			
NO. 71			
NO. 72			
NO. 73			
NO. 74			
NO. 75			
NO. 76			
NO. 77			
NO. 78			
NO. 79			
NO. 80			
NO. 81			
NO. 82			
NO. 83			
NO. 84			
NO. 85			
NO. 86			
NO. 87			
NO. 88			
NO. 89			
NO. 90			
NO. 91			
NO. 92			
NO. 93			
NO. 94			
NO. 95			
NO. 96			
NO. 97			
NO. 98			
NO. 99			
NO. 100			

STATE OF ILLINOIS  
 DEPARTMENT OF TRANSPORTATION

Sheet 4 of 4

Date: 1/13/2015

## FAA DETERMINATION EXTENSION



Mail Processing Center  
Federal Aviation Administration  
Southwest Regional Office  
Obstruction Evaluation Group  
10101 Hillwood Parkway  
Fort Worth, TX 76177

Aeronautical Study No.  
2013-AGL-12254-OE

Issued Date: 08/11/2015

Deana Hermes  
IL. Dept. of Transportation  
819 Depot Ave  
Dixon, IL 61021

### **\*\* DETERMINATION OF NO HAZARD TO AIR NAVIGATION \*\***

The Federal Aviation Administration has conducted an aeronautical study under the provisions of 49 U.S.C., Section 44718 and if applicable Title 14 of the Code of Federal Regulations, part 77, concerning:

Structure:	Bridge NE end of Truss
Location:	Savanna, IL
Latitude:	42-06-14.85N NAD 83
Longitude:	90-09-35.33W
Heights:	583 feet site elevation (SE) 72 feet above ground level (AGL) 655 feet above mean sea level (AMSL)

This aeronautical study revealed that the structure does not exceed obstruction standards and would not be a hazard to air navigation provided the following condition(s), if any, is(are) met:

It is required that FAA Form 7460-2, Notice of Actual Construction or Alteration, be e-filed any time the project is abandoned or:

- At least 10 days prior to start of construction (7460-2, Part 1)  
 Within 5 days after the construction reaches its greatest height (7460-2, Part 2)

Based on this evaluation, marking and lighting are not necessary for aviation safety. However, if marking/lighting are accomplished on a voluntary basis, we recommend it be installed and maintained in accordance with FAA Advisory circular 70/7460-1 K Change 2.

This determination expires on 02/11/2017 unless:

- the construction is started (not necessarily completed) and FAA Form 7460-2, Notice of Actual Construction or Alteration, is received by this office.
- extended, revised, or terminated by the issuing office.
- the construction is subject to the licensing authority of the Federal Communications Commission (FCC) and an application for a construction permit has been filed, as required by the FCC, within 6 months of the date of this determination. In such case, the determination expires on the date prescribed by the FCC for completion of construction, or the date the FCC denies the application.

NOTE: REQUEST FOR EXTENSION OF THE EFFECTIVE PERIOD OF THIS DETERMINATION MUST BE E-FILED AT LEAST 15 DAYS PRIOR TO THE EXPIRATION DATE. AFTER RE-EVALUATION OF CURRENT OPERATIONS IN THE AREA OF THE STRUCTURE TO DETERMINE THAT NO SIGNIFICANT AERONAUTICAL CHANGES HAVE OCCURRED, YOUR DETERMINATION MAY BE ELIGIBLE FOR ONE EXTENSION OF THE EFFECTIVE PERIOD.

This determination is based, in part, on the foregoing description which includes specific coordinates , heights, frequency(ies) and power . Any changes in coordinates , heights, and frequencies or use of greater power will void this determination. Any future construction or alteration , including increase to heights, power, or the addition of other transmitters, requires separate notice to the FAA.

This determination does include temporary construction equipment such as cranes, derricks, etc., which may be used during actual construction of the structure. However, this equipment shall not exceed the overall heights as indicated above. Equipment which has a height greater than the studied structure requires separate notice to the FAA.

This determination concerns the effect of this structure on the safe and efficient use of navigable airspace by aircraft and does not relieve the sponsor of compliance responsibilities relating to any law, ordinance, or regulation of any Federal, State, or local government body.

Any failure or malfunction that lasts more than thirty (30) minutes and affects a top light or flashing obstruction light, regardless of its position, should be reported immediately to (877) 487-6867 so a Notice to Airmen (NOTAM) can be issued. As soon as the normal operation is restored, notify the same number.

If we can be of further assistance, please contact our office at (847) 294-7458. On any future correspondence concerning this matter, please refer to Aeronautical Study Number 2013-AGL-12253-OE.

**Signature Control No: 203138512-260328880**  
Fred Souchet  
Specialist

( DNE )

Attachment(s)  
Map(s)



TOPO Map for ASN 2013-AGL-12253-OE

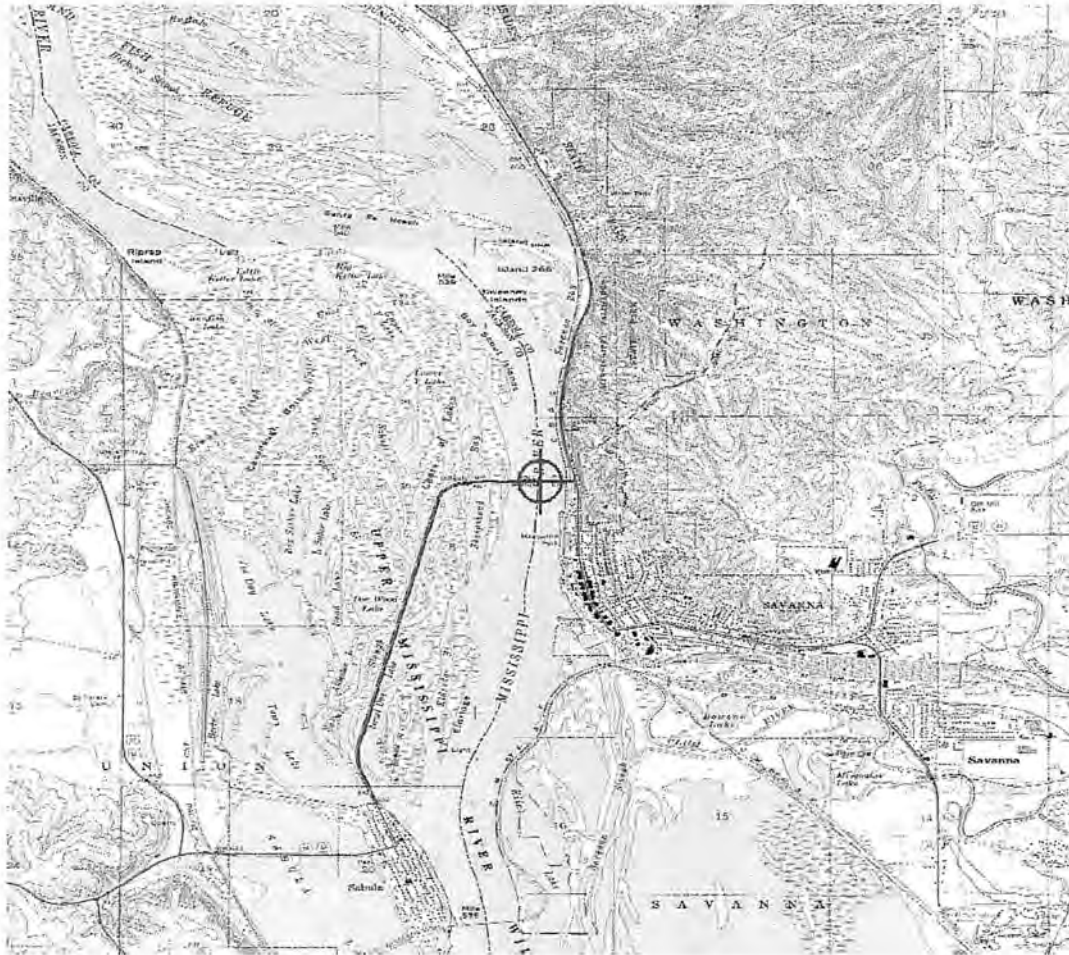



Mail Processing Center  
Federal Aviation Administration  
Southwest Regional Office  
Obstruction Evaluation Group  
10101 Hillwood Parkway  
Fort Worth, TX 76177

Aeronautical Study No.  
2013-AGL-12254-OE

Issued Date: 08/11/2015

Deana Hermes  
IL. Dept. of Transportation  
819 Depot Ave  
Dixon, IL 61021

**\*\* DETERMINATION OF NO HAZARD TO AIR NAVIGATION \*\***

The Federal Aviation Administration has conducted an aeronautical study under the provisions of 49 U.S.C., Section 44718 and if applicable Title 14 of the Code of Federal Regulations, part 77, concerning:

Structure:	Bridge NE end of Truss
Location:	Savanna, IL
Latitude:	42-06-14.85N NAD 83
Longitude:	90-09-35.33W
Heights:	583 feet site elevation (SE) 72 feet above ground level (AGL) 655 feet above mean sea level (AMSL)

This aeronautical study revealed that the structure does not exceed obstruction standards and would not be a hazard to air navigation provided the following condition(s), if any, is(are) met:

It is required that FAA Form 7460-2, Notice of Actual Construction or Alteration, be e-filed any time the project is abandoned or:

- At least 10 days prior to start of construction (7460-2, Part 1)  
 Within 5 days after the construction reaches its greatest height (7460-2, Part 2)

Based on this evaluation, marking and lighting are not necessary for aviation safety. However, if marking/lighting are accomplished on a voluntary basis, we recommend it be installed and maintained in accordance with FAA Advisory circular 70/7460-1 K Change 2.

This determination expires on 02/11/2017 unless:

- the construction is started (not necessarily completed) and FAA Form 7460-2, Notice of Actual Construction or Alteration, is received by this office.
- extended, revised, or terminated by the issuing office.
- the construction is subject to the licensing authority of the Federal Communications Commission (FCC) and an application for a construction permit has been filed, as required by the FCC, within 6 months of the date of this determination. In such case, the determination expires on the date prescribed by the FCC for completion of construction, or the date the FCC denies the application.

NOTE: REQUEST FOR EXTENSION OF THE EFFECTIVE PERIOD OF THIS DETERMINATION MUST BE E-FILED AT LEAST 15 DAYS PRIOR TO THE EXPIRATION DATE. AFTER RE-EVALUATION OF CURRENT OPERATIONS IN THE AREA OF THE STRUCTURE TO DETERMINE THAT NO SIGNIFICANT AERONAUTICAL CHANGES HAVE OCCURRED, YOUR DETERMINATION MAY BE ELIGIBLE FOR ONE EXTENSION OF THE EFFECTIVE PERIOD.

This determination is based, in part, on the foregoing description which includes specific coordinates , heights, frequency(ies) and power . Any changes in coordinates , heights, and frequencies or use of greater power will void this determination. Any future construction or alteration , including increase to heights, power, or the addition of other transmitters, requires separate notice to the FAA.

This determination does include temporary construction equipment such as cranes, derricks, etc., which may be used during actual construction of the structure. However, this equipment shall not exceed the overall heights as indicated above. Equipment which has a height greater than the studied structure requires separate notice to the FAA.

This determination concerns the effect of this structure on the safe and efficient use of navigable airspace by aircraft and does not relieve the sponsor of compliance responsibilities relating to any law, ordinance, or regulation of any Federal, State, or local government body.

Any failure or malfunction that lasts more than thirty (30) minutes and affects a top light or flashing obstruction light, regardless of its position, should be reported immediately to (877) 487-6867 so a Notice to Airmen (NOTAM) can be issued. As soon as the normal operation is restored, notify the same number.

If we can be of further assistance, please contact our office at (847) 294-7458. On any future correspondence concerning this matter, please refer to Aeronautical Study Number 2013-AGL-12254-OE.

**Signature Control No: 203138513-260328882**  
Fred Souchet  
Specialist

( DNE )

Attachment(s)  
Map(s)

TOPO Map for ASN 2013-AGL-12254-OE

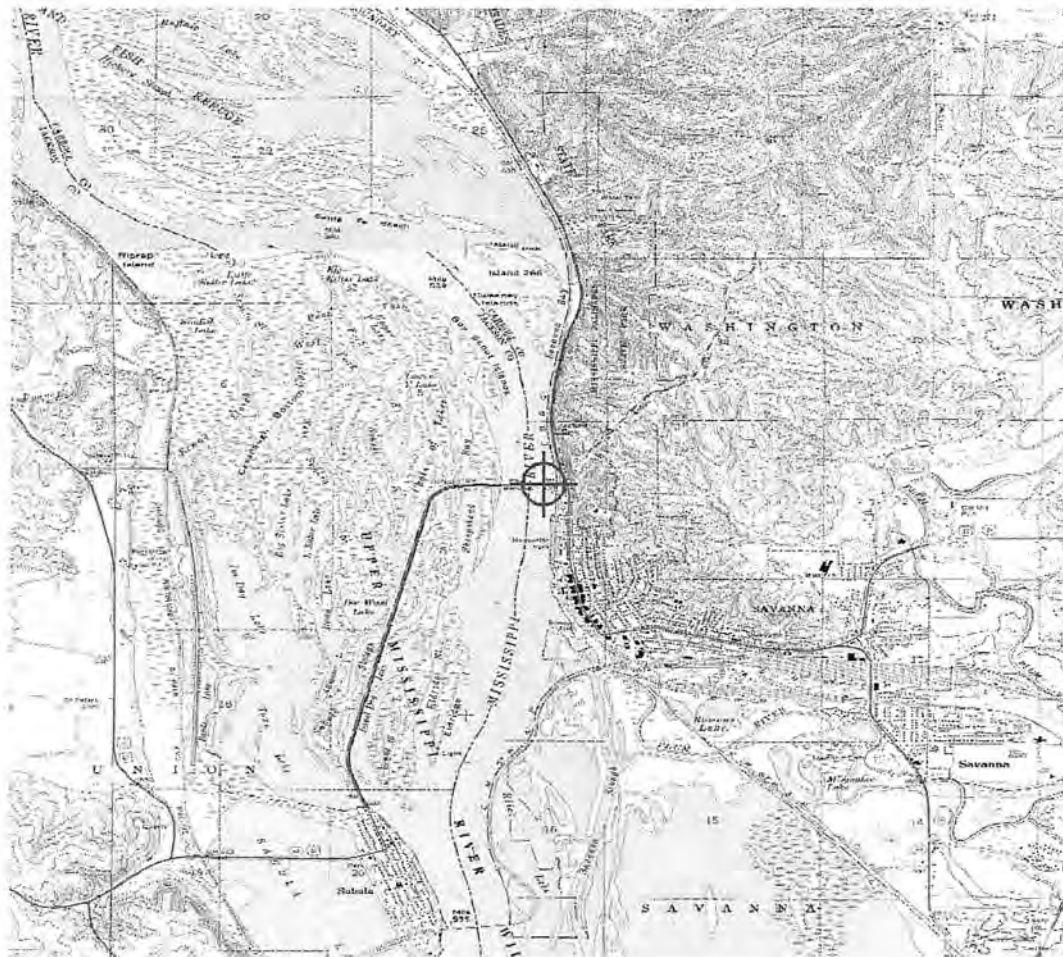



Mail Processing Center  
Federal Aviation Administration  
Southwest Regional Office  
Obstruction Evaluation Group  
10101 Hillwood Parkway  
Fort Worth, TX 76177

Aeronautical Study No.  
2013-AGL-12255-OE

Issued Date: 08/11/2015

Deana Hermes  
IL. Dept. of Transportation  
819 Depot Ave  
Dixon, IL 61021

**\*\* DETERMINATION OF NO HAZARD TO AIR NAVIGATION \*\***

The Federal Aviation Administration has conducted an aeronautical study under the provisions of 49 U.S.C., Section 44718 and if applicable Title 14 of the Code of Federal Regulations, part 77, concerning:

Structure:	Bridge Mid point East side on truss
Location:	Savanna, IL
Latitude:	42-06-14.85N NAD 83
Longitude:	90-09-37.14W
Heights:	583 feet site elevation (SE) 148 feet above ground level (AGL) 731 feet above mean sea level (AMSL)

This aeronautical study revealed that the structure does not exceed obstruction standards and would not be a hazard to air navigation provided the following condition(s), if any, is(are) met:

It is required that FAA Form 7460-2, Notice of Actual Construction or Alteration, be e-filed any time the project is abandoned or:

- At least 10 days prior to start of construction (7460-2, Part 1)  
 Within 5 days after the construction reaches its greatest height (7460-2, Part 2)

Based on this evaluation, marking and lighting are not necessary for aviation safety. However, if marking/lighting are accomplished on a voluntary basis, we recommend it be installed and maintained in accordance with FAA Advisory circular 70/7460-1 K Change 2.

This determination expires on 02/11/2017 unless:

- (a) the construction is started (not necessarily completed) and FAA Form 7460-2, Notice of Actual Construction or Alteration, is received by this office.
- (b) extended, revised, or terminated by the issuing office.
- (c) the construction is subject to the licensing authority of the Federal Communications Commission (FCC) and an application for a construction permit has been filed, as required by the FCC, within 6 months of the date of this determination. In such case, the determination expires on the date prescribed by the FCC for completion of construction, or the date the FCC denies the application.

NOTE: REQUEST FOR EXTENSION OF THE EFFECTIVE PERIOD OF THIS DETERMINATION MUST BE E-FILED AT LEAST 15 DAYS PRIOR TO THE EXPIRATION DATE. AFTER RE-EVALUATION OF CURRENT OPERATIONS IN THE AREA OF THE STRUCTURE TO DETERMINE THAT NO SIGNIFICANT AERONAUTICAL CHANGES HAVE OCCURRED, YOUR DETERMINATION MAY BE ELIGIBLE FOR ONE EXTENSION OF THE EFFECTIVE PERIOD.

This determination is based, in part, on the foregoing description which includes specific coordinates , heights, frequency(ies) and power . Any changes in coordinates , heights, and frequencies or use of greater power will void this determination. Any future construction or alteration , including increase to heights, power, or the addition of other transmitters, requires separate notice to the FAA.

This determination does include temporary construction equipment such as cranes, derricks, etc., which may be used during actual construction of the structure. However, this equipment shall not exceed the overall heights as indicated above. Equipment which has a height greater than the studied structure requires separate notice to the FAA.

This determination concerns the effect of this structure on the safe and efficient use of navigable airspace by aircraft and does not relieve the sponsor of compliance responsibilities relating to any law, ordinance, or regulation of any Federal, State, or local government body.

Any failure or malfunction that lasts more than thirty (30) minutes and affects a top light or flashing obstruction light, regardless of its position, should be reported immediately to (877) 487-6867 so a Notice to Airmen (NOTAM) can be issued. As soon as the normal operation is restored, notify the same number.

If we can be of further assistance, please contact our office at (847) 294-7458. On any future correspondence concerning this matter, please refer to Aeronautical Study Number 2013-AGL-12255-OE.

**Signature Control No: 203138517-260328881**  
Fred Souchet  
Specialist

( DNE )

Attachment(s)  
Map(s)

TOPO Map for ASN 2013-AGL-12255-OE

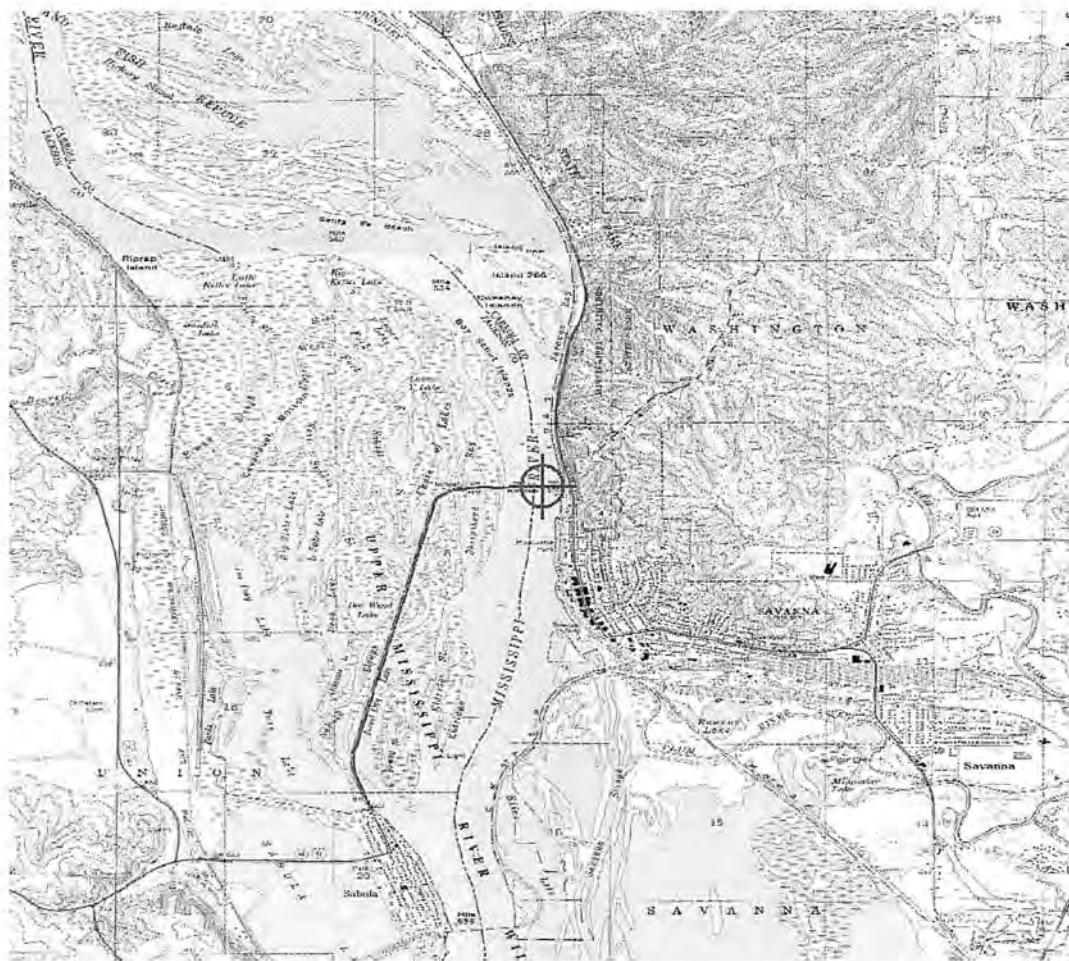

**FABRIC REINFORCED ELASTOMERIC**

Effective: August 29, 2014

Revise the second paragraph of Article 1028.01 of the Standard Specifications to read:

“The elastomer compound shall be either Polychloroprene according to Table X1 of AASHTO M 251 having a minimum Hardness (Durometer) of 50 or Ethylene Propylene Diene Monomer (EPDM) according to Article 1052.02. The composite of the fabric and elastomer compound shall have a minimum tensile strength of 700 x 700 lb./in. (122.6 x 122.6 N/mm) according to ASTM D 378. The minimum elongation at ultimate tensile strength shall be 30 percent according to ASTM D 412.”