

- 1 COVER SHEET
- 2 GENERAL NOTES/SUMMARY OF QUANTITIES
- 3 EXISTING PLAN
- 4 PROPOSED SLOPE IMPROVEMENTS
- 5 RIGHT-OF-WAY/EASEMENT PLAN

DEPARTMENT OF TRANSPORTATION

DIVISION OF HIGHWAYS

PROPOSED HIGHWAY PLANS

COUNTY HIGHWAY 2 (FAS 452) SN 029-3215
OVER SPOON RIVER

SECTION: 14-00130-14-DR
PROJECT NO. ER-057(038)
JOB NO. C-94-054-14
FULTON COUNTY, ILLINOIS

IDOT ROADWAY STANDARDS

NO.	DESCRIPTION
000001-06	STANDARD SYMBOLS, ABBREVIATIONS AND PATTERNS
001006	DECIMAL OF AN INCH AND OF A FOOT
701001-02	OFF-RD OPERATIONS, 2L, 2W, MORE THAN 15' AWAY
701006-05	OFF-RD OPERATIONS, 2L, 2W, 15' TO 24' FROM PAVEMENT EDGE
701201-04	LANE CLOSURE, 2L, 2W, DAY ONLY, FOR SPEEDS ≥ 45 MPH
701301-04	LANE CLOSURE, 2L, 2W, SHORT TIME OPERATIONS
701901-04	TRAFFIC CONTROL DEVICES

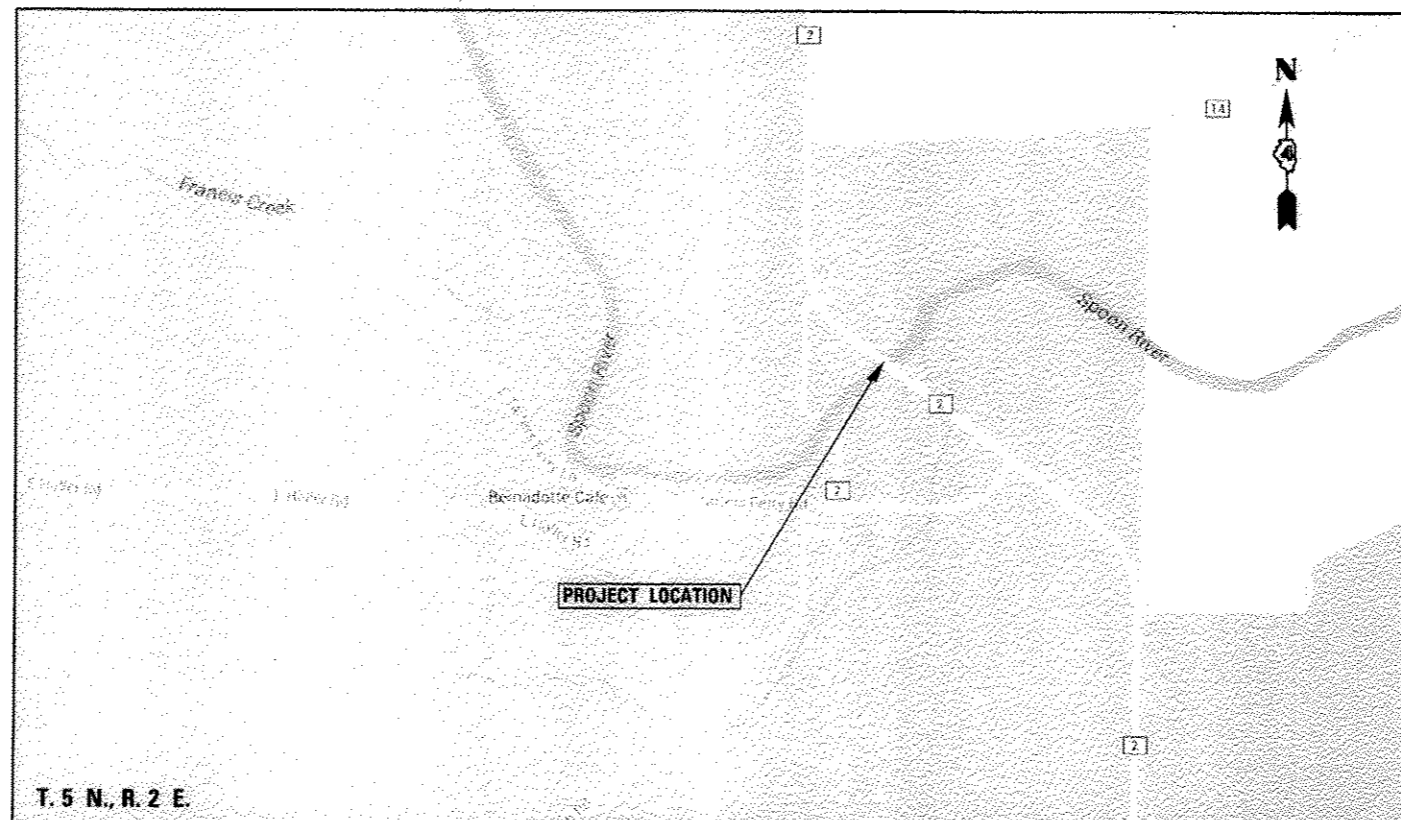
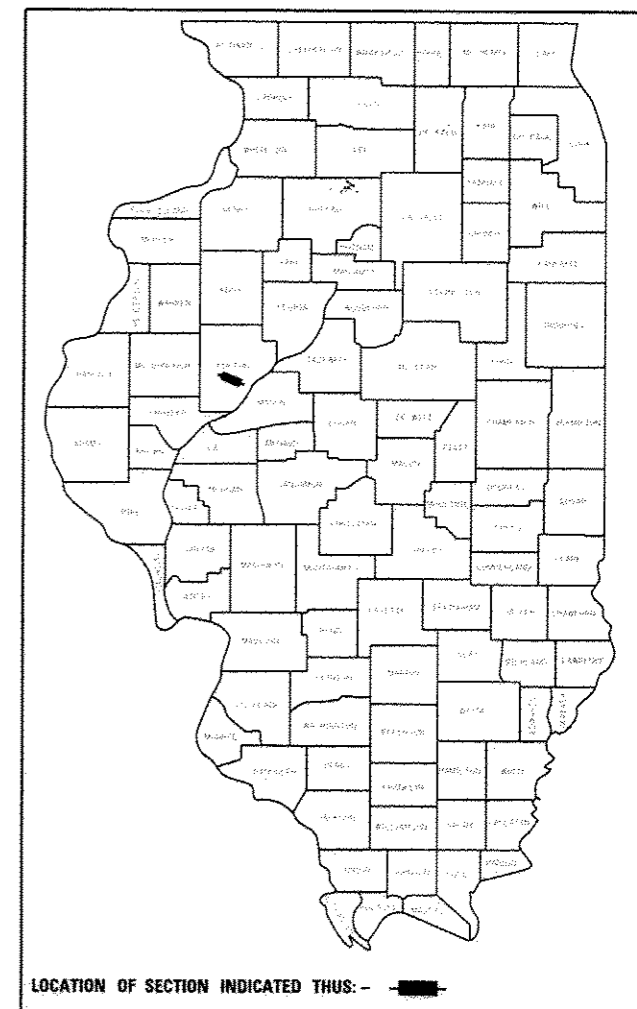

LOCATION MAP
NOT TO SCALE

STATE OF ILLINOIS DEPARTMENT OF TRANSPORTATION DIVISION OF HIGHWAYS	
APPROVED	<i>[Signature]</i> 20 15 <i>[Signature]</i> FULTON COUNTY HIGHWAY DEPARTMENT
PASSED	<i>[Signature]</i> 20 15 DISTRICT 4 ENGINEER OF LOCAL ROADS & STREETS
RELEASING FOR BID BASED ON LIMITED REVIEW	08-11 20 15 <i>[Signature]</i> DEPUTY DIRECTOR OF HIGHWAYS, REGION 3 ENGINEER

J.U.L.I.E.
JOINT UTILITY LOCATION INFORMATION FOR EXCAVATION
1-800-892-0123
OR 811

CONTRACT NO. 89666
CATALOG NO. 035067

SEAL

[Signature] 06/09/15
MATT D. MASTERSON, P.E. DATE
EXPIRES: 11/30/2015

LICENSED PROFESSIONAL ENGINEER
MATT D. MASTERSON
NO. 062-061885
STATE OF ILLINOIS

PRINTED BY AUTHORITY OF THE STATE OF ILLINOIS

Kaskaskia
Engineering Group, LLC

208 East Main Street, Suite 100
Belleville, Illinois 62220
618.233.5877 phone
618.233.5977 fax
www.kaskaskiaeng.com

PROFESSIONAL REGISTRATIONS
Illinois Professional Design Firm
Professional Engineering Group

LICENSE NO.
184.004773
20-5080586

GENERAL NOTES:

GENERAL

- 1 ALL WORK, INSTALLATION, PROCEDURES, MATERIALS, AND TESTING ASSOCIATED WITH THIS PROJECT SHALL CONFORM TO THE IDOT STANDARD SPECIFICATIONS FOR ROAD AND BRIDGE CONSTRUCTION (ADOPTED JANUARY 1, 2012) AND THE SUPPLEMENTAL SPECIFICATIONS AND RECURRING SPECIAL PROVISIONS, LATEST EDITION (BOTH OF WHICH WILL BE HEREINAFTER REFERRED TO IN THESE DOCUMENTS AS THE STANDARD SPECIFICATIONS).
- 2 IT SHALL BE THE CONTRACTOR'S RESPONSIBILITY TO VERIFY ALL DIMENSIONS AND CONDITIONS EXISTING IN THE FIELD PRIOR TO ORDERING MATERIALS AND BEGINNING CONSTRUCTION.
- 3 EXISTING GRADES AND ELEVATIONS REPORTED ON THE DRAWINGS ARE BASED ON BEST AVAILABLE INFORMATION.

UTILITIES

- 1 ILLINOIS STATE LAW REQUIRES A 48-HOUR NOTICE BE GIVEN TO ALL UTILITIES BEFORE DIGGING. FIELD MARKING OF FACILITIES MAY BE OBTAINED BY CONTACTING J.U.L.I.E FOR NON-MEMBERS. CONTACT THE UTILITY DIRECTLY.

MATERIALS

- 1 FABRIC MATERIAL SHOULD BE NON-WOVEN MIRAFI 180N OR EQUIVALENT IN GENERAL ACCORDANCE WITH SECTION 210. FABRIC FOR GROUND STABILIZATION, ARTICLE 1080.02 - GEOTEXTILE FABRIC.
- 2 RIP RAP SHOULD BE A DURABLE STONE WITH GRADATION NUMBER A3 AND A5 IN GENERAL ACCORDANCE WITH SECTION 1005. STONE AND BROKEN CONCRETE FOR EROSION PROTECTION, SEDIMENT CONTROL, AND ROCKFILL. THE RIP RAP SHALL CONTAIN A LARGE PERCENTAGE OF PIECES AS LARGE AS THE LAYER THICKNESS INDICATED ON THE PLANS, WITH ENOUGH SMALLER PIECES OF VARIOUS SIZES TO FILL THE LARGER VOIDS. GRADATION NUMBER A3 SHALL BE USED AS THE BASE OR BEDDING MATERIAL FOR THE SLOPE REPAIR AND BACKFILL FOR THE TRENCHES AS INDICATED ON THE DETAILS. ACCEPTANCE OF QUALITY AND SIZE OF THE MATERIAL WILL BE MADE BY VISUAL INSPECTION AT THE JOB SITE.

CONSTRUCTION REQUIREMENTS

- 1 CONSTRUCTION OF THE SLOPE REPAIR SHALL BEGIN AT THE TOE OF THE SLOPE AND PROGRESS UP-SLOPE TO THE UPPER TRENCH AND TIE-IN TO THE EXISTING SLOPE PROTECTION.
- 2 PREPARE THE SUBGRADE FOR THE RIP RAP AND FABRIC TO THE LINES AND GRADES SHOWN ON THE PLANS. REMOVE BRUSH AND OTHER OBJECTIONABLE MATERIAL. UNDERCUT OF SOFT RIVER MUCK TO FIRMER UNDISTURBED SOILS SHALL BE INCIDENTAL TO THE CONTRACT. FIRMNESS CONSTITUTES NO PUMPING OR RUTTING UNDER CONSTRUCTION EQUIPMENT. CUT THE SUBGRADES SUFFICIENTLY DEEP SO THAT THE FINISHED GRADE OF THE RIP RAP WILL BE AT THE ELEVATION OF THE SURROUNDING AREA. BACKFILL ANY OVER EXCAVATIONS WITH RIP RAP UP TO THE PROPOSED LINES AND GRADES SHOWN ON THE PLANS. DO NOT INSTALL FABRIC OVER SUBGRADES IN OVER EXCAVATED AREAS.
- 3 THE TRENCH AT THE TOE OF THE SLOPE SHALL BE EXCAVATED TO THE ELEVATIONS SHOWN ON THE PLANS, OR TO A DEPTH OF 2 FEET BELOW THE CURRENT GRADES AT THE TOE OF THE SLOPE AT THE CENTER LINE OF THE BRIDGE.
- 4 THE TRENCHES SHOULD BE EXCAVATED TO SUFFICIENTLY ALLOW PLACEMENT OF THE FABRIC AND RIP RAP IN A MANNER SUCH THAT THE FINISHED INSIDE DIMENSIONS AND GRADES OF THE TRENCHES MEET DESIGN SPECIFICATIONS.
- 5 THE TRENCHES SHOWN ON THE PLANS SHOULD BE EXCAVATED AND BACKFILLED IN SEGMENTS, WITH NO MORE THAN 10 LINEAL FEET OF TRENCH OPEN FOR MORE THAN 1 HOUR PRIOR TO BACKFILL PLACEMENT ALONG THE PROPOSED ALIGNMENTS. TRENCH EXCAVATIONS SHOULD BE BACKFILLED IMMEDIATELY IF RAIN IS EMINENT. FABRIC SHOULD BE DRAPED INTO THE TRENCH AND RIP RAP PLACED PRIOR TO EXCAVATING AN ADDITIONAL SEGMENT OF TRENCH. AT NO TIME SHALL EITHER TRENCH ALIGNMENT BE EXCAVATED IN ONE CONTINUOUS OPEN EXCAVATION.
- 6 FABRIC SHOULD BE PLACED ON PREPARED SUBGRADES TO THE LINES AND GRADES SHOWN ON THE PLANS. OVERLAP THE EDGES BY AT LEAST 2 FEET AND SPACE ANCHOR PINS EVERY 3 FEET ALONG THE OVERLAPS. BURY THE EDGES OF THE FABRIC AT THE OUTER PERIMETERS OF THE SLOPE REPAIR A MINIMUM OF 12-INCHES BELOW GRADE, OR AS OTHERWISE INDICATED ON THE PLANS. AT THE UPPER END OF THE SLOPE REPAIR NEW FABRIC SHOULD BE SUFFICIENTLY OVERLAPPED AND/OR PATCHED-IN WITH THE EXISTING FABRIC AT THE TRANSITION. TAKE PRECAUTIONS NOT TO DAMAGE THE FABRIC BY DROPPING OF THE RIP RAP. IF DAMAGE OCCURS, REMOVE RIP RAP AND REPAIR THE AREA BY ADDING ANOTHER LAYER OF FABRIC WITH A MINIMUM OVERLAP OF 2 FEET AROUND THE DAMAGED AREA AND SUFFICIENTLY WEIGHTED DOWN OR OTHERWISE SECURED TO PREVENT THE REPLACEMENT RIP RAP FROM CAUSING LAP SEPARATION.
- 7 PLACEMENT OF RIP RAP SHOULD FOLLOW IMMEDIATELY AFTER INSTALLATION OF THE FABRIC. RIP RAP PLACEMENT SHOULD BE ACCOMPLISHED BY SPREADING THE RIP RAP OFF THE PREVIOUSLY PLACED MATERIAL IN SUCH A MANNER AS TO PREVENT TEARING OR SHOVING OF THE FABRIC. NO CONSTRUCTION EQUIPMENT SHALL BE ALLOWED ON THE FABRIC PRIOR TO PLACEMENT OF RIP RAP. PLACE RIP RAP SO THAT IT FORMS A DENSE, WELL-GRADED MASS OF ROCK WITH A MINIMUM OF VOIDS. GOOD GRADATION OF THE RIP RAP THROUGHOUT EACH LIFT MAY BE OBTAINED BY SELECTIVE LOADING AT THE QUARRY AND CONTROLLED DUMPING DURING FINAL PLACEMENT. THE FINISHED SLOPE SHOULD BE FREE OF POCKETS OF SMALL ROCKS OR CLUSTERS OF LARGE ROCKS. HAND PLACING MAY BE NECESSARY TO ACHIEVE PROPER DISTRIBUTION OF ROCK SIZES AND A SMOOTH, UNIFORM SURFACE. THE FINISHED GRADE OF THE RIP RAP SHOULD BLEND WITH THE SURROUNDING AREA.

METHOD OF MEASUREMENT AND BASIS FOR PAYMENT

- 1 FABRIC FOR GROUND STABILIZATION - PER ARTICLES 210.05 AND 210.06 OF THE STANDARD SPECIFICATIONS
- 2 RIP RAP - PER ARTICLES 281.06 AND 281.07 OF THE STANDARD SPECIFICATIONS

COMMITMENTS

NONE

ENVIRONMENTAL REVIEWS

PRIOR TO THE USE OF ANY PROPOSED BORROW AREAS, USE AREAS (TEMPORARY ACCESS ROADS, DETOURS, RUN-AROUNDS, ETC.) AND/OR WASTE AREAS, THE CONTRACTOR SHALL FILE THE REQUIRED ENVIRONMENTAL RESOURCE REQUEST SURVEYS ACCORDING TO SECTION 107.22 OF THE STANDARD SPECIFICATIONS. THESE SURVEYS ARE REQUIRED IN ORDER FOR THE DEPARTMENT TO CONDUCT CULTURAL AND BIOLOGICAL RESOURCE SURVEYS FOR THE PROPOSED SITE.

THE REQUIRED ENVIRONMENTAL RESOURCE DOCUMENTATION SHALL INCLUDE THE FOLLOWING:

- BDE FORM 2289 (CULTURAL AND NATURAL RESOURCES REVIEW OF BORROW AREAS)
- BDE FORM 2290 (WASTE/USE AREA REVIEW)
- A LOCATION MAP SHOWING THE SIZE LIMITS AND LOCATION OF THE USE AREA
- COLOR PHOTOGRAPHS DEPICTING THE USE AREA
- BORROW AREA ENTRY AGREEMENT FOR - D4 P10101

PRIOR TO ANY WASTE MATERIALS BEING REMOVED FROM THE CONSTRUCTION SITE THE REQUIRED ENVIRONMENTAL RESOURCE SURVEYS SHALL BE OBTAINED AND FILED BY THE CONTRACTOR. EXCESS WASTE PRODUCTS REMOVED FROM THE CONSTRUCTION SITE SHALL BE DISPOSED OF AS REQUIRED IN SECTION 202.03 OF THE STANDARD SPECIFICATIONS.

ANY PROTRUDING METAL BARS SHALL BE REMOVED PRIOR TO THE DISPOSAL OF BROKEN CONCRETE AT APPROVED DISPOSAL SITES.

PLEASE NOTE THAT A MINIMUM OF FOUR WEEKS SHALL BE ALLOWED FOR THE DISTRICT TO OBTAIN THE REQUIRED WASTE SITE ENVIRONMENTAL CLEARANCES AND SIX WEEKS FOR THE REQUIRED BORROW SITE ENVIRONMENTAL CLEARANCES.

SUMMARY OF QUANTITIES

CODE NO.	ITEM	UNIT	TOTAL QUANTITIES
21001000	GEOTECHNICAL FABRIC FOR GROUND STABILIZATION	SQ YD	900
28100805	STONE DUMPED RIPRAP, CLASS A3	TON	1,000
28100809	STONE DUMPED RIPRAP, CLASS A5	TON	700
67100100	MOBILIZATION	L.S.M.	1

DESIGNED	MDM	REVISED	
DRAWN	TJH	REVISED	
CHECKED	LDC	REVISED	
DATE	4/14/2015	REVISED	

STATE OF ILLINOIS
DEPARTMENT OF TRANSPORTATION

GENERAL NOTES & SUMMARY OF QUANTITIES

SCALE: SHEET NO. OF SHEETS STA. TO STA.

SECTION	COUNTY	TOTAL SHEETS	SHEET NO.
14-00130-14-DR	FULTON	5	2
CH-2 OVER SPOON RIVER ILLINOIS		CONTRACT NO. 89666	

PLAN

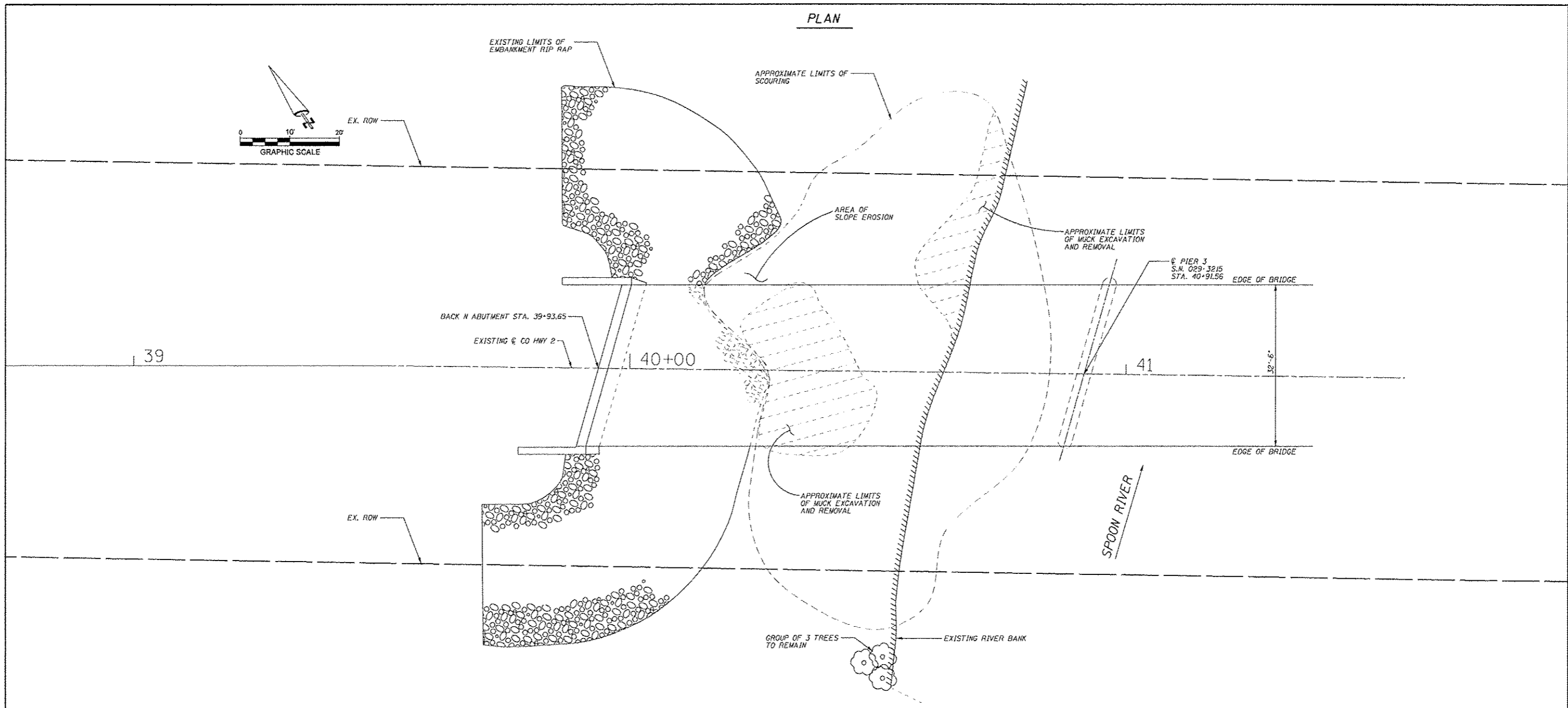

ELEVATION

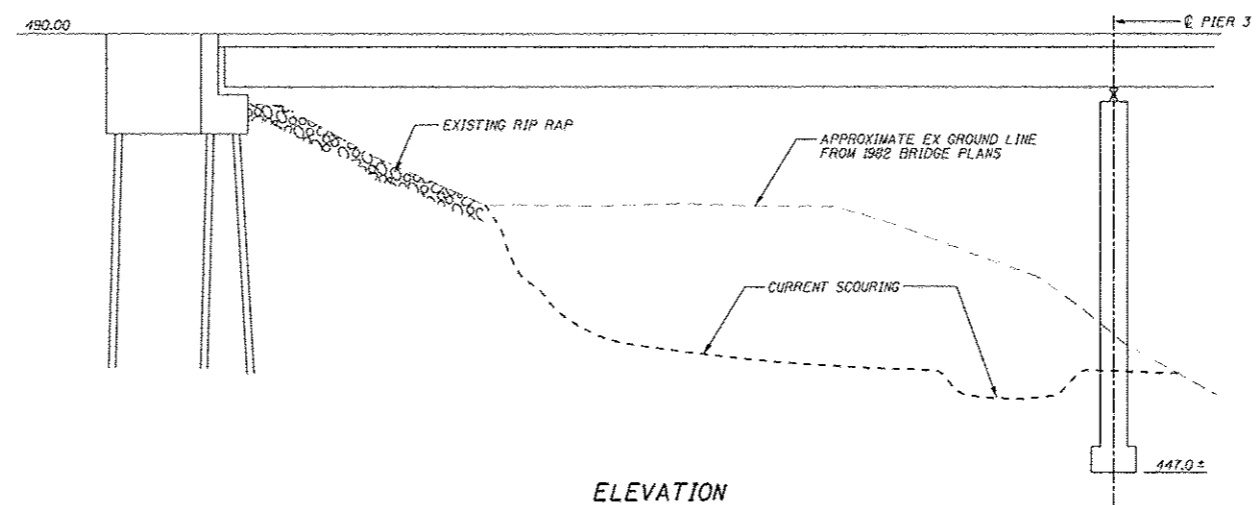

FILE NAME = #FILES#	USER NAME = #USER#	DESIGNED - MDM	REVISED -	STATE OF ILLINOIS DEPARTMENT OF TRANSPORTATION	EXISTING PLAN			SECTION	COUNTY	TOTAL SHEETS	SHEET NO.	
	MODEL NAME = #MODELNAME#	DRAWN - T.JH	REVISED -		SCALE: 1" = 10'	SHEET NO.	OF SHEETS	STA.	TO STA.	14-00130-14-DR	FULTON	5 3
	PLOT SCALE = #SCALE#	CHECKED - LDC	REVISED -							CH-2 OVER SPOON RIVER		CONTRACT NO. 89666
	PLOT DATE = #DATE#	DATE - 4/14/2015	REVISED -							ILLINOIS		

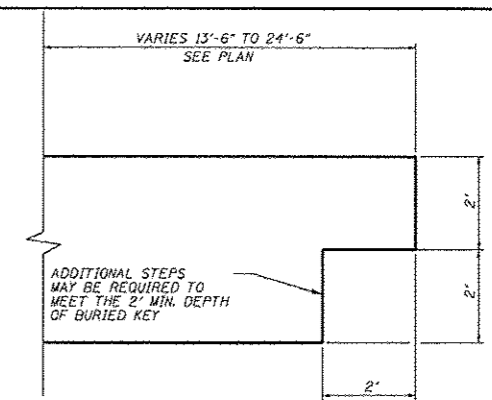
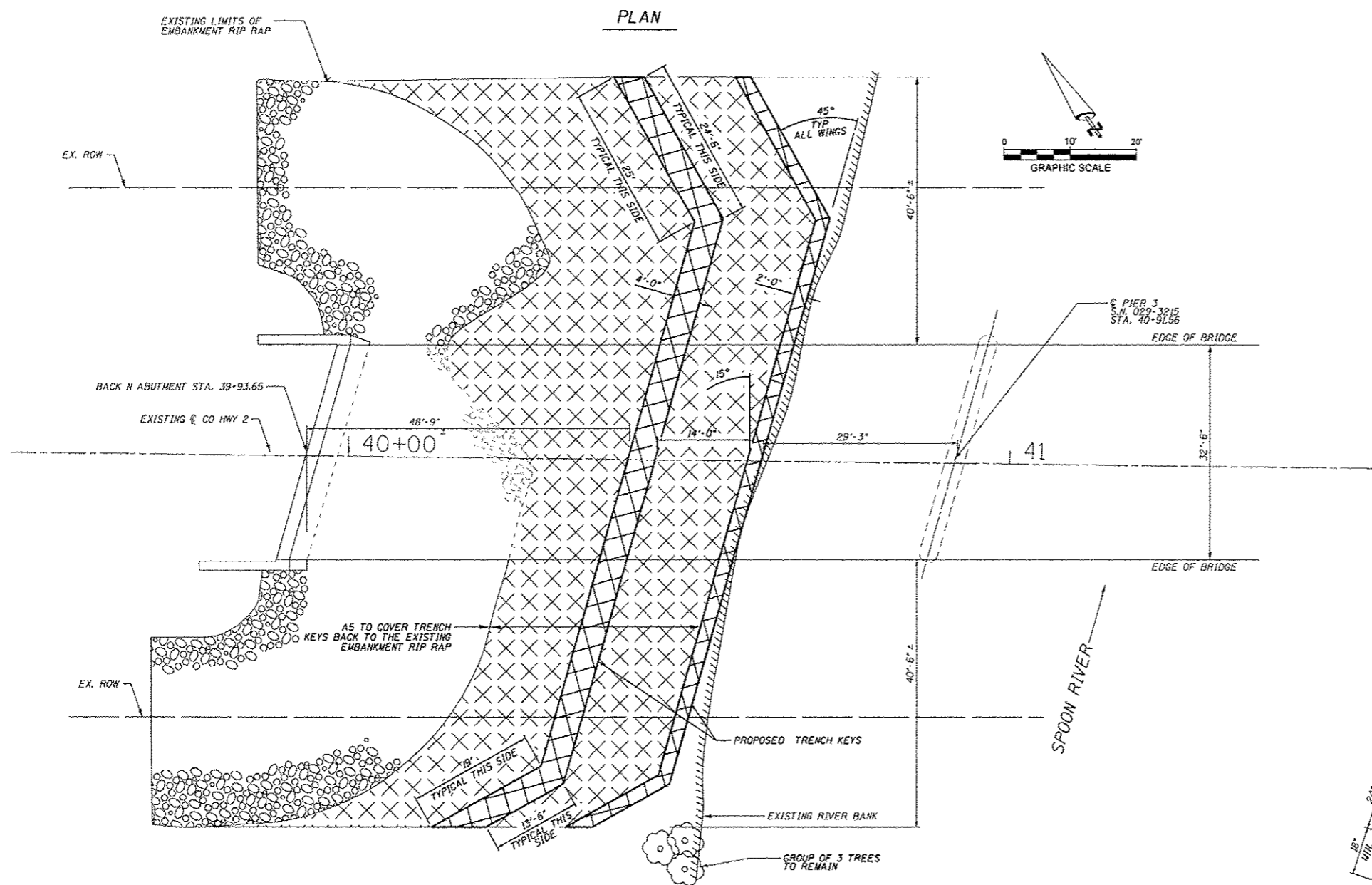

TRENCH KEY WING DETAIL
NOT TO SCALE

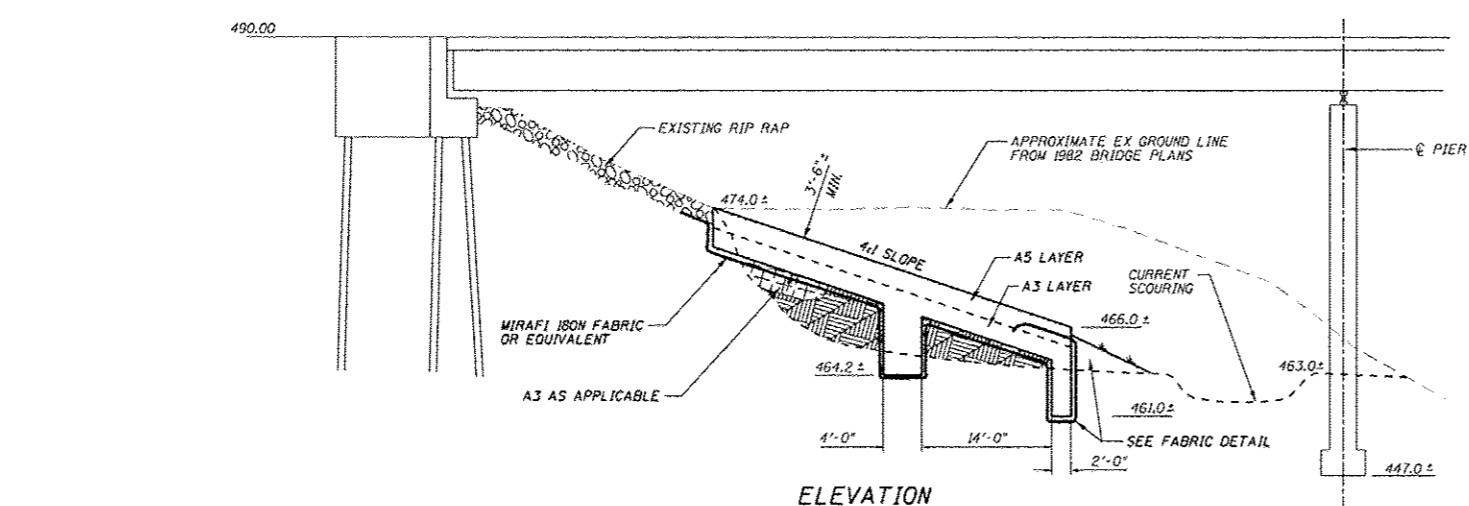

ELEVATION

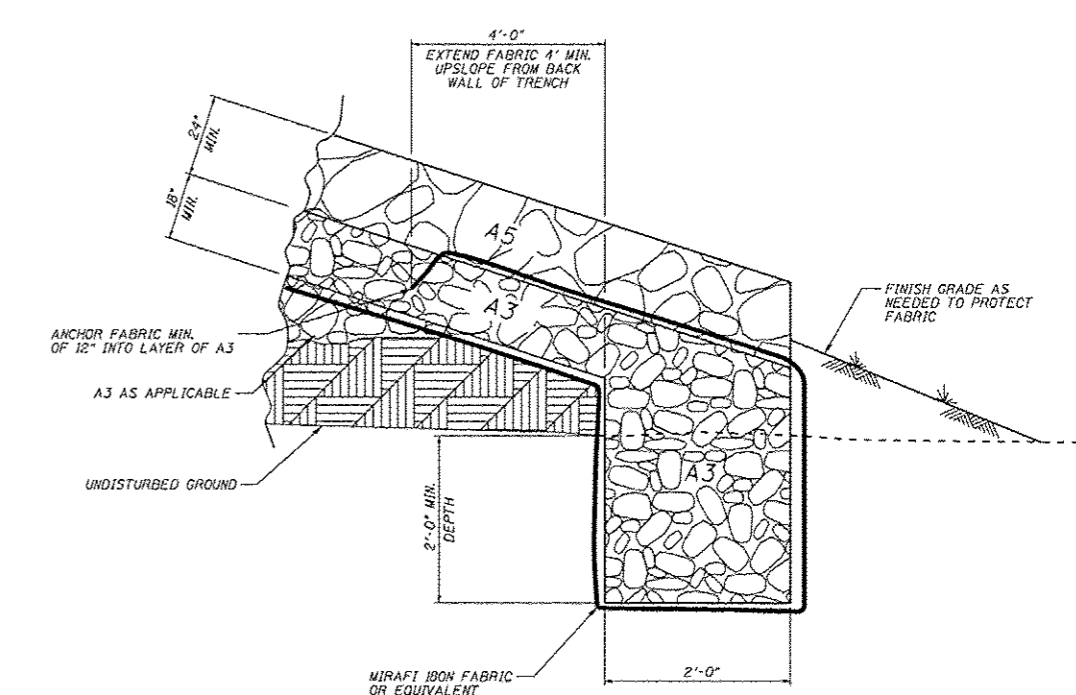

2 FT. TRENCH KEY & FABRIC DETAIL
NOT TO SCALE

NOTE:
MIN. = MINIMUM

FILE NAME = #FILES#	USER NAME = #USER#	DESIGNED - MDM	REVISED -	STATE OF ILLINOIS DEPARTMENT OF TRANSPORTATION	PROPOSED SLOPE IMPROVEMENTS			SECTION	COUNTY	TOTAL SHEETS	SHEET NO.
	MODEL NAME = #MODELNAME#	DRAWN - TJH	REVISED -					14-00130-14-DR	FULTON	5	4
	PLOT SCALE = #SCALE#	CHECKED - LDC	REVISED -					CH-2 OVER SPOON RIVER	CONTRACT NO. 89666		
	PLOT DATE = #DATE#	DATE - 4/14/2015	REVISED -					ILLINOIS			
				SCALE: 1" = 10'	SHEET NO.	OF SHEETS	STA.	TO STA.			

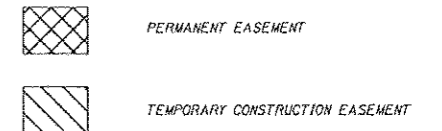
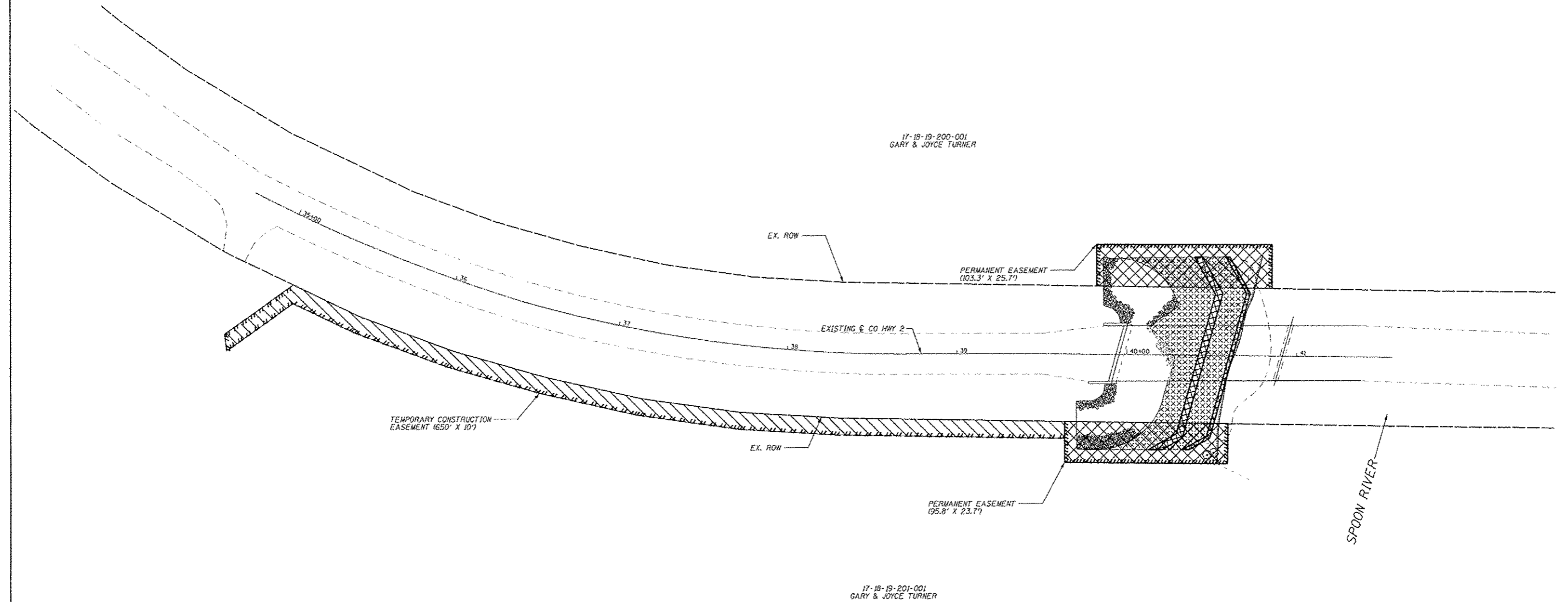
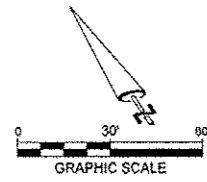

FILE NAME : #FILES#	USER NAME : #USER#	DESIGNED - MDM	REVISED -
	MODEL NAME : #MODELNAME#	DRAWN - T.JH	REVISED -
	PLOT SCALE : #SCALE#	CHECKED - LDC	REVISED -
	PLOT DATE : #DATE#	DATE - 4/14/2015	REVISED -

STATE OF ILLINOIS
DEPARTMENT OF TRANSPORTATION

RIGHT-OF-WAY & EASEMENT PLAN

SCALE: 1" = 30' SHEET NO. OF SHEETS STA. TO STA.

SECTION	COUNTY	TOTAL SHEETS	SHEET NO.
14-00130-14-DR	FULTON	5	5
CH-2 OVER SPOON RIVER		CONTRACT NO. 89666	
ILLINOIS			