

STATE OF ILLINOIS
DEPARTMENT OF TRANSPORTATION

F.A.P. RTE.	SECTION	COUNTY	TOTAL SHEETS	SHEET NO.
350	2020-118-I	COOK	16	1
		ILLINOIS	CONTRACT NO. 62L96	

FOR INDEX OF SHEETS, SEE SHEET NO. 2

THE PROJECT IS LOCATED IN VILLAGE OF SKOKIE AND VILLAGE OF LINCOLNWOOD

PROPOSED HIGHWAY PLANS

FAP ROUTE 350: IL 50 / US 41 (SKOKIE BLVD.)
NORTH OF GOLF ROAD TO TOUHY AVE.
SECTION: 2020-118-I
CRACK AND JOINT SEALING
PROJECT: NHPP-TNSA(639)
COOK COUNTY
C-91-316-20

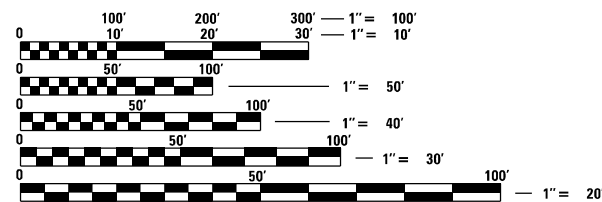
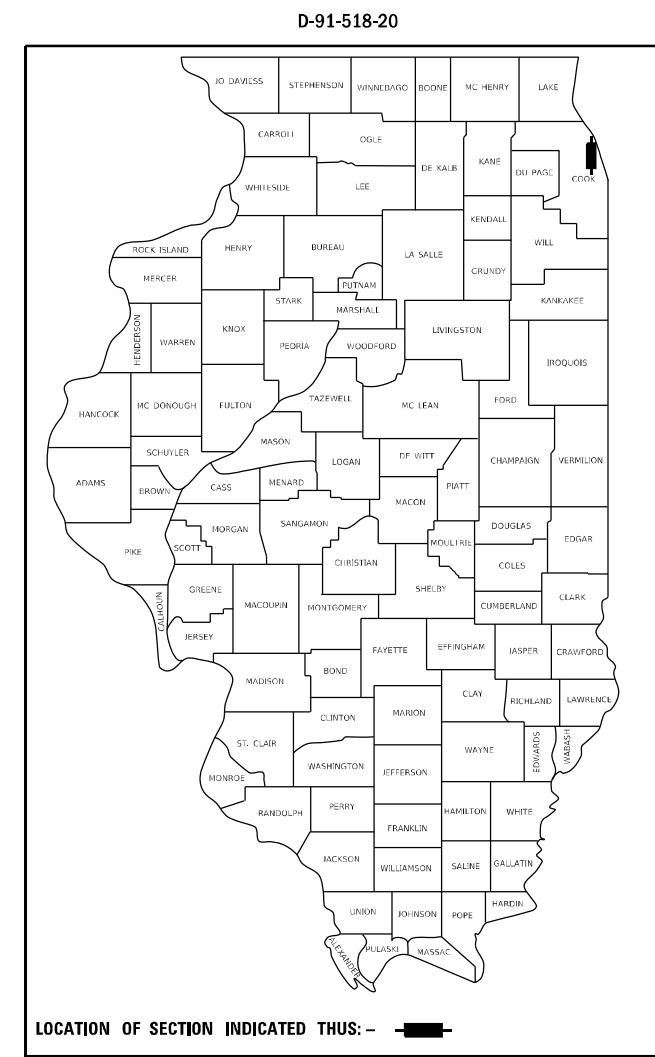

FULL SIZE PLANS HAVE BEEN PREPARED USING STANDARD ENGINEERING SCALES. REDUCED SIZED PLANS WILL NOT CONFORM TO STANDARD SCALES. IN MAKING MEASUREMENTS ON REDUCED PLANS, THE ABOVE SCALES MAY BE USED.

J.U.L.I.E.
JOINT UTILITY LOCATION INFORMATION FOR EXCAVATORS
1-800-892-0123
OR 811

PROJECT MANAGER: FAWAD AQUEEL (847) 705-4247
PROJECT ENGINEER: VESELIN VELICHKOV (847) 705-4432
CONTRACT NO. 62L96

TRAFFIC DATA
2019 ADT = 21,100 VPD

POSTED SPEED LIMIT
35 - 40 MPH

PROJECT BEGINS
STA. 57 + 27.7

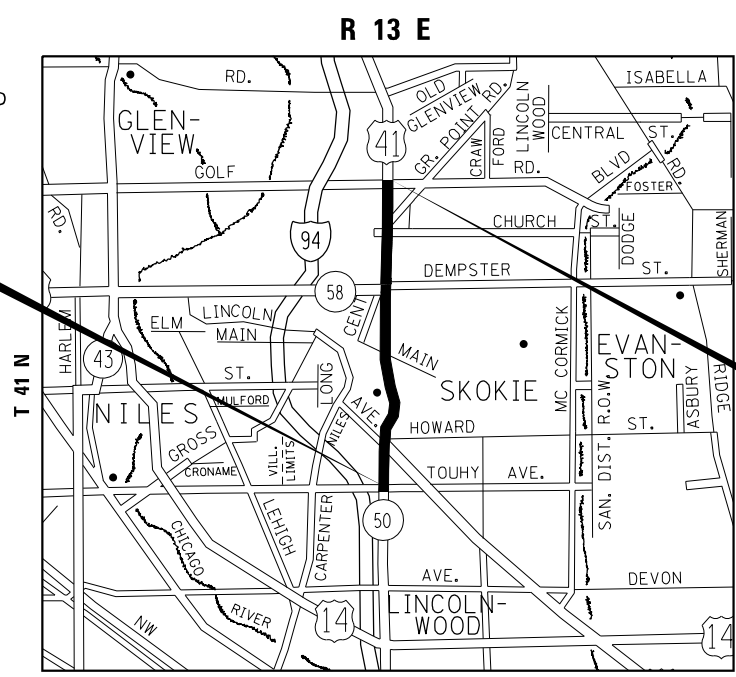

N
LOCATION MAP
NOT TO SCALE

PROJECT ENDS
STA. 218 + 27.7

NILES TOWNSHIP

GROSS & NET LENGTH OF PROJECT = 16,100 LINEAL FEET = 3.05 MILES

STATE OF ILLINOIS
DEPARTMENT OF TRANSPORTATION

SUBMITTED JUNE 18 2020
Anthony J. Dringler
REGIONAL ENGINEER

August 14, 2020
Scott A. Elk
ENGINEER OF DESIGN AND ENVIRONMENT

August 14, 2020
James J. ...
DIRECTOR OF HIGHWAYS PROJECT IMPLEMENTATION

PRINTED BY THE AUTHORITY
OF THE STATE OF ILLINOIS

SUMMARY OF QUANTITIES			TOTAL QUANTITIES URBAN	CONSTRUCTION TYPE CODE					
CODE NO	ITEM	UNIT		80% FED 20% STATE 0005					
45100100	CRACK ROUTING (PAVEMENT)	FOOT	97100	97100					
45100200	CRACK FILLING	POUND	25540	25540					
67000400	ENGINEER'S FIELD OFFICE, TYPE A	CAL MO	3	3					
67100100	MOBILIZATION	L SUM	1	1					
70102625	TRAFFIC CONTROL AND PROTECTION, STANDARD 701606	L SUM	1	1					
70102630	TRAFFIC CONTROL AND PROTECTION, STANDARD 701601	L SUM	1	1					
70102635	TRAFFIC CONTROL AND PROTECTION, STANDARD 701701	L SUM	1	1					
70102640	TRAFFIC CONTROL AND PROTECTION, STANDARD 701801	L SUM	1	1					
78009000	MODIFIED URETHANE PAVEMENT MARKING - LETTERS AND SYMBOLS	SO FT	1900	1900					
78009004	MODIFIED URETHANE PAVEMENT MARKING - LINE 4"	FOOT	43050	43050					
78009006	MODIFIED URETHANE PAVEMENT MARKING - LINE 6"	FOOT	15100	15100					
78009008	MODIFIED URETHANE PAVEMENT MARKING - LINE 8"	FOOT	750	750					

SUMMARY OF QUANTITIES			TOTAL QUANTITIES URBAN	CONSTRUCTION TYPE CODE					
CODE NO	ITEM	UNIT		80% FED 20% STATE 0005					
* 78009012	MODIFIED URETHANE PAVEMENT MARKING - LINE 12"	FOOT	1050	1050					
* 78009024	MODIFIED URETHANE PAVEMENT MARKING - LINE 24"	FOOT	1350	1350					
Z0030850	TEMPORARY INFORMATION SIGNING	SO FT	51.4	51.4					

MODEL: Default
 FILE: h:\a\c\p\pub\haronom.dwg
 PROJECT: 151820\CaddData\Design\151820-ent-500.dwg
 USER: shirani@shirani.com
 DATE: 6/2/2020

USER NAME = shirani@shirani.com	DESIGNED -	REVISED -
PLOT SCALE = 100.0000' / in.	DRAWN -	REVISED -
PLOT DATE = 6/2/2020	CHECKED -	REVISED -
	DATE -	REVISED -

**STATE OF ILLINOIS
DEPARTMENT OF TRANSPORTATION**

SUMMARY OF QUANTITIES	
IL RTE 50 /US 41 (SKOKIE BLVD.) NORTH OF GOLF ROAD TO TOUHY AVE.	
SCALE:	SHEET OF SHEETS STA. TO STA.

F.A.P. RTE.	SECTION	COUNTY	TOTAL SHEETS	SHEET NO.
350	2020-118-I	COOK	16	3
CONTRACT NO. 62L96				
ILLINOIS FED. AID PROJECT				

* SPECIALTY ITEM

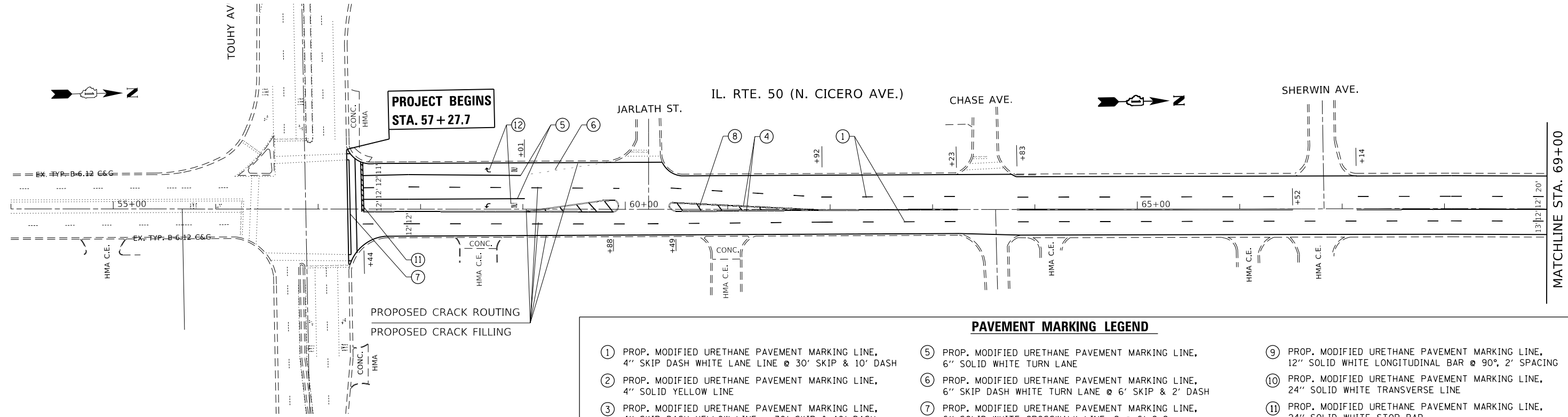

**PROJECT BEGINS
STA. 57 + 27.7**

PROPOSED CRACK ROUTING
PROPOSED CRACK FILLING

PAVEMENT MARKING LEGEND

- ① PROP. MODIFIED URETHANE PAVEMENT MARKING LINE, 4" SKIP DASH WHITE LANE LINE @ 30' SKIP & 10' DASH
- ② PROP. MODIFIED URETHANE PAVEMENT MARKING LINE, 4" SOLID YELLOW LINE
- ③ PROP. MODIFIED URETHANE PAVEMENT MARKING LINE, 4" SKIP DASH YELLOW LINE @ 30' SKIP & 10' DASH
- ④ PROP. MODIFIED URETHANE PAVEMENT MARKING LINE, 4" DOUBLE SOLID YELLOW LINE, 2 @ 11" C-C
- ⑤ PROP. MODIFIED URETHANE PAVEMENT MARKING LINE, 6" SOLID WHITE TURN LANE
- ⑥ PROP. MODIFIED URETHANE PAVEMENT MARKING LINE, 6" SKIP DASH WHITE TURN LANE @ 6' SKIP & 2' DASH
- ⑦ PROP. MODIFIED URETHANE PAVEMENT MARKING LINE, 6" SOLID WHITE CROSSWALK LINE, 2 @ 6' C-C
- ⑧ PROP. MODIFIED URETHANE PAVEMENT MARKING LINE, 12" DIAGONAL SOLID YELLOW LINE @ 75' SPACING OR 5 MIN.
- ⑨ PROP. MODIFIED URETHANE PAVEMENT MARKING LINE, 12" SOLID WHITE LONGITUDINAL BAR @ 90°, 2' SPACING
- ⑩ PROP. MODIFIED URETHANE PAVEMENT MARKING LINE, 24" SOLID WHITE TRANSVERSE LINE
- ⑪ PROP. MODIFIED URETHANE PAVEMENT MARKING LINE, 24" SOLID WHITE STOP BAR
- ⑫ PROP. MODIFIED URETHANE PAVEMENT MARKING LETTERS & SYMBOLS, SOLID WHITE

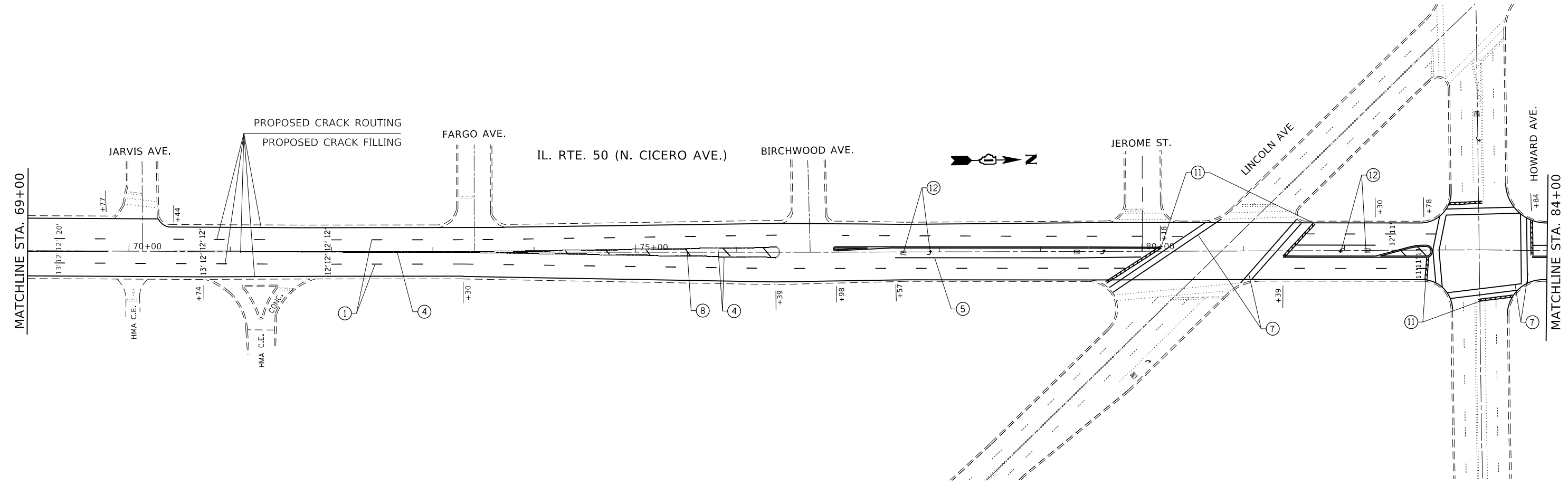

PROPOSED CRACK ROUTING
PROPOSED CRACK FILLING

MODEL: Default
 FILE: Model - Plot.dwg
 PROJECT: I:\Projects\151820\CADD\151820-01\151820-01.dwg
 USER: shirani

USER NAME = shirani	DESIGNED -	REVISED -
PLOT SCALE = 100,0000' / in.	DRAWN -	REVISED -
PLOT DATE = 6/2/2020	CHECKED -	REVISED -
	DATE -	REVISED -

**STATE OF ILLINOIS
DEPARTMENT OF TRANSPORTATION**

**ROADWAY PLAN IL RTE. 50 /US RTE. 41 (SKOKIE BLVD.)
NORTH OF GOLF RD. TO TOUGHY AVE.**

SCALE: 1"=50' SHEET OF SHEETS STA. 57+27.7 TO STA. 84+00

F.A.P. RTE. 350	SECTION 2020-118-I	COUNTY COOK	TOTAL SHEETS 16	SHEET NO. 4
CONTRACT NO. 62L96			ILLINOIS FED. AID PROJECT	

U.S. RTE. 41 (SKOKIE BLVD.)

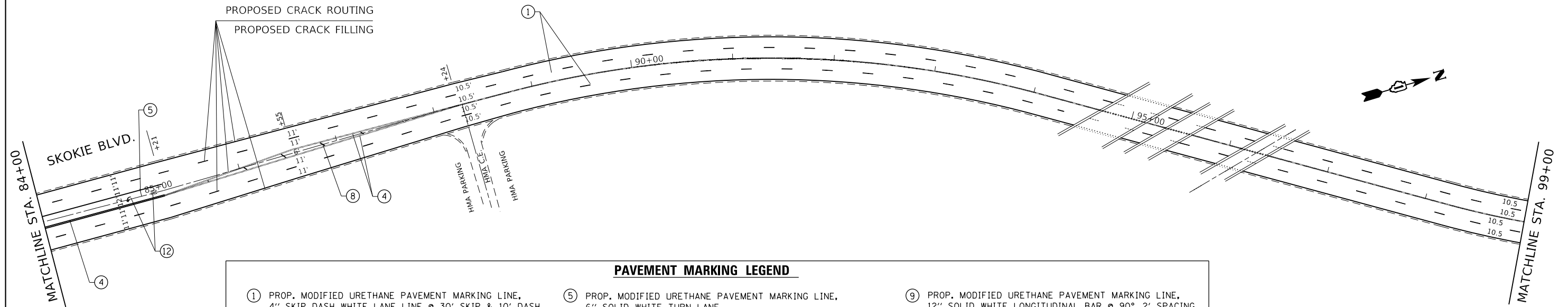

PAVEMENT MARKING LEGEND

- | | | |
|---|---|---|
| ① PROP. MODIFIED URETHANE PAVEMENT MARKING LINE, 4" SKIP DASH WHITE LANE LINE @ 30' SKIP & 10' DASH | ⑤ PROP. MODIFIED URETHANE PAVEMENT MARKING LINE, 6" SOLID WHITE TURN LANE | ⑨ PROP. MODIFIED URETHANE PAVEMENT MARKING LINE, 12" SOLID WHITE LONGITUDINAL BAR @ 90°, 2' SPACING |
| ② PROP. MODIFIED URETHANE PAVEMENT MARKING LINE, 4" SOLID YELLOW LINE | ⑥ PROP. MODIFIED URETHANE PAVEMENT MARKING LINE, 6" SKIP DASH WHITE TURN LANE @ 6' SKIP & 2' DASH | ⑩ PROP. MODIFIED URETHANE PAVEMENT MARKING LINE, 24" SOLID WHITE TRANSVERSE LINE |
| ③ PROP. MODIFIED URETHANE PAVEMENT MARKING LINE, 4" SKIP DASH YELLOW LINE @ 30' SKIP & 10' DASH | ⑦ PROP. MODIFIED URETHANE PAVEMENT MARKING LINE, 6" SOLID WHITE CROSSWALK LINE, 2 @ 6' C-C | ⑪ PROP. MODIFIED URETHANE PAVEMENT MARKING LINE, 24" SOLID WHITE STOP BAR |
| ④ PROP. MODIFIED URETHANE PAVEMENT MARKING LINE, 4" DOUBLE SOLID YELLOW LINE, 2 @ 11" C-C | ⑧ PROP. MODIFIED URETHANE PAVEMENT MARKING LINE, 12" DIAGONAL SOLID YELLOW LINE @ 75' SPACING OR 5 MIN. | ⑫ PROP. MODIFIED URETHANE PAVEMENT MARKING LETTERS & SYMBOLS, SOLID WHITE |

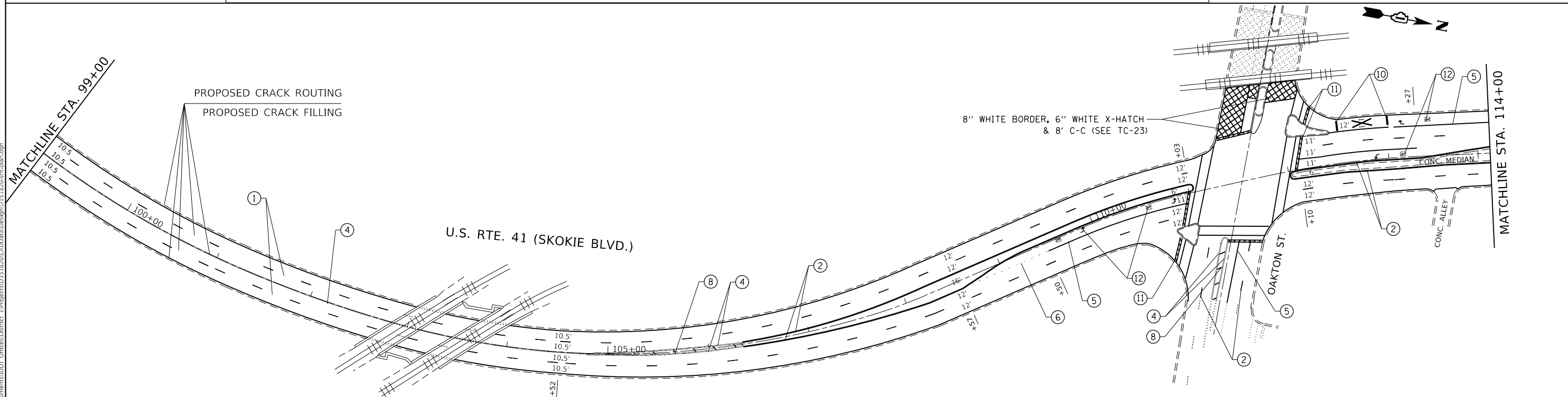

STATE OF ILLINOIS
DEPARTMENT OF TRANSPORTATION

ROADWAY PLAN IL RTE. 50 /US RTE. 41 (SKOKIE BLVD.)
NORTH OF GOLF RD. TO TOUGHY AVE.

F.A.P. RTE.	SECTION	COUNTY	TOTAL SHEETS	SHEET NO.
350	2020-118-I	COOK	16	5
CONTRACT NO. 62L96				
ILLINOIS FED. AID PROJECT				

SCALE: 1"=50' SHEET OF SHEETS STA. 84+00 TO STA. 114+00

USER NAME = shiraniib	DESIGNED -	REVISED -
PLOT SCALE = 100.0000' / in.	DRAWN -	REVISED -
PLOT DATE = 6/2/2020	CHECKED -	REVISED -
	DATE -	REVISED -

MODEL: Default
FILE: h:\m\c\p\pub\barroom.dwg
PROJECT: D:\151820\CADD\Drawings\DOT\Office\Drawings\151820-eh-lan.dwg

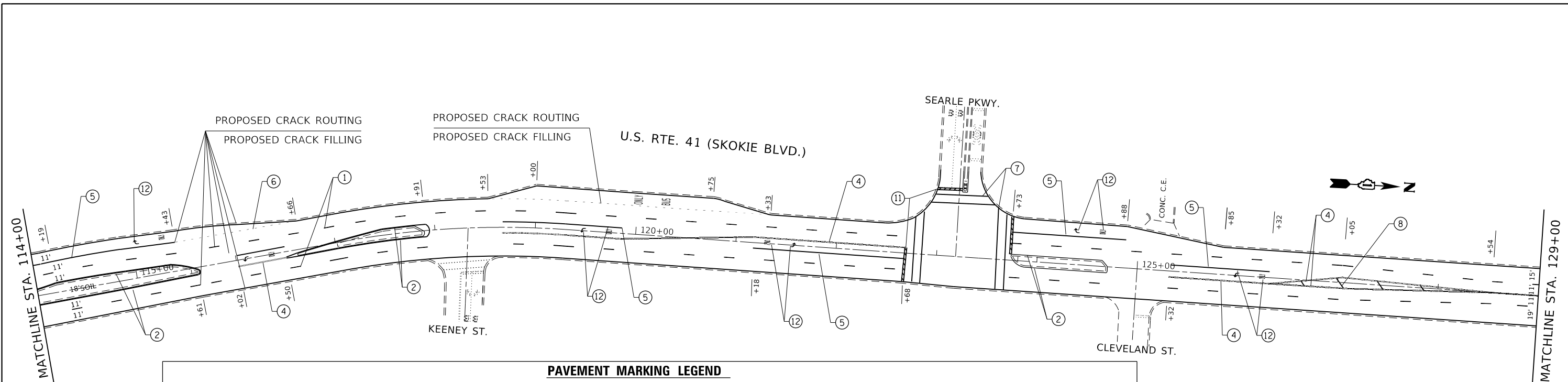

PAVEMENT MARKING LEGEND

<p>① PROP. MODIFIED URETHANE PAVEMENT MARKING LINE, 4" SKIP DASH WHITE LANE LINE @ 30' SKIP & 10' DASH</p> <p>② PROP. MODIFIED URETHANE PAVEMENT MARKING LINE, 4" SOLID YELLOW LINE</p> <p>③ PROP. MODIFIED URETHANE PAVEMENT MARKING LINE, 4" SKIP DASH YELLOW LINE @ 30' SKIP & 10' DASH</p> <p>④ PROP. MODIFIED URETHANE PAVEMENT MARKING LINE, 4" DOUBLE SOLID YELLOW LINE, 2 @ 11" C-C</p>	<p>⑤ PROP. MODIFIED URETHANE PAVEMENT MARKING LINE, 6" SOLID WHITE TURN LANE</p> <p>⑥ PROP. MODIFIED URETHANE PAVEMENT MARKING LINE, 6" SKIP DASH WHITE TURN LANE @ 6' SKIP & 2' DASH</p> <p>⑦ PROP. MODIFIED URETHANE PAVEMENT MARKING LINE, 6" SOLID WHITE CROSSWALK LINE, 2 @ 6' C-C</p> <p>⑧ PROP. MODIFIED URETHANE PAVEMENT MARKING LINE, 12" DIAGONAL SOLID YELLOW LINE @ 75' SPACING OR 5 MIN.</p>	<p>⑨ PROP. MODIFIED URETHANE PAVEMENT MARKING LINE, 12" SOLID WHITE LONGITUDINAL BAR @ 90°, 2' SPACING</p> <p>⑩ PROP. MODIFIED URETHANE PAVEMENT MARKING LINE, 24" SOLID WHITE TRANSVERSE LINE</p> <p>⑪ PROP. MODIFIED URETHANE PAVEMENT MARKING LINE, 24" SOLID WHITE STOP BAR</p> <p>⑫ PROP. MODIFIED URETHANE PAVEMENT MARKING LETTERS & SYMBOLS, SOLID WHITE</p>
---	--	--

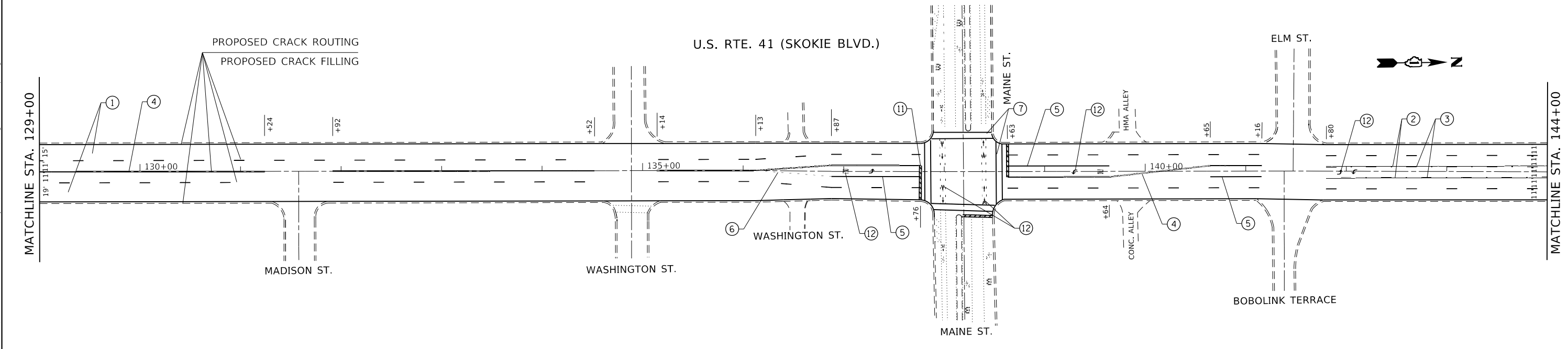

MODEL: Default
 FILE: h:\mhc\p\pub\planroom.dwg
 PROJECT: I:\Projects\151820\CADD\Drawings\DOT\Office\Drawings\151820-sh-4-lan.dwg

USER NAME = shirani	DESIGNED -	REVISED -
PLOT SCALE = 100.0000' / in.	DRAWN -	REVISED -
PLOT DATE = 6/2/2020	CHECKED -	REVISED -
	DATE -	REVISED -

**STATE OF ILLINOIS
DEPARTMENT OF TRANSPORTATION**

ROADWAY PLAN IL RTE. 50 /US RTE. 41 (SKOKIE BLVD.) NORTH OF GOLF RD. TO TOUGHY AVE.			
SCALE: 1"=50'	SHEET	OF	SHEETS
	STA. 114+00		TO STA. 144+00

F.A.P. RTE. 350	SECTION 2020-118-I	COUNTY COOK	TOTAL SHEETS 16	SHEET NO. 6
			CONTRACT NO. 62L96	
ILLINOIS FED. AID PROJECT				

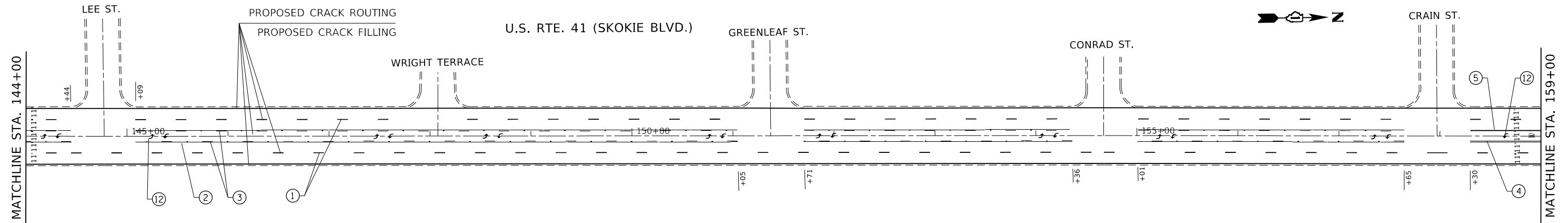

PAVEMENT MARKING LEGEND

- | | | |
|---|--|--|
| <p>① PROP. MODIFIED URETHANE PAVEMENT MARKING LINE, 4" SKIP DASH WHITE LANE LINE @ 30' SKIP & 10' DASH</p> <p>② PROP. MODIFIED URETHANE PAVEMENT MARKING LINE, 4" SOLID YELLOW LINE</p> <p>③ PROP. MODIFIED URETHANE PAVEMENT MARKING LINE, 4" SKIP DASH YELLOW LINE @ 30' SKIP & 10' DASH</p> <p>④ PROP. MODIFIED URETHANE PAVEMENT MARKING LINE, 4" DOUBLE SOLID YELLOW LINE, 2 @ 11" C-C</p> | <p>⑤ PROP. MODIFIED URETHANE PAVEMENT MARKING LINE, 6" SOLID WHITE TURN LANE</p> <p>⑥ PROP. MODIFIED URETHANE PAVEMENT MARKING LINE, 6" SKIP DASH WHITE TURN LANE @ 6' SKIP & 2' DASH</p> <p>⑦ PROP. MODIFIED URETHANE PAVEMENT MARKING LINE, 6" SOLID WHITE CROSSWALK LINE, 2 @ 6' C-C</p> <p>⑧ PROP. MODIFIED URETHANE PAVEMENT MARKING LINE, 12" DIAGONAL SOLID YELLOW LINE @ 75' SPACING OR 5 MIN.</p> | <p>⑨ PROP. MODIFIED URETHANE PAVEMENT MARKING LINE, 12" SOLID WHITE LONGITUDINAL BAR @ 90°, 2' SPACING</p> <p>⑩ PROP. MODIFIED URETHANE PAVEMENT MARKING LINE, 24" SOLID WHITE TRANSVERSE LINE</p> <p>⑪ PROP. MODIFIED URETHANE PAVEMENT MARKING LINE, 24" SOLID WHITE STOP BAR</p> <p>⑫ PROP. MODIFIED URETHANE PAVEMENT MARKING LETTERS & SYMBOLS, SOLID WHITE</p> |
|---|--|--|

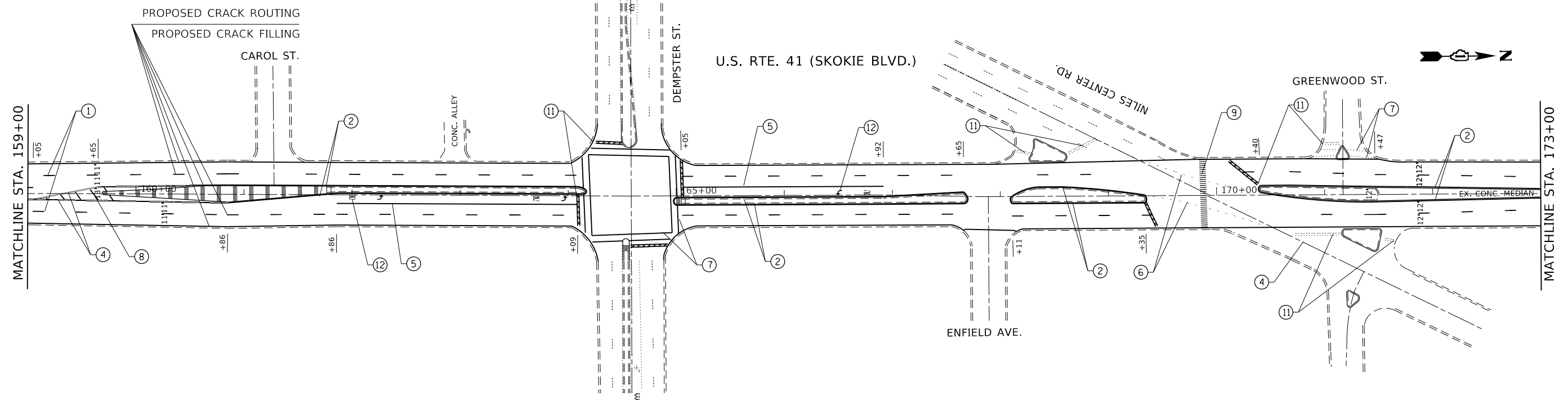

MODEL: Default
 FILE: Model_Plan_PlanRoom.dwg
 PROJECT: I:\Projects\151820\CD\Drawings\DOT\Office\Drawings\151820-sh-eb-01.dwg

USER NAME = shiraniib	DESIGNED -	REVISED -
PLOT SCALE = 100.0000' / in.	DRAWN -	REVISED -
PLOT DATE = 6/2/2020	CHECKED -	REVISED -
	DATE -	REVISED -

**STATE OF ILLINOIS
DEPARTMENT OF TRANSPORTATION**

**ROADWAY PLAN IL RTE. 50 /US RTE. 41 (SKOKIE BLVD.)
NORTH OF GOLF RD. TO TOUGHY AVE.**

SCALE: 1"=50' SHEET OF SHEETS STA. 144+00 TO STA. 173+00

F.A.P. RTE. 350	SECTION 2020-118-I	COUNTY COOK	TOTAL SHEETS 16	SHEET NO. 7
CONTRACT NO. 62L96			ILLINOIS FED. AID PROJECT	

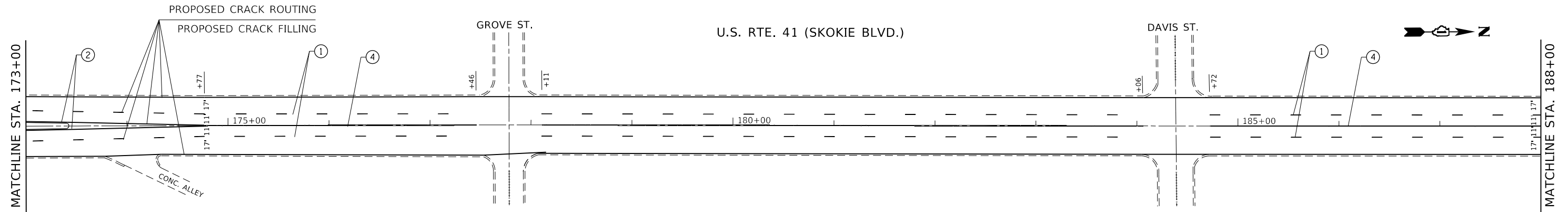

PAVEMENT MARKING LEGEND

- | | | |
|---|---|---|
| ① PROP. MODIFIED URETHANE PAVEMENT MARKING LINE, 4" SKIP DASH WHITE LANE LINE @ 30' SKIP & 10' DASH | ⑤ PROP. MODIFIED URETHANE PAVEMENT MARKING LINE, 6" SOLID WHITE TURN LANE | ⑨ PROP. MODIFIED URETHANE PAVEMENT MARKING LINE, 12" SOLID WHITE LONGITUDINAL BAR @ 90°, 2' SPACING |
| ② PROP. MODIFIED URETHANE PAVEMENT MARKING LINE, 4" SOLID YELLOW LINE | ⑥ PROP. MODIFIED URETHANE PAVEMENT MARKING LINE, 6" SKIP DASH WHITE TURN LANE @ 6' SKIP & 2' DASH | ⑩ PROP. MODIFIED URETHANE PAVEMENT MARKING LINE, 24" SOLID WHITE TRANSVERSE LINE |
| ③ PROP. MODIFIED URETHANE PAVEMENT MARKING LINE, 4" SKIP DASH YELLOW LINE @ 30' SKIP & 10' DASH | ⑦ PROP. MODIFIED URETHANE PAVEMENT MARKING LINE, 6" SOLID WHITE CROSSWALK LINE, 2 @ 6' C-C | ⑪ PROP. MODIFIED URETHANE PAVEMENT MARKING LINE, 24" SOLID WHITE STOP BAR |
| ④ PROP. MODIFIED URETHANE PAVEMENT MARKING LINE, 4" DOUBLE SOLID YELLOW LINE, 2 @ 11" C-C | ⑧ PROP. MODIFIED URETHANE PAVEMENT MARKING LINE, 12" DIAGONAL SOLID YELLOW LINE @ 75' SPACING OR 5 MIN. | ⑫ PROP. MODIFIED URETHANE PAVEMENT MARKING LETTERS & SYMBOLS, SOLID WHITE |

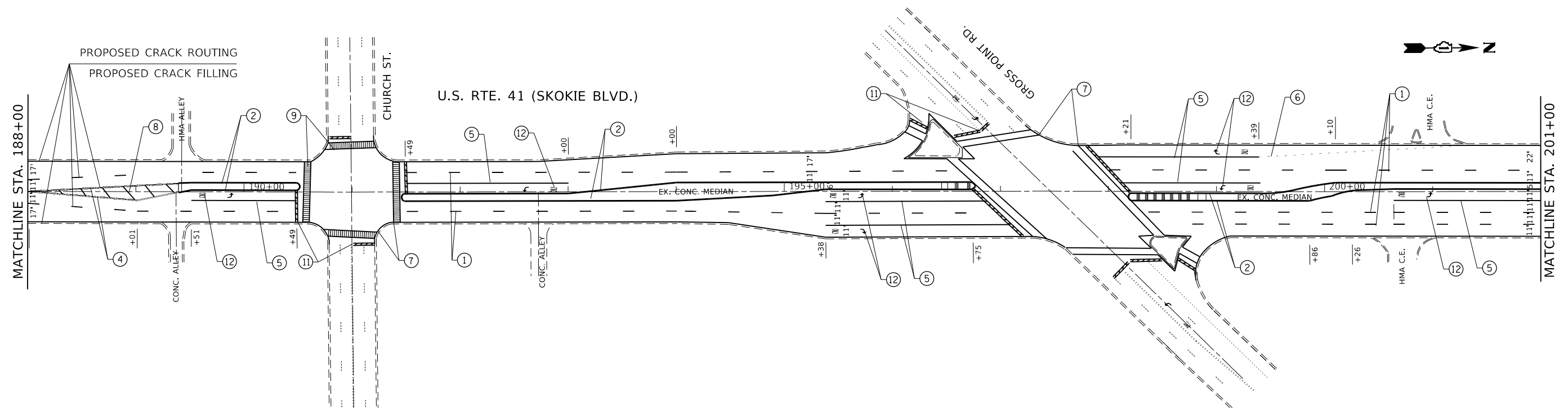

MODEL: Default
 FILE: h:\m\c\proj\pub\barroom.dwg
 PROJECT: 151820\CADD\Drawings\DOT - Offices\Drawings\151820-eh-1b-01.dwg

USER NAME = shirani	DESIGNED -	REVISED -
	DRAWN -	REVISED -
PLOT SCALE = 100,0000' / in.	CHECKED -	REVISED -
PLOT DATE = 6/2/2020	DATE -	REVISED -

**STATE OF ILLINOIS
DEPARTMENT OF TRANSPORTATION**

**ROADWAY PLAN IL RTE. 50 /US RTE. 41 (SKOKIE BLVD.)
NORTH OF GOLF RD. TO TOUGHY AVE.**

SCALE: 1"=50' SHEET OF SHEETS STA. 173+00 TO STA. 201+00

F.A.P. RTE. 350	SECTION 2020-118-I	COUNTY COOK	TOTAL SHEETS 16	SHEET NO. 8
CONTRACT NO. 62L96			ILLINOIS FED. AID PROJECT	

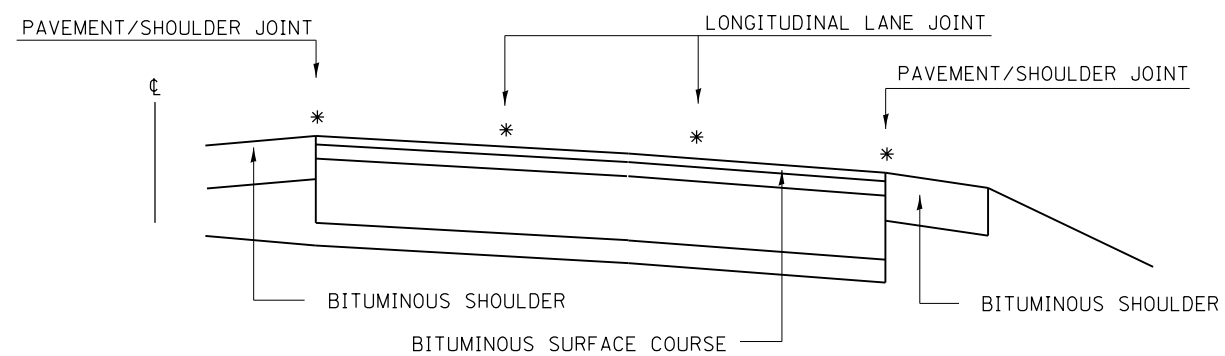

MULTI-LANE DIVIDED PAVEMENT

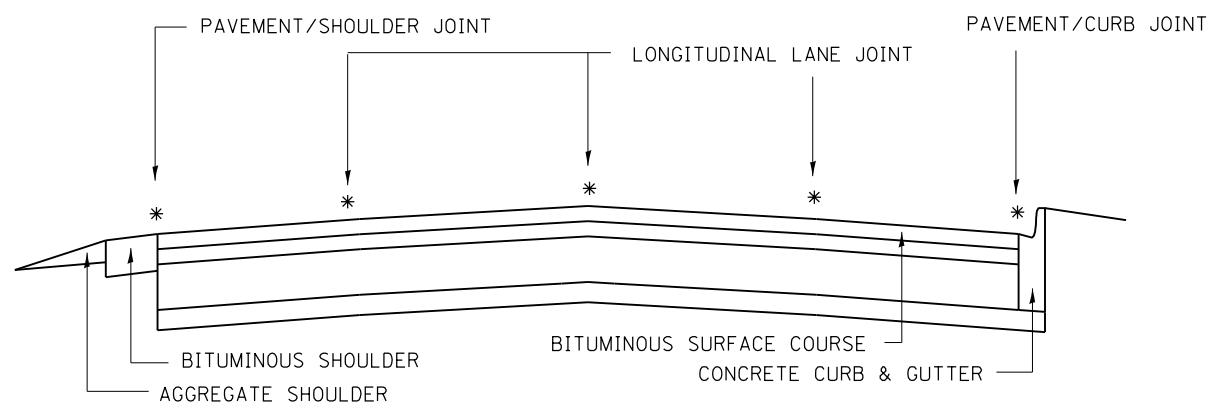

MULTI-LANE UNDIVIDED PAVEMENT

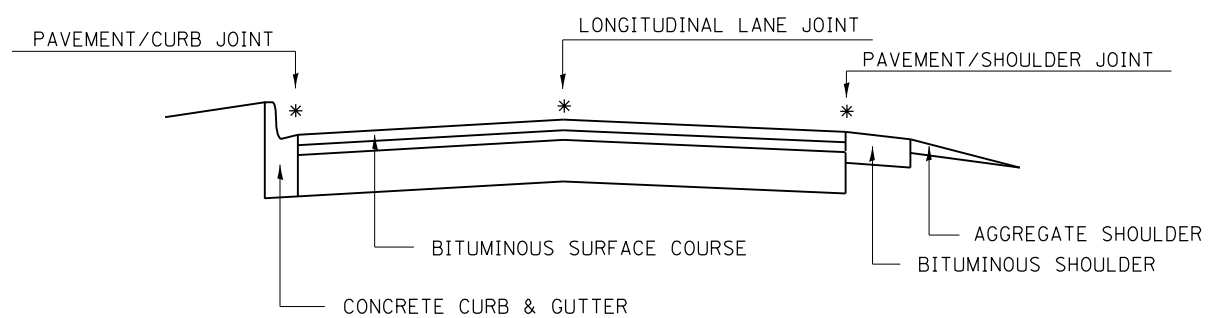

TWO-LANE PAVEMENT

PROPOSED TRANSVERSE CRACK ROUTING (PAVEMENT) & CRACK FILLING LOCATIONS NOT SHOWN

* PROPOSED LONGITUDINAL CRACK ROUTING (PAVEMENT) & CRACK FILLING LOCATIONS

GENERAL EXISTING TYPICAL SECTIONS

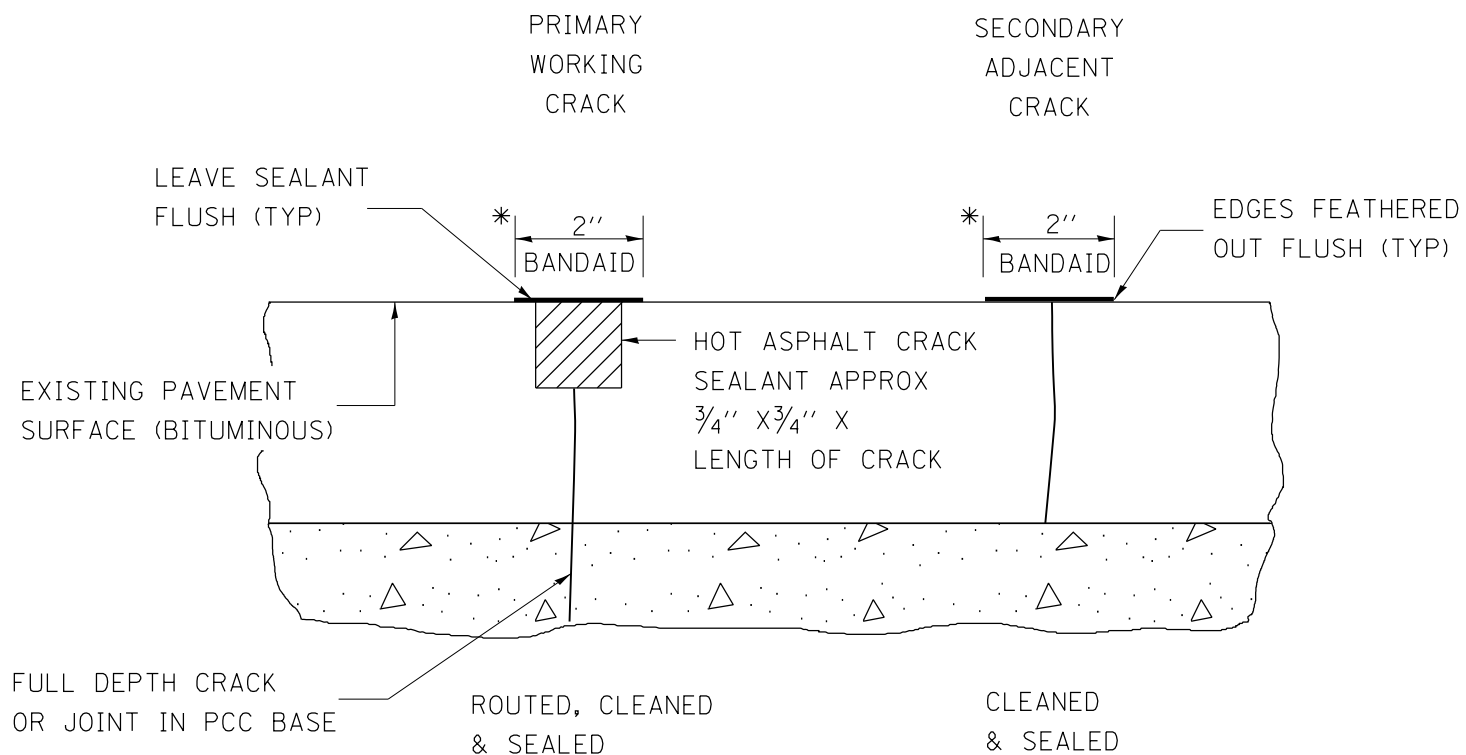

*

IN ALL LOCATIONS WHERE THE LONGITUDINAL CRACK CONFLICTS WITH EXISTING PAVEMENT MARKINGS (EITHER EDGE LINE OR LANE LINE) THE CRACK SHALL BE ROUTED & THE RESULTING RESERVOIR FILLED WITH SEALANT. ALL DAMAGES TO EXISTING RAISED REFLECTIVE PAVEMENT MARKERS SHALL BE REPLACED AT THE EXPENSE OF THE CONTRACTOR. ALL EXISTING PAVEMENT MARKINGS WITHIN THE PROJECT LIMITS SHALL BE RESTORED WITH MODIFIED URETHANE PAVEMENT MARKINGS.

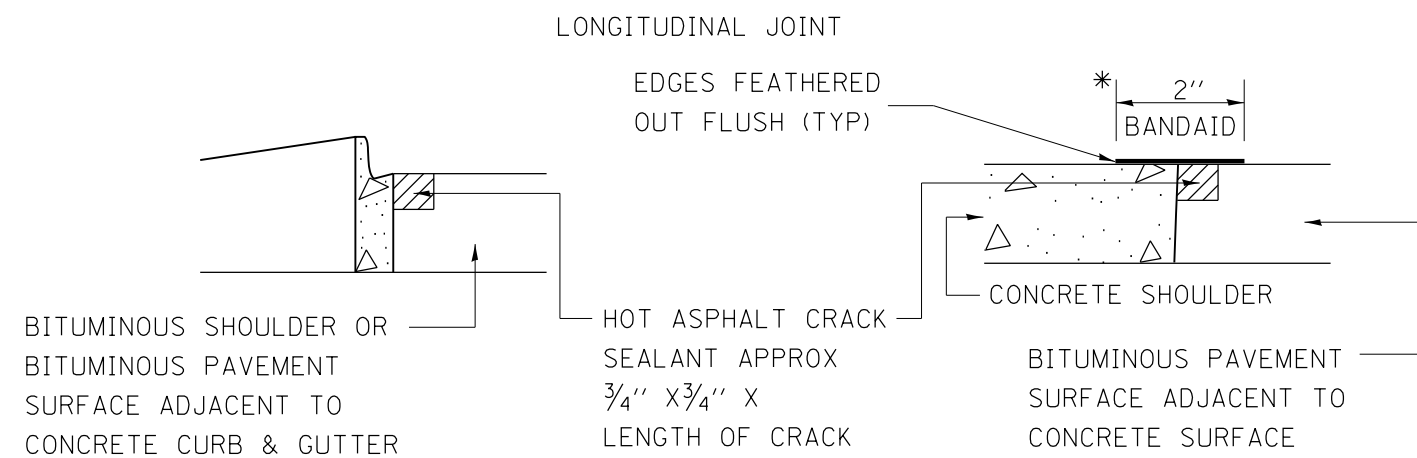

CRACK & JOINT SEALING DETAIL

FILE NAME = D151820-sh1-plen.dgn	USER NAME = shiranisb	DESIGNED -	REVISED -
		DRAWN -	REVISED -
	PLOT SCALE = 100.0000' / in.	CHECKED -	REVISED -
	PLOT DATE = 6/2/2020	DATE -	REVISED -

STATE OF ILLINOIS
DEPARTMENT OF TRANSPORTATION

IL 50 /US 41 (SKOKIE BLVD.) NORTH OF GOLF RD. TO TOUGHY AVE.
CRACK & JOINT SEALING DETAIL

SCALE: SHEET NO. OF SHEETS STA. TO STA.

F.A.P. RTE. 350	SECTION 2020-118-I	COUNTY COOK	TOTAL SHEETS 16	SHEET NO. 10
CONTRACT NO. 62L96				
ILLINOIS FED. AID PROJECT				

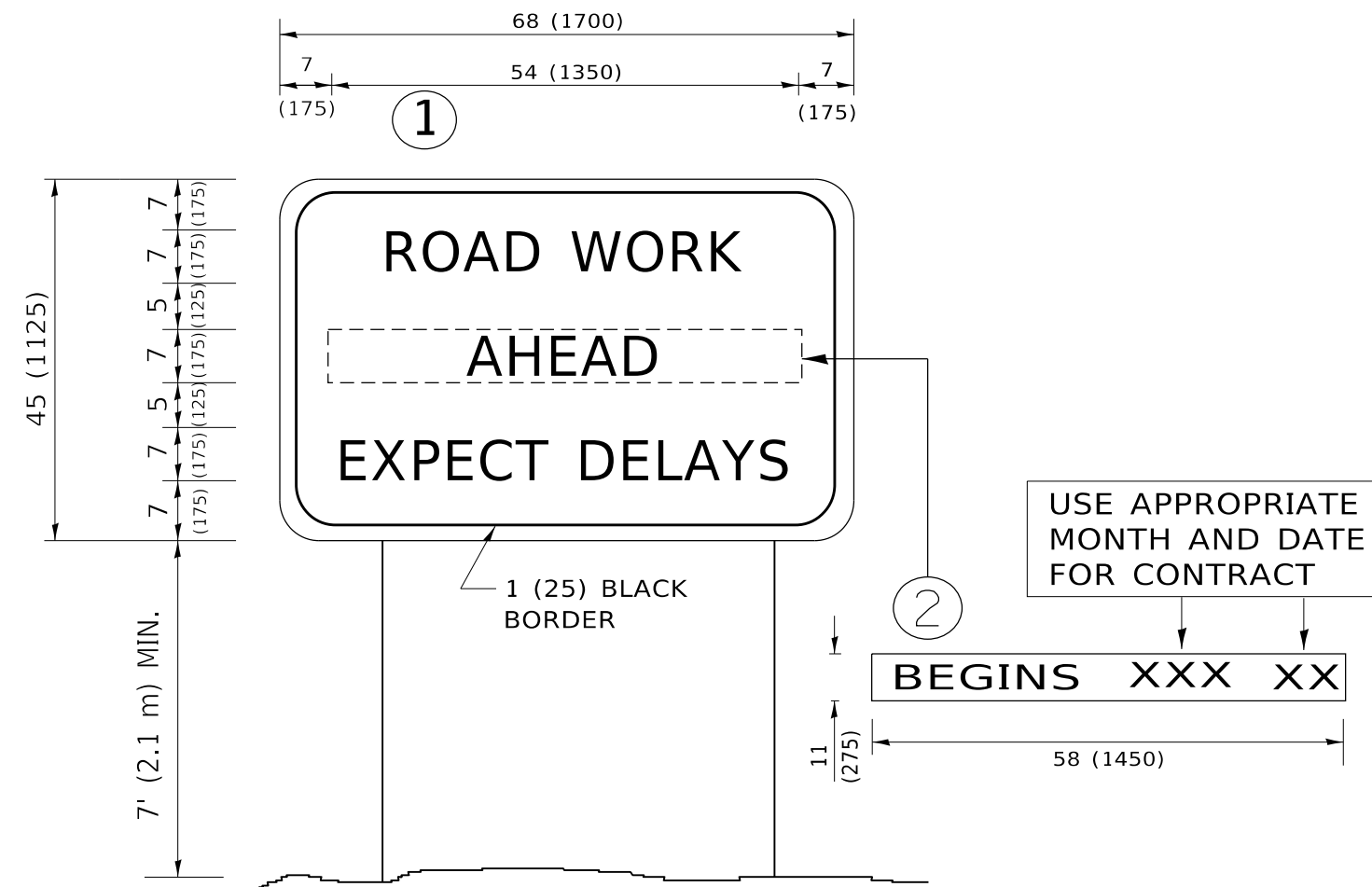

NOTES:

1. USE BLACK LETTERING ON ORANGE BACKGROUND.
2. ERECT SIGNS IN ADVANCE OF THE LOCATION FOR THE "ROAD CONSTRUCTION AHEAD" SIGN AT LOCATIONS AS DIRECTED BY THE ENGINEER.
3. ERECT SIGN ① WITH INSTALLED PANEL ② ONE WEEK PRIOR TO THE START OF CONSTRUCTION.
4. REMOVE PANEL ② SOON AFTER THE START OF CONSTRUCTION.
5. SEE SPECIAL PROVISION FOR "TEMPORARY INFORMATION SIGNING" FOR ADDITIONAL INFORMATION.
6. ONE SIGN ASSEMBLY EQUALS 25.70 SQ. FT. (2.3 SQ. M.)
7. SHALL BE PAID FOR AS TEMPORARY INFORMATION SIGNING.

ALL DIMENSIONS ARE IN INCHES (MILLIMETERS) UNLESS OTHERWISE SHOWN.

MODEL: Default
 FILE: \\nashville-prod\planroom\ad\illinois.gov\PWIDOT\Documents\IDOT_Offices\IDOT\1\Projects\151820\CADD\Drawings\Design\DESIGN.dgn

USER NAME = shiraniib	DESIGNED -	REVISED - R. MIRS 09-15-97
	DRAWN -	REVISED - R. MIRS 12-11-97
PLOT SCALE = 100.0000 ' / in.	CHECKED -	REVISED - T. RAMMACHER 02-02-99
PLOT DATE = 6/2/2020	DATE -	REVISED - C. JUCIUS 01-31-07

**STATE OF ILLINOIS
DEPARTMENT OF TRANSPORTATION**

**ARTERIAL ROAD
INFORMATION SIGN**

SCALE: NONE SHEET 1 OF 1 SHEETS STA. TO STA.

F.A.P. RTE.	SECTION	COUNTY	TOTAL SHEETS	SHEET NO.
350	2020-118-I	COOK	16	14
TC-22			CONTRACT NO. 62L96	
ILLINOIS FED. AID PROJECT				

TYPICAL SUPPLEMENTAL SIGNING AND PAVEMENT MARKING TREATMENT FOR RAILROAD CROSSINGS

WITH SIGNALIZED INTERSECTION

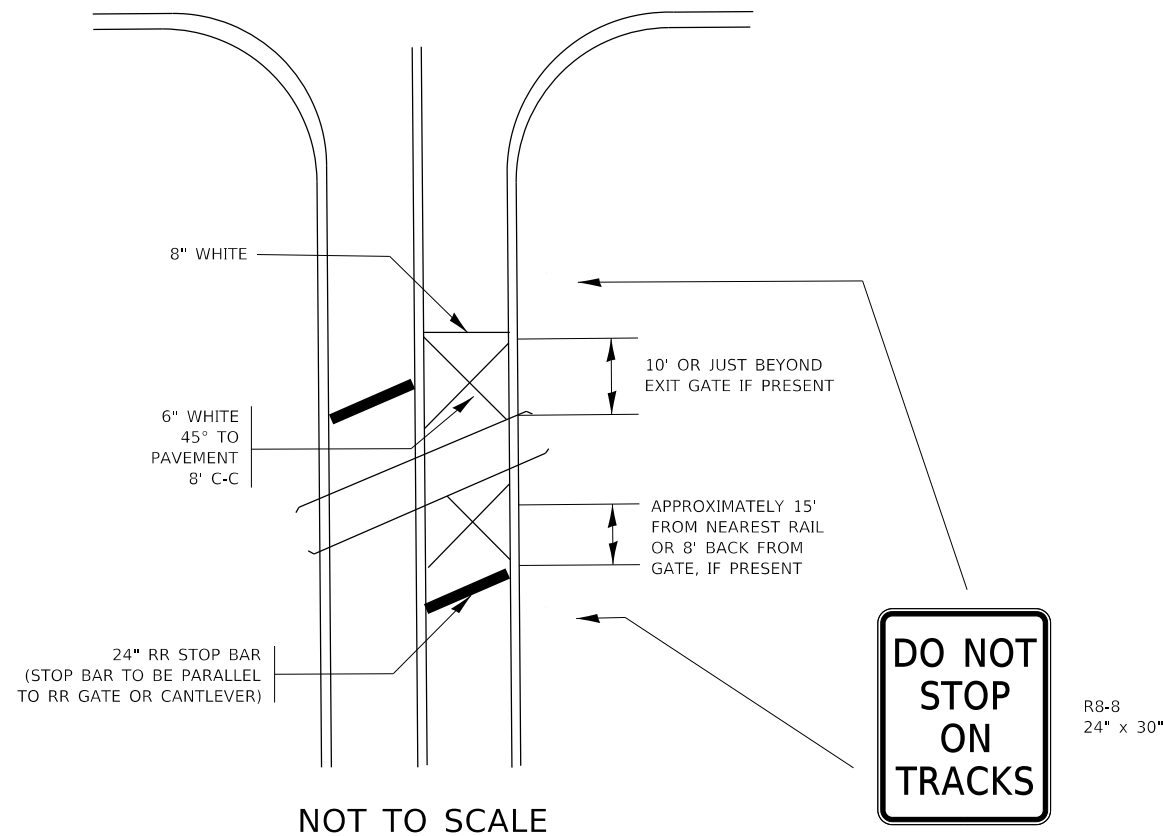

NOTE:

- PAVEMENT MARKINGS TO BE INSTALLED ONLY ON APPROACHES TO INTERSECTIONS CONTROLLED BY TRAFFIC SIGNALS WHICH ARE INTERCONNECTED WITH THE RAILROAD WARNING SIGNALS.
- WHERE NEAR-SIDE TRAFFIC SIGNALS ARE USED THE PAVEMENT MARKINGS EXTEND TO THE INTERSECTION. (SEE DETAIL FOR PRE-SIGNALS).

WITH NON-SIGNALIZED INTERSECTION 81' OR LESS TO CLOSEST RAIL

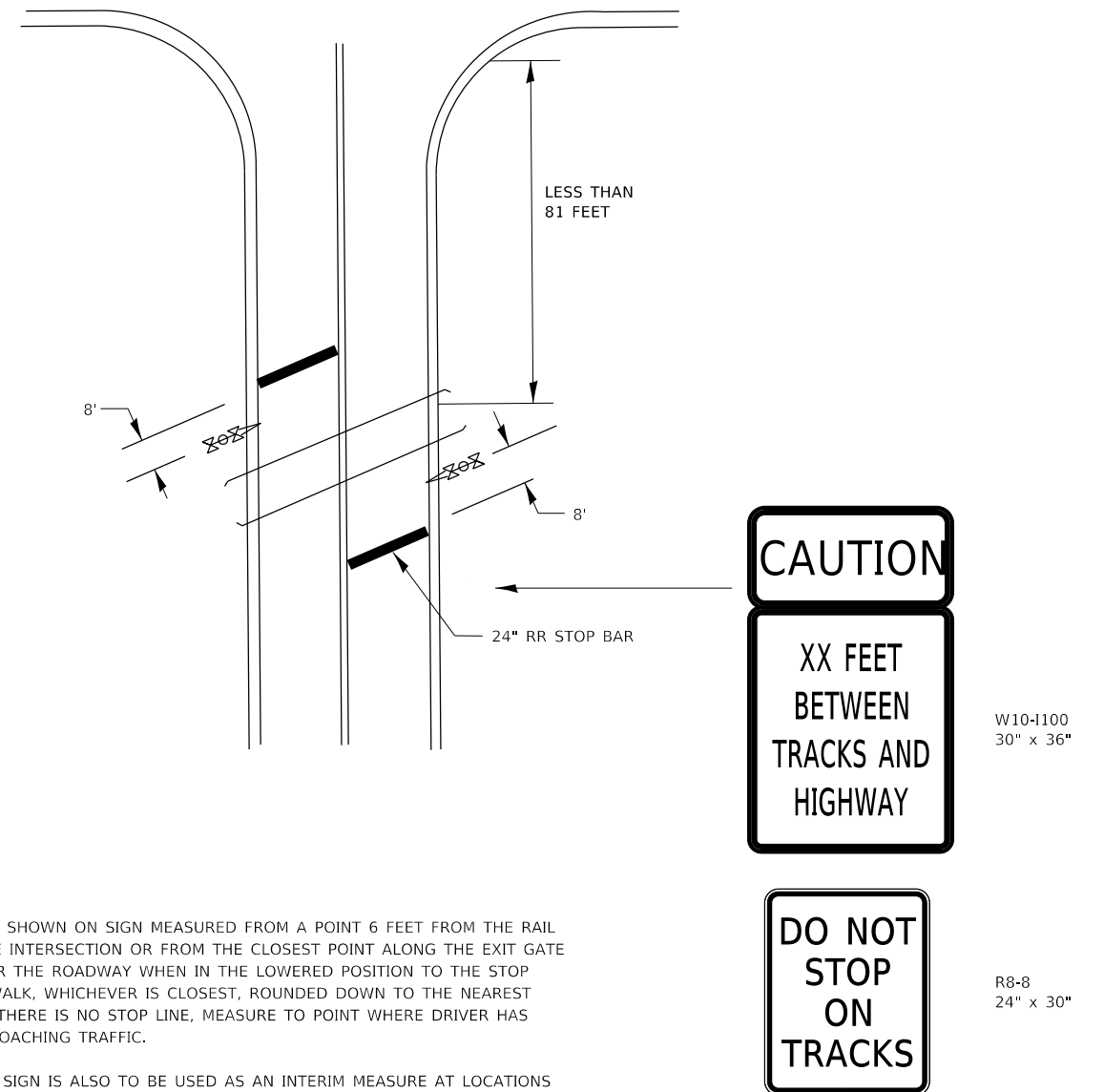

NOTE:

- DISTANCE TO BE SHOWN ON SIGN MEASURED FROM A POINT 6 FEET FROM THE RAIL CLOSEST TO THE INTERSECTION OR FROM THE CLOSEST POINT ALONG THE EXIT GATE IF PRESENT OVER THE ROADWAY WHEN IN THE LOWERED POSITION TO THE STOP BAR OR CROSSWALK, WHICHEVER IS CLOSEST, ROUNDED DOWN TO THE NEAREST 5 FEET. WHERE THERE IS NO STOP LINE, MEASURE TO POINT WHERE DRIVER HAS A VIEW OF APPROACHING TRAFFIC.
- THE CLEARANCE SIGN IS ALSO TO BE USED AS AN INTERIM MEASURE AT LOCATIONS WITH INTERCONNECTED INTERSECTION TRAFFIC SIGNALS WHERE IT IS PLANNED TO CHANGE THEM TO NEAR-SIDE SIGNALS AT A FUTURE TIME. IN THIS CASE, THE DISTANCE TO BE SHOWN ON THE SIGN IS MEASURED FROM THE EDGE OF THE STRIPED-OUT AREA INSTEAD OF 6 FEET FROM THE RAIL. THE SIGN IS TO BE REMOVED WHEN THE NEAR-SIDE SIGNALS ARE INSTALLED AND THE PAVEMENT MARKING EXTEND TO THE INTERSECTION.

ALL DIMENSIONS ARE IN INCHES (MILLIMETERS)
UNLESS OTHERWISE SHOWN.

MODEL: Default
FILE: Model: P:\pub\baronm.dwg
PROJECT: 151820\CADD\Drawings\Design\DRS4.dwg

USER NAME = shiraniib	DESIGNED -	REVISED -
	DRAWN -	REVISED -
PLOT SCALE = 100.0000' / in.	CHECKED -	REVISED -
PLOT DATE = 6/2/2020	DATE -	REVISED -

STATE OF ILLINOIS
DEPARTMENT OF TRANSPORTATION

TYPICAL SUPPLEMENTAL SIGNING AND PAVEMENT MARKING
TREATMENT FOR RAILROAD CROSSINGS

SCALE: NONE SHEET 2 OF 2 SHEETS STA. TO STA.

F.A.P. RTE.	SECTION	COUNTY	TOTAL SHEETS	SHEET NO.
350	2020-118-I	COOK	16	16
TC-23			CONTRACT NO. 62L96	
ILLINOIS FED. AID PROJECT				