

**INDEX OF SHEETS**

09-18-2020 LETTING ITEM 056

SHEET NO.	DESCRIPTION
1	COVER SHEET
2	SUMMARY OF QUANTITIES, GENERAL NOTES AND UTILITIES
3	TYPICAL SECTIONS
4	ALIGNMENTS, TIES AND BENCHMARKS
5	PLAN AND PROFILE - LINCOLN PRAIRIE TRAIL
6	PLAN AND PROFILE - TEMPORARY ACCESS ROAD (FOR INFORMATION ONLY)
7	SEEDING AND EROSION CONTROL PLAN
8	TIMBER BRIDGE APPROACH RAILING DETAILS
9 - 15	BRIDGE PLANS
16 - 20	CROSS SECTIONS

**STATE OF ILLINOIS  
DEPARTMENT OF TRANSPORTATION  
DIVISION OF HIGHWAYS**

**PLANS FOR PROPOSED ILLINOIS  
TRANSPORTATION ENHANCEMENT PROJECT  
LINCOLN PRAIRIE TRAIL  
BRIDGE REPLACEMENT**

**CITY OF PANA**

**SECTION 16-00054-00-BR  
PROJECT YA6Z(398)  
CHRISTIAN COUNTY  
C-96-215-17**

F.A. RTE.	SECTION	COUNTY	TOTAL SHEETS	SHEET NO.
	16-00054-00-BR	CHRISTIAN	20	1
FED. ROAD DIST. NO.	ILLINOIS	CONTRACT NO. 93750		

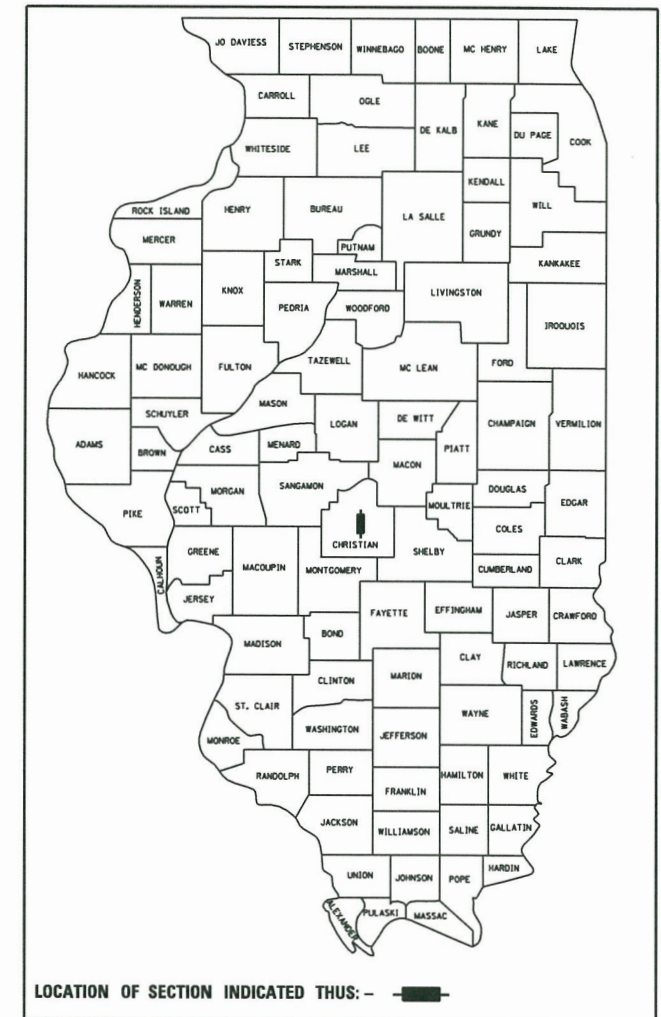

**STANDARDS**

- 280001-07 TEMPORARY EROSION CONTROL SYSTEMS
- 515001-04 NAME PLATES FOR BRIDGES
- 701001-02 OFF-RD OPERATIONS, 2L, 2W, MORE THAN 15' AWAY
- 701006-05 OFF-RD OPERATIONS, 2L, 2W, 15' TO 24" FROM PAVEMENT EDGE
- 701011-04 OFF-RD MOVING OPERATIONS, 2L, 2W, DAY ONLY
- 701201-05 LANE CLOSURE, 2L, 2W, DAY ONLY, FOR SPEEDS >= 45 MPH
- 701301-04 LANE CLOSURE, 2L, 2W, SHORT TIME OPERATIONS
- 701901-08 TRAFFIC CONTROL DEVICES
- BLR 21-9 TYPICAL APPLICATION OF TRAFFIC CONTROL DEVICES FOR CONSTRUCTION ON RURAL LOCAL HIGHWAYS

**UTILITIES**

SEE SHEET NO. 2 FOR LIST OF UTILITIES.

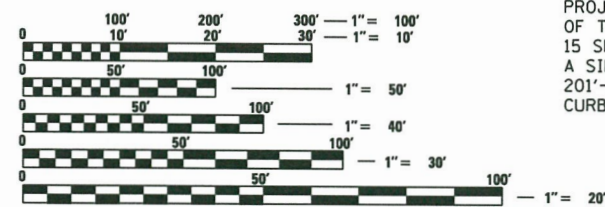

FULL SIZE PLANS HAVE BEEN PREPARED USING STANDARD ENGINEERING SCALES. REDUCED SIZED PLANS WILL NOT CONFORM TO STANDARD SCALES. IN MAKING MEASUREMENTS ON REDUCED PLANS, THE ABOVE SCALES MAY BE USED.

**J.U.L.I.E.**  
JOINT UTILITY LOCATION INFORMATION FOR EXCAVATION  
1-800-892-0123  
OR 811

**PROJECT ENGINEER  
PROJECT MANAGER**

**CONTRACT NO. 93750**

**PROJECT DESCRIPTION**

PROJECT CONSISTS OF THE REMOVAL AND REPLACEMENT OF THE EXISTING 182'-8" LONG, 9'-0" FACE TO FACE CURB, 15 SPAN WOODEN RAILROAD TRESTLE AND CONSTRUCTION OF A SINGLE SPAN STEEL PEDESTRIAN TRUSS SUPERSTRUCTURE, 201'-8" BACK TO BACK ABUTMENTS, 10'-0" FACE TO FACE CURBS ON PILE BENT SPILL-THRU ABUTMENTS.

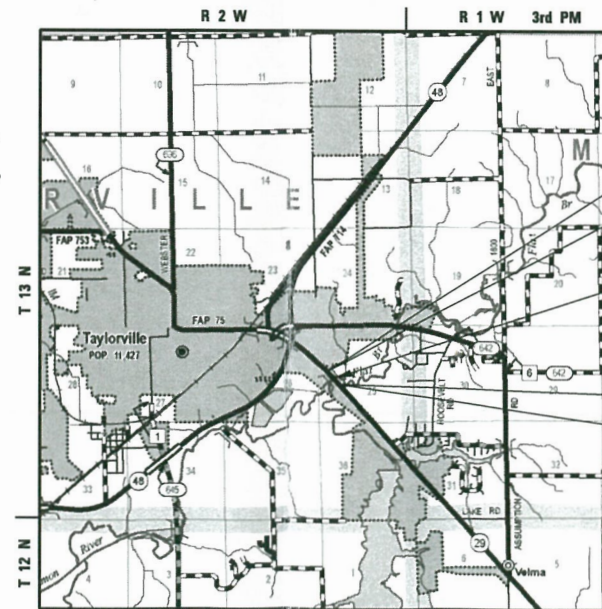
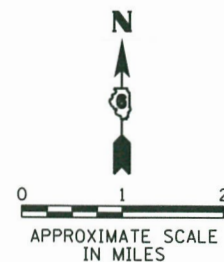

- STA. 8143+94.00  
END IMPROVEMENTS
- STA. 8142+18.00  
PROP. SN 011-P002  
PREFABRICATED  
PEDESTRIAN BRIDGE
- STA. 8140+42.00  
BEGIN IMPROVEMENTS

**LOCATION MAP**

NET LENGTH OF PROJECT = 352.00 FEET = 0.067 MILES

**DESIGN DESIGNATION**

MULTI-USE TRAIL  
DESIGN SPEED: NONE REQUIRED



EXPIRES: 11/30/2021

APPROVED: *Carol Krush* 20  
6/22/2020  
MAYOR

PASSED: *Julie Clark* 20  
20  
DISTRICT SIX ENGINEER OF LOCAL ROADS & STREETS

Releasing For Bid Based on Limited Review: *Julie Clark* 20  
20  
REGION FOUR ENGINEER

STATE OF ILLINOIS  
DEPARTMENT OF TRANSPORTATION

**PRINTED BY THE AUTHORITY  
OF THE STATE OF ILLINOIS**

COMPUTER FILE NO. 17022-sht-01-Cover.dgn PROJECT 17022 4/09/20 - MDS



KTCE PROJECT: 17022

**SUMMARY OF QUANTITIES**

ITEM NO.	ITEM	UNIT	TOTAL
20100110	TREE REMOVAL (6 TO 15 UNITS DIAMETER)	UNIT	222
20100210	TREE REMOVAL (OVER 15 UNITS DIAMETER)	UNIT	184
20300100	CHANNEL EXCAVATION	CU YD	79
28000250	TEMPORARY EROSION CONTROL SEEDING	POUND	20
28000400	PERIMETER EROSION BARRIER	FOOT	475
28100107	STONE RIPRAP, CLASS A4	SQ YD	798
28200200	FILTER FABRIC	SQ YD	798
35800100	PREPARATION OF BASE	SQ YD	146
35800200	AGGREGATE BASE REPAIR	TON	5
* 40201000	AGGREGATE FOR TEMPORARY ACCESS	TON	200
40600275	BITUMINOUS MATERIALS (PRIME COAT)	POUND	38
* 40604050	HOT-MIX ASPHALT SURFACE COURSE, IL-9.5, MIX "C", N50	TON	16
50100100	REMOVAL OF EXISTING STRUCTURES	EACH	1
50200100	STRUCTURE EXCAVATION	CU YD	95
50300225	CONCRETE STRUCTURES	CU YD	15.2
50300300	PROTECTIVE COAT	SQ YD	28.2
50301350	CONCRETE SUPERSTRUCTURE (APPROACH SLAB)	CU YD	9.4
50800205	REINFORCEMENT BARS, EPOXY COATED	POUND	3,760
51201600	FURNISHING STEEL PILES HP12X53	FOOT	120
51202305	DRIVING PILES	FOOT	120
51203600	TEST PILE STEEL HP12X53	EACH	2
51500100	NAME PLATES	EACH	1
52100520	ANCHOR BOLTS, 1"	EACH	8
58600101	GRANULAR BACKFILL FOR STRUCTURES	CU YD	43
58700300	CONCRETE SEALER	SQ FT	336
67100100	MOBILIZATION	L SUM	1
* X0322508	PEDESTRIAN TRUSS SUPERSTRUCTURE	SQ FT	2,000
* X2020410	EARTH EXCAVATION (SPECIAL)	CU YD	300
* X2501000	SEEDING, CLASS 2 (SPECIAL)	ACRE	0.4
* X4400196	HOT-MIX ASPHALT SURFACE REMOVAL, SPECIAL	SQ YD	185
* X4811300	AGGREGATE SHOULDERS, TYPE B (SPECIAL)	TON	11
* X7010216	TRAFFIC CONTROL AND PROTECTION, (SPECIAL)	L SUM	1

**SUMMARY OF QUANTITIES**

ITEM NO.	ITEM	UNIT	TOTAL
* XX008340	TIMBER BRIDGE APPROACH RAILING	FOOT	300
Z0013798	CONSTRUCTION LAYOUT	L SUM	1
* Z0015500	DEBRIS REMOVAL	L SUM	1
* Z0022810	FENCE REMOVAL (SPECIAL)	FOOT	300
* Z0064600	SELECTIVE CLEARING	ACRE	0.04

CONSTRUCTION CODE: 0028

- \* SPECIAL PROVISION
- # SPECIALTY ITEM

**HOT-MIX ASPHALT MIXTURE REQUIREMENTS**

ITEM	AGGREGATE COMPOSITION	ASPHALT GRADE	VOIDS
HMA SURFACE	IL-9.5, MIX "C"	PG 64-22	4.0% @ N50

**GENERAL NOTES**

- THIS PROJECT SHALL BE CONSTRUCTED IN ACCORDANCE WITH THESE PLANS, THE ILLINOIS DEPARTMENT OF TRANSPORTATION STANDARD SPECIFICATIONS FOR ROAD AND BRIDGE CONSTRUCTION, LATEST ADDITION (INCLUDING ALL ADDITIONS AND ADDENDA), AND THE STANDARD SPECIFICATIONS FOR WATER AND SEWER MAIN CONSTRUCTION IN ILLINOIS, LATEST EDITION. IN CASE OF CONFLICT, THE MORE RESTRICTIVE SPECIFICATIONS SHALL APPLY.
- WHEN SECTION OR SUB-SECTION MONUMENTS ARE ENCOUNTERED, THE ENGINEER SHALL BE NOTIFIED BEFORE SUCH MONUMENTS ARE REMOVED. THE CONTRACTOR SHALL PROTECT AND CAREFULLY PRESERVE ALL PROPERTY MARKS AND MONUMENTS UNTIL THE OWNER OR AN AUTHORIZED SURVEYOR OR AGENT HAS WITNESSED OR OTHERWISE REFERENCED THEIR LOCATION.
- THE CONTRACTOR SHALL TAKE REASONABLE PRECAUTIONS TO PROTECT PUBLIC AND PRIVATE PROPERTY. IF, AT ANY TIME, HE DAMAGES OR DESTROYS PUBLIC OR PRIVATE PROPERTY, THE CONTRACTOR SHALL, AT HIS OWN EXPENSE, RESTORE SUCH PROPERTY TO A CONDITION EQUAL TO THAT EXISTING BEFORE SUCH DAMAGE.
- THE CONTRACTOR SHALL BE RESPONSIBLE FOR PROVIDING A FINAL PRODUCT WHICH IS COMPLIANT WITH ALL LOCAL, STATE, AND FEDERAL AMERICANS WITH DISABILITIES ACT (A.D.A.) REQUIREMENTS. IF THE CONTRACTOR BELIEVES THAT CONSTRUCTION DOCUMENTS WILL PREVENT COMPLIANCE WITH A.D.A., HE SHALL IMMEDIATELY NOTIFY THE ENGINEER OF ANY DISCREPANCIES PRIOR TO CONSTRUCTION. FAILURE OF THE CONTRACTOR TO PERFORM DUE DILIGENCE WITH RESPECT TO A.D.A. REQUIREMENTS SHALL NOT RELIEVE THE CONTRACTOR FROM LIABILITY FOR THE SAME.
- THE OWNER WILL PROCURE ALL CONSTRUCTION PERMITS. THE CONTRACTOR SHALL GIVE ALL NOTICES NECESSARY AND INCIDENTAL TO THE DUE AND LAWFUL PROSECUTION OF THE WORK.
- THE CONTRACTOR SHALL FURNISH ALL CONSTRUCTION SIGNS AND BARRICADES AS REQUIRED.
- THE LOCATIONS OF THOSE BURIED AND ABOVEGROUND UTILITIES SHOWN ARE APPROXIMATE, ARE SHOWN FOR CONTRACTOR INFORMATION USE ONLY, AND ARE NOT TO BE REFERENCED FOR CONSTRUCTION PURPOSES. THE IMPLIED PRESENCE OR ABSENCE OF UTILITIES IS NOT TO BE CONSTRUED BY THE OWNER, ENGINEER, CONTRACTOR, OR SUBCONTRACTORS TO BE AN ACCURATE AND COMPLETE REPRESENTATION OF UTILITIES THAT MAY OR MAY NOT EXIST ON THE CONSTRUCTION SITE. BURIED AND ABOVEGROUND UTILITY LOCATION, IDENTIFICATION, AND MARKING ARE THE SOLE RESPONSIBILITY OF THE CONTRACTOR. REROUTING, DISCONNECTION, PROTECTION, ETC. OF ANY UTILITIES MUST BE COORDINATED BETWEEN THE CONTRACTOR, UTILITY COMPANY, AND OWNER. SITE SAFETY, INCLUDING THE AVOIDANCE OF HAZARDS ASSOCIATED WITH BURIED AND ABOVEGROUND UTILITIES, REMAINS THE SOLE RESPONSIBILITY OF THE CONTRACTOR. THE CONTRACTOR SHALL BE RESPONSIBLE FOR PROTECTING UTILITY PROPERTY FROM CONSTRUCTION OPERATIONS AS OUTLINED IN ARTICLE 107.39 OF THE STANDARD SPECIFICATIONS. CALL JULIE 1-800-892-0123 PRIOR TO CONSTRUCTION.
- SUMMARY OF QUANTITIES FOR MAJOR CONSTRUCTION ITEMS ARE INTENDED AS A GUIDE FOR THE CONTRACTOR TO DETERMINE THE SCOPE OF THE COMPLETED PROJECT. IT IS THE CONTRACTOR'S RESPONSIBILITY TO DETERMINE ALL QUANTITIES OF MATERIAL AND EQUIPMENT REQUIRED TO PROVIDE A COMPLETE PROJECT. NO CLAIMS FOR EXTRA WORK WILL BE RECOGNIZED DUE TO REASONABLE VARIATIONS IN THE QUANTITIES.
- ALL SURPLUS EXCAVATED MATERIAL AND SPOILS SHALL BE DISPOSED OF OFFSITE AT A LOCATION APPROVED BY THE ENGINEER AT NO ADDITIONAL COST TO THE CONTRACT.
- ALL SAWCUTS NECESSARY FOR THE CONSTRUCTION OF BUTT JOINTS SHALL BE TO THE FULL DEPTH OF THE ITEM TO REMOVED OR CONSTRUCTED (MINIMUM DEPTH 1-1/2"), AND SHALL BE INCLUDED IN THE COST OF THAT ITEM. NO ADDITIONAL COMPENSATION WILL BE ALLOWED.
- THE FOLLOWING APPLICATION RATES WERE USED IN THE DEVELOPMENT OF PLAN QUANTITIES:
 

HMA SURFACE COURSE	112 LBS / SQ YD / IN
BIT. MATERIALS (PRIME COAT)	0.25 LBS / SQ FT
COARSE AGGREGATE	2.05 TON / CU YD
RIPRAP	1.50 TON / CU YD

**UTILITIES**

NAME	CONTACT	PHONE	EMAIL	TYPE
AMEREN CIPS - (SOUTH)	NATHAN HILL	618-301-5327	NHILL2@AMEREN.COM	GAS/ELECTRIC
COMPUTER TECHNIQUES, INC.	ADAM VOCKS	217-824-6398		INTERNET
IL CONSOLIDATED TELEPHONE	WES CHAMBERS	217-235-3355	WES.CHAMBERS@CONSOLIDATED.COM	TELEPHONE
TAYLORVILLE, CITY OF	DAVID SPEAGLE	217-287-1441 217-820-7639	WATERSUPT@CTITECH.COM	WATER
BUCKEYE PARTNERS	DAVE JONES	610-904-4409	DAJONES@BUCKEYE.COM	PETROLEUM PIPELINE

**CITY OF PANA  
LINCOLN PRAIRIE TRAIL BRIDGE REPLACEMENT**

**SUMMARY OF QUANTITIES, GENERAL NOTES  
AND UTILITIES**

SCALE: 1"=20' SHEET NO. OF SHEETS STA. TO STA.

F.A. RTE.	SECTION	COUNTY	TOTAL SHEETS	SHEET NO.
	16-00054-00-BR	CHRISTIAN	20	2
CONTRACT NO. 93750				
ILLINOIS FED. AID PROJECT				

FILE NAME = J:\17022 Pano - Bike Trail Bridge\GDD\GDD\_Sheets\17022-sht-02-.S00.dgn  
 MODEL = \$MODEL\$  
 PLOT DRIVER = \$PLTDIV\$



USER NAME = msutheard	DESIGNED - MDS	REVISED -
FILE NAME = 17022-sht-02-.S00.dgn	DRAWN - MDS	REVISED -
PLOT SCALE = 40.0000' / 1in.	CHECKED - KLK	REVISED -
PLOT DATE = 6/17/2020	DATE - 6/17/20	REVISED -



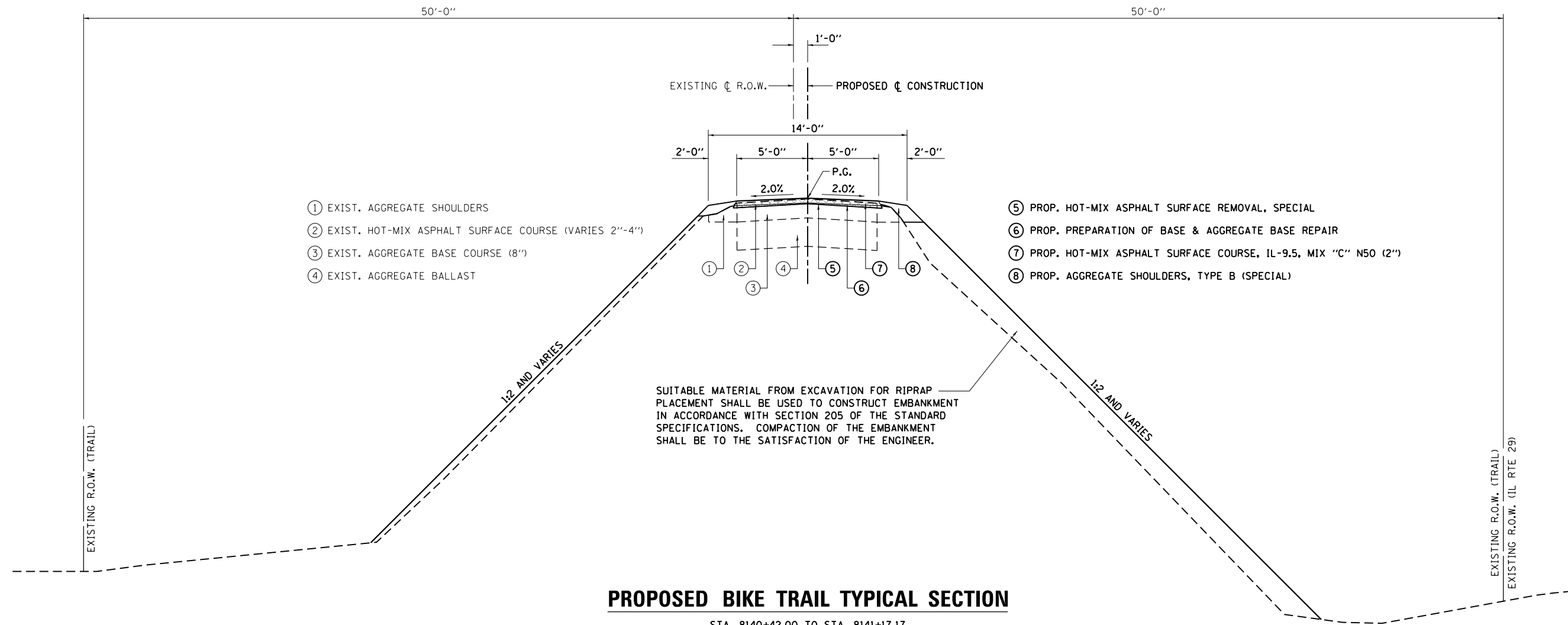

**PROPOSED BIKE TRAIL TYPICAL SECTION**

STA. 8140+42.00 TO STA. 8141+17.17  
 STA. 8143+18.83 TO STA. 8143+94.00

**FOR INFORMATION ONLY**

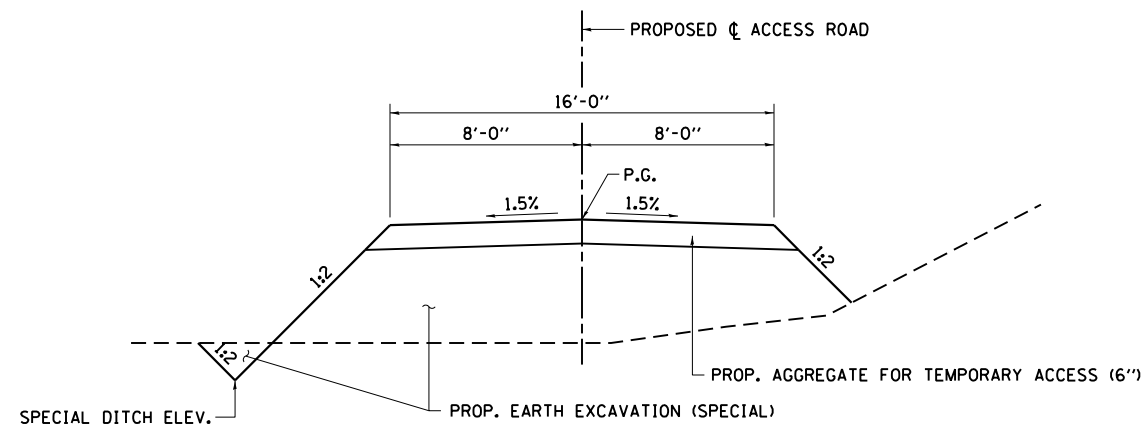

**PROPOSED TEMPORARY ACCESS ROAD TYPICAL SECTION**

STA. 10+00.00 TO STA. 12+74.57

THIS TYPICAL SECTION IS FOR INFORMATION ONLY. IT SHOWS AN EXAMPLE CROSS SECTION FOR A TEMPORARY ACCESS ROAD. THE CONTRACTOR SHALL DESIGN AND SUBMIT HIS/HER ACTUAL CONSTRUCTION PLAN TO THE ILLINOIS DEPARTMENT OF TRANSPORTATION AND THE ENGINEER FOR APPROVAL, PRIOR TO CONSTRUCTION. SEE SPECIAL PROVISIONS FOR MORE INFORMATION.

FILE NAME = J:\17022 Pana - Bike Trail Bridge\CADD\CADD Sheets\17022-sht-03\_Typical.dgn  
 MODEL = \$MODEL\$  
 PLOT DRIVER = \$PLTDRVS\$



USER NAME = msutheard	DESIGNED - MDS	REVISED -
FILE NAME = 17022-sht-03_Typical.dgn	DRAWN - MDS	REVISED -
PLOT SCALE = 40.0000' / in.	CHECKED - KLK	REVISED -
PLOT DATE = 6/17/2020	DATE - 6/17/20	REVISED -

**CITY OF PANA  
 LINCOLN PRAIRIE TRAIL BRIDGE REPLACEMENT**

**TYPICAL SECTIONS**

SCALE: SHEET NO. OF SHEETS STA. TO STA.

F.A. RTE.	SECTION	COUNTY	TOTAL SHEETS	SHEET NO.
	16-00054-00-BR	CHRISTIAN	20	3
CONTRACT NO. 93750				
ILLINOIS FED. AID PROJECT				

Beginning chain CLCONST description

Point X201 N 1,047,274.5720 E 2,552,240.7684 Sta 8115+00.00  
 Course from X201 to PC CLCONST-1 N 42° 19' 31.40" W Dist 2,910.5897

Curve Data  
 Curve CLCONST-1  
 P. I. Station = 8144+87.41 N 1,049,483.2628 E 2,550,229.2247  
 Delta = 3° 26' 42.39" (LT)  
 Degree = 2° 14' 34.70"  
 Tangent = 76.8210  
 Length = 153.5958  
 Radius = 2,554.4591  
 External = 1.1549  
 Long Chord = 153.5727  
 Mid. Ord. = 1.1543  
 P. C. Station = 8144+10.59 N 1,049,426.4665 E 2,550,280.9514  
 P. T. Station = 8145+64.19 N 1,049,536.8481 E 2,550,174.1784  
 C. C. = 8145+64.19 N 1,048,487.0627 E 2,549,152.2545  
 Back = N 42° 19' 31.40" W  
 Ahead = N 45° 46' 13.79" W  
 Chord Bear = N 44° 02' 52.60" W

Chain CLCONST description (continued)

Curve Data  
 Curve CLCONST-2  
 P. I. Station = 8148+72.40 N 1,049,751.8368 E 2,549,953.3284  
 Delta = 23° 45' 39.11" (LT)  
 Degree = 3° 54' 39.01"  
 Tangent = 308.2124  
 Length = 607.5650  
 Radius = 1,465.0522  
 External = 32.0693  
 Long Chord = 603.2206  
 Mid. Ord. = 31.3824  
 P. C. Station = 8145+64.19 N 1,049,536.8481 E 2,550,174.1784  
 P. T. Station = 8151+71.75 N 1,049,859.6170 E 2,549,664.5753  
 C. C. = 8151+71.75 N 1,048,487.0627 E 2,549,152.2545  
 Back = N 45° 46' 13.79" W  
 Ahead = N 69° 31' 52.91" W  
 Chord Bear = N 57° 39' 03.35" W

Beginning chain ACCESS3 description

Point X931 N 1,049,446.9547 E 2,550,327.4576 Sta 10+00.00  
 Course from X931 to X932 N 30° 05' 13.83" W Dist 285.9240  
 Point X932 N 1,049,694.3543 E 2,550,184.1190 Sta 12+85.92  
 Ending chain ACCESS3 description

Ending chain CLCONST description

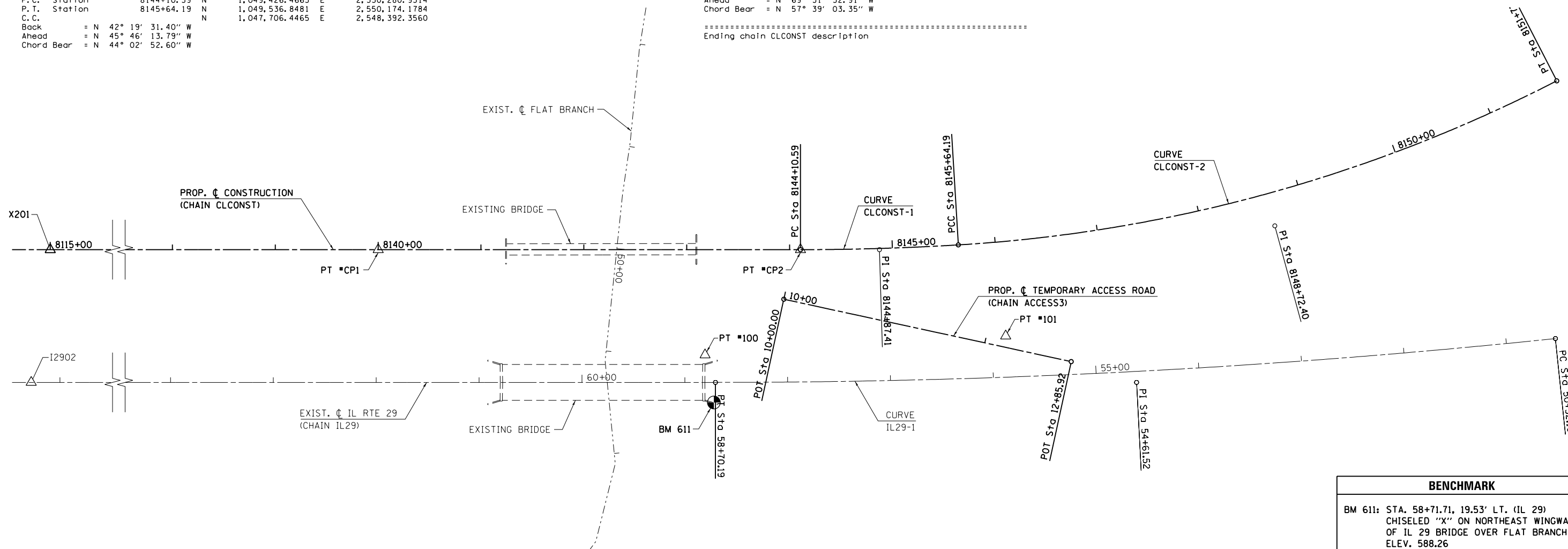

**BENCHMARK**  
 BM 611: STA. 58+71.71, 19.53' LT. (IL 29)  
 CHISELED "X" ON NORTHEAST WINGWALL  
 OF IL 29 BRIDGE OVER FLAT BRANCH  
 ELEV. 588.26

Beginning chain IL29 description

Curve Data  
 Curve IL29-1  
 P. I. Station = 54+61.52 N 1,049,754.9281 E 2,550,156.2898  
 Delta = 5° 58' 39.22" (RT)  
 Degree = 0° 43' 50.40"  
 Tangent = 409.4195  
 Length = 818.0961  
 Radius = 7,841.5670  
 External = 10.6809  
 Long Chord = 817.7251  
 Mid. Ord. = 10.6664  
 P. C. Station = 50+52.10 N 1,050,027.2706 E 2,549,850.5875  
 P. T. Station = 58+70.19 N 1,049,452.2309 E 2,550,431.9684  
 C. C. = 58+70.19 N 1,044,172.1886 E 2,544,634.4407  
 Back = S 48° 18' 10.62" E  
 Ahead = S 42° 19' 31.40" E  
 Chord Bear = S 45° 18' 51.01" E

Course from PT IL29-1 to I2902 S 42° 19' 31.40" E Dist 2,357.7001  
 Point I2902 N 1,047,709.1059 E 2,552,019.5026 Sta 82+27.89

Ending chain IL29 description

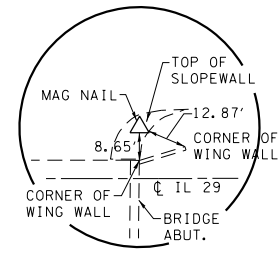

**POINT #100**  
**MAG NAIL**  
 STA. 58+80.28 (IL 29)  
 26.75' RT  
 N 1,049,426.7640  
 E 2,550,418.9850

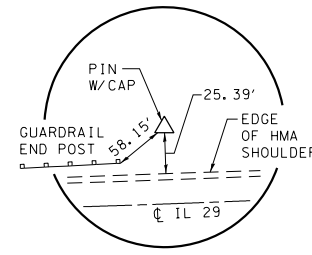

**POINT #101**  
**PIN W/CAP**  
 STA. 55+86.47 (IL 29)  
 40.01' RT  
 N 1,049,630.5010  
 E 2,550,208.5840

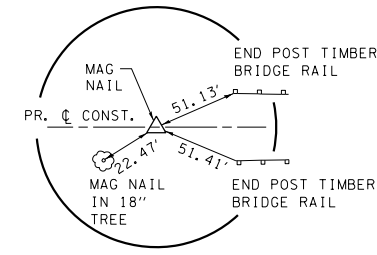

**POINT #CP1**  
**MAG NAIL**  
 POT STA. 8140+00.00  
 N 1,049,122.9040  
 E 2,550,557.4179

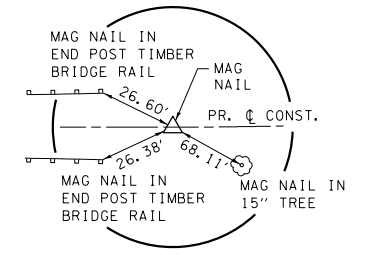

**POINT #CP2**  
**MAG NAIL**  
 PC STA. 8144+10.59,  
 N 1,049,426.4665  
 E 2,550,280.9514

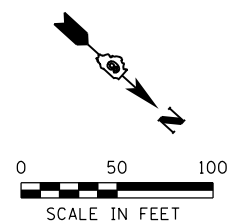

FILE NAME = J:\17022 Pana - Bike Trail Bridge\CADD\CADD Sheets\17022-sht-04-ATB.dgn  
 MODEL = \$MODEL\$  
 PLOT DRIVER = \$PLOTDRVS\$



USER NAME = msutheard	DESIGNED - MDS	REVISED -
FILE NAME = 17022-sht-04-ATB.dgn	DRAWN - MDS	REVISED -
PLOT SCALE = 100.0000' / 1in.	CHECKED - KLK	REVISED -
PLOT DATE = 6/17/2020	DATE - 6/17/20	REVISED -

**CITY OF PANA**  
**LINCOLN PRAIRIE TRAIL BRIDGE REPLACEMENT**

**ALIGNMENTS, TIES AND BENCHMARKS**

SCALE: 1"=50' SHEET NO. OF SHEETS STA. TO STA.

F.A. RTE.	SECTION	COUNTY	TOTAL SHEETS	SHEET NO.
	16-00054-00-BR	CHRISTIAN	20	4
CONTRACT NO. 93750				
ILLINOIS FED. AID PROJECT				

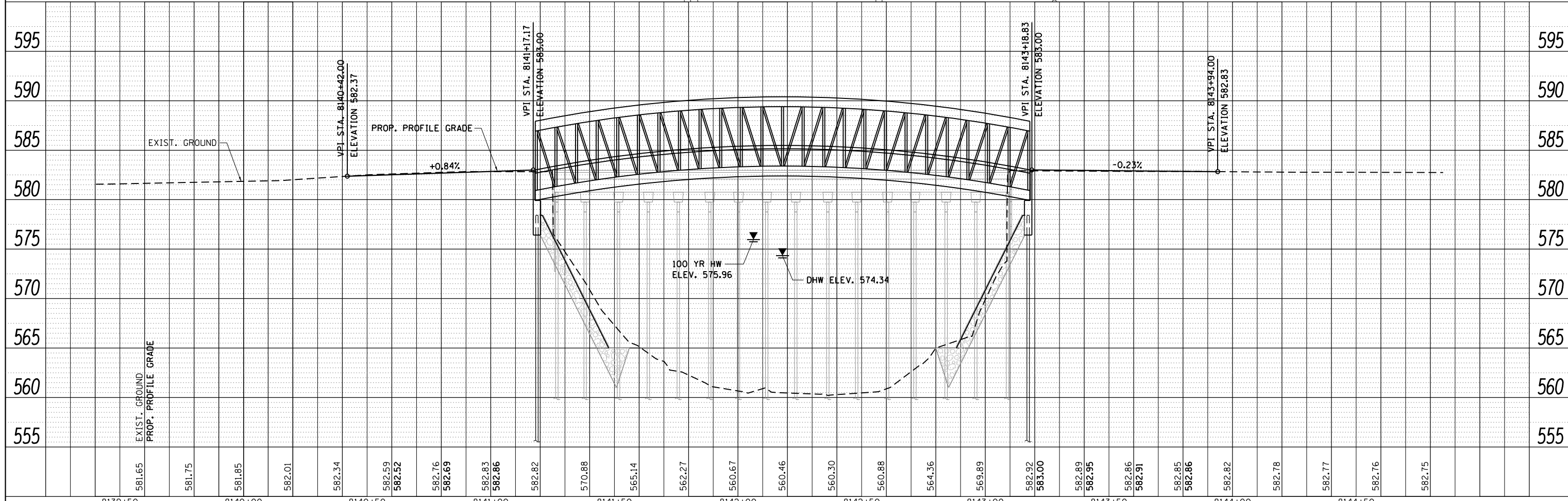
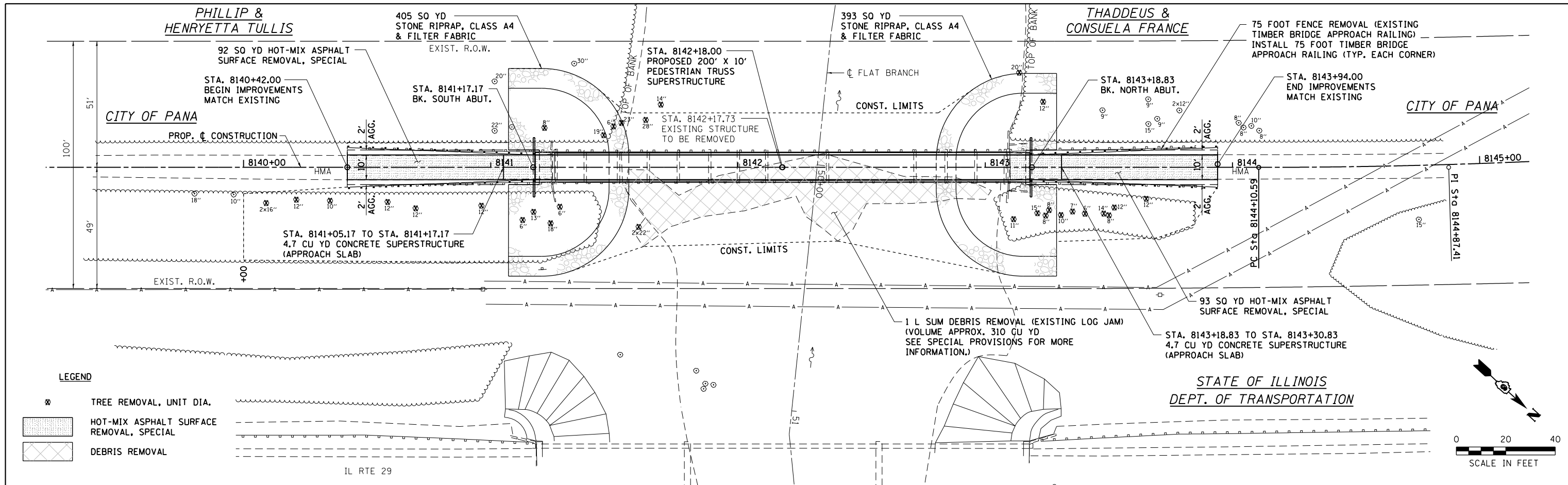

581.65	581.75	581.85	582.01	582.34	582.59	582.52	582.76	582.69	582.83	582.86	582.82	570.88	565.14	562.27	562.16	560.67	560.46	560.30	560.88	564.36	569.89	582.92	583.00	582.89	582.95	582.86	582.91	582.85	582.86	582.82	582.78	582.77	582.76	582.75
8139+50	8140+00	8140+50	8141+00	8141+50	8142+00	8142+50	8143+00	8143+50	8144+00	8144+50																								

FILE NAME = J:\17022 Pana - Bike Trail Bridge\CADD\CADD Sheets\17022-sht-05.PlnPr-f01.dgn  
 MODEL = \$MODEL\$  
 PLOT DRIVER = \$PLTDRVS\$

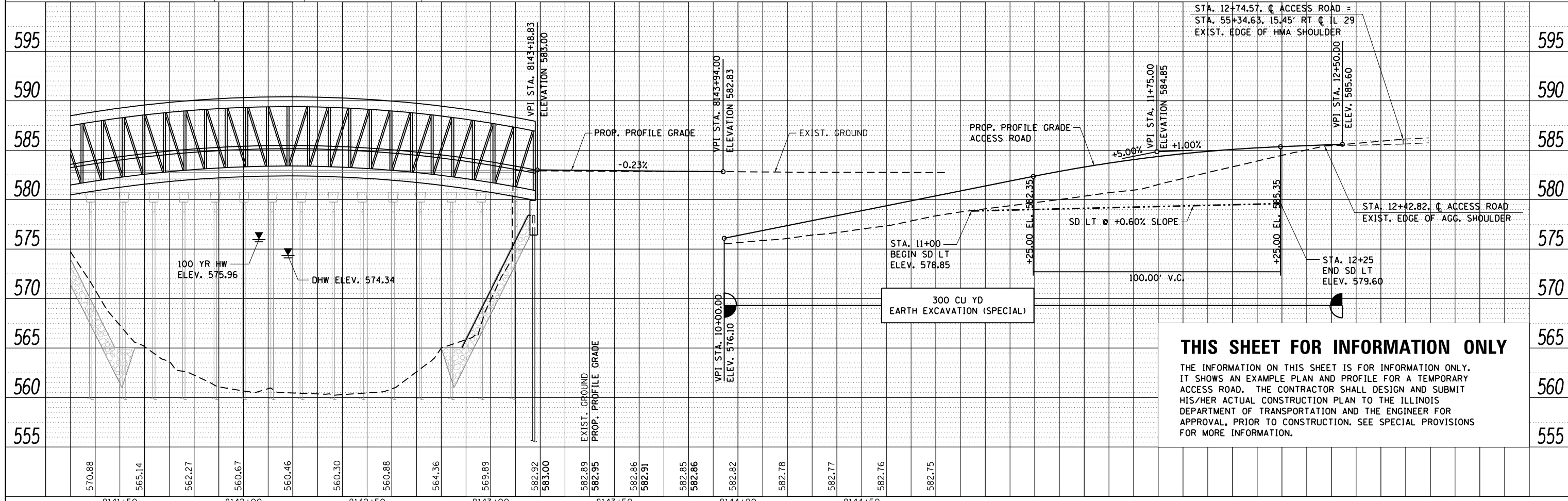
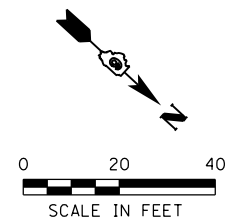
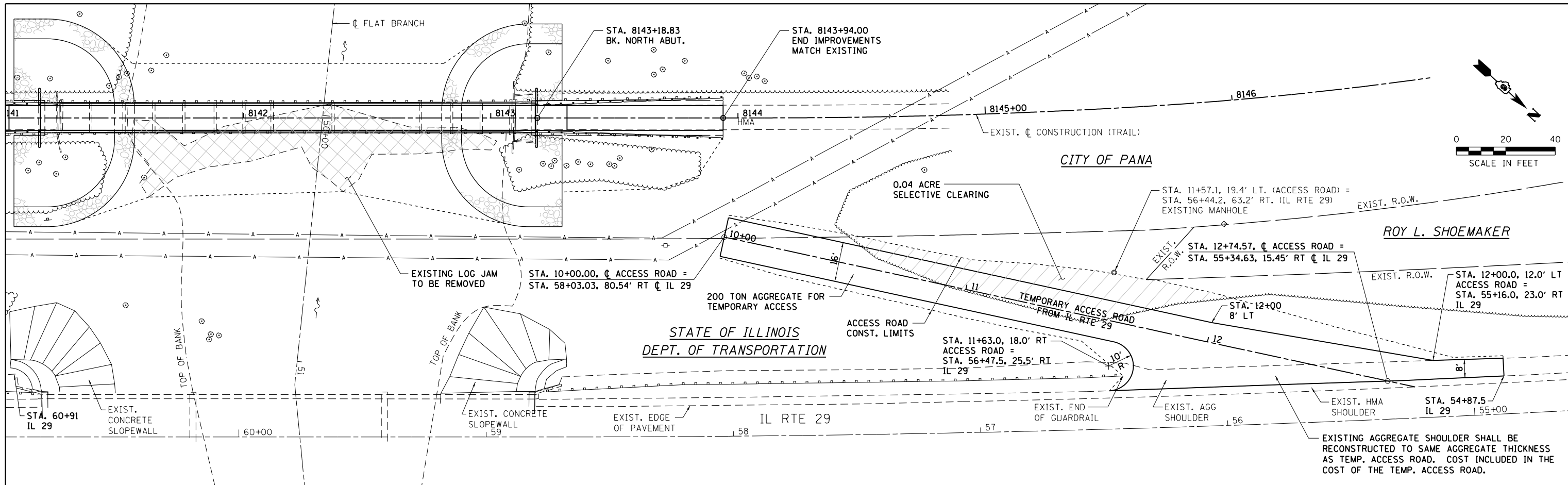

**THIS SHEET FOR INFORMATION ONLY**

THE INFORMATION ON THIS SHEET IS FOR INFORMATION ONLY. IT SHOWS AN EXAMPLE PLAN AND PROFILE FOR A TEMPORARY ACCESS ROAD. THE CONTRACTOR SHALL DESIGN AND SUBMIT HIS/HER ACTUAL CONSTRUCTION PLAN TO THE ILLINOIS DEPARTMENT OF TRANSPORTATION AND THE ENGINEER FOR APPROVAL, PRIOR TO CONSTRUCTION. SEE SPECIAL PROVISIONS FOR MORE INFORMATION.

570.88	565.14	562.27	560.67	560.46	560.30	560.88	564.36	569.89	582.92	583.00	582.89	582.95	582.86	582.91	582.85	582.86	582.82	582.78	582.77	582.76	582.75
8141+50	8142+00	8142+50	8143+00	8143+50	8144+00	8144+50															

<b>KT</b> Professional Design Firm No. 284-006516	<b>KUHN &amp; TRELLO</b> CONSULTING ENGINEERS A Limited Liability Company 109 N. 7th Street, 3rd Floor Springfield, IL 62702 Phone: 217-678-0244	USER NAME = msutheard	DESIGNED - MDS	REVISED -
	FILE NAME = 17022-sht-06.PlnPr-f02.dgn	DRAWN - MDS	REVISED -	
	PLOT SCALE = 40.0000' / in.	CHECKED - KLK	REVISED -	
	PLOT DATE = 6/17/2020	DATE - 6/17/19	REVISED -	

<b>CITY OF PANA</b>		<b>PLAN AND PROFILE</b>	
<b>LINCOLN PRAIRIE TRAIL BRIDGE REPLACEMENT</b>		<b>TEMPORARY ACCESS ROAD - FOR INFORMATION ONLY</b>	
SCALE:	SHEET NO. OF SHEETS	STA. TO STA.	

F.A. RTE.	SECTION	COUNTY	TOTAL SHEETS	SHEET NO.
	16-00054-00-BR	CHRISTIAN	20	6
CONTRACT NO. 93750			ILLINOIS FED. AID PROJECT	

FILE NAME = JAN17022 Pana - Bike Trail Bridge\CADD\CADD Sheets\17022-sht-06.PlnPr-f02.dgn  
 MODEL = \$MODEL\$  
 PLOT DRIVER = \$PLTDRVS\$

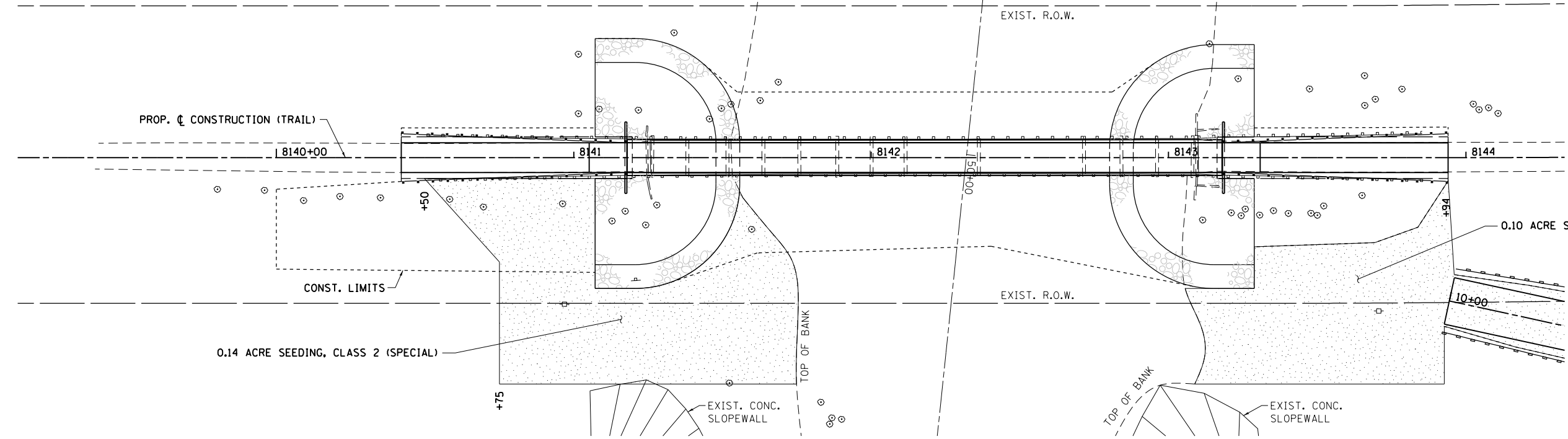
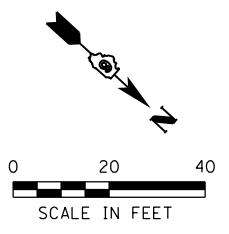

**LEGEND**

SEEDING, CLASS 2 (SPECIAL)

PERIMETER EROSION BARRIER

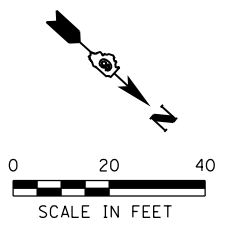
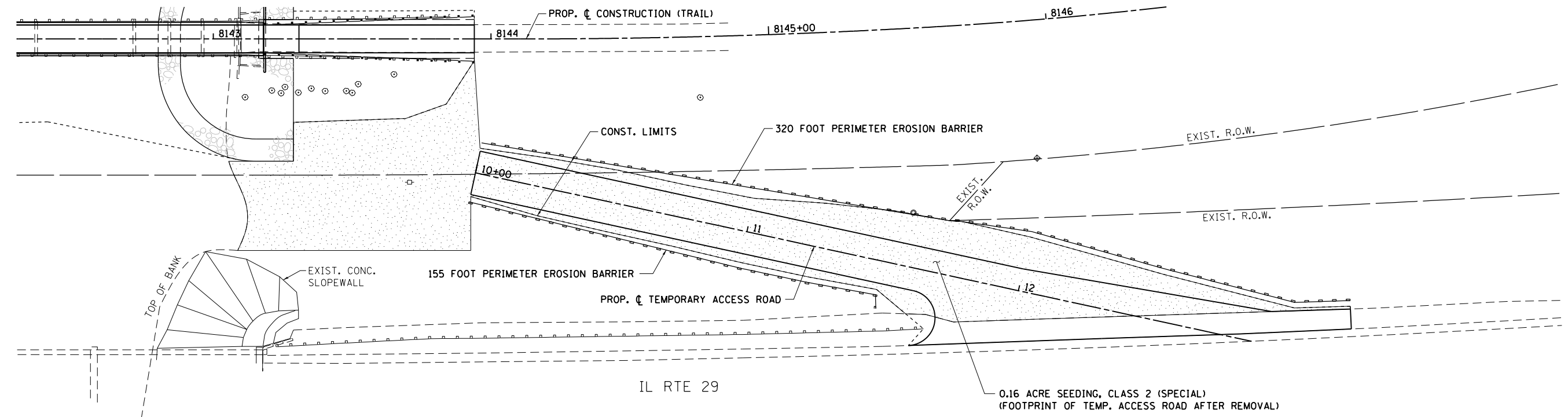

**LEGEND**

SEEDING, CLASS 2 (SPECIAL)

PERIMETER EROSION BARRIER

NOTES: TEMPORARY EROSION CONTROL SEEDING TO BE INSTALLED AND MAINTAINED ON TEMPORARY ACCESS ROAD UNTIL SEEDING, CLASS 2 (SPECIAL) HAS BEEN INSTALLED.

TEMPORARY ACCESS ROAD EXAMPLE LAYOUT SHOWN. ADJUST SEEDING AND EROSION CONTROL ITEMS FOR ACTUAL TEMPORARY ACCESS ROAD CONSTRUCTION.

FILE NAME = J:\17022 Pana - Bike Trail Bridge\CADD\CADD Sheets\17022-sht-07.Eros.dgn  
 MODEL = \$MODEL\$  
 PLOT DRIVER = \$PLTDVRS\$

**KT**  
**KUHN & TRELLO**  
 CONSULTING ENGINEERS  
 A Limited Liability Company  
 109 N. 7th Street, 3rd Floor  
 Springfield, IL 62702  
 Phone: 217-628-0244  
 Professional Design Firm No. 284-006516

USER NAME = msutheard	DESIGNED - MDS	REVISED -
FILE NAME = 17022-sht-07.Eros.dgn	DRAWN - MDS	REVISED -
PLOT SCALE = 40.0000' / in.	CHECKED - KLK	REVISED -
PLOT DATE = 6/17/2020	DATE - 6/17/20	REVISED -

**CITY OF PANA**  
**LINCOLN PRAIRIE TRAIL BRIDGE REPLACEMENT**

**SEEDING AND EROSION CONTROL PLAN**

SCALE: 1"=20'    SHEET NO.    OF    SHEETS    STA.    TO STA.

F.A. RTE.	SECTION	COUNTY	TOTAL SHEETS	SHEET NO.
	16-00054-00-BR	CHRISTIAN	20	7
CONTRACT NO. 93750				
ILLINOIS FED. AID PROJECT				

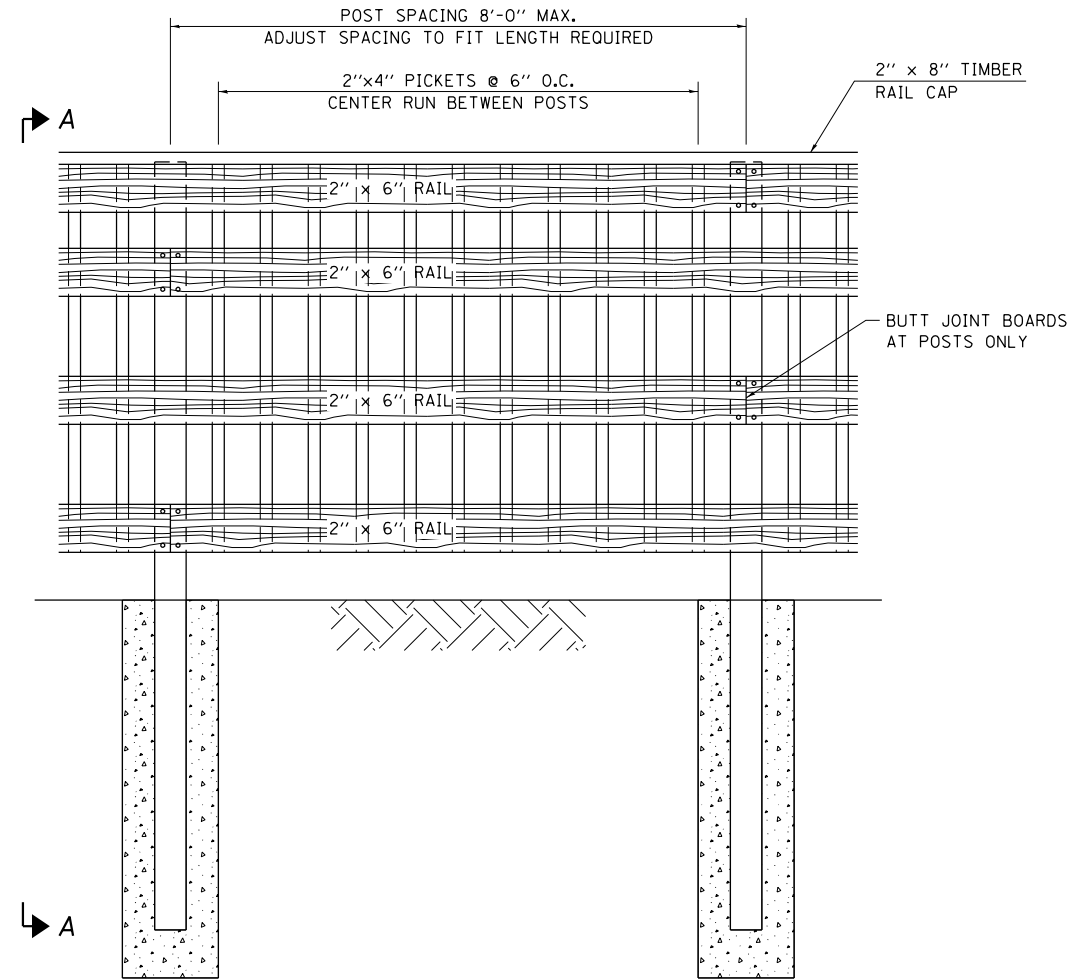

ELEVATION

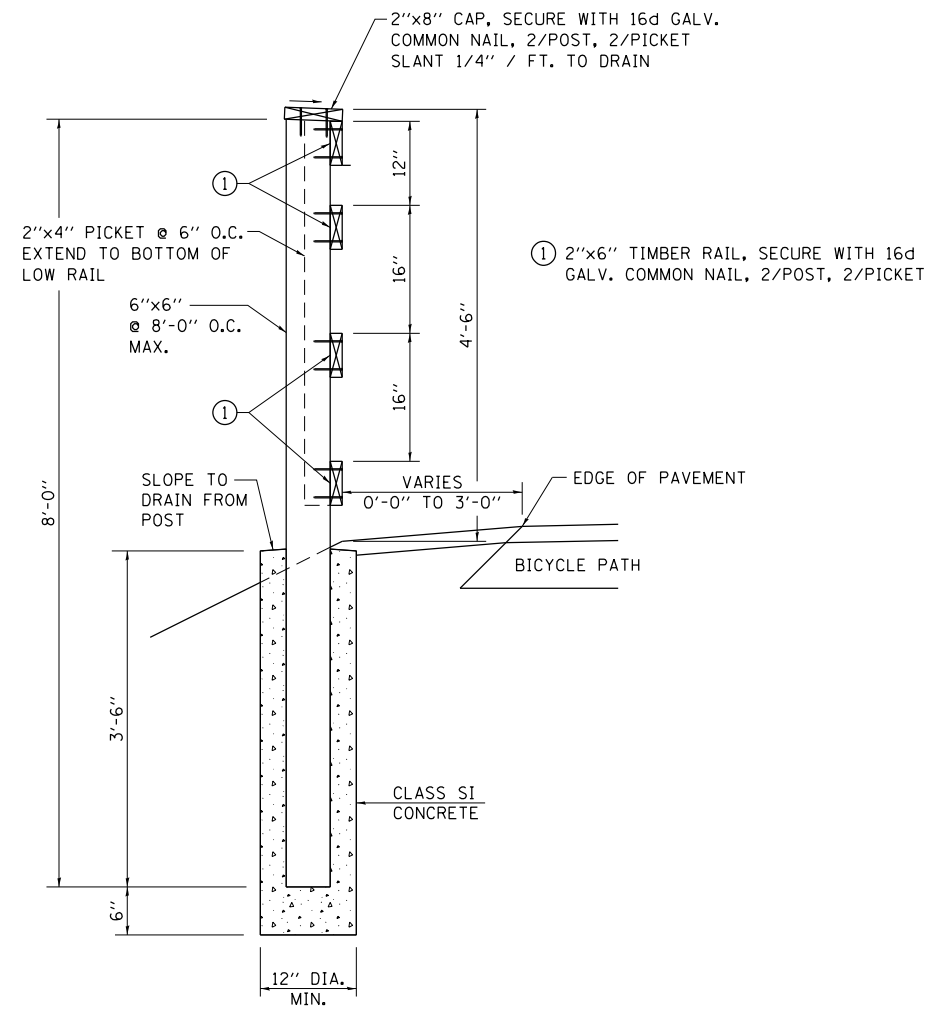

SECTION A-A

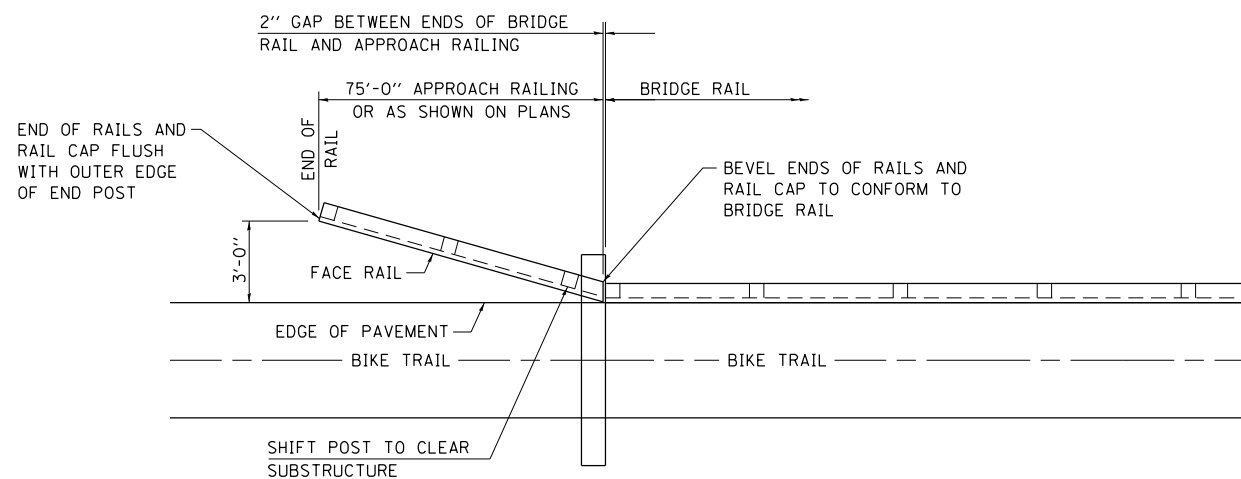

PLAN VIEW

NOTES:

1. ALL TIMBER MATERIALS SHALL BE TREATED TO CONFORM TO THE REQUIREMENTS OF SECTION 507 OF THE STANDARD SPECIFICATIONS.
2. ALL NAILS AND OTHER FASTENERS SHALL BE HOT-DIPPED GALVANIZED AND CONFORM TO THE REQUIREMENTS OF SECTION 507 OF THE STANDARD SPECIFICATIONS.
3. STAGGER ALTERNATING BUTT ENDS ON FACE RAIL AND TOP RAIL CAP. CENTER ALL BUTT END JOINTS ON POSTS.

FILE NAME = JAN17022 Pana - Bike Trail Bridge\CADD\CADD Sheets\17022-sht-08-Details01.dgn  
 MODEL = \$MODEL\$  
 PLOT DRIVER = \$PLTDVRS\$



USER NAME = msutheard	DESIGNED - MDS	REVISED -
FILE NAME = 17022-sht-08-Details01.dgn	DRAWN - MDS	REVISED -
PLOT SCALE = 40.0000' / in.	CHECKED - KLK	REVISED -
PLOT DATE = 6/17/2020	DATE - 6/17/20	REVISED -

CITY OF PANA  
 LINCOLN PRAIRIE TRAIL BRIDGE REPLACEMENT

TIMBER BRIDGE APPROACH RAILING DETAILS

SCALE: SHEET NO. OF SHEETS STA. TO STA.

F.A. RTE.	SECTION	COUNTY	TOTAL SHEETS	SHEET NO.
	16-00054-00-BR	CHRISTIAN	20	8
CONTRACT NO. 93750				
ILLINOIS FED. AID PROJECT				



BM #31: Sta. 58+71.71, 19.53' Lt. (IL Rte 29) = Sta. 8143+26.43, 149.53' Rt. (Bike Trail)  
Chiseled "X" on top of northeast abutment wingwall on IL 29 bridge. Elev. 588.26

Existing Structure: The existing structure (no structure number) is a 15 span timber trestle railroad bridge which was rehabilitated in the 1990's with new timber ties, deck planks and railings during bike trail construction. The structure is 182'-8" face to face of abutment backwalls with a width of 9'-0" face to face of deck curbs.

The existing structure will be completely removed and replaced with a single span Pedestrian Truss Superstructure. No salvage.

**INDEX OF SHEETS**

- 1 General Plan and Elevation
- 2 General Notes and Cross Section Details
- 3 Bridge Approach Slab Details
- 4 Abutments
- 5 HP Pile Details
- 6-7 Boring Logs

**WATERWAY INFORMATION**

Drainage Area = 279 Sq Mi		Low Grade Elev. 581.87		Sta. 8139+28.20					
Flood	Freq. Yr.	Q C.F.S.	Opening Ft <sup>2</sup>		Nat. H.W.E.	Head - Ft.		Headwater El.	
			Exist.	Prop.		Exist.	Prop.	Exist.	Prop.
Design	30	9,200	3,019	1,880	572.42	8.16	1.92	580.58	574.34
Base	100	11,900	3,058	2,171	573.46	8.56	2.50	582.02	575.96

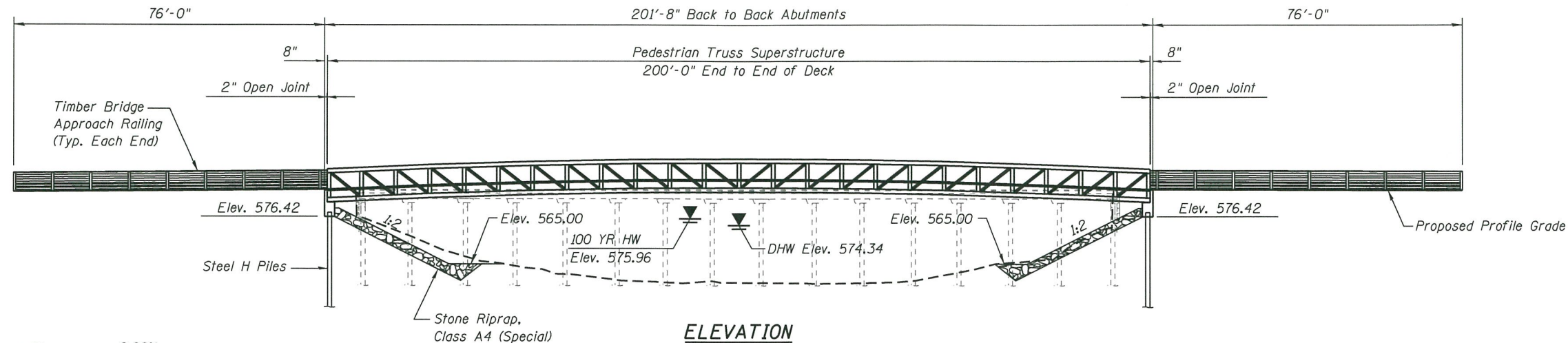

FLAT BRANCH  
BUILT 20xx BY CITIES OF  
PANA & TAYLORVILLE  
SEC. 16-00054-00-BR  
LINCOLN PRAIRIE TRAIL  
STA. 8142+18.00  
STR. NO. 011-PO02 LOADING H10

**NAME PLATE**  
See Std. 515001

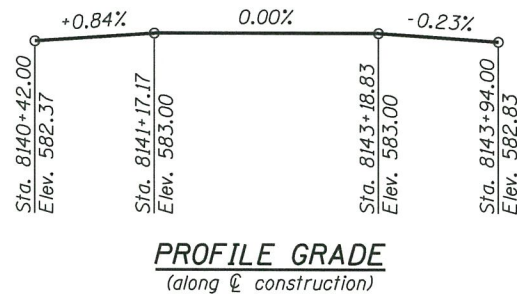

**PROFILE GRADE**  
(along centerline construction)

**ELEVATION**

**DESIGN SPECIFICATIONS**

2009 AASHTO LRFD Guide  
Specifications for the Design of  
Pedestrian Bridges (Superstructure)

2017 AASHTO LRFD Bridge Design  
Specification, 8th Edition (Abutments)

**LOADING H-10**

Vehicle Load: 20,000 lb  
Pedestrian Load: 90 psf uniform load

**DESIGN STRESSES**

**FIELD UNITS**

$f'_c = 3,500$  psi  
 $f_y = 60,000$  psi (reinforcement)

**SEISMIC DATA**

Seismic Performance Zone (SPZ) =  
Design Spectral Acceleration at 1.0 sec. (SD1) = 0.121g  
Design Spectral Acceleration at 0.2 sec. (SDS) = 0.253g  
Soil Site Class = C

**TOTAL BILL OF MATERIAL**

ITEM	UNIT	TOTAL
Concrete Structures	Cu. Yd.	15.2
Stone Riprap, Class A4	Sq. Yd.	798
Filter Fabric	Sq. Yd.	798
Pedestrian Truss Superstructure	Sq. Ft.	2,000
Removal of Existing Structures	Each	1
Structure Excavation	Cu. Yd.	95
Reinforcement Bars (Epoxy Coated)	Pound	3760
Furnishing Steel Piles HP 12 x 53	Foot	120
Driving Piles	Foot	120
Test Pile Steel HP 12 x 53	Each	2
Granular Backfill For Structures	Cu. Yd.	43
Protective Coat	Sq. Yd.	28.2
Concrete Superstructure (Approach Slab)	Cu. Yd.	9.4
Name Plates	Each	1
Anchor Bolts, 1"	Each	8
Concrete Sealer	Sq. Ft.	336

\* See Special Provisions

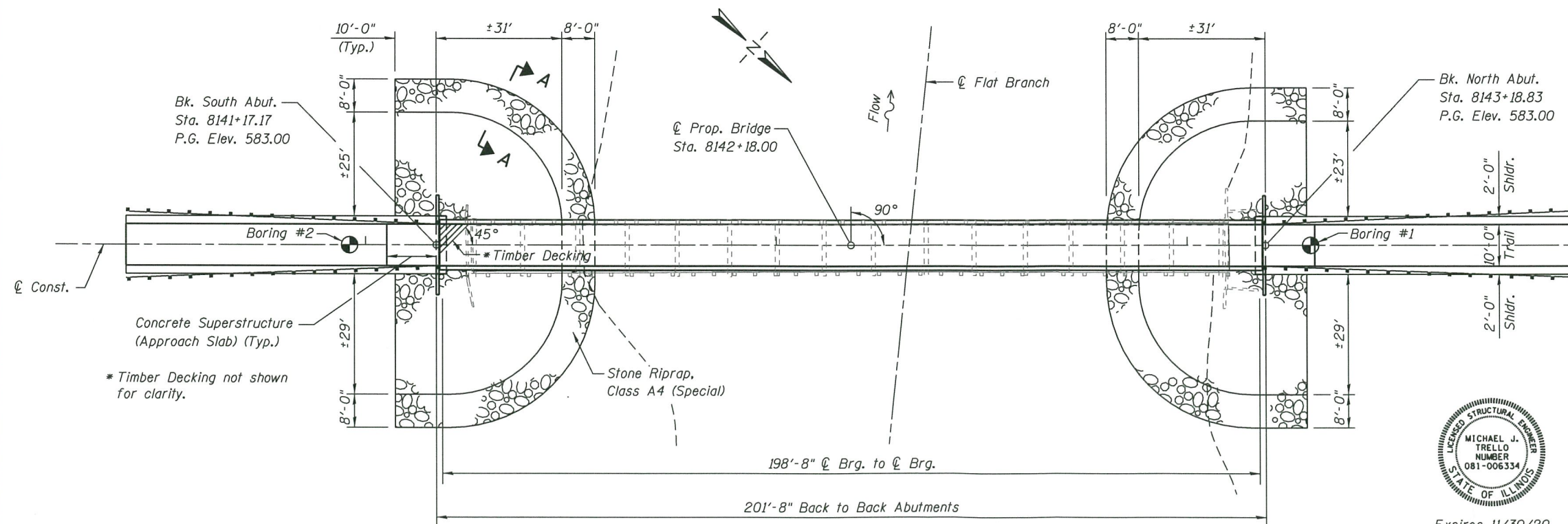

**PLAN**

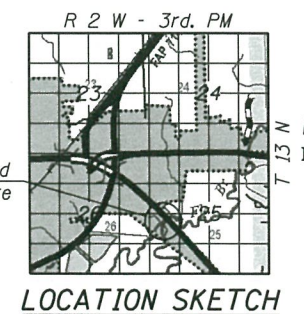

**LOCATION SKETCH**



Expires 11/30/20  
(Applies to abutments only)

Signed: *[Signature]*  
Dated: 6/17/2020

I certify that to the best of my knowledge, information and belief, this bridge foundation design is structurally adequate for the design loading shown on the plans. The design is an economical one for the style of structure and complies with requirements of the current A.A.S.H.T.O. L.R.F.D. Bridge Design Specifications.

MODEL: Default  
FILE NAME: J:\17022\_Pana - Bike Trail Bridge\CADD\CADD\_Sheets\17022-sht-09\_5001\_GPE.dgn



USER NAME =	DESIGNED -	REVISED -
PLOT DRIVER = 17022_PDF_11x17.plt	CHECKED -	REVISED -
PLOT SCALE = 32:0.0000"=1"	DRAWN -	REVISED -
PLOT DATE = 6/17/2020	CHECKED -	REVISED -

**CITY OF PANA  
LINCOLN PRAIRIE TRAIL BRIDGE REPLACEMENT**

**GENERAL PLAN AND ELEVATION**

SHEET 1 OF 7 SHEETS

F.A. RTE.	SECTION	COUNTY	TOTAL SHEETS	SHEET NO.
	16-00054-00-BR	CHRISTIAN	20	9
CONTRACT NO. 93750			ILLINOIS FED. AID PROJECT	

**GENERAL NOTES**

- The Contractor shall field verify all conditions at the site prior to the start of construction or fabrication of proposed bridge.
- No field welding is permitted except as specified in the contract documents.
- Bearing seat surfaces shall be constructed or adjusted to the designated elevations within a tolerance of 1/8 inch (0.01 ft.). Adjustment shall be made either by grinding the surface or by shimming the bearings.
- Layout of slope protection system may be varied to suit ground conditions in the field as directed by the Engineer.
- Reinforcement bars (E) shall be epoxy coated.
- Unless otherwise noted, exposed concrete edges shall have a 3/4" chamfer.
- Concrete sealer shall be applied to the designated areas of the abutments.
- Timber deck planks shall be placed with the grain such that cupping will not cause water to sit on a plank.
- All structural timber shall be treated to conform to Section 507 of the Standard Specifications.
- All hardware required for timber construction, including nuts, washers, lag screws, threaded rods and miscellaneous fasteners shall be stainless steel or hot-dipped galvanized and shall conform to Section 507 of the Standard Specifications unless otherwise noted.
- All lumber dimensions given are nominal dimensions. The minimum surfaced areas of timbers shall be as follows:

NOMINAL SIZE	DRESSED
2 x 6	1 1/2" x 5 1/2"
2 x 8	1 1/2" x 7 1/4"
2 x 12	1 1/2" x 11 1/4"
3 x 12	2 1/2" x 11 1/4"
6 x 6	5 1/2" x 5 1/2"
8 x 8	7 1/2" x 7 1/2"

**BRIDGE SPAN REACTIONS**

LOAD	P lbs	H lbs	L lbs
DEAD	36,000	-	-
UNIFORM LIVE	45,000	-	-
VEHICLE	13,800	-	-
WIND	±17,000	27,000	-
WINDWARD	-23,100	-	-
LEEWARD	6,000	-	-
THERMAL	-	-	7,000

\* DOWNWARD LOAD  
- UPWARD LOAD

"P" - VERTICAL LOAD EACH BASE PLATE (4 PER BRIDGE SPAN)  
"H" - HORIZONTAL LOAD EACH FOOTING (2 PER BRIDGE SPAN)  
"L" - LONGITUDINAL LOAD EACH BASE PLATE (4 PER BRIDGE SPAN)

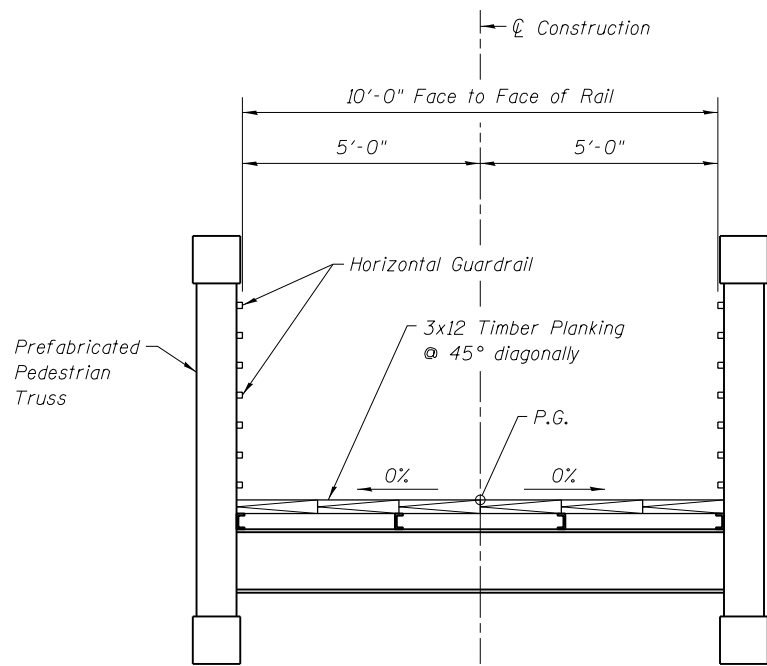

**SECTION THRU PROPOSED PREFABRICATED BRIDGE SUPERSTRUCTURE**  
(SHOWN FOR DIMENSIONS ONLY. SHAPE MAY VARY.)

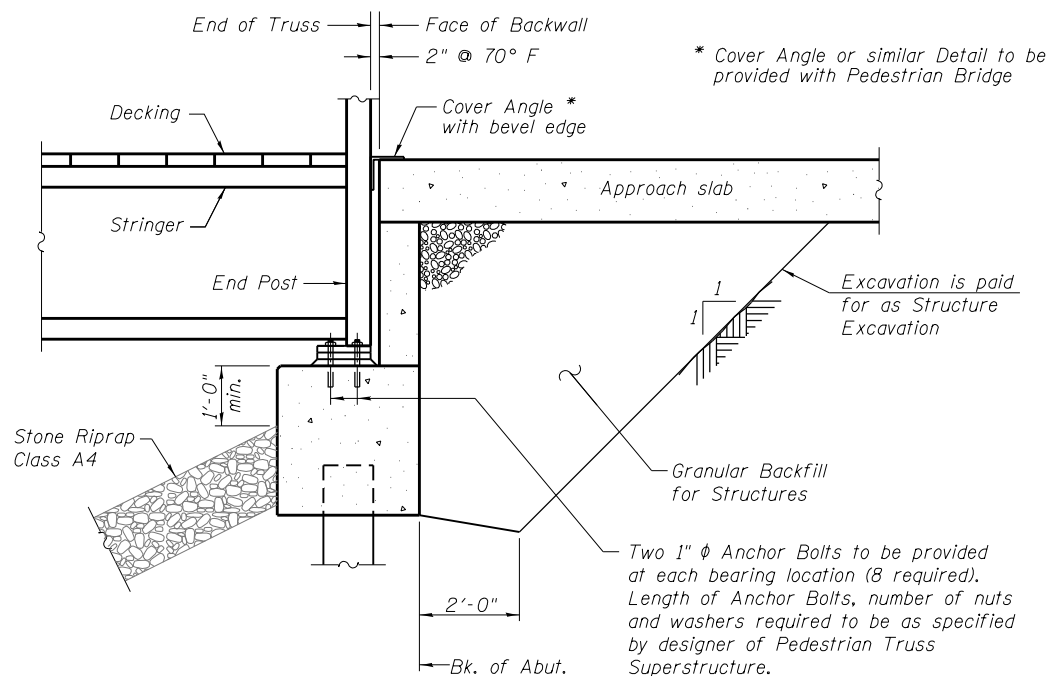

**SECTION THRU ABUTMENT**

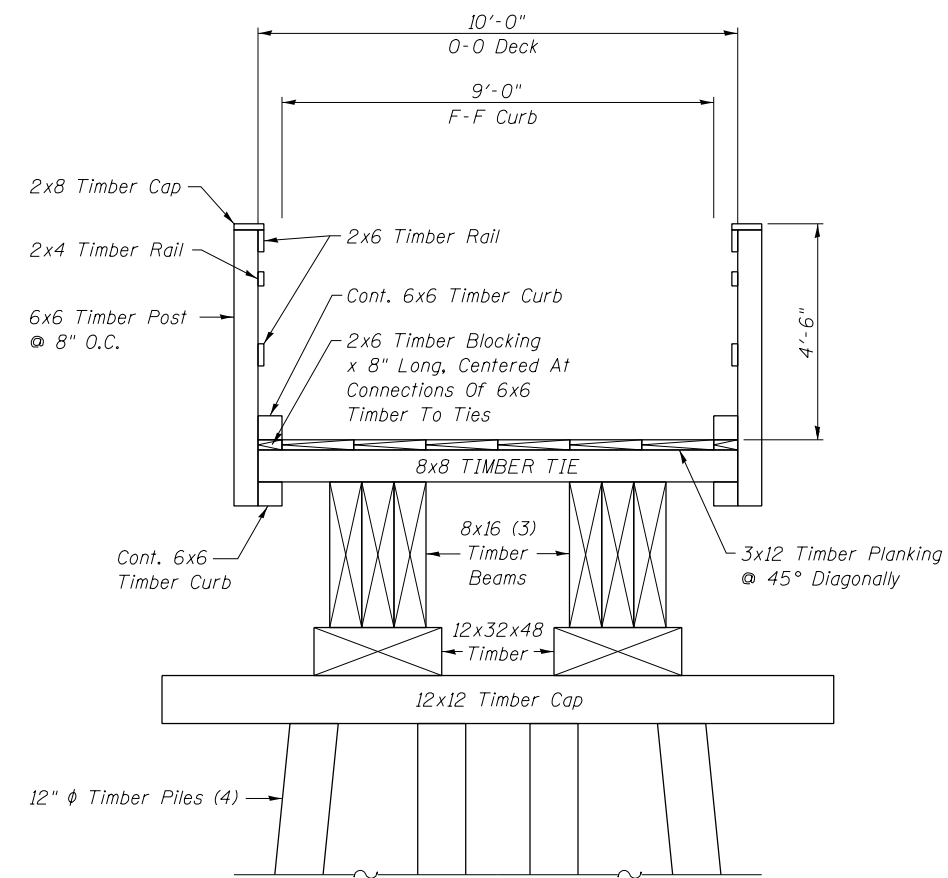

Typical Section At Each Of 14 Piers.  
Piers At ± 12' Centers.

**SECTION THRU EXISTING TIMBER STRUCTURE**  
(FOR INFORMATION ONLY)

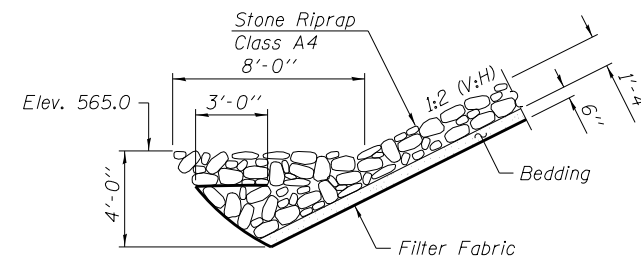

**SEC. A-A STONE RIPRAP ANCHOR DETAIL**

MODEL: Default  
FILE NAME: J:\17022 Pana - Bike Trail Bridge\CADD\Sheets\17022-sht-10\_S002\_GN.dgn

**KUHN & TRELLO**  
CONSULTING ENGINEERS  
A Limited Liability Company  
109 N. 7th Street, 3rd Floor  
Springfield, IL 62702  
Phone: 217-478-0244  
Professional Design Firm No. 284-006516

USER NAME =	DESIGNED -	REVISED -
PLOT DRIVER = \$PLTDRVSS	CHECKED -	REVISED -
PLOT SCALE = 320,0000" / 1in.	DRAWN -	REVISED -
PLOT DATE = 6/17/2020	CHECKED -	REVISED -

**CITY OF PANA  
LINCOLN PRAIRIE TRAIL BRIDGE REPLACEMENT**

**GENERAL NOTES AND  
CROSS SECTION DETAILS**

SHEET 2 OF 7 SHEETS

F.A. RTE.	SECTION	COUNTY	TOTAL SHEETS	SHEET NO.
	16-00054-00-BR	CHRISTIAN	20	10
CONTRACT NO. 93750				
ILLINOIS FED. AID PROJECT				

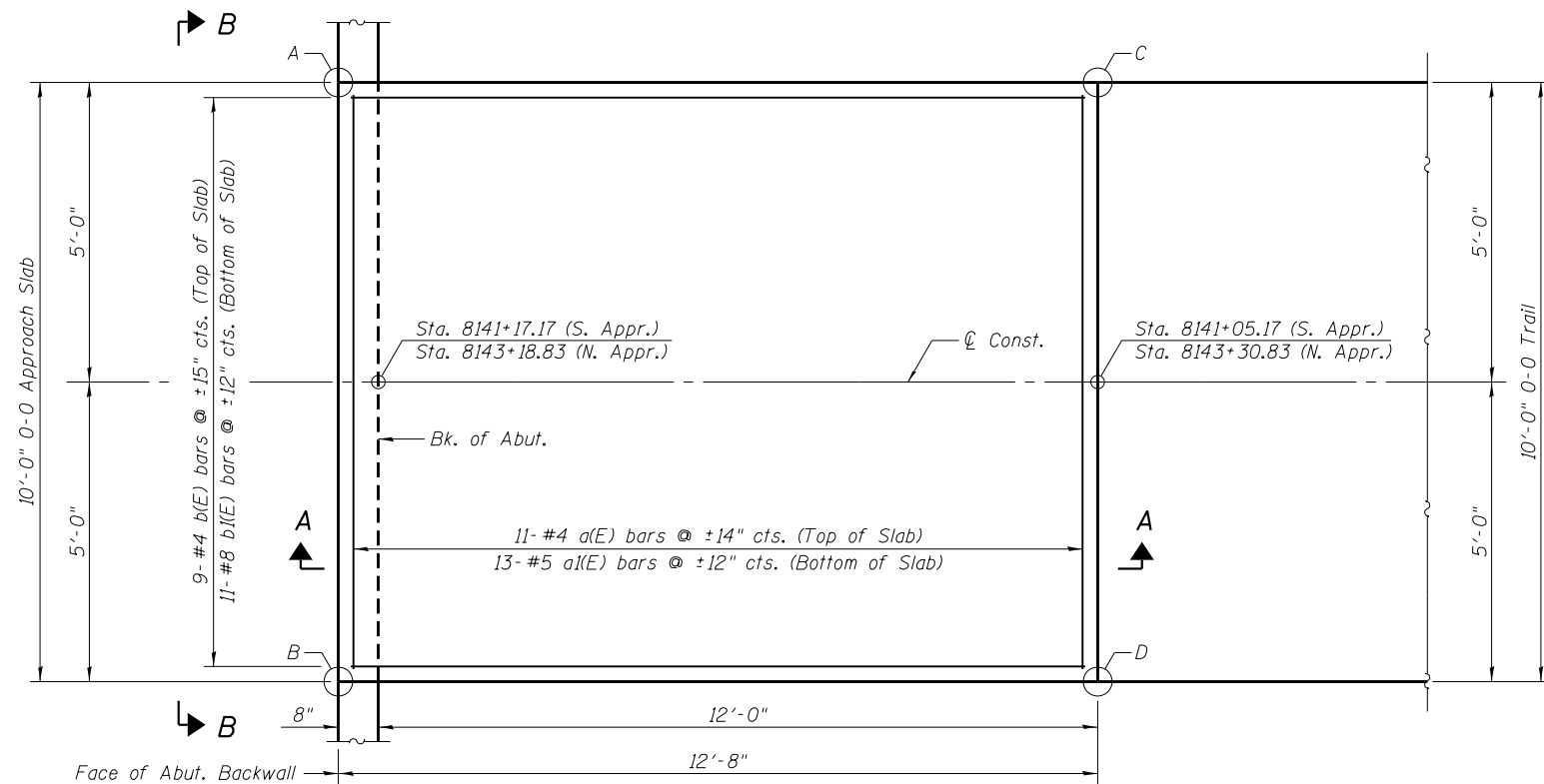

PLAN

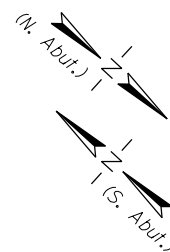

**TOP OF APPROACH ELEVATIONS**

Point	South Approach	North Approach
A	583.00	583.00
B	583.00	583.00
C	582.90	582.97
D	582.90	582.97

Notes:  
 Approach slab shall be paid for as Concrete Superstructure (Approach Slab).  
 For Granular Backfill for Structures and drainage treatment details, see sheet 2 of 7.

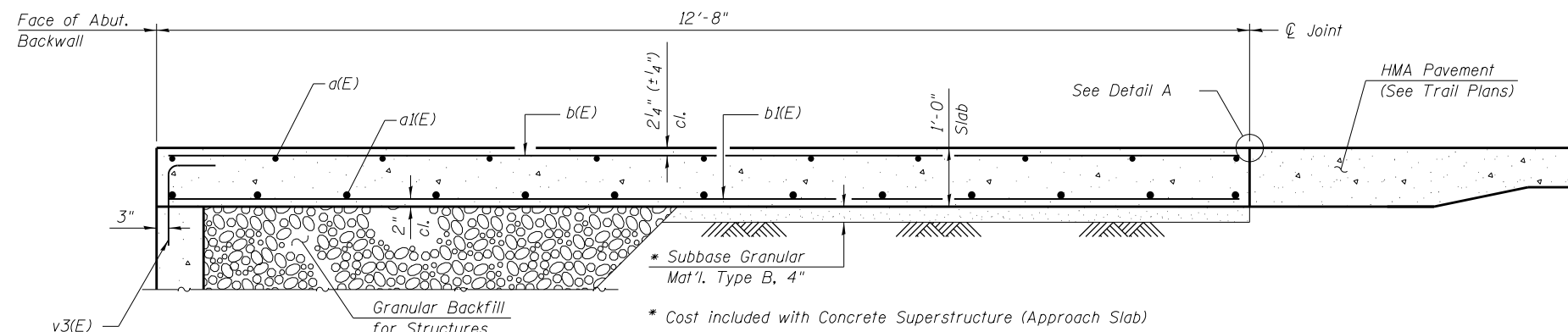

SECTION A-A

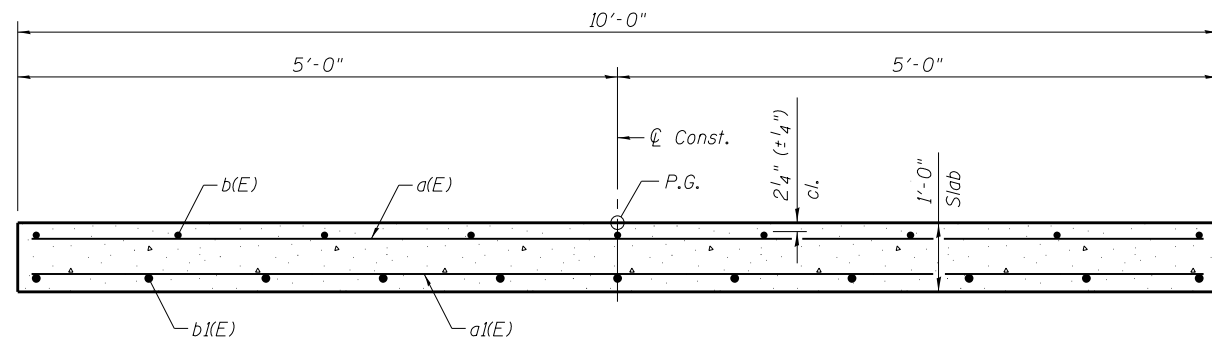

SECTION B-B

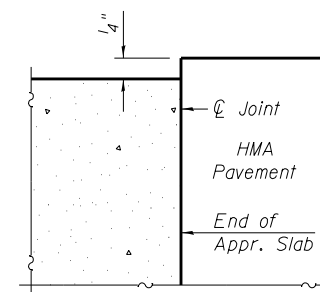

FLEXIBLE PAVEMENT  
 DETAIL A

**TWO APPROACHES  
 BILL OF MATERIAL**

Bar	No.	Size	Length	Shape	
a(E)	22	#4	9'-8"	—	
a(E)	26	#5	9'-8"	—	
b(E)	18	#4	12'-4"	—	
b(E)	22	#8	12'-4"	—	
Concrete Superstructure (Approach Slab)					
				Cu. Yd.	9.4
Protective Coat				Sq. Yd.	28.2
Reinforcement Bars, Epoxy Coated				Pound	1,280

MODEL: Default  
 FILE NAME: J:\17022 Pana - Bike Trail Bridge\CADD\Sheets\17022-sht-11\_S003\_APPR.dgn  
 6/17/2020 1:12:30 PM



USER NAME =	DESIGNED -	REVISED -
PLOT DRIVER = \$PLTDRVSS	CHECKED -	REVISED -
PLOT SCALE = 320,0000"/In.	DRAWN -	REVISED -
PLOT DATE = 6/17/2020	CHECKED -	REVISED -

**CITY OF PANA  
 LINCOLN PRAIRIE TRAIL BRIDGE REPLACEMENT**

**BRIDGE APPROACH SLAB DETAILS**  
 SHEET 3 OF 7 SHEETS

F.A. RTE.	SECTION	COUNTY	TOTAL SHEETS	SHEET NO.
	16-00054-00-BR	CHRISTIAN	20	11
CONTRACT NO. 93750				
ILLINOIS FED. AID PROJECT				



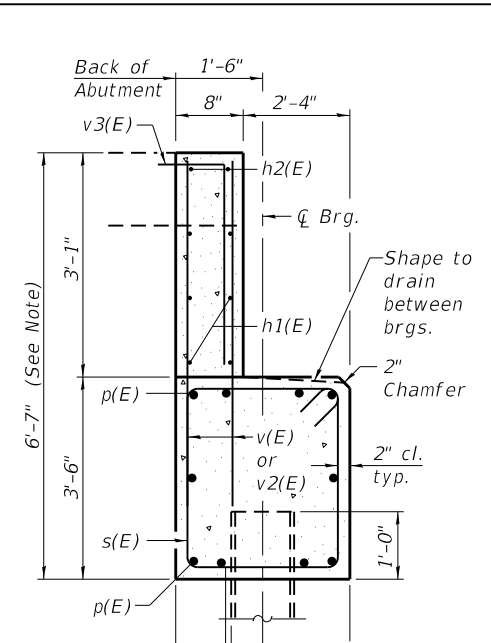
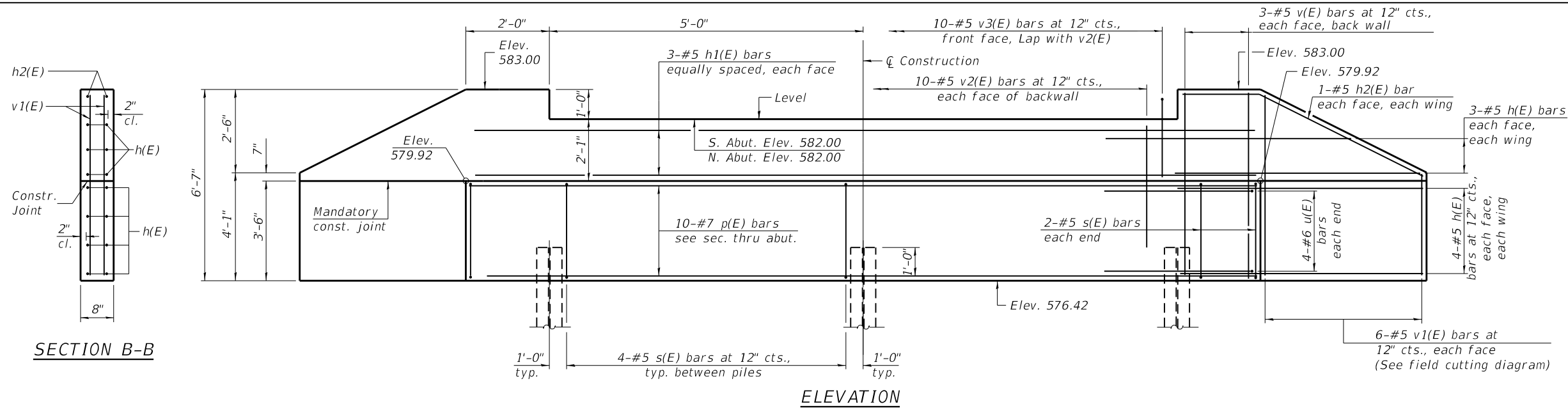

SECTION B-B

ELEVATION

SECTION A-A

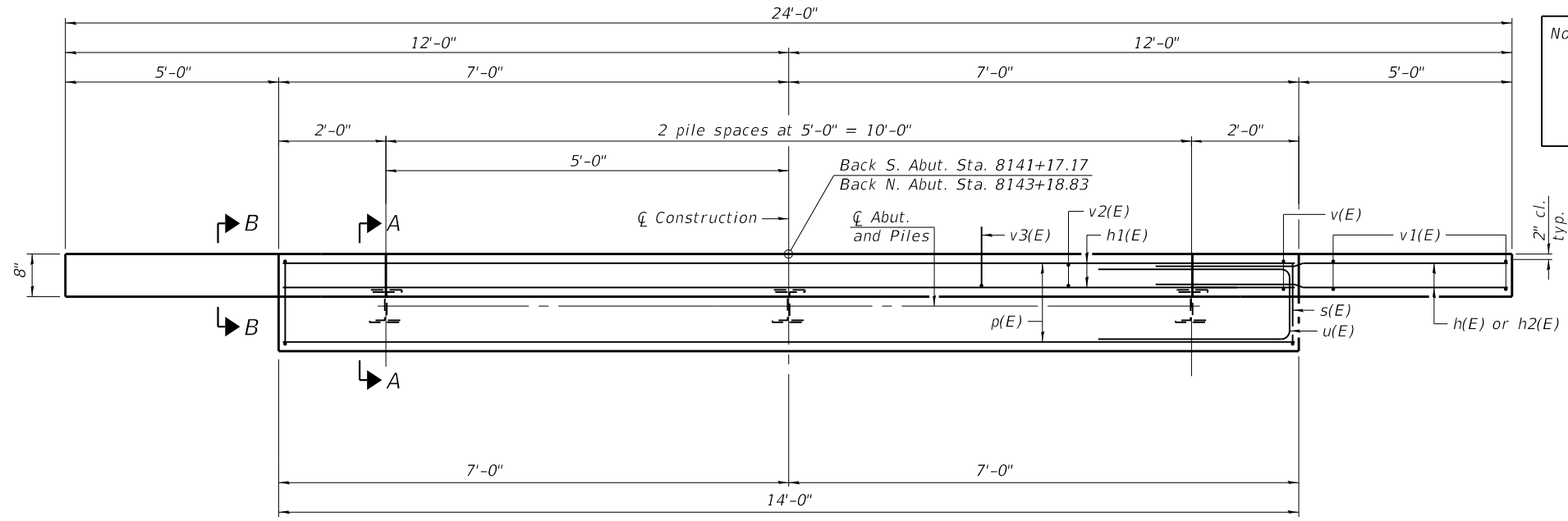
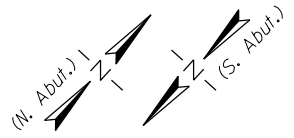

PLAN

Note: Contractor shall verify this dimension with Pre-fabricated Bridge Supplier. (Hold PG elevation 583.00 and adjust bearing seat elevation.)

**PILE DATA**

Type: Steel H, 12x53  
 Nominal Required Bearing: 190 kip  
 Factored Resistance Available: 104 kip  
 Est. Length: 24 ft N. Abut., 36 ft S. Abut.  
 No. Production Piles: 4  
 No. Test Piles: 2

One test pile to be driven in a permanent location at each Abutment, as directed by the Engineer, before ordering the remainder of the piles. The test pile shall be driven to 110 percent of the Nominal Required. Bearing indicated in the pile data information.

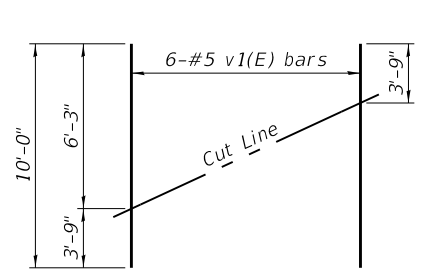

FIELD CUTTING DIAGRAM

Order v1(E) bars full length. Cut as shown and use remainder of bars in opposite wing.

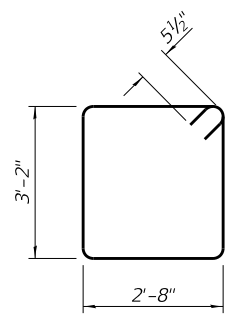

BAR s(E)

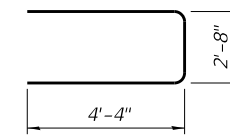

BARS u(E)

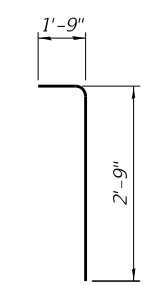

BAR v3(E)

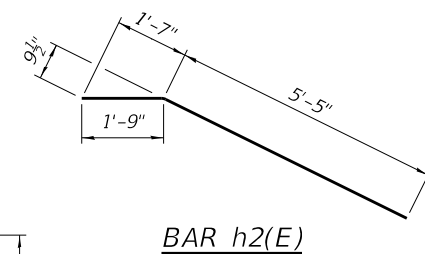

BAR h2(E)

**BILL OF MATERIAL TWO ABUTMENTS**

Bar	No.	Size	Length	Shape
h(E)	56	#5	7'-4"	—
h1(E)	12	#5	13'-8"	—
h2(E)	8	#5	7'-2"	—
p(E)	20	#7	13'-8"	—
s(E)	24	#5	12'-7"	□
u(E)	16	#6	11'-4"	□
v(E)	24	#5	6'-3"	—
v1(E)	24	#5	10'-0"	—
v2(E)	40	#5	4'-2"	—
v3(E)	20	#5	4'-6"	—
Structure Excavation		Cu. Yd.	95	
Concrete Structures		Cu. Yd.	15.2	
Reinforcement Bars, Epoxy Coated		Pound	2480	
Furnishing Steel H Piles, 12x53		Foot	120	
Driving Piles		Foot	120	
Test Pile, HP 12x53		Each	2	
Concrete Sealer		Sq. Ft.	336	

Notes:  
 For details of piles, see sheet 5 of 7.  
 Cast backwall and tops of wingwalls after Pedestrian Truss Superstructure has been erected. Concrete Sealer shall be applied to the bearing seat and the front face of the backwall, wingwall and pile cap.

MODEL: Default; FILE NAME: J:\17022 Pana - Bike Trail Bridge\CADD\CADD Sheets\17022-sh1-12\_S004\_ABUT.dgn

AD-SB-0 6-15-2019

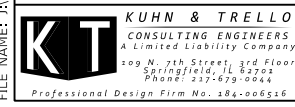

USER NAME =	DESIGNED -	REVISED -
PLOT DRIVER = SPLTRVSS	CHECKED -	REVISED -
PLOT SCALE = 320,0000 1/16"	DRAWN -	REVISED -
PLOT DATE = 6/17/2020	CHECKED -	REVISED -

**CITY OF PANA  
 LINCOLN PRAIRIE TRAIL BRIDGE REPLACEMENT**

**ABUTMENTS**  
 SHEET 4 OF 7 SHEETS

F.A. RTE.	SECTION	COUNTY	TOTAL SHEETS	SHEET NO.
	16-00054-00-BR	CHRISTIAN	20	12
CONTRACT NO. 93750				
ILLINOIS FED. AID PROJECT				

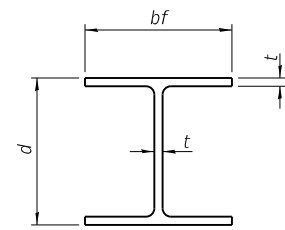

**STEEL PILE TABLE**

Designation	Depth d	Flange width bf	Web and Flange thickness t	Encasement diameter A
HP 14x117	14 1/4"	14 7/8"	1 3/16"	30"
x102	14"	14 3/4"	1 1/16"	30"
x89	13 7/8"	14 3/4"	5/8"	30"
x73	13 3/8"	14 3/8"	1/2"	30"
HP 12x84	12 1/4"	12 1/4"	1 1/16"	24"
x74	12 1/8"	12 1/4"	5/8"	24"
x63	12"	12 1/8"	1/2"	24"
x53	11 3/4"	12"	7/16"	24"
HP 10x57	10"	10 1/4"	9/16"	24"
x42	9 3/4"	10 1/8"	7/16"	24"
HP 8x36	8"	8 1/8"	7/16"	18"

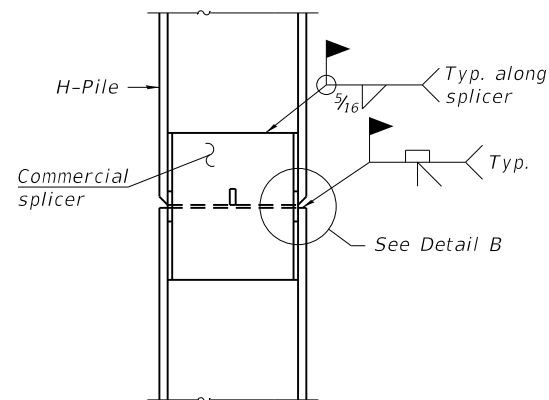

**ELEVATION**

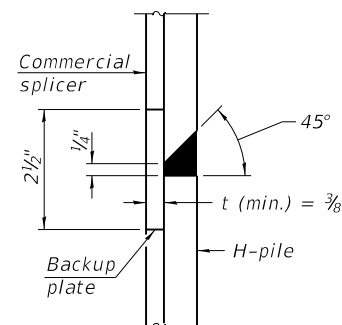

**DETAIL "B"**

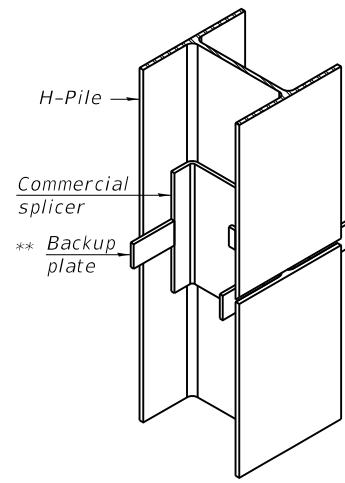

**ISOMETRIC VIEW**

**WELDED COMMERCIAL SPLICE**

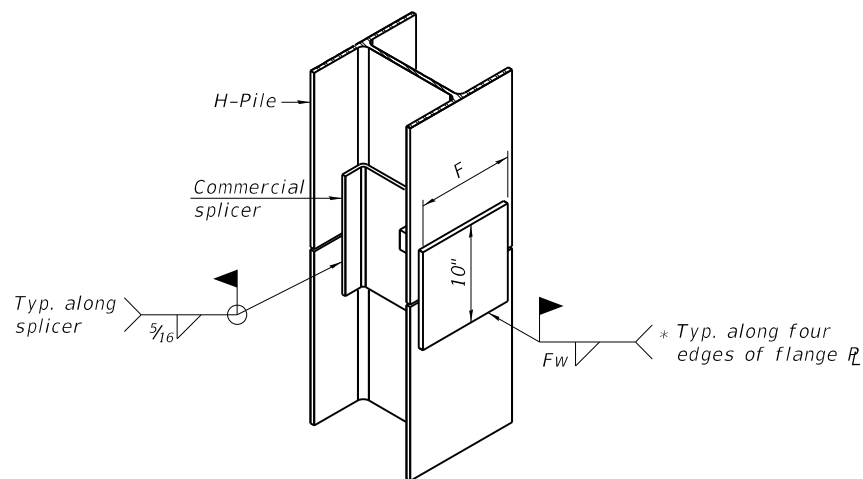

**ISOMETRIC VIEW**

**WELDED COMMERCIAL SPLICE ALTERNATE**

- \* Interrupt welds 1/4" from end of web and/or each flange.
- \*\* Remove portions of backup plates that extend outside the flanges.
- \*\*\* Weld size per pile shoe manufacturer (5/16" min.).

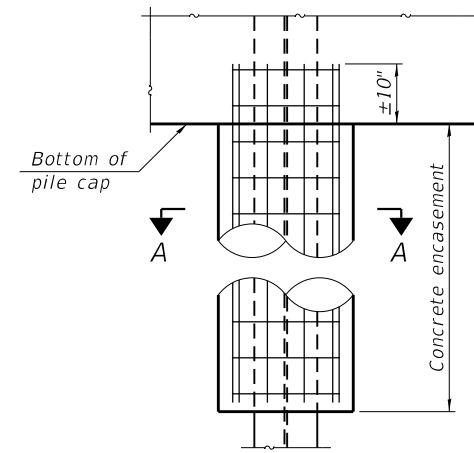

**ELEVATION**

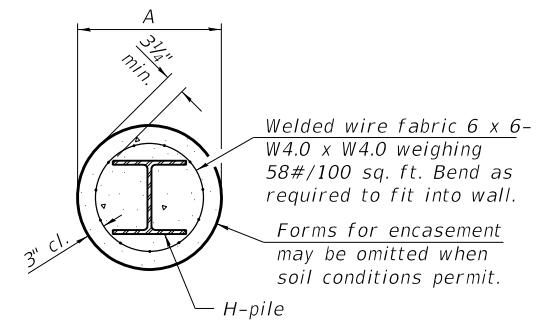

**SECTION A-A**

**INDIVIDUAL PILE CONCRETE ENCASUREMENT**  
(when specified)

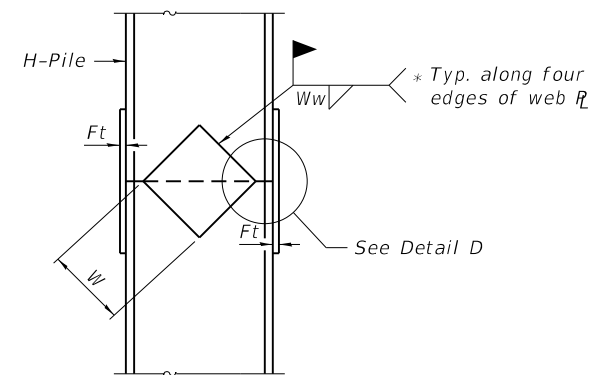

**ELEVATION**

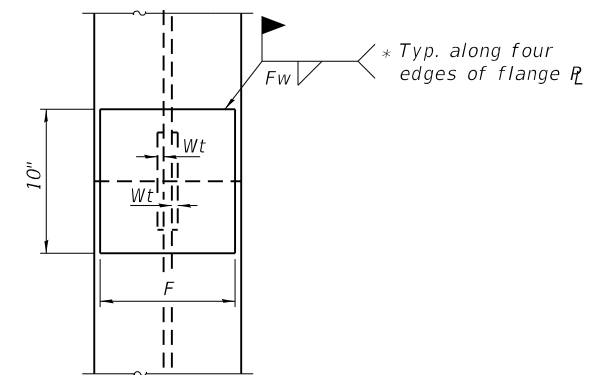

**END VIEW**

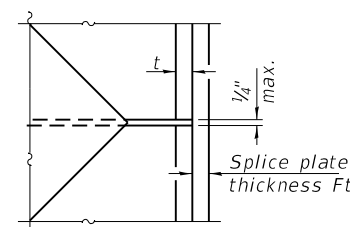

**DETAIL D**

**WELDED PLATE FIELD SPLICE**

Designation	F	Ft	Fw	W	Wt	Ww
HP 14x117	12 1/2"	1"	7/8"	7 3/4"	5/8"	1/2"
x102	12 1/2"	7/8"	3/4"	7 3/4"	5/8"	1/2"
x89	12 1/2"	3/4"	1 1/16"	7 3/4"	5/8"	1/2"
x73	12 1/2"	5/8"	9/16"	7 3/4"	5/8"	1/2"
HP 12x84	10"	7/8"	1 1/16"	6 1/2"	5/8"	1/2"
x74	10"	7/8"	1 1/16"	6 1/2"	5/8"	1/2"
x63	10"	5/8"	1/2"	6 1/2"	1/2"	3/8"
x53	10"	5/8"	1/2"	6 1/2"	1/2"	3/8"
HP 10x57	8"	3/4"	9/16"	5 1/4"	1/2"	3/8"
x42	8"	5/8"	9/16"	5 1/4"	1/2"	3/8"
HP 8x36	7"	5/8"	7/16"	4 1/4"	1/2"	3/8"

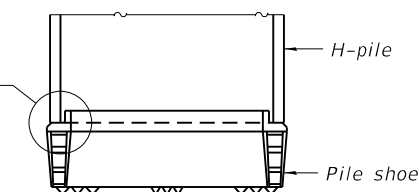

**ELEVATION**

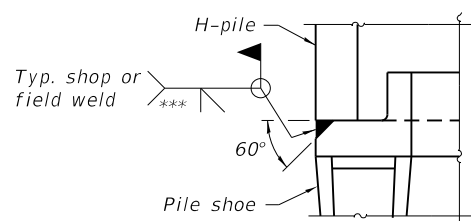

**DETAIL A**

**SHOE ATTACHMENT**

Note:  
The steel H-piles shall be according to AASHTO M270 Grade 50.

MODEL: Default; FILE NAME: J:\17022 Pana - Bike Trail Bridge\CADD\CADD Sheets\17022-sh1-13\_S005\_PILES.dgn

F-HP 1-1-2020



USER NAME =	DESIGNED -	REVISED -
PLOT DRIVER = SPLDRVSS	CHECKED -	REVISED -
PLOT SCALE = 320,0000 1/16"	DRAWN -	REVISED -
PLOT DATE = 6/17/2020	CHECKED -	REVISED -

**CITY OF PANA  
LINCOLN PRAIRIE TRAIL BRIDGE REPLACEMENT**

**HP PILE DETAILS**

SHEET 5 OF 7 SHEETS

F.A. RTE.	SECTION	COUNTY	TOTAL SHEETS	SHEET NO.
	16-00054-00-BR	CHRISTIAN	20	13
CONTRACT NO. 93750				
ILLINOIS		FED. AID PROJECT		







FINAL SURVEY NO.	SURVEYED	BY	DATE
NOTE BOOK	PLOTTED		
AREAS CHECKED	TEMPLATE		
	AREAS CHECKED		

ORIGINAL SURVEY NO.	SURVEYED	BY	DATE
NOTE BOOK	PLOTTED		
AREAS CHECKED	TEMPLATE		
	AREAS CHECKED		

PLOT DRIVER = #PLTDVRS\*  
FILE NAME = #PFILELNGS

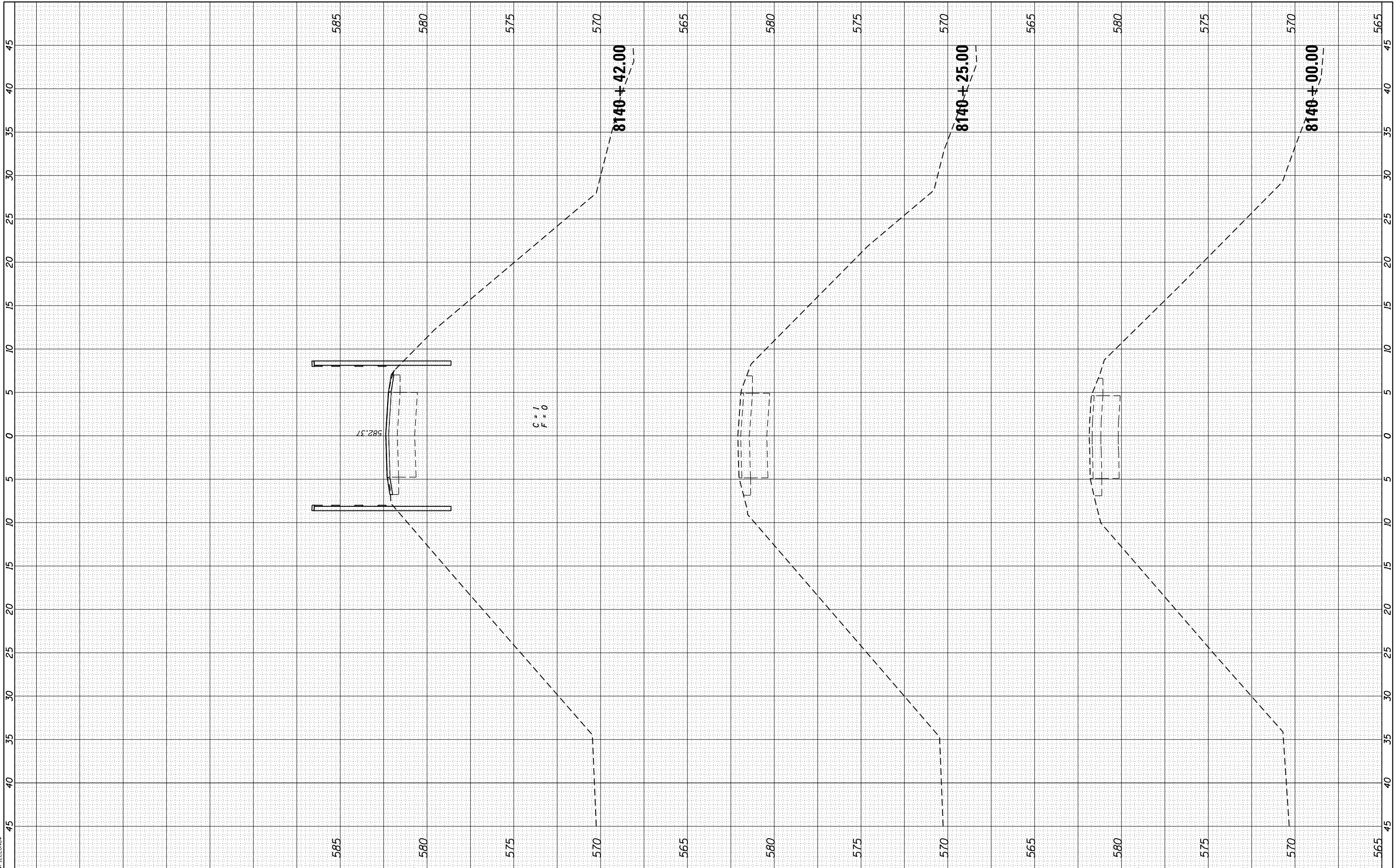

**KT**  
**KUHN & TRELLO**  
 CONSULTING ENGINEERS  
 A Limited Liability Company  
 209 N. 7th Street, 3rd Floor  
 Springfield, IL 62702  
 Phone: 217-528-2144  
 Professional Design Firm No. 184-006526

USER NAME = msutheard	DESIGNED <i>MDS</i>	REVISED -
FILE NAME = 17022-sht-16_XSht-Trail.dgn	DRAWN <i>MDS</i>	REVISED -
PLOT SCALE = 10.0000' / in.	CHECKED <i>KLK</i>	REVISED -
PLOT DATE = 6/17/2020	DATE <i>6/17/20</i>	REVISED -

**CITY OF PANA  
 LINCOLN PRAIRIE TRAIL BRIDGE REPLACEMENT**

<b>CROSS SECTIONS BIKE TRAIL</b>	
SCALE:	SHEET OF SHEETS STA. 8140+00.00 TO STA. 8140+42.00

F.A. RTE.	SECTION	COUNTY	TOTAL SHEETS	SHEET NO.
	16-00054-00-BR	CHRISTIAN	20	16
			CONTRACT NO. 93750	
ILLINOIS FED. AID PROJECT				

FINAL SURVEY NO.	SURVEYED	DATE
NOTE BOOK	PLOTTED	
AREAS CHECKED	TEMPLATE	
	AREAS	
	CHECKED	

ORIGINAL SURVEY NO.	SURVEYED	DATE
NOTE BOOK	PLOTTED	
AREAS CHECKED	TEMPLATE	
	AREAS	
	CHECKED	

PLOT DRIVER = #PLTDVRS\*  
FILE NAME = #FILELGN#

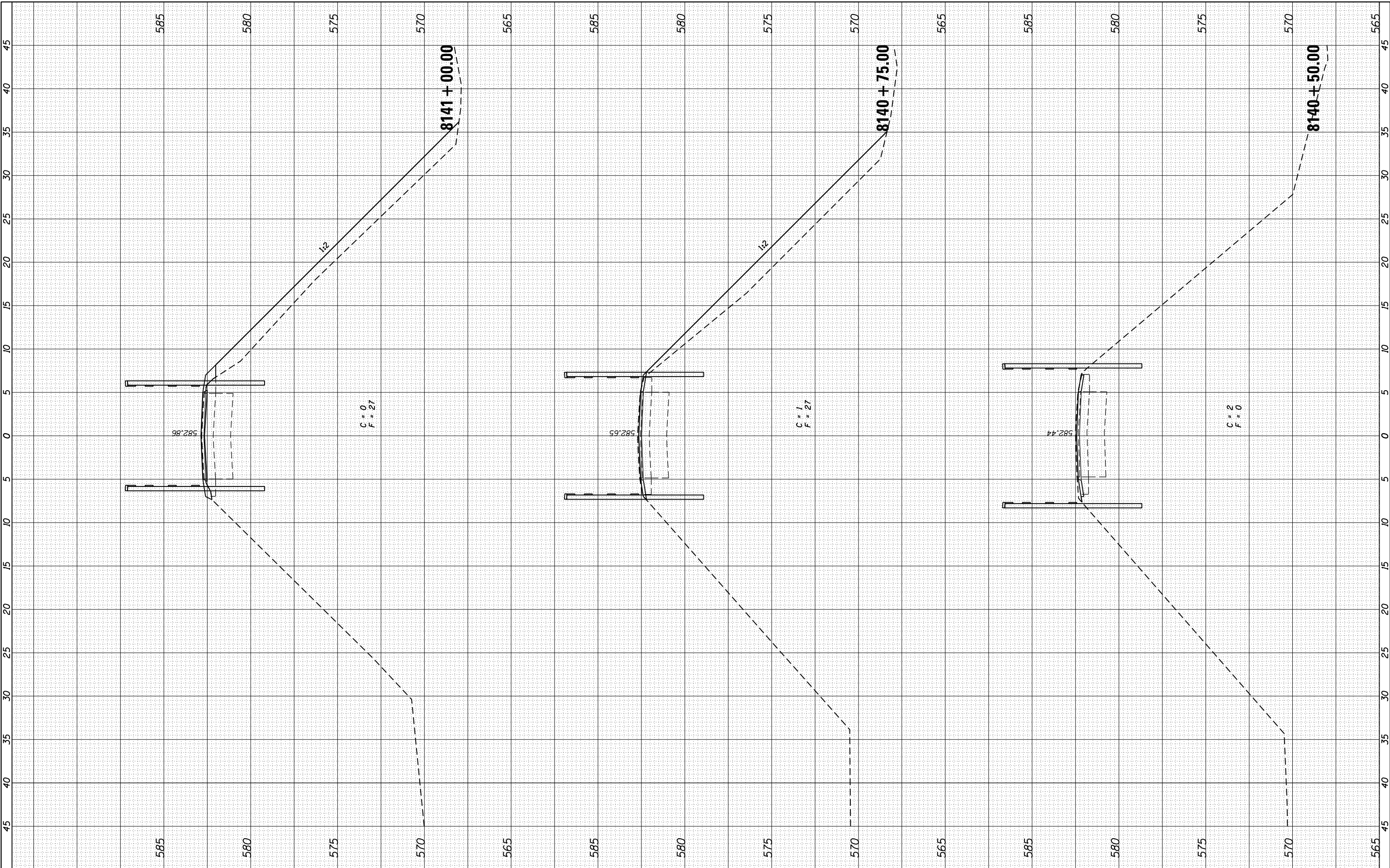

USER NAME = msutheard	DESIGNED MDS	REVISED -
FILE NAME = 17022-sht-16_XSht-Trail.dgn	DRAWN MDS	REVISED -
PLOT SCALE = 10.0000" / 1"	CHECKED KLK	REVISED -
PLOT DATE = 6/17/2020	DATE 6/17/20	REVISED -

**CITY OF PANA  
LINCOLN PRAIRIE TRAIL BRIDGE REPLACEMENT**

**CROSS SECTIONS  
BIKE TRAIL**

SCALE: SHEET OF SHEETS STA. 8140+50.00 TO STA. 8141+00.00

F.A. RTE.	SECTION	COUNTY	TOTAL SHEETS	SHEET NO.
	16-00054-00-BR	CHRISTIAN	20	17
			CONTRACT NO. 93750	
ILLINOIS FED. AID PROJECT				

FINAL SURVEY NO.	SURVEYED	DATE
NOTE BOOK	PLOTTED	
AREAS CHECKED	TEMPLATE	
AREAS CHECKED	AREAS	

ORIGINAL SURVEY NO.	SURVEYED	DATE
NOTE BOOK	PLOTTED	
AREAS CHECKED	TEMPLATE	
AREAS CHECKED	AREAS	

PLOT DRIVER = #PLTDVRS\*  
FILE NAME = #PFILELGN#

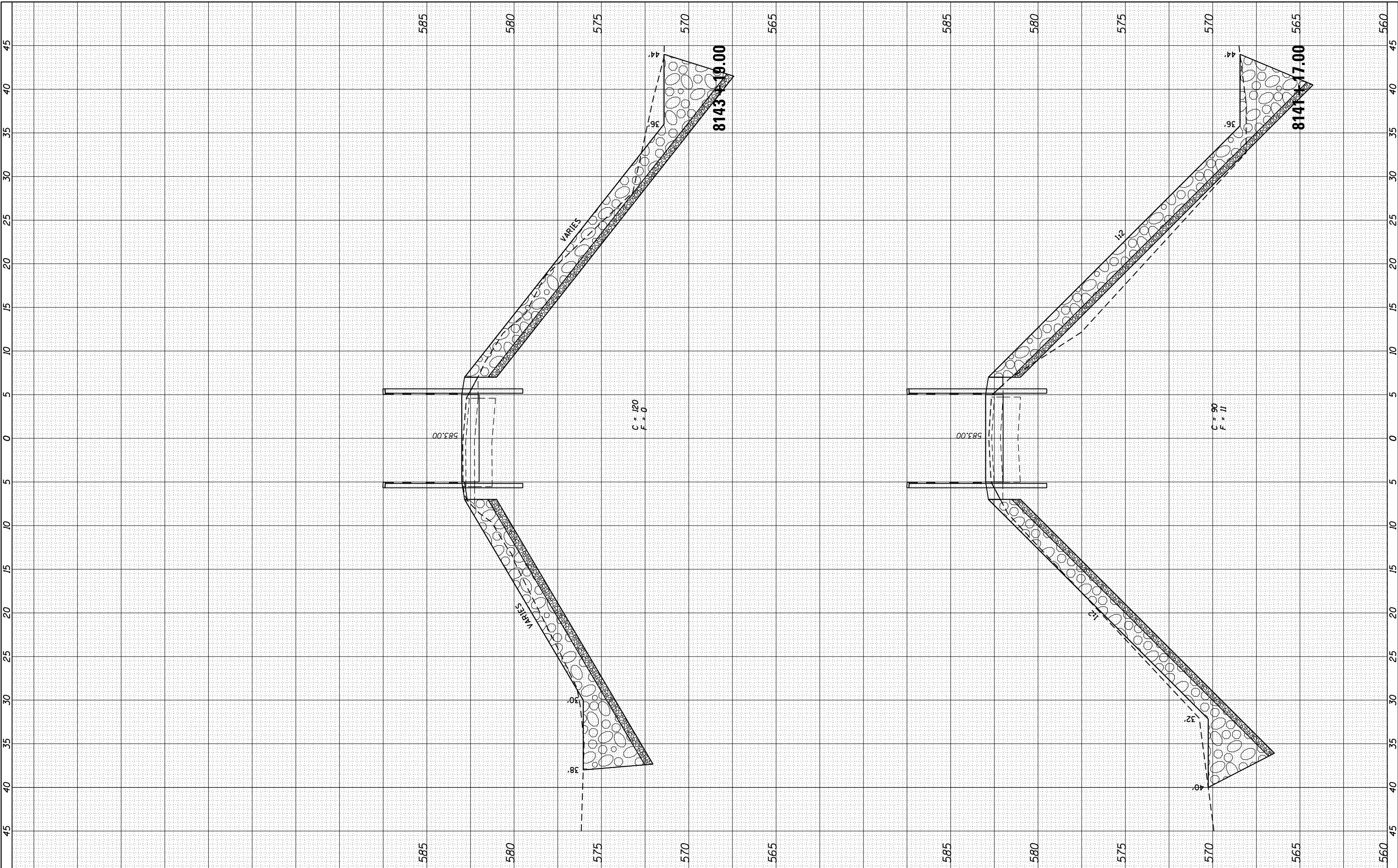

USER NAME = msutheard	DESIGNED MDS	REVISED -
FILE NAME = 17022-sht-16-XSht-Trail.dgn	DRAWN MDS	REVISED -
PLOT SCALE = 10.0000' / 1"	CHECKED KLK	REVISED -
PLOT DATE = 6/17/2020	DATE 6/17/20	REVISED -

**CITY OF PANA  
LINCOLN PRAIRIE TRAIL BRIDGE REPLACEMENT**

**CROSS SECTIONS  
BIKE TRAIL**

SCALE: SHEET OF SHEETS STA. 8141+17.00 TO STA. 8143+19.00

F.A. RTE.	SECTION	COUNTY	TOTAL SHEETS	SHEET NO.
	16-00054-00-BR	CHRISTIAN	20	18
				CONTRACT NO. 93750
				ILLINOIS FED. AID PROJECT



FINAL SURVEY NO.	SURVEYED PLOTTED AREAS CHECKED	BY	DATE

ORIGINAL SURVEY NO.	SURVEYED PLOTTED AREAS CHECKED	BY	DATE

PLOT DRIVER = #PLTRVRS\*  
FILE NAME = #FIELLONS\*

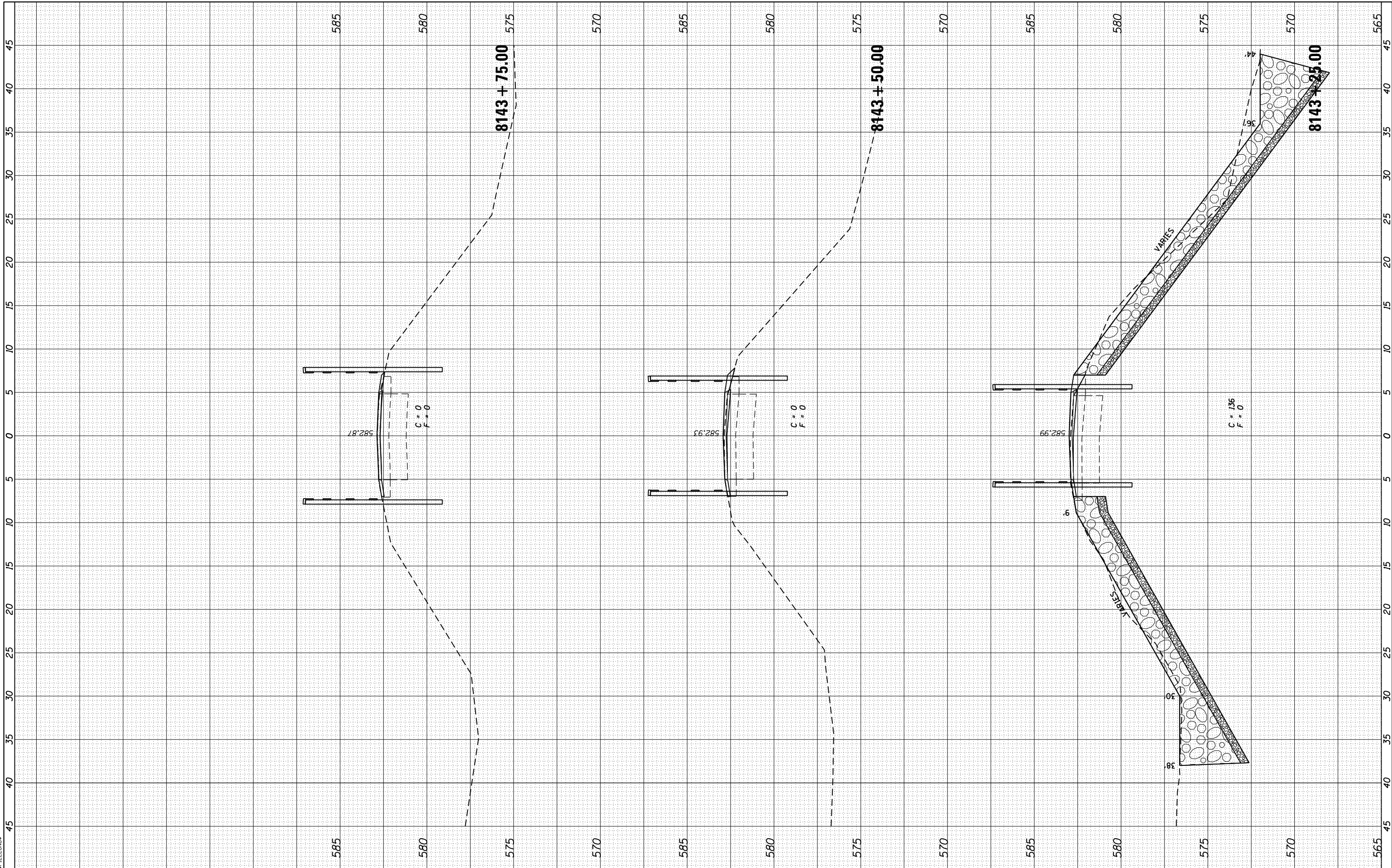

**KT** KUHN & TRELLO  
CONSULTING ENGINEERS  
A Limited Liability Company  
209 N. 7th Street, 3rd Floor  
Springfield, IL 62702  
PHONE: 217-822-2144  
Professional Design Firm No. 184-006526

USER NAME = msutheard	DESIGNED MDS	REVISED -
FILE NAME = 17022-sht-16_XSht-Trail.dgn	DRAWN MDS	REVISED -
PLOT SCALE = 10.0000' / 1"	CHECKED KLK	REVISED -
PLOT DATE = 6/17/2020	DATE 6/17/20	REVISED -

**CITY OF PANA  
LINCOLN PRAIRIE TRAIL BRIDGE REPLACEMENT**

**CROSS SECTIONS  
BIKE TRAIL**

SCALE: SHEET OF SHEETS STA. 8143+25.00 TO STA. 8143+75.00

F.A. RTE.	SECTION	COUNTY	TOTAL SHEETS	SHEET NO.
	16-00054-00-BR	CHRISTIAN	20	19
				CONTRACT NO. 93750

ILLINOIS FED. AID PROJECT

FINAL SURVEY NO.	SURVEYED	BY	DATE
NOTE BOOK	PLOTTED		
AREAS CHECKED	TEMPLATE		
	AREAS CHECKED		

ORIGINAL SURVEY NO.	SURVEYED	BY	DATE
NOTE BOOK	PLOTTED		
AREAS CHECKED	TEMPLATE		
	AREAS CHECKED		

PLOT DRIVER = #PLTDVRS#  
FILE NAME = #FILELNOMS#

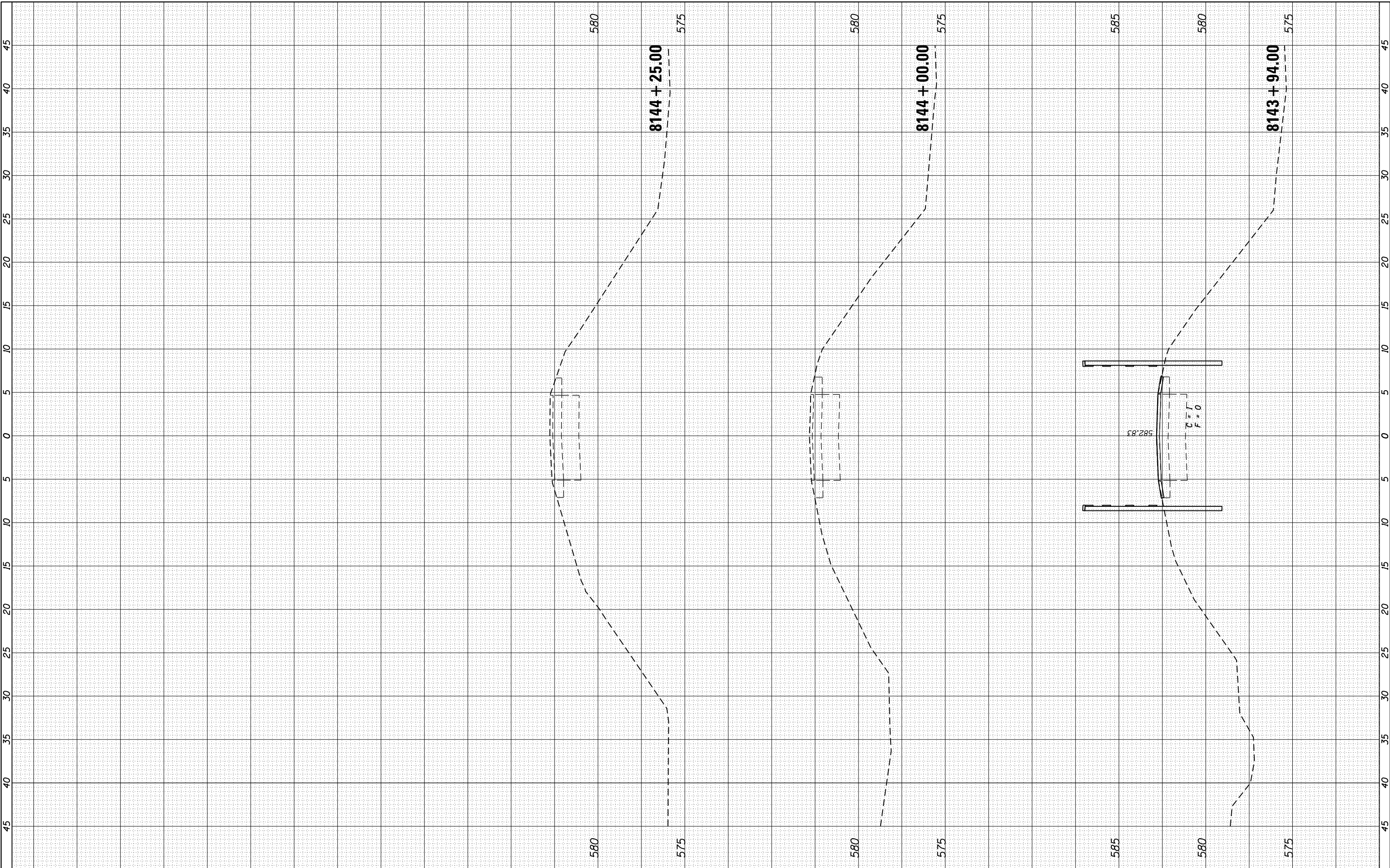

**KT**  
**KUHN & TRELLO**  
 CONSULTING ENGINEERS  
 A Limited Liability Company  
 209 N. 7th Street, 3rd Floor  
 Springfield, IL 62703  
 Phone: 217-824-2144  
 Professional Design Firm No. 184-006526

USER NAME = msutheard	DESIGNED <i>MDS</i>	REVISED -
FILE NAME = 17022-sht-16-XSht-Trail.dgn	DRAWN <i>MDS</i>	REVISED -
PLOT SCALE = 10.0000' / 1"	CHECKED <i>KLK</i>	REVISED -
PLOT DATE = 6/17/2020	DATE <i>6/17/20</i>	REVISED -

**CITY OF PANA**  
**LINCOLN PRAIRIE TRAIL BRIDGE REPLACEMENT**

**CROSS SECTIONS**  
**BIKE TRAIL**

SCALE: SHEET OF SHEETS STA. 8143+94.00 TO STA. 8144+25.00

F.A. RTE.	SECTION	COUNTY	TOTAL SHEETS	SHEET NO.
	16-00054-00-BR	CHRISTIAN	20	20
			CONTRACT NO. 93750	
ILLINOIS FED. AID PROJECT				