

F.A.I. RTE.	SECTION	COUNTY	TOTAL SHEETS	SHEET NO.
94	2005-068 LS	COOK	58	31
STA. 153+09 (SB I-57) TO STA. 154+00 (SB I-57)		1214+95 (SB I-94) TO STA. 2213+00 (NB I-94)		
FED. ROAD DIST. NO.		ILLINOIS FED. AID PROJECT		60A74

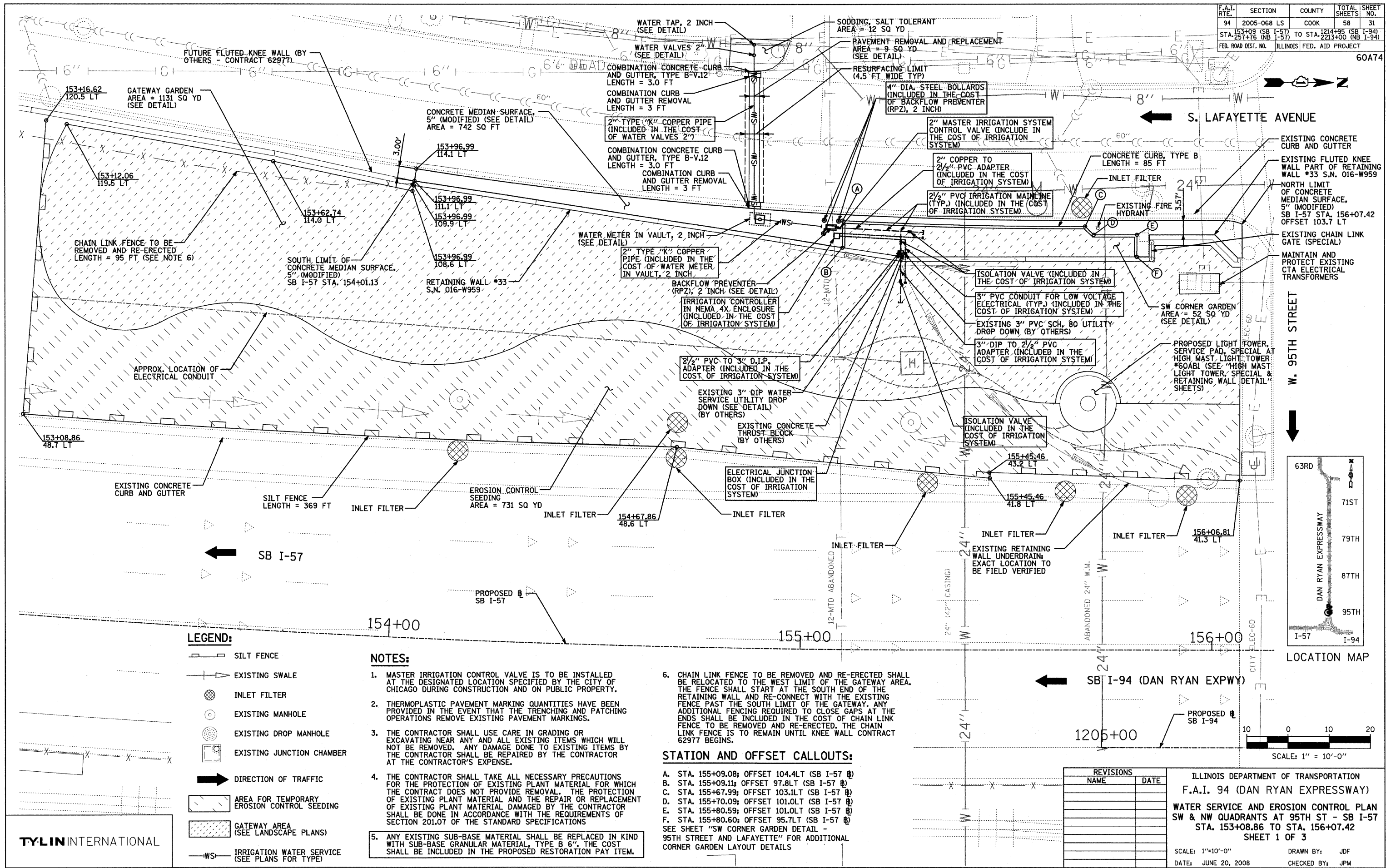

**LEGEND:**

- SILT FENCE
- EXISTING SWALE
- INLET FILTER
- EXISTING MANHOLE
- EXISTING DROP MANHOLE
- EXISTING JUNCTION CHAMBER
- DIRECTION OF TRAFFIC
- AREA FOR TEMPORARY EROSION CONTROL SEEDING
- GATEWAY AREA (SEE LANDSCAPE PLANS)
- IRRIGATION WATER SERVICE (SEE PLANS FOR TYPE)

**NOTES:**

1. MASTER IRRIGATION CONTROL VALVE IS TO BE INSTALLED AT THE DESIGNATED LOCATION SPECIFIED BY THE CITY OF CHICAGO DURING CONSTRUCTION AND ON PUBLIC PROPERTY.
2. THERMOPLASTIC PAVEMENT MARKING QUANTITIES HAVE BEEN PROVIDED IN THE EVENT THAT THE TRENCHING AND PATCHING OPERATIONS REMOVE EXISTING PAVEMENT MARKINGS.
3. THE CONTRACTOR SHALL USE CARE IN GRADING OR EXCAVATING NEAR ANY AND ALL EXISTING ITEMS WHICH WILL NOT BE REMOVED. ANY DAMAGE DONE TO EXISTING ITEMS BY THE CONTRACTOR SHALL BE REPAIRED BY THE CONTRACTOR AT THE CONTRACTOR'S EXPENSE.
4. THE CONTRACTOR SHALL TAKE ALL NECESSARY PRECAUTIONS FOR THE PROTECTION OF EXISTING PLANT MATERIAL FOR WHICH THE CONTRACT DOES NOT PROVIDE REMOVAL. THE PROTECTION OF EXISTING PLANT MATERIAL AND THE REPAIR OR REPLACEMENT OF EXISTING PLANT MATERIAL DAMAGED BY THE CONTRACTOR SHALL BE DONE IN ACCORDANCE WITH THE REQUIREMENTS OF SECTION 201.07 OF THE STANDARD SPECIFICATIONS
5. ANY EXISTING SUB-BASE MATERIAL SHALL BE REPLACED IN KIND WITH SUB-BASE GRANULAR MATERIAL, TYPE B 6". THE COST SHALL BE INCLUDED IN THE PROPOSED RESTORATION PAY ITEM.

6. CHAIN LINK FENCE TO BE REMOVED AND RE-ERECTED SHALL BE RELOCATED TO THE WEST LIMIT OF THE GATEWAY AREA. THE FENCE SHALL START AT THE SOUTH END OF THE RETAINING WALL AND RE-CONNECT WITH THE EXISTING FENCE PAST THE SOUTH LIMIT OF THE GATEWAY. ANY ADDITIONAL FENCING REQUIRED TO CLOSE GAPS AT THE ENDS SHALL BE INCLUDED IN THE COST OF CHAIN LINK FENCE TO BE REMOVED AND RE-ERECTED. THE CHAIN LINK FENCE IS TO REMAIN UNTIL KNEE WALL CONTRACT 62977 BEGINS.

**STATION AND OFFSET CALLOUTS:**

- A. STA. 155+09.08; OFFSET 104.4LT (SB I-57 @)
  - B. STA. 155+09.11; OFFSET 97.8LT (SB I-57 @)
  - C. STA. 155+67.99; OFFSET 103.1LT (SB I-57 @)
  - D. STA. 155+70.09; OFFSET 101.0LT (SB I-57 @)
  - E. STA. 155+80.59; OFFSET 101.0LT (SB I-57 @)
  - F. STA. 155+80.60; OFFSET 95.7LT (SB I-57 @)
- SEE SHEET "SW CORNER GARDEN DETAIL - 95TH STREET AND LAFAYETTE" FOR ADDITIONAL CORNER GARDEN LAYOUT DETAILS

REVISIONS	
NAME	DATE

ILLINOIS DEPARTMENT OF TRANSPORTATION  
**F.A.I. 94 (DAN RYAN EXPRESSWAY)**  
**WATER SERVICE AND EROSION CONTROL PLAN**  
**SW & NW QUADRANTS AT 95TH ST - SB I-57**  
**STA. 153+08.86 TO STA. 156+07.42**  
**SHEET 1 OF 3**

SCALE: 1"=10'-0"  
 DATE: JUNE 20, 2008  
 DRAWN BY: JDF  
 CHECKED BY: JPM

**TYLIN INTERNATIONAL**

