

PROFILE SURVEYED BY DATE  
 POINTS CHECKED  
 NOTE BOOK NO. NOTED  
 NO. STRUCTURE INDICATING CHRD

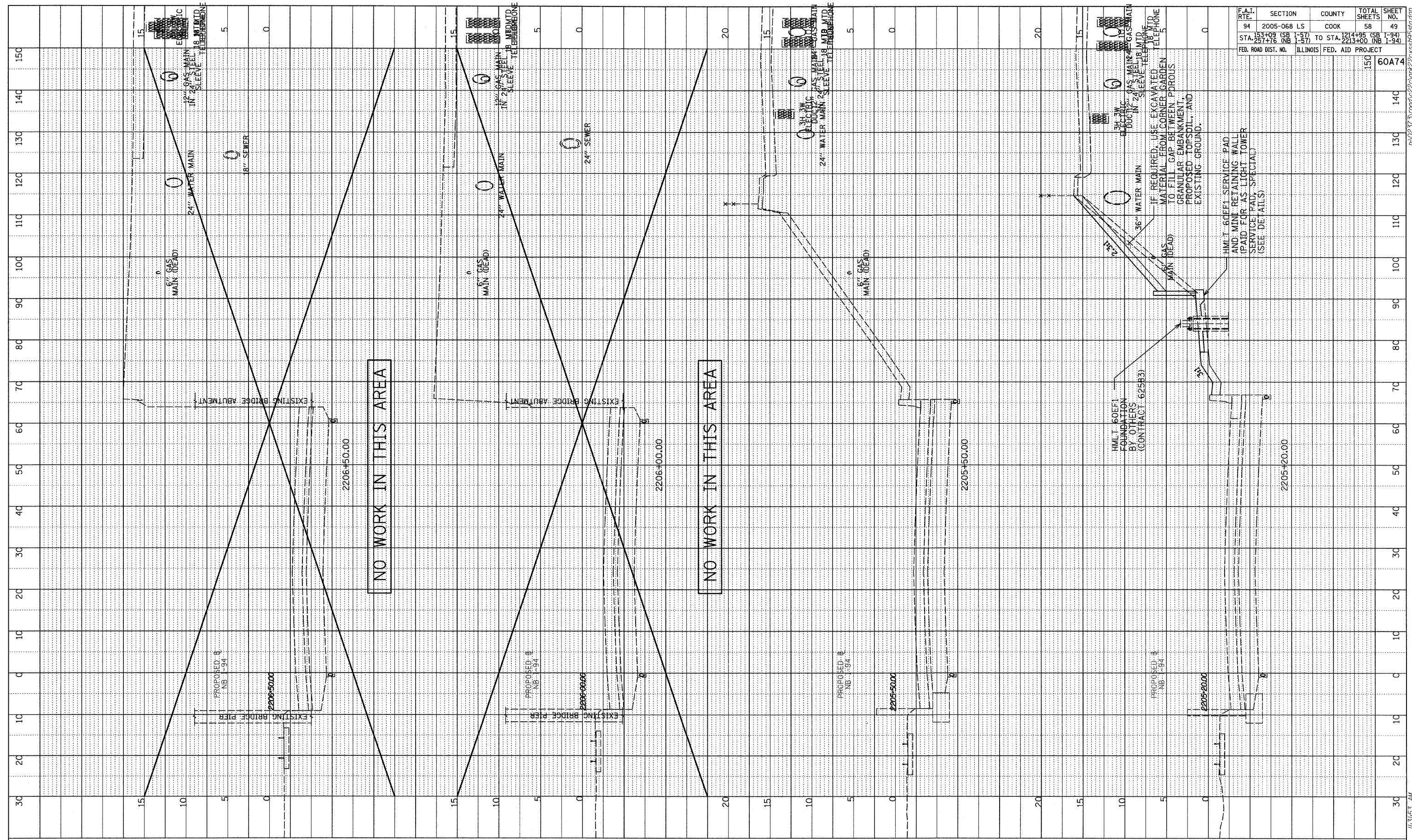

F.A.I. RTE.	SECTION	COUNTY	TOTAL SHEETS	SHEET NO.
94	2005-068 LS	COOK	58	49
STA. 153+09 (SB I-57) TO STA. 1214+95 (SB I-94)				
STA. 257+76 (NB I-57) TO STA. 2213+00 (NB I-94)				
FED. ROAD DIST. NO. ILLINOIS FED. AID PROJECT				
				150
				60A74

NO WORK IN THIS AREA

NO WORK IN THIS AREA

TYLIN INTERNATIONAL

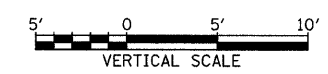
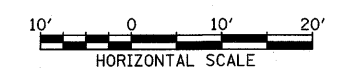

NB I-94 (DAN RYAN EXPRESSWAY)  
 STA. 2205+20 TO STA. 2206+50

6/20/2008 11:51:53 AM