

F.A.P. RTE.	SECTION	COUNTY	TOTAL SHEETS	SHEET NO.
852	18B	WILL	31	1
FED. ROAD DIST. NO.	ILLINOIS	CONTRACT NO. 60D87		

STATE OF ILLINOIS  
DEPARTMENT OF TRANSPORTATION  
DIVISION OF HIGHWAYS

**PROPOSED  
HIGHWAY PLANS**

FAP ROUTE 852/US ROUTE 52  
OVER FORKED CREEK  
SECTION 18B  
BRIDGE BEAM REPLACEMENT, NEW DECK

WILL COUNTY  
C-91-121-08

FOR INDEX OF SHEETS SEE SHEET NUMBER 2

THIS IMPROVEMENT IS LOCATED  
IN WILTON TOWNSHIP WITHIN  
UNINCORPORATED WILL COUNTY

**TRAFFIC DATA**

2005 ADT - 4700  
POSTED SPEED LIMIT - 45 MPH

**US 52 OVER FORKED CREEK**

SN: 099-0133 (STA. 65+70.00)  
3-SPAN PPC DECK BEAM BRIDGE  
ON PIERS AND CLOSED ABUTMENTS

IMPROVEMENT LOCATION  
SN: 099-0133

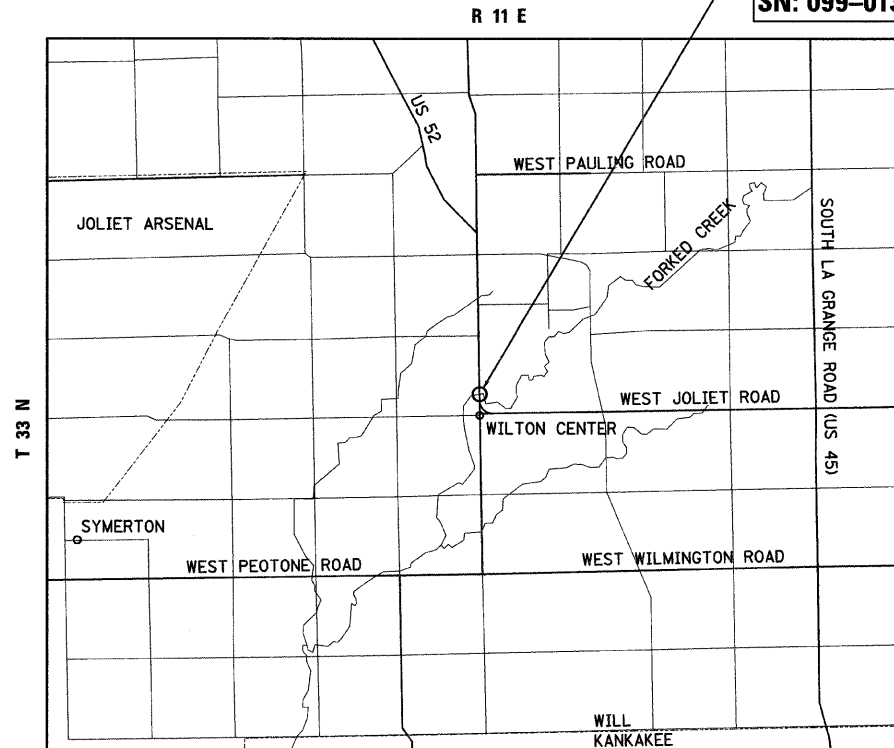

WILTON TOWNSHIP

LOCATION MAP

1" = 5000'

GROSS AND NET LENGTH OF PROJECT = 483 FT = 0.09 MI

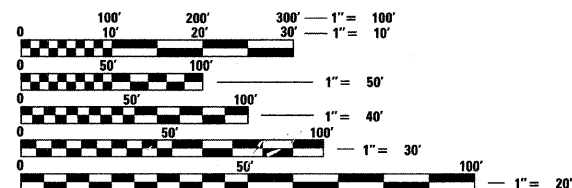

FULL SIZE PLANS HAVE BEEN PREPARED USING STANDARD  
ENGINEERING SCALES. REDUCED SIZED PLANS WILL NOT  
CONFORM TO STANDARD SCALES. IN MAKING MEASUREMENTS  
ON REDUCED PLANS, THE ABOVE SCALES MAY BE USED.

J.U.L.I.E.  
JOINT UTILITY LOCATION INFORMATION FOR EXCAVATION  
1-800-892-0123  
OR 811

**Ciorba Group, Inc.**

DESIGN FIRM  
REGISTRATION NUMBER

184-001016

CONSULTING ENGINEERS  
SUITE 402, 5507 NORTH CUMBERLAND AVE  
CHICAGO, ILLINOIS 60656 (773) 775-4009



Matthew J. Lehan  
DATE: 07/09/2008  
SEAL EXPIRES: 11/30/2009

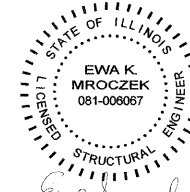

Ewa K. Mroczek  
DATE: 07/09/2008  
SEAL EXPIRES: 11/30/2009

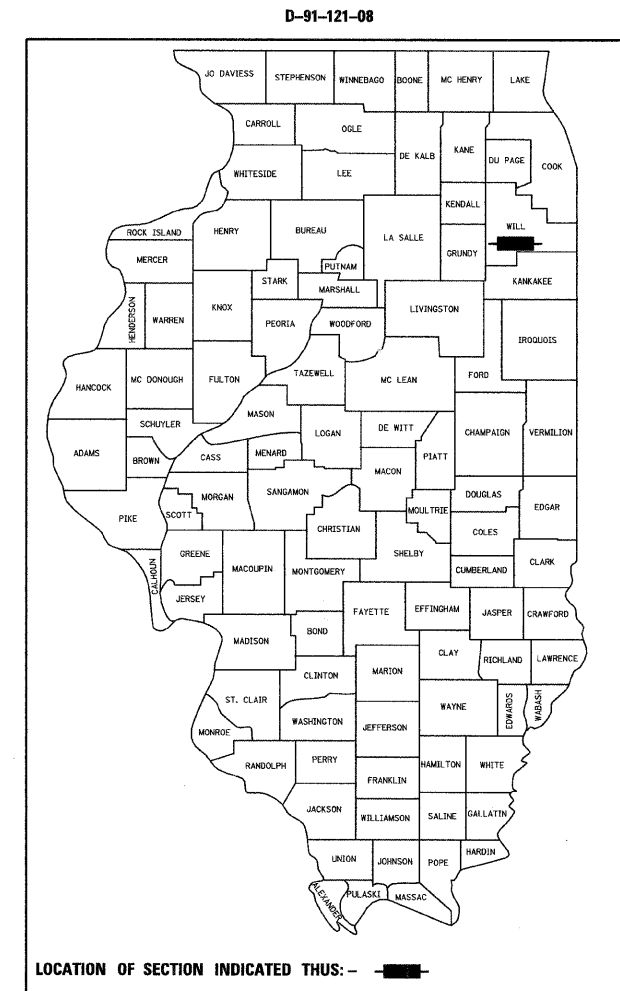

LOCATION OF SECTION INDICATED THUS: - [black rectangle] -

STATE OF ILLINOIS  
DEPARTMENT OF TRANSPORTATION  
DIVISION OF HIGHWAYS

SUBMITTED JULY 7, 2008

Diana M. O'Keefe  
DEPUTY DIRECTOR OF HIGHWAYS, REGION ENGINEER

August 15, 2008  
Eric E. Harnett  
ENGINEER OF DESIGN AND ENVIRONMENT

August 15, 2008  
Christina M. Reed  
DIRECTOR OF HIGHWAYS, CHIEF ENGINEER

**PRINTED BY THE AUTHORITY  
OF THE STATE OF ILLINOIS**

CONTRACT NO. 60D87

DISTRICT 1 DESIGN PLAN PREPARATION ENGINEER: K.ENG (847) 705-4247