

TYPICAL ENTRANCE/EXIT RAMP COMBINATION PAVEMENT MARKINGS

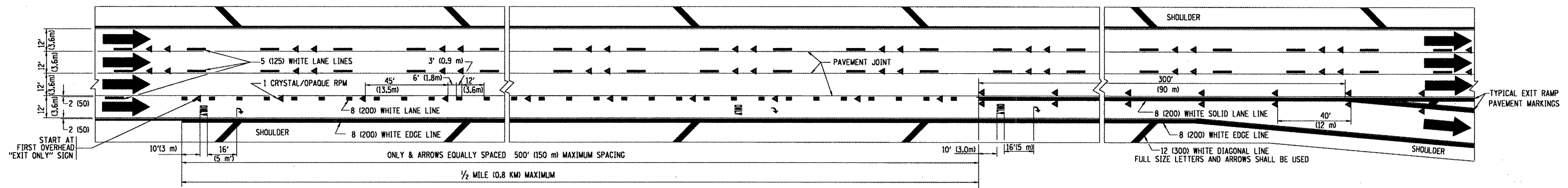

TYPICAL EXIT ONLY LANE PAVEMENT MARKINGS

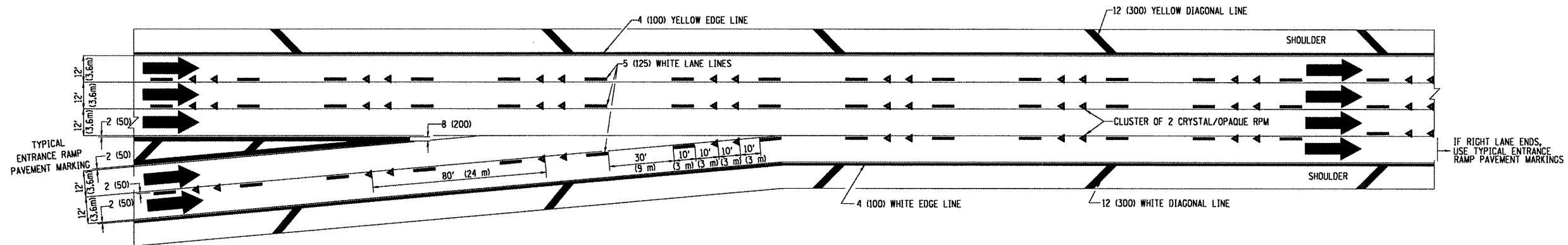

TYPICAL TWO LANE ENTRANCE RAMP PAVEMENT MARKINGS

FILE NAME =	USER NAME = smthkl	DESIGNED - D.W.S.	REVISED - A.H. 03-96	STATE OF ILLINOIS DEPARTMENT OF TRANSPORTATION	MULTI-LANE FREEWAY PAVEMENT MARKING DETAILS			F.A. -	SECTION	COUNTY	TOTAL SHEETS	SHEET NO.	
\dist\ntf2\user\smthkl\Desktop\CADD	DETAILS\to12.dgn	DRAWN -	REVISED - D.W.S. 07-96		SCALE: NONE	SHEET NO. 1 OF 2 SHEETS	STA.	TO STA.	VAR.	2008-050 PP	COOK	18	14
PLOT SCALE = 100.000' / IN.	CHECKED -	REVISOR - J.A.F. 02-06	REVISOR - S.P.B. 01-07					TC-12		CONTRACT NO. 60E99			
PLOT DATE = 6/24/2008	DATE - 01-90							FED. ROAD DIST. NO. 1 [ILLINOIS] FED. AID PROJECT					