

SECTION	COUNTY	TOTAL SHEETS	SHEET NO.
08-00053-00-LT	COOK/DUPAGE	15	4
IL RTE. 83 - STA. 1012+00 TO STA. 1034+00			
LIGHTING PLAN			

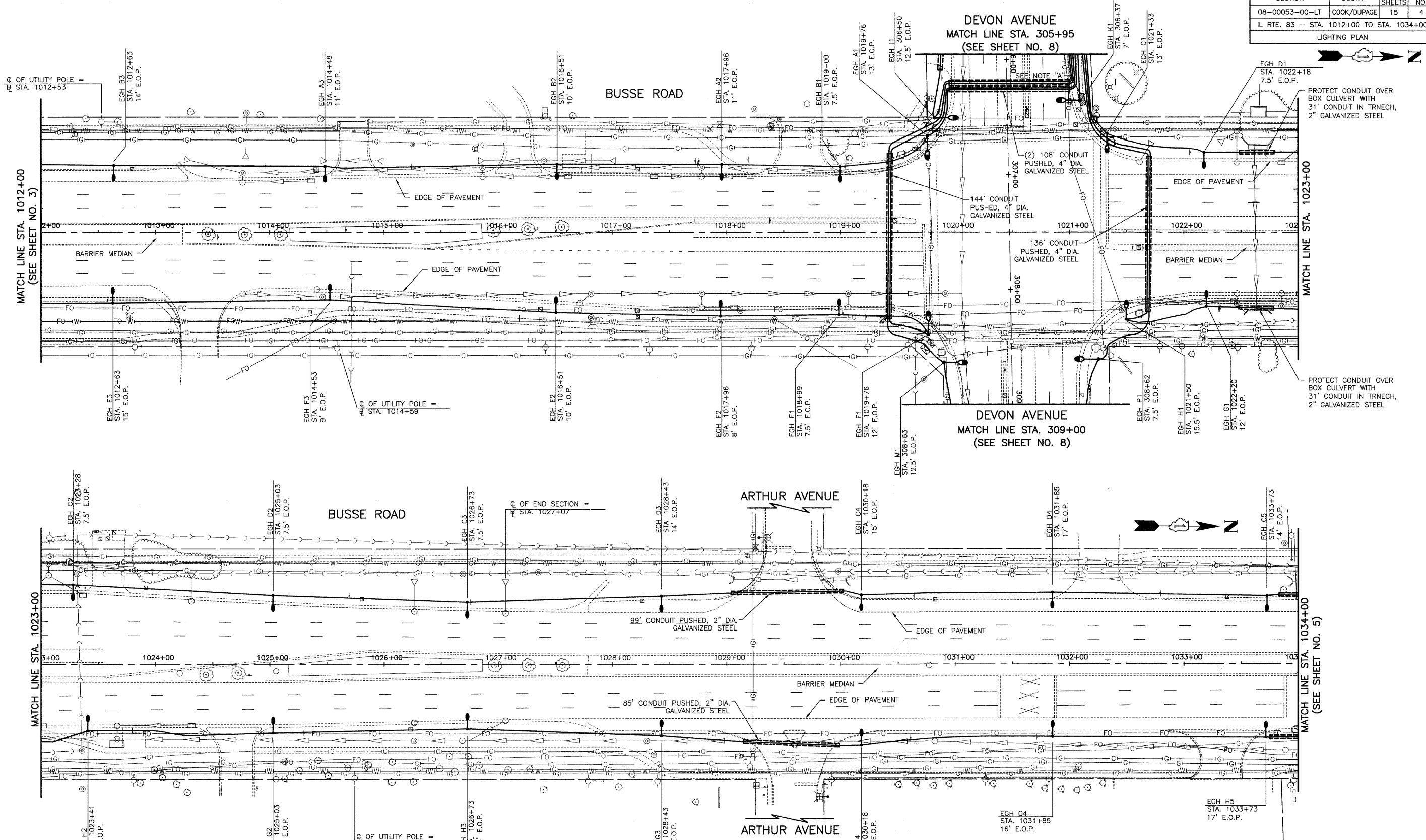

NOTES:  
 A SIDEWALK REMOVAL; PORTLAND CEMENT CONCRETE SIDEWALK 5 INCH

REVISIONS	
NAME	DATE

ILLINOIS DEPARTMENT OF TRANSPORTATION  
 ILLINOIS ROUTE 83  
 ROADWAY LIGHTING  
**LIGHTING PLAN**

ILLINOIS ROUTE 83 (BUSSE ROAD)  
 STA. 1012+00 TO STA. 1034+00

DATE: 05/14/2008  
 CHECKED BY: D.N.M.

SCALE IN FEET

