

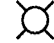



LEGEND

-  EXIST. 110 FT. HIGHMAST TOWER WITH 6-LUMINAIRE RING, 400W H.P.S.
-  PROP. 100 FT. HIGHMAST TOWER WITH 6-LUMINAIRE RING, 400W H.P.S.
-  ELECTRIC CABLE IN DUCT
-  CONDUIT PUSHED, SIZE AND LENGTH AS SHOWN

PULL EXIST. WIRES INTO NEW CONDUIT, SPLICE NEW CONDUIT TO EXIST. CONDUIT, SPLICE NEW GROUND TO EXIST. GROUND WIRE, AND INSTALL NEW GROUND ADJACENT TO NEW CONDUIT.

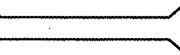
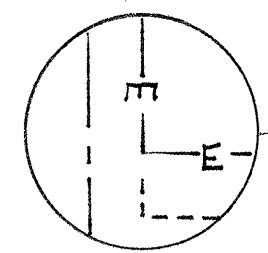

NOTES:

- 1) CONTRACTOR SHALL CAREFULLY HAND DIG AND LOCATE EXIST. CABLE. COST TO OPEN AND CLOSE EXCAVATIONS SHALL BE INCLUDED WITH CONDUIT PUSHED.
- 2) CONTRACTOR SHALL MEGGER TEST THE CONDUCTORS BEFORE AND AFTER WORK IS COMPLETED IN ORDER TO VERIFY THAT CONDUCTOR/CKT INSULATION IS NOT DEGRADED.
- 3) A GREEN INSULATED EQUIPMENT GROUNDING CONDUCTOR SHALL BE RUN FROM THE BARE GROUND WIRE TO THE NEW TOWER

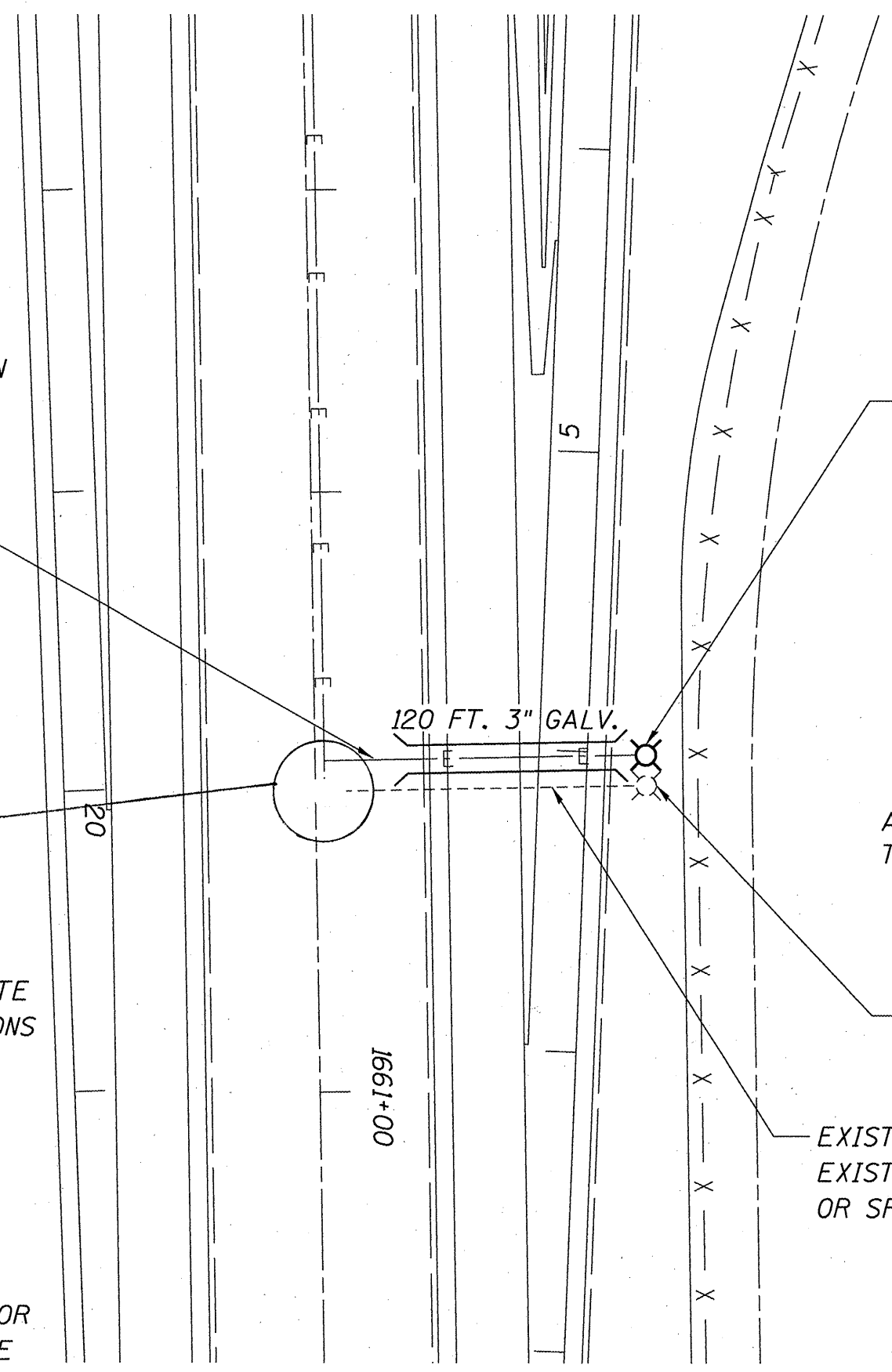

PROP. FOUNDATION, LIGHT TOWER, BORE, AND CONDUIT.

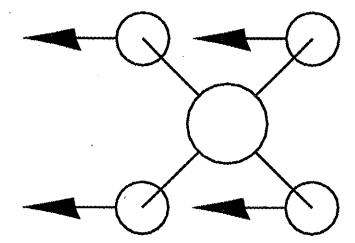

AIM LUMINAIRES PERPENDICULAR TO THE ϕ OF ROADWAY

EXIST. FOUNDATION TO BE REMOVED TO 2.5 FT. BELOW GRADE.

EXIST. CONDUIT TO BE ABANDONED IN PLACE. EXIST. WIRES TO BE REUSED - DO NOT CUT OR SPLICE

LOCATION #1

LOCATION #1 PLAN
FAI 55 (I-55)
SECTION D6 LIGHTING 2009
SANGAMON/MONTGOMERY COUNTY

Rev.