

F.A.U. RTE.	SECTION	COUNTY	TOTAL SHEETS	SHEET NO.
1230	03-00159-00-PV	LAKE	262	23
STA.		TO STA.		
FED. ROAD DIST. NO. 1		ILLINOIS	FED. AID PROJECT	
CONTRACT: 83828				

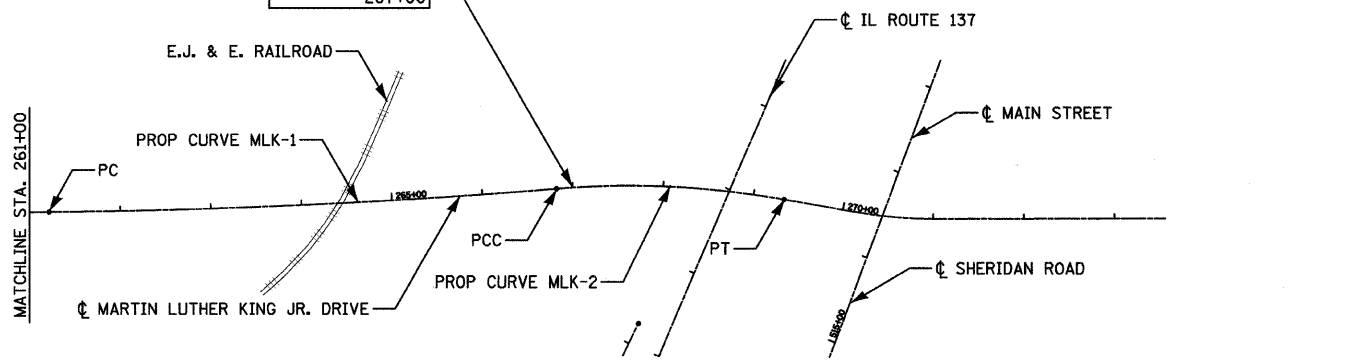
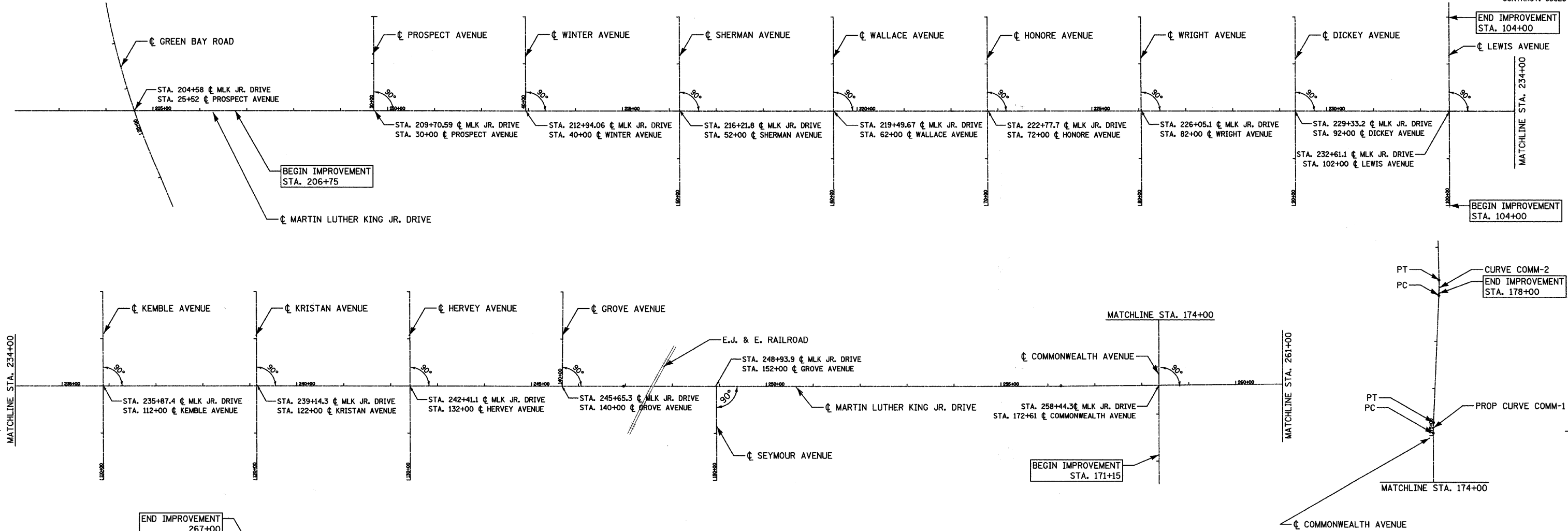

PROP. CURVE MLK-1  
 PI STA. = 264+01.98  
 $\Delta = 4^\circ 00' 48''$  (LT)  
 $D = 0^\circ 42' 58''$   
 $R = 8,000.00'$   
 $T = 280.29'$   
 $L = 560.35'$   
 $E = 4.91'$   
 P.C.C. STA. = 261+21.69  
 P.T. STA. = 266+82.04

PROP. CURVE MLK-2  
 PI STA. = 268+08.40  
 $\Delta = 14^\circ 24' 12''$  (RT)  
 $D = 5^\circ 43' 46''$   
 $R = 1,000.00'$   
 $T = 126.36'$   
 $L = 251.39'$   
 $E = 7.95'$   
 P.C.C. STA. = 266+82.04  
 P.T. STA. = 269+33.43

CURVE NO.	ALIGNMENT POINT	NORTHING	EASTING
MLK-1	PC = 261+21.69	9,964.90	10,247.78
	PI = 264+01.98	9,958.83	10,528.01
	PCC = 266+82.04	9,972.38	10,807.97
MLK-2	PCC = 266+82.04	9,972.38	10,807.97
	PI = 268+08.40	9,978.49	10,934.18
	PT = 269+33.43	9,953.01	11,057.94
COMM-1	PC = 175+05.44	10,215.48	9,969.61
	PI = 175+16.63	10,226.66	9,969.93
	PT = 175+27.81	10,201.00	10,469.40
COMM-2	PC = 177+97.67	10,506.95	9,990.63
	PI = 178+14.17	10,523.40	9,991.85
	PT = 178+30.66	10,539.90	9,991.97

PROP. CURVE COMM-1  
 PI STA. = 175+16.63  
 $\Delta = 2^\circ 33' 48''$  (RT)  
 $D = 11^\circ 27' 33''$   
 $R = 500.00'$   
 $T = 11.19'$   
 $L = 22.37'$   
 $E = 0.13'$   
 P.C. STA. = 175+05.44  
 P.T. STA. = 175+27.81

PROP. CURVE COMM-2  
 PI STA. = 178+14.17  
 $\Delta = 3^\circ 46' 50''$  (LT)  
 $D = 11^\circ 27' 33''$   
 $R = 500.00'$   
 $T = 16.50'$   
 $L = 32.99'$   
 $E = 0.27'$   
 P.C. STA. = 177+97.67  
 P.T. STA. = 178+30.66

PROPOSED $\phi$ MARTIN LUTHER KING JR. DRIVE		
STA.	NORTHING	EASTING
206+75	10,134.05	4,803.74
256+27.70	9,975.61	9,753.90
267+00	9,973.08	10,825.91

REVISIONS	
NAME	DATE

**Clorba Group, Inc.**  
 CONSULTING ENGINEERS  
 5507 North Cumberland Avenue, Suite 402 Chicago, Illinois 60656  
 Tel. 773.775.4009 Fax 773.775.4014 Email chicago@clorba.com

CITY OF NORTH CHICAGO  
 MARTIN LUTHER KING JR. DRIVE IMPROVEMENTS

ALIGNMENT

SCALE: 1"=100'  
 DATE: APRIL, 2008  
 DRAWN BY: KMS  
 CHECKED BY: MJL

DATE: 6/30/2008  
 TIME: 9:56:54 AM  
 FILENAME: N:\PROJ\161\Design\Alignment\161-align03.dgn