

F.A.U. RTE.	SECTION	COUNTY	TOTAL SHEETS	SHEET NO.
1230	03-00159-00-PV	LAKE	262	68
STA. 222+00		TO STA. 252+00		
FED. ROAD DIST. NO. 1		ILLINOIS FED. AID PROJECT		
CONTRACT: 83828				

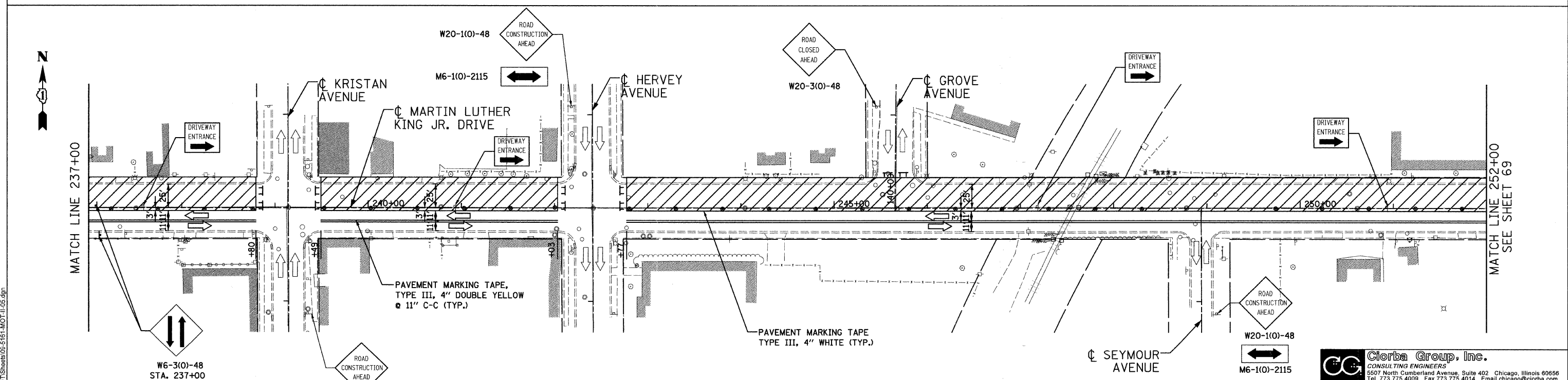
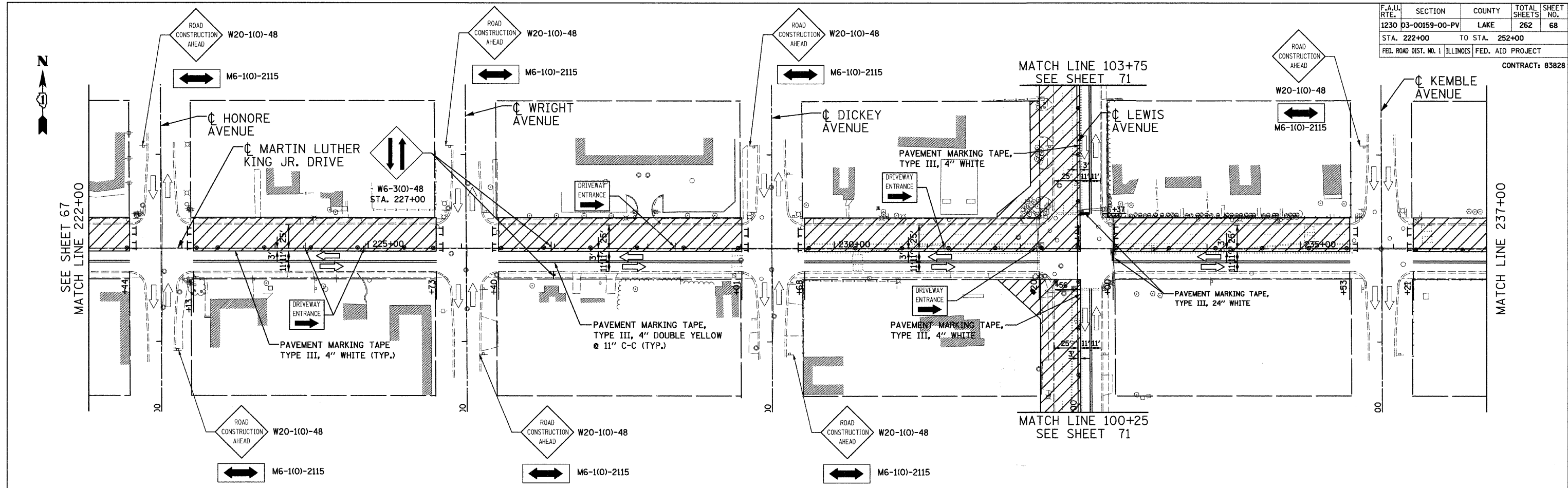

DATE: 6/30/2008
 FILENAME: N:\PROJ\05161\Design\MOT\Sheets\05-5161-MOT-11-05.dgn

LEGEND	
[Symbol]	TYPE II BARRICADE OR DRUM W/ MONODIRECTIONAL STEADY BURNING LIGHT (SPACED @ 50' CENTERS IN TANGENTS, 25' CENTERS IN TAPERS)
[Symbol]	WORK ZONE
[Symbol]	SIGN ON PERMANENT OR TEMPORARY SUPPORT

REVISIONS	
NAME	DATE

Clorba Group, Inc.
 CONSULTING ENGINEERS
 5507 North Cumberland Avenue, Suite 402 Chicago, Illinois 60656
 Tel. 773.775.4009 Fax 773.775.4014 Email chicago@clorba.com

CITY OF NORTH CHICAGO
 MARTIN LUTHER KING JR. DRIVE IMPROVEMENTS
 TRAFFIC CONTROL AND PROTECTION
 STAGE 2

SCALE: 1"=50'
 DATE: APRIL, 2008
 DRAWN BY: BWS
 CHECKED BY: MJL